



# Rogers

## Assessment Property Record Card for Tax Year 2026

Data provided by LISA DELOZIER County Assessor

Date 04/16/2026  
Time 22:28:49  
Page 1

Assessment Data					Primary Image																																																																																																																				
<b>Account</b> 660029418 <b>Parcel ID</b> 000000-00-0-00027-001-0014 <b>Cadastral ID</b> 34-21-15-04100 <b>Property Type</b> REAL - Real Property <b>Property Class</b> RRP VI Area 4 <b>Tax Area</b> 4 - VERDIGRIS/VERD FIRE <b>Name ID</b> 326914 JORDAN, DEBORAH JEANINE & JOSEPH D & OLIVER RAY & JANET SUE JORDAN 7422 E HEATHER DR CLAREMORE OK 74019-0000																																																																																																																									
<b>Parcel Location</b> <b>Situs</b> 07422 HEATHER DR <b>Subdivision</b> BATTENFIELD ACRES 4 <b>Lot/Block</b> 0014 / 0001 <b>Parcel Size</b> .75 - Lots <b>Sec/Twn/Rng</b> 34 / 21 / 15 / 5 <b>Neighborhood</b> 1122 - R-V04-SE VERDIGRIS <b>School District</b> S008 - VERDIGRIS SCHOOLS																																																																																																																									
<b>Legal Description</b> Lat/Long: 36.25913389 -95.69686200					<b>Building Permits</b> <table border="1"> <thead> <tr> <th>Number</th> <th>Description</th> <th>Opened</th> <th>Closed</th> <th>Amount</th> </tr> </thead> <tbody> <tr> <td>R22 332</td> <td>R23 NEW RMA 428 SQ FT</td> <td>08/2022</td> <td>08/2023</td> <td>60,000</td> </tr> </tbody> </table>					Number	Description	Opened	Closed	Amount	R22 332	R23 NEW RMA 428 SQ FT	08/2022	08/2023	60,000																																																																																																						
Number	Description	Opened	Closed	Amount																																																																																																																					
R22 332	R23 NEW RMA 428 SQ FT	08/2022	08/2023	60,000																																																																																																																					
<b>Exemptions</b> <table border="1"> <thead> <tr> <th>Code</th> <th>Type</th> <th>Active</th> <th>Maximum</th> <th>Exemption</th> </tr> </thead> <tbody> <tr> <td>H</td> <td>Homestead</td> <td>Yes</td> <td>1,000</td> <td>1,000</td> </tr> </tbody> </table>					Code	Type	Active	Maximum	Exemption	H	Homestead	Yes	1,000	1,000	<b>Sale History</b> <table border="1"> <thead> <tr> <th>Bk/Pg</th> <th>Grantor</th> <th>Date</th> <th>Price</th> <th>Code</th> </tr> </thead> <tbody> <tr> <td>/</td> <td>METZ, JEFF</td> <td>02/19/2019</td> <td>160,500</td> <td>YES</td> </tr> <tr> <td>802/503</td> <td></td> <td></td> <td>68,000</td> <td>No</td> </tr> </tbody> </table>					Bk/Pg	Grantor	Date	Price	Code	/	METZ, JEFF	02/19/2019	160,500	YES	802/503			68,000	No																																																																																							
Code	Type	Active	Maximum	Exemption																																																																																																																					
H	Homestead	Yes	1,000	1,000																																																																																																																					
Bk/Pg	Grantor	Date	Price	Code																																																																																																																					
/	METZ, JEFF	02/19/2019	160,500	YES																																																																																																																					
802/503			68,000	No																																																																																																																					
<b>Parcel Valuation</b> <table border="1"> <thead> <tr> <th>Source</th> <th>REAL</th> <th>Fair Cash</th> <th>Capped</th> <th>Asmnt Level</th> <th>Assessed</th> <th>Levy Rate</th> <th>104.132</th> <th>Current Tax</th> </tr> </thead> <tbody> <tr> <td>Remove Cap</td> <td>2020</td> <td>Land Value 76,304</td> <td>51,536</td> <td>11%</td> <td>5,669</td> <td>Assessed</td> <td>22,404</td> <td>2,332.97</td> </tr> <tr> <td>Year Frozen</td> <td>0</td> <td>Improvements 157,795</td> <td>152,140</td> <td></td> <td>16,735</td> <td>Penalty</td> <td>0</td> <td></td> </tr> <tr> <td>Uncapped Value</td> <td>0</td> <td>Mobile Home 0</td> <td>0</td> <td></td> <td>0</td> <td>Exemption</td> <td>1,000</td> <td>-87.00</td> </tr> <tr> <td>TIF Project ID</td> <td>0</td> <td>Total Value 234,099</td> <td>203,676</td> <td></td> <td>22,404</td> <td>Total Taxable</td> <td>21,404</td> <td>2,246.00</td> </tr> </tbody> </table>										Source	REAL	Fair Cash	Capped	Asmnt Level	Assessed	Levy Rate	104.132	Current Tax	Remove Cap	2020	Land Value 76,304	51,536	11%	5,669	Assessed	22,404	2,332.97	Year Frozen	0	Improvements 157,795	152,140		16,735	Penalty	0		Uncapped Value	0	Mobile Home 0	0		0	Exemption	1,000	-87.00	TIF Project ID	0	Total Value 234,099	203,676		22,404	Total Taxable	21,404	2,246.00																																																																			
Source	REAL	Fair Cash	Capped	Asmnt Level	Assessed	Levy Rate	104.132	Current Tax																																																																																																																	
Remove Cap	2020	Land Value 76,304	51,536	11%	5,669	Assessed	22,404	2,332.97																																																																																																																	
Year Frozen	0	Improvements 157,795	152,140		16,735	Penalty	0																																																																																																																		
Uncapped Value	0	Mobile Home 0	0		0	Exemption	1,000	-87.00																																																																																																																	
TIF Project ID	0	Total Value 234,099	203,676		22,404	Total Taxable	21,404	2,246.00																																																																																																																	
<b>Assessment History</b> <table border="1"> <thead> <tr> <th>Tax Year</th> <th>Statement Number</th> <th>Billed Owner</th> <th>Tax Area</th> <th>Total Value</th> <th>Exemptions</th> <th>Taxable Value</th> <th>Billed Tax</th> </tr> </thead> <tbody> <tr><td>2025</td><td>2025-660029418</td><td>JORDAN, DEBORAH JEANINE &amp;</td><td>4</td><td>228,688</td><td>1000</td><td>20,752</td><td>2,178.00</td></tr> <tr><td>2024</td><td>2024-660029418</td><td>JORDAN, DEBORAH JEANINE &amp;</td><td>4</td><td>238,544</td><td>1000</td><td>20,119</td><td>1,939.00</td></tr> <tr><td>2023</td><td>2023-660029418</td><td>JORDAN, DEBORAH JEANINE &amp;</td><td>4</td><td>182,803</td><td>1000</td><td>17,777</td><td>1,688.00</td></tr> <tr><td>2022</td><td>2022-660029418</td><td>JORDAN, DEBORAH JEANINE &amp;</td><td>4</td><td>165,727</td><td>1000</td><td>17,230</td><td>1,667.00</td></tr> <tr><td>2021</td><td>2021-660029418</td><td>JORDAN, DEBORAH JEANINE &amp;</td><td>4</td><td>169,834</td><td>0</td><td>18,681</td><td>1,748.00</td></tr> <tr><td>2020</td><td>2020-660029418</td><td>JORDAN, DEBORAH JEANINE &amp;</td><td>4</td><td>167,242</td><td>0</td><td>18,396</td><td>1,726.00</td></tr> <tr><td>2019</td><td>2019-660029418</td><td>JORDAN, DEBORAH JEANINE &amp;</td><td>4</td><td>159,451</td><td>0</td><td>17,539</td><td>1,671.00</td></tr> <tr><td>2018</td><td>2018-660029418</td><td>METZ, JEFF</td><td>4</td><td>165,422</td><td>0</td><td>18,196</td><td>1,734.00</td></tr> <tr><td>2017</td><td>2017-660029418</td><td>METZ, JEFF</td><td>4</td><td>164,117</td><td>0</td><td>18,053</td><td>1,725.00</td></tr> <tr><td>2016</td><td>2016-660029418</td><td>METZ, JEFF</td><td>4</td><td>167,728</td><td>0</td><td>18,450</td><td>1,768.00</td></tr> <tr><td>2015</td><td>2015-660029418</td><td>METZ, JEFF</td><td>4</td><td>164,494</td><td>0</td><td>18,094</td><td>1,747.00</td></tr> <tr><td>2014</td><td>2014-660029418</td><td>METZ, JEFF</td><td>4</td><td>165,707</td><td>0</td><td>17,410</td><td>1,591.00</td></tr> <tr><td>2013</td><td>2013-660029418</td><td>METZ, JEFF</td><td>4</td><td>157,781</td><td>0</td><td>16,581</td><td>1,570.00</td></tr> </tbody> </table>										Tax Year	Statement Number	Billed Owner	Tax Area	Total Value	Exemptions	Taxable Value	Billed Tax	2025	2025-660029418	JORDAN, DEBORAH JEANINE &	4	228,688	1000	20,752	2,178.00	2024	2024-660029418	JORDAN, DEBORAH JEANINE &	4	238,544	1000	20,119	1,939.00	2023	2023-660029418	JORDAN, DEBORAH JEANINE &	4	182,803	1000	17,777	1,688.00	2022	2022-660029418	JORDAN, DEBORAH JEANINE &	4	165,727	1000	17,230	1,667.00	2021	2021-660029418	JORDAN, DEBORAH JEANINE &	4	169,834	0	18,681	1,748.00	2020	2020-660029418	JORDAN, DEBORAH JEANINE &	4	167,242	0	18,396	1,726.00	2019	2019-660029418	JORDAN, DEBORAH JEANINE &	4	159,451	0	17,539	1,671.00	2018	2018-660029418	METZ, JEFF	4	165,422	0	18,196	1,734.00	2017	2017-660029418	METZ, JEFF	4	164,117	0	18,053	1,725.00	2016	2016-660029418	METZ, JEFF	4	167,728	0	18,450	1,768.00	2015	2015-660029418	METZ, JEFF	4	164,494	0	18,094	1,747.00	2014	2014-660029418	METZ, JEFF	4	165,707	0	17,410	1,591.00	2013	2013-660029418	METZ, JEFF	4	157,781	0	16,581	1,570.00
Tax Year	Statement Number	Billed Owner	Tax Area	Total Value	Exemptions	Taxable Value	Billed Tax																																																																																																																		
2025	2025-660029418	JORDAN, DEBORAH JEANINE &	4	228,688	1000	20,752	2,178.00																																																																																																																		
2024	2024-660029418	JORDAN, DEBORAH JEANINE &	4	238,544	1000	20,119	1,939.00																																																																																																																		
2023	2023-660029418	JORDAN, DEBORAH JEANINE &	4	182,803	1000	17,777	1,688.00																																																																																																																		
2022	2022-660029418	JORDAN, DEBORAH JEANINE &	4	165,727	1000	17,230	1,667.00																																																																																																																		
2021	2021-660029418	JORDAN, DEBORAH JEANINE &	4	169,834	0	18,681	1,748.00																																																																																																																		
2020	2020-660029418	JORDAN, DEBORAH JEANINE &	4	167,242	0	18,396	1,726.00																																																																																																																		
2019	2019-660029418	JORDAN, DEBORAH JEANINE &	4	159,451	0	17,539	1,671.00																																																																																																																		
2018	2018-660029418	METZ, JEFF	4	165,422	0	18,196	1,734.00																																																																																																																		
2017	2017-660029418	METZ, JEFF	4	164,117	0	18,053	1,725.00																																																																																																																		
2016	2016-660029418	METZ, JEFF	4	167,728	0	18,450	1,768.00																																																																																																																		
2015	2015-660029418	METZ, JEFF	4	164,494	0	18,094	1,747.00																																																																																																																		
2014	2014-660029418	METZ, JEFF	4	165,707	0	17,410	1,591.00																																																																																																																		
2013	2013-660029418	METZ, JEFF	4	157,781	0	16,581	1,570.00																																																																																																																		



# Rogers

## Assessment Property Record Card for Tax Year 2026

Data provided by LISA DELOZIER County Assessor

Date 04/16/2026  
Time 22:28:50  
Page 2

Lot Data	Square-Foot - NBHD 1122 #1	Primary Image
Lot Size		
Lot Count	1	
Units Buildable	1	
Non-Ag Acres	1.0608	
Topography		
Street Access		
Utilities		
Amenities	LAND QUALITY	
	0	
	0	
Method	Square-Foot	
Base Lot Value	46,209.00 x 1.65 = 76,304	
Factor Value		
Adjustments	1.0000	
Lot Value	76,304	

Residential Data	
Type	1 Single Family Residence
Condition	3 - Average
Quality	2.5 - Fair
Architecture	
Style	100% One Story
Exterior Wall	100% Veneer, Masonry
Base/Total Area	2,247 / 2,247
Style	100% One Story
HVAC	100% Warmed & Cooled Air
Roof Cover	1 Composition Shingle
Area on Slab	2,247
Fixture/RghIn	11 /
Bed/F/H Bath	3 / 2.0 /
Basement Area	
Garage Type	
Remodel	
Year/Eff Age	1980 / 35

Cost Approach		Manual : 01/2025	
Base Cost	98.19	Total Misc Impr	+ 14,384
Roofing Adj	+ 4.16	Garage Cost	+
Subfloor Adj	+ -1.09	Total RCN	= 281,777
Heat/Cool Adj	+ 11.47	Depreciation ( 44%)	- 123,982
Plumbing Adj	+ 6.27	Lump Sums	+ 0
Basement Adj	+ 0.00	RCNLD	= 157,795
Adj Base Cost	= 119.00	Lot Value	+ 76,304
Total Area	x 2,247	Indicated Value	= 234,099
Adjusted Cost	= 267,393	Value Per SqFt	104.18

GRM Approach	
GRM Code	
Gross Rent	0.00
Indicated Value	

Multiple Regression	
MRA Code	1 Test
Adusted R	0.8445
Indicated Value	164,575 73.24 Per SqFt

Direct Comparables	
Selection Model	A Adam Test
Adjustment Model	1 2022 Residential
Comparables	4
Indicated Value	240,440 Per SqFt

Value Reconciliation	
Selected Approach	Cost Approach
Improvements	157,795
Lot Value	76,304
Indicated Value	234,099 104.18 Per SqFt
Agland Value	
Site Improvements	
Total Value	234,099 104.18 Total Value Per SqFt

Miscellaneous Improvements								
Code	Description	Sketch ID	Size	Year	Units	Unit Cost	Depr	Value
FPR1	FIREPLACE - RESIDENTIAL 1 STORY	0		1	1	5,095.98		5,096
PRCH	SLAB PORCH - COVERED	70451		202	202	23.56		4,759
PRCH	SLAB PORCH - COVERED	70452	16x12		192	23.59		4,529



# Rogers

## Assessment Property Record Card for Tax Year 2026

Data provided by LISA DELOZIER County Assessor

Date 04/16/2026  
 Time 22:28:50  
 Page 3

Sketch Image

660029418

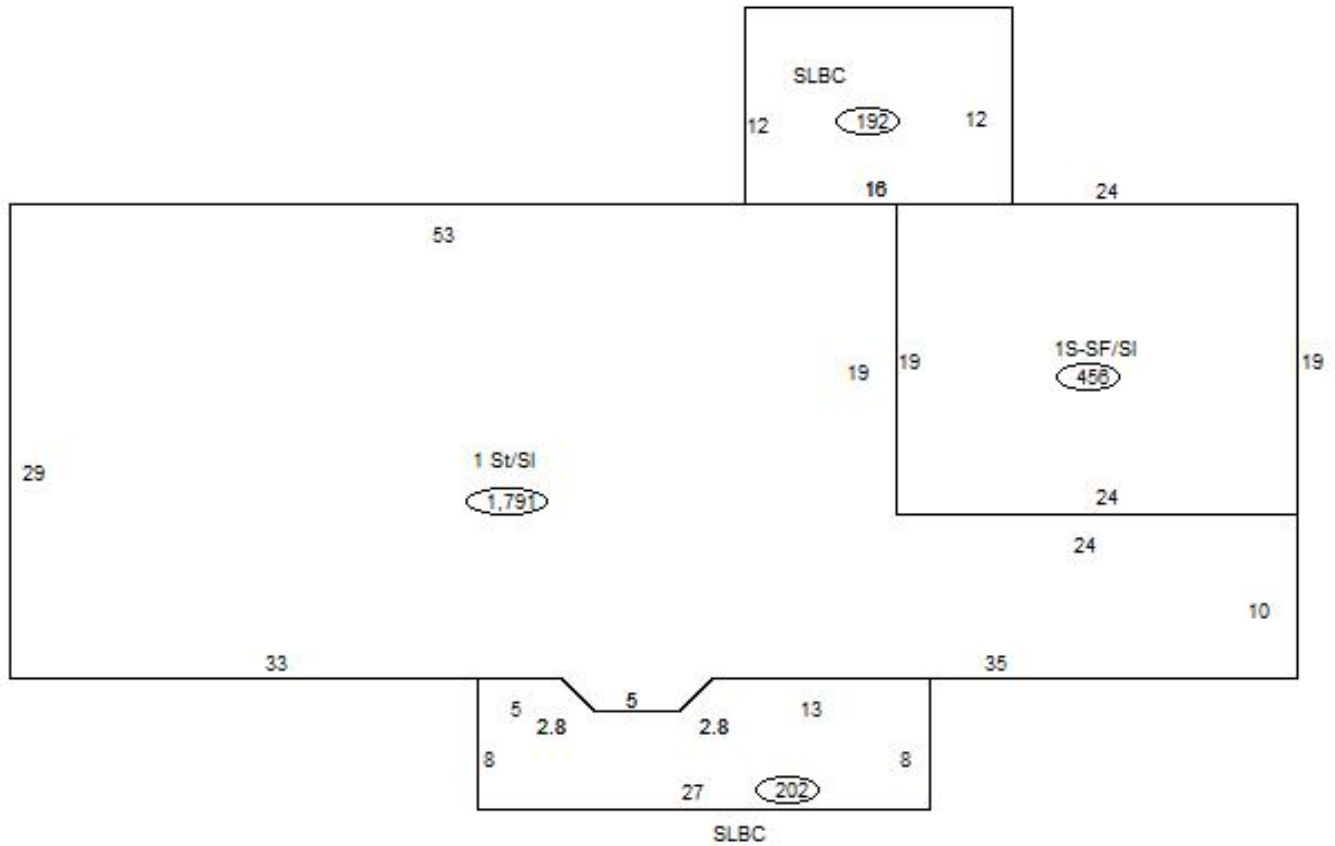

### Sketch Vector Information

Sequence	Code	Type	Built Over	Scale	Section Label	Base Area	Multiplier	Total Area
1	R	1	Slab	13	1 St/SI	1,791	1.000	1,791
2	M	PRCH		13	SLBC	202	1.000	202
3	M	PRCH		13	SLBC	192	1.000	192
4	R	1	Slab	13	1S-SF/SI	456	1.000	456
<b>Total Building Area</b>						<b>2,247</b>		<b>2,247</b>