



# Rogers

## Assessment Property Record Card for Tax Year 2026

Data provided by LISA DELOZIER County Assessor

Date 04/16/2026  
Time 22:29:05  
Page 1

Assessment Data					Primary Image																																																																																																																				
<b>Account</b> 660029435 <b>Parcel ID</b> 000000-00-0-00027-002-0008 <b>Cadastral ID</b> 34-21-15-04270 <b>Property Type</b> REAL - Real Property <b>Property Class</b> RRP VI Area 4 <b>Tax Area</b> 4 - VERDIGRIS/VERD FIRE <b>Name ID</b> 291155 BURK, ROGER DEAN REVOCABLE TRUST  24392 S RAUQUEL RD CLAREMORE OK 74019-0000  <b>Parcel Location</b> <b>Situs</b> 24392 RAUQUEL RD <b>Subdivision</b> BATTENFIELD ACRES 4 <b>Lot/Block</b> 0008 / 0002 <b>Parcel Size</b> 1 - Lots <b>Sec/Twn/Rng</b> 34 / 21 / 15 / 5 <b>Neighborhood</b> 1122 - R-V04-SE VERDIGRIS <b>School District</b> S008 - VERDIGRIS SCHOOLS					<p>\\tsclient\C\Users\Randy Necessary\Pictures\101_0711\IMG_0018. 7/11/2022</p>																																																																																																																				
<b>Legal Description</b> Lot/Long: 36.25803380 -95.70194766																																																																																																																									
<b>Building Permits</b>					<table border="1"> <thead> <tr> <th>Number</th> <th>Description</th> <th>Opened</th> <th>Closed</th> <th>Amount</th> </tr> </thead> <tbody> <tr> <td colspan="5" style="height: 100px;"> </td> </tr> </tbody> </table>					Number	Description	Opened	Closed	Amount																																																																																																											
Number	Description	Opened	Closed	Amount																																																																																																																					
<b>Exemptions</b>					<b>Sale History</b>																																																																																																																				
<table border="1"> <thead> <tr> <th>Code</th> <th>Type</th> <th>Active</th> <th>Maximum</th> <th>Exemption</th> </tr> </thead> <tbody> <tr> <td>H</td> <td>Homestead</td> <td>Yes</td> <td>1,000</td> <td>1,000</td> </tr> </tbody> </table>					Code	Type	Active	Maximum	Exemption	H	Homestead	Yes	1,000	1,000	<table border="1"> <thead> <tr> <th>Bk/Pg</th> <th>Grantor</th> <th>Date</th> <th>Price</th> <th>Code</th> </tr> </thead> <tbody> <tr> <td>1751/600</td> <td>CREEKMORE, KELLEY H &amp;</td> <td>02/14/2006</td> <td>155,000</td> <td>YES</td> </tr> <tr> <td>876/93</td> <td>BERNETT, PATRICIA A &amp;</td> <td>03/11/1992</td> <td>84,000</td> <td>Yes</td> </tr> </tbody> </table>					Bk/Pg	Grantor	Date	Price	Code	1751/600	CREEKMORE, KELLEY H &	02/14/2006	155,000	YES	876/93	BERNETT, PATRICIA A &	03/11/1992	84,000	Yes																																																																																							
Code	Type	Active	Maximum	Exemption																																																																																																																					
H	Homestead	Yes	1,000	1,000																																																																																																																					
Bk/Pg	Grantor	Date	Price	Code																																																																																																																					
1751/600	CREEKMORE, KELLEY H &	02/14/2006	155,000	YES																																																																																																																					
876/93	BERNETT, PATRICIA A &	03/11/1992	84,000	Yes																																																																																																																					
<b>Parcel Valuation</b>																																																																																																																									
<table border="1"> <thead> <tr> <th>Source</th> <th>REAL</th> </tr> </thead> <tbody> <tr> <td>Remove Cap</td> <td>2007</td> </tr> <tr> <td>Year Frozen</td> <td>0</td> </tr> <tr> <td>Uncapped Value</td> <td>0</td> </tr> <tr> <td>TIF Project ID</td> <td>0</td> </tr> </tbody> </table>		Source	REAL	Remove Cap	2007	Year Frozen	0	Uncapped Value	0	TIF Project ID	0	<table border="1"> <thead> <tr> <th>Fair Cash</th> <th>Capped</th> <th>Asmnt Level</th> <th>Assessed</th> </tr> </thead> <tbody> <tr> <td>Land Value</td> <td>73,438</td> <td>37,108</td> <td>11%</td> </tr> <tr> <td>Improvements</td> <td>139,081</td> <td>130,961</td> <td>14,406</td> </tr> <tr> <td>Mobile Home</td> <td>0</td> <td>0</td> <td>0</td> </tr> <tr> <td>Total Value</td> <td>212,519</td> <td>168,069</td> <td>18,488</td> </tr> </tbody> </table>			Fair Cash	Capped	Asmnt Level	Assessed	Land Value	73,438	37,108	11%	Improvements	139,081	130,961	14,406	Mobile Home	0	0	0	Total Value	212,519	168,069	18,488	<table border="1"> <thead> <tr> <th>Levy Rate</th> <th>Current Tax</th> </tr> </thead> <tbody> <tr> <td>104.132</td> <td>1,925.19</td> </tr> <tr> <td>Assessed</td> <td>18,488</td> </tr> <tr> <td>Penalty</td> <td>0</td> </tr> <tr> <td>Exemption</td> <td>1,000</td> </tr> <tr> <td>Total Taxable</td> <td>17,488</td> </tr> </tbody> </table>		Levy Rate	Current Tax	104.132	1,925.19	Assessed	18,488	Penalty	0	Exemption	1,000	Total Taxable	17,488																																																																									
Source	REAL																																																																																																																								
Remove Cap	2007																																																																																																																								
Year Frozen	0																																																																																																																								
Uncapped Value	0																																																																																																																								
TIF Project ID	0																																																																																																																								
Fair Cash	Capped	Asmnt Level	Assessed																																																																																																																						
Land Value	73,438	37,108	11%																																																																																																																						
Improvements	139,081	130,961	14,406																																																																																																																						
Mobile Home	0	0	0																																																																																																																						
Total Value	212,519	168,069	18,488																																																																																																																						
Levy Rate	Current Tax																																																																																																																								
104.132	1,925.19																																																																																																																								
Assessed	18,488																																																																																																																								
Penalty	0																																																																																																																								
Exemption	1,000																																																																																																																								
Total Taxable	17,488																																																																																																																								
<b>Assessment History</b>																																																																																																																									
<table border="1"> <thead> <tr> <th>Tax Year</th> <th>Statement Number</th> <th>Billed Owner</th> <th>Tax Area</th> <th>Total Value</th> <th>Exemptions</th> <th>Taxable Value</th> <th>Billed Tax</th> </tr> </thead> <tbody> <tr><td>2025</td><td>2025-660029435</td><td>BURK, ROGER DEAN</td><td>4</td><td>209,107</td><td>1000</td><td>16,950</td><td>1,782.00</td></tr> <tr><td>2024</td><td>2024-660029435</td><td>BURK, ROGER DEAN</td><td>4</td><td>218,147</td><td>1000</td><td>16,427</td><td>1,585.00</td></tr> <tr><td>2023</td><td>2023-660029435</td><td>BURK, ROGER D &amp;</td><td>4</td><td>168,332</td><td>1000</td><td>15,919</td><td>1,513.00</td></tr> <tr><td>2022</td><td>2022-660029435</td><td>BURK, ROGER D &amp;</td><td>4</td><td>149,329</td><td>1000</td><td>15,426</td><td>1,493.00</td></tr> <tr><td>2021</td><td>2021-660029435</td><td>BURK, ROGER D &amp;</td><td>4</td><td>153,355</td><td>1000</td><td>15,869</td><td>1,496.00</td></tr> <tr><td>2020</td><td>2020-660029435</td><td>BURK, ROGER D &amp;</td><td>4</td><td>154,085</td><td>1000</td><td>15,631</td><td>1,476.00</td></tr> <tr><td>2019</td><td>2019-660029435</td><td>BURK, ROGER D &amp;</td><td>4</td><td>146,789</td><td>1000</td><td>15,147</td><td>1,453.00</td></tr> <tr><td>2018</td><td>2018-660029435</td><td>BURK, ROGER D &amp;</td><td>4</td><td>151,378</td><td>1000</td><td>15,652</td><td>1,502.00</td></tr> <tr><td>2017</td><td>2017-660029435</td><td>BURK, ROGER D &amp;</td><td>4</td><td>149,867</td><td>1000</td><td>15,485</td><td>1,490.00</td></tr> <tr><td>2016</td><td>2016-660029435</td><td>BURK, ROGER D &amp;</td><td>4</td><td>146,552</td><td>1000</td><td>15,121</td><td>1,459.00</td></tr> <tr><td>2015</td><td>2015-660029435</td><td>BURK, ROGER D &amp;</td><td>4</td><td>145,114</td><td>1000</td><td>14,734</td><td>1,433.00</td></tr> <tr><td>2014</td><td>2014-660029435</td><td>BURK, ROGER D &amp;</td><td>4</td><td>148,841</td><td>1000</td><td>14,276</td><td>1,314.00</td></tr> <tr><td>2013</td><td>2013-660029435</td><td>BURK, ROGER D &amp;</td><td>4</td><td>142,915</td><td>1000</td><td>13,831</td><td>1,320.00</td></tr> </tbody> </table>										Tax Year	Statement Number	Billed Owner	Tax Area	Total Value	Exemptions	Taxable Value	Billed Tax	2025	2025-660029435	BURK, ROGER DEAN	4	209,107	1000	16,950	1,782.00	2024	2024-660029435	BURK, ROGER DEAN	4	218,147	1000	16,427	1,585.00	2023	2023-660029435	BURK, ROGER D &	4	168,332	1000	15,919	1,513.00	2022	2022-660029435	BURK, ROGER D &	4	149,329	1000	15,426	1,493.00	2021	2021-660029435	BURK, ROGER D &	4	153,355	1000	15,869	1,496.00	2020	2020-660029435	BURK, ROGER D &	4	154,085	1000	15,631	1,476.00	2019	2019-660029435	BURK, ROGER D &	4	146,789	1000	15,147	1,453.00	2018	2018-660029435	BURK, ROGER D &	4	151,378	1000	15,652	1,502.00	2017	2017-660029435	BURK, ROGER D &	4	149,867	1000	15,485	1,490.00	2016	2016-660029435	BURK, ROGER D &	4	146,552	1000	15,121	1,459.00	2015	2015-660029435	BURK, ROGER D &	4	145,114	1000	14,734	1,433.00	2014	2014-660029435	BURK, ROGER D &	4	148,841	1000	14,276	1,314.00	2013	2013-660029435	BURK, ROGER D &	4	142,915	1000	13,831	1,320.00
Tax Year	Statement Number	Billed Owner	Tax Area	Total Value	Exemptions	Taxable Value	Billed Tax																																																																																																																		
2025	2025-660029435	BURK, ROGER DEAN	4	209,107	1000	16,950	1,782.00																																																																																																																		
2024	2024-660029435	BURK, ROGER DEAN	4	218,147	1000	16,427	1,585.00																																																																																																																		
2023	2023-660029435	BURK, ROGER D &	4	168,332	1000	15,919	1,513.00																																																																																																																		
2022	2022-660029435	BURK, ROGER D &	4	149,329	1000	15,426	1,493.00																																																																																																																		
2021	2021-660029435	BURK, ROGER D &	4	153,355	1000	15,869	1,496.00																																																																																																																		
2020	2020-660029435	BURK, ROGER D &	4	154,085	1000	15,631	1,476.00																																																																																																																		
2019	2019-660029435	BURK, ROGER D &	4	146,789	1000	15,147	1,453.00																																																																																																																		
2018	2018-660029435	BURK, ROGER D &	4	151,378	1000	15,652	1,502.00																																																																																																																		
2017	2017-660029435	BURK, ROGER D &	4	149,867	1000	15,485	1,490.00																																																																																																																		
2016	2016-660029435	BURK, ROGER D &	4	146,552	1000	15,121	1,459.00																																																																																																																		
2015	2015-660029435	BURK, ROGER D &	4	145,114	1000	14,734	1,433.00																																																																																																																		
2014	2014-660029435	BURK, ROGER D &	4	148,841	1000	14,276	1,314.00																																																																																																																		
2013	2013-660029435	BURK, ROGER D &	4	142,915	1000	13,831	1,320.00																																																																																																																		



# Rogers

## Assessment Property Record Card for Tax Year 2026

Data provided by LISA DELOZIER County Assessor

Date 04/16/2026  
Time 22:29:05  
Page 2

Lot Data		Square-Foot - NBHD 1122 #1	
Lot Size			
Lot Count	1		
Units Buildable	1		
Non-Ag Acres	0.9917		
Topography			
Street Access			
Utilities			
Amenities	LAND QUALITY	0	0
Method	Square-Foot		
Base Lot Value	43,199.00 x 1.70 = 73,438		
Factor Value			
Adjustments	1.0000		
Lot Value	73,438		



\\tsclient\C\Users\Randy Necessary\Pictures\101\_0711\IMG\_0018. 7/11/2022

Residential Data	
Type	1 Single Family Residence
Condition	3 - Average
Quality	2.5 - Fair
Architecture	
Style	100% One Story
Exterior Wall	100% Veneer, Stone
Base/Total Area	1,608 / 1,608
Style	100% One Story
HVAC	100% Warmed & Cooled Air
Roof Cover	1 Composition Shingle
Area on Slab	1,608
Fixture/RghIn	11 /
Bed/F/H Bath	3 / 2.0 /
Basement Area	
Garage Type	480 Attached Garage - Unfinished
Remodel	
Year/Eff Age	1978 / 36

### GRM Approach

GRM Code	
Gross Rent	0.00
Indicated Value	

### Multiple Regression

MRA Code	1 Test
Adusted R	0.8445
Indicated Value	174,161 108.31 Per SqFt

### Direct Comparables

Selection Model	A Adam Test
Adjustment Model	1 2022 Residential
Comparables	4
Indicated Value	246,560 Per SqFt

### Value Reconciliation

Selected Approach	Cost Approach
Improvements	131,313
Lot Value	73,438
Indicated Value	204,751 127.33 Per SqFt
Agland Value	
Site Improvements	7,768
Total Value	212,519 132.16 Total Value Per SqFt

Cost Approach		Manual : 01/2025	
Base Cost	111.20	Total Misc Impr	+ 7,409
Roofing Adj	+ 4.46	Garage Cost	+ 13,282
Subfloor Adj	+ -1.15	Total RCN	= 237,353
Heat/Cool Adj	+ 11.47	Depreciation ( 45%)	- 106,809
Plumbing Adj	+ 8.76	Lump Sums	+ 769
Basement Adj	+ 0.00	RCNLD	= 131,313
Adj Base Cost	= 134.74	Lot Value	+ 73,438
Total Area	x 1,608	Indicated Value	= 204,751
Adjusted Cost	= 216,662	Value Per SqFt	127.33

### Miscellaneous Improvements

Code	Description	Sketch ID	Size	Year	Units	Unit Cost	Depr	Value
FPR1	FIREPLACE - RESIDENTIAL 1 STORY	0		1	1	5,095.98		5,096
PRCH	SLAB PORCH - COVERED	70518	8x4		32	24.17		773
WODO	WOOD DECK - OPEN	70519	10x10		100	25.63	70%	769
PRCH	SLAB PORCH - COVERED	70520	8x8		64	24.07		1,540



# Rogers

## Assessment Property Record Card for Tax Year 2026

Data provided by LISA DELOZIER County Assessor

Date 04/16/2026  
 Time 22:29:05  
 Page 3

Sketch Image

660029435

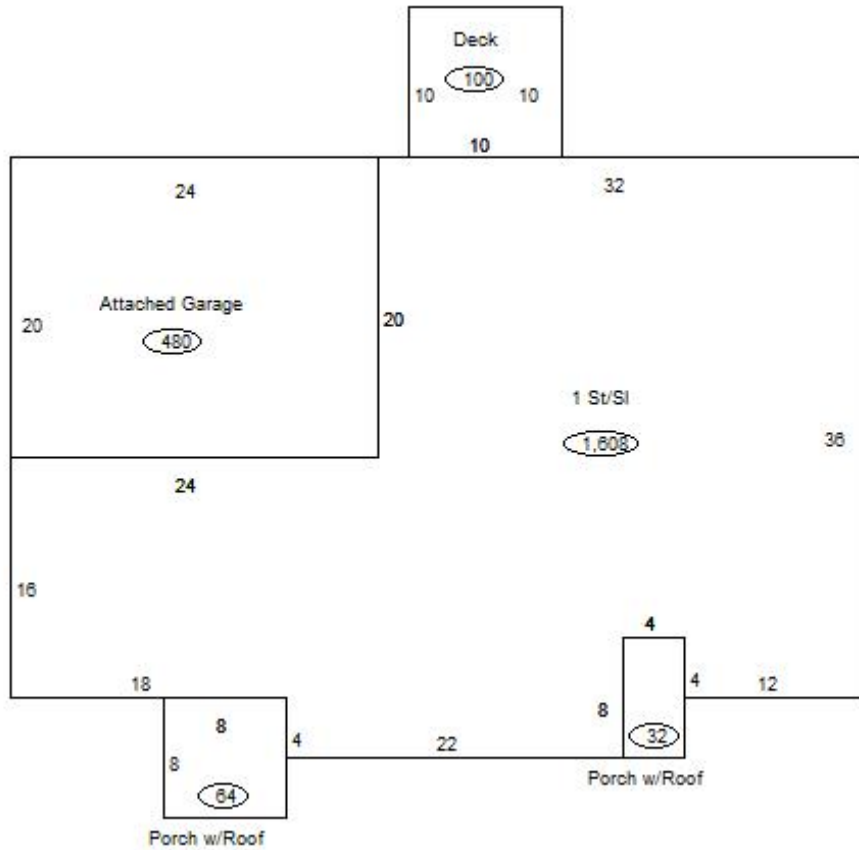

### Sketch Vector Information

Sequence	Code	Type	Built Over	Scale	Section Label	Base Area	Multiplier	Total Area
1	R	1	Slab	13	1 St/SI	1,608	1.000	1,608
2	G	1		13	Attached Garage	480	1.000	480
3	M	PRCH		13	SLBC	32	1.000	32
4	M	WODO		13	WODO	100	1.000	100
5	M	PRCH		13	SLBC	64	1.000	64
<b>Total Building Area</b>						1,608		1,608



# Rogers



## Assessment Property Record Card for Tax Year 2026

Data provided by LISA DELOZIER County Assessor

Date 04/16/2026  
Time 22:29:05  
Page 4

660029435

### Outbuildings/Site Improvements

Building Image	Code	Description	Dimensions	Floor	Roofing	Total Units
	DTGF	DETACHED GARAGE FAIR	0x0x0			952
	Qual 2	Cond 3	Year 2000	Eff Age 20		
	<b>Valuation Summary</b>		<b>Modifier Total</b>	<b>RCN</b>	<b>Depr (49% Phys/ % Func)</b>	<b>RCNLD</b>
	Base Cost (16.00 x 952)		15,232	15,232	7,464	7,768
	STF	STG FAIR	0x0x0			
	Qual 2	Cond 3	Year	Eff Age 1520		
	<b>Valuation Summary</b>		<b>Modifier Total</b>	<b>RCN</b>	<b>Depr (100% Phys/ % Func)</b>	<b>RCNLD</b>
	Base Cost (4.68 x )					