



Rogers

Assessment Property Record Card for Tax Year 2026

Data provided by LISA DELOZIER County Assessor

Date 04/17/2026
 Time 08:07:56
 Page 1

Assessment Data					Primary Image																																																																																																																				
Account 660029454 Parcel ID 000000-00-0-00027-004-0004 Cadastral ID 34-21-15-04460 Property Type REAL - Real Property Property Class RRP VI Area 4 Tax Area 4 - VERDIGRIS/VERD FIRE Name ID 291192 JOHNSON, BRIAN M & KYLEE 7323 BOLEN RD CLAREMORE OK 74017-0000 Parcel Location Situs 07323 E BOLEN RD Subdivision BATTENFIELD ACRES 4 Lot/Block 0004 / 0004 Parcel Size 1 - Lots Sec/Twn/Rng 34 / 21 / 15 / 5 Neighborhood 1122 - R-V04-SE VERDIGRIS School District S008 - VERDIGRIS SCHOOLS																																																																																																																									
Legal Description Lot/Long: 36.25761643 -95.69882665 LOT 4 BLOCK 4 BATTENFIELD ACRES 4																																																																																																																									
					Building Permits <table border="1"> <thead> <tr> <th>Number</th> <th>Description</th> <th>Opened</th> <th>Closed</th> <th>Amount</th> </tr> </thead> <tbody> <tr> <td>R16</td> <td>R16-NEW SHOP PER DRIVE BY</td> <td>11/2015</td> <td>12/2015</td> <td></td> </tr> </tbody> </table>					Number	Description	Opened	Closed	Amount	R16	R16-NEW SHOP PER DRIVE BY	11/2015	12/2015																																																																																																							
Number	Description	Opened	Closed	Amount																																																																																																																					
R16	R16-NEW SHOP PER DRIVE BY	11/2015	12/2015																																																																																																																						
Exemptions <table border="1"> <thead> <tr> <th>Code</th> <th>Type</th> <th>Active</th> <th>Maximum</th> <th>Exemption</th> </tr> </thead> <tbody> <tr> <td>H</td> <td>Homestead</td> <td>Yes</td> <td>1,000</td> <td>1,000</td> </tr> </tbody> </table>					Code	Type	Active	Maximum	Exemption	H	Homestead	Yes	1,000	1,000	Sale History <table border="1"> <thead> <tr> <th>Bk/Pg</th> <th>Grantor</th> <th>Date</th> <th>Price</th> <th>Code</th> </tr> </thead> <tbody> <tr> <td>1753/3</td> <td>COUNTRY INVESTMENTS INC</td> <td>02/16/2006</td> <td>138,500</td> <td>YES</td> </tr> <tr> <td>1753/2</td> <td>RAMEY, LENSE E III &</td> <td>02/13/2006</td> <td>0</td> <td>4</td> </tr> <tr> <td>1697/662</td> <td>FUGATE, BETTE K</td> <td>07/21/2005</td> <td>100,000</td> <td>YES</td> </tr> <tr> <td>935/531</td> <td>FARRAR, KEVIN D</td> <td>11/08/1993</td> <td>79,900</td> <td>Yes</td> </tr> <tr> <td>864/153</td> <td>MCFARLAND, JAMES E &</td> <td>10/01/1991</td> <td>80,000</td> <td>No</td> </tr> </tbody> </table>					Bk/Pg	Grantor	Date	Price	Code	1753/3	COUNTRY INVESTMENTS INC	02/16/2006	138,500	YES	1753/2	RAMEY, LENSE E III &	02/13/2006	0	4	1697/662	FUGATE, BETTE K	07/21/2005	100,000	YES	935/531	FARRAR, KEVIN D	11/08/1993	79,900	Yes	864/153	MCFARLAND, JAMES E &	10/01/1991	80,000	No																																																																								
Code	Type	Active	Maximum	Exemption																																																																																																																					
H	Homestead	Yes	1,000	1,000																																																																																																																					
Bk/Pg	Grantor	Date	Price	Code																																																																																																																					
1753/3	COUNTRY INVESTMENTS INC	02/16/2006	138,500	YES																																																																																																																					
1753/2	RAMEY, LENSE E III &	02/13/2006	0	4																																																																																																																					
1697/662	FUGATE, BETTE K	07/21/2005	100,000	YES																																																																																																																					
935/531	FARRAR, KEVIN D	11/08/1993	79,900	Yes																																																																																																																					
864/153	MCFARLAND, JAMES E &	10/01/1991	80,000	No																																																																																																																					
Parcel Valuation <table border="1"> <thead> <tr> <th>Source</th> <th>REAL</th> <th>Fair Cash</th> <th>Capped</th> <th>Asmnt Level</th> <th>Assessed</th> <th>Levy Rate</th> <th>104.132</th> <th>Current Tax</th> </tr> </thead> <tbody> <tr> <td>Remove Cap</td> <td>2007</td> <td>Land Value 81,845</td> <td>37,732</td> <td>11%</td> <td>4,151</td> <td>Assessed</td> <td>27,621</td> <td>2,876.23</td> </tr> <tr> <td>Year Frozen</td> <td>0</td> <td>Improvements 244,927</td> <td>213,362</td> <td></td> <td>23,470</td> <td>Penalty</td> <td>0</td> <td></td> </tr> <tr> <td>Uncapped Value</td> <td>0</td> <td>Mobile Home 0</td> <td>0</td> <td></td> <td>0</td> <td>Exemption</td> <td>1,000</td> <td>-87.00</td> </tr> <tr> <td>TIF Project ID</td> <td>0</td> <td>Total Value 326,772</td> <td>251,094</td> <td></td> <td>27,621</td> <td>Total Taxable</td> <td>26,621</td> <td>2,789.00</td> </tr> </tbody> </table>										Source	REAL	Fair Cash	Capped	Asmnt Level	Assessed	Levy Rate	104.132	Current Tax	Remove Cap	2007	Land Value 81,845	37,732	11%	4,151	Assessed	27,621	2,876.23	Year Frozen	0	Improvements 244,927	213,362		23,470	Penalty	0		Uncapped Value	0	Mobile Home 0	0		0	Exemption	1,000	-87.00	TIF Project ID	0	Total Value 326,772	251,094		27,621	Total Taxable	26,621	2,789.00																																																																			
Source	REAL	Fair Cash	Capped	Asmnt Level	Assessed	Levy Rate	104.132	Current Tax																																																																																																																	
Remove Cap	2007	Land Value 81,845	37,732	11%	4,151	Assessed	27,621	2,876.23																																																																																																																	
Year Frozen	0	Improvements 244,927	213,362		23,470	Penalty	0																																																																																																																		
Uncapped Value	0	Mobile Home 0	0		0	Exemption	1,000	-87.00																																																																																																																	
TIF Project ID	0	Total Value 326,772	251,094		27,621	Total Taxable	26,621	2,789.00																																																																																																																	
Assessment History <table border="1"> <thead> <tr> <th>Tax Year</th> <th>Statement Number</th> <th>Billed Owner</th> <th>Tax Area</th> <th>Total Value</th> <th>Exemptions</th> <th>Taxable Value</th> <th>Billed Tax</th> </tr> </thead> <tbody> <tr><td>2025</td><td>2025-660029454</td><td>JOHNSON, BRIAN M &</td><td>4</td><td>311,909</td><td>1000</td><td>25,817</td><td>2,705.00</td></tr> <tr><td>2024</td><td>2024-660029454</td><td>JOHNSON, BRIAN M &</td><td>4</td><td>333,600</td><td>1000</td><td>25,035</td><td>2,410.00</td></tr> <tr><td>2023</td><td>2023-660029454</td><td>JOHNSON, BRIAN M &</td><td>4</td><td>249,706</td><td>1000</td><td>24,276</td><td>2,302.00</td></tr> <tr><td>2022</td><td>2022-660029454</td><td>JOHNSON, BRIAN M &</td><td>4</td><td>223,096</td><td>1000</td><td>23,541</td><td>2,273.00</td></tr> <tr><td>2021</td><td>2021-660029454</td><td>JOHNSON, BRIAN M &</td><td>4</td><td>228,199</td><td>1000</td><td>24,095</td><td>2,266.00</td></tr> <tr><td>2020</td><td>2020-660029454</td><td>JOHNSON, BRIAN M &</td><td>4</td><td>224,406</td><td>1000</td><td>23,364</td><td>2,201.00</td></tr> <tr><td>2019</td><td>2019-660029454</td><td>JOHNSON, BRIAN M &</td><td>4</td><td>215,039</td><td>1000</td><td>22,654</td><td>2,168.00</td></tr> <tr><td>2018</td><td>2018-660029454</td><td>JOHNSON, BRIAN M &</td><td>4</td><td>224,195</td><td>1000</td><td>23,661</td><td>2,265.00</td></tr> <tr><td>2017</td><td>2017-660029454</td><td>JOHNSON, BRIAN M &</td><td>4</td><td>221,350</td><td>1000</td><td>23,349</td><td>2,241.00</td></tr> <tr><td>2016</td><td>2016-660029454</td><td>JOHNSON, BRIAN M &</td><td>4</td><td>216,548</td><td>1000</td><td>22,807</td><td>2,196.00</td></tr> <tr><td>2015</td><td>2015-660029454</td><td>JOHNSON, BRIAN M &</td><td>4</td><td>195,678</td><td>1000</td><td>20,239</td><td>1,965.00</td></tr> <tr><td>2014</td><td>2014-660029454</td><td>JOHNSON, BRIAN M &</td><td>4</td><td>193,270</td><td>1000</td><td>19,620</td><td>1,803.00</td></tr> <tr><td>2013</td><td>2013-660029454</td><td>JOHNSON, BRIAN M &</td><td>4</td><td>185,533</td><td>1000</td><td>19,020</td><td>1,811.00</td></tr> </tbody> </table>										Tax Year	Statement Number	Billed Owner	Tax Area	Total Value	Exemptions	Taxable Value	Billed Tax	2025	2025-660029454	JOHNSON, BRIAN M &	4	311,909	1000	25,817	2,705.00	2024	2024-660029454	JOHNSON, BRIAN M &	4	333,600	1000	25,035	2,410.00	2023	2023-660029454	JOHNSON, BRIAN M &	4	249,706	1000	24,276	2,302.00	2022	2022-660029454	JOHNSON, BRIAN M &	4	223,096	1000	23,541	2,273.00	2021	2021-660029454	JOHNSON, BRIAN M &	4	228,199	1000	24,095	2,266.00	2020	2020-660029454	JOHNSON, BRIAN M &	4	224,406	1000	23,364	2,201.00	2019	2019-660029454	JOHNSON, BRIAN M &	4	215,039	1000	22,654	2,168.00	2018	2018-660029454	JOHNSON, BRIAN M &	4	224,195	1000	23,661	2,265.00	2017	2017-660029454	JOHNSON, BRIAN M &	4	221,350	1000	23,349	2,241.00	2016	2016-660029454	JOHNSON, BRIAN M &	4	216,548	1000	22,807	2,196.00	2015	2015-660029454	JOHNSON, BRIAN M &	4	195,678	1000	20,239	1,965.00	2014	2014-660029454	JOHNSON, BRIAN M &	4	193,270	1000	19,620	1,803.00	2013	2013-660029454	JOHNSON, BRIAN M &	4	185,533	1000	19,020	1,811.00
Tax Year	Statement Number	Billed Owner	Tax Area	Total Value	Exemptions	Taxable Value	Billed Tax																																																																																																																		
2025	2025-660029454	JOHNSON, BRIAN M &	4	311,909	1000	25,817	2,705.00																																																																																																																		
2024	2024-660029454	JOHNSON, BRIAN M &	4	333,600	1000	25,035	2,410.00																																																																																																																		
2023	2023-660029454	JOHNSON, BRIAN M &	4	249,706	1000	24,276	2,302.00																																																																																																																		
2022	2022-660029454	JOHNSON, BRIAN M &	4	223,096	1000	23,541	2,273.00																																																																																																																		
2021	2021-660029454	JOHNSON, BRIAN M &	4	228,199	1000	24,095	2,266.00																																																																																																																		
2020	2020-660029454	JOHNSON, BRIAN M &	4	224,406	1000	23,364	2,201.00																																																																																																																		
2019	2019-660029454	JOHNSON, BRIAN M &	4	215,039	1000	22,654	2,168.00																																																																																																																		
2018	2018-660029454	JOHNSON, BRIAN M &	4	224,195	1000	23,661	2,265.00																																																																																																																		
2017	2017-660029454	JOHNSON, BRIAN M &	4	221,350	1000	23,349	2,241.00																																																																																																																		
2016	2016-660029454	JOHNSON, BRIAN M &	4	216,548	1000	22,807	2,196.00																																																																																																																		
2015	2015-660029454	JOHNSON, BRIAN M &	4	195,678	1000	20,239	1,965.00																																																																																																																		
2014	2014-660029454	JOHNSON, BRIAN M &	4	193,270	1000	19,620	1,803.00																																																																																																																		
2013	2013-660029454	JOHNSON, BRIAN M &	4	185,533	1000	19,020	1,811.00																																																																																																																		



Rogers

Assessment Property Record Card for Tax Year 2026

Data provided by LISA DELOZIER County Assessor

Date 04/17/2026
Time 08:07:56
Page 2

Lot Data	Square-Foot - NBHD 1122 #1	Primary Image
Lot Size Lot Count 1 Units Buildable 1 Non-Ag Acres 1.2105 Topography Street Access Utilities Amenities LAND QUALITY 0 0 Method Square-Foot Base Lot Value 52,728.00 x 1.55 = 81,845 Factor Value Adjustments 1.0000 Lot Value 81,845		

Residential Data	
Type	1 Single Family Residence
Condition	3 - Average
Quality	3 - Average
Architecture	
Style	100% One Story
Exterior Wall	50% Veneer, Masonry 50% Frame, Siding, Wood
Base/Total Area	2,492 / 2,492
Style	100% One Story
HVAC	100% Warmed & Cooled Air
Roof Cover	1 Composition Shingle
Area on Slab	2,492
Fixture/RghIn	11 /
Bed/F/H Bath	4 / 2.0 /
Basement Area	
Garage Type	780 Attached Garage - Unfinished
Remodel	
Year/Eff Age	1979 / 35

\\tsclient\C\Users\Randy Necessary\Pictures\101_0711\IMG_0038. 7/12/2022

GRM Approach	
GRM Code	
Gross Rent	0.00
Indicated Value	

Multiple Regression			
MRA Code	1	Test	
Adusted R	0.8445		
Indicated Value	326,424	130.99	Per SqFt

Direct Comparables			
Selection Model	A	Adam Test	
Adjustment Model	1	2022 Residential	
Comparables	3		
Indicated Value	386,320		Per SqFt

Cost Approach				Manual : 01/2025			
Base Cost	94.55	Total Misc Impr	+ 34,986				
Roofing Adj	+ 4.29	Garage Cost	+ 23,236				
Subfloor Adj	+ -2.06	Total RCN	= 346,397				
Heat/Cool Adj	+ 12.64	Depreciation (43%)	- 148,951				
Plumbing Adj	+ 6.22	Lump Sums	+ 0				
Basement Adj	+ 0.00	RCNLD	= 197,446				
Adj Base Cost	= 115.64	Lot Value	+ 81,845				
Total Area	x 2,492	Indicated Value	= 279,291				
Adjusted Cost	= 288,175	Value Per SqFt	112.08				

Value Reconciliation			
Selected Approach	Cost Approach		
Improvements	197,446		
Lot Value	81,845		
Indicated Value	279,291	112.08	Per SqFt
Agland Value			
Site Improvements	47,481		
Total Value	326,772	131.13	Total Value Per SqFt

Miscellaneous Improvements								
Code	Description	Sketch ID	Size	Year	Units	Unit Cost	Depr	Value
FPR1	FIREPLACE - RESIDENTIAL 1 STORY	0		1	1	5,615.40		5,615
PRCH	SLAB PORCH - COVERED	70596	38x6		228	26.21		5,976
EPSW	ENCLOSED PORCH - SOLID WALL	70597	24x14		336	68.03		22,858
PRCH	SLAB PORCH - COVERED	70600	5x4		20	26.87		537



Rogers

Assessment Property Record Card for Tax Year 2026

Data provided by LISA DELOZIER County Assessor

Date 04/17/2026

Time 08:07:56

Page 3

Sketch Image

660029454

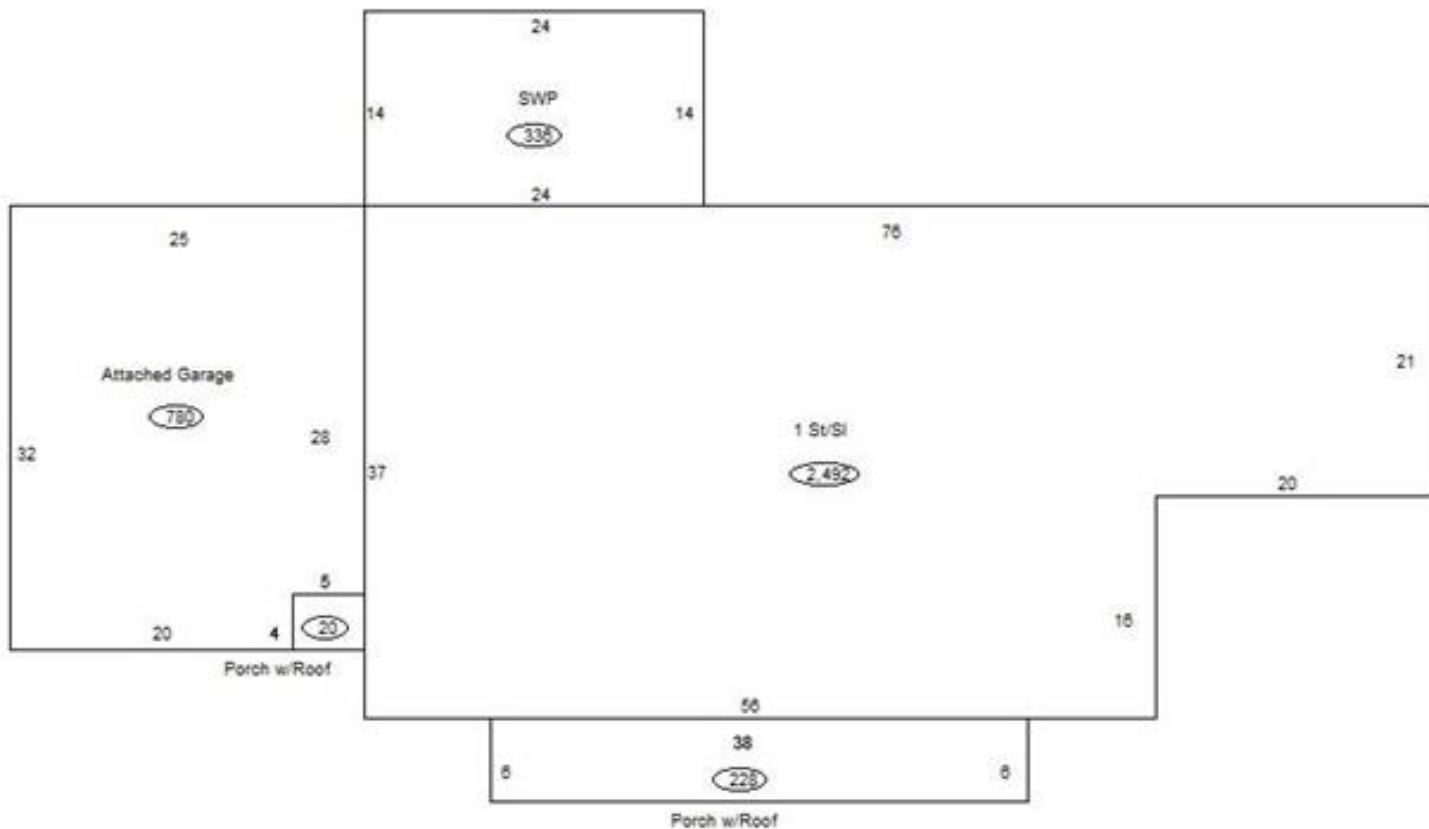

Sketch Vector Information

Sequence	Code	Type	Built Over	Scale	Section Label	Base Area	Multiplier	Total Area
1	M	PRCH		13	SLBC	228	1.000	228
2	M	EPSW		13	EPSW	336	1.000	336
3	R	1	Slab	13	1 St/Sl	2,492	1.000	2,492
4	G	1		13	Attached Garage	780	1.000	780
5	M	PRCH		13	SLBC	20	1.000	20
Total Building Area						2,492		2,492



Rogers



Assessment Property Record Card for Tax Year 2026

Data provided by LISA DELOZIER County Assessor

Date 04/17/2026
Time 08:07:57
Page 4

660029454

Outbuildings/Site Improvements

Building Image	Code	Description	Dimensions	Floor	Roofing	Total Units	
	UTIL	SHOP BUILDING	40x30x0			1,200	
	Qual	3	Cond 3	Year 2015	Eff Age 8		
	Valuation Summary		Modifier Total	RCN	Depr (15% Phys/ % Func)	RCNLD	
	Base Cost (33.14 x 1,200)		39,768		39,768	5,965	33,803
	SG	SWIM-GUNITE	0x0x0			1	
	Qual	3	Cond 3	Year 2009	Eff Age 13		
	Valuation Summary		Modifier Total	RCN	Depr (56% Phys/ % Func)	RCNLD	
	Base Cost (30,000.00 x 1)		30,000		30,000	16,800	13,200
	STF	STG FAIR	0x0x0			120	
	Qual	2	Cond 3	Year	Eff Age		
	Valuation Summary		Modifier Total	RCN	Depr (15% Phys/ % Func)	RCNLD	
	Base Cost (4.68 x 120)		562		562	84	478