



# Rogers

## Assessment Property Record Card for Tax Year 2026

Data provided by LISA DELOZIER County Assessor

Date 04/18/2026  
Time 07:30:18  
Page 1

Assessment Data					Primary Image																																																																																																																				
<b>Account</b> 660029469 <b>Parcel ID</b> 21N16E-34-1-00000-000-0000 <b>Cadastral ID</b> 34-21-16-00200 <b>Property Type</b> REAL - Real Property <b>Property Class</b> RA VI Area 1 <b>Tax Area</b> 5 - JUSTUS RURAL/NO FIRE <b>Name ID</b> 333738 KNIGHT, JOHNATHAN  14378 E 430 RD CLAREMORE OK 74017-0000  <b>Parcel Location</b> <b>Situs</b> 13980 E 520 RD <b>Subdivision</b> <b>Lot/Block</b> / <b>Parcel Size</b> 5 - Acres <b>Sec/Twn/Rng</b> 34 / 21 / 16 / 1 <b>Neighborhood</b> 2116 - UNPLATTED <b>School District</b> S009 - JUSTUS-TIAWAH SCHOOLS																																																																																																																									
<b>Legal Description</b> Lat/Long: 36.26290236 -95.58387912																																																																																																																									
<b>E2 NE NW NE</b>					<b>Building Permits</b> <table border="1"> <thead> <tr> <th>Number</th> <th>Description</th> <th>Opened</th> <th>Closed</th> <th>Amount</th> </tr> </thead> <tbody> <tr> <td> </td> <td> </td> <td> </td> <td> </td> <td> </td> </tr> </tbody> </table>					Number	Description	Opened	Closed	Amount																																																																																																											
Number	Description	Opened	Closed	Amount																																																																																																																					
<b>Exemptions</b> <table border="1"> <thead> <tr> <th>Code</th> <th>Type</th> <th>Active</th> <th>Maximum</th> <th>Exemption</th> </tr> </thead> <tbody> <tr> <td> </td> <td> </td> <td> </td> <td> </td> <td> </td> </tr> </tbody> </table>					Code	Type	Active	Maximum	Exemption						<b>Sale History</b> <table border="1"> <thead> <tr> <th>Bk/Pg</th> <th>Grantor</th> <th>Date</th> <th>Price</th> <th>Code</th> </tr> </thead> <tbody> <tr> <td>/</td> <td>KNIGHT, EMILY L &amp;</td> <td>02/10/2021</td> <td>0</td> <td>4</td> </tr> <tr> <td>/</td> <td>KNIGHT, GLENDA M %</td> <td>09/10/2018</td> <td>0</td> <td>4</td> </tr> </tbody> </table>					Bk/Pg	Grantor	Date	Price	Code	/	KNIGHT, EMILY L &	02/10/2021	0	4	/	KNIGHT, GLENDA M %	09/10/2018	0	4																																																																																							
Code	Type	Active	Maximum	Exemption																																																																																																																					
Bk/Pg	Grantor	Date	Price	Code																																																																																																																					
/	KNIGHT, EMILY L &	02/10/2021	0	4																																																																																																																					
/	KNIGHT, GLENDA M %	09/10/2018	0	4																																																																																																																					
<b>Parcel Valuation</b> <table border="1"> <thead> <tr> <th>Source</th> <th>REAL</th> <th>Fair Cash</th> <th>Capped</th> <th>Asmnt Level</th> <th>Assessed</th> <th>Levy Rate</th> <th>83.050</th> <th>Current Tax</th> </tr> </thead> <tbody> <tr> <td>Remove Cap</td> <td>0</td> <td>Land Value 463</td> <td>463</td> <td>11%</td> <td>51</td> <td>Assessed</td> <td>649</td> <td>53.90</td> </tr> <tr> <td>Year Frozen</td> <td>0</td> <td>Improvements 11,421</td> <td>5,432</td> <td></td> <td>598</td> <td>Penalty</td> <td>0</td> <td></td> </tr> <tr> <td>Uncapped Value</td> <td>0</td> <td>Mobile Home 0</td> <td>0</td> <td></td> <td>0</td> <td>Exemption</td> <td>0</td> <td>0.00</td> </tr> <tr> <td>TIF Project ID</td> <td>0</td> <td>Total Value 11,884</td> <td>5,895</td> <td></td> <td>649</td> <td>Total Taxable</td> <td>649</td> <td>54.00</td> </tr> </tbody> </table>										Source	REAL	Fair Cash	Capped	Asmnt Level	Assessed	Levy Rate	83.050	Current Tax	Remove Cap	0	Land Value 463	463	11%	51	Assessed	649	53.90	Year Frozen	0	Improvements 11,421	5,432		598	Penalty	0		Uncapped Value	0	Mobile Home 0	0		0	Exemption	0	0.00	TIF Project ID	0	Total Value 11,884	5,895		649	Total Taxable	649	54.00																																																																			
Source	REAL	Fair Cash	Capped	Asmnt Level	Assessed	Levy Rate	83.050	Current Tax																																																																																																																	
Remove Cap	0	Land Value 463	463	11%	51	Assessed	649	53.90																																																																																																																	
Year Frozen	0	Improvements 11,421	5,432		598	Penalty	0																																																																																																																		
Uncapped Value	0	Mobile Home 0	0		0	Exemption	0	0.00																																																																																																																	
TIF Project ID	0	Total Value 11,884	5,895		649	Total Taxable	649	54.00																																																																																																																	
<b>Assessment History</b> <table border="1"> <thead> <tr> <th>Tax Year</th> <th>Statement Number</th> <th>Billed Owner</th> <th>Tax Area</th> <th>Total Value</th> <th>Exemptions</th> <th>Taxable Value</th> <th>Billed Tax</th> </tr> </thead> <tbody> <tr><td>2025</td><td>2025-660029469</td><td>KNIGHT, JOHNATHAN</td><td>5</td><td>11,268</td><td>0</td><td>630</td><td>52.00</td></tr> <tr><td>2024</td><td>2024-660029469</td><td>KNIGHT, JOHNATHAN</td><td>5</td><td>12,058</td><td>0</td><td>611</td><td>51.00</td></tr> <tr><td>2023</td><td>2023-660029469</td><td>KNIGHT, JOHNATHAN</td><td>5</td><td>10,018</td><td>0</td><td>594</td><td>49.00</td></tr> <tr><td>2022</td><td>2022-660029469</td><td>KNIGHT, JOHNATHAN</td><td>5</td><td>5,240</td><td>0</td><td>576</td><td>48.00</td></tr> <tr><td>2021</td><td>2021-660029469</td><td>KNIGHT, JOHNATHAN</td><td>5</td><td>8,221</td><td>0</td><td>904</td><td>77.00</td></tr> <tr><td>2020</td><td>2020-660029469</td><td>KNIGHT, EMILY L &amp;</td><td>5</td><td>8,535</td><td>0</td><td>939</td><td>79.00</td></tr> <tr><td>2019</td><td>2019-660029469</td><td>KNIGHT, EMILY L &amp;</td><td>5</td><td>8,992</td><td>0</td><td>989</td><td>86.00</td></tr> <tr><td>2018</td><td>2018-660029469</td><td>KNIGHT, EMILY L &amp;</td><td>5</td><td>9,983</td><td>0</td><td>1,098</td><td>95.00</td></tr> <tr><td>2017</td><td>2017-660029469</td><td>KNIGHT, GLENDA M</td><td>5</td><td>9,898</td><td>0</td><td>1,089</td><td>89.00</td></tr> <tr><td>2016</td><td>2016-660029469</td><td>KNIGHT, GLENDA M</td><td>5</td><td>9,624</td><td>0</td><td>1,059</td><td>90.00</td></tr> <tr><td>2015</td><td>2015-660029469</td><td>KNIGHT, GLENDA M</td><td>5</td><td>21,868</td><td>0</td><td>2,406</td><td>203.00</td></tr> <tr><td>2014</td><td>2014-660029469</td><td>KNIGHT, GLENDA M</td><td>5</td><td>22,064</td><td>0</td><td>2,427</td><td>208.00</td></tr> <tr><td>2013</td><td>2013-660029469</td><td>KNIGHT, GLENDA M</td><td>5</td><td>23,997</td><td>0</td><td>2,635</td><td>230.00</td></tr> </tbody> </table>										Tax Year	Statement Number	Billed Owner	Tax Area	Total Value	Exemptions	Taxable Value	Billed Tax	2025	2025-660029469	KNIGHT, JOHNATHAN	5	11,268	0	630	52.00	2024	2024-660029469	KNIGHT, JOHNATHAN	5	12,058	0	611	51.00	2023	2023-660029469	KNIGHT, JOHNATHAN	5	10,018	0	594	49.00	2022	2022-660029469	KNIGHT, JOHNATHAN	5	5,240	0	576	48.00	2021	2021-660029469	KNIGHT, JOHNATHAN	5	8,221	0	904	77.00	2020	2020-660029469	KNIGHT, EMILY L &	5	8,535	0	939	79.00	2019	2019-660029469	KNIGHT, EMILY L &	5	8,992	0	989	86.00	2018	2018-660029469	KNIGHT, EMILY L &	5	9,983	0	1,098	95.00	2017	2017-660029469	KNIGHT, GLENDA M	5	9,898	0	1,089	89.00	2016	2016-660029469	KNIGHT, GLENDA M	5	9,624	0	1,059	90.00	2015	2015-660029469	KNIGHT, GLENDA M	5	21,868	0	2,406	203.00	2014	2014-660029469	KNIGHT, GLENDA M	5	22,064	0	2,427	208.00	2013	2013-660029469	KNIGHT, GLENDA M	5	23,997	0	2,635	230.00
Tax Year	Statement Number	Billed Owner	Tax Area	Total Value	Exemptions	Taxable Value	Billed Tax																																																																																																																		
2025	2025-660029469	KNIGHT, JOHNATHAN	5	11,268	0	630	52.00																																																																																																																		
2024	2024-660029469	KNIGHT, JOHNATHAN	5	12,058	0	611	51.00																																																																																																																		
2023	2023-660029469	KNIGHT, JOHNATHAN	5	10,018	0	594	49.00																																																																																																																		
2022	2022-660029469	KNIGHT, JOHNATHAN	5	5,240	0	576	48.00																																																																																																																		
2021	2021-660029469	KNIGHT, JOHNATHAN	5	8,221	0	904	77.00																																																																																																																		
2020	2020-660029469	KNIGHT, EMILY L &	5	8,535	0	939	79.00																																																																																																																		
2019	2019-660029469	KNIGHT, EMILY L &	5	8,992	0	989	86.00																																																																																																																		
2018	2018-660029469	KNIGHT, EMILY L &	5	9,983	0	1,098	95.00																																																																																																																		
2017	2017-660029469	KNIGHT, GLENDA M	5	9,898	0	1,089	89.00																																																																																																																		
2016	2016-660029469	KNIGHT, GLENDA M	5	9,624	0	1,059	90.00																																																																																																																		
2015	2015-660029469	KNIGHT, GLENDA M	5	21,868	0	2,406	203.00																																																																																																																		
2014	2014-660029469	KNIGHT, GLENDA M	5	22,064	0	2,427	208.00																																																																																																																		
2013	2013-660029469	KNIGHT, GLENDA M	5	23,997	0	2,635	230.00																																																																																																																		



# Rogers

## Assessment Property Record Card for Tax Year 2026

Data provided by LISA DELOZIER County Assessor

Date 04/18/2026  
 Time 07:30:18  
 Page 2

<b>Lot Data</b>	
Lot Size	-
Lot Count	
Units Buildable	
Non-Ag Acres	0
Topography	
Street Access	
Utilities	
Amenities	LAND QUALITY
<b>Method</b>	
Base Lot Value	
Factor Value	
Adjustments	
Lot Value	



\\tsclient\T\LOGAN\LOGAN RESIDENTIAL VI\2023-12-20\IMG\_001 12/20/2023

<b>Residential Data</b>	
Type	1 Single Family Residence
Condition	1 - Low
Quality	2 - Fair
<b>Architecture</b>	
Style	100% One Story
Exterior Wall	100% Veneer, Stone
Base/Total Area	1,152 / 1,152
Style	100% One Story
HVAC	100% Floor Furnace
Roof Cover	1 Composition Shingle
Area on Slab	0
Fixture/RghIn	4 /
Bed/F/H Bath	3 / 1.0 /
Basement Area	
Garage Type	
Remodel	
Year/Eff Age	1958 / 95

<b>GRM Approach</b>	
GRM Code	
Gross Rent	0.00
Indicated Value	

<b>Multiple Regression</b>	
MRA Code	
Adjusted R	
Indicated Value	

<b>Direct Comparables</b>	
Selection Model	A Adam Test
Adjustment Model	NewTest
Comparables	
Indicated Value	

<b>Cost Approach</b>		<b>Manual : 01/2025</b>	
Base Cost	105.25	Total Misc Impr	+ 7,190
Roofing Adj	+ 4.07	Garage Cost	+
Subfloor Adj	+ 2.37	Total RCN	= 142,757
Heat/Cool Adj	+ 1.65	Depreciation ( 92%)	- 131,336
Plumbing Adj	+ 4.34	Lump Sums	+ 0
Basement Adj	+ 0.00	RCNLD	= 11,421
Adj Base Cost	= 117.68	Lot Value	+
Total Area	x 1,152	Indicated Value	= 11,421
Adjusted Cost	= 135,567	Value Per SqFt	9.91

<b>Value Reconciliation</b>	
Selected Approach	Cost Approach
Improvements	11,421
Lot Value	
Indicated Value	11,421 9.91 Per SqFt
Agland Value	463
Site Improvements	
Total Value	11,884 10.32 Total Value Per SqFt

<b>Miscellaneous Improvements</b>								
Code	Description	Sketch ID	Size	Year	Units	Unit Cost	Depr	Value
FPR1	FIREPLACE - RESIDENTIAL 1 STORY	0		1	1	4,576.55		4,577
PRCH	SLAB PORCH - COVERED	70638	25x5		125	20.90		2,613



# Rogers

## Assessment Property Record Card for Tax Year 2026

Data provided by LISA DELOZIER County Assessor

Date 04/18/2026

Time 07:30:18

Page 3

### Sketch Image

660029469

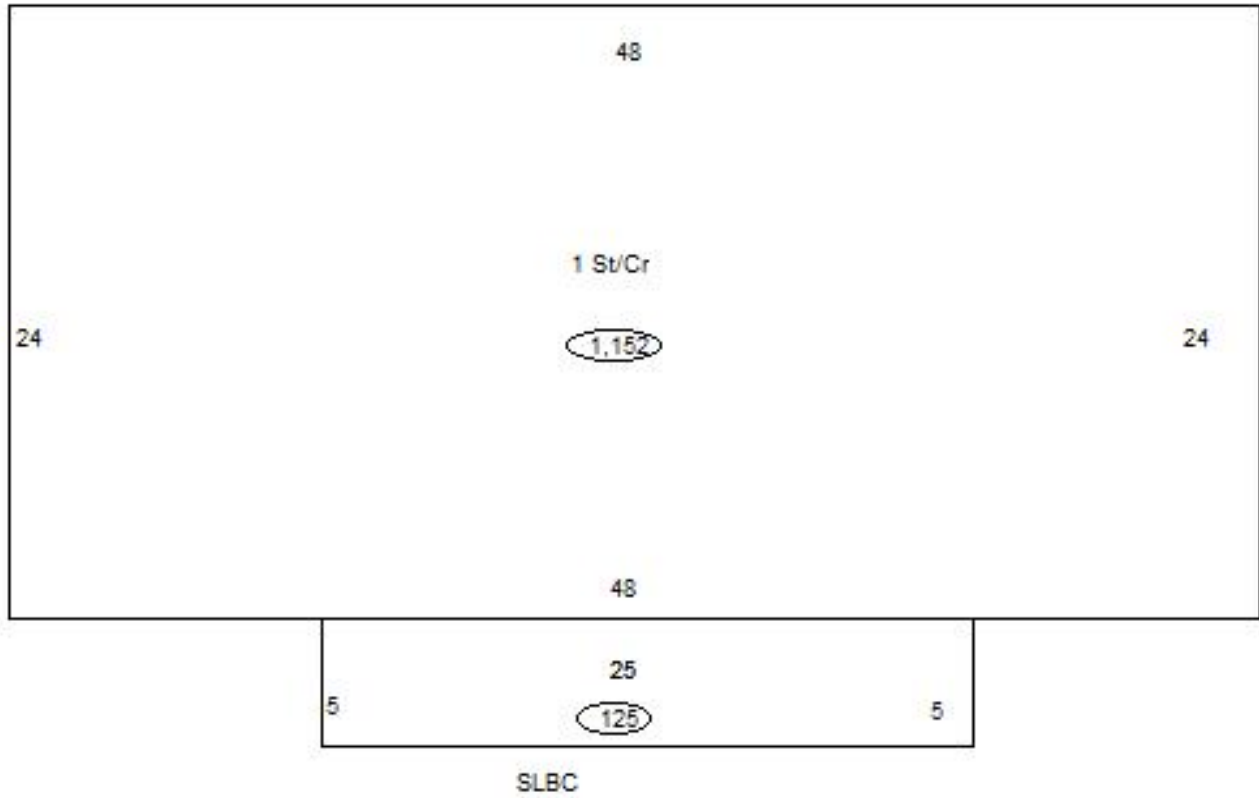

### Sketch Vector Information

Sequence	Code	Type	Built Over	Scale	Section Label	Base Area	Multiplier	Total Area
1	R	1	Crawl	10	1 St/Cr	1,152	1.000	1,152
2	M	PRCH		10	SLBC	125	1.000	125
<b>Total Building Area</b>						1,152		1,152



# Rogers

## Assessment Property Record Card for Tax Year 2026

Data provided by LISA DELOZIER County Assessor

Date 04/18/2026  
Time 07:30:18  
Page 4

### Agland Inventory

660029469

Soi	Description	Land Use	LPI	Adj Type	Adj Code	Acres	Use/Acre	Mkt/Acre	Use Value	Market Value
HLC	HECTOR-LINKER FINE SANDY	TMBR	35			1.550	63	63	98	98
LKB	LINKER FINE SANDY LOAM 1-	TMBR	63			3.100	113	113	352	352
RS	ROUGH STONY LAND	TMBR	20			.350	36	36	13	13
<b>TMBR Totals</b>						5.000			463	463
<b>Total Agland</b>						5.000			463	463