



# Rogers

## Assessment Property Record Card for Tax Year 2026

Data provided by LISA DELOZIER County Assessor

Date 04/16/2026  
 Time 22:17:04  
 Page 1

Assessment Data					Primary Image																																																																																																																				
<b>Account</b> 660029502 <b>Parcel ID</b> 22N14E-34-2-00000-000-0000 <b>Cadastral ID</b> 34-22-14-01000 <b>Property Type</b> REAL - Real Property <b>Property Class</b> RR VI Area 2 <b>Tax Area</b> 27 - COLLINSVILLE/COLL FIRE <b>Name ID</b> 312248 BAKER, RICHARD OTIS & NANCY LEANN REVOCABLE TRUST 14710 E 136TH ST N COLLINSVILLE OK 74021-0000																																																																																																																									
<b>Parcel Location</b> <b>Situs</b> 14710 E 136TH ST N <b>Subdivision</b> <b>Lot/Block</b> / <b>Parcel Size</b> 2.5 - Acres <b>Sec/Twn/Rng</b> 34 / 22 / 14 / 2 <b>Neighborhood</b> 4010 - 22-14 <b>School District</b> S026 - COLLINSVILLE SCHOOLS																																																																																																																									
<b>Legal Description</b> Lat/Long: 36.35011625 -95.80972196 W2 W2 NE NW NW					<b>Building Permits</b> <table border="1"> <thead> <tr> <th>Number</th> <th>Description</th> <th>Opened</th> <th>Closed</th> <th>Amount</th> </tr> </thead> <tbody> <tr> <td> </td> <td> </td> <td> </td> <td> </td> <td> </td> </tr> </tbody> </table>					Number	Description	Opened	Closed	Amount																																																																																																											
Number	Description	Opened	Closed	Amount																																																																																																																					
<b>Exemptions</b> <table border="1"> <thead> <tr> <th>Code</th> <th>Type</th> <th>Active</th> <th>Maximum</th> <th>Exemption</th> </tr> </thead> <tbody> <tr> <td>H</td> <td>Homestead</td> <td>Yes</td> <td>1,000</td> <td>1,000</td> </tr> <tr> <td>PD</td> <td>Add-Homestead</td> <td>No</td> <td>1,000</td> <td> </td> </tr> </tbody> </table>					Code	Type	Active	Maximum	Exemption	H	Homestead	Yes	1,000	1,000	PD	Add-Homestead	No	1,000		<b>Sale History</b> <table border="1"> <thead> <tr> <th>Bk/Pg</th> <th>Grantor</th> <th>Date</th> <th>Price</th> <th>Code</th> </tr> </thead> <tbody> <tr> <td>2400/633</td> <td>BRATTON, ROBERT W</td> <td>05/08/2014</td> <td>165,000</td> <td>YES</td> </tr> <tr> <td>2263/635</td> <td>BRATTON, MELVINA M</td> <td>07/31/2012</td> <td>148,000</td> <td>YES</td> </tr> </tbody> </table>					Bk/Pg	Grantor	Date	Price	Code	2400/633	BRATTON, ROBERT W	05/08/2014	165,000	YES	2263/635	BRATTON, MELVINA M	07/31/2012	148,000	YES																																																																																		
Code	Type	Active	Maximum	Exemption																																																																																																																					
H	Homestead	Yes	1,000	1,000																																																																																																																					
PD	Add-Homestead	No	1,000																																																																																																																						
Bk/Pg	Grantor	Date	Price	Code																																																																																																																					
2400/633	BRATTON, ROBERT W	05/08/2014	165,000	YES																																																																																																																					
2263/635	BRATTON, MELVINA M	07/31/2012	148,000	YES																																																																																																																					
<b>Parcel Valuation</b> <table border="1"> <thead> <tr> <th>Source</th> <th>REAL</th> <th>Fair Cash</th> <th>Capped</th> <th>Asmnt Level</th> <th>Assessed</th> <th>Levy Rate</th> <th>102.120</th> <th>Current Tax</th> </tr> </thead> <tbody> <tr> <td>Remove Cap</td> <td>2015</td> <td>Land Value 87,575</td> <td>61,009</td> <td>11%</td> <td>6,711</td> <td>Assessed</td> <td>24,142</td> <td>2,465.38</td> </tr> <tr> <td>Year Frozen</td> <td>0</td> <td>Improvements 161,639</td> <td>158,464</td> <td> </td> <td>17,431</td> <td>Penalty</td> <td>0</td> <td> </td> </tr> <tr> <td>Uncapped Value</td> <td>0</td> <td>Mobile Home 0</td> <td>0</td> <td> </td> <td>0</td> <td>Exemption</td> <td>1,000</td> <td>-102.00</td> </tr> <tr> <td>TIF Project ID</td> <td>0</td> <td>Total Value 249,214</td> <td>219,473</td> <td> </td> <td>24,142</td> <td>Total Taxable</td> <td>23,142</td> <td>2,363.00</td> </tr> </tbody> </table>										Source	REAL	Fair Cash	Capped	Asmnt Level	Assessed	Levy Rate	102.120	Current Tax	Remove Cap	2015	Land Value 87,575	61,009	11%	6,711	Assessed	24,142	2,465.38	Year Frozen	0	Improvements 161,639	158,464		17,431	Penalty	0		Uncapped Value	0	Mobile Home 0	0		0	Exemption	1,000	-102.00	TIF Project ID	0	Total Value 249,214	219,473		24,142	Total Taxable	23,142	2,363.00																																																																			
Source	REAL	Fair Cash	Capped	Asmnt Level	Assessed	Levy Rate	102.120	Current Tax																																																																																																																	
Remove Cap	2015	Land Value 87,575	61,009	11%	6,711	Assessed	24,142	2,465.38																																																																																																																	
Year Frozen	0	Improvements 161,639	158,464		17,431	Penalty	0																																																																																																																		
Uncapped Value	0	Mobile Home 0	0		0	Exemption	1,000	-102.00																																																																																																																	
TIF Project ID	0	Total Value 249,214	219,473		24,142	Total Taxable	23,142	2,363.00																																																																																																																	
<b>Assessment History</b> <table border="1"> <thead> <tr> <th>Tax Year</th> <th>Statement Number</th> <th>Billed Owner</th> <th>Tax Area</th> <th>Total Value</th> <th>Exemptions</th> <th>Taxable Value</th> <th>Billed Tax</th> </tr> </thead> <tbody> <tr><td>2025</td><td>2025-660029502</td><td>BAKER, RICHARD OTIS &amp;</td><td>27</td><td>252,210</td><td>1000</td><td>22,439</td><td>2,291.00</td></tr> <tr><td>2024</td><td>2024-660029502</td><td>BAKER, RICHARD OTIS &amp;</td><td>27</td><td>264,068</td><td>1000</td><td>21,756</td><td>2,180.00</td></tr> <tr><td>2023</td><td>2023-660029502</td><td>BAKER, RICHARD OTIS &amp;</td><td>27</td><td>201,509</td><td>1000</td><td>21,093</td><td>2,074.00</td></tr> <tr><td>2022</td><td>2022-660029502</td><td>BAKER, RICHARD OTIS &amp;</td><td>27</td><td>201,109</td><td>1000</td><td>20,450</td><td>1,998.00</td></tr> <tr><td>2021</td><td>2021-660029502</td><td>BAKER, RICHARD OTIS &amp;</td><td>27</td><td>199,689</td><td>1000</td><td>19,825</td><td>1,967.00</td></tr> <tr><td>2020</td><td>2020-660029502</td><td>BAKER, RICHARD OTIS &amp;</td><td>27</td><td>194,964</td><td>1000</td><td>19,219</td><td>1,912.00</td></tr> <tr><td>2019</td><td>2019-660029502</td><td>BAKER, RICHARD OTIS &amp;</td><td>27</td><td>178,454</td><td>1000</td><td>18,630</td><td>1,832.00</td></tr> <tr><td>2018</td><td>2018-660029502</td><td>BAKER, RICHARD OTIS &amp;</td><td>27</td><td>184,865</td><td>1000</td><td>19,081</td><td>1,897.00</td></tr> <tr><td>2017</td><td>2017-660029502</td><td>BAKER, RICHARD OTIS &amp;</td><td>27</td><td>182,682</td><td>1000</td><td>18,497</td><td>1,810.00</td></tr> <tr><td>2016</td><td>2016-660029502</td><td>BAKER, RICHARD OTIS &amp;</td><td>27</td><td>172,082</td><td>1000</td><td>17,929</td><td>1,710.00</td></tr> <tr><td>2015</td><td>2015-660029502</td><td>BAKER, RICHARD OTIS &amp;</td><td>27</td><td>167,541</td><td>1000</td><td>17,429</td><td>1,683.00</td></tr> <tr><td>2014</td><td>2014-660029502</td><td>BAKER, RICHARD OTIS &amp;</td><td>27</td><td>157,265</td><td>0</td><td>17,299</td><td>1,620.00</td></tr> <tr><td>2013</td><td>2013-660029502</td><td>BRATTON, ROBERT W</td><td>27</td><td>150,793</td><td>0</td><td>16,587</td><td>1,549.00</td></tr> </tbody> </table>										Tax Year	Statement Number	Billed Owner	Tax Area	Total Value	Exemptions	Taxable Value	Billed Tax	2025	2025-660029502	BAKER, RICHARD OTIS &	27	252,210	1000	22,439	2,291.00	2024	2024-660029502	BAKER, RICHARD OTIS &	27	264,068	1000	21,756	2,180.00	2023	2023-660029502	BAKER, RICHARD OTIS &	27	201,509	1000	21,093	2,074.00	2022	2022-660029502	BAKER, RICHARD OTIS &	27	201,109	1000	20,450	1,998.00	2021	2021-660029502	BAKER, RICHARD OTIS &	27	199,689	1000	19,825	1,967.00	2020	2020-660029502	BAKER, RICHARD OTIS &	27	194,964	1000	19,219	1,912.00	2019	2019-660029502	BAKER, RICHARD OTIS &	27	178,454	1000	18,630	1,832.00	2018	2018-660029502	BAKER, RICHARD OTIS &	27	184,865	1000	19,081	1,897.00	2017	2017-660029502	BAKER, RICHARD OTIS &	27	182,682	1000	18,497	1,810.00	2016	2016-660029502	BAKER, RICHARD OTIS &	27	172,082	1000	17,929	1,710.00	2015	2015-660029502	BAKER, RICHARD OTIS &	27	167,541	1000	17,429	1,683.00	2014	2014-660029502	BAKER, RICHARD OTIS &	27	157,265	0	17,299	1,620.00	2013	2013-660029502	BRATTON, ROBERT W	27	150,793	0	16,587	1,549.00
Tax Year	Statement Number	Billed Owner	Tax Area	Total Value	Exemptions	Taxable Value	Billed Tax																																																																																																																		
2025	2025-660029502	BAKER, RICHARD OTIS &	27	252,210	1000	22,439	2,291.00																																																																																																																		
2024	2024-660029502	BAKER, RICHARD OTIS &	27	264,068	1000	21,756	2,180.00																																																																																																																		
2023	2023-660029502	BAKER, RICHARD OTIS &	27	201,509	1000	21,093	2,074.00																																																																																																																		
2022	2022-660029502	BAKER, RICHARD OTIS &	27	201,109	1000	20,450	1,998.00																																																																																																																		
2021	2021-660029502	BAKER, RICHARD OTIS &	27	199,689	1000	19,825	1,967.00																																																																																																																		
2020	2020-660029502	BAKER, RICHARD OTIS &	27	194,964	1000	19,219	1,912.00																																																																																																																		
2019	2019-660029502	BAKER, RICHARD OTIS &	27	178,454	1000	18,630	1,832.00																																																																																																																		
2018	2018-660029502	BAKER, RICHARD OTIS &	27	184,865	1000	19,081	1,897.00																																																																																																																		
2017	2017-660029502	BAKER, RICHARD OTIS &	27	182,682	1000	18,497	1,810.00																																																																																																																		
2016	2016-660029502	BAKER, RICHARD OTIS &	27	172,082	1000	17,929	1,710.00																																																																																																																		
2015	2015-660029502	BAKER, RICHARD OTIS &	27	167,541	1000	17,429	1,683.00																																																																																																																		
2014	2014-660029502	BAKER, RICHARD OTIS &	27	157,265	0	17,299	1,620.00																																																																																																																		
2013	2013-660029502	BRATTON, ROBERT W	27	150,793	0	16,587	1,549.00																																																																																																																		



# Rogers

## Assessment Property Record Card for Tax Year 2026

Data provided by LISA DELOZIER County Assessor

Date 04/16/2026  
Time 22:17:04  
Page 2

Lot Data	Square-Foot - NBHD 4010 #1	Primary Image
<b>Lot Size</b> <b>Lot Count</b> <b>Units Buildable</b> 2.5 <b>Non-Ag Acres</b> 2.3682 <b>Topography</b> <b>Street Access</b> <b>Utilities</b> <b>Amenities</b> LAND QUALITY 0 0 <b>Method</b> Square-Foot <b>Base Lot Value</b> 103,157.00 x .85 = 87,575 <b>Factor Value</b> <b>Adjustments</b> 1.0000 <b>Lot Value</b> 87,575		

Residential Data	
<b>Type</b>	1 Single Family Residence
<b>Condition</b>	4 - Good
<b>Quality</b>	2.5 - Fair
<b>Architecture</b>	
<b>Style</b>	100% One Story
<b>Exterior Wall</b>	100% Veneer, Masonry
<b>Base/Total Area</b>	1,205 / 1,205
<b>Style</b>	100% One Story
<b>HVAC</b>	100% Warmed & Cooled Air
<b>Roof Cover</b>	1 Composition Shingle
<b>Area on Slab</b>	1,205
<b>Fixture/RghIn</b>	11 /
<b>Bed/F/H Bath</b>	3 / 2.0 /
<b>Basement Area</b>	
<b>Garage Type</b>	672 Attached Garage - Unfinished
<b>Remodel</b>	
<b>Year/Eff Age</b>	1980 / 28



\\tsclient\TCASEY\CASEY BOOTH VISUAL INSPECTION\2020-9- 9/18/2020

GRM Approach	
<b>GRM Code</b>	
<b>Gross Rent</b>	0.00
<b>Indicated Value</b>	

Multiple Regression			
<b>MRA Code</b>	1	Test	
<b>Adusted R</b>	0.8445		
<b>Indicated Value</b>	200,791	166.63	Per SqFt

Direct Comparables	
<b>Selection Model</b>	1 Res
<b>Adjustment Model</b>	A2 AO Test
<b>Comparables</b>	
<b>Indicated Value</b>	

Cost Approach				Manual : 01/2025			
<b>Base Cost</b>	108.00	<b>Total Misc Impr</b>	+	16,495			
<b>Roofing Adj</b>	+ 4.56	<b>Garage Cost</b>	+	17,418			
<b>Subfloor Adj</b>	+ -1.15	<b>Total RCN</b>	=	196,058			
<b>Heat/Cool Adj</b>	+ 11.47	<b>Depreciation ( 38%)</b>	-	74,502			
<b>Plumbing Adj</b>	+ 11.68	<b>Lump Sums</b>	+	0			
<b>Basement Adj</b>	+ 0.00	<b>RCNLD</b>	=	121,556			
<b>Adj Base Cost</b>	= 134.56	<b>Lot Value</b>	+	87,575			
<b>Total Area</b>	x 1,205	<b>Indicated Value</b>	=	209,131			
<b>Adjusted Cost</b>	= 162,145	<b>Value Per SqFt</b>		173.55			

Value Reconciliation			
<b>Selected Approach</b>	Cost Approach		
<b>Improvements</b>	121,556		
<b>Lot Value</b>	87,575		
<b>Indicated Value</b>	209,131	173.55	Per SqFt
<b>Agland Value</b>			
<b>Site Improvements</b>	40,083		
<b>Total Value</b>	249,214	206.82	Total Value Per SqFt

Miscellaneous Improvements								
Code	Description	Sketch ID	Size	Year	Units	Unit Cost	Depr	Value
FPR1	FIREPLACE - RESIDENTIAL 1 STORY	0		1	1	5,095.98		5,096
PRCH	SLAB PORCH - COVERED	70699	20x5		100	23.95		2,395
EPSW	ENCLOSED PORCH - SOLID WALL	70700	12x12		144	62.53		9,004



# Rogers

## Assessment Property Record Card for Tax Year 2026

Data provided by LISA DELOZIER County Assessor

Date 04/16/2026

Time 22:17:04

Page 3

### Sketch Image

660029502

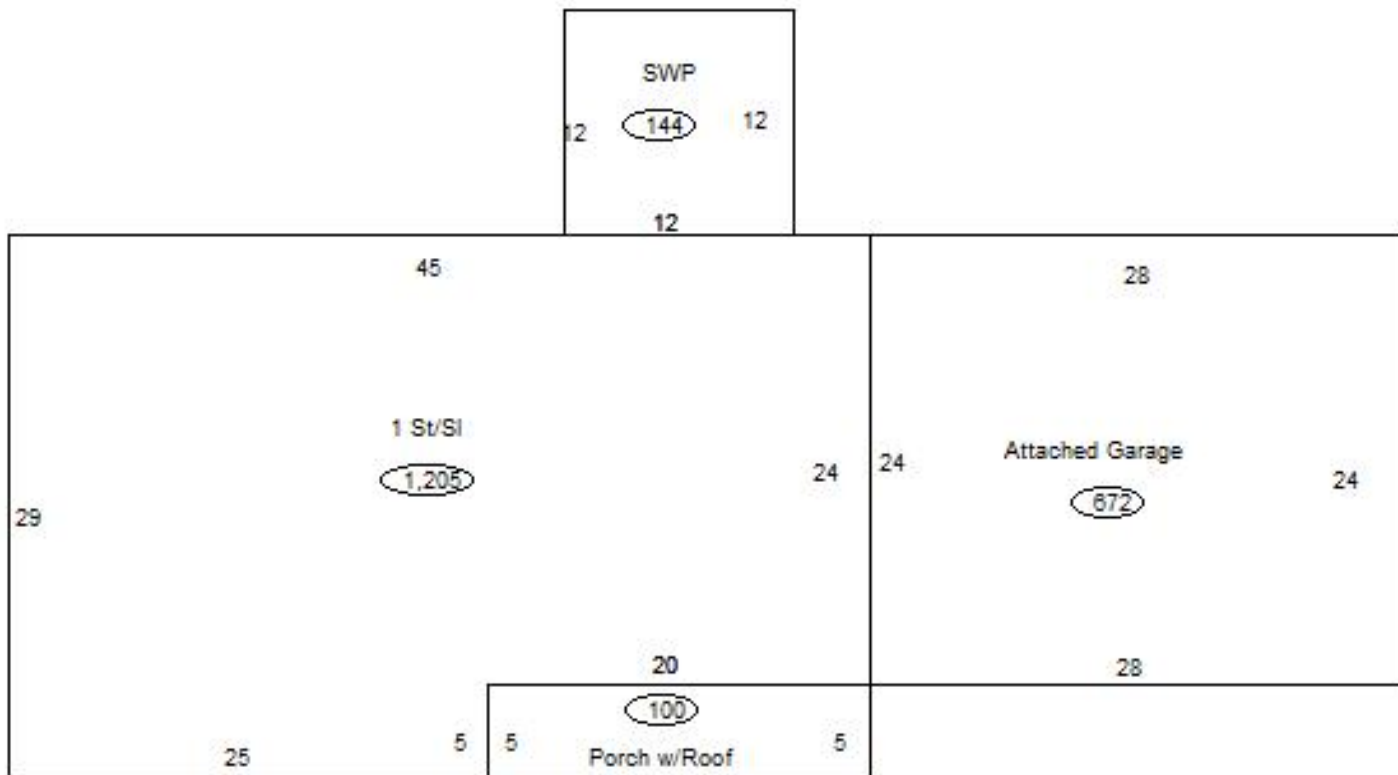

### Sketch Vector Information

Sequence	Code	Type	Built Over	Scale	Section Label	Base Area	Multiplier	Total Area
1	R	1	Slab	13	1 St/SI	1,205	1.000	1,205
2	G	1		13	Attached Garage	672	1.000	672
3	M	PRCH		13	SLBC	100	1.000	100
4	M	EPSW		13	EPSW	144	1.000	144
<b>Total Building Area</b>						1,205		1,205



# Rogers



## Assessment Property Record Card for Tax Year 2026

Data provided by LISA DELOZIER County Assessor

Date 04/16/2026  
Time 22:17:05  
Page 4

660029502

### Outbuildings/Site Improvements

Building Image	Code	Description	Dimensions	Floor	Roofing	Total Units	
	SHDS	Shed - Small	14x10x6	Plank	Composition Shingle	140	
	Qual	3	Cond 3	Year 2018	Eff Age 6		
		<b>Valuation Summary</b>		<b>Modifier Total</b>	<b>RCN</b>	<b>Depr (100% Phys/ % Func)</b>	<b>RCNLD</b>
		Base Cost (26.10 x 140)	3,654		3,654	3,654	
	UTIL	SHOP BUILDING	36x60x10	Concrete	Galvanized Metal	2,160	
	Qual	3	Cond 3	Year 2012	Eff Age		
		<b>Valuation Summary</b>		<b>Modifier Total</b>	<b>RCN</b>	<b>Depr (30% Phys/ % Func)</b>	<b>RCNLD</b>
		Base Cost (26.51 x 2,160)	57,262		57,262	17,179	40,083