



Rogers

Assessment Property Record Card for Tax Year 2026

Data provided by LISA DELOZIER County Assessor

Date 04/16/2026
Time 22:02:25
Page 1

Assessment Data					Primary Image																																																																																																																				
Account 660029561 Parcel ID 000000-00-0-00945-003-0012 Cadastral ID 34-22-14-02330 Property Type REAL - Real Property Property Class RRP VI Area 2 Tax Area 27 - COLLINSVILLE/COLL FIRE Name ID 193244 BOYER, THOMAS W 15235 E 131ST ST N COLLINSVILLE OK 74021-0000 Parcel Location Situs 15235 131ST ST Subdivision WINDING CREEK ESTATES III Lot/Block 0012 / 0003 Parcel Size 1 - Lots Sec/Twn/Rng 34 / 22 / 14 / 5 Neighborhood 1096 - R-V02-NW COLLINSVILLE School District S026 - COLLINSVILLE SCHOOLS																																																																																																																									
Legal Description Lat/Long: 36.34444379 -95.80431459																																																																																																																									
Building Permits					\\tsclient\TCASEY\CASEY BOOTH VISUAL INSPECTION\2020-9- 9/18/2020																																																																																																																				
Exemptions					Sale History																																																																																																																				
LOT 12 BLOCK 3 WINDING CREEK EXT. 3					<table border="1"> <thead> <tr> <th>Number</th> <th>Description</th> <th>Opened</th> <th>Closed</th> <th>Amount</th> </tr> </thead> <tbody> <tr> <td> </td> <td> </td> <td> </td> <td> </td> <td> </td> </tr> </tbody> </table>					Number	Description	Opened	Closed	Amount																																																																																																											
Number	Description	Opened	Closed	Amount																																																																																																																					
<table border="1"> <thead> <tr> <th>Code</th> <th>Type</th> <th>Active</th> <th>Maximum</th> <th>Exemption</th> </tr> </thead> <tbody> <tr> <td>H</td> <td>Homestead</td> <td>Yes</td> <td>1,000</td> <td>1,000</td> </tr> </tbody> </table>					Code	Type	Active	Maximum	Exemption	H	Homestead	Yes	1,000	1,000	<table border="1"> <thead> <tr> <th>Bk/Pg</th> <th>Grantor</th> <th>Date</th> <th>Price</th> <th>Code</th> </tr> </thead> <tbody> <tr> <td>954/416</td> <td>SELLER</td> <td>04/18/1994</td> <td>0</td> <td>No</td> </tr> </tbody> </table>					Bk/Pg	Grantor	Date	Price	Code	954/416	SELLER	04/18/1994	0	No																																																																																												
Code	Type	Active	Maximum	Exemption																																																																																																																					
H	Homestead	Yes	1,000	1,000																																																																																																																					
Bk/Pg	Grantor	Date	Price	Code																																																																																																																					
954/416	SELLER	04/18/1994	0	No																																																																																																																					
Parcel Valuation																																																																																																																									
<table border="1"> <thead> <tr> <th>Source</th> <th>REAL</th> <th>Fair Cash</th> <th>Capped</th> <th>Asmnt Level</th> <th>Assessed</th> <th>Levy Rate</th> <th>102.120</th> <th>Current Tax</th> </tr> </thead> <tbody> <tr> <td>Remove Cap</td> <td>0</td> <td>Land Value 98,309</td> <td>50,313</td> <td>11%</td> <td>5,534</td> <td>Assessed</td> <td>24,211</td> <td>2,472.43</td> </tr> <tr> <td>Year Frozen</td> <td>0</td> <td>Improvements 170,588</td> <td>169,794</td> <td></td> <td>18,677</td> <td>Penalty</td> <td>0</td> <td></td> </tr> <tr> <td>Uncapped Value</td> <td>0</td> <td>Mobile Home 0</td> <td>0</td> <td></td> <td>0</td> <td>Exemption</td> <td>1,000</td> <td>-102.00</td> </tr> <tr> <td>TIF Project ID</td> <td>0</td> <td>Total Value 268,897</td> <td>220,107</td> <td></td> <td>24,211</td> <td>Total Taxable</td> <td>23,211</td> <td>2,370.00</td> </tr> </tbody> </table>		Source	REAL	Fair Cash	Capped	Asmnt Level	Assessed	Levy Rate	102.120	Current Tax	Remove Cap	0	Land Value 98,309	50,313	11%	5,534	Assessed	24,211	2,472.43	Year Frozen	0	Improvements 170,588	169,794		18,677	Penalty	0		Uncapped Value	0	Mobile Home 0	0		0	Exemption	1,000	-102.00	TIF Project ID	0	Total Value 268,897	220,107		24,211	Total Taxable	23,211	2,370.00																																																																											
Source	REAL	Fair Cash	Capped	Asmnt Level	Assessed	Levy Rate	102.120	Current Tax																																																																																																																	
Remove Cap	0	Land Value 98,309	50,313	11%	5,534	Assessed	24,211	2,472.43																																																																																																																	
Year Frozen	0	Improvements 170,588	169,794		18,677	Penalty	0																																																																																																																		
Uncapped Value	0	Mobile Home 0	0		0	Exemption	1,000	-102.00																																																																																																																	
TIF Project ID	0	Total Value 268,897	220,107		24,211	Total Taxable	23,211	2,370.00																																																																																																																	
Assessment History																																																																																																																									
<table border="1"> <thead> <tr> <th>Tax Year</th> <th>Statement Number</th> <th>Billed Owner</th> <th>Tax Area</th> <th>Total Value</th> <th>Exemptions</th> <th>Taxable Value</th> <th>Billed Tax</th> </tr> </thead> <tbody> <tr><td>2025</td><td>2025-660029561</td><td>BOYER, THOMAS W</td><td>27</td><td>263,158</td><td>1000</td><td>22,506</td><td>2,298.00</td></tr> <tr><td>2024</td><td>2024-660029561</td><td>BOYER, THOMAS W</td><td>27</td><td>302,477</td><td>1000</td><td>21,822</td><td>2,187.00</td></tr> <tr><td>2023</td><td>2023-660029561</td><td>BOYER, THOMAS W</td><td>27</td><td>201,431</td><td>1000</td><td>21,157</td><td>2,081.00</td></tr> <tr><td>2022</td><td>2022-660029561</td><td>BOYER, THOMAS W</td><td>27</td><td>201,426</td><td>1000</td><td>21,157</td><td>2,067.00</td></tr> <tr><td>2021</td><td>2021-660029561</td><td>BOYER, THOMAS W</td><td>27</td><td>204,266</td><td>1000</td><td>21,264</td><td>2,110.00</td></tr> <tr><td>2020</td><td>2020-660029561</td><td>BOYER, THOMAS W</td><td>27</td><td>203,135</td><td>1000</td><td>20,616</td><td>2,050.00</td></tr> <tr><td>2019</td><td>2019-660029561</td><td>BOYER, THOMAS W</td><td>27</td><td>193,330</td><td>1000</td><td>19,986</td><td>1,965.00</td></tr> <tr><td>2018</td><td>2018-660029561</td><td>BOYER, THOMAS W</td><td>27</td><td>198,815</td><td>1000</td><td>19,375</td><td>1,926.00</td></tr> <tr><td>2017</td><td>2017-660029561</td><td>BOYER, THOMAS W</td><td>27</td><td>197,206</td><td>1000</td><td>18,782</td><td>1,838.00</td></tr> <tr><td>2016</td><td>2016-660029561</td><td>BOYER, THOMAS W</td><td>27</td><td>193,059</td><td>1000</td><td>18,205</td><td>1,737.00</td></tr> <tr><td>2015</td><td>2015-660029561</td><td>BOYER, THOMAS W</td><td>27</td><td>188,008</td><td>1000</td><td>17,646</td><td>1,704.00</td></tr> <tr><td>2014</td><td>2014-660029561</td><td>BOYER, THOMAS W</td><td>27</td><td>193,178</td><td>1000</td><td>17,104</td><td>1,601.00</td></tr> <tr><td>2013</td><td>2013-660029561</td><td>BOYER, THOMAS W</td><td>27</td><td>182,074</td><td>1000</td><td>16,575</td><td>1,548.00</td></tr> </tbody> </table>										Tax Year	Statement Number	Billed Owner	Tax Area	Total Value	Exemptions	Taxable Value	Billed Tax	2025	2025-660029561	BOYER, THOMAS W	27	263,158	1000	22,506	2,298.00	2024	2024-660029561	BOYER, THOMAS W	27	302,477	1000	21,822	2,187.00	2023	2023-660029561	BOYER, THOMAS W	27	201,431	1000	21,157	2,081.00	2022	2022-660029561	BOYER, THOMAS W	27	201,426	1000	21,157	2,067.00	2021	2021-660029561	BOYER, THOMAS W	27	204,266	1000	21,264	2,110.00	2020	2020-660029561	BOYER, THOMAS W	27	203,135	1000	20,616	2,050.00	2019	2019-660029561	BOYER, THOMAS W	27	193,330	1000	19,986	1,965.00	2018	2018-660029561	BOYER, THOMAS W	27	198,815	1000	19,375	1,926.00	2017	2017-660029561	BOYER, THOMAS W	27	197,206	1000	18,782	1,838.00	2016	2016-660029561	BOYER, THOMAS W	27	193,059	1000	18,205	1,737.00	2015	2015-660029561	BOYER, THOMAS W	27	188,008	1000	17,646	1,704.00	2014	2014-660029561	BOYER, THOMAS W	27	193,178	1000	17,104	1,601.00	2013	2013-660029561	BOYER, THOMAS W	27	182,074	1000	16,575	1,548.00
Tax Year	Statement Number	Billed Owner	Tax Area	Total Value	Exemptions	Taxable Value	Billed Tax																																																																																																																		
2025	2025-660029561	BOYER, THOMAS W	27	263,158	1000	22,506	2,298.00																																																																																																																		
2024	2024-660029561	BOYER, THOMAS W	27	302,477	1000	21,822	2,187.00																																																																																																																		
2023	2023-660029561	BOYER, THOMAS W	27	201,431	1000	21,157	2,081.00																																																																																																																		
2022	2022-660029561	BOYER, THOMAS W	27	201,426	1000	21,157	2,067.00																																																																																																																		
2021	2021-660029561	BOYER, THOMAS W	27	204,266	1000	21,264	2,110.00																																																																																																																		
2020	2020-660029561	BOYER, THOMAS W	27	203,135	1000	20,616	2,050.00																																																																																																																		
2019	2019-660029561	BOYER, THOMAS W	27	193,330	1000	19,986	1,965.00																																																																																																																		
2018	2018-660029561	BOYER, THOMAS W	27	198,815	1000	19,375	1,926.00																																																																																																																		
2017	2017-660029561	BOYER, THOMAS W	27	197,206	1000	18,782	1,838.00																																																																																																																		
2016	2016-660029561	BOYER, THOMAS W	27	193,059	1000	18,205	1,737.00																																																																																																																		
2015	2015-660029561	BOYER, THOMAS W	27	188,008	1000	17,646	1,704.00																																																																																																																		
2014	2014-660029561	BOYER, THOMAS W	27	193,178	1000	17,104	1,601.00																																																																																																																		
2013	2013-660029561	BOYER, THOMAS W	27	182,074	1000	16,575	1,548.00																																																																																																																		



Rogers

Assessment Property Record Card for Tax Year 2026

Data provided by LISA DELOZIER County Assessor

Date 04/16/2026
Time 22:02:25
Page 2

Lot Data	Square-Foot - NBHD 1096 #1	Primary Image
Lot Size Lot Count Units Buildable 86984.15 Non-Ag Acres 1.9294 Topography Street Access Utilities Amenities LAND QUALITY 0 0 Method Square-Foot Base Lot Value 84,044.00 x 1.17 = 98,309 Factor Value Adjustments 1.0000 Lot Value 98,309		

Residential Data	
Type	1 Single Family Residence
Condition	3 - Average
Quality	2.5 - Fair
Architecture	TRAD TRADITIONAL
Style	100% One Story
Exterior Wall	70% Veneer, Stone 30% Frame, Siding, Wood
Base/Total Area	2,242 / 2,242
Style	100% One Story
HVAC	100% Warmed & Cooled Air
Roof Cover	1 Composition Shingle
Area on Slab	2,242
Fixture/RghIn	11 /
Bed/F/H Bath	3 / 2.0 /
Basement Area	
Garage Type	792 Attached Garage - Unfinished
Remodel	
Year/Eff Age	1980 / 35

GRM Approach
GRM Code Gross Rent 0.00 Indicated Value

Multiple Regression
MRA Code 1 Test Adusted R 0.8445 Indicated Value 235,048 104.84 Per SqFt

Direct Comparables
Selection Model A Adam Test Adjustment Model 1 2022 Residential Comparables 3 Indicated Value 393,670 Per SqFt

Cost Approach				Manual : 01/2025			
Base Cost	99.61	Total Misc Impr	+ 14,294	Roofing Adj	+ 4.16	Garage Cost	+ 20,323
Subfloor Adj	+ -1.09	Total RCN	= 304,621	Heat/Cool Adj	+ 11.47	Depreciation (44%)	- 134,033
Plumbing Adj	+ 6.28	Lump Sums	+ 0	Basement Adj	+ 0.00	RCNLD	= 170,588
Adj Base Cost	= 120.43	Lot Value	+ 98,309	Total Area	x 2,242	Indicated Value	= 268,897
		Value Per SqFt	119.94	Adjusted Cost	= 270,004		

Value Reconciliation
Selected Approach Cost Approach Improvements 170,588 Lot Value 98,309 Indicated Value 268,897 119.94 Per SqFt Agland Value Site Improvements Total Value 268,897 119.94 Total Value Per SqFt

Miscellaneous Improvements								
Code	Description	Sketch ID	Size	Year	Units	Unit Cost	Depr	Value
FPR1	FIREPLACE - RESIDENTIAL 1 STORY	0		1	1	5,095.98		5,096
WODO	WOOD DECK - OPEN	70950	376		376	16.06	100%	
PRCH	SLAB PORCH - COVERED	70951	4x2		8	24.24		194
EPSW	ENCLOSED PORCH - SOLID WALL	70952	18x8		144	62.53		9,004



Rogers
Assessment Property Record Card for Tax Year 2026

Data provided by LISA DELOZIER County Assessor

Date 04/16/2026
 Time 22:02:25
 Page 3

Sketch Image

660029561

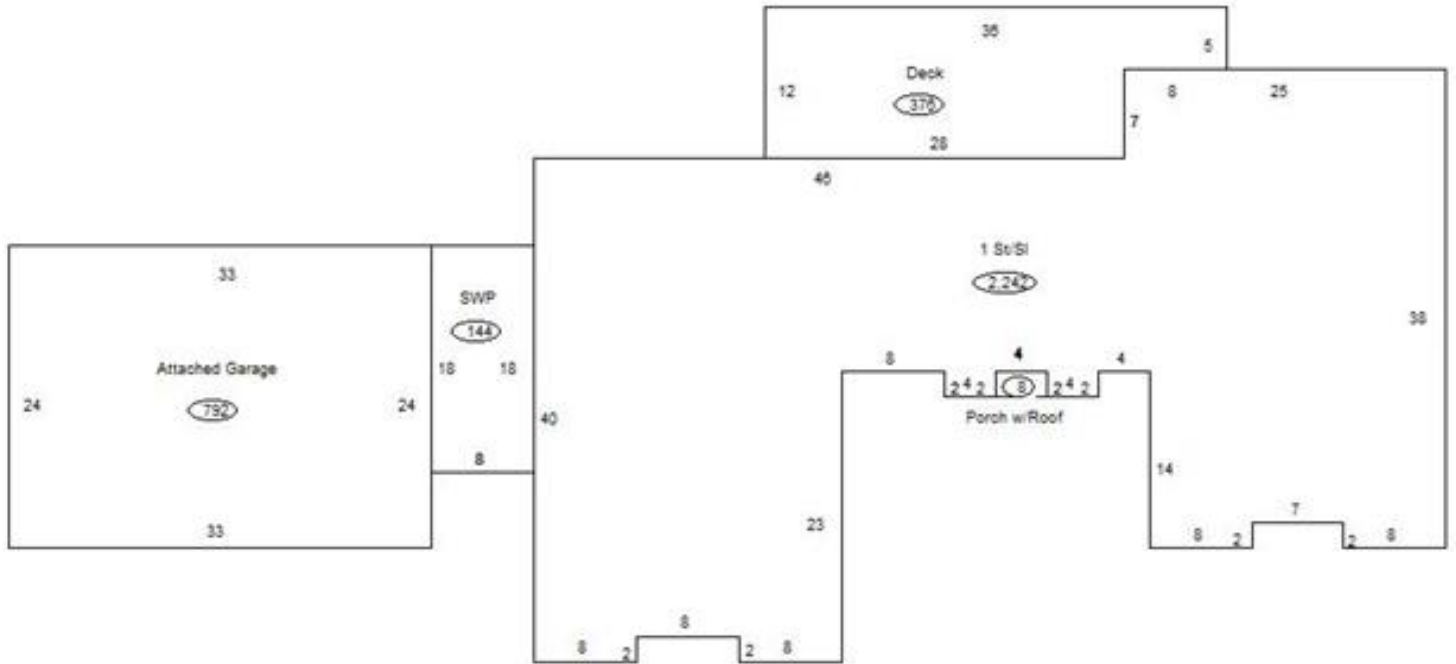

Sketch Vector Information

Sequence	Code	Type	Built Over	Scale	Section Label	Base Area	Multiplier	Total Area
1	R	1	Slab	13	1 St/SI	2,242	1.000	2,242
2	G	1		13	Attached Garage	792	1.000	792
3	M	WODO		13	WODO	376	1.000	376
4	M	PRCH		13	SLBC	8	1.000	8
5	M	EPSW		13	EPSW	144	1.000	144
Total Building Area						2,242		2,242



Rogers

Assessment Property Record Card for Tax Year 2026

Data provided by LISA DELOZIER County Assessor

Date 04/16/2026
Time 22:02:25
Page 4

660029561

Outbuildings/Site Improvements

Building Image	Code	Description	Dimensions	Floor	Roofing	Total Units
	SHDS	Shed - Small	0x0x0	Base	Composition Shingle	
	Qual	3	Cond 3	Year	Eff Age 1520	
Valuation Summary		Modifier Total		RCN	Depr (100% Phys/ % Func)	RCNLD
Base Cost (37.81 x)						