



Rogers

Assessment Property Record Card for Tax Year 2026

Data provided by LISA DELOZIER County Assessor

Date 04/16/2026
Time 22:02:49
Page 1

Assessment Data					Primary Image																																																																																																																				
Account 660029575 Parcel ID 000000-00-0-00945-003-0026 Cadastral ID 34-22-14-02470 Property Type REAL - Real Property Property Class RRP VI Area 2 Tax Area 27 - COLLINSVILLE/COLL FIRE Name ID 329916 WARREN, ROBERT & KIMBERLY 13106 N 150TH E AVE COLLINSVILLE OK 74021-0000 Parcel Location Situs 13106 N 150TH E AVE Subdivision WINDING CREEK ESTATES III Lot/Block 0026 / 0003 Parcel Size 1 - Lots Sec/Twn/Rng 34 / 22 / 14 / 5 Neighborhood 1096 - R-V02-NW COLLINSVILLE School District S026 - COLLINSVILLE SCHOOLS																																																																																																																									
Legal Description Lot/Long: 36.34435193 -95.80956357																																																																																																																									
Building Permits					\\tsclient\TCASEY\CASEY BOOTH VISUAL INSPECTION\2020-9- 9/18/2020																																																																																																																				
Exemptions					Sale History																																																																																																																				
LOT 26 BLOCK 3 WINDING CREEK EXT. 3					<table border="1"> <thead> <tr> <th>Number</th> <th>Description</th> <th>Opened</th> <th>Closed</th> <th>Amount</th> </tr> </thead> <tbody> <tr> <td></td> <td></td> <td></td> <td></td> <td></td> </tr> </tbody> </table>					Number	Description	Opened	Closed	Amount																																																																																																											
Number	Description	Opened	Closed	Amount																																																																																																																					
<table border="1"> <thead> <tr> <th>Code</th> <th>Type</th> <th>Active</th> <th>Maximum</th> <th>Exemption</th> </tr> </thead> <tbody> <tr> <td>H</td> <td>Homestead</td> <td>Yes</td> <td>1,000</td> <td>1,000</td> </tr> </tbody> </table>					Code	Type	Active	Maximum	Exemption	H	Homestead	Yes	1,000	1,000	<table border="1"> <thead> <tr> <th>Bk/Pg</th> <th>Grantor</th> <th>Date</th> <th>Price</th> <th>Code</th> </tr> </thead> <tbody> <tr> <td>/</td> <td>PFLUM, TYLER</td> <td>01/04/2020</td> <td>230,500</td> <td>YES</td> </tr> <tr> <td>2686/109</td> <td>STARR, DOUGLAS R JR & TRACY L</td> <td>01/08/2018</td> <td>179,000</td> <td>YES</td> </tr> <tr> <td>1491/298</td> <td>CHRISMAN, ALBERT E &~JEANETTE</td> <td>06/13/2003</td> <td>134,000</td> <td>YES</td> </tr> <tr> <td>1070/506</td> <td>GILPIN, SUSAN CAROL</td> <td>06/13/1997</td> <td>98,500</td> <td>Yes</td> </tr> <tr> <td>998/668</td> <td>SECRETARY HOUSING & URBAN-DE\</td> <td>07/24/1995</td> <td>0</td> <td>No</td> </tr> <tr> <td>978/63</td> <td>GILES, MARK C</td> <td>10/20/1994</td> <td>61,000</td> <td>No</td> </tr> </tbody> </table>					Bk/Pg	Grantor	Date	Price	Code	/	PFLUM, TYLER	01/04/2020	230,500	YES	2686/109	STARR, DOUGLAS R JR & TRACY L	01/08/2018	179,000	YES	1491/298	CHRISMAN, ALBERT E &~JEANETTE	06/13/2003	134,000	YES	1070/506	GILPIN, SUSAN CAROL	06/13/1997	98,500	Yes	998/668	SECRETARY HOUSING & URBAN-DE\	07/24/1995	0	No	978/63	GILES, MARK C	10/20/1994	61,000	No																																																																			
Code	Type	Active	Maximum	Exemption																																																																																																																					
H	Homestead	Yes	1,000	1,000																																																																																																																					
Bk/Pg	Grantor	Date	Price	Code																																																																																																																					
/	PFLUM, TYLER	01/04/2020	230,500	YES																																																																																																																					
2686/109	STARR, DOUGLAS R JR & TRACY L	01/08/2018	179,000	YES																																																																																																																					
1491/298	CHRISMAN, ALBERT E &~JEANETTE	06/13/2003	134,000	YES																																																																																																																					
1070/506	GILPIN, SUSAN CAROL	06/13/1997	98,500	Yes																																																																																																																					
998/668	SECRETARY HOUSING & URBAN-DE\	07/24/1995	0	No																																																																																																																					
978/63	GILES, MARK C	10/20/1994	61,000	No																																																																																																																					
Parcel Valuation																																																																																																																									
<table border="1"> <thead> <tr> <th>Source</th> <th>REAL</th> </tr> </thead> <tbody> <tr> <td>Remove Cap</td> <td>2021</td> </tr> <tr> <td>Year Frozen</td> <td>0</td> </tr> <tr> <td>Uncapped Value</td> <td>0</td> </tr> <tr> <td>TIF Project ID</td> <td>0</td> </tr> </tbody> </table>		Source	REAL	Remove Cap	2021	Year Frozen	0	Uncapped Value	0	TIF Project ID	0	<table border="1"> <thead> <tr> <th>Fair Cash</th> <th>Capped</th> <th>Asmnt Level</th> <th>Assessed</th> </tr> </thead> <tbody> <tr> <td>Land Value</td> <td>96,922</td> <td>80,761</td> <td>8,884</td> </tr> <tr> <td>Improvements</td> <td>179,846</td> <td>179,411</td> <td>19,735</td> </tr> <tr> <td>Mobile Home</td> <td>0</td> <td>0</td> <td>0</td> </tr> <tr> <td>Total Value</td> <td>276,768</td> <td>260,172</td> <td>28,619</td> </tr> </tbody> </table>			Fair Cash	Capped	Asmnt Level	Assessed	Land Value	96,922	80,761	8,884	Improvements	179,846	179,411	19,735	Mobile Home	0	0	0	Total Value	276,768	260,172	28,619	<table border="1"> <thead> <tr> <th>Levy Rate</th> <th>Current Tax</th> </tr> </thead> <tbody> <tr> <td>102.120</td> <td></td> </tr> <tr> <td>Assessed</td> <td>28,619</td> </tr> <tr> <td>Penalty</td> <td>0</td> </tr> <tr> <td>Exemption</td> <td>1,000</td> </tr> <tr> <td>Total Taxable</td> <td>27,619</td> </tr> </tbody> </table>		Levy Rate	Current Tax	102.120		Assessed	28,619	Penalty	0	Exemption	1,000	Total Taxable	27,619																																																																									
Source	REAL																																																																																																																								
Remove Cap	2021																																																																																																																								
Year Frozen	0																																																																																																																								
Uncapped Value	0																																																																																																																								
TIF Project ID	0																																																																																																																								
Fair Cash	Capped	Asmnt Level	Assessed																																																																																																																						
Land Value	96,922	80,761	8,884																																																																																																																						
Improvements	179,846	179,411	19,735																																																																																																																						
Mobile Home	0	0	0																																																																																																																						
Total Value	276,768	260,172	28,619																																																																																																																						
Levy Rate	Current Tax																																																																																																																								
102.120																																																																																																																									
Assessed	28,619																																																																																																																								
Penalty	0																																																																																																																								
Exemption	1,000																																																																																																																								
Total Taxable	27,619																																																																																																																								
Assessment History																																																																																																																									
<table border="1"> <thead> <tr> <th>Tax Year</th> <th>Statement Number</th> <th>Billed Owner</th> <th>Tax Area</th> <th>Total Value</th> <th>Exemptions</th> <th>Taxable Value</th> <th>Billed Tax</th> </tr> </thead> <tbody> <tr> <td>2025</td> <td>2025-660029575</td> <td>WARREN, ROBERT & KIMBERLY</td> <td>27</td> <td>271,108</td> <td>1000</td> <td>26,785</td> <td>2,735.00</td> </tr> <tr> <td>2024</td> <td>2024-660029575</td> <td>WARREN, ROBERT & KIMBERLY</td> <td>27</td> <td>284,783</td> <td>1000</td> <td>25,102</td> <td>2,515.00</td> </tr> <tr> <td>2023</td> <td>2023-660029575</td> <td>WARREN, ROBERT & KIMBERLY</td> <td>27</td> <td>230,376</td> <td>1000</td> <td>24,342</td> <td>2,394.00</td> </tr> <tr> <td>2022</td> <td>2022-660029575</td> <td>WARREN, ROBERT & KIMBERLY</td> <td>27</td> <td>235,308</td> <td>1000</td> <td>24,633</td> <td>2,406.00</td> </tr> <tr> <td>2021</td> <td>2021-660029575</td> <td>WARREN, ROBERT & KIMBERLY</td> <td>27</td> <td>226,239</td> <td>1000</td> <td>23,887</td> <td>2,370.00</td> </tr> <tr> <td>2020</td> <td>2020-660029575</td> <td>WARREN, ROBERT & KIMBERLY</td> <td>27</td> <td>189,424</td> <td>0</td> <td>20,837</td> <td>2,072.00</td> </tr> <tr> <td>2019</td> <td>2019-660029575</td> <td>PFLUM, TYLER</td> <td>27</td> <td>180,770</td> <td>0</td> <td>19,885</td> <td>1,955.00</td> </tr> <tr> <td>2018</td> <td>2018-660029575</td> <td>PFLUM, TYLER</td> <td>27</td> <td>174,548</td> <td>0</td> <td>19,200</td> <td>1,909.00</td> </tr> <tr> <td>2017</td> <td>2017-660029575</td> <td>STARR, DOUGLAS R JR & TRACY L</td> <td>27</td> <td>172,804</td> <td>0</td> <td>19,008</td> <td>1,860.00</td> </tr> <tr> <td>2016</td> <td>2016-660029575</td> <td>STARR, DOUGLAS R JR &</td> <td>27</td> <td>169,683</td> <td>0</td> <td>18,665</td> <td>1,781.00</td> </tr> <tr> <td>2015</td> <td>2015-660029575</td> <td>STARR, DOUGLAS R JR &</td> <td>27</td> <td>165,463</td> <td>0</td> <td>18,201</td> <td>1,757.00</td> </tr> <tr> <td>2014</td> <td>2014-660029575</td> <td>STARR, DOUGLAS R JR &</td> <td>27</td> <td>168,202</td> <td>0</td> <td>18,392</td> <td>1,722.00</td> </tr> <tr> <td>2013</td> <td>2013-660029575</td> <td>STARR, DOUGLAS R JR &</td> <td>27</td> <td>159,867</td> <td>0</td> <td>17,516</td> <td>1,636.00</td> </tr> </tbody> </table>										Tax Year	Statement Number	Billed Owner	Tax Area	Total Value	Exemptions	Taxable Value	Billed Tax	2025	2025-660029575	WARREN, ROBERT & KIMBERLY	27	271,108	1000	26,785	2,735.00	2024	2024-660029575	WARREN, ROBERT & KIMBERLY	27	284,783	1000	25,102	2,515.00	2023	2023-660029575	WARREN, ROBERT & KIMBERLY	27	230,376	1000	24,342	2,394.00	2022	2022-660029575	WARREN, ROBERT & KIMBERLY	27	235,308	1000	24,633	2,406.00	2021	2021-660029575	WARREN, ROBERT & KIMBERLY	27	226,239	1000	23,887	2,370.00	2020	2020-660029575	WARREN, ROBERT & KIMBERLY	27	189,424	0	20,837	2,072.00	2019	2019-660029575	PFLUM, TYLER	27	180,770	0	19,885	1,955.00	2018	2018-660029575	PFLUM, TYLER	27	174,548	0	19,200	1,909.00	2017	2017-660029575	STARR, DOUGLAS R JR & TRACY L	27	172,804	0	19,008	1,860.00	2016	2016-660029575	STARR, DOUGLAS R JR &	27	169,683	0	18,665	1,781.00	2015	2015-660029575	STARR, DOUGLAS R JR &	27	165,463	0	18,201	1,757.00	2014	2014-660029575	STARR, DOUGLAS R JR &	27	168,202	0	18,392	1,722.00	2013	2013-660029575	STARR, DOUGLAS R JR &	27	159,867	0	17,516	1,636.00
Tax Year	Statement Number	Billed Owner	Tax Area	Total Value	Exemptions	Taxable Value	Billed Tax																																																																																																																		
2025	2025-660029575	WARREN, ROBERT & KIMBERLY	27	271,108	1000	26,785	2,735.00																																																																																																																		
2024	2024-660029575	WARREN, ROBERT & KIMBERLY	27	284,783	1000	25,102	2,515.00																																																																																																																		
2023	2023-660029575	WARREN, ROBERT & KIMBERLY	27	230,376	1000	24,342	2,394.00																																																																																																																		
2022	2022-660029575	WARREN, ROBERT & KIMBERLY	27	235,308	1000	24,633	2,406.00																																																																																																																		
2021	2021-660029575	WARREN, ROBERT & KIMBERLY	27	226,239	1000	23,887	2,370.00																																																																																																																		
2020	2020-660029575	WARREN, ROBERT & KIMBERLY	27	189,424	0	20,837	2,072.00																																																																																																																		
2019	2019-660029575	PFLUM, TYLER	27	180,770	0	19,885	1,955.00																																																																																																																		
2018	2018-660029575	PFLUM, TYLER	27	174,548	0	19,200	1,909.00																																																																																																																		
2017	2017-660029575	STARR, DOUGLAS R JR & TRACY L	27	172,804	0	19,008	1,860.00																																																																																																																		
2016	2016-660029575	STARR, DOUGLAS R JR &	27	169,683	0	18,665	1,781.00																																																																																																																		
2015	2015-660029575	STARR, DOUGLAS R JR &	27	165,463	0	18,201	1,757.00																																																																																																																		
2014	2014-660029575	STARR, DOUGLAS R JR &	27	168,202	0	18,392	1,722.00																																																																																																																		
2013	2013-660029575	STARR, DOUGLAS R JR &	27	159,867	0	17,516	1,636.00																																																																																																																		



Rogers

Assessment Property Record Card for Tax Year 2026

Data provided by LISA DELOZIER County Assessor

Date 04/16/2026
 Time 22:02:49
 Page 2

Lot Data		Square-Foot - NBHD 1096 #1	
Lot Size			
Lot Count			
Units Buildable	74570.38		
Non-Ag Acres	1.7702		
Topography			
Street Access			
Utilities			
Amenities	LAND QUALITY	0	0
Method	Square-Foot		
Base Lot Value	77,111.00 x 1.26 = 96,922		
Factor Value			
Adjustments	1.0000		
Lot Value	96,922		



\\tsclient\TCASEY\CASEY BOOTH VISUAL INSPECTION\2020-9- 9/18/2020

Residential Data	
Type	1 Single Family Residence
Condition	3 - Average
Quality	3 - Average
Architecture	TRAD TRADITIONAL
Style	100% 1 1/2 Story Finished
Exterior Wall	50% Veneer, Stone 50% Frame, Siding, Vinyl
Base/Total Area	1,085 / 1,867
Style	100% 1 1/2 Story Finished
HVAC	100% Warmed & Cooled Air
Roof Cover	1 Composition Shingle
Area on Slab	1,085
Fixture/RghIn	20 /
Bed/F/H Bath	3 / 2.0 /
Basement Area	
Garage Type	399 Attached Garage - Finished
Remodel	
Year/Eff Age	1982 / 33

GRM Approach	
GRM Code	
Gross Rent	0.00
Indicated Value	

Multiple Regression			
MRA Code	1	Test	
Adusted R	0.8445		
Indicated Value	204,615	109.60	Per SqFt

Direct Comparables	
Selection Model	A Adam Test
Adjustment Model	1 2022 Residential
Comparables	5
Indicated Value	318,930 Per SqFt

Cost Approach				Manual : 01/2025			
Base Cost	97.54	Total Misc Impr	+ 18,020				
Roofing Adj	+ 3.15	Garage Cost	+ 16,993				
Subfloor Adj	+ -1.49	Total RCN	= 271,375				
Heat/Cool Adj	+ 12.64	Depreciation (41%)	- 111,264				
Plumbing Adj	+ 14.76	Lump Sums	+ 16,868				
Basement Adj	+ 0.00	RCNLD	= 176,979				
Adj Base Cost	= 126.60	Lot Value	+ 96,922				
Total Area	x 1,867	Indicated Value	= 273,901				
Adjusted Cost	= 236,362	Value Per SqFt	146.71				

Value Reconciliation			
Selected Approach	Cost Approach		
Improvements	176,979		
Lot Value	96,922		
Indicated Value	273,901	146.71	Per SqFt
Agland Value			
Site Improvements	2,867		
Total Value	276,768	148.24	Total Value Per SqFt

Miscellaneous Improvements								
Code	Description	Sketch ID	Size	Year	Units	Unit Cost	Depr	Value
FPR1	FIREPLACE - RESIDENTIAL 1 STORY	0		1	1	5,615.40		5,615
PATO	SLAB PORCH - OPEN	71008	128		128	11.22		1,436
PRCH	SLAB PORCH - COVERED	71009	7x5		35	26.82		939
BALW	BALCONY - WOOD	71010	8x5		40	28.08		1,123
PATO	SLAB PORCH - OPEN	147529	8x7		56	11.48		643
GRDT	Garage - Detached	171731	50x34		1,700	27.24	66%	15,745
LNT0	Lean To - Attached	171734	18x7		126	9.50		1,197
SOLP	Solar Panels		26		26	315.00		8,190



Rogers

Assessment Property Record Card for Tax Year 2026

Data provided by LISA DELOZIER County Assessor

Date 04/16/2026

Time 22:02:49

Page 3

Sketch Image

660029575

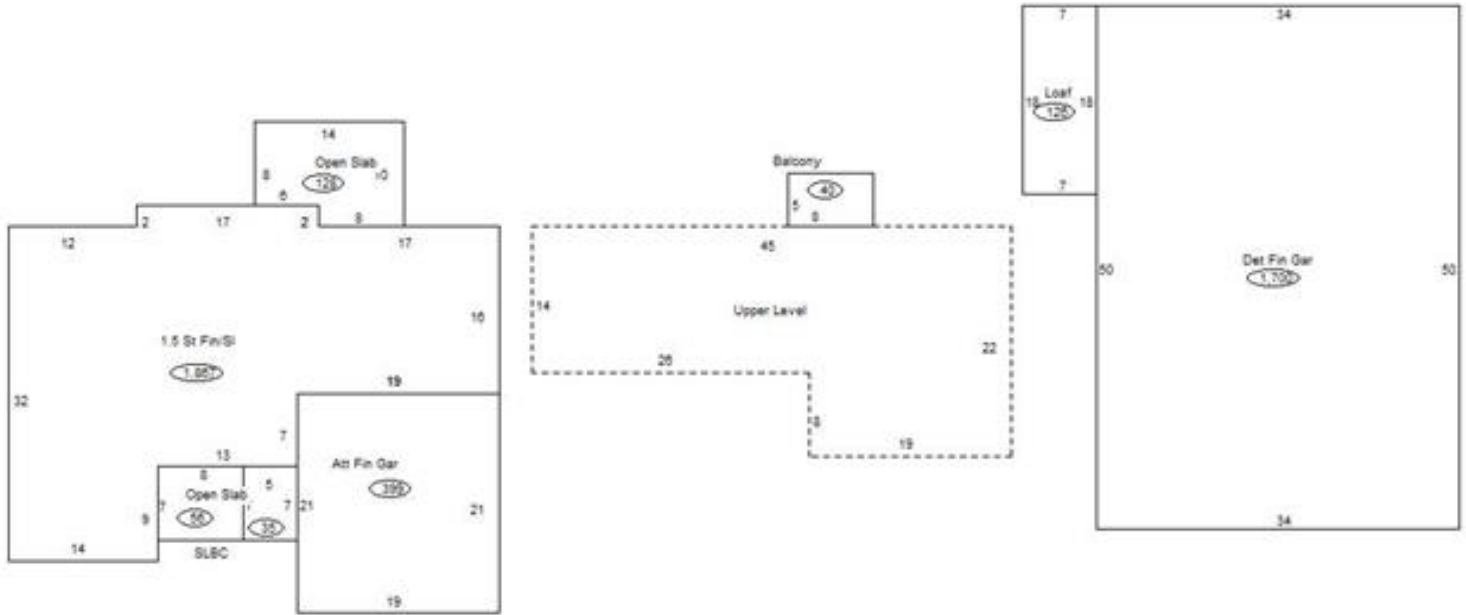

Sketch Vector Information

Sequence	Code	Type	Built Over	Scale	Section Label	Base Area	Multiplier	Total Area
1	R	5	Slab	13	1.5 St Fin/SI	1,085	1.721	1,867
2	G	5		13	Att Fin Gar	399	1.000	399
3	M	PATO		13	Open Slab	128	1.000	128
4	M	PRCH		13	SLBC	35	1.000	35
5	M	BALW		13	Balcony	40	1.000	40
6	U	^UL		13	Upper Level	782	1.000	782
7	M	PATO		13	Open Slab	56	1.000	56
8	G	6		13	Det Fin Gar	1,700	1.000	1,700
9	M	LNT0		13	LNT0	126	1.000	126
Total Building Area						1,085		1,867



Rogers

Assessment Property Record Card for Tax Year 2026

Data provided by LISA DELOZIER County Assessor

Date 04/16/2026
Time 22:02:49
Page 4

660029575

Outbuildings/Site Improvements

Building Image	Code	Description	Dimensions	Floor	Roofing	Total Units
	SHDS	Shed - Small	12x18x8	Plank	Composition Shingle	216
	Qual 4	Cond 3	Year 2009	Eff Age 13		

Valuation Summary	Modifier Total	RCN	Depr (47% Phys/ % Func)	RCNLD
Base Cost (25.04 x 216)	5,409		5,409	2,542
				2,867