



# Rogers

## Assessment Property Record Card for Tax Year 2026

Data provided by LISA DELOZIER County Assessor

Date 04/16/2026  
Time 23:16:14  
Page 1

Assessment Data					Primary Image																																																																																																																				
<b>Account</b> 660029642 <b>Parcel ID</b> 000000-00-0-00633-002-0009 <b>Cadastral ID</b> 34-22-16-04170 <b>Property Type</b> REAL - Real Property <b>Property Class</b> RRP VI Area 1 <b>Tax Area</b> 9 - SEQUOYAH/ NO FIRE <b>Name ID</b> 307345 WILSON, MARCUS R & ROY J WILSON  18105 S QUAIL CREEK RD CLAREMORE OK 74017-0000  <b>Parcel Location</b> <b>Situs</b> 18105 QUAIL CREEK RD <b>Subdivision</b> QUAIL MEADOW <b>Lot/Block</b> 0009 / 0002 <b>Parcel Size</b> 1 - Lots <b>Sec/Twn/Rng</b> 34 / 22 / 16 / 5 <b>Neighborhood</b> 1029 - R-V01-NE SEQUOYAH <b>School District</b> S006 - SEQUOYAH SCHOOLS																																																																																																																									
<b>Legal Description</b> Lot/Long: 36.34896423 -95.58394375										\\tsclient\T\TOMMY DUNLAP\New folder (110)\IMG_0013.JPG 11/16/2022																																																																																																															
<b>Legal Description</b> LOT 9 BLOCK 2 QUAIL MEADOW					<b>Building Permits</b> <table border="1"> <thead> <tr> <th>Number</th> <th>Description</th> <th>Opened</th> <th>Closed</th> <th>Amount</th> </tr> </thead> <tbody> <tr> <td> </td> <td> </td> <td> </td> <td> </td> <td> </td> </tr> </tbody> </table>					Number	Description	Opened	Closed	Amount																																																																																																											
Number	Description	Opened	Closed	Amount																																																																																																																					
<b>Exemptions</b> <table border="1"> <thead> <tr> <th>Code</th> <th>Type</th> <th>Active</th> <th>Maximum</th> <th>Exemption</th> </tr> </thead> <tbody> <tr> <td>H</td> <td>Homestead</td> <td>Yes</td> <td>1,000</td> <td>1,000</td> </tr> </tbody> </table>					Code	Type	Active	Maximum	Exemption	H	Homestead	Yes	1,000	1,000	<b>Sale History</b> <table border="1"> <thead> <tr> <th>Bk/Pg</th> <th>Grantor</th> <th>Date</th> <th>Price</th> <th>Code</th> </tr> </thead> <tbody> <tr> <td>2255/212</td> <td>BULLIS, JAMES M SR &amp;</td> <td>06/27/2012</td> <td>150,000</td> <td>YES</td> </tr> <tr> <td>1614/437</td> <td>ARMSTRONG, GARY JOE &amp;</td> <td>08/19/2004</td> <td>162,500</td> <td>YES</td> </tr> <tr> <td>1534/902</td> <td>STIMSON, TERRANCE J</td> <td>10/20/2003</td> <td>17,000</td> <td>YES</td> </tr> <tr> <td>936/757</td> <td>FLYNN, HUEY I</td> <td>11/15/1993</td> <td>90,000</td> <td>No</td> </tr> </tbody> </table>					Bk/Pg	Grantor	Date	Price	Code	2255/212	BULLIS, JAMES M SR &	06/27/2012	150,000	YES	1614/437	ARMSTRONG, GARY JOE &	08/19/2004	162,500	YES	1534/902	STIMSON, TERRANCE J	10/20/2003	17,000	YES	936/757	FLYNN, HUEY I	11/15/1993	90,000	No																																																																													
Code	Type	Active	Maximum	Exemption																																																																																																																					
H	Homestead	Yes	1,000	1,000																																																																																																																					
Bk/Pg	Grantor	Date	Price	Code																																																																																																																					
2255/212	BULLIS, JAMES M SR &	06/27/2012	150,000	YES																																																																																																																					
1614/437	ARMSTRONG, GARY JOE &	08/19/2004	162,500	YES																																																																																																																					
1534/902	STIMSON, TERRANCE J	10/20/2003	17,000	YES																																																																																																																					
936/757	FLYNN, HUEY I	11/15/1993	90,000	No																																																																																																																					
<b>Parcel Valuation</b> <table border="1"> <thead> <tr> <th>Source</th> <th>REAL</th> <th>Fair Cash</th> <th>Capped</th> <th>Asmnt Level</th> <th>Assessed</th> <th>Levy Rate</th> <th>88.320</th> <th>Current Tax</th> </tr> </thead> <tbody> <tr> <td>Remove Cap</td> <td>2013</td> <td>Land Value 63,516</td> <td>41,576</td> <td>11%</td> <td>4,573</td> <td>Assessed</td> <td>26,595</td> <td>2,348.87</td> </tr> <tr> <td>Year Frozen</td> <td>0</td> <td>Improvements 226,151</td> <td>200,204</td> <td></td> <td>22,022</td> <td>Penalty</td> <td>0</td> <td></td> </tr> <tr> <td>Uncapped Value</td> <td>0</td> <td>Mobile Home 0</td> <td>0</td> <td></td> <td>0</td> <td>Exemption</td> <td>1,000</td> <td>-88.00</td> </tr> <tr> <td>TIF Project ID</td> <td>0</td> <td>Total Value 289,667</td> <td>241,780</td> <td></td> <td>26,595</td> <td>Total Taxable</td> <td>25,595</td> <td>2,261.00</td> </tr> </tbody> </table>										Source	REAL	Fair Cash	Capped	Asmnt Level	Assessed	Levy Rate	88.320	Current Tax	Remove Cap	2013	Land Value 63,516	41,576	11%	4,573	Assessed	26,595	2,348.87	Year Frozen	0	Improvements 226,151	200,204		22,022	Penalty	0		Uncapped Value	0	Mobile Home 0	0		0	Exemption	1,000	-88.00	TIF Project ID	0	Total Value 289,667	241,780		26,595	Total Taxable	25,595	2,261.00																																																																			
Source	REAL	Fair Cash	Capped	Asmnt Level	Assessed	Levy Rate	88.320	Current Tax																																																																																																																	
Remove Cap	2013	Land Value 63,516	41,576	11%	4,573	Assessed	26,595	2,348.87																																																																																																																	
Year Frozen	0	Improvements 226,151	200,204		22,022	Penalty	0																																																																																																																		
Uncapped Value	0	Mobile Home 0	0		0	Exemption	1,000	-88.00																																																																																																																	
TIF Project ID	0	Total Value 289,667	241,780		26,595	Total Taxable	25,595	2,261.00																																																																																																																	
<b>Assessment History</b> <table border="1"> <thead> <tr> <th>Tax Year</th> <th>Statement Number</th> <th>Billed Owner</th> <th>Tax Area</th> <th>Total Value</th> <th>Exemptions</th> <th>Taxable Value</th> <th>Billed Tax</th> </tr> </thead> <tbody> <tr><td>2025</td><td>2025-660029642</td><td>WILSON, MARCUS R &amp;</td><td>9</td><td>285,762</td><td>1000</td><td>24,821</td><td>2,192.00</td></tr> <tr><td>2024</td><td>2024-660029642</td><td>WILSON, MARCUS R &amp;</td><td>9</td><td>296,392</td><td>1000</td><td>24,069</td><td>2,135.00</td></tr> <tr><td>2023</td><td>2023-660029642</td><td>WILSON, MARCUS R &amp;</td><td>9</td><td>246,460</td><td>1000</td><td>23,339</td><td>2,119.00</td></tr> <tr><td>2022</td><td>2022-660029642</td><td>WILSON, MARCUS R &amp;</td><td>9</td><td>236,450</td><td>1000</td><td>22,630</td><td>2,077.00</td></tr> <tr><td>2021</td><td>2021-660029642</td><td>WILSON, MARCUS R &amp;</td><td>9</td><td>208,564</td><td>1000</td><td>21,942</td><td>1,935.00</td></tr> <tr><td>2020</td><td>2020-660029642</td><td>WILSON, MARCUS R &amp;</td><td>9</td><td>207,144</td><td>1000</td><td>21,343</td><td>1,943.00</td></tr> <tr><td>2019</td><td>2019-660029642</td><td>WILSON, MARCUS R &amp;</td><td>9</td><td>197,203</td><td>1000</td><td>20,692</td><td>1,853.00</td></tr> <tr><td>2018</td><td>2018-660029642</td><td>WILSON, MARCUS R &amp;</td><td>9</td><td>201,974</td><td>1000</td><td>21,217</td><td>1,923.00</td></tr> <tr><td>2017</td><td>2017-660029642</td><td>WILSON, MARCUS R &amp;</td><td>9</td><td>200,404</td><td>1000</td><td>21,044</td><td>1,879.00</td></tr> <tr><td>2016</td><td>2016-660029642</td><td>WILSON, MARCUS R &amp;</td><td>9</td><td>195,445</td><td>1000</td><td>20,499</td><td>1,822.00</td></tr> <tr><td>2015</td><td>2015-660029642</td><td>WILSON, MARCUS R &amp;</td><td>9</td><td>189,811</td><td>1000</td><td>19,879</td><td>1,809.00</td></tr> <tr><td>2014</td><td>2014-660029642</td><td>WILSON, MARCUS R &amp;</td><td>9</td><td>192,937</td><td>1000</td><td>19,623</td><td>1,810.00</td></tr> <tr><td>2013</td><td>2013-660029642</td><td>WILSON, MARCUS R &amp;</td><td>9</td><td>182,022</td><td>1000</td><td>19,022</td><td>1,726.00</td></tr> </tbody> </table>										Tax Year	Statement Number	Billed Owner	Tax Area	Total Value	Exemptions	Taxable Value	Billed Tax	2025	2025-660029642	WILSON, MARCUS R &	9	285,762	1000	24,821	2,192.00	2024	2024-660029642	WILSON, MARCUS R &	9	296,392	1000	24,069	2,135.00	2023	2023-660029642	WILSON, MARCUS R &	9	246,460	1000	23,339	2,119.00	2022	2022-660029642	WILSON, MARCUS R &	9	236,450	1000	22,630	2,077.00	2021	2021-660029642	WILSON, MARCUS R &	9	208,564	1000	21,942	1,935.00	2020	2020-660029642	WILSON, MARCUS R &	9	207,144	1000	21,343	1,943.00	2019	2019-660029642	WILSON, MARCUS R &	9	197,203	1000	20,692	1,853.00	2018	2018-660029642	WILSON, MARCUS R &	9	201,974	1000	21,217	1,923.00	2017	2017-660029642	WILSON, MARCUS R &	9	200,404	1000	21,044	1,879.00	2016	2016-660029642	WILSON, MARCUS R &	9	195,445	1000	20,499	1,822.00	2015	2015-660029642	WILSON, MARCUS R &	9	189,811	1000	19,879	1,809.00	2014	2014-660029642	WILSON, MARCUS R &	9	192,937	1000	19,623	1,810.00	2013	2013-660029642	WILSON, MARCUS R &	9	182,022	1000	19,022	1,726.00
Tax Year	Statement Number	Billed Owner	Tax Area	Total Value	Exemptions	Taxable Value	Billed Tax																																																																																																																		
2025	2025-660029642	WILSON, MARCUS R &	9	285,762	1000	24,821	2,192.00																																																																																																																		
2024	2024-660029642	WILSON, MARCUS R &	9	296,392	1000	24,069	2,135.00																																																																																																																		
2023	2023-660029642	WILSON, MARCUS R &	9	246,460	1000	23,339	2,119.00																																																																																																																		
2022	2022-660029642	WILSON, MARCUS R &	9	236,450	1000	22,630	2,077.00																																																																																																																		
2021	2021-660029642	WILSON, MARCUS R &	9	208,564	1000	21,942	1,935.00																																																																																																																		
2020	2020-660029642	WILSON, MARCUS R &	9	207,144	1000	21,343	1,943.00																																																																																																																		
2019	2019-660029642	WILSON, MARCUS R &	9	197,203	1000	20,692	1,853.00																																																																																																																		
2018	2018-660029642	WILSON, MARCUS R &	9	201,974	1000	21,217	1,923.00																																																																																																																		
2017	2017-660029642	WILSON, MARCUS R &	9	200,404	1000	21,044	1,879.00																																																																																																																		
2016	2016-660029642	WILSON, MARCUS R &	9	195,445	1000	20,499	1,822.00																																																																																																																		
2015	2015-660029642	WILSON, MARCUS R &	9	189,811	1000	19,879	1,809.00																																																																																																																		
2014	2014-660029642	WILSON, MARCUS R &	9	192,937	1000	19,623	1,810.00																																																																																																																		
2013	2013-660029642	WILSON, MARCUS R &	9	182,022	1000	19,022	1,726.00																																																																																																																		



# Rogers

## Assessment Property Record Card for Tax Year 2026

Data provided by LISA DELOZIER County Assessor

Date 04/16/2026  
Time 23:16:14  
Page 2

Lot Data		Square-Foot - NBHD 1029 #1		Primary Image
Lot Size				
Lot Count	1			
Units Buildable	5600			
Non-Ag Acres	0.9721			
Topography				
Street Access				
Utilities				
Amenities	LAND QUALITY	0		
		0		
Method	Square-Foot			
Base Lot Value	42,344.00 x 1.50 = 63,516			
Factor Value				
Adjustments	1.0000			
Lot Value	63,516			

Residential Data	
Type	1 Single Family Residence
Condition	3 - Average
Quality	3 - Average
Architecture	
Style	100% One Story
Exterior Wall	90% Veneer, Masonry 10% Frame, Siding, Wood
Base/Total Area	1,902 / 1,902
Style	100% One Story
HVAC	100% Warmed & Cooled Air
Roof Cover	1 Composition Shingle
Area on Slab	1,902
Fixture/RghIn	10 /
Bed/F/H Bath	3 / 2.5 /
Basement Area	
Garage Type	576 Attached Garage - Unfinished 2 Stalls
Remodel	
Year/Eff Age	2004 / 17

Cost Approach		Manual : 01/2025	
Base Cost	107.82	Total Misc Impr	+ 13,384
Roofing Adj	+ 4.75	Garage Cost	+ 17,775
Subfloor Adj	+ -2.25	Total RCN	= 279,199
Heat/Cool Adj	+ 12.64	Depreciation ( 19%)	- 53,048
Plumbing Adj	+ 7.45	Lump Sums	+ 0
Basement Adj	+ 0.00	RCNLD	= 226,151
Adj Base Cost	= 130.41	Lot Value	+ 63,516
Total Area	x 1,902	Indicated Value	= 289,667
Adjusted Cost	= 248,040	Value Per SqFt	152.30

GRM Approach	
GRM Code	
Gross Rent	0.00
Indicated Value	

Multiple Regression	
MRA Code	1 Test
Adusted R	0.8445
Indicated Value	245,164 128.90 Per SqFt

Direct Comparables	
Selection Model	A Adam Test
Adjustment Model	1 2022 Residential
Comparables	6
Indicated Value	264,090 Per SqFt

Value Reconciliation	
Selected Approach	Cost Approach
Improvements	226,151
Lot Value	63,516
Indicated Value	289,667 152.30 Per SqFt
Agland Value	
Site Improvements	
Total Value	289,667 152.30 Total Value Per SqFt

Miscellaneous Improvements								
Code	Description	Sketch ID	Size	Year	Units	Unit Cost	Depr	Value
PRCH	SLAB PORCH - COVERED	71201	18x6		108	26.59		2,872
PRCH	SLAB PORCH - COVERED	71202	41x10		410	25.64		10,512



# Rogers

## Assessment Property Record Card for Tax Year 2026

Data provided by LISA DELOZIER County Assessor

Date 04/16/2026  
 Time 23:16:14  
 Page 3

Sketch Image

660029642

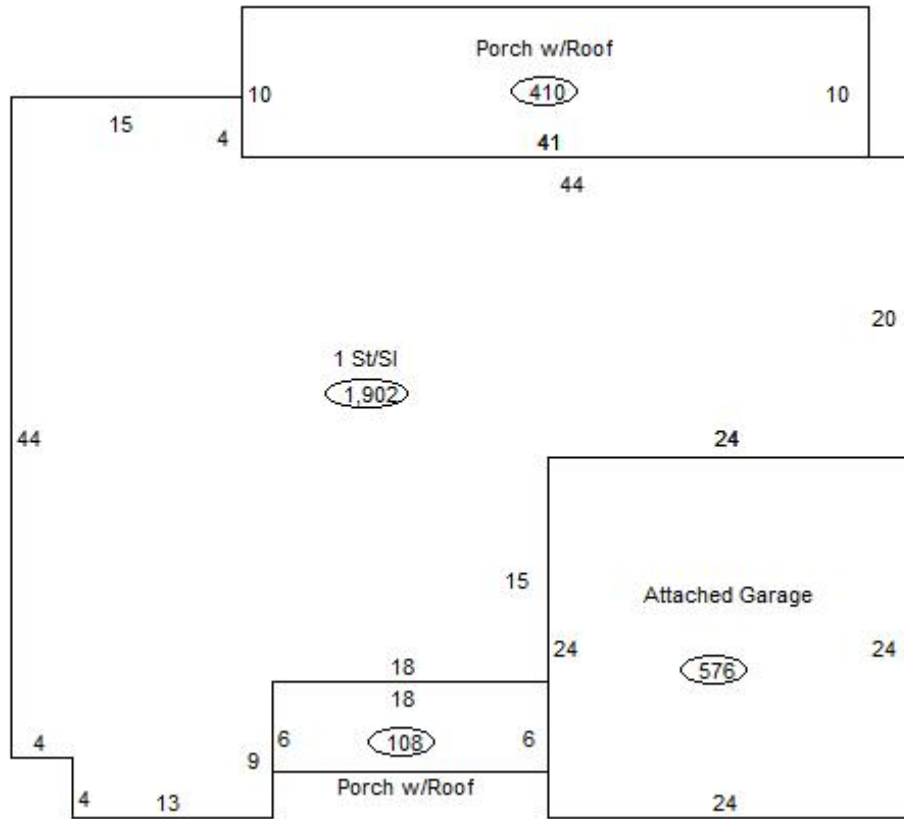

### Sketch Vector Information

Sequence	Code	Type	Built Over	Scale	Section Label	Base Area	Multiplier	Total Area
1	R	1	Slab	13	1 St/Sl	1,902	1.000	1,902
2	G	1		13	Attached Garage	576	1.000	576
3	M	PRCH		13	SLBC	108	1.000	108
4	M	PRCH		13	SLBC	410	1.000	410
<b>Total Building Area</b>						1,902		1,902