



Rogers

Assessment Property Record Card for Tax Year 2026

Data provided by LISA DELOZIER County Assessor

Date 04/16/2026
Time 21:43:57
Page 1

Assessment Data					Primary Image																																																																																																																				
Account 660029777 Parcel ID 23N17E-34-4-00000-000-0000 Cadastral ID 34-23-17-01300 Property Type REAL - Real Property Property Class RA VI Area 2 Tax Area 70 - FOYIL RURAL/FOYIL FIRE Name ID 343247 UNITED TINOCO CONSTRUCTION LLC 731 E KLINDERA AVE TIPTON CA 93274-0000 Parcel Location Situs 19450 E ACORN RD Subdivision Lot/Block / Parcel Size 27.5 - Acres Sec/Twn/Rng 34 / 23 / 17 / 4 Neighborhood 4070 - FOYIL SEQUOYAH AREA School District S007 - FOYIL SCHOOLS																																																																																																																									
Legal Description Lat/Long: 36.42889063 -95.48080400																																																																																																																									
Legal Description NW NW SE & E2 NE SW LESS W 504' N 216' OF NE NE SW.					Building Permits <table border="1"> <thead> <tr> <th>Number</th> <th>Description</th> <th>Opened</th> <th>Closed</th> <th>Amount</th> </tr> </thead> <tbody> <tr> <td>R25</td> <td>NEW RMA</td> <td>09/2025</td> <td></td> <td></td> </tr> </tbody> </table>					Number	Description	Opened	Closed	Amount	R25	NEW RMA	09/2025																																																																																																								
Number	Description	Opened	Closed	Amount																																																																																																																					
R25	NEW RMA	09/2025																																																																																																																							
Exemptions <table border="1"> <thead> <tr> <th>Code</th> <th>Type</th> <th>Active</th> <th>Maximum</th> <th>Exemption</th> </tr> </thead> <tbody> <tr> <td>H</td> <td>Homestead</td> <td>No</td> <td>1,000</td> <td></td> </tr> </tbody> </table>					Code	Type	Active	Maximum	Exemption	H	Homestead	No	1,000		Sale History <table border="1"> <thead> <tr> <th>Bk/Pg</th> <th>Grantor</th> <th>Date</th> <th>Price</th> <th>Code</th> </tr> </thead> <tbody> <tr> <td>/</td> <td>BROOKS, GEORGE G TRUST</td> <td>11/28/2023</td> <td>250,000</td> <td>21</td> </tr> <tr> <td>1079/513</td> <td>BROOKS, GEORGE G & ELSIE S</td> <td>08/29/1997</td> <td>0</td> <td>4</td> </tr> </tbody> </table>					Bk/Pg	Grantor	Date	Price	Code	/	BROOKS, GEORGE G TRUST	11/28/2023	250,000	21	1079/513	BROOKS, GEORGE G & ELSIE S	08/29/1997	0	4																																																																																							
Code	Type	Active	Maximum	Exemption																																																																																																																					
H	Homestead	No	1,000																																																																																																																						
Bk/Pg	Grantor	Date	Price	Code																																																																																																																					
/	BROOKS, GEORGE G TRUST	11/28/2023	250,000	21																																																																																																																					
1079/513	BROOKS, GEORGE G & ELSIE S	08/29/1997	0	4																																																																																																																					
Parcel Valuation <table border="1"> <thead> <tr> <th>Source</th> <th>REAL</th> <th>Fair Cash</th> <th>Capped</th> <th>Asmnt Level</th> <th>Assessed</th> <th>Levy Rate</th> <th>101.660</th> <th>Current Tax</th> </tr> </thead> <tbody> <tr> <td>Remove Cap</td> <td>2024</td> <td>Land Value 1,557</td> <td>1,557</td> <td>11%</td> <td>171</td> <td>Assessed</td> <td>17,811</td> <td>1,810.67</td> </tr> <tr> <td>Year Frozen</td> <td>2019</td> <td>Improvements 160,365</td> <td>160,365</td> <td></td> <td>17,640</td> <td>Penalty</td> <td>0</td> <td></td> </tr> <tr> <td>Uncapped Value</td> <td>0</td> <td>Mobile Home 0</td> <td>0</td> <td></td> <td>0</td> <td>Exemption</td> <td>0</td> <td>0.00</td> </tr> <tr> <td>TIF Project ID</td> <td>0</td> <td>Total Value 161,922</td> <td>161,922</td> <td></td> <td>17,811</td> <td>Total Taxable</td> <td>17,811</td> <td>1,811.00</td> </tr> </tbody> </table>										Source	REAL	Fair Cash	Capped	Asmnt Level	Assessed	Levy Rate	101.660	Current Tax	Remove Cap	2024	Land Value 1,557	1,557	11%	171	Assessed	17,811	1,810.67	Year Frozen	2019	Improvements 160,365	160,365		17,640	Penalty	0		Uncapped Value	0	Mobile Home 0	0		0	Exemption	0	0.00	TIF Project ID	0	Total Value 161,922	161,922		17,811	Total Taxable	17,811	1,811.00																																																																			
Source	REAL	Fair Cash	Capped	Asmnt Level	Assessed	Levy Rate	101.660	Current Tax																																																																																																																	
Remove Cap	2024	Land Value 1,557	1,557	11%	171	Assessed	17,811	1,810.67																																																																																																																	
Year Frozen	2019	Improvements 160,365	160,365		17,640	Penalty	0																																																																																																																		
Uncapped Value	0	Mobile Home 0	0		0	Exemption	0	0.00																																																																																																																	
TIF Project ID	0	Total Value 161,922	161,922		17,811	Total Taxable	17,811	1,811.00																																																																																																																	
Assessment History <table border="1"> <thead> <tr> <th>Tax Year</th> <th>Statement Number</th> <th>Billed Owner</th> <th>Tax Area</th> <th>Total Value</th> <th>Exemptions</th> <th>Taxable Value</th> <th>Billed Tax</th> </tr> </thead> <tbody> <tr><td>2025</td><td>2025-660029777</td><td>UNITED TINOCO CONSTRUCTION LLC</td><td>70</td><td>157,574</td><td>0</td><td>17,333</td><td>1,762.00</td></tr> <tr><td>2024</td><td>2024-660029777</td><td>UNITED TINOCO CONSTRUCTION LLC</td><td>70</td><td>164,607</td><td>0</td><td>18,106</td><td>1,888.00</td></tr> <tr><td>2023</td><td>2023-660029777</td><td>BROOKS, GEORGE G TRUST</td><td>70</td><td>135,956</td><td>1000</td><td>13,955</td><td>1,469.00</td></tr> <tr><td>2022</td><td>2022-660029777</td><td>BROOKS, GEORGE G TRUST</td><td>70</td><td>135,378</td><td>1000</td><td>13,891</td><td>1,468.00</td></tr> <tr><td>2021</td><td>2021-660029777</td><td>BROOKS, GEORGE G TRUST</td><td>70</td><td>147,707</td><td>1000</td><td>15,248</td><td>1,569.00</td></tr> <tr><td>2020</td><td>2020-660029777</td><td>BROOKS, GEORGE G TRUST</td><td>70</td><td>163,084</td><td>1000</td><td>16,290</td><td>1,741.00</td></tr> <tr><td>2019</td><td>2019-660029777</td><td>BROOKS, GEORGE G TRUST</td><td>70</td><td>157,181</td><td>1000</td><td>16,290</td><td>1,746.00</td></tr> <tr><td>2018</td><td>2018-660029777</td><td>BROOKS, GEORGE G TRUST</td><td>70</td><td>162,918</td><td>1000</td><td>16,921</td><td>1,781.00</td></tr> <tr><td>2017</td><td>2017-660029777</td><td>BROOKS, GEORGE G TRUST</td><td>70</td><td>161,407</td><td>1000</td><td>16,626</td><td>1,754.00</td></tr> <tr><td>2016</td><td>2016-660029777</td><td>BROOKS, GEORGE G TRUST</td><td>70</td><td>156,580</td><td>1000</td><td>16,112</td><td>1,760.00</td></tr> <tr><td>2015</td><td>2015-660029777</td><td>BROOKS, GEORGE G TRUST</td><td>70</td><td>151,038</td><td>1000</td><td>15,614</td><td>1,691.00</td></tr> <tr><td>2014</td><td>2014-660029777</td><td>BROOKS, GEORGE G TRUST</td><td>70</td><td>150,634</td><td>1000</td><td>15,569</td><td>1,662.00</td></tr> <tr><td>2013</td><td>2013-660029777</td><td>BROOKS, GEORGE G TRUST</td><td>70</td><td>289,736</td><td>0</td><td>31,871</td><td>3,292.00</td></tr> </tbody> </table>										Tax Year	Statement Number	Billed Owner	Tax Area	Total Value	Exemptions	Taxable Value	Billed Tax	2025	2025-660029777	UNITED TINOCO CONSTRUCTION LLC	70	157,574	0	17,333	1,762.00	2024	2024-660029777	UNITED TINOCO CONSTRUCTION LLC	70	164,607	0	18,106	1,888.00	2023	2023-660029777	BROOKS, GEORGE G TRUST	70	135,956	1000	13,955	1,469.00	2022	2022-660029777	BROOKS, GEORGE G TRUST	70	135,378	1000	13,891	1,468.00	2021	2021-660029777	BROOKS, GEORGE G TRUST	70	147,707	1000	15,248	1,569.00	2020	2020-660029777	BROOKS, GEORGE G TRUST	70	163,084	1000	16,290	1,741.00	2019	2019-660029777	BROOKS, GEORGE G TRUST	70	157,181	1000	16,290	1,746.00	2018	2018-660029777	BROOKS, GEORGE G TRUST	70	162,918	1000	16,921	1,781.00	2017	2017-660029777	BROOKS, GEORGE G TRUST	70	161,407	1000	16,626	1,754.00	2016	2016-660029777	BROOKS, GEORGE G TRUST	70	156,580	1000	16,112	1,760.00	2015	2015-660029777	BROOKS, GEORGE G TRUST	70	151,038	1000	15,614	1,691.00	2014	2014-660029777	BROOKS, GEORGE G TRUST	70	150,634	1000	15,569	1,662.00	2013	2013-660029777	BROOKS, GEORGE G TRUST	70	289,736	0	31,871	3,292.00
Tax Year	Statement Number	Billed Owner	Tax Area	Total Value	Exemptions	Taxable Value	Billed Tax																																																																																																																		
2025	2025-660029777	UNITED TINOCO CONSTRUCTION LLC	70	157,574	0	17,333	1,762.00																																																																																																																		
2024	2024-660029777	UNITED TINOCO CONSTRUCTION LLC	70	164,607	0	18,106	1,888.00																																																																																																																		
2023	2023-660029777	BROOKS, GEORGE G TRUST	70	135,956	1000	13,955	1,469.00																																																																																																																		
2022	2022-660029777	BROOKS, GEORGE G TRUST	70	135,378	1000	13,891	1,468.00																																																																																																																		
2021	2021-660029777	BROOKS, GEORGE G TRUST	70	147,707	1000	15,248	1,569.00																																																																																																																		
2020	2020-660029777	BROOKS, GEORGE G TRUST	70	163,084	1000	16,290	1,741.00																																																																																																																		
2019	2019-660029777	BROOKS, GEORGE G TRUST	70	157,181	1000	16,290	1,746.00																																																																																																																		
2018	2018-660029777	BROOKS, GEORGE G TRUST	70	162,918	1000	16,921	1,781.00																																																																																																																		
2017	2017-660029777	BROOKS, GEORGE G TRUST	70	161,407	1000	16,626	1,754.00																																																																																																																		
2016	2016-660029777	BROOKS, GEORGE G TRUST	70	156,580	1000	16,112	1,760.00																																																																																																																		
2015	2015-660029777	BROOKS, GEORGE G TRUST	70	151,038	1000	15,614	1,691.00																																																																																																																		
2014	2014-660029777	BROOKS, GEORGE G TRUST	70	150,634	1000	15,569	1,662.00																																																																																																																		
2013	2013-660029777	BROOKS, GEORGE G TRUST	70	289,736	0	31,871	3,292.00																																																																																																																		



Rogers

Assessment Property Record Card for Tax Year 2026

Data provided by LISA DELOZIER County Assessor

Date 04/16/2026
Time 21:43:57
Page 3

Units Buildable - FOYIL SEQUOYAH AREA (UNITS BUILDABLE)	
Lot Size	
Lot Count	
Units Buildable	
Non-Ag Acres	0
Topography	
Street Access	
Utilities	
Amenities	LAND QUALITY
Method	Units-Buildable
Base Lot Value	
Factor Value	
Adjustments	
Lot Value	



Residential Data	
Type	1 Single Family Residence
Condition	2 - Fair
Quality	3 - Average
Architecture	TRAD TRADITIONAL
Style	100% 1 1/2 Story Finished
Exterior Wall	80% Veneer, Masonry 20% Frame, Siding, Wood
Base/Total Area	2,176 / 2,581
Style	100% 1 1/2 Story Finished
HVAC	100% Warmed & Cooled Air
Roof Cover	1 Composition Shingle
Area on Slab	2,176
Fixture/RghIn	14 /
Bed/F/H Bath	2 / 2.0 / 1.0
Basement Area	
Garage Type	572 Attached Garage - Finished
Remodel	
Year/Eff Age	1980 / 46

GRM Approach	
GRM Code	
Gross Rent	0.00
Indicated Value	

Multiple Regression			
MRA Code	1	Test	
Adusted R	0.8445		
Indicated Value	278,290	107.82	Per SqFt

Direct Comparables	
Selection Model	1 Res
Adjustment Model	A2 AO Test
Comparables	
Indicated Value	

Cost Approach		Manual : 01/2025	
Base Cost	87.08	Total Misc Impr	+ 2,192
Roofing Adj	+ 3.65	Garage Cost	+ 22,165
Subfloor Adj	+ -1.83	Total RCN	= 305,970
Heat/Cool Adj	+ 12.64	Depreciation (51%)	- 156,045
Plumbing Adj	+ 7.57	Lump Sums	+ 0
Basement Adj	+ 0.00	RCNLD	= 149,925
Adj Base Cost	= 109.11	Lot Value	+ 149,925
Total Area	x 2,581	Indicated Value	= 149,925
Adjusted Cost	= 281,613	Value Per SqFt	58.09

Value Reconciliation			
Selected Approach	Cost Approach		
Improvements	149,925		
Lot Value			
Indicated Value	149,925	58.09	Per SqFt
Agland Value			
Site Improvements	10,440		
Total Value	160,365	62.13	Total Value Per SqFt

Miscellaneous Improvements								
Code	Description	Sketch ID	Size	Year	Units	Unit Cost	Depr	Value
PATO	SLAB PORCH - OPEN	71376	11x11		121	11.28		1,365
PATO	SLAB PORCH - OPEN	71377	12x6		72	11.48		827



Rogers

Assessment Property Record Card for Tax Year 2026

Data provided by LISA DELOZIER County Assessor

Date 04/16/2026
 Time 21:43:57
 Page 4

Sketch Image

660029777

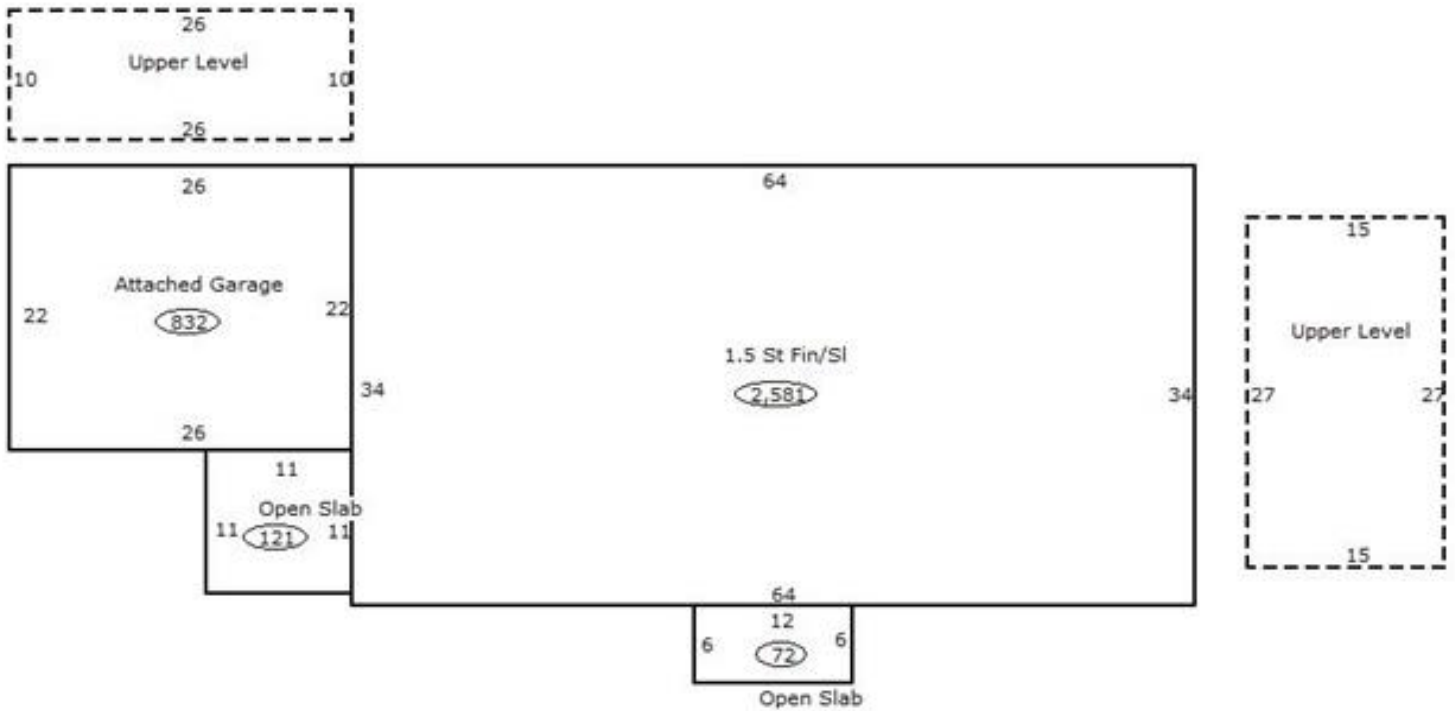

Sketch Vector Information

Sequence	Code	Type	Built Over	Scale	Section Label	Base Area	Multiplier	Total Area
1	R	5	Slab	13	1.5 St Fin/SI	2,176	1.186	2,581
2	G	1		13	Attached Garage	572	1.000	572
3	M	PATO		13	Open Slab	121	1.000	121
4	M	PATO		13	Open Slab	72	1.000	72
5	U	^UL		13	Upper Level	405	1.000	405
6	U	^UL		13	Upper Level	260	1.000	260
Total Building Area						2,176		2,581



Rogers

Assessment Property Record Card for Tax Year 2026

Data provided by LISA DELOZIER County Assessor

Date 04/16/2026
Time 21:43:57
Page 5

660029777

Outbuildings/Site Improvements

Building Image	Code	Description	Dimensions	Floor	Roofing	Total Units
	UTIL	SHOP BUILDING	20x36x14	Concrete	Formed Metal	720
	Qual 3	Cond 2.5	Year 2000	Eff Age 23		
		Valuation Summary	Modifier Total	RCN	Depr (52% Phys/ % Func)	RCNLD
		Base Cost (30.21 x 720)	21,751	21,751	11,311	10,440



Rogers

Assessment Property Record Card for Tax Year 2026

Data provided by LISA DELOZIER County Assessor

Date 04/16/2026
Time 21:43:57
Page 6

Agland Inventory

660029777

Soi	Description	Land Use	LPI	Adj Type	Adj Code	Acres	Use/Acre	Mkt/Acre	Use Value	Market Value
HC	HECTOR STONY SANDY LOAM	TMBR	20			14.000	36	36	504	504
HLC	HECTOR-LINKER FINE SANDY	TMBR	35			6.500	63	63	410	410
LKC	LINKER FINE SANDY LOAM 3-	TMBR	51			7.000	92	92	643	643
TMBR Totals						27.500			1,557	1,557
Total Agland						27.500			1,557	1,557