



Rogers

Assessment Property Record Card for Tax Year 2026

Data provided by LISA DELOZIER County Assessor

Date 04/16/2026
Time 23:32:37
Page 1

Assessment Data					Primary Image																																																	
Account 660029785 Parcel ID 23N17E-34-4-00000-000-0000 Cadastral ID 34-23-17-02000 Property Type REAL - Real Property Property Class RR VI Area 2 Tax Area 70 - FOYIL RURAL/FOYIL FIRE Name ID 282573 PARKER, MICHAEL E & CHRISTINE R 12790 S 4230 RD CHELSEA OK 74016-0000 Parcel Location Situs 12790 S 4230 RD Subdivision Lot/Block / Parcel Size 10 - Acres Sec/Twn/Rng 34 / 23 / 17 / 4 Neighborhood 4070 - FOYIL SEQUOYAH AREA School District S007 - FOYIL SCHOOLS					<p>\\tsclient\C\Users\Randy Necessary\Pictures\2020-12-07\IMG_009 12/15/2020</p>																																																	
Legal Description Lat/Long: 36.42596145 -95.47261661																																																						
NE SE SE					Building Permits <table border="1"> <thead> <tr> <th>Number</th> <th>Description</th> <th>Opened</th> <th>Closed</th> <th>Amount</th> </tr> </thead> <tbody> <tr> <td> </td> <td> </td> <td> </td> <td> </td> <td> </td> </tr> </tbody> </table>					Number	Description	Opened	Closed	Amount																																								
Number	Description	Opened	Closed	Amount																																																		
Exemptions					Sale History																																																	
Code	Type	Active	Maximum	Exemption	Bk/Pg	Grantor	Date	Price	Code																																													
H	Homestead	No	1,000		1477/760	WILLHOITE, GUY EDWARD &	05/09/2003	130,000	YES																																													
					1031/221	SCOTT, WILBURN &	07/05/1996	54,500	Yes																																													
					845/863			26,000	No																																													
Parcel Valuation					<table border="1"> <thead> <tr> <th>Source</th> <th>REAL</th> <th>Fair Cash</th> <th>Capped</th> <th>Asmnt Level</th> <th>Assessed</th> <th>Levy Rate</th> <th>101.660</th> <th>Current Tax</th> </tr> </thead> <tbody> <tr> <td>Remove Cap</td> <td>2005</td> <td>Land Value 130,381</td> <td>81,148</td> <td>11%</td> <td>8,926</td> <td>Assessed</td> <td>19,794</td> <td>2,012.26</td> </tr> <tr> <td>Year Frozen</td> <td>0</td> <td>Improvements 98,802</td> <td>98,802</td> <td> </td> <td>10,868</td> <td>Penalty</td> <td>0</td> <td> </td> </tr> <tr> <td>Uncapped Value</td> <td>0</td> <td>Mobile Home 0</td> <td>0</td> <td> </td> <td>0</td> <td>Exemption</td> <td>0</td> <td>0.00</td> </tr> <tr> <td>TIF Project ID</td> <td>0</td> <td>Total Value 229,183</td> <td>179,950</td> <td> </td> <td>19,794</td> <td>Total Taxable</td> <td>19,794</td> <td>2,012.00</td> </tr> </tbody> </table>					Source	REAL	Fair Cash	Capped	Asmnt Level	Assessed	Levy Rate	101.660	Current Tax	Remove Cap	2005	Land Value 130,381	81,148	11%	8,926	Assessed	19,794	2,012.26	Year Frozen	0	Improvements 98,802	98,802		10,868	Penalty	0		Uncapped Value	0	Mobile Home 0	0		0	Exemption	0	0.00	TIF Project ID	0	Total Value 229,183	179,950		19,794	Total Taxable	19,794	2,012.00
Source	REAL	Fair Cash	Capped	Asmnt Level	Assessed	Levy Rate	101.660	Current Tax																																														
Remove Cap	2005	Land Value 130,381	81,148	11%	8,926	Assessed	19,794	2,012.26																																														
Year Frozen	0	Improvements 98,802	98,802		10,868	Penalty	0																																															
Uncapped Value	0	Mobile Home 0	0		0	Exemption	0	0.00																																														
TIF Project ID	0	Total Value 229,183	179,950		19,794	Total Taxable	19,794	2,012.00																																														
Assessment History																																																						
Tax Year	Statement Number	Billed Owner	Tax Area	Total Value	Exemptions	Taxable Value	Billed Tax																																															
2025	2025-660029785	PARKER, MICHAEL E &	70	238,460	0	18,852	1,917.00																																															
2024	2024-660029785	PARKER, MICHAEL E &	70	246,834	0	17,955	1,872.00																																															
2023	2023-660029785	PARKER, MICHAEL E &	70	159,489	0	17,100	1,783.00																																															
2022	2022-660029785	PARKER, MICHAEL E &	70	148,046	0	16,285	1,704.00																																															
2021	2021-660029785	PARKER, MICHAEL E &	70	153,012	0	16,831	1,715.00																																															
2020	2020-660029785	PARKER, MICHAEL E &	70	145,812	0	16,040	1,699.00																																															
2019	2019-660029785	PARKER, MICHAEL E &	70	140,179	0	15,420	1,638.00																																															
2018	2018-660029785	PARKER, MICHAEL E &	70	146,414	0	16,105	1,679.00																																															
2017	2017-660029785	PARKER, MICHAEL E &	70	145,307	0	15,984	1,671.00																																															
2016	2016-660029785	PARKER, MICHAEL E &	70	142,263	0	15,649	1,694.00																																															
2015	2015-660029785	PARKER, MICHAEL E &	70	138,984	0	15,288	1,640.00																																															
2014	2014-660029785	PARKER, MICHAEL E &	70	138,848	0	14,637	1,546.00																																															
2013	2013-660029785	PARKER, MICHAEL E &	70	133,130	1000	12,940	1,353.00																																															



Rogers

Assessment Property Record Card for Tax Year 2026

Data provided by LISA DELOZIER County Assessor

Date 04/16/2026
Time 23:32:37
Page 2

Lot Data	Square-Foot - NBHD 4070 #1	Primary Image
Lot Size		
Lot Count		
Units Buildable	10	
Non-Ag Acres	0	
Topography		
Street Access		
Utilities		
Amenities	LAND QUALITY	
	0	
	0	
Method	Square-Foot	
Base Lot Value	434,404.00 x .30 = 130,381	
Factor Value		
Adjustments	1.0000	
Lot Value	130,381	

Residential Data	
Type	1 Single Family Residence
Condition	3 - Average
Quality	2.5 - Fair
Architecture	TRAD TRADITIONAL
Style	100% One Story
Exterior Wall	60% Veneer, Masonry 40% Frame, Siding, Vinyl
Base/Total Area	1,617 / 1,617
Style	100% One Story
HVAC	100% Warmed & Cooled Air
Roof Cover	1 Composition Shingle
Area on Slab	1,617
Fixture/RghIn	7 /
Bed/F/H Bath	3 / 1.0 / 1.0
Basement Area	
Garage Type	
Remodel	RMA -
Year/Eff Age	1962 / 45

GRM Approach	
GRM Code	
Gross Rent	0.00
Indicated Value	

Multiple Regression			
MRA Code	1	Test	
Adjusted R	0.8445		
Indicated Value	111,512	68.96	Per SqFt

Direct Comparables	
Selection Model	1 Res
Adjustment Model	A2 AO Test
Comparables	
Indicated Value	

Cost Approach				Manual : 01/2025	
Base Cost	101.55	Total Misc Impr	+	677	
Roofing Adj	+ 4.45	Garage Cost	+		
Subfloor Adj	+ -1.15	Total RCN	=	197,983	
Heat/Cool Adj	+ 11.47	Depreciation (52%)	-	102,951	
Plumbing Adj	+ 5.70	Lump Sums	+	2,503	
Basement Adj	+ 0.00	RCNLD	=	97,535	
Adj Base Cost	= 122.02	Lot Value	+	130,381	
Total Area	x 1,617	Indicated Value	=	227,916	
Adjusted Cost	= 197,306	Value Per SqFt		140.95	

Value Reconciliation			
Selected Approach	Cost Approach		
Improvements	97,535		
Lot Value	130,381		
Indicated Value	227,916	140.95	Per SqFt
Agland Value			
Site Improvements	1,267		
Total Value	229,183	141.73	Total Value Per SqFt

Miscellaneous Improvements								
Code	Description	Sketch ID	Size	Year	Units	Unit Cost	Depr	Value
SHLT	STORM SHELTER	0		1	2013	1	0.00	
PRCH	SLAB PORCH - COVERED	71395		28		28	24.18	677
WODO	WOOD DECK - OPEN	71396	20x8			160	22.76	75% 910
WODC	WOOD DECK - COVERED	148071	20x8			160	39.82	75% 1,593



Rogers
Assessment Property Record Card for Tax Year 2026
 Data provided by LISA DELOZIER County Assessor

Date 04/16/2026
 Time 23:32:37
 Page 3

Sketch Image

660029785

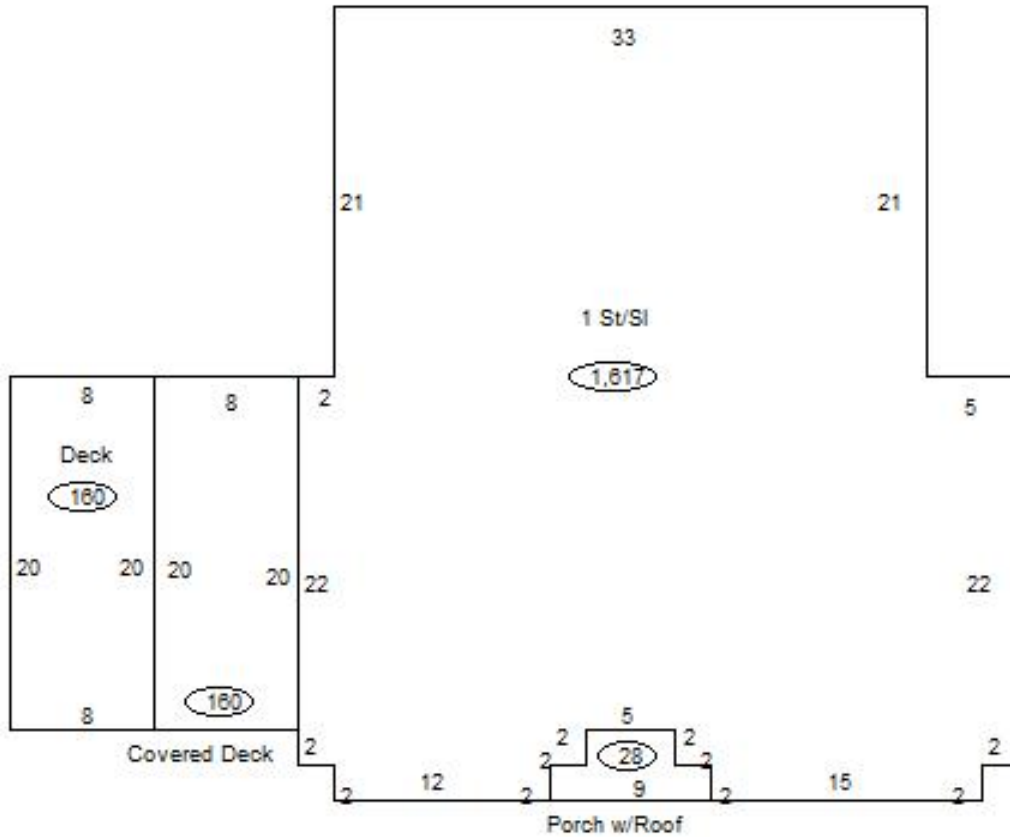

Sketch Vector Information

Sequence	Code	Type	Built Over	Scale	Section Label	Base Area	Multiplier	Total Area
1	R	1	Slab	13	1 St/Sl	1,617	1.000	1,617
2	M	PRCH		13	SLBC	28	1.000	28
3	M	WODO		13	WODO	160	1.000	160
4	M	WODC		13	WODC	160	1.000	160
Total Building Area						1,617		1,617



Rogers



Assessment Property Record Card for Tax Year 2026

Data provided by LISA DELOZIER County Assessor

Date 04/16/2026
 Time 23:32:37
 Page 4

660029785

Outbuildings/Site Improvements

Building Image	Code	Description	Dimensions	Floor	Roofing	Total Units
	LOAF	LOAFING SHED	8x16x8	Dirt	Galvanized Metal	128
	Qual 2	Cond 2	Year 2008	Eff Age 18		
Valuation Summary		Modifier Total	RCN	Depr (56% Phys/ % Func)		RCNLD
Base Cost (5.68 x 128)		727		727	407	320
	LOAF	LOAFING SHED	12x20x8	Concrete	Formed Metal	240
	Qual 2	Cond 2	Year 2000	Eff Age 26		
Valuation Summary		Modifier Total	RCN	Depr (70% Phys/ % Func)		RCNLD
Base Cost (9.76 x 240)		2,342		2,342	1,639	703
	SHDS	Shed - Small	6x6x8	Concrete	Composition Shingle	36
	Qual 2	Cond 3	Year 1962	Eff Age 48		
Valuation Summary		Modifier Total	RCN	Depr (80% Phys/ % Func)		RCNLD
Base Cost (33.83 x 36)		1,218		1,218	974	244