



# Rogers

## Assessment Property Record Card for Tax Year 2026

Data provided by LISA DELOZIER County Assessor

Date 04/16/2026  
Time 22:31:51  
Page 1

Assessment Data					Primary Image																																																																																																																				
<b>Account</b> 660029944 <b>Parcel ID</b> 000000-00-0-00375-002-0001 <b>Cadastral ID</b> 35-20-14-04220 <b>Property Type</b> REAL - Real Property <b>Property Class</b> URP VI Area 3 <b>Tax Area</b> 1 - CATOOSA OT <b>Name ID</b> 334920 TEEPEE INVESTMENTS LLC  PO BOX 1222 CATOOSA OK 74015-0000  <b>Parcel Location</b>  <b>Situs</b> <b>Subdivision</b> HIGHLAND ACRES <b>Lot/Block</b> 0001 / 0002 <b>Parcel Size</b> 1 - Lots <b>Sec/Twn/Rng</b> 35 / 20 / 14 / 5 <b>Neighborhood</b> 1045 - R-V03-SW CATOOSA <b>School District</b> S002 - CATOOSA SCHOOLS					<p>\\tsclient\T\LOGAN\LOGAN RESIDENTIAL VI\2021-5-24\IMG_000: 5/25/2021</p>																																																																																																																				
<b>Legal Description</b> Lot/Long: 36.17684469 -95.79108656																																																																																																																									
<b>Building Permits</b>					<table border="1"> <thead> <tr> <th>Number</th> <th>Description</th> <th>Opened</th> <th>Closed</th> <th>Amount</th> </tr> </thead> <tbody> <tr> <td colspan="5"> </td> </tr> </tbody> </table>					Number	Description	Opened	Closed	Amount																																																																																																											
Number	Description	Opened	Closed	Amount																																																																																																																					
<b>Exemptions</b>					<b>Sale History</b>																																																																																																																				
<table border="1"> <thead> <tr> <th>Code</th> <th>Type</th> <th>Active</th> <th>Maximum</th> <th>Exemption</th> </tr> </thead> <tbody> <tr> <td colspan="5"> </td> </tr> </tbody> </table>					Code	Type	Active	Maximum	Exemption						<table border="1"> <thead> <tr> <th>Bk/Pg</th> <th>Grantor</th> <th>Date</th> <th>Price</th> <th>Code</th> </tr> </thead> <tbody> <tr> <td>/</td> <td>FULTZ, GARY T</td> <td>06/25/2021</td> <td>150,000</td> <td>WG</td> </tr> </tbody> </table>					Bk/Pg	Grantor	Date	Price	Code	/	FULTZ, GARY T	06/25/2021	150,000	WG																																																																																												
Code	Type	Active	Maximum	Exemption																																																																																																																					
Bk/Pg	Grantor	Date	Price	Code																																																																																																																					
/	FULTZ, GARY T	06/25/2021	150,000	WG																																																																																																																					
<b>Parcel Valuation</b>																																																																																																																									
<table border="1"> <thead> <tr> <th>Source</th> <th>REAL</th> <th>Fair Cash</th> <th>Capped</th> <th>Asmnt Level</th> <th>Assessed</th> <th>Levy Rate</th> <th>106.660</th> <th>Current Tax</th> </tr> </thead> <tbody> <tr> <td>Remove Cap</td> <td>2022</td> <td>Land Value 34,533</td> <td>15,258</td> <td>11%</td> <td>1,678</td> <td>Assessed 5,187</td> <td></td> <td>553.25</td> </tr> <tr> <td>Year Frozen</td> <td>0</td> <td>Improvements 39,596</td> <td>31,902</td> <td></td> <td>3,509</td> <td>Penalty 0</td> <td></td> <td></td> </tr> <tr> <td>Uncapped Value</td> <td>0</td> <td>Mobile Home 0</td> <td>0</td> <td></td> <td>0</td> <td>Exemption 0</td> <td></td> <td>0.00</td> </tr> <tr> <td>TIF Project ID</td> <td>0</td> <td>Total Value 74,129</td> <td>47,160</td> <td></td> <td>5,187</td> <td>Total Taxable 5,187</td> <td></td> <td>553.00</td> </tr> </tbody> </table>		Source	REAL	Fair Cash	Capped	Asmnt Level	Assessed	Levy Rate	106.660	Current Tax	Remove Cap	2022	Land Value 34,533	15,258	11%	1,678	Assessed 5,187		553.25	Year Frozen	0	Improvements 39,596	31,902		3,509	Penalty 0			Uncapped Value	0	Mobile Home 0	0		0	Exemption 0		0.00	TIF Project ID	0	Total Value 74,129	47,160		5,187	Total Taxable 5,187		553.00																																																																											
Source	REAL	Fair Cash	Capped	Asmnt Level	Assessed	Levy Rate	106.660	Current Tax																																																																																																																	
Remove Cap	2022	Land Value 34,533	15,258	11%	1,678	Assessed 5,187		553.25																																																																																																																	
Year Frozen	0	Improvements 39,596	31,902		3,509	Penalty 0																																																																																																																			
Uncapped Value	0	Mobile Home 0	0		0	Exemption 0		0.00																																																																																																																	
TIF Project ID	0	Total Value 74,129	47,160		5,187	Total Taxable 5,187		553.00																																																																																																																	
<b>Assessment History</b>																																																																																																																									
<table border="1"> <thead> <tr> <th>Tax Year</th> <th>Statement Number</th> <th>Billed Owner</th> <th>Tax Area</th> <th>Total Value</th> <th>Exemptions</th> <th>Taxable Value</th> <th>Billed Tax</th> </tr> </thead> <tbody> <tr><td>2025</td><td>2025-660029944</td><td>TEEPEE INVESTMENTS LLC</td><td>1</td><td>70,515</td><td>0</td><td>4,940</td><td>527.00</td></tr> <tr><td>2024</td><td>2024-660029944</td><td>TEEPEE INVESTMENTS LLC</td><td>1</td><td>73,246</td><td>0</td><td>4,705</td><td>496.00</td></tr> <tr><td>2023</td><td>2023-660029944</td><td>TEEPEE INVESTMENTS LLC</td><td>1</td><td>53,285</td><td>0</td><td>4,481</td><td>460.00</td></tr> <tr><td>2022</td><td>2022-660029944</td><td>TEEPEE INVESTMENTS LLC</td><td>1</td><td>38,800</td><td>0</td><td>4,268</td><td>428.00</td></tr> <tr><td>2021</td><td>2021-660029944</td><td>TEEPEE INVESTMENTS LLC</td><td>1</td><td>38,252</td><td>0</td><td>3,886</td><td>342.00</td></tr> <tr><td>2020</td><td>2020-660029944</td><td>FULTZ, GARY T</td><td>1</td><td>37,719</td><td>0</td><td>3,701</td><td>328.00</td></tr> <tr><td>2019</td><td>2019-660029944</td><td>FULTZ, GARY T</td><td>1</td><td>36,871</td><td>0</td><td>3,525</td><td>317.00</td></tr> <tr><td>2018</td><td>2018-660029944</td><td>FULTZ, GARY T</td><td>1</td><td>36,110</td><td>0</td><td>3,357</td><td>300.00</td></tr> <tr><td>2017</td><td>2017-660029944</td><td>FULTZ, GARY T</td><td>1</td><td>35,834</td><td>0</td><td>3,197</td><td>289.00</td></tr> <tr><td>2016</td><td>2016-660029944</td><td>FULTZ, GARY T</td><td>1</td><td>34,976</td><td>0</td><td>3,045</td><td>271.00</td></tr> <tr><td>2015</td><td>2015-660029944</td><td>FULTZ, GARY T</td><td>1</td><td>32,581</td><td>0</td><td>2,900</td><td>259.00</td></tr> <tr><td>2014</td><td>2014-660029944</td><td>FULTZ, GARY T</td><td>1</td><td>32,845</td><td>0</td><td>2,761</td><td>250.00</td></tr> <tr><td>2013</td><td>2013-660029944</td><td>FULTZ, GARY T</td><td>1</td><td>31,920</td><td>0</td><td>2,631</td><td>235.00</td></tr> </tbody> </table>										Tax Year	Statement Number	Billed Owner	Tax Area	Total Value	Exemptions	Taxable Value	Billed Tax	2025	2025-660029944	TEEPEE INVESTMENTS LLC	1	70,515	0	4,940	527.00	2024	2024-660029944	TEEPEE INVESTMENTS LLC	1	73,246	0	4,705	496.00	2023	2023-660029944	TEEPEE INVESTMENTS LLC	1	53,285	0	4,481	460.00	2022	2022-660029944	TEEPEE INVESTMENTS LLC	1	38,800	0	4,268	428.00	2021	2021-660029944	TEEPEE INVESTMENTS LLC	1	38,252	0	3,886	342.00	2020	2020-660029944	FULTZ, GARY T	1	37,719	0	3,701	328.00	2019	2019-660029944	FULTZ, GARY T	1	36,871	0	3,525	317.00	2018	2018-660029944	FULTZ, GARY T	1	36,110	0	3,357	300.00	2017	2017-660029944	FULTZ, GARY T	1	35,834	0	3,197	289.00	2016	2016-660029944	FULTZ, GARY T	1	34,976	0	3,045	271.00	2015	2015-660029944	FULTZ, GARY T	1	32,581	0	2,900	259.00	2014	2014-660029944	FULTZ, GARY T	1	32,845	0	2,761	250.00	2013	2013-660029944	FULTZ, GARY T	1	31,920	0	2,631	235.00
Tax Year	Statement Number	Billed Owner	Tax Area	Total Value	Exemptions	Taxable Value	Billed Tax																																																																																																																		
2025	2025-660029944	TEEPEE INVESTMENTS LLC	1	70,515	0	4,940	527.00																																																																																																																		
2024	2024-660029944	TEEPEE INVESTMENTS LLC	1	73,246	0	4,705	496.00																																																																																																																		
2023	2023-660029944	TEEPEE INVESTMENTS LLC	1	53,285	0	4,481	460.00																																																																																																																		
2022	2022-660029944	TEEPEE INVESTMENTS LLC	1	38,800	0	4,268	428.00																																																																																																																		
2021	2021-660029944	TEEPEE INVESTMENTS LLC	1	38,252	0	3,886	342.00																																																																																																																		
2020	2020-660029944	FULTZ, GARY T	1	37,719	0	3,701	328.00																																																																																																																		
2019	2019-660029944	FULTZ, GARY T	1	36,871	0	3,525	317.00																																																																																																																		
2018	2018-660029944	FULTZ, GARY T	1	36,110	0	3,357	300.00																																																																																																																		
2017	2017-660029944	FULTZ, GARY T	1	35,834	0	3,197	289.00																																																																																																																		
2016	2016-660029944	FULTZ, GARY T	1	34,976	0	3,045	271.00																																																																																																																		
2015	2015-660029944	FULTZ, GARY T	1	32,581	0	2,900	259.00																																																																																																																		
2014	2014-660029944	FULTZ, GARY T	1	32,845	0	2,761	250.00																																																																																																																		
2013	2013-660029944	FULTZ, GARY T	1	31,920	0	2,631	235.00																																																																																																																		



# Rogers

## Assessment Property Record Card for Tax Year 2026

Data provided by LISA DELOZIER County Assessor

Date 04/16/2026  
 Time 22:31:51  
 Page 2

Lot Data		Square-Foot - NBHD 1045 #1	
Lot Size			
Lot Count			
Units Buildable	1		
Non-Ag Acres	0.3236		
Topography			
Street Access			
Utilities			
Amenities	LAND QUALITY	0	
		0	
Method	Square-Foot		
Base Lot Value	14,095.00 x 2.45 = 34,533		
Factor Value			
Adjustments	1.0000		
Lot Value	34,533		



\\tsclient\T\LOGAN\LOGAN RESIDENTIAL VI\2021-5-24\IMG\_000: 5/25/2021

Residential Data	
Type	1 Single Family Residence
Condition	3 - Average
Quality	2 - Fair
Architecture	TRAD TRADITIONAL
Style	100% One Story
Exterior Wall	100% Frame, Plywood or Hardboard
Base/Total Area	504 / 504
Style	100% One Story
HVAC	1 Wall Air Conditioners (Count)
Roof Cover	1 Composition Shingle
Area on Slab	0
Fixture/RghIn	4 /
Bed/F/H Bath	2 / 1.0 /
Basement Area	
Garage Type	
Remodel	
Year/Eff Age	1990 / 27

GRM Approach	
GRM Code	
Gross Rent	0.00
Indicated Value	

Multiple Regression			
MRA Code	1	Test	
Adusted R	0.8445		
Indicated Value	61,540	122.10	Per SqFt

Direct Comparables	
Selection Model	A Adam Test
Adjustment Model	1 2022 Residential
Comparables	
Indicated Value	

Cost Approach				Manual : 01/2025	
Base Cost	106.35	Total Misc Impr	+	0	
Roofing Adj	+ 4.93	Garage Cost	+		
Subfloor Adj	+ 2.91	Total RCN	=	62,562	
Heat/Cool Adj	+ 0.00	Depreciation ( 39%)	-	24,399	
Plumbing Adj	+ 9.94	Lump Sums	+	1,433	
Basement Adj	+ 0.00	RCNLD	=	39,596	
Adj Base Cost	= 124.13	Lot Value	+	34,533	
Total Area	x 504	Indicated Value	=	74,129	
Adjusted Cost	= 62,562	Value Per SqFt		147.08	

Value Reconciliation			
Selected Approach	Cost Approach		
Improvements	39,596		
Lot Value	34,533		
Indicated Value	74,129	147.08	Per SqFt
Agland Value			
Site Improvements			
Total Value	74,129	147.08	Total Value Per SqFt

Miscellaneous Improvements								
Code	Description	Sketch ID	Size	Year	Units	Unit Cost	Depr	Value
WODC	Wood Deck - Covered	175537	10x3		30	47.78		1,433



# Rogers

## Assessment Property Record Card for Tax Year 2026

Data provided by LISA DELOZIER County Assessor

Date 04/16/2026

Time 22:31:51

Page 3

### Sketch Image

660029944

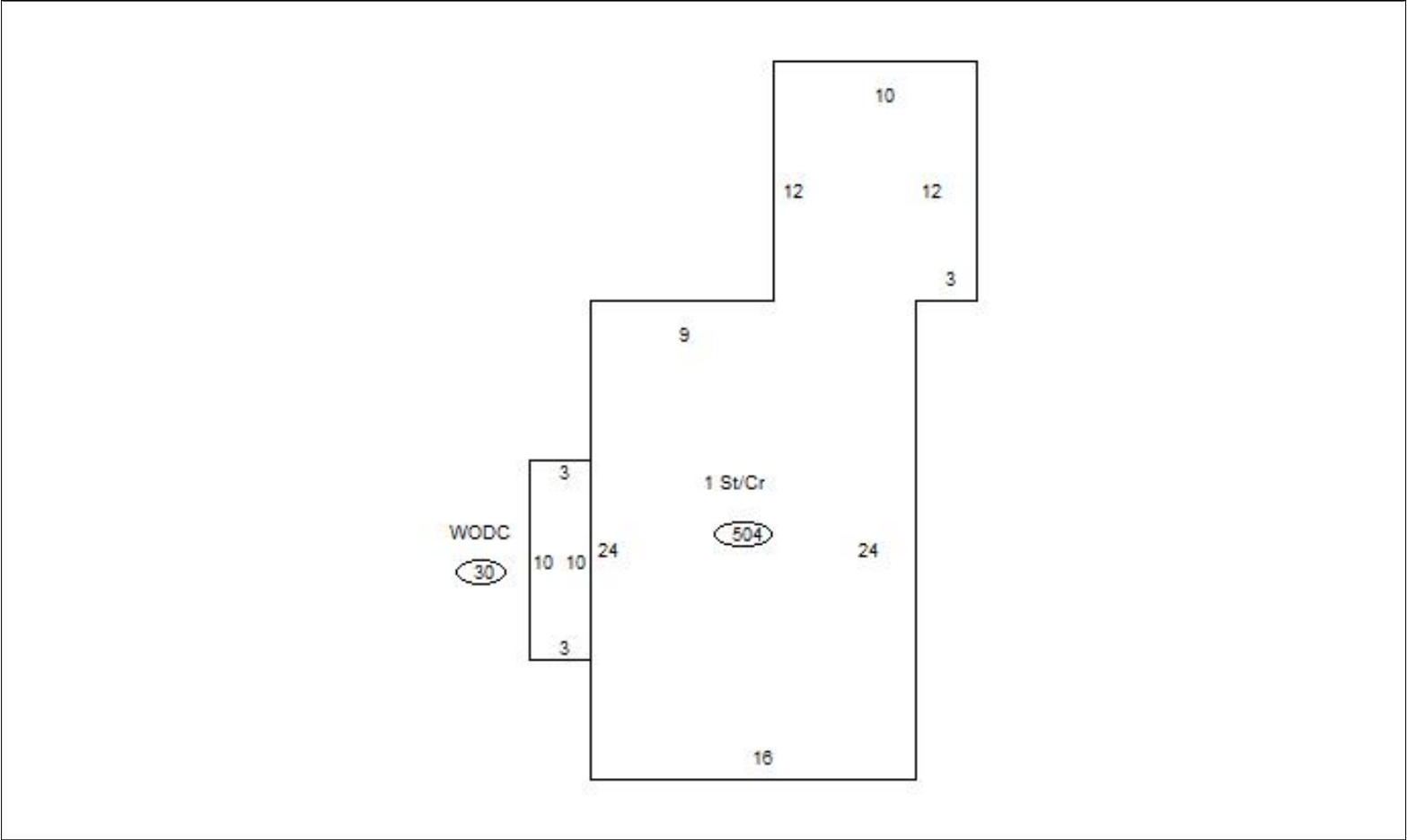

### Sketch Vector Information

Sequence	Code	Type	Built Over	Scale	Section Label	Base Area	Multiplier	Total Area
1	R	1	Crawl	10	1 St/Cr	504	1.000	504
2	M	WODC		10	WODC	30	1.000	30
<b>Total Building Area</b>						504		504