



# Rogers

## Assessment Property Record Card for Tax Year 2026

Data provided by LISA DELOZIER County Assessor

Date 04/17/2026  
Time 01:01:22  
Page 1

Assessment Data					Primary Image																																																																																																																				
<b>Account</b> 660030674 <b>Parcel ID</b> 000000-00-0-00819-005-0008 <b>Cadastral ID</b> 35-21-16-02660 <b>Property Type</b> REAL - Real Property <b>Property Class</b> RRP VI Area 1 <b>Tax Area</b> 5 - JUSTUS RURAL/NO FIRE <b>Name ID</b> 328875 DIETRICH, BILLY  24156 S 4180 RD CLAREMORE OK 74019-0000  <b>Parcel Location</b> <b>Situs</b> 24156 S 4180 RD <b>Subdivision</b> TIAWAH TOWN <b>Lot/Block</b> 0008 / 0005 <b>Parcel Size</b> 3 - Lots <b>Sec/Twn/Rng</b> 35 / 21 / 16 / 5 <b>Neighborhood</b> 1220 - R-V04-SE JUSTUS <b>School District</b> S009 - JUSTUS-TIAWAH SCHOOLS					<p>\\tsclient\T\TOMMY DUNLAP\New folder (112)\IMG_0005.JPG 11/17/2022</p>																																																																																																																				
<b>Legal Description</b> Lat/Long: 36.26136786 -95.56132694																																																																																																																									
LOTS 6 THRU 8 BLOCK 5 TIAWAH TOWN					<b>Building Permits</b> <table border="1"> <thead> <tr> <th>Number</th> <th>Description</th> <th>Opened</th> <th>Closed</th> <th>Amount</th> </tr> </thead> <tbody> <tr> <td> </td> <td> </td> <td> </td> <td> </td> <td> </td> </tr> </tbody> </table>					Number	Description	Opened	Closed	Amount																																																																																																											
Number	Description	Opened	Closed	Amount																																																																																																																					
<b>Exemptions</b> <table border="1"> <thead> <tr> <th>Code</th> <th>Type</th> <th>Active</th> <th>Maximum</th> <th>Exemption</th> </tr> </thead> <tbody> <tr> <td>H</td> <td>Homestead</td> <td>Yes</td> <td>1,000</td> <td>1,000</td> </tr> <tr> <td>H</td> <td>Homestead</td> <td>No</td> <td>1,000</td> <td> </td> </tr> <tr> <td>PD</td> <td>Add-Homestead</td> <td>No</td> <td>1,000</td> <td> </td> </tr> </tbody> </table>					Code	Type	Active	Maximum	Exemption	H	Homestead	Yes	1,000	1,000	H	Homestead	No	1,000		PD	Add-Homestead	No	1,000		<b>Sale History</b> <table border="1"> <thead> <tr> <th>Bk/Pg</th> <th>Grantor</th> <th>Date</th> <th>Price</th> <th>Code</th> </tr> </thead> <tbody> <tr> <td>/</td> <td>GILLUM, DOROTHY</td> <td>09/16/2019</td> <td>0</td> <td>4</td> </tr> </tbody> </table>					Bk/Pg	Grantor	Date	Price	Code	/	GILLUM, DOROTHY	09/16/2019	0	4																																																																																		
Code	Type	Active	Maximum	Exemption																																																																																																																					
H	Homestead	Yes	1,000	1,000																																																																																																																					
H	Homestead	No	1,000																																																																																																																						
PD	Add-Homestead	No	1,000																																																																																																																						
Bk/Pg	Grantor	Date	Price	Code																																																																																																																					
/	GILLUM, DOROTHY	09/16/2019	0	4																																																																																																																					
<b>Parcel Valuation</b> <table border="1"> <thead> <tr> <th>Source</th> <th>REAL</th> <th>Fair Cash</th> <th>Capped</th> <th>Asmnt Level</th> <th>Assessed</th> <th>Levy Rate</th> <th>83.050</th> <th>Current Tax</th> </tr> </thead> <tbody> <tr> <td>Remove Cap</td> <td>0</td> <td>Land Value 3,026</td> <td>1,623</td> <td>11%</td> <td>179</td> <td>Assessed</td> <td>2,717</td> <td>225.65</td> </tr> <tr> <td>Year Frozen</td> <td>1999</td> <td>Improvements 47,676</td> <td>23,077</td> <td> </td> <td>2,538</td> <td>Penalty</td> <td>0</td> <td> </td> </tr> <tr> <td>Uncapped Value</td> <td>0</td> <td>Mobile Home 0</td> <td>0</td> <td> </td> <td>0</td> <td>Exemption</td> <td>1,000</td> <td>-83.00</td> </tr> <tr> <td>TIF Project ID</td> <td>0</td> <td>Total Value 50,702</td> <td>24,700</td> <td> </td> <td>2,717</td> <td>Total Taxable</td> <td>1,717</td> <td>143.00</td> </tr> </tbody> </table>										Source	REAL	Fair Cash	Capped	Asmnt Level	Assessed	Levy Rate	83.050	Current Tax	Remove Cap	0	Land Value 3,026	1,623	11%	179	Assessed	2,717	225.65	Year Frozen	1999	Improvements 47,676	23,077		2,538	Penalty	0		Uncapped Value	0	Mobile Home 0	0		0	Exemption	1,000	-83.00	TIF Project ID	0	Total Value 50,702	24,700		2,717	Total Taxable	1,717	143.00																																																																			
Source	REAL	Fair Cash	Capped	Asmnt Level	Assessed	Levy Rate	83.050	Current Tax																																																																																																																	
Remove Cap	0	Land Value 3,026	1,623	11%	179	Assessed	2,717	225.65																																																																																																																	
Year Frozen	1999	Improvements 47,676	23,077		2,538	Penalty	0																																																																																																																		
Uncapped Value	0	Mobile Home 0	0		0	Exemption	1,000	-83.00																																																																																																																	
TIF Project ID	0	Total Value 50,702	24,700		2,717	Total Taxable	1,717	143.00																																																																																																																	
<b>Assessment History</b> <table border="1"> <thead> <tr> <th>Tax Year</th> <th>Statement Number</th> <th>Billed Owner</th> <th>Tax Area</th> <th>Total Value</th> <th>Exemptions</th> <th>Taxable Value</th> <th>Billed Tax</th> </tr> </thead> <tbody> <tr><td>2025</td><td>2025-660030674</td><td>DIETRICH, BILLY</td><td>5</td><td>50,258</td><td>1000</td><td>1,637</td><td>136.00</td></tr> <tr><td>2024</td><td>2024-660030674</td><td>DIETRICH, BILLY</td><td>5</td><td>53,989</td><td>1000</td><td>1,561</td><td>130.00</td></tr> <tr><td>2023</td><td>2023-660030674</td><td>DIETRICH, BILLY</td><td>5</td><td>48,503</td><td>1000</td><td>1,487</td><td>124.00</td></tr> <tr><td>2022</td><td>2022-660030674</td><td>DIETRICH, BILLY</td><td>5</td><td>48,503</td><td>1000</td><td>1,414</td><td>118.00</td></tr> <tr><td>2021</td><td>2021-660030674</td><td>DIETRICH, BILLY</td><td>5</td><td>48,572</td><td>1000</td><td>1,343</td><td>114.00</td></tr> <tr><td>2020</td><td>2020-660030674</td><td>DIETRICH, BILLY</td><td>5</td><td>49,293</td><td>1000</td><td>1,275</td><td>108.00</td></tr> <tr><td>2019</td><td>2019-660030674</td><td>DIETRICH, BILLY</td><td>5</td><td>44,557</td><td>2000</td><td>210</td><td>18.00</td></tr> <tr><td>2018</td><td>2018-660030674</td><td>GILLUM, DOROTHY</td><td>5</td><td>48,754</td><td>2000</td><td>210</td><td>18.00</td></tr> <tr><td>2017</td><td>2017-660030674</td><td>GILLUM, DOROTHY</td><td>5</td><td>48,316</td><td>2000</td><td>209</td><td>17.00</td></tr> <tr><td>2016</td><td>2016-660030674</td><td>GILLUM, DOROTHY</td><td>5</td><td>46,906</td><td>2000</td><td>209</td><td>18.00</td></tr> <tr><td>2015</td><td>2015-660030674</td><td>GILLUM, DOROTHY</td><td>5</td><td>47,029</td><td>2000</td><td>210</td><td>18.00</td></tr> <tr><td>2014</td><td>2014-660030674</td><td>GILLUM, DOROTHY</td><td>5</td><td>48,859</td><td>2000</td><td>210</td><td>18.00</td></tr> <tr><td>2013</td><td>2013-660030674</td><td>GILLUM, DOROTHY</td><td>5</td><td>46,621</td><td>2000</td><td>209</td><td>18.00</td></tr> </tbody> </table>										Tax Year	Statement Number	Billed Owner	Tax Area	Total Value	Exemptions	Taxable Value	Billed Tax	2025	2025-660030674	DIETRICH, BILLY	5	50,258	1000	1,637	136.00	2024	2024-660030674	DIETRICH, BILLY	5	53,989	1000	1,561	130.00	2023	2023-660030674	DIETRICH, BILLY	5	48,503	1000	1,487	124.00	2022	2022-660030674	DIETRICH, BILLY	5	48,503	1000	1,414	118.00	2021	2021-660030674	DIETRICH, BILLY	5	48,572	1000	1,343	114.00	2020	2020-660030674	DIETRICH, BILLY	5	49,293	1000	1,275	108.00	2019	2019-660030674	DIETRICH, BILLY	5	44,557	2000	210	18.00	2018	2018-660030674	GILLUM, DOROTHY	5	48,754	2000	210	18.00	2017	2017-660030674	GILLUM, DOROTHY	5	48,316	2000	209	17.00	2016	2016-660030674	GILLUM, DOROTHY	5	46,906	2000	209	18.00	2015	2015-660030674	GILLUM, DOROTHY	5	47,029	2000	210	18.00	2014	2014-660030674	GILLUM, DOROTHY	5	48,859	2000	210	18.00	2013	2013-660030674	GILLUM, DOROTHY	5	46,621	2000	209	18.00
Tax Year	Statement Number	Billed Owner	Tax Area	Total Value	Exemptions	Taxable Value	Billed Tax																																																																																																																		
2025	2025-660030674	DIETRICH, BILLY	5	50,258	1000	1,637	136.00																																																																																																																		
2024	2024-660030674	DIETRICH, BILLY	5	53,989	1000	1,561	130.00																																																																																																																		
2023	2023-660030674	DIETRICH, BILLY	5	48,503	1000	1,487	124.00																																																																																																																		
2022	2022-660030674	DIETRICH, BILLY	5	48,503	1000	1,414	118.00																																																																																																																		
2021	2021-660030674	DIETRICH, BILLY	5	48,572	1000	1,343	114.00																																																																																																																		
2020	2020-660030674	DIETRICH, BILLY	5	49,293	1000	1,275	108.00																																																																																																																		
2019	2019-660030674	DIETRICH, BILLY	5	44,557	2000	210	18.00																																																																																																																		
2018	2018-660030674	GILLUM, DOROTHY	5	48,754	2000	210	18.00																																																																																																																		
2017	2017-660030674	GILLUM, DOROTHY	5	48,316	2000	209	17.00																																																																																																																		
2016	2016-660030674	GILLUM, DOROTHY	5	46,906	2000	209	18.00																																																																																																																		
2015	2015-660030674	GILLUM, DOROTHY	5	47,029	2000	210	18.00																																																																																																																		
2014	2014-660030674	GILLUM, DOROTHY	5	48,859	2000	210	18.00																																																																																																																		
2013	2013-660030674	GILLUM, DOROTHY	5	46,621	2000	209	18.00																																																																																																																		



# Rogers

## Assessment Property Record Card for Tax Year 2026

Data provided by LISA DELOZIER County Assessor

Date 04/17/2026  
Time 01:01:22  
Page 2

Lot Data	Square-Foot - NBHD 1220 #1	Primary Image
<b>Lot Size</b> <b>Lot Count</b> <b>Units Buildable</b> 1 <b>Non-Ag Acres</b> 0.2315 <b>Topography</b> <b>Street Access</b> <b>Utilities</b> <b>Amenities</b> 0  <b>Method</b> Square-Foot <b>Base Lot Value</b> 10,085.00 x .30 = 3,026 <b>Factor Value</b> <b>Adjustments</b> 1.0000 <b>Lot Value</b> 3,026		 <p>\\tsclient\T\TOMMY DUNLAP\New folder (112)\IMG_0005.JPG 11/17/2022</p>

Residential Data	
<b>Type</b>	1 Single Family Residence
<b>Condition</b>	3 - Average
<b>Quality</b>	1.5 - Low
<b>Architecture</b>	
<b>Style</b>	100% One Story
<b>Exterior Wall</b>	100% Frame, Siding, Vinyl
<b>Base/Total Area</b>	1,130 / 1,130
<b>Style</b>	100% One Story
<b>HVAC</b>	100% Wall Furnace
<b>Roof Cover</b>	1 Composition Shingle
<b>Area on Slab</b>	0
<b>Fixture/RghIn</b>	4 /
<b>Bed/F/H Bath</b>	3 / 1.0 /
<b>Basement Area</b>	
<b>Garage Type</b>	
<b>Remodel</b>	
<b>Year/Eff Age</b>	1960 / 50



\\tsclient\T\TOMMY DUNLAP\New folder (112)\IMG\_0005.JPG 11/17/2022

GRM Approach	
<b>GRM Code</b>	
<b>Gross Rent</b>	0.00
<b>Indicated Value</b>	

Multiple Regression			
<b>MRA Code</b>	1	Test	
<b>Adusted R</b>	0.8445		
<b>Indicated Value</b>	52,334	46.31	Per SqFt

Direct Comparables	
<b>Selection Model</b>	A Adam Test
<b>Adjustment Model</b>	1 2022 Residential
<b>Comparables</b>	
<b>Indicated Value</b>	

Value Reconciliation			
<b>Selected Approach</b>	Cost Approach		
<b>Improvements</b>	46,385		
<b>Lot Value</b>	3,026		
<b>Indicated Value</b>	49,411	43.73	Per SqFt
<b>Agland Value</b>			
<b>Site Improvements</b>	1,291		
<b>Total Value</b>	50,702	44.87	Total Value Per SqFt

Cost Approach				Manual : 01/2025			
<b>Base Cost</b>	87.93	<b>Total Misc Impr</b>	+	655			
<b>Roofing Adj</b>	+ 4.10	<b>Garage Cost</b>	+				
<b>Subfloor Adj</b>	+ 2.52	<b>Total RCN</b>	=	113,135			
<b>Heat/Cool Adj</b>	+ 0.73	<b>Depreciation ( 59%)</b>	-	66,750			
<b>Plumbing Adj</b>	+ 4.26	<b>Lump Sums</b>	+	0			
<b>Basement Adj</b>	+ 0.00	<b>RCNLD</b>	=	46,385			
<b>Adj Base Cost</b>	= 99.54	<b>Lot Value</b>	+	3,026			
<b>Total Area</b>	x 1,130	<b>Indicated Value</b>	=	49,411			
<b>Adjusted Cost</b>	= 112,480	<b>Value Per SqFt</b>		43.73			

Miscellaneous Improvements								
Code	Description	Sketch ID	Size	Year	Units	Unit Cost	Depr	Value
PRCH	SLAB PORCH - COVERED	72778	8x4		32	20.46		655



# Rogers

## Assessment Property Record Card for Tax Year 2026

Data provided by LISA DELOZIER County Assessor

Date 04/17/2026  
Time 01:01:22  
Page 3

### Sketch Image

660030674

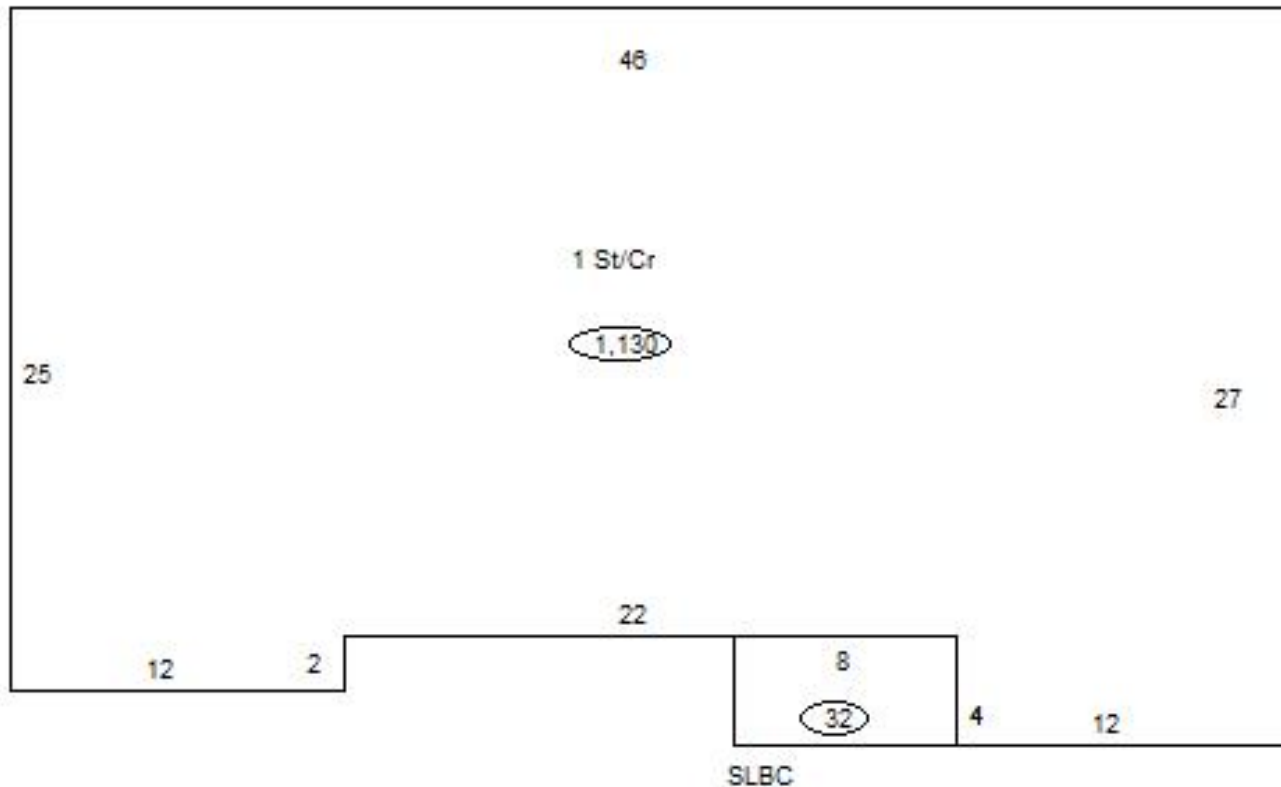

### Sketch Vector Information

Sequence	Code	Type	Built Over	Scale	Section Label	Base Area	Multiplier	Total Area
1	R	1	Crawl	10	1 St/Cr	1,130	1.000	1,130
2	M	PRCH		10	SLBC	32	1.000	32
<b>Total Building Area</b>						1,130		1,130



# Rogers



## Assessment Property Record Card for Tax Year 2026

Data provided by LISA DELOZIER County Assessor

Date 04/17/2026  
Time 01:01:22  
Page 4

660030674

### Outbuildings/Site Improvements

Building Image	Code	Description	Dimensions	Floor	Roofing	Total Units	
	CPDT	CARPORT - DETACHED	10x20x0			200	
	Qual	2	Cond 3	Year	Eff Age 1520		
	<b>Valuation Summary</b>		<b>Modifier Total</b>	<b>RCN</b>	<b>Depr (30% Phys/ % Func)</b>	<b>RCNLD</b>	
	Base Cost (9.22 x 200)		1,844		1,844	553	1,291
	STF	STG FAIR	0x0x0				
	Qual	2	Cond	Year	Eff Age		
	<b>Valuation Summary</b>		<b>Modifier Total</b>	<b>RCN</b>	<b>Depr (100% Phys/ % Func)</b>	<b>RCNLD</b>	
	Base Cost (4.68 x )						