



Rogers

Assessment Property Record Card for Tax Year 2026

Data provided by LISA DELOZIER County Assessor

Date 04/18/2026
 Time 08:12:30
 Page 1

Assessment Data					Primary Image																																																																																																																				
Account 660030690 Parcel ID 000000-00-0-00819-008-0014 Cadastral ID 35-21-16-02815 Property Type REAL - Real Property Property Class RRP VI Area 1 Tax Area 5 - JUSTUS RURAL/NO FIRE Name ID 328365 HAMMERLEIN, MATISEN & JACOB 24102 S 4178 RD CLAREMORE OK 74019-0000 Parcel Location Situs 24102 S 4178 RD Subdivision TIAWAH TOWN Lot/Block 0014 / 0008 Parcel Size 3 - Lots Sec/Twn/Rng 35 / 21 / 16 / 5 Neighborhood 1220 - R-V04-SE JUSTUS School District S009 - JUSTUS-TIAWAH SCHOOLS																																																																																																																									
Legal Description Lat/Long: 36.26222580 -95.56360493																																																																																																																									
Legal Description LOTS 12, 13 & 14 BLOCK 8 TIAWAH TOWN AND THAT PORTION OF THE ADJACENT VACATED ALLEY AND THAT PORTION OF THE ADJACENT VACATED STREET AS DESCRIBED ON 2681-371 CV-17 198					Building Permits <table border="1"> <thead> <tr> <th>Number</th> <th>Description</th> <th>Opened</th> <th>Closed</th> <th>Amount</th> </tr> </thead> <tbody> <tr> <td> </td> <td> </td> <td> </td> <td> </td> <td> </td> </tr> </tbody> </table>					Number	Description	Opened	Closed	Amount																																																																																																											
Number	Description	Opened	Closed	Amount																																																																																																																					
Exemptions <table border="1"> <thead> <tr> <th>Code</th> <th>Type</th> <th>Active</th> <th>Maximum</th> <th>Exemption</th> </tr> </thead> <tbody> <tr> <td> </td> <td> </td> <td> </td> <td> </td> <td> </td> </tr> </tbody> </table>					Code	Type	Active	Maximum	Exemption						Sale History <table border="1"> <thead> <tr> <th>Bk/Pg</th> <th>Grantor</th> <th>Date</th> <th>Price</th> <th>Code</th> </tr> </thead> <tbody> <tr> <td>/</td> <td>CTM PROPERTIES LLC</td> <td>07/24/2019</td> <td>110,000</td> <td>WG</td> </tr> <tr> <td>/</td> <td>OKLAHOMA STATE BANK</td> <td>12/20/2018</td> <td>35,000</td> <td>WB</td> </tr> <tr> <td>2632/166</td> <td>ROSS, ALFORD & REBECCA CRISTINE</td> <td>05/03/2017</td> <td>0</td> <td>WB</td> </tr> <tr> <td>2211/755</td> <td>GROUP ONE INC</td> <td>11/23/2011</td> <td>92,000</td> <td>YES</td> </tr> <tr> <td>2086/233</td> <td>HARVEY, ANNA JO</td> <td>02/16/2010</td> <td>20,000</td> <td>11</td> </tr> </tbody> </table>					Bk/Pg	Grantor	Date	Price	Code	/	CTM PROPERTIES LLC	07/24/2019	110,000	WG	/	OKLAHOMA STATE BANK	12/20/2018	35,000	WB	2632/166	ROSS, ALFORD & REBECCA CRISTINE	05/03/2017	0	WB	2211/755	GROUP ONE INC	11/23/2011	92,000	YES	2086/233	HARVEY, ANNA JO	02/16/2010	20,000	11																																																																								
Code	Type	Active	Maximum	Exemption																																																																																																																					
Bk/Pg	Grantor	Date	Price	Code																																																																																																																					
/	CTM PROPERTIES LLC	07/24/2019	110,000	WG																																																																																																																					
/	OKLAHOMA STATE BANK	12/20/2018	35,000	WB																																																																																																																					
2632/166	ROSS, ALFORD & REBECCA CRISTINE	05/03/2017	0	WB																																																																																																																					
2211/755	GROUP ONE INC	11/23/2011	92,000	YES																																																																																																																					
2086/233	HARVEY, ANNA JO	02/16/2010	20,000	11																																																																																																																					
Parcel Valuation <table border="1"> <thead> <tr> <th>Source</th> <th>REAL</th> <th>Fair Cash</th> <th>Capped</th> <th>Asmnt Level</th> <th>Assessed</th> <th>Levy Rate</th> <th>83.050</th> <th>Current Tax</th> </tr> </thead> <tbody> <tr> <td>Remove Cap</td> <td>2020</td> <td>Land Value 7,537</td> <td>7,537</td> <td>11%</td> <td>829</td> <td>Assessed</td> <td>7,535</td> <td>625.78</td> </tr> <tr> <td>Year Frozen</td> <td>0</td> <td>Improvements 60,966</td> <td>60,966</td> <td></td> <td>6,706</td> <td>Penalty</td> <td>0</td> <td></td> </tr> <tr> <td>Uncapped Value</td> <td>0</td> <td>Mobile Home 0</td> <td>0</td> <td></td> <td>0</td> <td>Exemption</td> <td>0</td> <td>0.00</td> </tr> <tr> <td>TIF Project ID</td> <td>0</td> <td>Total Value 68,503</td> <td>68,503</td> <td></td> <td>7,535</td> <td>Total Taxable</td> <td>7,535</td> <td>626.00</td> </tr> </tbody> </table>										Source	REAL	Fair Cash	Capped	Asmnt Level	Assessed	Levy Rate	83.050	Current Tax	Remove Cap	2020	Land Value 7,537	7,537	11%	829	Assessed	7,535	625.78	Year Frozen	0	Improvements 60,966	60,966		6,706	Penalty	0		Uncapped Value	0	Mobile Home 0	0		0	Exemption	0	0.00	TIF Project ID	0	Total Value 68,503	68,503		7,535	Total Taxable	7,535	626.00																																																																			
Source	REAL	Fair Cash	Capped	Asmnt Level	Assessed	Levy Rate	83.050	Current Tax																																																																																																																	
Remove Cap	2020	Land Value 7,537	7,537	11%	829	Assessed	7,535	625.78																																																																																																																	
Year Frozen	0	Improvements 60,966	60,966		6,706	Penalty	0																																																																																																																		
Uncapped Value	0	Mobile Home 0	0		0	Exemption	0	0.00																																																																																																																	
TIF Project ID	0	Total Value 68,503	68,503		7,535	Total Taxable	7,535	626.00																																																																																																																	
Assessment History <table border="1"> <thead> <tr> <th>Tax Year</th> <th>Statement Number</th> <th>Billed Owner</th> <th>Tax Area</th> <th>Total Value</th> <th>Exemptions</th> <th>Taxable Value</th> <th>Billed Tax</th> </tr> </thead> <tbody> <tr><td>2025</td><td>2025-660030690</td><td>HAMMERLEIN, MATISEN &</td><td>5</td><td>69,179</td><td>0</td><td>7,610</td><td>632.00</td></tr> <tr><td>2024</td><td>2024-660030690</td><td>HAMMERLEIN, MATISEN &</td><td>5</td><td>73,069</td><td>0</td><td>8,038</td><td>671.00</td></tr> <tr><td>2023</td><td>2023-660030690</td><td>HAMMERLEIN, MATISEN &</td><td>5</td><td>87,397</td><td>0</td><td>9,614</td><td>801.00</td></tr> <tr><td>2022</td><td>2022-660030690</td><td>HAMMERLEIN, MATISEN &</td><td>5</td><td>89,950</td><td>0</td><td>9,895</td><td>823.00</td></tr> <tr><td>2021</td><td>2021-660030690</td><td>HAMMERLEIN, MATISEN &</td><td>5</td><td>88,613</td><td>0</td><td>9,747</td><td>827.00</td></tr> <tr><td>2020</td><td>2020-660030690</td><td>HAMMERLEIN, MATISEN &</td><td>5</td><td>89,070</td><td>0</td><td>9,798</td><td>829.00</td></tr> <tr><td>2019</td><td>2019-660030690</td><td>HAMMERLEIN, MATISEN &</td><td>5</td><td>49,577</td><td>0</td><td>5,453</td><td>472.00</td></tr> <tr><td>2018</td><td>2018-660030690</td><td>OKLAHOMA STATE BANK</td><td>5</td><td>55,056</td><td>0</td><td>6,056</td><td>525.00</td></tr> <tr><td>2017</td><td>2017-660030690</td><td>OKLAHOMA STATE BANK</td><td>5</td><td>54,551</td><td>0</td><td>6,001</td><td>489.00</td></tr> <tr><td>2016</td><td>2016-660030690</td><td>ROSS, REBECCA CRISTINE &</td><td>5</td><td>52,964</td><td>0</td><td>5,826</td><td>497.00</td></tr> <tr><td>2015</td><td>2015-660030690</td><td>ROSS, REBECCA CRISTINE &</td><td>5</td><td>65,992</td><td>0</td><td>7,259</td><td>613.00</td></tr> <tr><td>2014</td><td>2014-660030690</td><td>ROSS, REBECCA CRISTINE &</td><td>5</td><td>67,291</td><td>0</td><td>7,263</td><td>623.00</td></tr> <tr><td>2013</td><td>2013-660030690</td><td>ROSS, REBECCA CRISTINE &</td><td>5</td><td>62,882</td><td>0</td><td>6,917</td><td>603.00</td></tr> </tbody> </table>										Tax Year	Statement Number	Billed Owner	Tax Area	Total Value	Exemptions	Taxable Value	Billed Tax	2025	2025-660030690	HAMMERLEIN, MATISEN &	5	69,179	0	7,610	632.00	2024	2024-660030690	HAMMERLEIN, MATISEN &	5	73,069	0	8,038	671.00	2023	2023-660030690	HAMMERLEIN, MATISEN &	5	87,397	0	9,614	801.00	2022	2022-660030690	HAMMERLEIN, MATISEN &	5	89,950	0	9,895	823.00	2021	2021-660030690	HAMMERLEIN, MATISEN &	5	88,613	0	9,747	827.00	2020	2020-660030690	HAMMERLEIN, MATISEN &	5	89,070	0	9,798	829.00	2019	2019-660030690	HAMMERLEIN, MATISEN &	5	49,577	0	5,453	472.00	2018	2018-660030690	OKLAHOMA STATE BANK	5	55,056	0	6,056	525.00	2017	2017-660030690	OKLAHOMA STATE BANK	5	54,551	0	6,001	489.00	2016	2016-660030690	ROSS, REBECCA CRISTINE &	5	52,964	0	5,826	497.00	2015	2015-660030690	ROSS, REBECCA CRISTINE &	5	65,992	0	7,259	613.00	2014	2014-660030690	ROSS, REBECCA CRISTINE &	5	67,291	0	7,263	623.00	2013	2013-660030690	ROSS, REBECCA CRISTINE &	5	62,882	0	6,917	603.00
Tax Year	Statement Number	Billed Owner	Tax Area	Total Value	Exemptions	Taxable Value	Billed Tax																																																																																																																		
2025	2025-660030690	HAMMERLEIN, MATISEN &	5	69,179	0	7,610	632.00																																																																																																																		
2024	2024-660030690	HAMMERLEIN, MATISEN &	5	73,069	0	8,038	671.00																																																																																																																		
2023	2023-660030690	HAMMERLEIN, MATISEN &	5	87,397	0	9,614	801.00																																																																																																																		
2022	2022-660030690	HAMMERLEIN, MATISEN &	5	89,950	0	9,895	823.00																																																																																																																		
2021	2021-660030690	HAMMERLEIN, MATISEN &	5	88,613	0	9,747	827.00																																																																																																																		
2020	2020-660030690	HAMMERLEIN, MATISEN &	5	89,070	0	9,798	829.00																																																																																																																		
2019	2019-660030690	HAMMERLEIN, MATISEN &	5	49,577	0	5,453	472.00																																																																																																																		
2018	2018-660030690	OKLAHOMA STATE BANK	5	55,056	0	6,056	525.00																																																																																																																		
2017	2017-660030690	OKLAHOMA STATE BANK	5	54,551	0	6,001	489.00																																																																																																																		
2016	2016-660030690	ROSS, REBECCA CRISTINE &	5	52,964	0	5,826	497.00																																																																																																																		
2015	2015-660030690	ROSS, REBECCA CRISTINE &	5	65,992	0	7,259	613.00																																																																																																																		
2014	2014-660030690	ROSS, REBECCA CRISTINE &	5	67,291	0	7,263	623.00																																																																																																																		
2013	2013-660030690	ROSS, REBECCA CRISTINE &	5	62,882	0	6,917	603.00																																																																																																																		



Rogers

Assessment Property Record Card for Tax Year 2026

Data provided by LISA DELOZIER County Assessor

Date 04/18/2026
 Time 08:12:31
 Page 2

Lot Data		Square-Foot - NBHD 1220 #1	
Lot Size			
Lot Count			
Units Buildable	3		
Non-Ag Acres	0.5767		
Topography			
Street Access			
Utilities			
Amenities		0	
		0	
Method	Square-Foot		
Base Lot Value	25,123.00 x .30 = 7,537		
Factor Value			
Adjustments	1.0000		
Lot Value	7,537		



\\tsclient\T\TOMMY DUNLAP\New folder (112)\IMG_0049.JPG 11/17/2022

Residential Data	
Type	1 Single Family Residence
Condition	3 - Average
Quality	2 - Fair
Architecture	
Style	100% One Story
Exterior Wall	100% Frame, Stucco
Base/Total Area	960 / 960
Style	100% One Story
HVAC	100% Warmed & Cooled Air
Roof Cover	1 Composition Shingle
Area on Slab	960
Fixture/RghIn	14 /
Bed/F/H Bath	2 / 1.0 /
Basement Area	
Garage Type	
Remodel	RMA -
Year/Eff Age	1940 / 43

GRM Approach

GRM Code	
Gross Rent	0.00
Indicated Value	

Multiple Regression

MRA Code	1 Test
Adusted R	0.8445
Indicated Value	41,759 43.50 Per SqFt

Direct Comparables

Selection Model	A Adam Test
Adjustment Model	1 2022 Residential
Comparables	
Indicated Value	

Value Reconciliation

Selected Approach	Cost Approach
Improvements	60,966
Lot Value	7,537
Indicated Value	68,503 71.36 Per SqFt
Agland Value	
Site Improvements	
Total Value	68,503 71.36 Total Value Per SqFt

Cost Approach		Manual : 01/2025	
Base Cost	97.31	Total Misc Impr	+ 6,383
Roofing Adj	+ 4.28	Garage Cost	+
Subfloor Adj	+ 0.00	Total RCN	= 129,714
Heat/Cool Adj	+ 10.30	Depreciation (53%)	- 68,748
Plumbing Adj	+ 16.58	Lump Sums	+ 0
Basement Adj	+ 0.00	RCNLD	= 60,966
Adj Base Cost	= 128.47	Lot Value	+ 7,537
Total Area	x 960	Indicated Value	= 68,503
Adjusted Cost	= 123,331	Value Per SqFt	71.36

Miscellaneous Improvements

Code	Description	Sketch ID	Size	Year	Units	Unit Cost	Depr	Value
PRCH	SLAB PORCH - COVERED	72792	17x11		187	20.71		3,873
PRCH	SLAB PORCH - COVERED	72793	15x8		120	20.92		2,510



Rogers

Assessment Property Record Card for Tax Year 2026

Data provided by LISA DELOZIER County Assessor

Date 04/18/2026

Time 08:12:31

Page 3

Sketch Image

660030690

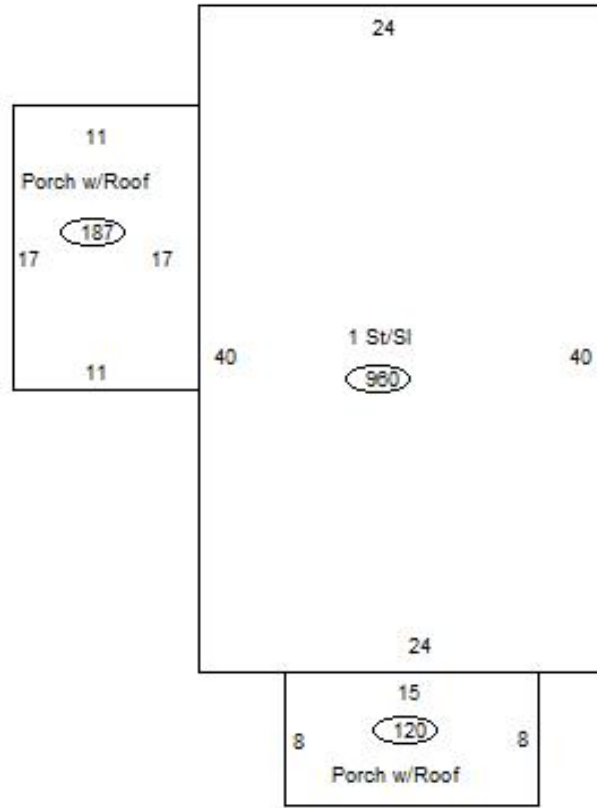

Sketch Vector Information

Sequence	Code	Type	Built Over	Scale	Section Label	Base Area	Multiplier	Total Area
1	R	1	Slab	13	1 St/Sl	960	1.000	960
2	M	PRCH		13	SLBC	187	1.000	187
3	M	PRCH		13	SLBC	120	1.000	120
Total Building Area						960		960



Rogers

Assessment Property Record Card for Tax Year 2026

Data provided by LISA DELOZIER County Assessor

Date 04/18/2026
Time 08:12:31
Page 4

660030690

Outbuildings/Site Improvements

Building Image	Code	Description	Dimensions	Floor	Roofing	Total Units
	STF	STG FAIR	0x0x0			
	Qual	Cond	Year	Eff Age		
Valuation Summary			Modifier Total	RCN	Depr (100% Phys/ % Func)	RCNLD
Base Cost (4.68 x)						