



# Rogers

## Assessment Property Record Card for Tax Year 2026

Data provided by LISA DELOZIER County Assessor

Date 04/16/2026  
Time 21:20:36  
Page 1

Assessment Data					Primary Image																																																																																																																				
<b>Account</b> 660031111 <b>Parcel ID</b> 000000-00-0-20200-004-0019 <b>Cadastral ID</b> 36-20-14-02950 <b>Property Type</b> REAL - Real Property <b>Property Class</b> URP VI Area 3 <b>Tax Area</b> 1 - CATOOSA OT <b>Name ID</b> 318243 O'BRIEN, TERESA L  1290 ASPEN LN CATOOSA OK 74015-0000  <b>Parcel Location</b> <b>Situs</b> 01290 ASPEN LN <b>Subdivision</b> WOODCREST ESTATES <b>Lot/Block</b> 0019 / 0004 <b>Parcel Size</b> 1 - Lots <b>Sec/Twn/Rng</b> 36 / 20 / 14 / 5 <b>Neighborhood</b> 1193 - R-V03-SW CATOOSA <b>School District</b> S002 - CATOOSA SCHOOLS					<p>\\tsclient\T\LOGAN\LOGAN RESIDENTIAL VI\2021-6-28\IMG_005; 6/28/2021</p>																																																																																																																				
<b>Legal Description</b> Lot/Long: 36.17447570 -95.76775561																																																																																																																									
<b>Building Permits</b> <table border="1"> <thead> <tr> <th>Number</th> <th>Description</th> <th>Opened</th> <th>Closed</th> <th>Amount</th> </tr> </thead> <tbody> <tr> <td colspan="5"> </td> </tr> </tbody> </table>					Number	Description	Opened	Closed	Amount																																																																																																																
Number	Description	Opened	Closed	Amount																																																																																																																					
<b>Exemptions</b> <table border="1"> <thead> <tr> <th>Code</th> <th>Type</th> <th>Active</th> <th>Maximum</th> <th>Exemption</th> </tr> </thead> <tbody> <tr> <td>H</td> <td>Homestead</td> <td>No</td> <td>1,000</td> <td></td> </tr> </tbody> </table>					Code	Type	Active	Maximum	Exemption	H	Homestead	No	1,000		<b>Sale History</b> <table border="1"> <thead> <tr> <th>Bk/Pg</th> <th>Grantor</th> <th>Date</th> <th>Price</th> <th>Code</th> </tr> </thead> <tbody> <tr> <td>2547/493</td> <td>RECTOR, FREDDIE L</td> <td>04/26/2016</td> <td>152,000</td> <td>YES</td> </tr> <tr> <td>2496/192</td> <td>FEDERAL NATIONAL MORT ASSOC</td> <td>08/27/2015</td> <td>70,000</td> <td>3</td> </tr> <tr> <td>2464/908</td> <td>COONS, TRACY L</td> <td>03/26/2014</td> <td>0</td> <td>10</td> </tr> <tr> <td>840/586</td> <td></td> <td></td> <td>53,500</td> <td>No</td> </tr> </tbody> </table>					Bk/Pg	Grantor	Date	Price	Code	2547/493	RECTOR, FREDDIE L	04/26/2016	152,000	YES	2496/192	FEDERAL NATIONAL MORT ASSOC	08/27/2015	70,000	3	2464/908	COONS, TRACY L	03/26/2014	0	10	840/586			53,500	No																																																																													
Code	Type	Active	Maximum	Exemption																																																																																																																					
H	Homestead	No	1,000																																																																																																																						
Bk/Pg	Grantor	Date	Price	Code																																																																																																																					
2547/493	RECTOR, FREDDIE L	04/26/2016	152,000	YES																																																																																																																					
2496/192	FEDERAL NATIONAL MORT ASSOC	08/27/2015	70,000	3																																																																																																																					
2464/908	COONS, TRACY L	03/26/2014	0	10																																																																																																																					
840/586			53,500	No																																																																																																																					
<b>Parcel Valuation</b> <table border="1"> <thead> <tr> <th>Source</th> <th>REAL</th> <th>Fair Cash</th> <th>Capped</th> <th>Asmnt Level</th> <th>Assessed</th> <th>Levy Rate</th> <th>106.660</th> <th>Current Tax</th> </tr> </thead> <tbody> <tr> <td>Remove Cap</td> <td>2017</td> <td>Land Value 40,401</td> <td>40,401</td> <td>11%</td> <td>4,444</td> <td>Assessed</td> <td>20,399</td> <td>2,175.76</td> </tr> <tr> <td>Year Frozen</td> <td>0</td> <td>Improvements 145,048</td> <td>145,048</td> <td></td> <td>15,955</td> <td>Penalty</td> <td>0</td> <td></td> </tr> <tr> <td>Uncapped Value</td> <td>0</td> <td>Mobile Home 0</td> <td>0</td> <td></td> <td>0</td> <td>Exemption</td> <td>0</td> <td>0.00</td> </tr> <tr> <td>TIF Project ID</td> <td>0</td> <td>Total Value 185,449</td> <td>185,449</td> <td></td> <td>20,399</td> <td>Total Taxable</td> <td>20,399</td> <td>2,176.00</td> </tr> </tbody> </table>										Source	REAL	Fair Cash	Capped	Asmnt Level	Assessed	Levy Rate	106.660	Current Tax	Remove Cap	2017	Land Value 40,401	40,401	11%	4,444	Assessed	20,399	2,175.76	Year Frozen	0	Improvements 145,048	145,048		15,955	Penalty	0		Uncapped Value	0	Mobile Home 0	0		0	Exemption	0	0.00	TIF Project ID	0	Total Value 185,449	185,449		20,399	Total Taxable	20,399	2,176.00																																																																			
Source	REAL	Fair Cash	Capped	Asmnt Level	Assessed	Levy Rate	106.660	Current Tax																																																																																																																	
Remove Cap	2017	Land Value 40,401	40,401	11%	4,444	Assessed	20,399	2,175.76																																																																																																																	
Year Frozen	0	Improvements 145,048	145,048		15,955	Penalty	0																																																																																																																		
Uncapped Value	0	Mobile Home 0	0		0	Exemption	0	0.00																																																																																																																	
TIF Project ID	0	Total Value 185,449	185,449		20,399	Total Taxable	20,399	2,176.00																																																																																																																	
<b>Assessment History</b> <table border="1"> <thead> <tr> <th>Tax Year</th> <th>Statement Number</th> <th>Billed Owner</th> <th>Tax Area</th> <th>Total Value</th> <th>Exemptions</th> <th>Taxable Value</th> <th>Billed Tax</th> </tr> </thead> <tbody> <tr><td>2025</td><td>2025-660031111</td><td>O'BRIEN, TERESA L</td><td>1</td><td>184,315</td><td>0</td><td>20,275</td><td>2,163.00</td></tr> <tr><td>2024</td><td>2024-660031111</td><td>O'BRIEN, TERESA L</td><td>1</td><td>205,192</td><td>0</td><td>21,236</td><td>2,240.00</td></tr> <tr><td>2023</td><td>2023-660031111</td><td>O'BRIEN, TERESA L</td><td>1</td><td>183,864</td><td>0</td><td>20,225</td><td>2,076.00</td></tr> <tr><td>2022</td><td>2022-660031111</td><td>O'BRIEN, TERESA L</td><td>1</td><td>187,731</td><td>0</td><td>19,652</td><td>1,973.00</td></tr> <tr><td>2021</td><td>2021-660031111</td><td>O'BRIEN, TERESA L</td><td>1</td><td>170,150</td><td>0</td><td>18,717</td><td>1,647.00</td></tr> <tr><td>2020</td><td>2020-660031111</td><td>O'BRIEN, TERESA L</td><td>1</td><td>164,019</td><td>0</td><td>18,000</td><td>1,594.00</td></tr> <tr><td>2019</td><td>2019-660031111</td><td>O'BRIEN, TERESA L</td><td>1</td><td>155,846</td><td>0</td><td>17,143</td><td>1,539.00</td></tr> <tr><td>2018</td><td>2018-660031111</td><td>O'BRIEN, TERESA L</td><td>1</td><td>154,953</td><td>0</td><td>17,045</td><td>1,521.00</td></tr> <tr><td>2017</td><td>2017-660031111</td><td>O'BRIEN, TERESA L</td><td>1</td><td>153,602</td><td>0</td><td>16,896</td><td>1,526.00</td></tr> <tr><td>2016</td><td>2016-660031111</td><td>O'BRIEN, TERESA L</td><td>1</td><td>124,102</td><td>1000</td><td>12,651</td><td>1,125.00</td></tr> <tr><td>2015</td><td>2015-660031111</td><td>RECTOR, FREDDIE L</td><td>1</td><td>120,972</td><td>0</td><td>12,287</td><td>1,098.00</td></tr> <tr><td>2014</td><td>2014-660031111</td><td>COONS, TRACY L</td><td>1</td><td>123,341</td><td>0</td><td>11,702</td><td>1,059.00</td></tr> <tr><td>2013</td><td>2013-660031111</td><td>COONS, TRACY L</td><td>1</td><td>116,200</td><td>0</td><td>11,145</td><td>998.00</td></tr> </tbody> </table>										Tax Year	Statement Number	Billed Owner	Tax Area	Total Value	Exemptions	Taxable Value	Billed Tax	2025	2025-660031111	O'BRIEN, TERESA L	1	184,315	0	20,275	2,163.00	2024	2024-660031111	O'BRIEN, TERESA L	1	205,192	0	21,236	2,240.00	2023	2023-660031111	O'BRIEN, TERESA L	1	183,864	0	20,225	2,076.00	2022	2022-660031111	O'BRIEN, TERESA L	1	187,731	0	19,652	1,973.00	2021	2021-660031111	O'BRIEN, TERESA L	1	170,150	0	18,717	1,647.00	2020	2020-660031111	O'BRIEN, TERESA L	1	164,019	0	18,000	1,594.00	2019	2019-660031111	O'BRIEN, TERESA L	1	155,846	0	17,143	1,539.00	2018	2018-660031111	O'BRIEN, TERESA L	1	154,953	0	17,045	1,521.00	2017	2017-660031111	O'BRIEN, TERESA L	1	153,602	0	16,896	1,526.00	2016	2016-660031111	O'BRIEN, TERESA L	1	124,102	1000	12,651	1,125.00	2015	2015-660031111	RECTOR, FREDDIE L	1	120,972	0	12,287	1,098.00	2014	2014-660031111	COONS, TRACY L	1	123,341	0	11,702	1,059.00	2013	2013-660031111	COONS, TRACY L	1	116,200	0	11,145	998.00
Tax Year	Statement Number	Billed Owner	Tax Area	Total Value	Exemptions	Taxable Value	Billed Tax																																																																																																																		
2025	2025-660031111	O'BRIEN, TERESA L	1	184,315	0	20,275	2,163.00																																																																																																																		
2024	2024-660031111	O'BRIEN, TERESA L	1	205,192	0	21,236	2,240.00																																																																																																																		
2023	2023-660031111	O'BRIEN, TERESA L	1	183,864	0	20,225	2,076.00																																																																																																																		
2022	2022-660031111	O'BRIEN, TERESA L	1	187,731	0	19,652	1,973.00																																																																																																																		
2021	2021-660031111	O'BRIEN, TERESA L	1	170,150	0	18,717	1,647.00																																																																																																																		
2020	2020-660031111	O'BRIEN, TERESA L	1	164,019	0	18,000	1,594.00																																																																																																																		
2019	2019-660031111	O'BRIEN, TERESA L	1	155,846	0	17,143	1,539.00																																																																																																																		
2018	2018-660031111	O'BRIEN, TERESA L	1	154,953	0	17,045	1,521.00																																																																																																																		
2017	2017-660031111	O'BRIEN, TERESA L	1	153,602	0	16,896	1,526.00																																																																																																																		
2016	2016-660031111	O'BRIEN, TERESA L	1	124,102	1000	12,651	1,125.00																																																																																																																		
2015	2015-660031111	RECTOR, FREDDIE L	1	120,972	0	12,287	1,098.00																																																																																																																		
2014	2014-660031111	COONS, TRACY L	1	123,341	0	11,702	1,059.00																																																																																																																		
2013	2013-660031111	COONS, TRACY L	1	116,200	0	11,145	998.00																																																																																																																		



# Rogers

## Assessment Property Record Card for Tax Year 2026

Data provided by LISA DELOZIER County Assessor

Date 04/16/2026  
Time 21:20:36  
Page 2

Lot Data	Square-Foot - NBHD 1193 #1	Primary Image
<b>Lot Size</b> <b>Lot Count</b> <b>Units Buildable</b> 1 <b>Non-Ag Acres</b> 0.234 <b>Topography</b> <b>Street Access</b> <b>Utilities</b> <b>Amenities</b> LAND QUALITY 0 0 <b>Method</b> Square-Foot <b>Base Lot Value</b> 10,191.00 x 3.96 = 40,401 <b>Factor Value</b> <b>Adjustments</b> 1.0000 <b>Lot Value</b> 40,401		 <p>\\tsclient\T\LOGAN\LOGAN RESIDENTIAL VI\2021-6-28\IMG_005; 6/28/2021</p>

Residential Data	
<b>Type</b>	1 Single Family Residence
<b>Condition</b>	3 - Average
<b>Quality</b>	2.5 - Fair
<b>Architecture</b>	TRAD TRADITIONAL
<b>Style</b>	100% One Story
<b>Exterior Wall</b>	40% Veneer, Stone 60% Frame, Siding, Vinyl
<b>Base/Total Area</b>	1,632 / 1,632
<b>Style</b>	100% One Story
<b>HVAC</b>	100% Warmed & Cooled Air
<b>Roof Cover</b>	1 Composition Shingle
<b>Area on Slab</b>	1,632
<b>Fixture/RghIn</b>	11 /
<b>Bed/F/H Bath</b>	3 / 2.0 /
<b>Basement Area</b>	
<b>Garage Type</b>	396 Attached Garage - Finished
<b>Remodel</b>	RMA -
<b>Year/Eff Age</b>	1980 / 25

Cost Approach		Manual : 01/2025	
<b>Base Cost</b>	96.84	<b>Total Misc Impr</b>	+ 5,677
<b>Roofing Adj</b>	+ 4.25	<b>Garage Cost</b>	+ 14,553
<b>Subfloor Adj</b>	+ -1.15	<b>Total RCN</b>	= 216,135
<b>Heat/Cool Adj</b>	+ 11.47	<b>Depreciation ( 34%)</b>	- 73,486
<b>Plumbing Adj</b>	+ 8.63	<b>Lump Sums</b>	+ 0
<b>Basement Adj</b>	+ 0.00	<b>RCNLD</b>	= 142,649
<b>Adj Base Cost</b>	= 120.04	<b>Lot Value</b>	+ 40,401
<b>Total Area</b>	x 1,632	<b>Indicated Value</b>	= 183,050
<b>Adjusted Cost</b>	= 195,905	<b>Value Per SqFt</b>	112.16

GRM Approach	
<b>GRM Code</b>	
<b>Gross Rent</b>	0.00
<b>Indicated Value</b>	

Multiple Regression			
<b>MRA Code</b>	1	Test	
<b>Adusted R</b>	0.8445		
<b>Indicated Value</b>	164,636	100.88	Per SqFt

Direct Comparables			
<b>Selection Model</b>	A	Adam Test	
<b>Adjustment Model</b>	1	2022 Residential	
<b>Comparables</b>	7		
<b>Indicated Value</b>	197,990		Per SqFt

Value Reconciliation			
<b>Selected Approach</b>	Cost Approach		
<b>Improvements</b>	142,649		
<b>Lot Value</b>	40,401		
<b>Indicated Value</b>	183,050	112.16	Per SqFt
<b>Agland Value</b>			
<b>Site Improvements</b>	2,399		
<b>Total Value</b>	185,449	113.63	Total Value Per SqFt

Miscellaneous Improvements								
Code	Description	Sketch ID	Size	Year	Units	Unit Cost	Depr	Value
FPR1	FIREPLACE - RESIDENTIAL 1 STORY	0		1	1	5,095.98		5,096
PRCH	SLAB PORCH - COVERED	73826		6x4	24	24.19		581



# Rogers

## Assessment Property Record Card for Tax Year 2026

Data provided by LISA DELOZIER County Assessor

Date 04/16/2026  
 Time 21:20:37  
 Page 3

### Sketch Image

660031111

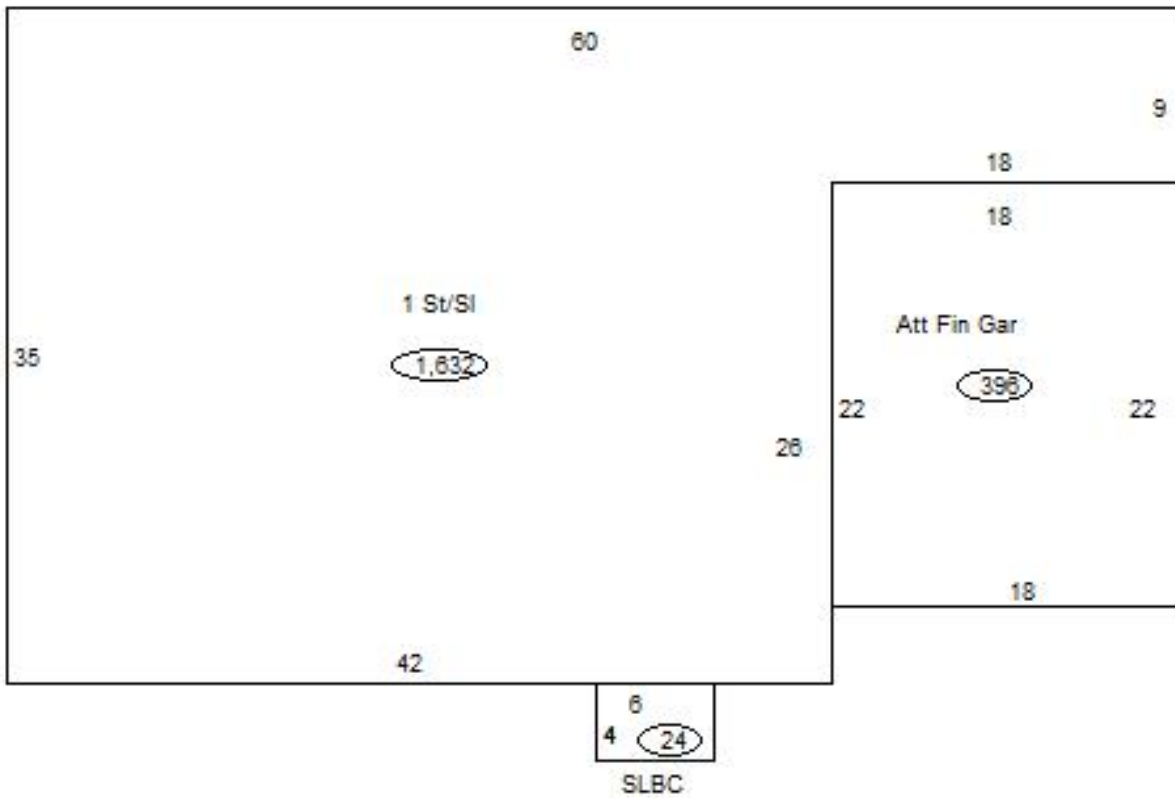

### Sketch Vector Information

Sequence	Code	Type	Built Over	Scale	Section Label	Base Area	Multiplier	Total Area
1	R	1	Slab	13	1 St/Sl	1,632	1.000	1,632
2	G	5		13	Att Fin Gar	396	1.000	396
3	M	PRCH		13	SLBC	24	1.000	24
<b>Total Building Area</b>						1,632		1,632



# Rogers

## Assessment Property Record Card for Tax Year 2026

Data provided by LISA DELOZIER County Assessor

Date 04/16/2026  
Time 21:20:37  
Page 4

660031111

### Outbuildings/Site Improvements

Building Image	Code	Description	Dimensions	Floor	Roofing	Total Units
	SHDS	Shed - Small	10x12x8	Plank	Composition Shingle	120
	Qual	3	Cond 3	Year 2020	Eff Age 5	

Valuation Summary	Modifier Total	RCN	Depr (23% Phys/ % Func)	RCNLD	
Base Cost (25.97 x 120)	3,116		3,116	717	2,399