



Rogers

Assessment Property Record Card for Tax Year 2026

Data provided by LISA DELOZIER County Assessor

Date 04/16/2026
Time 22:31:19
Page 1

Assessment Data					Primary Image																																																																																																																				
Account 660031155 Parcel ID 000000-00-0-20200-007-0015 Cadastral ID 36-20-14-03400 Property Type REAL - Real Property Property Class URP VI Area 3 Tax Area 1 - CATOOSA OT Name ID 340995 CONSIDINE, KYLE C & ALLEE L 18661 WOODCREST LN CATOOSA OK 74015-0000 Parcel Location Situs 18661 WOODCREST LN Subdivision WOODCREST ESTATES Lot/Block 0015 / 0007 Parcel Size 1 - Lots Sec/Twn/Rng 36 / 20 / 14 / 5 Neighborhood 1193 - R-V03-SW CATOOSA School District S002 - CATOOSA SCHOOLS					<p>660031173_001.JPG 10/15/2025</p>																																																																																																																				
Legal Description Lot/Long: 36.17621844 -95.76849166																																																																																																																									
LOT 15 BLOCK 7 WOODCREST ESTATES					Building Permits <table border="1"> <thead> <tr> <th>Number</th> <th>Description</th> <th>Opened</th> <th>Closed</th> <th>Amount</th> </tr> </thead> <tbody> <tr> <td> </td> <td> </td> <td> </td> <td> </td> <td> </td> </tr> </tbody> </table>					Number	Description	Opened	Closed	Amount																																																																																																											
Number	Description	Opened	Closed	Amount																																																																																																																					
Exemptions <table border="1"> <thead> <tr> <th>Code</th> <th>Type</th> <th>Active</th> <th>Maximum</th> <th>Exemption</th> </tr> </thead> <tbody> <tr> <td>H</td> <td>Homestead</td> <td>No</td> <td>1,000</td> <td> </td> </tr> </tbody> </table>					Code	Type	Active	Maximum	Exemption	H	Homestead	No	1,000		Sale History <table border="1"> <thead> <tr> <th>Bk/Pg</th> <th>Grantor</th> <th>Date</th> <th>Price</th> <th>Code</th> </tr> </thead> <tbody> <tr> <td>/</td> <td>CAYWOOD, DONALD</td> <td>02/22/2023</td> <td>250,000</td> <td>19</td> </tr> </tbody> </table>					Bk/Pg	Grantor	Date	Price	Code	/	CAYWOOD, DONALD	02/22/2023	250,000	19																																																																																												
Code	Type	Active	Maximum	Exemption																																																																																																																					
H	Homestead	No	1,000																																																																																																																						
Bk/Pg	Grantor	Date	Price	Code																																																																																																																					
/	CAYWOOD, DONALD	02/22/2023	250,000	19																																																																																																																					
Parcel Valuation <table border="1"> <thead> <tr> <th>Source</th> <th>REAL</th> <th>Fair Cash</th> <th>Capped</th> <th>Asmnt Level</th> <th>Assessed</th> <th>Levy Rate</th> <th>106.660</th> <th>Current Tax</th> </tr> </thead> <tbody> <tr> <td>Remove Cap</td> <td>2024</td> <td>Land Value 45,874</td> <td>45,874</td> <td>11%</td> <td>5,046</td> <td>Assessed</td> <td>28,716</td> <td>3,062.85</td> </tr> <tr> <td>Year Frozen</td> <td>2004</td> <td>Improvements 215,181</td> <td>215,181</td> <td> </td> <td>23,670</td> <td>Penalty</td> <td>0</td> <td> </td> </tr> <tr> <td>Uncapped Value</td> <td>0</td> <td>Mobile Home 0</td> <td>0</td> <td> </td> <td>0</td> <td>Exemption</td> <td>0</td> <td>0.00</td> </tr> <tr> <td>TIF Project ID</td> <td>0</td> <td>Total Value 261,055</td> <td>261,055</td> <td> </td> <td>28,716</td> <td>Total Taxable</td> <td>28,716</td> <td>3,063.00</td> </tr> </tbody> </table>										Source	REAL	Fair Cash	Capped	Asmnt Level	Assessed	Levy Rate	106.660	Current Tax	Remove Cap	2024	Land Value 45,874	45,874	11%	5,046	Assessed	28,716	3,062.85	Year Frozen	2004	Improvements 215,181	215,181		23,670	Penalty	0		Uncapped Value	0	Mobile Home 0	0		0	Exemption	0	0.00	TIF Project ID	0	Total Value 261,055	261,055		28,716	Total Taxable	28,716	3,063.00																																																																			
Source	REAL	Fair Cash	Capped	Asmnt Level	Assessed	Levy Rate	106.660	Current Tax																																																																																																																	
Remove Cap	2024	Land Value 45,874	45,874	11%	5,046	Assessed	28,716	3,062.85																																																																																																																	
Year Frozen	2004	Improvements 215,181	215,181		23,670	Penalty	0																																																																																																																		
Uncapped Value	0	Mobile Home 0	0		0	Exemption	0	0.00																																																																																																																	
TIF Project ID	0	Total Value 261,055	261,055		28,716	Total Taxable	28,716	3,063.00																																																																																																																	
Assessment History <table border="1"> <thead> <tr> <th>Tax Year</th> <th>Statement Number</th> <th>Billed Owner</th> <th>Tax Area</th> <th>Total Value</th> <th>Exemptions</th> <th>Taxable Value</th> <th>Billed Tax</th> </tr> </thead> <tbody> <tr><td>2025</td><td>2025-660031155</td><td>CONSIDINE, KYLE C &</td><td>1</td><td>252,482</td><td>0</td><td>27,773</td><td>2,962.00</td></tr> <tr><td>2024</td><td>2024-660031155</td><td>CONSIDINE, KYLE C &</td><td>1</td><td>266,680</td><td>0</td><td>29,334</td><td>3,094.00</td></tr> <tr><td>2023</td><td>2023-660031155</td><td>CONSIDINE, KYLE C &</td><td>1</td><td>253,768</td><td>0</td><td>18,845</td><td>1,934.00</td></tr> <tr><td>2022</td><td>2022-660031155</td><td>CAYWOOD, DONALD</td><td>1</td><td>253,762</td><td>1000</td><td>16,949</td><td>1,701.00</td></tr> <tr><td>2021</td><td>2021-660031155</td><td>CAYWOOD, DONALD</td><td>1</td><td>264,866</td><td>1000</td><td>16,949</td><td>1,491.00</td></tr> <tr><td>2020</td><td>2020-660031155</td><td>CAYWOOD, DONALD</td><td>1</td><td>258,061</td><td>1000</td><td>16,948</td><td>1,501.00</td></tr> <tr><td>2019</td><td>2019-660031155</td><td>CAYWOOD, DONALD</td><td>1</td><td>244,423</td><td>1000</td><td>16,948</td><td>1,522.00</td></tr> <tr><td>2018</td><td>2018-660031155</td><td>CAYWOOD, DONALD</td><td>1</td><td>247,057</td><td>1000</td><td>16,948</td><td>1,513.00</td></tr> <tr><td>2017</td><td>2017-660031155</td><td>CAYWOOD, DONALD</td><td>1</td><td>291,130</td><td>1000</td><td>16,948</td><td>1,530.00</td></tr> <tr><td>2016</td><td>2016-660031155</td><td>CAYWOOD, DONALD</td><td>1</td><td>283,031</td><td>1000</td><td>16,948</td><td>1,507.00</td></tr> <tr><td>2015</td><td>2015-660031155</td><td>CAYWOOD, DONALD</td><td>1</td><td>278,121</td><td>1000</td><td>16,948</td><td>1,515.00</td></tr> <tr><td>2014</td><td>2014-660031155</td><td>CAYWOOD, DONALD</td><td>1</td><td>285,104</td><td>1000</td><td>16,948</td><td>1,533.00</td></tr> <tr><td>2013</td><td>2013-660031155</td><td>CAYWOOD, DONALD</td><td>1</td><td>266,814</td><td>1000</td><td>16,949</td><td>1,517.00</td></tr> </tbody> </table>										Tax Year	Statement Number	Billed Owner	Tax Area	Total Value	Exemptions	Taxable Value	Billed Tax	2025	2025-660031155	CONSIDINE, KYLE C &	1	252,482	0	27,773	2,962.00	2024	2024-660031155	CONSIDINE, KYLE C &	1	266,680	0	29,334	3,094.00	2023	2023-660031155	CONSIDINE, KYLE C &	1	253,768	0	18,845	1,934.00	2022	2022-660031155	CAYWOOD, DONALD	1	253,762	1000	16,949	1,701.00	2021	2021-660031155	CAYWOOD, DONALD	1	264,866	1000	16,949	1,491.00	2020	2020-660031155	CAYWOOD, DONALD	1	258,061	1000	16,948	1,501.00	2019	2019-660031155	CAYWOOD, DONALD	1	244,423	1000	16,948	1,522.00	2018	2018-660031155	CAYWOOD, DONALD	1	247,057	1000	16,948	1,513.00	2017	2017-660031155	CAYWOOD, DONALD	1	291,130	1000	16,948	1,530.00	2016	2016-660031155	CAYWOOD, DONALD	1	283,031	1000	16,948	1,507.00	2015	2015-660031155	CAYWOOD, DONALD	1	278,121	1000	16,948	1,515.00	2014	2014-660031155	CAYWOOD, DONALD	1	285,104	1000	16,948	1,533.00	2013	2013-660031155	CAYWOOD, DONALD	1	266,814	1000	16,949	1,517.00
Tax Year	Statement Number	Billed Owner	Tax Area	Total Value	Exemptions	Taxable Value	Billed Tax																																																																																																																		
2025	2025-660031155	CONSIDINE, KYLE C &	1	252,482	0	27,773	2,962.00																																																																																																																		
2024	2024-660031155	CONSIDINE, KYLE C &	1	266,680	0	29,334	3,094.00																																																																																																																		
2023	2023-660031155	CONSIDINE, KYLE C &	1	253,768	0	18,845	1,934.00																																																																																																																		
2022	2022-660031155	CAYWOOD, DONALD	1	253,762	1000	16,949	1,701.00																																																																																																																		
2021	2021-660031155	CAYWOOD, DONALD	1	264,866	1000	16,949	1,491.00																																																																																																																		
2020	2020-660031155	CAYWOOD, DONALD	1	258,061	1000	16,948	1,501.00																																																																																																																		
2019	2019-660031155	CAYWOOD, DONALD	1	244,423	1000	16,948	1,522.00																																																																																																																		
2018	2018-660031155	CAYWOOD, DONALD	1	247,057	1000	16,948	1,513.00																																																																																																																		
2017	2017-660031155	CAYWOOD, DONALD	1	291,130	1000	16,948	1,530.00																																																																																																																		
2016	2016-660031155	CAYWOOD, DONALD	1	283,031	1000	16,948	1,507.00																																																																																																																		
2015	2015-660031155	CAYWOOD, DONALD	1	278,121	1000	16,948	1,515.00																																																																																																																		
2014	2014-660031155	CAYWOOD, DONALD	1	285,104	1000	16,948	1,533.00																																																																																																																		
2013	2013-660031155	CAYWOOD, DONALD	1	266,814	1000	16,949	1,517.00																																																																																																																		



Rogers

Assessment Property Record Card for Tax Year 2026

Data provided by LISA DELOZIER County Assessor

Date 04/16/2026
 Time 22:31:20
 Page 2

Lot Data	Square-Foot - NBHD 1193 #1	Primary Image
Lot Size Lot Count Units Buildable 1 Non-Ag Acres 0.2938 Topography Street Access Utilities Amenities LAND QUALITY 0 0 Method Square-Foot Base Lot Value 12,797.00 x 3.58 = 45,874 Factor Value Adjustments 1.0000 Lot Value 45,874		

Residential Data	
Type	1 Single Family Residence
Condition	2.5 - Fair
Quality	3.5 - Average
Architecture	TRAD TRADITIONAL
Style	100% 1 1/2 Story Finished
Exterior Wall	90% Frame, Siding, Wood 10% Veneer, Stone
Base/Total Area	1,748 / 2,912
Style	100% 1 1/2 Story Finished
HVAC	100% Warmed & Cooled Air
Roof Cover	1 Composition Shingle
Area on Slab	1,748
Fixture/RghIn	14 /
Bed/F/H Bath	3 / 2.5 /
Basement Area	
Garage Type	520 Attached Garage - Finished
Remodel	
Year/Eff Age	1980 / 41



\\tsclient\T\LOGAN\LOGAN RESIDENTIAL VI\2021-6-29\IMG_006 6/29/2021

GRM Approach	
GRM Code	
Gross Rent	0.00
Indicated Value	

Multiple Regression			
MRA Code	1	Test	
Adjusted R	0.8445		
Indicated Value	323,298	111.02	Per SqFt

Direct Comparables	
Selection Model	A Adam Test
Adjustment Model	1 2022 Residential
Comparables	3
Indicated Value	320,910 Per SqFt

Cost Approach				Manual : 01/2025			
Base Cost	88.25	Total Misc Impr	+	9,659			
Roofing Adj	+ 3.16	Garage Cost	+	25,719			
Subfloor Adj	+ -2.04	Total RCN	=	360,095			
Heat/Cool Adj	+ 14.47	Depreciation (47%)	-	169,245			
Plumbing Adj	+ 7.67	Lump Sums	+	24,331			
Basement Adj	+ 0.00	RCNLD	=	215,181			
Adj Base Cost	= 111.51	Lot Value	+	45,874			
Total Area	x 2,912	Indicated Value	=	261,055			
Adjusted Cost	= 324,717	Value Per SqFt		89.65			

Value Reconciliation			
Selected Approach	Cost Approach		
Improvements	215,181		
Lot Value	45,874		
Indicated Value	261,055	89.65	Per SqFt
Agland Value			
Site Improvements			
Total Value	261,055	89.65	Total Value Per SqFt

Miscellaneous Improvements								
Code	Description	Sketch ID	Size	Year	Units	Unit Cost	Depr	Value
@N15.6SUBTERRN GARAGE		0	252		252	15.60		3,931
FPR1 FIREPLACE - RESIDENTIAL 1 STORY		0	1		1	6,429.63		6,430
@N21.4BASEMENT, REC FIN 28X38		0	1064		1,064	21.40	23%	17,533
PRCH SLAB PORCH - COVERED		73976	12x5		60	29.34		1,760
PRCH SLAB PORCH - COVERED		73977	10x5		50	29.37		1,469
WODO WOOD DECK - OPEN		73978	296		296	19.37	50%	2,867



Rogers

Assessment Property Record Card for Tax Year 2026

Data provided by LISA DELOZIER County Assessor

Date 04/16/2026
 Time 22:31:20
 Page 3

Sketch Image

660031155

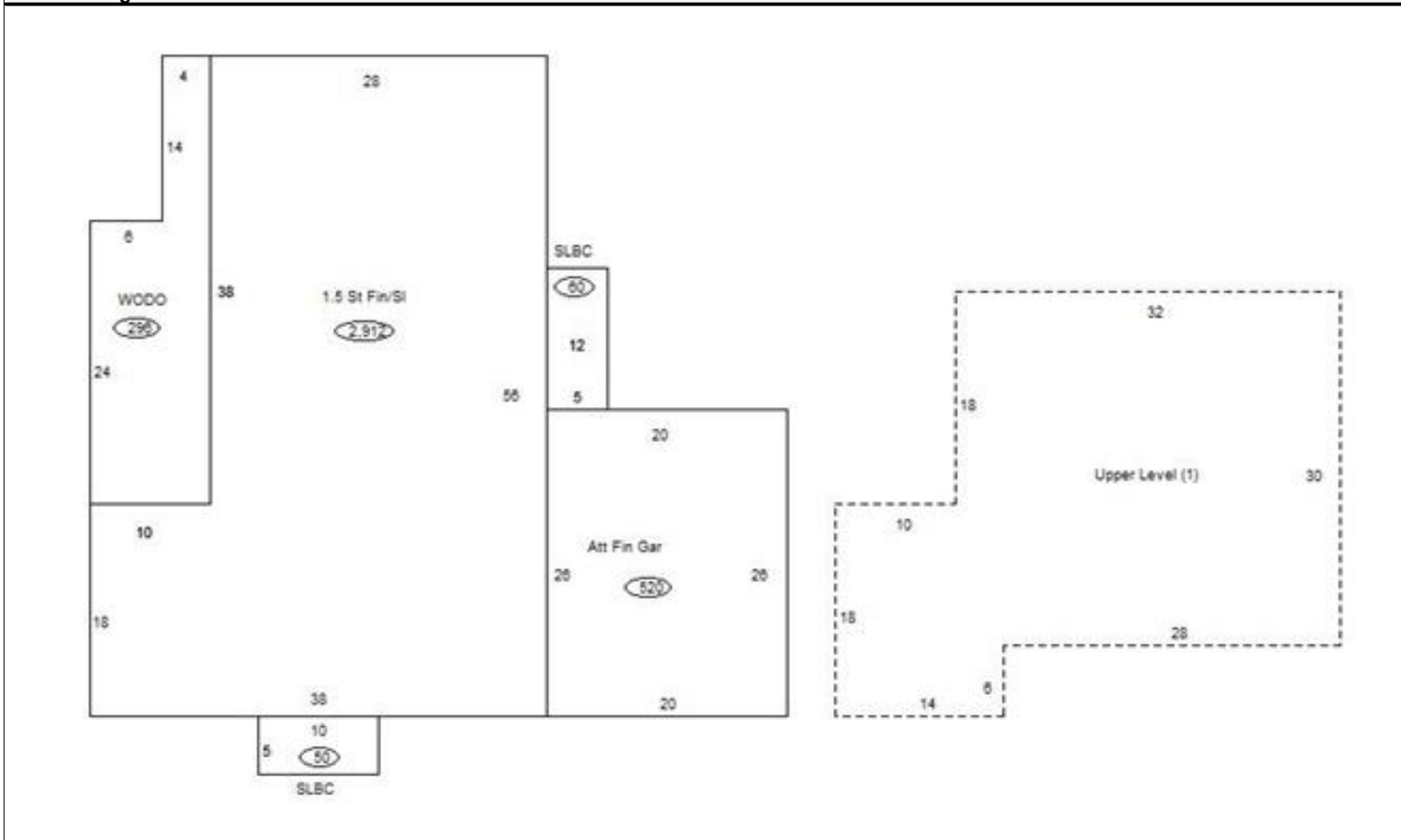

Sketch Vector Information

Sequence	Code	Type	Built Over	Scale	Section Label	Base Area	Multiplier	Total Area
1	R	5	Slab	13	1.5 St Fin/Sl	1,748	1.666	2,912
2	G	5		13	Att Fin Gar	520	1.000	520
3	M	PRCH		13	SLBC	60	1.000	60
4	M	PRCH		13	SLBC	50	1.000	50
5	M	WODO		13	WODO	296	1.000	296
6	U	^UL		13	Upper Level (1)	1,164	1.000	1,164
Total Building Area						1,748		2,912