



Rogers

Assessment Property Record Card for Tax Year 2026

Data provided by LISA DELOZIER County Assessor

Date 04/18/2026
 Time 08:12:44
 Page 1

Assessment Data					Primary Image																																																																																																																				
Account 660031366 Parcel ID 000000-00-0-00675-003-0001 Cadastral ID 36-20-16-01590 Property Type REAL - Real Property Property Class RRP VI Area 3 Tax Area 2 - INOLA RURAL Name ID 311794 FORRESTER, NICK & KIMBERLY 15925 E RIGGS RD INOLA OK 74036-0000 Parcel Location Situs 15925 E RIGGS RD Subdivision RIGGS ACRES Lot/Block 0001 / 0003 Parcel Size 1 - Lots Sec/Twn/Rng 36 / 20 / 16 / 5 Neighborhood 1125 - R-V03-SW INOLA School District S005 - INOLA SCHOOLS																																																																																																																									
Legal Description Lot/Long: 36.16603141 -95.54759373 LOT 1 BLOCK 3 RIGGS ACRES																																																																																																																									
Exemptions					Building Permits																																																																																																																				
<table border="1"> <thead> <tr> <th>Code</th> <th>Type</th> <th>Active</th> <th>Maximum</th> <th>Exemption</th> </tr> </thead> <tbody> <tr> <td></td> <td></td> <td></td> <td></td> <td></td> </tr> </tbody> </table>					Code	Type	Active	Maximum	Exemption						<table border="1"> <thead> <tr> <th>Number</th> <th>Description</th> <th>Opened</th> <th>Closed</th> <th>Amount</th> </tr> </thead> <tbody> <tr> <td></td> <td></td> <td></td> <td></td> <td></td> </tr> </tbody> </table>					Number	Description	Opened	Closed	Amount																																																																																																	
Code	Type	Active	Maximum	Exemption																																																																																																																					
Number	Description	Opened	Closed	Amount																																																																																																																					
<table border="1"> <thead> <tr> <th>Code</th> <th>Type</th> <th>Active</th> <th>Maximum</th> <th>Exemption</th> </tr> </thead> <tbody> <tr> <td></td> <td></td> <td></td> <td></td> <td></td> </tr> </tbody> </table>					Code	Type	Active	Maximum	Exemption						Sale History <table border="1"> <thead> <tr> <th>Bk/Pg</th> <th>Grantor</th> <th>Date</th> <th>Price</th> <th>Code</th> </tr> </thead> <tbody> <tr> <td>2388/430</td> <td>RIFF, STEVE</td> <td>02/19/2014</td> <td>125,000</td> <td>YES</td> </tr> <tr> <td>2264/644</td> <td>FEDERAL NATIONAL MORTGAGE ASS</td> <td>08/08/2012</td> <td>55,000</td> <td>3</td> </tr> <tr> <td>2226/220</td> <td>SANFORD, JOEY D</td> <td>02/13/2012</td> <td>0</td> <td>10</td> </tr> <tr> <td>1582/640</td> <td>DILL, RICHARD BARCLAY &</td> <td>04/22/2004</td> <td>102,000</td> <td>YES</td> </tr> <tr> <td>1093/297</td> <td>RASH, BRIAN & LEANN</td> <td>12/24/1997</td> <td>74,000</td> <td>Yes</td> </tr> <tr> <td>905/506</td> <td>CRIMMINS, LETA D</td> <td>02/01/1993</td> <td>56,000</td> <td>Yes</td> </tr> </tbody> </table>					Bk/Pg	Grantor	Date	Price	Code	2388/430	RIFF, STEVE	02/19/2014	125,000	YES	2264/644	FEDERAL NATIONAL MORTGAGE ASS	08/08/2012	55,000	3	2226/220	SANFORD, JOEY D	02/13/2012	0	10	1582/640	DILL, RICHARD BARCLAY &	04/22/2004	102,000	YES	1093/297	RASH, BRIAN & LEANN	12/24/1997	74,000	Yes	905/506	CRIMMINS, LETA D	02/01/1993	56,000	Yes																																																																			
Code	Type	Active	Maximum	Exemption																																																																																																																					
Bk/Pg	Grantor	Date	Price	Code																																																																																																																					
2388/430	RIFF, STEVE	02/19/2014	125,000	YES																																																																																																																					
2264/644	FEDERAL NATIONAL MORTGAGE ASS	08/08/2012	55,000	3																																																																																																																					
2226/220	SANFORD, JOEY D	02/13/2012	0	10																																																																																																																					
1582/640	DILL, RICHARD BARCLAY &	04/22/2004	102,000	YES																																																																																																																					
1093/297	RASH, BRIAN & LEANN	12/24/1997	74,000	Yes																																																																																																																					
905/506	CRIMMINS, LETA D	02/01/1993	56,000	Yes																																																																																																																					
Parcel Valuation <table border="1"> <thead> <tr> <th>Source</th> <th>REAL</th> <th>Fair Cash</th> <th>Capped</th> <th>Asmnt Level</th> <th>Assessed</th> <th>Levy Rate</th> <th>80.060</th> <th>Current Tax</th> </tr> </thead> <tbody> <tr> <td>Remove Cap</td> <td>2015</td> <td>Land Value 82,525</td> <td>33,109</td> <td>11%</td> <td>3,642</td> <td>Assessed</td> <td>16,388</td> <td>1,312.02</td> </tr> <tr> <td>Year Frozen</td> <td>0</td> <td>Improvements 125,720</td> <td>115,876</td> <td></td> <td>12,746</td> <td>Penalty</td> <td>0</td> <td></td> </tr> <tr> <td>Uncapped Value</td> <td>0</td> <td>Mobile Home 0</td> <td>0</td> <td></td> <td>0</td> <td>Exemption</td> <td>0</td> <td>0.00</td> </tr> <tr> <td>TIF Project ID</td> <td>0</td> <td>Total Value 208,245</td> <td>148,985</td> <td></td> <td>16,388</td> <td>Total Taxable</td> <td>16,388</td> <td>1,312.00</td> </tr> </tbody> </table>										Source	REAL	Fair Cash	Capped	Asmnt Level	Assessed	Levy Rate	80.060	Current Tax	Remove Cap	2015	Land Value 82,525	33,109	11%	3,642	Assessed	16,388	1,312.02	Year Frozen	0	Improvements 125,720	115,876		12,746	Penalty	0		Uncapped Value	0	Mobile Home 0	0		0	Exemption	0	0.00	TIF Project ID	0	Total Value 208,245	148,985		16,388	Total Taxable	16,388	1,312.00																																																																			
Source	REAL	Fair Cash	Capped	Asmnt Level	Assessed	Levy Rate	80.060	Current Tax																																																																																																																	
Remove Cap	2015	Land Value 82,525	33,109	11%	3,642	Assessed	16,388	1,312.02																																																																																																																	
Year Frozen	0	Improvements 125,720	115,876		12,746	Penalty	0																																																																																																																		
Uncapped Value	0	Mobile Home 0	0		0	Exemption	0	0.00																																																																																																																	
TIF Project ID	0	Total Value 208,245	148,985		16,388	Total Taxable	16,388	1,312.00																																																																																																																	
Assessment History <table border="1"> <thead> <tr> <th>Tax Year</th> <th>Statement Number</th> <th>Billed Owner</th> <th>Tax Area</th> <th>Total Value</th> <th>Exemptions</th> <th>Taxable Value</th> <th>Billed Tax</th> </tr> </thead> <tbody> <tr><td>2025</td><td>2025-660031366</td><td>FORRESTER, NICK &</td><td>2</td><td>192,884</td><td>0</td><td>15,608</td><td>1,250.00</td></tr> <tr><td>2024</td><td>2024-660031366</td><td>FORRESTER, NICK &</td><td>2</td><td>194,831</td><td>0</td><td>14,864</td><td>1,195.00</td></tr> <tr><td>2023</td><td>2023-660031366</td><td>FORRESTER, NICK &</td><td>2</td><td>128,700</td><td>0</td><td>14,157</td><td>1,140.00</td></tr> <tr><td>2022</td><td>2022-660031366</td><td>FORRESTER, NICK &</td><td>2</td><td>130,569</td><td>0</td><td>14,363</td><td>1,165.00</td></tr> <tr><td>2021</td><td>2021-660031366</td><td>FORRESTER, NICK &</td><td>2</td><td>136,355</td><td>0</td><td>14,999</td><td>1,202.00</td></tr> <tr><td>2020</td><td>2020-660031366</td><td>FORRESTER, NICK &</td><td>2</td><td>135,606</td><td>0</td><td>14,917</td><td>1,205.00</td></tr> <tr><td>2019</td><td>2019-660031366</td><td>FORRESTER, NICK &</td><td>2</td><td>129,267</td><td>0</td><td>14,219</td><td>1,175.00</td></tr> <tr><td>2018</td><td>2018-660031366</td><td>FORRESTER, NICK &</td><td>2</td><td>133,090</td><td>0</td><td>14,640</td><td>1,222.00</td></tr> <tr><td>2017</td><td>2017-660031366</td><td>FORRESTER, NICK &</td><td>2</td><td>131,870</td><td>0</td><td>14,506</td><td>1,221.00</td></tr> <tr><td>2016</td><td>2016-660031366</td><td>FORRESTER, NICK &</td><td>2</td><td>128,667</td><td>0</td><td>14,153</td><td>1,204.00</td></tr> <tr><td>2015</td><td>2015-660031366</td><td>FORRESTER, NICK &</td><td>2</td><td>124,785</td><td>0</td><td>13,726</td><td>1,191.00</td></tr> <tr><td>2014</td><td>2014-660031366</td><td>FORRESTER, NICK &</td><td>2</td><td>105,754</td><td>0</td><td>10,981</td><td>986.00</td></tr> <tr><td>2013</td><td>2013-660031366</td><td>RIFF, STEVE</td><td>2</td><td>95,070</td><td>0</td><td>10,458</td><td>881.00</td></tr> </tbody> </table>										Tax Year	Statement Number	Billed Owner	Tax Area	Total Value	Exemptions	Taxable Value	Billed Tax	2025	2025-660031366	FORRESTER, NICK &	2	192,884	0	15,608	1,250.00	2024	2024-660031366	FORRESTER, NICK &	2	194,831	0	14,864	1,195.00	2023	2023-660031366	FORRESTER, NICK &	2	128,700	0	14,157	1,140.00	2022	2022-660031366	FORRESTER, NICK &	2	130,569	0	14,363	1,165.00	2021	2021-660031366	FORRESTER, NICK &	2	136,355	0	14,999	1,202.00	2020	2020-660031366	FORRESTER, NICK &	2	135,606	0	14,917	1,205.00	2019	2019-660031366	FORRESTER, NICK &	2	129,267	0	14,219	1,175.00	2018	2018-660031366	FORRESTER, NICK &	2	133,090	0	14,640	1,222.00	2017	2017-660031366	FORRESTER, NICK &	2	131,870	0	14,506	1,221.00	2016	2016-660031366	FORRESTER, NICK &	2	128,667	0	14,153	1,204.00	2015	2015-660031366	FORRESTER, NICK &	2	124,785	0	13,726	1,191.00	2014	2014-660031366	FORRESTER, NICK &	2	105,754	0	10,981	986.00	2013	2013-660031366	RIFF, STEVE	2	95,070	0	10,458	881.00
Tax Year	Statement Number	Billed Owner	Tax Area	Total Value	Exemptions	Taxable Value	Billed Tax																																																																																																																		
2025	2025-660031366	FORRESTER, NICK &	2	192,884	0	15,608	1,250.00																																																																																																																		
2024	2024-660031366	FORRESTER, NICK &	2	194,831	0	14,864	1,195.00																																																																																																																		
2023	2023-660031366	FORRESTER, NICK &	2	128,700	0	14,157	1,140.00																																																																																																																		
2022	2022-660031366	FORRESTER, NICK &	2	130,569	0	14,363	1,165.00																																																																																																																		
2021	2021-660031366	FORRESTER, NICK &	2	136,355	0	14,999	1,202.00																																																																																																																		
2020	2020-660031366	FORRESTER, NICK &	2	135,606	0	14,917	1,205.00																																																																																																																		
2019	2019-660031366	FORRESTER, NICK &	2	129,267	0	14,219	1,175.00																																																																																																																		
2018	2018-660031366	FORRESTER, NICK &	2	133,090	0	14,640	1,222.00																																																																																																																		
2017	2017-660031366	FORRESTER, NICK &	2	131,870	0	14,506	1,221.00																																																																																																																		
2016	2016-660031366	FORRESTER, NICK &	2	128,667	0	14,153	1,204.00																																																																																																																		
2015	2015-660031366	FORRESTER, NICK &	2	124,785	0	13,726	1,191.00																																																																																																																		
2014	2014-660031366	FORRESTER, NICK &	2	105,754	0	10,981	986.00																																																																																																																		
2013	2013-660031366	RIFF, STEVE	2	95,070	0	10,458	881.00																																																																																																																		



Rogers

Assessment Property Record Card for Tax Year 2026

Data provided by LISA DELOZIER County Assessor

Date 04/18/2026
 Time 08:12:44
 Page 2

Lot Data		Square-Foot - NBHD 1125 #1	
Lot Size			
Lot Count			
Units Buildable	8500		
Non-Ag Acres	1.9843		
Topography			
Street Access			
Utilities			
Amenities	LAND QUALITY	0	
		0	
Method	Square-Foot		
Base Lot Value	86,438.00 x .95 = 82,525		
Factor Value			
Adjustments	1.0000		
Lot Value	82,525		



\\tsclient\C\Users\Randy Necessary\Pictures\101_1018\IMG_0001. 10/19/2021

Residential Data	
Type	1 Single Family Residence
Condition	3 - Average
Quality	2.5 - Fair
Architecture	TRAD TRADITIONAL
Style	100% One Story
Exterior Wall	100% Veneer, Masonry
Base/Total Area	1,286 / 1,286
Style	100% One Story
HVAC	100% Warmed & Cooled Air
Roof Cover	1 Composition Shingle
Area on Slab	1,286
Fixture/RghIn	11 /
Bed/F/H Bath	3 / 2.0 /
Basement Area	
Garage Type	468 Attached Garage - Unfinished
Remodel	
Year/Eff Age	1978 / 36

GRM Approach	
GRM Code	
Gross Rent	0.00
Indicated Value	

Multiple Regression			
MRA Code	1	Test	
Adusted R	0.8445		
Indicated Value	145,567	113.19	Per SqFt

Direct Comparables			
Selection Model	A	Adam Test	
Adjustment Model	1	2022 Residential	
Comparables	1		
Indicated Value	28,930		Per SqFt

Cost Approach		Manual : 01/2025	
Base Cost	110.58	Total Misc Impr	+ 11,285
Roofing Adj	+ 4.66	Garage Cost	+ 13,048
Subfloor Adj	+ -1.21	Total RCN	= 199,795
Heat/Cool Adj	+ 11.47	Depreciation (45%)	- 89,908
Plumbing Adj	+ 10.94	Lump Sums	+ 15,833
Basement Adj	+ 0.00	RCNLD	= 125,720
Adj Base Cost	= 136.44	Lot Value	+ 82,525
Total Area	x 1,286	Indicated Value	= 208,245
Adjusted Cost	= 175,462	Value Per SqFt	161.93

Value Reconciliation			
Selected Approach	Cost Approach		
Improvements	125,720		
Lot Value	82,525		
Indicated Value	208,245	161.93	Per SqFt
Agland Value			
Site Improvements			
Total Value	208,245	161.93	Total Value Per SqFt

Miscellaneous Improvements								
Code	Description	Sketch ID	Size	Year	Units	Unit Cost	Depr	Value
SHLT	STORM SHELTER	0		1	2018	1	0.00	
PRCH	Slab Porch - Covered	74629	18x14			252	23.40	5,897
PATO	Slab Porch - Open	74630	14x14			196	10.02	1,964
PRCH	Slab Porch - Covered	74631	144			144	23.78	3,424
GRDT	Garage - Detached	181249	30x24			720	21.99	15,833



Rogers

Assessment Property Record Card for Tax Year 2026

Data provided by LISA DELOZIER County Assessor

Date 04/18/2026

Time 08:12:44

Page 3

Sketch Image

660031366

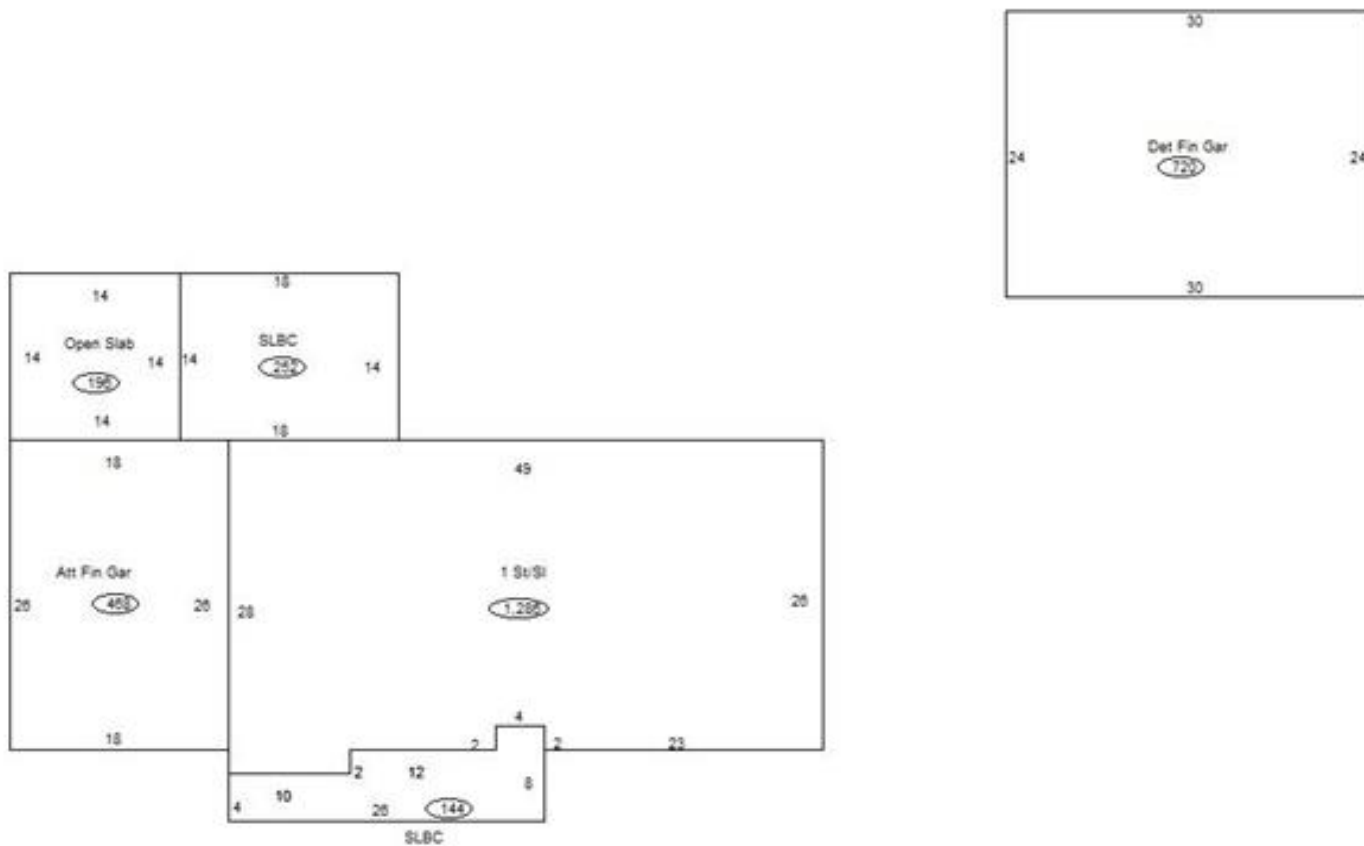

Sketch Vector Information

Sequence	Code	Type	Built Over	Scale	Section Label	Base Area	Multiplier	Total Area
1	R	1	Slab	13	1 St/SI	1,286	1.000	1,286
2	G	5	Slab	13	Att Fin Gar	468	1.000	468
3	M	PRCH		13	SLBC	252	1.000	252
4	M	PATO		13	Open Slab	196	1.000	196
5	M	PRCH		13	SLBC	144	1.000	144
6	G	6		13	Det Fin Gar	720	1.000	720
Total Building Area						1,286		1,286