



# Rogers

## Assessment Property Record Card for Tax Year 2026

Data provided by LISA DELOZIER County Assessor

Date 04/17/2026  
 Time 18:14:10  
 Page 1

Assessment Data					Primary Image																																																																																																																				
<b>Account</b> 660031438 <b>Parcel ID</b> 21N15E-36-3-00000-000-0000 <b>Cadastral ID</b> 36-21-15-05700 <b>Property Type</b> REAL - Real Property <b>Property Class</b> RCL VI Area 4 <b>Tax Area</b> 4 - VERDIGRIS/VERD FIRE <b>Name ID</b> 337536 OKLAHOMA EMERGENCY VEHICLES LLC  PO BOX 3054 CLAREMORE OK 74018-0000  <b>Parcel Location</b> <b>Situs</b> 24808 S AMAH PKWY <b>Subdivision</b> <b>Lot/Block</b> / <b>Parcel Size</b> 2 - Acres <b>Sec/Twn/Rng</b> 36 / 21 / 15 / 3 <b>Neighborhood</b> 5001 - TASC 2016 <b>School District</b> S008 - VERDIGRIS SCHOOLS																																																																																																																									
<b>Legal Description</b> Lat/Long: 36.25402098 -95.66774437										REVAL 2023 5/20/2022																																																																																																															
<b>Legal Description</b> TR IN SW NW SW, START AT A PT 1654.99' N SW/C S 66-44-19 E 73.65' TO POB, N 44-00 E 378. 17', S 48-50-45 E 280.28' M/L TO A PT ON NLY ROW/L OF ACCESS RD, SWLY ALG SD ROW/L 296.87', N 66-44-19 W 272.91' TO POB					<b>Building Permits</b> <table border="1"> <thead> <tr> <th>Number</th> <th>Description</th> <th>Opened</th> <th>Closed</th> <th>Amount</th> </tr> </thead> <tbody> <tr> <td></td> <td></td> <td></td> <td></td> <td></td> </tr> </tbody> </table>					Number	Description	Opened	Closed	Amount																																																																																																											
Number	Description	Opened	Closed	Amount																																																																																																																					
<b>Exemptions</b> <table border="1"> <thead> <tr> <th>Code</th> <th>Type</th> <th>Active</th> <th>Maximum</th> <th>Exemption</th> </tr> </thead> <tbody> <tr> <td></td> <td></td> <td></td> <td></td> <td></td> </tr> </tbody> </table>					Code	Type	Active	Maximum	Exemption						<b>Sale History</b> <table border="1"> <thead> <tr> <th>Bk/Pg</th> <th>Grantor</th> <th>Date</th> <th>Price</th> <th>Code</th> </tr> </thead> <tbody> <tr> <td>/</td> <td>JARVIS, MICHAEL R &amp;</td> <td>03/03/2022</td> <td>25,000</td> <td>5</td> </tr> <tr> <td>2470/194</td> <td>JARVIS, MICHAEL &amp;</td> <td>04/24/2015</td> <td>0</td> <td>4</td> </tr> <tr> <td>1659/596</td> <td>COOK, WAYNE P</td> <td>02/25/2005</td> <td>72,500</td> <td>YES</td> </tr> </tbody> </table>					Bk/Pg	Grantor	Date	Price	Code	/	JARVIS, MICHAEL R &	03/03/2022	25,000	5	2470/194	JARVIS, MICHAEL &	04/24/2015	0	4	1659/596	COOK, WAYNE P	02/25/2005	72,500	YES																																																																																		
Code	Type	Active	Maximum	Exemption																																																																																																																					
Bk/Pg	Grantor	Date	Price	Code																																																																																																																					
/	JARVIS, MICHAEL R &	03/03/2022	25,000	5																																																																																																																					
2470/194	JARVIS, MICHAEL &	04/24/2015	0	4																																																																																																																					
1659/596	COOK, WAYNE P	02/25/2005	72,500	YES																																																																																																																					
<b>Parcel Valuation</b> <table border="1"> <thead> <tr> <th>Source</th> <th>REAL</th> <th>Fair Cash</th> <th>Capped</th> <th>Asmnt Level</th> <th>Assessed</th> <th>Levy Rate</th> <th>104.132</th> <th>Current Tax</th> </tr> </thead> <tbody> <tr> <td>Remove Cap</td> <td></td> <td>Land Value 74,208</td> <td>74,208</td> <td>11%</td> <td>8,163</td> <td>Assessed</td> <td>35,385</td> <td>3,684.70</td> </tr> <tr> <td>Year Frozen</td> <td>0</td> <td>Improvements 302,613</td> <td>247,470</td> <td></td> <td>27,222</td> <td>Penalty</td> <td>0</td> <td></td> </tr> <tr> <td>Uncapped Value</td> <td>0</td> <td>Mobile Home 0</td> <td>0</td> <td></td> <td>0</td> <td>Exemption</td> <td>0</td> <td>0.00</td> </tr> <tr> <td>TIF Project ID</td> <td>0</td> <td>Total Value 376,821</td> <td>321,678</td> <td></td> <td>35,385</td> <td>Total Taxable</td> <td>35,385</td> <td>3,685.00</td> </tr> </tbody> </table>										Source	REAL	Fair Cash	Capped	Asmnt Level	Assessed	Levy Rate	104.132	Current Tax	Remove Cap		Land Value 74,208	74,208	11%	8,163	Assessed	35,385	3,684.70	Year Frozen	0	Improvements 302,613	247,470		27,222	Penalty	0		Uncapped Value	0	Mobile Home 0	0		0	Exemption	0	0.00	TIF Project ID	0	Total Value 376,821	321,678		35,385	Total Taxable	35,385	3,685.00																																																																			
Source	REAL	Fair Cash	Capped	Asmnt Level	Assessed	Levy Rate	104.132	Current Tax																																																																																																																	
Remove Cap		Land Value 74,208	74,208	11%	8,163	Assessed	35,385	3,684.70																																																																																																																	
Year Frozen	0	Improvements 302,613	247,470		27,222	Penalty	0																																																																																																																		
Uncapped Value	0	Mobile Home 0	0		0	Exemption	0	0.00																																																																																																																	
TIF Project ID	0	Total Value 376,821	321,678		35,385	Total Taxable	35,385	3,685.00																																																																																																																	
<b>Assessment History</b> <table border="1"> <thead> <tr> <th>Tax Year</th> <th>Statement Number</th> <th>Billed Owner</th> <th>Tax Area</th> <th>Total Value</th> <th>Exemptions</th> <th>Taxable Value</th> <th>Billed Tax</th> </tr> </thead> <tbody> <tr> <td>2025</td> <td>2025-660031438</td> <td>OKLAHOMA EMERGENCY VEHICLES LLC</td> <td>4</td> <td>385,407</td> <td>0</td> <td>33,700</td> <td>3,509.00</td> </tr> <tr> <td>2024</td> <td>2024-660031438</td> <td>OKLAHOMA EMERGENCY VEHICLES LLC</td> <td>4</td> <td>291,772</td> <td>0</td> <td>32,095</td> <td>3,077.00</td> </tr> <tr> <td>2023</td> <td>2023-660031438</td> <td>OKLAHOMA EMERGENCY VEHICLES LLC</td> <td>4</td> <td>379,778</td> <td>0</td> <td>32,342</td> <td>3,053.00</td> </tr> <tr> <td>2022</td> <td>2022-660031438</td> <td>OKLAHOMA EMERGENCY VEHICLES LLC</td> <td>4</td> <td>167,439</td> <td>0</td> <td>14,235</td> <td>1,369.00</td> </tr> <tr> <td>2021</td> <td>2021-660031438</td> <td>JARVIS, MICHAEL R &amp;</td> <td>4</td> <td>153,946</td> <td>0</td> <td>13,557</td> <td>1,269.00</td> </tr> <tr> <td>2020</td> <td>2020-660031438</td> <td>JARVIS, MICHAEL R &amp;</td> <td>4</td> <td>153,946</td> <td>0</td> <td>12,911</td> <td>1,211.00</td> </tr> <tr> <td>2019</td> <td>2019-660031438</td> <td>JARVIS, MICHAEL R &amp;</td> <td>4</td> <td>153,946</td> <td>0</td> <td>12,296</td> <td>1,172.00</td> </tr> <tr> <td>2018</td> <td>2018-660031438</td> <td>JARVIS, MICHAEL R &amp;</td> <td>4</td> <td>165,700</td> <td>0</td> <td>11,711</td> <td>1,116.00</td> </tr> <tr> <td>2017</td> <td>2017-660031438</td> <td>JARVIS, MICHAEL R &amp;</td> <td>4</td> <td>165,700</td> <td>0</td> <td>11,154</td> <td>1,066.00</td> </tr> <tr> <td>2016</td> <td>2016-660031438</td> <td>JARVIS, MICHAEL R &amp;</td> <td>4</td> <td>165,700</td> <td>0</td> <td>10,622</td> <td>1,017.00</td> </tr> <tr> <td>2015</td> <td>2015-660031438</td> <td>JARVIS, MICHAEL R &amp;</td> <td>4</td> <td>193,788</td> <td>0</td> <td>10,116</td> <td>977.00</td> </tr> <tr> <td>2014</td> <td>2014-660031438</td> <td>JARVIS, MICHAEL R &amp;</td> <td>4</td> <td>193,788</td> <td>0</td> <td>9,635</td> <td>880.00</td> </tr> <tr> <td>2013</td> <td>2013-660031438</td> <td>JARVIS, MICHAEL R &amp;</td> <td>4</td> <td>83,420</td> <td>0</td> <td>9,176</td> <td>869.00</td> </tr> </tbody> </table>										Tax Year	Statement Number	Billed Owner	Tax Area	Total Value	Exemptions	Taxable Value	Billed Tax	2025	2025-660031438	OKLAHOMA EMERGENCY VEHICLES LLC	4	385,407	0	33,700	3,509.00	2024	2024-660031438	OKLAHOMA EMERGENCY VEHICLES LLC	4	291,772	0	32,095	3,077.00	2023	2023-660031438	OKLAHOMA EMERGENCY VEHICLES LLC	4	379,778	0	32,342	3,053.00	2022	2022-660031438	OKLAHOMA EMERGENCY VEHICLES LLC	4	167,439	0	14,235	1,369.00	2021	2021-660031438	JARVIS, MICHAEL R &	4	153,946	0	13,557	1,269.00	2020	2020-660031438	JARVIS, MICHAEL R &	4	153,946	0	12,911	1,211.00	2019	2019-660031438	JARVIS, MICHAEL R &	4	153,946	0	12,296	1,172.00	2018	2018-660031438	JARVIS, MICHAEL R &	4	165,700	0	11,711	1,116.00	2017	2017-660031438	JARVIS, MICHAEL R &	4	165,700	0	11,154	1,066.00	2016	2016-660031438	JARVIS, MICHAEL R &	4	165,700	0	10,622	1,017.00	2015	2015-660031438	JARVIS, MICHAEL R &	4	193,788	0	10,116	977.00	2014	2014-660031438	JARVIS, MICHAEL R &	4	193,788	0	9,635	880.00	2013	2013-660031438	JARVIS, MICHAEL R &	4	83,420	0	9,176	869.00
Tax Year	Statement Number	Billed Owner	Tax Area	Total Value	Exemptions	Taxable Value	Billed Tax																																																																																																																		
2025	2025-660031438	OKLAHOMA EMERGENCY VEHICLES LLC	4	385,407	0	33,700	3,509.00																																																																																																																		
2024	2024-660031438	OKLAHOMA EMERGENCY VEHICLES LLC	4	291,772	0	32,095	3,077.00																																																																																																																		
2023	2023-660031438	OKLAHOMA EMERGENCY VEHICLES LLC	4	379,778	0	32,342	3,053.00																																																																																																																		
2022	2022-660031438	OKLAHOMA EMERGENCY VEHICLES LLC	4	167,439	0	14,235	1,369.00																																																																																																																		
2021	2021-660031438	JARVIS, MICHAEL R &	4	153,946	0	13,557	1,269.00																																																																																																																		
2020	2020-660031438	JARVIS, MICHAEL R &	4	153,946	0	12,911	1,211.00																																																																																																																		
2019	2019-660031438	JARVIS, MICHAEL R &	4	153,946	0	12,296	1,172.00																																																																																																																		
2018	2018-660031438	JARVIS, MICHAEL R &	4	165,700	0	11,711	1,116.00																																																																																																																		
2017	2017-660031438	JARVIS, MICHAEL R &	4	165,700	0	11,154	1,066.00																																																																																																																		
2016	2016-660031438	JARVIS, MICHAEL R &	4	165,700	0	10,622	1,017.00																																																																																																																		
2015	2015-660031438	JARVIS, MICHAEL R &	4	193,788	0	10,116	977.00																																																																																																																		
2014	2014-660031438	JARVIS, MICHAEL R &	4	193,788	0	9,635	880.00																																																																																																																		
2013	2013-660031438	JARVIS, MICHAEL R &	4	83,420	0	9,176	869.00																																																																																																																		



# Rogers

## Assessment Property Record Card for Tax Year 2026

Data provided by LISA DELOZIER County Assessor

Date 04/17/2026  
 Time 18:14:10  
 Page 2

Lot Data		Primary Image	
Lot Size	0 x 0		
Lot Count	0		
Units Buildable	2		
Non-Ag Acres	1.907		
Topography			
Street Access			
Utilities			
Amenities	0		
	0		
Value Model	1835 COMM		
Value Method	Square-Foot		
Base Lot Value	83,075.00 x .89 =	74,208	
Factor Value	0		
Adjustments			
Lot Value	74,208		
Cost Approach		Image Information	
Manual Date	01/2025	Image ID	999468
Total Building Area	6,560	Image Date	5/20/2022
Total Base Value	441,986	Name	IMG_0075.JPG
Modifier Value		Description	REVAL 2023
Misc Improvements			
Replacement Cost New	441,986		
Phys/Func Depreciation Loss	()		
RCN Less Phys/Func	295,127		
Economic Depreciation			
RCNLD (All Sources)	295,127		
Depreciated Improvements			
Outbuilding Value	7,486		
Total Improvement Value	302,613		
Land Value	74,208		
Cost Approach Value	376,821		57.44/SqFt
Income Approach		Value Reconciliation	
Potential Gross Income (PGI)		Selected Valuation Method	Cost Approach
Vacancy & Collection Loss		Total Improvement Value	7,486
Miscellaneous Income		Land Value	74,208
Effective Gross Income (EGI)		Total Appraised Value	376,821
Total Expenses			57.44/SqFt
Net Operating Income (NOI)			
Income Capitalization Rate			
Indicated Value	0.00		



# Rogers

## Assessment Property Record Card for Tax Year 2026

Data provided by LISA DELOZIER County Assessor

Date 04/17/2026

Time 18:14:10

Page 3

### Sketch Image

660031438

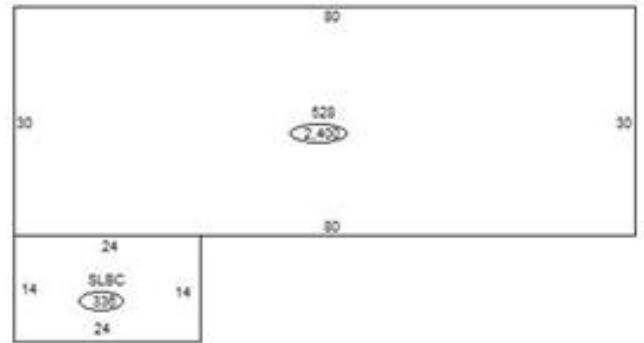

### Sketch Vector Information

Sequence	Code	Type	Built Over	Scale	Section Label	Base Area	Multiplier	Total Area
1	C	406		20	1-1 1St 0	4,160	1.000	4,160
2	C	528		20	528	2,400	1.000	2,400
3	O	PRCH		20	SLBC	336	1.000	336
<b>Total Building Area</b>						<b>6,560</b>		<b>6,560</b>



# Rogers

## Assessment Property Record Card for Tax Year 2026

Data provided by LISA DELOZIER County Assessor

Date 04/17/2026  
Time 18:14:10  
Page 4

Account 660031438  
Parcel ID 21N15E-36-3-00000-000-0000  
Cadastral ID 36-21-15-05700

Tax Area Code 4  
Property Class RCL  
Owners Name OKLAHOMA EMERGENCY VEHICLES LLC

### Building Data

Building ID 4939  
Building Sequence 1  
Occupancy 1 528 Service Repair Garage 100%  
Occupancy 2  
Occupancy 3  
Total Floor Area 2,400  
Average Perimeter 220  
Number Of Storys 1.00  
Average Wall Ht 10.00  
Year Built 2022  
Effective Age 2  
Construction Class 7 - Pre-Engineered Steel Frame  
Quality 3 - Average  
Condition 3 - Average  
Exterior Wall 88 - Stud Metal Siding  
Heating/Cooling 15 - No HVAC  
Roof Type Gable  
Roof Cover Metal

Basement Area  
Basement Levels  
Basement Finish  
Finish Code - 1  
Finish Area - 1  
Finish Code - 2  
Finish Area - 2

### Building Image



### Image Information

Image Name IMG\_0074.JPG  
Image Date 5/20/2022  
Image Name IMG\_0074.JPG  
Description REVAL 2023

### Cost Calculations

Appraisal Zone 4  
Zone Description  
Base Cost 57.26  
Wall Cost 19.85  
HVAC Cost 0.00  
Basement Cost 0.00  
Total Base Cost 77.11  
Total Area 2,400  
Base RCN 185,064  
Misc Impr Value

Manual Date 01/2025  
Base Year 2026  
Modifier Value  
Total Replacement Cost 185,064  
Physical Depreciation 3%  
Functional Depreciation  
Total Depreciation 3% (5,552)  
Total RCNLD 179,512  
Lump Sums  
Total Building Value 179,512 \$ 74.80 Per SqFt



# Rogers

## Assessment Property Record Card for Tax Year 2026

Data provided by LISA DELOZIER County Assessor

Date 04/17/2026  
Time 18:14:10  
Page 5

Account 660031438  
Parcel ID 21N15E-36-3-00000-000-0000  
Cadastral ID 36-21-15-05700

Tax Area Code 4  
Property Class RCL  
Owners Name OKLAHOMA EMERGENCY VEHICLES LLC

### Building Data

Building ID 1132  
Building Sequence 2  
Occupancy 1 406 Storage Warehouse 100%  
Occupancy 2  
Occupancy 3  
Total Floor Area 4,160  
Average Perimeter 264  
Number Of Storys 1.00  
Average Wall Ht 16.00  
Year Built 1987  
Effective Age 25  
Construction Class 7 - Pre-Engineered Steel Frame  
Quality 2 - Fair  
Condition 2 - Fair  
Exterior Wall 88 - Stud Metal Siding  
Heating/Cooling 15 - No HVAC  
Roof Type Gable  
Roof Cover

Basement Area  
Basement Levels  
Basement Finish  
Finish Code - 1 0  
Finish Area - 1  
Finish Code - 2 0  
Finish Area - 2

### Building Image



### Image Information

Image Name 660031438-01.jpg  
Image Date 7/15/2009  
Image Name 660031438-01.jpg  
Description D:\Convert\Photos\660\031\438-01.jpg

### Cost Calculations

Appraisal Zone 4  
Zone Description  
Base Cost 42.60  
Wall Cost 19.16  
HVAC Cost 0.00  
Basement Cost 0.00  
Total Base Cost 61.76  
Total Area 4,160  
Base RCN 256,922  
Misc Impr Value

Manual Date 01/2025  
Base Year 2026  
Modifier Value  
Total Replacement Cost 256,922  
Physical Depreciation 55%  
Functional Depreciation  
Total Depreciation 55% (141,307)  
Total RCNLD 115,615  
Lump Sums  
Total Building Value 115,615 \$ 27.79 Per SqFt



# Rogers

## Assessment Property Record Card for Tax Year 2026

Data provided by LISA DELOZIER County Assessor

Date 04/17/2026

Time 18:14:10

Page 6

660031438

### Outbuildings/Site Improvements

Building Image	Code	Description	Dimensions	Floor	Roofing	Total Units
	PRCH	Slab Porch - Covered	0x0x0			336
	<b>Qual</b> 2	<b>Cond</b> 2	<b>Year</b> 2022	<b>Eff Age</b> 4		
<b>Valuation Summary</b>		<b>Modifier Total</b>	<b>RCN</b>	<b>Depr (% Phys/ % Func)</b>		<b>RCNLD</b>
Base Cost (20.30 x 336)			6,821	1,432		5,389
	PACN	PAVING - CONCRETE	0x0x0			660
	<b>Qual</b> 2	<b>Cond</b> 2	<b>Year</b>	<b>Eff Age</b> 1317		
<b>Valuation Summary</b>		<b>Modifier Total</b>	<b>RCN</b>	<b>Depr (% Phys/ % Func)</b>		<b>RCNLD</b>
Base Cost (4.33 x 660)			2,858	1,143		1,715
	STF	STG FAIR	8x12x0			96
	<b>Qual</b>	<b>Cond</b>	<b>Year</b>	<b>Eff Age</b>		
<b>Valuation Summary</b>		<b>Modifier Total</b>	<b>RCN</b>	<b>Depr (% Phys/ % Func)</b>		<b>RCNLD</b>
Base Cost (4.68 x 96)			449	67		382
<b>Total Site Improvement Value</b>						<b>7,486</b>