



# Rogers

## Assessment Property Record Card for Tax Year 2026

Data provided by LISA DELOZIER County Assessor

Date 04/16/2026  
Time 22:14:40  
Page 1

Assessment Data					Primary Image																																																																																																																				
<b>Account</b> 660031502 <b>Parcel ID</b> 000000-00-0-00075-002-0013 <b>Cadastral ID</b> 36-21-15-08320 <b>Property Type</b> REAL - Real Property <b>Property Class</b> URP VI Area 4 <b>Tax Area</b> 80 - VERDIGRIS TOWN/ VERDIGRI <b>Name ID</b> 331112 DEAVER, MATTHEW A & CAYLA C  24962 S HEARTWOOD DR CLAREMORE OK 74019-0000  <b>Parcel Location</b> <b>Situs</b> 24962 HEARTWOOD <b>Subdivision</b> BRIDGEPORT 1 <b>Lot/Block</b> 0013 / 0002 <b>Parcel Size</b> 1 - Lots <b>Sec/Twn/Rng</b> 36 / 21 / 15 / 5 <b>Neighborhood</b> 1109 - R-V03-SW VERDIGRIS <b>School District</b> S008 - VERDIGRIS SCHOOLS																																																																																																																									
<b>Legal Description</b> Lot/Long: 36.25041003 -95.66316657																																																																																																																									
<b>Legal Description</b> LOT 13 BLOCK 2 BRIDGEPORT 1					<b>Building Permits</b> <table border="1"> <thead> <tr> <th>Number</th> <th>Description</th> <th>Opened</th> <th>Closed</th> <th>Amount</th> </tr> </thead> <tbody> <tr> <td colspan="5"> </td> </tr> </tbody> </table>					Number	Description	Opened	Closed	Amount																																																																																																											
Number	Description	Opened	Closed	Amount																																																																																																																					
<b>Exemptions</b> <table border="1"> <thead> <tr> <th>Code</th> <th>Type</th> <th>Active</th> <th>Maximum</th> <th>Exemption</th> </tr> </thead> <tbody> <tr> <td>H</td> <td>Homestead</td> <td>No</td> <td>1,000</td> <td></td> </tr> </tbody> </table>					Code	Type	Active	Maximum	Exemption	H	Homestead	No	1,000		<b>Sale History</b> <table border="1"> <thead> <tr> <th>Bk/Pg</th> <th>Grantor</th> <th>Date</th> <th>Price</th> <th>Code</th> </tr> </thead> <tbody> <tr> <td>/</td> <td>MARLIN, JOHNA</td> <td>06/16/2020</td> <td>125,000</td> <td>YES</td> </tr> <tr> <td>2275/605</td> <td>BLOOD, GREGORY A &amp;</td> <td>09/28/2012</td> <td>95,000</td> <td>YES</td> </tr> <tr> <td>1448/446</td> <td>SCOTT, KRISTIN L</td> <td>02/07/2003</td> <td>83,500</td> <td>YES</td> </tr> <tr> <td>1369/1</td> <td>BARNOSKI, PHILLIP E &amp;-SHONDA</td> <td>04/09/2002</td> <td>80,000</td> <td>YES</td> </tr> <tr> <td>1128/364</td> <td>MAYFIELD, HAROLD L II &amp;</td> <td>07/27/1998</td> <td>68,000</td> <td>Yes</td> </tr> <tr> <td>1021/512</td> <td>VREELAND, FRANK</td> <td>04/08/1996</td> <td>57,500</td> <td>Yes</td> </tr> </tbody> </table>					Bk/Pg	Grantor	Date	Price	Code	/	MARLIN, JOHNA	06/16/2020	125,000	YES	2275/605	BLOOD, GREGORY A &	09/28/2012	95,000	YES	1448/446	SCOTT, KRISTIN L	02/07/2003	83,500	YES	1369/1	BARNOSKI, PHILLIP E &-SHONDA	04/09/2002	80,000	YES	1128/364	MAYFIELD, HAROLD L II &	07/27/1998	68,000	Yes	1021/512	VREELAND, FRANK	04/08/1996	57,500	Yes																																																																			
Code	Type	Active	Maximum	Exemption																																																																																																																					
H	Homestead	No	1,000																																																																																																																						
Bk/Pg	Grantor	Date	Price	Code																																																																																																																					
/	MARLIN, JOHNA	06/16/2020	125,000	YES																																																																																																																					
2275/605	BLOOD, GREGORY A &	09/28/2012	95,000	YES																																																																																																																					
1448/446	SCOTT, KRISTIN L	02/07/2003	83,500	YES																																																																																																																					
1369/1	BARNOSKI, PHILLIP E &-SHONDA	04/09/2002	80,000	YES																																																																																																																					
1128/364	MAYFIELD, HAROLD L II &	07/27/1998	68,000	Yes																																																																																																																					
1021/512	VREELAND, FRANK	04/08/1996	57,500	Yes																																																																																																																					
<b>Parcel Valuation</b> <table border="1"> <thead> <tr> <th>Source</th> <th>REAL</th> <th>Fair Cash</th> <th>Capped</th> <th>Asmnt Level</th> <th>Assessed</th> <th>Levy Rate</th> <th>104.132</th> <th>Current Tax</th> </tr> </thead> <tbody> <tr> <td>Remove Cap</td> <td>2021</td> <td>Land Value 51,979</td> <td>40,955</td> <td>11%</td> <td>4,505</td> <td>Assessed</td> <td>16,340</td> <td>1,701.51</td> </tr> <tr> <td>Year Frozen</td> <td>0</td> <td>Improvements 107,591</td> <td>107,591</td> <td></td> <td>11,835</td> <td>Penalty</td> <td>0</td> <td></td> </tr> <tr> <td>Uncapped Value</td> <td>0</td> <td>Mobile Home 0</td> <td>0</td> <td></td> <td>0</td> <td>Exemption</td> <td>0</td> <td>0.00</td> </tr> <tr> <td>TIF Project ID</td> <td>0</td> <td>Total Value 159,570</td> <td>148,546</td> <td></td> <td>16,340</td> <td>Total Taxable</td> <td>16,340</td> <td>1,702.00</td> </tr> </tbody> </table>										Source	REAL	Fair Cash	Capped	Asmnt Level	Assessed	Levy Rate	104.132	Current Tax	Remove Cap	2021	Land Value 51,979	40,955	11%	4,505	Assessed	16,340	1,701.51	Year Frozen	0	Improvements 107,591	107,591		11,835	Penalty	0		Uncapped Value	0	Mobile Home 0	0		0	Exemption	0	0.00	TIF Project ID	0	Total Value 159,570	148,546		16,340	Total Taxable	16,340	1,702.00																																																																			
Source	REAL	Fair Cash	Capped	Asmnt Level	Assessed	Levy Rate	104.132	Current Tax																																																																																																																	
Remove Cap	2021	Land Value 51,979	40,955	11%	4,505	Assessed	16,340	1,701.51																																																																																																																	
Year Frozen	0	Improvements 107,591	107,591		11,835	Penalty	0																																																																																																																		
Uncapped Value	0	Mobile Home 0	0		0	Exemption	0	0.00																																																																																																																	
TIF Project ID	0	Total Value 159,570	148,546		16,340	Total Taxable	16,340	1,702.00																																																																																																																	
<b>Assessment History</b> <table border="1"> <thead> <tr> <th>Tax Year</th> <th>Statement Number</th> <th>Billed Owner</th> <th>Tax Area</th> <th>Total Value</th> <th>Exemptions</th> <th>Taxable Value</th> <th>Billed Tax</th> </tr> </thead> <tbody> <tr><td>2025</td><td>2025-660031502</td><td>DEAVER, MATTHEW A &amp;</td><td>80</td><td>158,500</td><td>0</td><td>15,562</td><td>1,621.00</td></tr> <tr><td>2024</td><td>2024-660031502</td><td>DEAVER, MATTHEW A &amp;</td><td>80</td><td>160,560</td><td>0</td><td>14,821</td><td>1,421.00</td></tr> <tr><td>2023</td><td>2023-660031502</td><td>DEAVER, MATTHEW A &amp;</td><td>80</td><td>128,321</td><td>0</td><td>14,115</td><td>1,332.00</td></tr> <tr><td>2022</td><td>2022-660031502</td><td>DEAVER, MATTHEW A &amp;</td><td>80</td><td>125,616</td><td>0</td><td>13,788</td><td>1,325.00</td></tr> <tr><td>2021</td><td>2021-660031502</td><td>DEAVER, MATTHEW A &amp;</td><td>80</td><td>119,380</td><td>0</td><td>13,132</td><td>1,229.00</td></tr> <tr><td>2020</td><td>2020-660031502</td><td>DEAVER, MATTHEW A</td><td>80</td><td>105,101</td><td>0</td><td>11,170</td><td>1,047.00</td></tr> <tr><td>2019</td><td>2019-660031502</td><td>MARLIN, JOHNA</td><td>80</td><td>96,714</td><td>0</td><td>10,639</td><td>1,014.00</td></tr> <tr><td>2018</td><td>2018-660031502</td><td>MARLIN, JOHNA</td><td>80</td><td>99,181</td><td>0</td><td>10,910</td><td>1,039.00</td></tr> <tr><td>2017</td><td>2017-660031502</td><td>MARLIN, JOHNA</td><td>80</td><td>98,440</td><td>0</td><td>10,828</td><td>1,035.00</td></tr> <tr><td>2016</td><td>2016-660031502</td><td>MARLIN, JOHNA</td><td>80</td><td>96,145</td><td>0</td><td>10,576</td><td>1,014.00</td></tr> <tr><td>2015</td><td>2015-660031502</td><td>MARLIN, JOHNA</td><td>80</td><td>94,434</td><td>0</td><td>10,388</td><td>1,003.00</td></tr> <tr><td>2014</td><td>2014-660031502</td><td>MARLIN, JOHNA</td><td>80</td><td>95,104</td><td>0</td><td>10,461</td><td>956.00</td></tr> <tr><td>2013</td><td>2013-660031502</td><td>MARLIN, JOHNA</td><td>80</td><td>95,065</td><td>0</td><td>10,457</td><td>990.00</td></tr> </tbody> </table>										Tax Year	Statement Number	Billed Owner	Tax Area	Total Value	Exemptions	Taxable Value	Billed Tax	2025	2025-660031502	DEAVER, MATTHEW A &	80	158,500	0	15,562	1,621.00	2024	2024-660031502	DEAVER, MATTHEW A &	80	160,560	0	14,821	1,421.00	2023	2023-660031502	DEAVER, MATTHEW A &	80	128,321	0	14,115	1,332.00	2022	2022-660031502	DEAVER, MATTHEW A &	80	125,616	0	13,788	1,325.00	2021	2021-660031502	DEAVER, MATTHEW A &	80	119,380	0	13,132	1,229.00	2020	2020-660031502	DEAVER, MATTHEW A	80	105,101	0	11,170	1,047.00	2019	2019-660031502	MARLIN, JOHNA	80	96,714	0	10,639	1,014.00	2018	2018-660031502	MARLIN, JOHNA	80	99,181	0	10,910	1,039.00	2017	2017-660031502	MARLIN, JOHNA	80	98,440	0	10,828	1,035.00	2016	2016-660031502	MARLIN, JOHNA	80	96,145	0	10,576	1,014.00	2015	2015-660031502	MARLIN, JOHNA	80	94,434	0	10,388	1,003.00	2014	2014-660031502	MARLIN, JOHNA	80	95,104	0	10,461	956.00	2013	2013-660031502	MARLIN, JOHNA	80	95,065	0	10,457	990.00
Tax Year	Statement Number	Billed Owner	Tax Area	Total Value	Exemptions	Taxable Value	Billed Tax																																																																																																																		
2025	2025-660031502	DEAVER, MATTHEW A &	80	158,500	0	15,562	1,621.00																																																																																																																		
2024	2024-660031502	DEAVER, MATTHEW A &	80	160,560	0	14,821	1,421.00																																																																																																																		
2023	2023-660031502	DEAVER, MATTHEW A &	80	128,321	0	14,115	1,332.00																																																																																																																		
2022	2022-660031502	DEAVER, MATTHEW A &	80	125,616	0	13,788	1,325.00																																																																																																																		
2021	2021-660031502	DEAVER, MATTHEW A &	80	119,380	0	13,132	1,229.00																																																																																																																		
2020	2020-660031502	DEAVER, MATTHEW A	80	105,101	0	11,170	1,047.00																																																																																																																		
2019	2019-660031502	MARLIN, JOHNA	80	96,714	0	10,639	1,014.00																																																																																																																		
2018	2018-660031502	MARLIN, JOHNA	80	99,181	0	10,910	1,039.00																																																																																																																		
2017	2017-660031502	MARLIN, JOHNA	80	98,440	0	10,828	1,035.00																																																																																																																		
2016	2016-660031502	MARLIN, JOHNA	80	96,145	0	10,576	1,014.00																																																																																																																		
2015	2015-660031502	MARLIN, JOHNA	80	94,434	0	10,388	1,003.00																																																																																																																		
2014	2014-660031502	MARLIN, JOHNA	80	95,104	0	10,461	956.00																																																																																																																		
2013	2013-660031502	MARLIN, JOHNA	80	95,065	0	10,457	990.00																																																																																																																		



# Rogers

## Assessment Property Record Card for Tax Year 2026

Data provided by LISA DELOZIER County Assessor

Date 04/16/2026  
 Time 22:14:41  
 Page 2

Lot Data	Square-Foot - NBHD 1109 #1	Primary Image
<b>Lot Size</b> <b>Lot Count</b> <b>Units Buildable</b> 1 <b>Non-Ag Acres</b> 0.2204 <b>Topography</b> <b>Street Access</b> <b>Utilities</b> <b>Amenities</b> 0  <b>Method</b> Square-Foot <b>Base Lot Value</b> 9,601.00 x 5.41 = 51,979 <b>Factor Value</b> <b>Adjustments</b> 1.0000 <b>Lot Value</b> 51,979		

Residential Data	
<b>Type</b>	1 Single Family Residence
<b>Condition</b>	3 - Average
<b>Quality</b>	2.5 - Fair
<b>Architecture</b>	
<b>Style</b>	100% One Story
<b>Exterior Wall</b>	90% Frame, Siding, Wood 10% Veneer, Masonry
<b>Base/Total Area</b>	1,025 / 1,025
<b>Style</b>	100% One Story
<b>HVAC</b>	100% Warmed & Cooled Air
<b>Roof Cover</b>	1 Composition Shingle
<b>Area on Slab</b>	1,025
<b>Fixture/RghIn</b>	11 /
<b>Bed/F/H Bath</b>	3 / 2.0 /
<b>Basement Area</b>	
<b>Garage Type</b>	399 Attached Garage - Unfinished
<b>Remodel</b>	
<b>Year/Eff Age</b>	1996 / 23

\\tsclient\T\TOM\COMMERCIAL PICS\2022-06-16\IMG_0031.JPG 6/16/2022	
--	--

GRM Approach	
<b>GRM Code</b>	
<b>Gross Rent</b>	0.00
<b>Indicated Value</b>	

Multiple Regression			
<b>MRA Code</b>	1	Test	
<b>Adusted R</b>	0.8445		
<b>Indicated Value</b>	142,076	138.61	Per SqFt

Direct Comparables			
<b>Selection Model</b>	A	Adam Test	
<b>Adjustment Model</b>	1	2022 Residential	
<b>Comparables</b>	8		
<b>Indicated Value</b>	136,440		Per SqFt

Cost Approach				Manual : 01/2025			
<b>Base Cost</b>	104.18	<b>Total Misc Impr</b>	+ 5,811				
<b>Roofing Adj</b>	+ 4.76	<b>Garage Cost</b>	+ 11,679				
<b>Subfloor Adj</b>	+ -1.26	<b>Total RCN</b>	= 153,702				
<b>Heat/Cool Adj</b>	+ 11.47	<b>Depreciation ( 30%)</b>	- 46,111				
<b>Plumbing Adj</b>	+ 13.74	<b>Lump Sums</b>	+ 0				
<b>Basement Adj</b>	+ 0.00	<b>RCNLD</b>	= 107,591				
<b>Adj Base Cost</b>	= 132.89	<b>Lot Value</b>	+ 51,979				
<b>Total Area</b>	x 1,025	<b>Indicated Value</b>	= 159,570				
<b>Adjusted Cost</b>	= 136,212	<b>Value Per SqFt</b>	155.68				

Value Reconciliation			
<b>Selected Approach</b>	Cost Approach		
<b>Improvements</b>	107,591		
<b>Lot Value</b>	51,979		
<b>Indicated Value</b>	159,570	155.68	Per SqFt
<b>Agland Value</b>			
<b>Site Improvements</b>			
<b>Total Value</b>	159,570	155.68	Total Value Per SqFt

Miscellaneous Improvements								
Code	Description	Sketch ID	Size	Year	Units	Unit Cost	Depr	Value
PRCH	SLAB PORCH - COVERED	74858	12x7		84	24.00		2,016
PRCH	SLAB PORCH - COVERED	74859	16x10		160	23.72		3,795



# Rogers

## Assessment Property Record Card for Tax Year 2026

Data provided by LISA DELOZIER County Assessor

Date 04/16/2026  
Time 22:14:41  
Page 3

Sketch Image

660031502

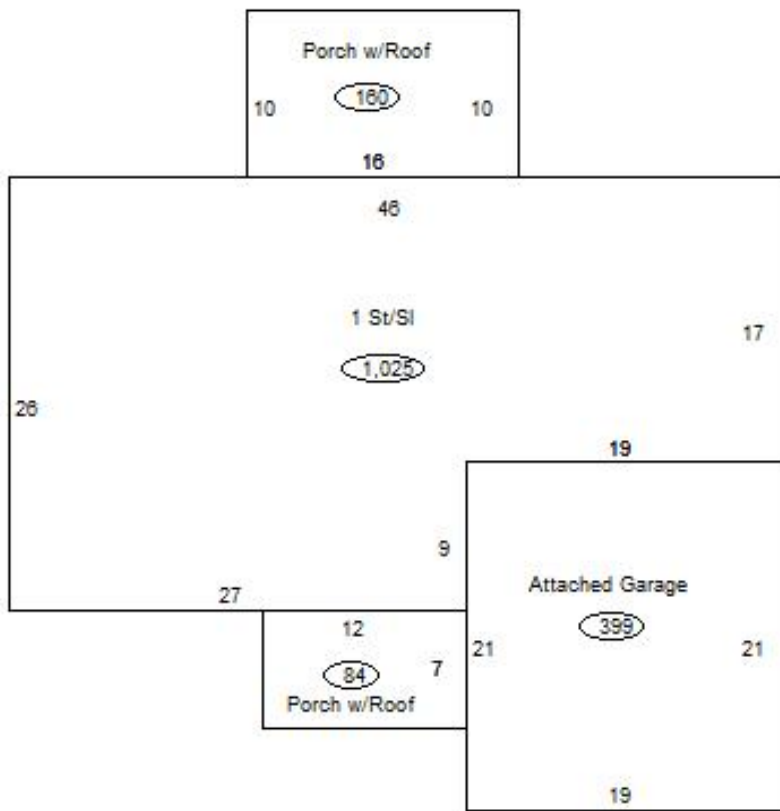

### Sketch Vector Information

Sequence	Code	Type	Built Over	Scale	Section Label	Base Area	Multiplier	Total Area
1	R	1	Slab	13	1 St/SI	1,025	1.000	1,025
2	G	1		13	Attached Garage	399	1.000	399
3	M	PRCH		13	SLBC	84	1.000	84
4	M	PRCH		13	SLBC	160	1.000	160
<b>Total Building Area</b>						1,025		1,025