



# Rogers

## Assessment Property Record Card for Tax Year 2026

Data provided by LISA DELOZIER County Assessor

Date 04/16/2026  
Time 21:17:23  
Page 1

Assessment Data					Primary Image																																																																																																																				
<b>Account</b> 660031551 <b>Parcel ID</b> 000000-00-0-00075-004-0018 <b>Cadastral ID</b> 36-21-15-08810 <b>Property Type</b> REAL - Real Property <b>Property Class</b> URP VI Area 4 <b>Tax Area</b> 80 - VERDIGRIS TOWN/ VERDIGRI <b>Name ID</b> 224134 LAMASON, J WILSON & NANCY LEE  <b>TRUSTEES</b> 21605 S 4120 RD CLAREMORE OK 74019-0000  <b>Parcel Location</b> <b>Situs</b> 09447 BIRCHWOOD <b>Subdivision</b> BRIDGEPORT 1 <b>Lot/Block</b> 0018 / 0004 <b>Parcel Size</b> 1 - Lots <b>Sec/Twn/Rng</b> 36 / 21 / 15 / 5 <b>Neighborhood</b> 1109 - R-V03-SW VERDIGRIS <b>School District</b> S008 - VERDIGRIS SCHOOLS																																																																																																																									
<b>Legal Description</b> Lot/Long: 36.25119614 -95.66173931																																																																																																																									
<b>Legal Description</b> LOT 18 BLOCK 4 BRIDGEPORT 1					<b>Building Permits</b> <table border="1"> <thead> <tr> <th>Number</th> <th>Description</th> <th>Opened</th> <th>Closed</th> <th>Amount</th> </tr> </thead> <tbody> <tr> <td> </td> <td> </td> <td> </td> <td> </td> <td> </td> </tr> </tbody> </table>					Number	Description	Opened	Closed	Amount																																																																																																											
Number	Description	Opened	Closed	Amount																																																																																																																					
<b>Exemptions</b> <table border="1"> <thead> <tr> <th>Code</th> <th>Type</th> <th>Active</th> <th>Maximum</th> <th>Exemption</th> </tr> </thead> <tbody> <tr> <td> </td> <td> </td> <td> </td> <td> </td> <td> </td> </tr> </tbody> </table>					Code	Type	Active	Maximum	Exemption						<b>Sale History</b> <table border="1"> <thead> <tr> <th>Bk/Pg</th> <th>Grantor</th> <th>Date</th> <th>Price</th> <th>Code</th> </tr> </thead> <tbody> <tr> <td>1116/493</td> <td>HADDOCK, JUSTIN W &amp; TARA B</td> <td>06/10/1998</td> <td>68,000</td> <td>No</td> </tr> <tr> <td>981/827</td> <td>VREELAND, FRANK</td> <td>02/15/1995</td> <td>58,500</td> <td>Yes</td> </tr> <tr> <td>976/537</td> <td>HILLCREST PROPERTIES, INC</td> <td>12/12/1994</td> <td>6,000</td> <td>No</td> </tr> </tbody> </table>					Bk/Pg	Grantor	Date	Price	Code	1116/493	HADDOCK, JUSTIN W & TARA B	06/10/1998	68,000	No	981/827	VREELAND, FRANK	02/15/1995	58,500	Yes	976/537	HILLCREST PROPERTIES, INC	12/12/1994	6,000	No																																																																																		
Code	Type	Active	Maximum	Exemption																																																																																																																					
Bk/Pg	Grantor	Date	Price	Code																																																																																																																					
1116/493	HADDOCK, JUSTIN W & TARA B	06/10/1998	68,000	No																																																																																																																					
981/827	VREELAND, FRANK	02/15/1995	58,500	Yes																																																																																																																					
976/537	HILLCREST PROPERTIES, INC	12/12/1994	6,000	No																																																																																																																					
<b>Parcel Valuation</b> <table border="1"> <thead> <tr> <th>Source</th> <th>REAL</th> <th>Fair Cash</th> <th>Capped</th> <th>Asmnt Level</th> <th>Assessed</th> <th>Levy Rate</th> <th>104.132</th> <th>Current Tax</th> </tr> </thead> <tbody> <tr> <td>Remove Cap</td> <td>1999</td> <td>Land Value 38,806</td> <td>30,270</td> <td>11%</td> <td>3,330</td> <td>Assessed</td> <td>15,642</td> <td>1,628.83</td> </tr> <tr> <td>Year Frozen</td> <td>0</td> <td>Improvements 113,114</td> <td>111,927</td> <td></td> <td>12,312</td> <td>Penalty</td> <td>0</td> <td></td> </tr> <tr> <td>Uncapped Value</td> <td>0</td> <td>Mobile Home 0</td> <td>0</td> <td></td> <td>0</td> <td>Exemption</td> <td>0</td> <td>0.00</td> </tr> <tr> <td>TIF Project ID</td> <td>0</td> <td>Total Value 151,920</td> <td>142,197</td> <td></td> <td>15,642</td> <td>Total Taxable</td> <td>15,642</td> <td>1,629.00</td> </tr> </tbody> </table>										Source	REAL	Fair Cash	Capped	Asmnt Level	Assessed	Levy Rate	104.132	Current Tax	Remove Cap	1999	Land Value 38,806	30,270	11%	3,330	Assessed	15,642	1,628.83	Year Frozen	0	Improvements 113,114	111,927		12,312	Penalty	0		Uncapped Value	0	Mobile Home 0	0		0	Exemption	0	0.00	TIF Project ID	0	Total Value 151,920	142,197		15,642	Total Taxable	15,642	1,629.00																																																																			
Source	REAL	Fair Cash	Capped	Asmnt Level	Assessed	Levy Rate	104.132	Current Tax																																																																																																																	
Remove Cap	1999	Land Value 38,806	30,270	11%	3,330	Assessed	15,642	1,628.83																																																																																																																	
Year Frozen	0	Improvements 113,114	111,927		12,312	Penalty	0																																																																																																																		
Uncapped Value	0	Mobile Home 0	0		0	Exemption	0	0.00																																																																																																																	
TIF Project ID	0	Total Value 151,920	142,197		15,642	Total Taxable	15,642	1,629.00																																																																																																																	
<b>Assessment History</b> <table border="1"> <thead> <tr> <th>Tax Year</th> <th>Statement Number</th> <th>Billed Owner</th> <th>Tax Area</th> <th>Total Value</th> <th>Exemptions</th> <th>Taxable Value</th> <th>Billed Tax</th> </tr> </thead> <tbody> <tr><td>2025</td><td>2025-660031551</td><td>LAMASON, J WILSON &amp; NANCY LEE</td><td>80</td><td>147,725</td><td>0</td><td>14,897</td><td>1,551.00</td></tr> <tr><td>2024</td><td>2024-660031551</td><td>LAMASON, J WILSON &amp; NANCY LEE</td><td>80</td><td>148,308</td><td>0</td><td>14,187</td><td>1,360.00</td></tr> <tr><td>2023</td><td>2023-660031551</td><td>LAMASON, J WILSON &amp; NANCY LEE</td><td>80</td><td>122,837</td><td>0</td><td>13,512</td><td>1,275.00</td></tr> <tr><td>2022</td><td>2022-660031551</td><td>LAMASON, J WILSON &amp; NANCY LEE</td><td>80</td><td>121,290</td><td>0</td><td>13,342</td><td>1,282.00</td></tr> <tr><td>2021</td><td>2021-660031551</td><td>LAMASON, J WILSON &amp; NANCY LEE</td><td>80</td><td>126,326</td><td>0</td><td>12,976</td><td>1,215.00</td></tr> <tr><td>2020</td><td>2020-660031551</td><td>LAMASON, J WILSON &amp; NANCY LEE</td><td>80</td><td>116,888</td><td>0</td><td>12,359</td><td>1,159.00</td></tr> <tr><td>2019</td><td>2019-660031551</td><td>LAMASON, J WILSON &amp; NANCY LEE</td><td>80</td><td>107,000</td><td>0</td><td>11,770</td><td>1,121.00</td></tr> <tr><td>2018</td><td>2018-660031551</td><td>LAMASON, J WILSON &amp; NANCY LEE</td><td>80</td><td>112,318</td><td>0</td><td>12,355</td><td>1,177.00</td></tr> <tr><td>2017</td><td>2017-660031551</td><td>LAMASON, J WILSON &amp; NANCY LEE</td><td>80</td><td>111,455</td><td>0</td><td>12,260</td><td>1,171.00</td></tr> <tr><td>2016</td><td>2016-660031551</td><td>LAMASON, J WILSON &amp; NANCY LEE</td><td>80</td><td>108,736</td><td>0</td><td>11,961</td><td>1,146.00</td></tr> <tr><td>2015</td><td>2015-660031551</td><td>LAMASON, J WILSON &amp; NANCY LEE</td><td>80</td><td>107,701</td><td>0</td><td>11,847</td><td>1,144.00</td></tr> <tr><td>2014</td><td>2014-660031551</td><td>LAMASON, J WILSON &amp; NANCY LEE</td><td>80</td><td>110,653</td><td>0</td><td>12,172</td><td>1,112.00</td></tr> <tr><td>2013</td><td>2013-660031551</td><td>LAMASON, J WILSON &amp; NANCY LEE</td><td>80</td><td>109,094</td><td>0</td><td>11,597</td><td>1,098.00</td></tr> </tbody> </table>										Tax Year	Statement Number	Billed Owner	Tax Area	Total Value	Exemptions	Taxable Value	Billed Tax	2025	2025-660031551	LAMASON, J WILSON & NANCY LEE	80	147,725	0	14,897	1,551.00	2024	2024-660031551	LAMASON, J WILSON & NANCY LEE	80	148,308	0	14,187	1,360.00	2023	2023-660031551	LAMASON, J WILSON & NANCY LEE	80	122,837	0	13,512	1,275.00	2022	2022-660031551	LAMASON, J WILSON & NANCY LEE	80	121,290	0	13,342	1,282.00	2021	2021-660031551	LAMASON, J WILSON & NANCY LEE	80	126,326	0	12,976	1,215.00	2020	2020-660031551	LAMASON, J WILSON & NANCY LEE	80	116,888	0	12,359	1,159.00	2019	2019-660031551	LAMASON, J WILSON & NANCY LEE	80	107,000	0	11,770	1,121.00	2018	2018-660031551	LAMASON, J WILSON & NANCY LEE	80	112,318	0	12,355	1,177.00	2017	2017-660031551	LAMASON, J WILSON & NANCY LEE	80	111,455	0	12,260	1,171.00	2016	2016-660031551	LAMASON, J WILSON & NANCY LEE	80	108,736	0	11,961	1,146.00	2015	2015-660031551	LAMASON, J WILSON & NANCY LEE	80	107,701	0	11,847	1,144.00	2014	2014-660031551	LAMASON, J WILSON & NANCY LEE	80	110,653	0	12,172	1,112.00	2013	2013-660031551	LAMASON, J WILSON & NANCY LEE	80	109,094	0	11,597	1,098.00
Tax Year	Statement Number	Billed Owner	Tax Area	Total Value	Exemptions	Taxable Value	Billed Tax																																																																																																																		
2025	2025-660031551	LAMASON, J WILSON & NANCY LEE	80	147,725	0	14,897	1,551.00																																																																																																																		
2024	2024-660031551	LAMASON, J WILSON & NANCY LEE	80	148,308	0	14,187	1,360.00																																																																																																																		
2023	2023-660031551	LAMASON, J WILSON & NANCY LEE	80	122,837	0	13,512	1,275.00																																																																																																																		
2022	2022-660031551	LAMASON, J WILSON & NANCY LEE	80	121,290	0	13,342	1,282.00																																																																																																																		
2021	2021-660031551	LAMASON, J WILSON & NANCY LEE	80	126,326	0	12,976	1,215.00																																																																																																																		
2020	2020-660031551	LAMASON, J WILSON & NANCY LEE	80	116,888	0	12,359	1,159.00																																																																																																																		
2019	2019-660031551	LAMASON, J WILSON & NANCY LEE	80	107,000	0	11,770	1,121.00																																																																																																																		
2018	2018-660031551	LAMASON, J WILSON & NANCY LEE	80	112,318	0	12,355	1,177.00																																																																																																																		
2017	2017-660031551	LAMASON, J WILSON & NANCY LEE	80	111,455	0	12,260	1,171.00																																																																																																																		
2016	2016-660031551	LAMASON, J WILSON & NANCY LEE	80	108,736	0	11,961	1,146.00																																																																																																																		
2015	2015-660031551	LAMASON, J WILSON & NANCY LEE	80	107,701	0	11,847	1,144.00																																																																																																																		
2014	2014-660031551	LAMASON, J WILSON & NANCY LEE	80	110,653	0	12,172	1,112.00																																																																																																																		
2013	2013-660031551	LAMASON, J WILSON & NANCY LEE	80	109,094	0	11,597	1,098.00																																																																																																																		



# Rogers

## Assessment Property Record Card for Tax Year 2026

Data provided by LISA DELOZIER County Assessor

Date 04/16/2026  
 Time 21:17:23  
 Page 2

Lot Data		Square-Foot - NBHD 1109 #1	
Lot Size			
Lot Count			
Units Buildable	1		
Non-Ag Acres	0.1497		
Topography			
Street Access			
Utilities			
Amenities		0	
		0	
Method	Square-Foot		
Base Lot Value	6,522.00 x 5.95 = 38,806		
Factor Value			
Adjustments	1.0000		
Lot Value	38,806		



\\tsclient\T\TOM\COMMERCIAL PICS\2022-06-27\IMG\_0039.JPG 6/29/2022

Residential Data	
Type	1 Single Family Residence
Condition	2.5 - Fair
Quality	2.5 - Fair
Architecture	
Style	100% One Story
Exterior Wall	95% Frame, Siding, Wood 5% Veneer, Masonry
Base/Total Area	1,203 / 1,203
Style	100% One Story
HVAC	100% Warmed & Cooled Air
Roof Cover	1 Composition Shingle
Area on Slab	1,203
Fixture/RghIn	11 /
Bed/F/H Bath	3 / 2.0 /
Basement Area	
Garage Type	400 Attached Garage - Unfinished
Remodel	
Year/Eff Age	1995 / 27

### GRM Approach

GRM Code	
Gross Rent	0.00
Indicated Value	

### Multiple Regression

MRA Code	1 Test
Adjusted R	0.8445
Indicated Value	151,919 126.28 Per SqFt

### Direct Comparables

Selection Model	A Adam Test
Adjustment Model	1 2022 Residential
Comparables	8
Indicated Value	148,620 Per SqFt

### Value Reconciliation

Selected Approach	Cost Approach
Improvements	113,114
Lot Value	38,806
Indicated Value	151,920 126.28 Per SqFt
Agland Value	
Site Improvements	
Total Value	151,920 126.28 Total Value Per SqFt

### Cost Approach Manual : 01/2025

Base Cost	101.40	Total Misc Impr	+	11,032
Roofing Adj	+ 4.66	Garage Cost	+	11,700
Subfloor Adj	+ -1.21	Total RCN	=	176,740
Heat/Cool Adj	+ 11.47	Depreciation ( 36%)	-	63,626
Plumbing Adj	+ 11.70	Lump Sums	+	0
Basement Adj	+ 0.00	RCNLD	=	113,114
Adj Base Cost	= 128.02	Lot Value	+	38,806
Total Area	x 1,203	Indicated Value	=	151,920
Adjusted Cost	= 154,008	Value Per SqFt		126.28

### Miscellaneous Improvements

Code	Description	Sketch ID	Size	Year	Units	Unit Cost	Depr	Value
PRCH	SLAB PORCH - COVERED	75056	18x16		288	23.29		6,708
PRCH	SLAB PORCH - COVERED	75057	183		183	23.63		4,324



# Rogers

## Assessment Property Record Card for Tax Year 2026

Data provided by LISA DELOZIER County Assessor

Date 04/16/2026  
 Time 21:17:23  
 Page 3

### Sketch Image

660031551

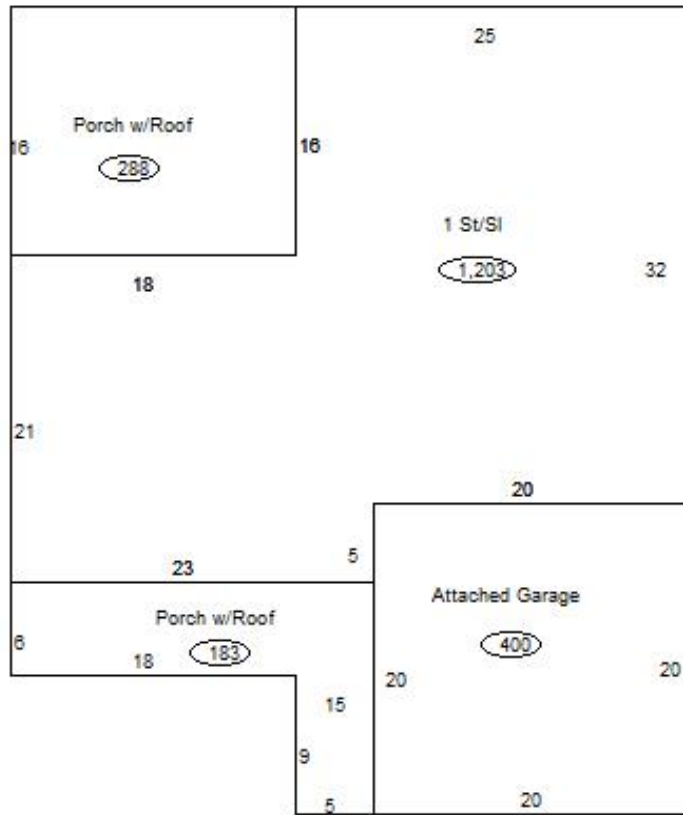

### Sketch Vector Information

Sequence	Code	Type	Built Over	Scale	Section Label	Base Area	Multiplier	Total Area
1	R	1	Slab	13	1 St/Sl	1,203	1.000	1,203
2	G	1		13	Attached Garage	400	1.000	400
3	M	PRCH		13	SLBC	288	1.000	288
4	M	PRCH		13	SLBC	183	1.000	183
<b>Total Building Area</b>						1,203		1,203