



Rogers

Assessment Property Record Card for Tax Year 2026

Data provided by LISA DELOZIER County Assessor

Date 04/16/2026
Time 22:50:29
Page 1

Assessment Data					Primary Image																																																																																																																				
Account 660031580 Parcel ID 000000-00-0-00381-001-0015 Cadastral ID 36-21-15-09100 Property Type REAL - Real Property Property Class URP VI Area 4 Tax Area 80 - VERDIGRIS TOWN/ VERDIGRI Name ID 114394 WILLIAMS, THEODORE B JR 9804 E HILLCREST DR CLAREMORE OK 74019-0000 Parcel Location Situs 09804 HILLCREST DR Subdivision HILLCREST HEIGHTS Lot/Block 0015 / 0001 Parcel Size .6 - Lots Sec/Twn/Rng 36 / 21 / 15 / 5 Neighborhood 1076 - R-V04-SW VERDIGRIS School District S008 - VERDIGRIS SCHOOLS																																																																																																																									
Legal Description Lot/Long: 36.25176265 -95.65391329																																																																																																																									
Legal Description LOT 15 BLOCK 1 LESS W 250' THEREOF HILLCREST HEIGHTS					Building Permits <table border="1"> <thead> <tr> <th>Number</th> <th>Description</th> <th>Opened</th> <th>Closed</th> <th>Amount</th> </tr> </thead> <tbody> <tr> <td> </td> <td> </td> <td> </td> <td> </td> <td> </td> </tr> </tbody> </table>					Number	Description	Opened	Closed	Amount																																																																																																											
Number	Description	Opened	Closed	Amount																																																																																																																					
Exemptions <table border="1"> <thead> <tr> <th>Code</th> <th>Type</th> <th>Active</th> <th>Maximum</th> <th>Exemption</th> </tr> </thead> <tbody> <tr> <td>H</td> <td>Homestead</td> <td>Yes</td> <td>1,000</td> <td>1,000</td> </tr> </tbody> </table>					Code	Type	Active	Maximum	Exemption	H	Homestead	Yes	1,000	1,000	Sale History <table border="1"> <thead> <tr> <th>Bk/Pg</th> <th>Grantor</th> <th>Date</th> <th>Price</th> <th>Code</th> </tr> </thead> <tbody> <tr> <td> </td> <td> </td> <td> </td> <td> </td> <td> </td> </tr> </tbody> </table>					Bk/Pg	Grantor	Date	Price	Code																																																																																																	
Code	Type	Active	Maximum	Exemption																																																																																																																					
H	Homestead	Yes	1,000	1,000																																																																																																																					
Bk/Pg	Grantor	Date	Price	Code																																																																																																																					
Parcel Valuation <table border="1"> <thead> <tr> <th>Source</th> <th>REAL</th> <th>Fair Cash</th> <th>Capped</th> <th>Asmnt Level</th> <th>Assessed</th> <th>Levy Rate</th> <th>104.132</th> <th>Current Tax</th> </tr> </thead> <tbody> <tr> <td>Remove Cap</td> <td>0</td> <td>Land Value 77,209</td> <td>27,009</td> <td>11%</td> <td>2,971</td> <td>Assessed</td> <td>24,078</td> <td>2,507.29</td> </tr> <tr> <td>Year Frozen</td> <td>0</td> <td>Improvements 209,988</td> <td>191,882</td> <td></td> <td>21,107</td> <td>Penalty</td> <td>0</td> <td></td> </tr> <tr> <td>Uncapped Value</td> <td>0</td> <td>Mobile Home 0</td> <td>0</td> <td></td> <td>0</td> <td>Exemption</td> <td>1,000</td> <td>-87.00</td> </tr> <tr> <td>TIF Project ID</td> <td>0</td> <td>Total Value 287,197</td> <td>218,891</td> <td></td> <td>24,078</td> <td>Total Taxable</td> <td>23,078</td> <td>2,420.00</td> </tr> </tbody> </table>										Source	REAL	Fair Cash	Capped	Asmnt Level	Assessed	Levy Rate	104.132	Current Tax	Remove Cap	0	Land Value 77,209	27,009	11%	2,971	Assessed	24,078	2,507.29	Year Frozen	0	Improvements 209,988	191,882		21,107	Penalty	0		Uncapped Value	0	Mobile Home 0	0		0	Exemption	1,000	-87.00	TIF Project ID	0	Total Value 287,197	218,891		24,078	Total Taxable	23,078	2,420.00																																																																			
Source	REAL	Fair Cash	Capped	Asmnt Level	Assessed	Levy Rate	104.132	Current Tax																																																																																																																	
Remove Cap	0	Land Value 77,209	27,009	11%	2,971	Assessed	24,078	2,507.29																																																																																																																	
Year Frozen	0	Improvements 209,988	191,882		21,107	Penalty	0																																																																																																																		
Uncapped Value	0	Mobile Home 0	0		0	Exemption	1,000	-87.00																																																																																																																	
TIF Project ID	0	Total Value 287,197	218,891		24,078	Total Taxable	23,078	2,420.00																																																																																																																	
Assessment History <table border="1"> <thead> <tr> <th>Tax Year</th> <th>Statement Number</th> <th>Billed Owner</th> <th>Tax Area</th> <th>Total Value</th> <th>Exemptions</th> <th>Taxable Value</th> <th>Billed Tax</th> </tr> </thead> <tbody> <tr><td>2025</td><td>2025-660031580</td><td>WILLIAMS, THEODORE B JR</td><td>80</td><td>280,274</td><td>1000</td><td>22,376</td><td>2,346.00</td></tr> <tr><td>2024</td><td>2024-660031580</td><td>WILLIAMS, THEODORE B JR</td><td>80</td><td>566,043</td><td>1000</td><td>21,696</td><td>2,090.00</td></tr> <tr><td>2023</td><td>2023-660031580</td><td>WILLIAMS, THEODORE B JR</td><td>80</td><td>203,812</td><td>1000</td><td>21,035</td><td>1,996.00</td></tr> <tr><td>2022</td><td>2022-660031580</td><td>WILLIAMS, THEODORE B JR</td><td>80</td><td>194,484</td><td>1000</td><td>20,393</td><td>1,970.00</td></tr> <tr><td>2021</td><td>2021-660031580</td><td>WILLIAMS, THEODORE B JR</td><td>80</td><td>203,669</td><td>1000</td><td>20,951</td><td>1,971.00</td></tr> <tr><td>2020</td><td>2020-660031580</td><td>WILLIAMS, THEODORE B JR</td><td>80</td><td>202,573</td><td>1000</td><td>20,311</td><td>1,916.00</td></tr> <tr><td>2019</td><td>2019-660031580</td><td>WILLIAMS, THEODORE B JR</td><td>80</td><td>202,021</td><td>1000</td><td>19,691</td><td>1,886.00</td></tr> <tr><td>2018</td><td>2018-660031580</td><td>WILLIAMS, THEODORE B JR</td><td>80</td><td>210,750</td><td>1000</td><td>19,088</td><td>1,829.00</td></tr> <tr><td>2017</td><td>2017-660031580</td><td>WILLIAMS, THEODORE B JR</td><td>80</td><td>208,894</td><td>1000</td><td>18,503</td><td>1,778.00</td></tr> <tr><td>2016</td><td>2016-660031580</td><td>WILLIAMS, THEODORE B JR</td><td>80</td><td>203,687</td><td>1000</td><td>17,935</td><td>1,729.00</td></tr> <tr><td>2015</td><td>2015-660031580</td><td>WILLIAMS, THEODORE B JR</td><td>80</td><td>197,796</td><td>1000</td><td>17,383</td><td>1,689.00</td></tr> <tr><td>2014</td><td>2014-660031580</td><td>WILLIAMS, THEODORE B JR</td><td>80</td><td>195,651</td><td>1000</td><td>16,848</td><td>1,550.00</td></tr> <tr><td>2013</td><td>2013-660031580</td><td>WILLIAMS, THEODORE B JR</td><td>80</td><td>186,941</td><td>1000</td><td>16,328</td><td>1,557.00</td></tr> </tbody> </table>										Tax Year	Statement Number	Billed Owner	Tax Area	Total Value	Exemptions	Taxable Value	Billed Tax	2025	2025-660031580	WILLIAMS, THEODORE B JR	80	280,274	1000	22,376	2,346.00	2024	2024-660031580	WILLIAMS, THEODORE B JR	80	566,043	1000	21,696	2,090.00	2023	2023-660031580	WILLIAMS, THEODORE B JR	80	203,812	1000	21,035	1,996.00	2022	2022-660031580	WILLIAMS, THEODORE B JR	80	194,484	1000	20,393	1,970.00	2021	2021-660031580	WILLIAMS, THEODORE B JR	80	203,669	1000	20,951	1,971.00	2020	2020-660031580	WILLIAMS, THEODORE B JR	80	202,573	1000	20,311	1,916.00	2019	2019-660031580	WILLIAMS, THEODORE B JR	80	202,021	1000	19,691	1,886.00	2018	2018-660031580	WILLIAMS, THEODORE B JR	80	210,750	1000	19,088	1,829.00	2017	2017-660031580	WILLIAMS, THEODORE B JR	80	208,894	1000	18,503	1,778.00	2016	2016-660031580	WILLIAMS, THEODORE B JR	80	203,687	1000	17,935	1,729.00	2015	2015-660031580	WILLIAMS, THEODORE B JR	80	197,796	1000	17,383	1,689.00	2014	2014-660031580	WILLIAMS, THEODORE B JR	80	195,651	1000	16,848	1,550.00	2013	2013-660031580	WILLIAMS, THEODORE B JR	80	186,941	1000	16,328	1,557.00
Tax Year	Statement Number	Billed Owner	Tax Area	Total Value	Exemptions	Taxable Value	Billed Tax																																																																																																																		
2025	2025-660031580	WILLIAMS, THEODORE B JR	80	280,274	1000	22,376	2,346.00																																																																																																																		
2024	2024-660031580	WILLIAMS, THEODORE B JR	80	566,043	1000	21,696	2,090.00																																																																																																																		
2023	2023-660031580	WILLIAMS, THEODORE B JR	80	203,812	1000	21,035	1,996.00																																																																																																																		
2022	2022-660031580	WILLIAMS, THEODORE B JR	80	194,484	1000	20,393	1,970.00																																																																																																																		
2021	2021-660031580	WILLIAMS, THEODORE B JR	80	203,669	1000	20,951	1,971.00																																																																																																																		
2020	2020-660031580	WILLIAMS, THEODORE B JR	80	202,573	1000	20,311	1,916.00																																																																																																																		
2019	2019-660031580	WILLIAMS, THEODORE B JR	80	202,021	1000	19,691	1,886.00																																																																																																																		
2018	2018-660031580	WILLIAMS, THEODORE B JR	80	210,750	1000	19,088	1,829.00																																																																																																																		
2017	2017-660031580	WILLIAMS, THEODORE B JR	80	208,894	1000	18,503	1,778.00																																																																																																																		
2016	2016-660031580	WILLIAMS, THEODORE B JR	80	203,687	1000	17,935	1,729.00																																																																																																																		
2015	2015-660031580	WILLIAMS, THEODORE B JR	80	197,796	1000	17,383	1,689.00																																																																																																																		
2014	2014-660031580	WILLIAMS, THEODORE B JR	80	195,651	1000	16,848	1,550.00																																																																																																																		
2013	2013-660031580	WILLIAMS, THEODORE B JR	80	186,941	1000	16,328	1,557.00																																																																																																																		



Rogers

Assessment Property Record Card for Tax Year 2026

Data provided by LISA DELOZIER County Assessor

Date 04/16/2026
 Time 22:50:29
 Page 2

Lot Data		Square-Foot - NBHD 1076 #1	
Lot Size			
Lot Count			
Units Buildable	41		
Non-Ag Acres	3.2648		
Topography			
Street Access			
Utilities			
Amenities	LAND QUALITY	0	
		0	
Method	Square-Foot		
Base Lot Value	142,213.00 x .54 = 77,209		
Factor Value			
Adjustments	1.0000		
Lot Value	77,209		



\\tsclient\TOM\COMMERCIAL PICS\2022-07-21\IMG_0020.JPG 7/21/2022

Residential Data	
Type	1 Single Family Residence
Condition	3 - Average
Quality	3 - Average
Architecture	
Style	100% One Story
Exterior Wall	90% Veneer, Masonry 10% Frame, Siding, Wood
Base/Total Area	2,290 / 2,290
Style	100% One Story
HVAC	100% Warmed & Cooled Air
Roof Cover	1 Composition Shingle
Area on Slab	2,290
Fixture/RghIn	10 /
Bed/F/H Bath	3 / 2.5 /
Basement Area	
Garage Type	638 Attached Garage - Unfinished
Remodel	
Year/Eff Age	1972 / 41

GRM Approach

GRM Code	
Gross Rent	0.00
Indicated Value	

Multiple Regression

MRA Code	1 Test
Adusted R	0.8445
Indicated Value	253,398 110.65 Per SqFt

Direct Comparables

Selection Model	A Adam Test
Adjustment Model	1 2022 Residential
Comparables	7
Indicated Value	266,790 Per SqFt

Value Reconciliation

Selected Approach	Cost Approach
Improvements	201,625
Lot Value	77,209
Indicated Value	278,834 121.76 Per SqFt
Agland Value	
Site Improvements	8,363
Total Value	287,197 125.41 Total Value Per SqFt

Cost Approach		Manual : 01/2025	
Base Cost	107.90	Total Misc Impr	+ 26,681
Roofing Adj	+ 4.74	Garage Cost	+ 20,112
Subfloor Adj	+ -2.28	Total RCN	= 344,379
Heat/Cool Adj	+ 13.15	Depreciation (47%)	- 161,858
Plumbing Adj	+ 6.44	Lump Sums	+ 19,104
Basement Adj	+ 0.00	RCNLD	= 201,625
Adj Base Cost	= 129.95	Lot Value	+ 77,209
Total Area	x 2,290	Indicated Value	= 278,834
Adjusted Cost	= 297,586	Value Per SqFt	121.76

Miscellaneous Improvements

Code	Description	Sketch ID	Size	Year	Units	Unit Cost	Depr	Value
FPR1	FIREPLACE - RESIDENTIAL 1 STORY	0		1	1	5,840.02		5,840
FPR1	FIREPLACE - RESIDENTIAL 1 STORY	0		1	1	5,840.02		5,840
@N15.0	SUBTERRN GARAGE	0			400	15.00		6,000
PRCH	SLAB PORCH - COVERED	75157	13x6		78	27.75		2,165
PRCH	SLAB PORCH - COVERED	75158	25x6		150	27.52		4,128
PRCH	SLAB PORCH - COVERED	75159	19x17		323	26.96		8,708
GRDT	GARAGE - DETACHED	75160	20x20		400	32.76		13,104



Rogers
Assessment Property Record Card for Tax Year 2026

Data provided by LISA DELOZIER County Assessor

Date 04/16/2026
 Time 22:50:29
 Page 3

Sketch Image

660031580

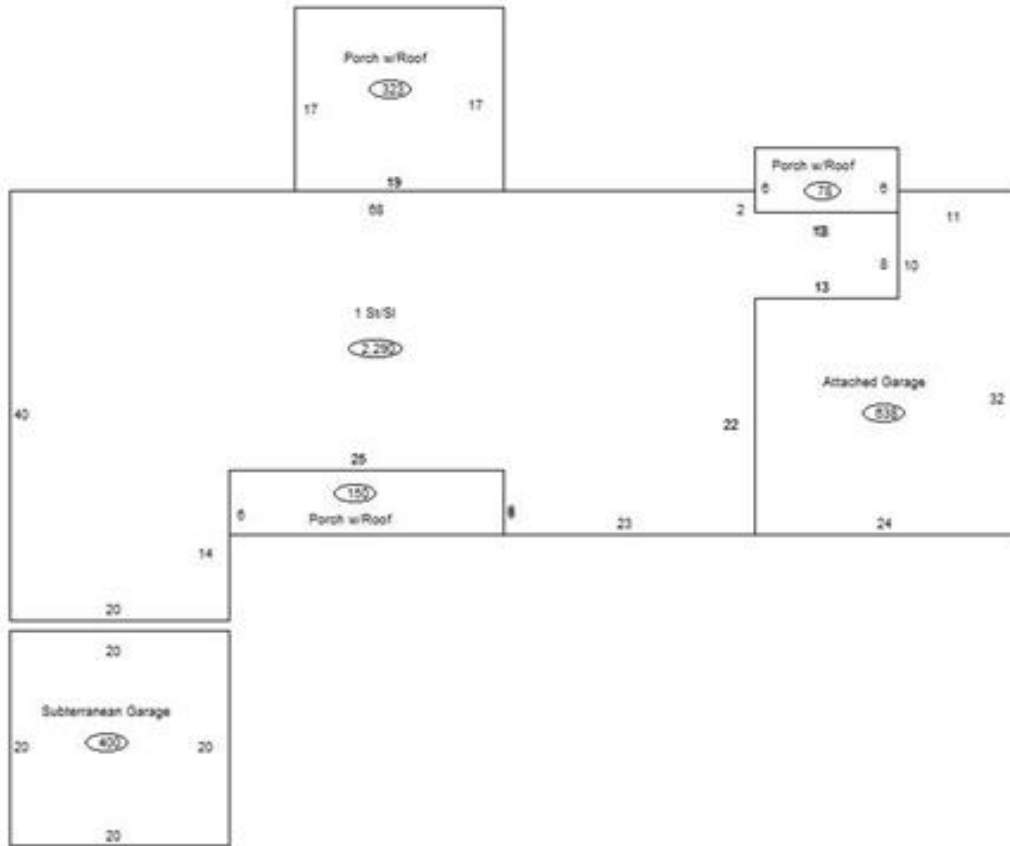

Sketch Vector Information

Sequence	Code	Type	Built Over	Scale	Section Label	Base Area	Multiplier	Total Area
1	R	1	Slab	13	1 St/Sl	2,290	1.000	2,290
2	G	1		13	Attached Garage	638	1.000	638
3	M	PRCH		13	SLBC	78	1.000	78
4	M	PRCH		13	SLBC	150	1.000	150
5	M	PRCH		13	SLBC	323	1.000	323
6	G	8		13	Subterranean Garage	400	1.000	400
Total Building Area						2,290		2,290



Rogers

Assessment Property Record Card for Tax Year 2026

Data provided by LISA DELOZIER County Assessor

Date 04/16/2026
 Time 22:50:29
 Page 4

660031580

Outbuildings/Site Improvements

Building Image	Code	Description	Dimensions	Floor	Roofing	Total Units
	BARN	BARN	0x0x0			576
	Qual	3	Cond 3	Year	Eff Age	
	Valuation Summary		Modifier Total		RCN	Depr (65% Phys/ % Func)
Base Cost (10.48 x 576)		6,036		6,036	3,923	2,113
	SV	SWIM VINYL	0x0x0			1
	Qual	3	Cond 3	Year	Eff Age	
	Valuation Summary		Modifier Total		RCN	Depr (75% Phys/ % Func)
Base Cost (25,000.00 x 1)		25,000		25,000	18,750	6,250