



Rogers

Assessment Property Record Card for Tax Year 2026

Data provided by LISA DELOZIER County Assessor

Date 04/16/2026
 Time 21:58:36
 Page 1

Assessment Data					Primary Image																																																																																																																				
Account 660031699 Parcel ID 000000-00-0-00078-002-0023 Cadastral ID 36-21-15-10430 Property Type REAL - Real Property Property Class URP VI Area 4 Tax Area 80 - VERDIGRIS TOWN/ VERDIGRI Name ID 334342 ROWE, DYLAN 24752 S HEARTWOOD DR CLAREMORE OK 74019-0000 Parcel Location Situs 24752 S HEARTWOOD DR Subdivision BRIDGEPORT II Lot/Block 0023 / 0002 Parcel Size 1 - Lots Sec/Twn/Rng 36 / 21 / 15 / 5 Neighborhood 1109 - R-V03-SW VERDIGRIS School District S008 - VERDIGRIS SCHOOLS					<p>\\tsclient\T\TOM\COMMERCIAL PICS\2022-07-13\IMG_0009.JPG 7/13/2022</p>																																																																																																																				
Legal Description Lot/Long: 36.25200198 -95.66303022																																																																																																																									
LOT 23 BLOCK 2 BRIDGEPORT 2					Building Permits <table border="1"> <thead> <tr> <th>Number</th> <th>Description</th> <th>Opened</th> <th>Closed</th> <th>Amount</th> </tr> </thead> <tbody> <tr> <td colspan="5"> </td> </tr> </tbody> </table>					Number	Description	Opened	Closed	Amount																																																																																																											
Number	Description	Opened	Closed	Amount																																																																																																																					
Exemptions <table border="1"> <thead> <tr> <th>Code</th> <th>Type</th> <th>Active</th> <th>Maximum</th> <th>Exemption</th> </tr> </thead> <tbody> <tr> <td>H</td> <td>Homestead</td> <td>No</td> <td>1,000</td> <td></td> </tr> <tr> <td>H</td> <td>Homestead</td> <td>No</td> <td>1,000</td> <td></td> </tr> </tbody> </table>					Code	Type	Active	Maximum	Exemption	H	Homestead	No	1,000		H	Homestead	No	1,000		Sale History <table border="1"> <thead> <tr> <th>Bk/Pg</th> <th>Grantor</th> <th>Date</th> <th>Price</th> <th>Code</th> </tr> </thead> <tbody> <tr> <td>/</td> <td>STEPHENS, KYLE</td> <td>05/03/2021</td> <td>175,000</td> <td>YES</td> </tr> <tr> <td>2507/874</td> <td>HOFFMAN, CHRIS &</td> <td>09/24/2015</td> <td>130,000</td> <td>YES</td> </tr> <tr> <td>2001/591</td> <td>CLARK, SHAWN W & KALLI K</td> <td>01/23/2009</td> <td>112,500</td> <td>YES</td> </tr> <tr> <td>1423/343</td> <td>GORDON, PEGGY A</td> <td>10/30/2002</td> <td>90,200</td> <td>YES</td> </tr> <tr> <td>1353/862</td> <td>LOPEZ, GLENNA J & WALTER J</td> <td>01/25/2002</td> <td>88,000</td> <td>YES</td> </tr> <tr> <td>1222/272</td> <td>HALL, JAMES RICHARD SR &</td> <td>03/30/2000</td> <td>85,000</td> <td>Yes</td> </tr> </tbody> </table>					Bk/Pg	Grantor	Date	Price	Code	/	STEPHENS, KYLE	05/03/2021	175,000	YES	2507/874	HOFFMAN, CHRIS &	09/24/2015	130,000	YES	2001/591	CLARK, SHAWN W & KALLI K	01/23/2009	112,500	YES	1423/343	GORDON, PEGGY A	10/30/2002	90,200	YES	1353/862	LOPEZ, GLENNA J & WALTER J	01/25/2002	88,000	YES	1222/272	HALL, JAMES RICHARD SR &	03/30/2000	85,000	Yes																																																														
Code	Type	Active	Maximum	Exemption																																																																																																																					
H	Homestead	No	1,000																																																																																																																						
H	Homestead	No	1,000																																																																																																																						
Bk/Pg	Grantor	Date	Price	Code																																																																																																																					
/	STEPHENS, KYLE	05/03/2021	175,000	YES																																																																																																																					
2507/874	HOFFMAN, CHRIS &	09/24/2015	130,000	YES																																																																																																																					
2001/591	CLARK, SHAWN W & KALLI K	01/23/2009	112,500	YES																																																																																																																					
1423/343	GORDON, PEGGY A	10/30/2002	90,200	YES																																																																																																																					
1353/862	LOPEZ, GLENNA J & WALTER J	01/25/2002	88,000	YES																																																																																																																					
1222/272	HALL, JAMES RICHARD SR &	03/30/2000	85,000	Yes																																																																																																																					
Parcel Valuation <table border="1"> <thead> <tr> <th>Source</th> <th>REAL</th> <th>Fair Cash</th> <th>Capped</th> <th>Asmnt Level</th> <th>Assessed</th> <th>Levy Rate</th> <th>104.132</th> <th>Current Tax</th> </tr> </thead> <tbody> <tr> <td>Remove Cap</td> <td>2022</td> <td>Land Value 55,761</td> <td>55,761</td> <td>11%</td> <td>6,134</td> <td>Assessed</td> <td>22,090</td> <td>2,300.27</td> </tr> <tr> <td>Year Frozen</td> <td>0</td> <td>Improvements 145,058</td> <td>145,058</td> <td></td> <td>15,956</td> <td>Penalty</td> <td>0</td> <td></td> </tr> <tr> <td>Uncapped Value</td> <td>0</td> <td>Mobile Home 0</td> <td>0</td> <td></td> <td>0</td> <td>Exemption</td> <td>0</td> <td>0.00</td> </tr> <tr> <td>TIF Project ID</td> <td>0</td> <td>Total Value 200,819</td> <td>200,819</td> <td></td> <td>22,090</td> <td>Total Taxable</td> <td>22,090</td> <td>2,300.00</td> </tr> </tbody> </table>										Source	REAL	Fair Cash	Capped	Asmnt Level	Assessed	Levy Rate	104.132	Current Tax	Remove Cap	2022	Land Value 55,761	55,761	11%	6,134	Assessed	22,090	2,300.27	Year Frozen	0	Improvements 145,058	145,058		15,956	Penalty	0		Uncapped Value	0	Mobile Home 0	0		0	Exemption	0	0.00	TIF Project ID	0	Total Value 200,819	200,819		22,090	Total Taxable	22,090	2,300.00																																																																			
Source	REAL	Fair Cash	Capped	Asmnt Level	Assessed	Levy Rate	104.132	Current Tax																																																																																																																	
Remove Cap	2022	Land Value 55,761	55,761	11%	6,134	Assessed	22,090	2,300.27																																																																																																																	
Year Frozen	0	Improvements 145,058	145,058		15,956	Penalty	0																																																																																																																		
Uncapped Value	0	Mobile Home 0	0		0	Exemption	0	0.00																																																																																																																	
TIF Project ID	0	Total Value 200,819	200,819		22,090	Total Taxable	22,090	2,300.00																																																																																																																	
Assessment History <table border="1"> <thead> <tr> <th>Tax Year</th> <th>Statement Number</th> <th>Billed Owner</th> <th>Tax Area</th> <th>Total Value</th> <th>Exemptions</th> <th>Taxable Value</th> <th>Billed Tax</th> </tr> </thead> <tbody> <tr><td>2025</td><td>2025-660031699</td><td>ROWE, DYLAN</td><td>80</td><td>201,049</td><td>0</td><td>21,223</td><td>2,210.00</td></tr> <tr><td>2024</td><td>2024-660031699</td><td>ROWE, DYLAN</td><td>80</td><td>210,594</td><td>0</td><td>20,212</td><td>1,937.00</td></tr> <tr><td>2023</td><td>2023-660031699</td><td>ROWE, DYLAN</td><td>80</td><td>175,000</td><td>0</td><td>19,251</td><td>1,817.00</td></tr> <tr><td>2022</td><td>2022-660031699</td><td>ROWE, DYLAN</td><td>80</td><td>175,000</td><td>0</td><td>19,251</td><td>1,850.00</td></tr> <tr><td>2021</td><td>2021-660031699</td><td>ROWE, DYLAN</td><td>80</td><td>145,774</td><td>1000</td><td>14,133</td><td>1,333.00</td></tr> <tr><td>2020</td><td>2020-660031699</td><td>STEPHENS, KYLE</td><td>80</td><td>134,644</td><td>1000</td><td>13,691</td><td>1,294.00</td></tr> <tr><td>2019</td><td>2019-660031699</td><td>STEPHENS, KYLE</td><td>80</td><td>129,669</td><td>1000</td><td>13,264</td><td>1,274.00</td></tr> <tr><td>2018</td><td>2018-660031699</td><td>STEPHENS, KYLE</td><td>80</td><td>133,222</td><td>1000</td><td>13,654</td><td>1,312.00</td></tr> <tr><td>2017</td><td>2017-660031699</td><td>STEPHENS, KYLE</td><td>80</td><td>132,165</td><td>1000</td><td>13,538</td><td>1,304.00</td></tr> <tr><td>2016</td><td>2016-660031699</td><td>STEPHENS, KYLE</td><td>80</td><td>129,023</td><td>1000</td><td>13,193</td><td>1,274.00</td></tr> <tr><td>2015</td><td>2015-660031699</td><td>HOFFMAN, CHRIS &</td><td>80</td><td>121,409</td><td>1000</td><td>12,355</td><td>1,204.00</td></tr> <tr><td>2014</td><td>2014-660031699</td><td>HOFFMAN, CHRIS &</td><td>80</td><td>122,380</td><td>1000</td><td>12,462</td><td>1,149.00</td></tr> <tr><td>2013</td><td>2013-660031699</td><td>HOFFMAN, CHRIS &</td><td>80</td><td>122,287</td><td>1000</td><td>12,452</td><td>1,190.00</td></tr> </tbody> </table>										Tax Year	Statement Number	Billed Owner	Tax Area	Total Value	Exemptions	Taxable Value	Billed Tax	2025	2025-660031699	ROWE, DYLAN	80	201,049	0	21,223	2,210.00	2024	2024-660031699	ROWE, DYLAN	80	210,594	0	20,212	1,937.00	2023	2023-660031699	ROWE, DYLAN	80	175,000	0	19,251	1,817.00	2022	2022-660031699	ROWE, DYLAN	80	175,000	0	19,251	1,850.00	2021	2021-660031699	ROWE, DYLAN	80	145,774	1000	14,133	1,333.00	2020	2020-660031699	STEPHENS, KYLE	80	134,644	1000	13,691	1,294.00	2019	2019-660031699	STEPHENS, KYLE	80	129,669	1000	13,264	1,274.00	2018	2018-660031699	STEPHENS, KYLE	80	133,222	1000	13,654	1,312.00	2017	2017-660031699	STEPHENS, KYLE	80	132,165	1000	13,538	1,304.00	2016	2016-660031699	STEPHENS, KYLE	80	129,023	1000	13,193	1,274.00	2015	2015-660031699	HOFFMAN, CHRIS &	80	121,409	1000	12,355	1,204.00	2014	2014-660031699	HOFFMAN, CHRIS &	80	122,380	1000	12,462	1,149.00	2013	2013-660031699	HOFFMAN, CHRIS &	80	122,287	1000	12,452	1,190.00
Tax Year	Statement Number	Billed Owner	Tax Area	Total Value	Exemptions	Taxable Value	Billed Tax																																																																																																																		
2025	2025-660031699	ROWE, DYLAN	80	201,049	0	21,223	2,210.00																																																																																																																		
2024	2024-660031699	ROWE, DYLAN	80	210,594	0	20,212	1,937.00																																																																																																																		
2023	2023-660031699	ROWE, DYLAN	80	175,000	0	19,251	1,817.00																																																																																																																		
2022	2022-660031699	ROWE, DYLAN	80	175,000	0	19,251	1,850.00																																																																																																																		
2021	2021-660031699	ROWE, DYLAN	80	145,774	1000	14,133	1,333.00																																																																																																																		
2020	2020-660031699	STEPHENS, KYLE	80	134,644	1000	13,691	1,294.00																																																																																																																		
2019	2019-660031699	STEPHENS, KYLE	80	129,669	1000	13,264	1,274.00																																																																																																																		
2018	2018-660031699	STEPHENS, KYLE	80	133,222	1000	13,654	1,312.00																																																																																																																		
2017	2017-660031699	STEPHENS, KYLE	80	132,165	1000	13,538	1,304.00																																																																																																																		
2016	2016-660031699	STEPHENS, KYLE	80	129,023	1000	13,193	1,274.00																																																																																																																		
2015	2015-660031699	HOFFMAN, CHRIS &	80	121,409	1000	12,355	1,204.00																																																																																																																		
2014	2014-660031699	HOFFMAN, CHRIS &	80	122,380	1000	12,462	1,149.00																																																																																																																		
2013	2013-660031699	HOFFMAN, CHRIS &	80	122,287	1000	12,452	1,190.00																																																																																																																		



Rogers

Assessment Property Record Card for Tax Year 2026

Data provided by LISA DELOZIER County Assessor

Date 04/16/2026
Time 21:58:36
Page 2

Lot Data	Square-Foot - NBHD 1109 #1	Primary Image
Lot Size Lot Count Units Buildable 1 Non-Ag Acres 0.257 Topography Street Access Utilities Amenities 0 Method Square-Foot Base Lot Value 11,193.00 x 4.98 = 55,761 Factor Value Adjustments 1.0000 Lot Value 55,761		 <p>\\tsclient\TOM\COMMERCIAL PICS\2022-07-13\IMG_0009.JPG 7/13/2022</p>

Residential Data	
Type	1 Single Family Residence
Condition	3 - Average
Quality	2.5 - Fair
Architecture	
Style	100% One Story
Exterior Wall	100% Veneer, Masonry
Base/Total Area	1,348 / 1,348
Style	100% One Story
HVAC	100% Warmed & Cooled Air
Roof Cover	1 Composition Shingle
Area on Slab	1,348
Fixture/RghIn	11 /
Bed/F/H Bath	3 / 2.0 /
Basement Area	
Garage Type	504 Attached Garage - Unfinished
Remodel	
Year/Eff Age	1997 / 22

Cost Approach				Manual : 01/2025			
Base Cost	109.57	Total Misc Impr	+ 8,652				
Roofing Adj	+ 4.63	Garage Cost	+ 13,810				
Subfloor Adj	+ -1.22	Total RCN	= 204,307				
Heat/Cool Adj	+ 11.47	Depreciation (29%)	- 59,249				
Plumbing Adj	+ 10.45	Lump Sums	+ 0				
Basement Adj	+ 0.00	RCNLD	= 145,058				
Adj Base Cost	= 134.90	Lot Value	+ 55,761				
Total Area	x 1,348	Indicated Value	= 200,819				
Adjusted Cost	= 181,845	Value Per SqFt	148.98				

GRM Approach	
GRM Code	
Gross Rent	0.00
Indicated Value	

Multiple Regression			
MRA Code	1	Test	
Adusted R	0.8445		
Indicated Value	172,460	127.94	Per SqFt

Direct Comparables			
Selection Model	A	Adam Test	
Adjustment Model	1	2022 Residential	
Comparables	8		
Indicated Value	171,880		Per SqFt

Value Reconciliation			
Selected Approach	Cost Approach		
Improvements	145,058		
Lot Value	55,761		
Indicated Value	200,819	148.98	Per SqFt
Agland Value			
Site Improvements			
Total Value	200,819	148.98	Total Value Per SqFt

Miscellaneous Improvements								
Code	Description	Sketch ID	Size	Year	Units	Unit Cost	Depr	Value
PRCH	SLAB PORCH - COVERED	75574	156		156	23.73		3,702
PATO	SLAB PORCH - OPEN	75575	13x4		52	10.86		565
PRCH	SLAB PORCH - COVERED	75576	18x10		180	23.64		4,255
PATO	SLAB PORCH - OPEN	75577	4x3		12	10.86		130



Rogers

Assessment Property Record Card for Tax Year 2026

Data provided by LISA DELOZIER County Assessor

Date 04/16/2026
 Time 21:58:36
 Page 3

Sketch Image

660031699

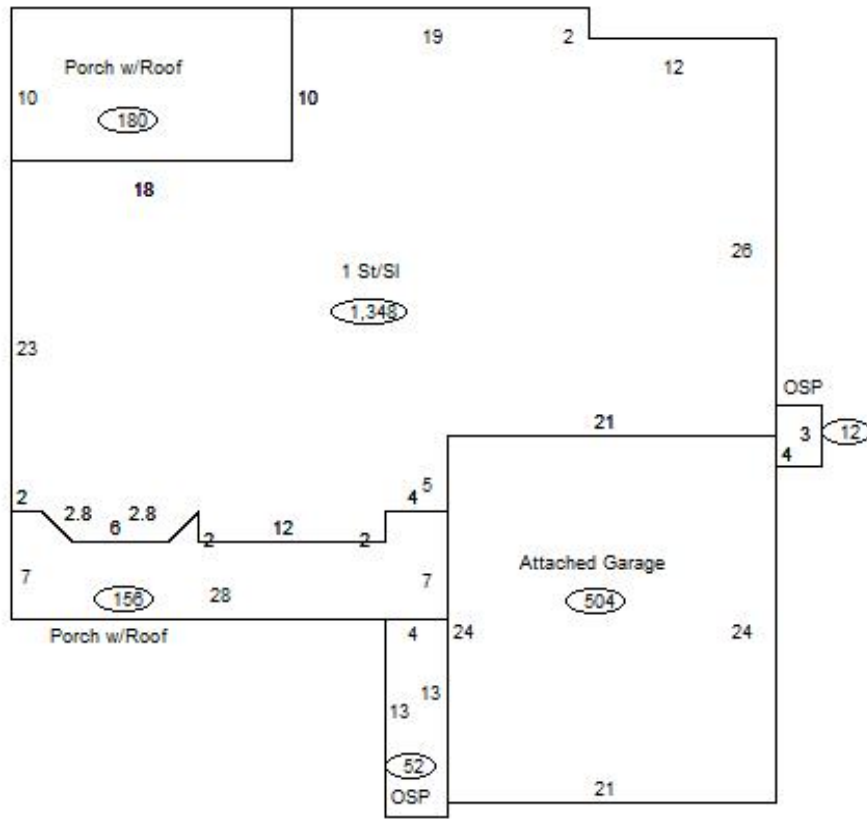

Sketch Vector Information

Sequence	Code	Type	Built Over	Scale	Section Label	Base Area	Multiplier	Total Area
1	R	1	Slab	13	1 St/Sl	1,348	1.000	1,348
2	G	1		13	Attached Garage	504	1.000	504
3	M	PRCH		13	SLBC	156	1.000	156
4	M	PATO		13	Open Slab	52	1.000	52
5	M	PRCH		13	SLBC	180	1.000	180
6	M	PATO		13	Open Slab	12	1.000	12
Total Building Area						1,348		1,348