



Rogers

Assessment Property Record Card for Tax Year 2026

Data provided by LISA DELOZIER County Assessor

Date 04/17/2026
Time 01:02:44
Page 1

Assessment Data					Primary Image																																																																																																																				
Account 660031772 Parcel ID 21N16E-36-1-00000-000-0000 Cadastral ID 36-21-16-01900 Property Type REAL - Real Property Property Class RR VI Area 1 Tax Area 5 - JUSTUS RURAL/NO FIRE Name ID 326433 COATS, DARRYL G & ANGELA L 24106 S 4190 CLAREMORE OK 74019-2592 Parcel Location Situs 24106 S 4190 RD Subdivision Lot/Block / Parcel Size 2.5 - Acres Sec/Twn/Rng 36 / 21 / 16 / 1 Neighborhood 2116 - UNPLATTED School District S009 - JUSTUS-TIAWAH SCHOOLS																																																																																																																									
Legal Description Lat/Long: 36.26242563 -95.54367369																																																																																																																									
SE NE NE NE					Building Permits <table border="1"> <thead> <tr> <th>Number</th> <th>Description</th> <th>Opened</th> <th>Closed</th> <th>Amount</th> </tr> </thead> <tbody> <tr> <td> </td> <td> </td> <td> </td> <td> </td> <td> </td> </tr> </tbody> </table>					Number	Description	Opened	Closed	Amount																																																																																																											
Number	Description	Opened	Closed	Amount																																																																																																																					
Exemptions <table border="1"> <thead> <tr> <th>Code</th> <th>Type</th> <th>Active</th> <th>Maximum</th> <th>Exemption</th> </tr> </thead> <tbody> <tr> <td>H</td> <td>Homestead</td> <td>Yes</td> <td>1,000</td> <td>1,000</td> </tr> </tbody> </table>					Code	Type	Active	Maximum	Exemption	H	Homestead	Yes	1,000	1,000	Sale History <table border="1"> <thead> <tr> <th>Bk/Pg</th> <th>Grantor</th> <th>Date</th> <th>Price</th> <th>Code</th> </tr> </thead> <tbody> <tr> <td>/</td> <td>HALL, MARGARET ESTELLE &</td> <td>10/27/2018</td> <td>155,000</td> <td>WB</td> </tr> <tr> <td>/</td> <td>EDDY, LAWRENCE D-TRUST</td> <td>10/22/2018</td> <td>0</td> <td>WB</td> </tr> <tr> <td>1464/36</td> <td>EDDY LIMITED PARTNERSHIP</td> <td>04/01/2003</td> <td>0</td> <td>4</td> </tr> <tr> <td>880/189</td> <td>SELLER</td> <td>04/23/1992</td> <td>0</td> <td>No</td> </tr> <tr> <td>687/437</td> <td> </td> <td> </td> <td>0</td> <td>No</td> </tr> </tbody> </table>					Bk/Pg	Grantor	Date	Price	Code	/	HALL, MARGARET ESTELLE &	10/27/2018	155,000	WB	/	EDDY, LAWRENCE D-TRUST	10/22/2018	0	WB	1464/36	EDDY LIMITED PARTNERSHIP	04/01/2003	0	4	880/189	SELLER	04/23/1992	0	No	687/437			0	No																																																																								
Code	Type	Active	Maximum	Exemption																																																																																																																					
H	Homestead	Yes	1,000	1,000																																																																																																																					
Bk/Pg	Grantor	Date	Price	Code																																																																																																																					
/	HALL, MARGARET ESTELLE &	10/27/2018	155,000	WB																																																																																																																					
/	EDDY, LAWRENCE D-TRUST	10/22/2018	0	WB																																																																																																																					
1464/36	EDDY LIMITED PARTNERSHIP	04/01/2003	0	4																																																																																																																					
880/189	SELLER	04/23/1992	0	No																																																																																																																					
687/437			0	No																																																																																																																					
Parcel Valuation <table border="1"> <thead> <tr> <th>Source</th> <th>REAL</th> <th>Fair Cash</th> <th>Capped</th> <th>Asmnt Level</th> <th>Assessed</th> <th>Levy Rate</th> <th>83.050</th> <th>Current Tax</th> </tr> </thead> <tbody> <tr> <td>Remove Cap</td> <td>2019</td> <td>Land Value 63,043</td> <td>39,384</td> <td>11%</td> <td>4,332</td> <td>Assessed</td> <td>15,248</td> <td>1,266.35</td> </tr> <tr> <td>Year Frozen</td> <td>0</td> <td>Improvements 113,464</td> <td>99,237</td> <td> </td> <td>10,916</td> <td>Penalty</td> <td>0</td> <td> </td> </tr> <tr> <td>Uncapped Value</td> <td>0</td> <td>Mobile Home 0</td> <td>0</td> <td> </td> <td>0</td> <td>Exemption</td> <td>1,000</td> <td>-83.00</td> </tr> <tr> <td>TIF Project ID</td> <td>0</td> <td>Total Value 176,507</td> <td>138,621</td> <td> </td> <td>15,248</td> <td>Total Taxable</td> <td>14,248</td> <td>1,183.00</td> </tr> </tbody> </table>										Source	REAL	Fair Cash	Capped	Asmnt Level	Assessed	Levy Rate	83.050	Current Tax	Remove Cap	2019	Land Value 63,043	39,384	11%	4,332	Assessed	15,248	1,266.35	Year Frozen	0	Improvements 113,464	99,237		10,916	Penalty	0		Uncapped Value	0	Mobile Home 0	0		0	Exemption	1,000	-83.00	TIF Project ID	0	Total Value 176,507	138,621		15,248	Total Taxable	14,248	1,183.00																																																																			
Source	REAL	Fair Cash	Capped	Asmnt Level	Assessed	Levy Rate	83.050	Current Tax																																																																																																																	
Remove Cap	2019	Land Value 63,043	39,384	11%	4,332	Assessed	15,248	1,266.35																																																																																																																	
Year Frozen	0	Improvements 113,464	99,237		10,916	Penalty	0																																																																																																																		
Uncapped Value	0	Mobile Home 0	0		0	Exemption	1,000	-83.00																																																																																																																	
TIF Project ID	0	Total Value 176,507	138,621		15,248	Total Taxable	14,248	1,183.00																																																																																																																	
Assessment History <table border="1"> <thead> <tr> <th>Tax Year</th> <th>Statement Number</th> <th>Billed Owner</th> <th>Tax Area</th> <th>Total Value</th> <th>Exemptions</th> <th>Taxable Value</th> <th>Billed Tax</th> </tr> </thead> <tbody> <tr><td>2025</td><td>2025-660031772</td><td>COATS, DARRYL G &</td><td>5</td><td>166,718</td><td>1000</td><td>13,804</td><td>1,146.00</td></tr> <tr><td>2024</td><td>2024-660031772</td><td>COATS, DARRYL G &</td><td>5</td><td>172,222</td><td>1000</td><td>13,374</td><td>1,116.00</td></tr> <tr><td>2023</td><td>2023-660031772</td><td>COATS, DARRYL G &</td><td>5</td><td>126,860</td><td>1000</td><td>12,955</td><td>1,079.00</td></tr> <tr><td>2022</td><td>2022-660031772</td><td>COATS, DARRYL G &</td><td>5</td><td>127,042</td><td>1000</td><td>12,975</td><td>1,079.00</td></tr> <tr><td>2021</td><td>2021-660031772</td><td>COATS, DARRYL G &</td><td>5</td><td>128,047</td><td>1000</td><td>13,086</td><td>1,110.00</td></tr> <tr><td>2020</td><td>2020-660031772</td><td>COATS, DARRYL G &</td><td>5</td><td>126,858</td><td>1000</td><td>12,954</td><td>1,097.00</td></tr> <tr><td>2019</td><td>2019-660031772</td><td>COATS, DARRYL G &</td><td>5</td><td>123,382</td><td>0</td><td>13,572</td><td>1,175.00</td></tr> <tr><td>2018</td><td>2018-660031772</td><td>EDDY, LAWRENCE D</td><td>5</td><td>116,045</td><td>0</td><td>12,765</td><td>1,107.00</td></tr> <tr><td>2017</td><td>2017-660031772</td><td>EDDY, LAWRENCE D</td><td>5</td><td>115,338</td><td>0</td><td>12,687</td><td>1,035.00</td></tr> <tr><td>2016</td><td>2016-660031772</td><td>EDDY, LAWRENCE D</td><td>5</td><td>113,007</td><td>0</td><td>12,431</td><td>1,060.00</td></tr> <tr><td>2015</td><td>2015-660031772</td><td>EDDY, LAWRENCE D</td><td>5</td><td>112,266</td><td>0</td><td>12,349</td><td>1,043.00</td></tr> <tr><td>2014</td><td>2014-660031772</td><td>EDDY, LAWRENCE D</td><td>5</td><td>114,091</td><td>0</td><td>12,550</td><td>1,077.00</td></tr> <tr><td>2013</td><td>2013-660031772</td><td>EDDY, LAWRENCE D</td><td>5</td><td>110,481</td><td>0</td><td>12,153</td><td>1,059.00</td></tr> </tbody> </table>										Tax Year	Statement Number	Billed Owner	Tax Area	Total Value	Exemptions	Taxable Value	Billed Tax	2025	2025-660031772	COATS, DARRYL G &	5	166,718	1000	13,804	1,146.00	2024	2024-660031772	COATS, DARRYL G &	5	172,222	1000	13,374	1,116.00	2023	2023-660031772	COATS, DARRYL G &	5	126,860	1000	12,955	1,079.00	2022	2022-660031772	COATS, DARRYL G &	5	127,042	1000	12,975	1,079.00	2021	2021-660031772	COATS, DARRYL G &	5	128,047	1000	13,086	1,110.00	2020	2020-660031772	COATS, DARRYL G &	5	126,858	1000	12,954	1,097.00	2019	2019-660031772	COATS, DARRYL G &	5	123,382	0	13,572	1,175.00	2018	2018-660031772	EDDY, LAWRENCE D	5	116,045	0	12,765	1,107.00	2017	2017-660031772	EDDY, LAWRENCE D	5	115,338	0	12,687	1,035.00	2016	2016-660031772	EDDY, LAWRENCE D	5	113,007	0	12,431	1,060.00	2015	2015-660031772	EDDY, LAWRENCE D	5	112,266	0	12,349	1,043.00	2014	2014-660031772	EDDY, LAWRENCE D	5	114,091	0	12,550	1,077.00	2013	2013-660031772	EDDY, LAWRENCE D	5	110,481	0	12,153	1,059.00
Tax Year	Statement Number	Billed Owner	Tax Area	Total Value	Exemptions	Taxable Value	Billed Tax																																																																																																																		
2025	2025-660031772	COATS, DARRYL G &	5	166,718	1000	13,804	1,146.00																																																																																																																		
2024	2024-660031772	COATS, DARRYL G &	5	172,222	1000	13,374	1,116.00																																																																																																																		
2023	2023-660031772	COATS, DARRYL G &	5	126,860	1000	12,955	1,079.00																																																																																																																		
2022	2022-660031772	COATS, DARRYL G &	5	127,042	1000	12,975	1,079.00																																																																																																																		
2021	2021-660031772	COATS, DARRYL G &	5	128,047	1000	13,086	1,110.00																																																																																																																		
2020	2020-660031772	COATS, DARRYL G &	5	126,858	1000	12,954	1,097.00																																																																																																																		
2019	2019-660031772	COATS, DARRYL G &	5	123,382	0	13,572	1,175.00																																																																																																																		
2018	2018-660031772	EDDY, LAWRENCE D	5	116,045	0	12,765	1,107.00																																																																																																																		
2017	2017-660031772	EDDY, LAWRENCE D	5	115,338	0	12,687	1,035.00																																																																																																																		
2016	2016-660031772	EDDY, LAWRENCE D	5	113,007	0	12,431	1,060.00																																																																																																																		
2015	2015-660031772	EDDY, LAWRENCE D	5	112,266	0	12,349	1,043.00																																																																																																																		
2014	2014-660031772	EDDY, LAWRENCE D	5	114,091	0	12,550	1,077.00																																																																																																																		
2013	2013-660031772	EDDY, LAWRENCE D	5	110,481	0	12,153	1,059.00																																																																																																																		



Rogers

Assessment Property Record Card for Tax Year 2026

Data provided by LISA DELOZIER County Assessor

Date 04/17/2026
Time 01:02:44
Page 2

Lot Data	Square-Foot - NBHD 2116 #1	Primary Image
Lot Size		
Lot Count		
Units Buildable	1	
Non-Ag Acres	2.6363	
Topography		
Street Access		
Utilities		
Amenities	LAND QUALITY	
	0	
	0	
Method	Square-Foot	
Base Lot Value	114,838.00 x .55 = 63,043	
Factor Value		
Adjustments	1.0000	
Lot Value	63,043	

Residential Data	
Type	1 Single Family Residence
Condition	2 - Fair
Quality	2 - Fair
Architecture	
Style	100% One Story
Exterior Wall	100% Veneer, Masonry
Base/Total Area	1,234 / 1,234
Style	100% One Story
HVAC	100% Warmed & Cooled Air
Roof Cover	1 Composition Shingle
Area on Slab	1,234
Fixture/RghIn	11 /
Bed/F/H Bath	3 / 2.0 /
Basement Area	
Garage Type	546 Attached Garage - Unfinished 2 Stalls
Remodel	
Year/Eff Age	1986 / 40



\\tsclient\T\TOMMY DUNLAP\VI Pictures\110222 (2)\IMG_0021.JPG 11/2/2022

GRM Approach	
GRM Code	
Gross Rent	0.00
Indicated Value	

Multiple Regression			
MRA Code	1	Test	
Adusted R	0.8445		
Indicated Value	165,911	134.45	Per SqFt

Direct Comparables	
Selection Model	A Adam Test
Adjustment Model	NewTest
Comparables	
Indicated Value	

Cost Approach				Manual : 01/2025			
Base Cost	101.68	Total Misc Impr	+	10,631			
Roofing Adj	+ 4.15	Garage Cost	+	12,498			
Subfloor Adj	+ 0.00	Total RCN	=	179,070			
Heat/Cool Adj	+ 10.30	Depreciation (50%)	-	89,535			
Plumbing Adj	+ 10.24	Lump Sums	+	0			
Basement Adj	+ 0.00	RCNLD	=	89,535			
Adj Base Cost	= 126.37	Lot Value	+	63,043			
Total Area	x 1,234	Indicated Value	=	152,578			
Adjusted Cost	= 155,941	Value Per SqFt		123.65			

Value Reconciliation			
Selected Approach	Cost Approach		
Improvements	89,535		
Lot Value	63,043		
Indicated Value	152,578	123.65	Per SqFt
Agland Value			
Site Improvements	23,929		
Total Value	176,507	143.04	Total Value Per SqFt

Miscellaneous Improvements								
Code	Description	Sketch ID	Size	Year	Units	Unit Cost	Depr	Value
FPR1	FIREPLACE - RESIDENTIAL 1 STORY	0		1	1	4,576.55		4,577
PRCH	SLAB PORCH - COVERED	75819	26x7		182	20.72		3,771
PATO	SLAB PORCH - OPEN	75820	276		276	8.27		2,283



Rogers

Assessment Property Record Card for Tax Year 2026

Data provided by LISA DELOZIER County Assessor

Date 04/17/2026
 Time 01:02:44
 Page 3

Sketch Image

660031772

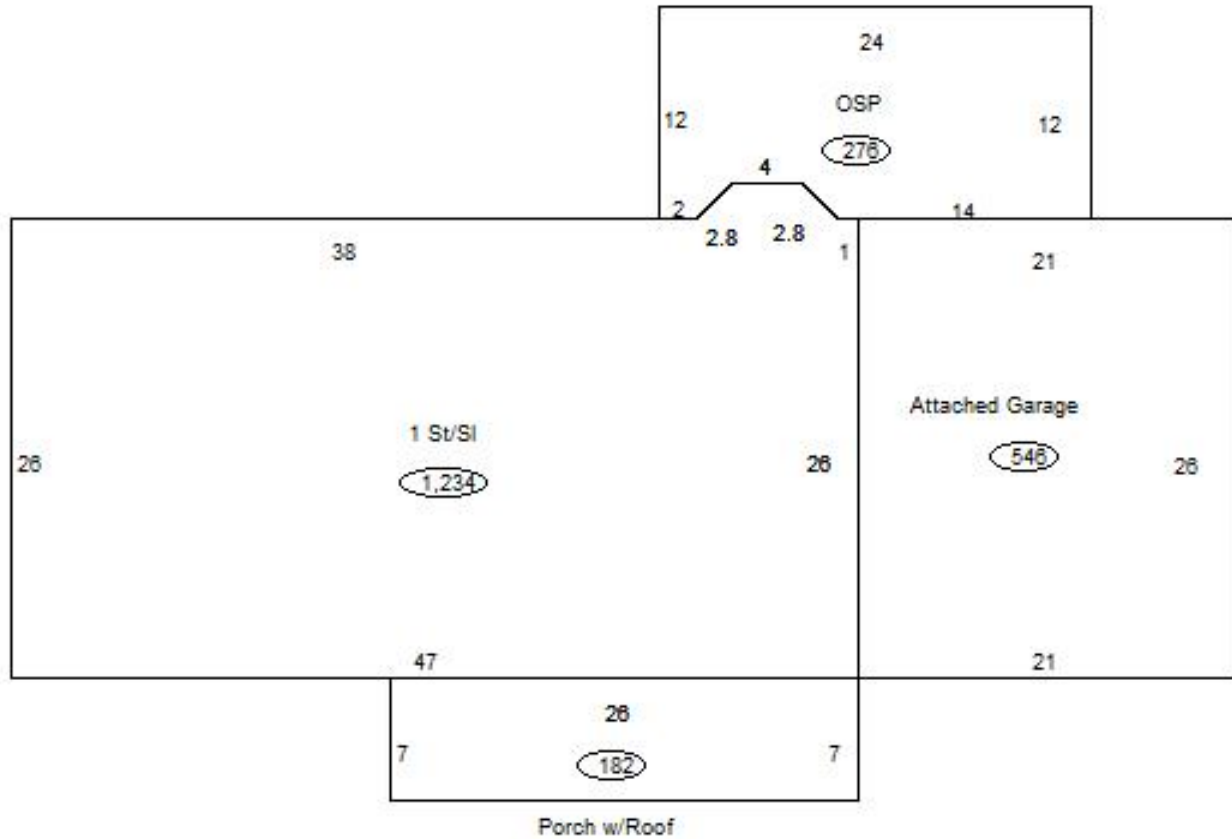

Sketch Vector Information

Sequence	Code	Type	Built Over	Scale	Section Label	Base Area	Multiplier	Total Area
1	R	1	Slab	13	1 St/Sl	1,234	1.000	1,234
2	G	1		13	Attached Garage	546	1.000	546
3	M	PRCH		13	SLBC	182	1.000	182
4	M	PATO		13	Open Slab	276	1.000	276
Total Building Area						1,234		1,234



Rogers

Assessment Property Record Card for Tax Year 2026

Data provided by LISA DELOZIER County Assessor

Date 04/17/2026
 Time 01:02:45
 Page 4

660031772

Outbuildings/Site Improvements

Building Image	Code	Description	Dimensions	Floor	Roofing	Total Units	
	UTIL	SHOP BUILDING	0x0x0			900	
	Qual	2	Cond 3	Year	Eff Age		
	Valuation Summary		Modifier Total		RCN	Depr (15% Phys/ % Func)	RCNLD
	Base Cost (31.28 x 900)		28,152		28,152	4,223	23,929
	STF	STG FAIR	0x0x0				
	Qual	2	Cond 3	Year	Eff Age 1520		
	Valuation Summary		Modifier Total		RCN	Depr (100% Phys/ % Func)	RCNLD
	Base Cost (4.68 x)						
	CKCP	Chicken Coop	0x0x0				
	Qual		Cond	Year	Eff Age		
	Valuation Summary		Modifier Total		RCN	Depr (100% Phys/ % Func)	RCNLD
	Base Cost (6.59 x)						