



Rogers

Assessment Property Record Card for Tax Year 2026

Data provided by LISA DELOZIER County Assessor

Date 04/16/2026
Time 21:17:32
Page 1

| Assessment Data | | | | | Primary Image | | | | | | | | | |
|---|----------------------------|-------------------------|---------|-------------|---------------|--------------------|---------------|---------------|------------|--|--|--|--|--|
| Account | 660031978 | | | | | | | | | | | | | |
| Parcel ID | 000000-00-0-00777-001-0024 | | | | | | | | | | | | | |
| Cadastral ID | 36-22-15-03420 | | | | | | | | | | | | | |
| Property Type | REAL - Real Property | | | | | | | | | | | | | |
| Property Class | RRP | VI Area 4 | | | | | | | | | | | | |
| Tax Area | 10 - OOLOGAH RURAL/NW FIRE | | | | | | | | | | | | | |
| Name ID | 314802 | | | | | | | | | | | | | |
| LIST, KRISTOPHER & JONI | | | | | | | | | | | | | | |
| 18095 S CREEKSIDE DR CLAREMORE OK 74017-0000 | | | | | | | | | | | | | | |
| Parcel Location | | | | | | | | | | | | | | |
| Situs | 18095 S CREEKSIDE DR | | | | | | | | | | | | | |
| Subdivision | STONE CREEK | | | | | | | | | | | | | |
| Lot/Block | 0024 / 0001 | Parcel Size 1 - Lots | | | | | | | | | | | | |
| Sec/Twn/Rng | 36 / 22 / 15 / 5 | | | | | | | | | | | | | |
| Neighborhood | 1114 - R-V01,4-NW OOLOGAH | | | | | | | | | | | | | |
| School District | S004 - OOLOGAH SCHOOLS | | | | | | | | | | | | | |
| Legal Description Lat/Long: 36.34930854 -95.65472454 | | | | | | | | | | | | | | |
| Building Permits | | | | | | | | | | | | | | |
| <table border="1"> <thead> <tr> <th>Number</th><th>Description</th><th>Opened</th><th>Closed</th><th>Amount</th></tr> </thead> <tbody> <tr> <td colspan="5"> </td></tr> </tbody> </table> | | | | | Number | Description | Opened | Closed | Amount | | | | | |
| Number | Description | Opened | Closed | Amount | | | | | | | | | | |
| | | | | | | | | | | | | | | |
| LOT 24 BLOCK 1 STONE CREEK | | | | | | | | | | | | | | |
| Exemptions | | | | | | | | | | | | | | |
| Sale History | | | | | | | | | | | | | | |
| Code | Type | Active | Maximum | Exemption | Bk/Pg | Grantor | Date | Price | Code | | | | | |
| | | | | | 2463/318 | US BANK NA | 02/12/2015 | 118,000 | 3 | | | | | |
| | | | | | 2443/782 | TAYLOR, KAREN S | 12/03/2014 | 0 | 10 | | | | | |
| | | | | | 1772/437 | WOOLARD, KERRY A & | 05/01/2006 | 149,000 | YES | | | | | |
| | | | | | 823/430 | | | 81,500 | No | | | | | |
| Parcel Valuation | | | | | | | | | | | | | | |
| Source | REAL | Fair Cash | Capped | Asmnt Level | Assessed | Levy Rate | 108.182 | Current Tax | | | | | | |
| Remove Cap | 2016 | Land Value | 75,506 | 58,038 | 11% | 6,384 | Assessed | 24,500 | 2,650.45 | | | | | |
| Year Frozen | 0 | Improvements | 164,691 | 164,691 | | 18,116 | Penalty | 0 | | | | | | |
| Uncapped Value | 0 | Mobile Home | 0 | 0 | | 0 | Exemption | 0 | 0.00 | | | | | |
| TIF Project ID | 0 | Total Value | 240,197 | 222,729 | | 24,500 | Total Taxable | 24,500 | 2,650.00 | | | | | |
| Assessment History | | | | | | | | | | | | | | |
| Tax Year | Statement Number | Billed Owner | | | Tax Area | Total Value | Exemptions | Taxable Value | Billed Tax | | | | | |
| 2025 | 2025-660031978 | LIST, KRISTOPHER & JONI | | | 10 | 234,462 | 0 | 23,333 | 2,524.00 | | | | | |
| 2024 | 2024-660031978 | LIST, KRISTOPHER & JONI | | | 10 | 251,541 | 0 | 22,222 | 2,327.00 | | | | | |
| 2023 | 2023-660031978 | LIST, KRISTOPHER & JONI | | | 10 | 192,402 | 0 | 21,164 | 2,201.00 | | | | | |
| 2022 | 2022-660031978 | LIST, KRISTOPHER & JONI | | | 10 | 194,816 | 0 | 21,430 | 2,218.00 | | | | | |
| 2021 | 2021-660031978 | LIST, KRISTOPHER & JONI | | | 10 | 187,753 | 0 | 20,653 | 2,153.00 | | | | | |
| 2020 | 2020-660031978 | LIST, KRISTOPHER & JONI | | | 10 | 188,567 | 0 | 20,742 | 2,194.00 | | | | | |
| 2019 | 2019-660031978 | LIST, KRISTOPHER & JONI | | | 10 | 179,697 | 0 | 19,767 | 2,052.00 | | | | | |
| 2018 | 2018-660031978 | LIST, KRISTOPHER & JONI | | | 10 | 184,503 | 0 | 20,295 | 2,179.00 | | | | | |
| 2017 | 2017-660031978 | LIST, KRISTOPHER & JONI | | | 10 | 183,089 | 0 | 20,140 | 2,290.00 | | | | | |
| 2016 | 2016-660031978 | LIST, KRISTOPHER & JONI | | | 10 | 178,655 | 0 | 19,652 | 2,035.00 | | | | | |
| 2015 | 2015-660031978 | LIST, KRISTOPHER & JONI | | | 10 | 174,427 | 0 | 18,973 | 1,859.00 | | | | | |
| 2014 | 2014-660031978 | TAYLOR, KAREN S | | | 10 | 180,139 | 0 | 18,070 | 1,768.00 | | | | | |
| 2013 | 2013-660031978 | TAYLOR, KAREN S | | | 10 | 170,818 | 0 | 17,210 | 1,629.00 | | | | | |



Rogers

Assessment Property Record Card for Tax Year 2026

Data provided by LISA DELOZIER County Assessor

Date 04/16/2026
 Time 21:17:33
 Page 2

| Lot Data | | Square-Foot - NBHD 1114 #1 | |
|-----------------|---------------------------|----------------------------|--|
| Lot Size | | | |
| Lot Count | | | |
| Units Buildable | 1 | | |
| Non-Ag Acres | 1.3334 | | |
| Topography | | | |
| Street Access | | | |
| Utilities | | | |
| Amenities | LAND VALUE | 0 | |
| | | 0 | |
| Method | Square-Foot | | |
| Base Lot Value | 58,085.00 x 1.30 = 75,506 | | |
| Factor Value | | | |
| Adjustments | 1.0000 | | |
| Lot Value | 75,506 | | |

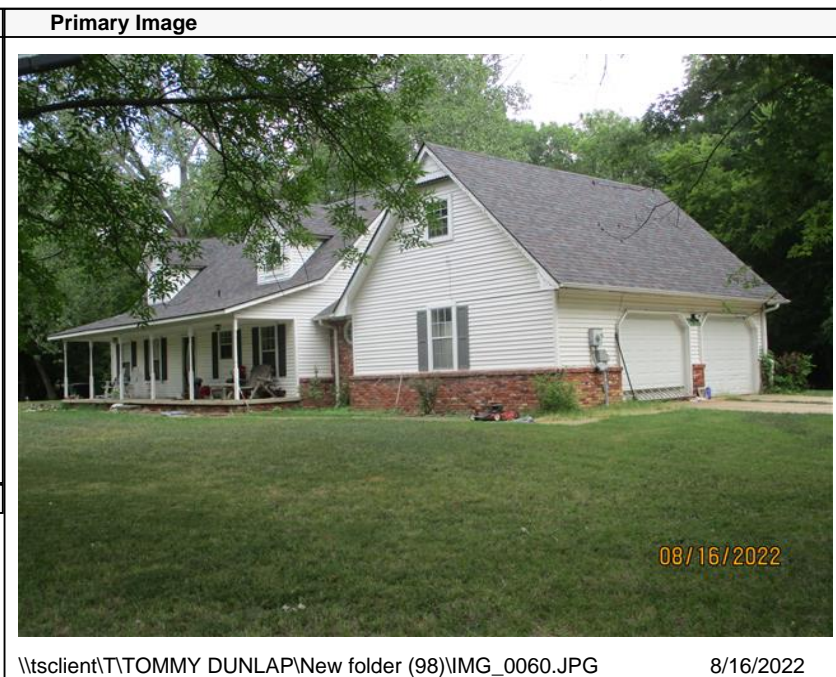

\\tsclient\T\TOMMY DUNLAP\New folder (98)\IMG_0060.JPG 8/16/2022

| Residential Data | |
|------------------|--|
| Type | 1 Single Family Residence |
| Condition | 3 - Average |
| Quality | 3 - Average |
| Architecture | |
| Style | 100% 1 1/2 Story Finished |
| Exterior Wall | 80% Frame, Siding, Vinyl 20% Veneer, Masonry |
| Base/Total Area | 1,166 / 1,926 |
| Style | 100% 1 1/2 Story Finished |
| HVAC | 100% Warmed & Cooled Air |
| Roof Cover | 1 Composition Shingle |
| Area on Slab | 1,166 |
| Fixture/RghIn | 14 / |
| Bed/F/H Bath | 3 / 2.5 / |
| Basement Area | |
| Garage Type | 601 Attached Garage - Unfinished |
| Remodel | |
| Year/Eff Age | 1986 / 30 |

GRM Approach

| | |
|-----------------|------|
| GRM Code | |
| Gross Rent | 0.00 |
| Indicated Value | |

Multiple Regression

| | |
|-----------------|-------------------------|
| MRA Code | 1 Test |
| Adjusted R | 0.8445 |
| Indicated Value | 228,119 118.44 Per SqFt |

Direct Comparables

| | |
|------------------|--------------------|
| Selection Model | A Adam Test |
| Adjustment Model | 1 2022 Residential |
| Comparables | 6 |
| Indicated Value | 263,340 Per SqFt |

Value Reconciliation

| | |
|-------------------|-------------------------------------|
| Selected Approach | Cost Approach |
| Improvements | 164,691 |
| Lot Value | 75,506 |
| Indicated Value | 240,197 124.71 Per SqFt |
| Agland Value | |
| Site Improvements | |
| Total Value | 240,197 124.71 Total Value Per SqFt |

| Cost Approach | | Manual : 01/2025 | |
|---------------|-----------|---------------------|-----------|
| Base Cost | 92.37 | Total Misc Impr | + 18,026 |
| Roofing Adj | + 3.20 | Garage Cost | + 18,355 |
| Subfloor Adj | + -1.50 | Total RCN | = 261,415 |
| Heat/Cool Adj | + 12.64 | Depreciation (37%) | - 96,724 |
| Plumbing Adj | + 10.13 | Lump Sums | + 0 |
| Basement Adj | + 0.00 | RCNLD | = 164,691 |
| Adj Base Cost | = 116.84 | Lot Value | + 75,506 |
| Total Area | x 1,926 | Indicated Value | = 240,197 |
| Adjusted Cost | = 225,034 | Value Per SqFt | 124.71 |

Miscellaneous Improvements

| Code | Description | Sketch ID | Size | Year | Units | Unit Cost | Depr | Value |
|------|---------------------------------|-----------|-------|------|-------|-----------|------|-------|
| FPR1 | FIREPLACE - RESIDENTIAL 1 STORY | 0 | | 1 | 1 | 5,615.40 | | 5,615 |
| PRCH | SLAB PORCH - COVERED | 76478 | 41x6 | | 246 | 26.16 | | 6,435 |
| PRCH | SLAB PORCH - COVERED | 76479 | 19x12 | | 228 | 26.21 | | 5,976 |



Rogers

Assessment Property Record Card for Tax Year 2026

Data provided by LISA DELOZIER County Assessor

Date 04/16/2026
 Time 21:17:33
 Page 3

Sketch Image

660031978

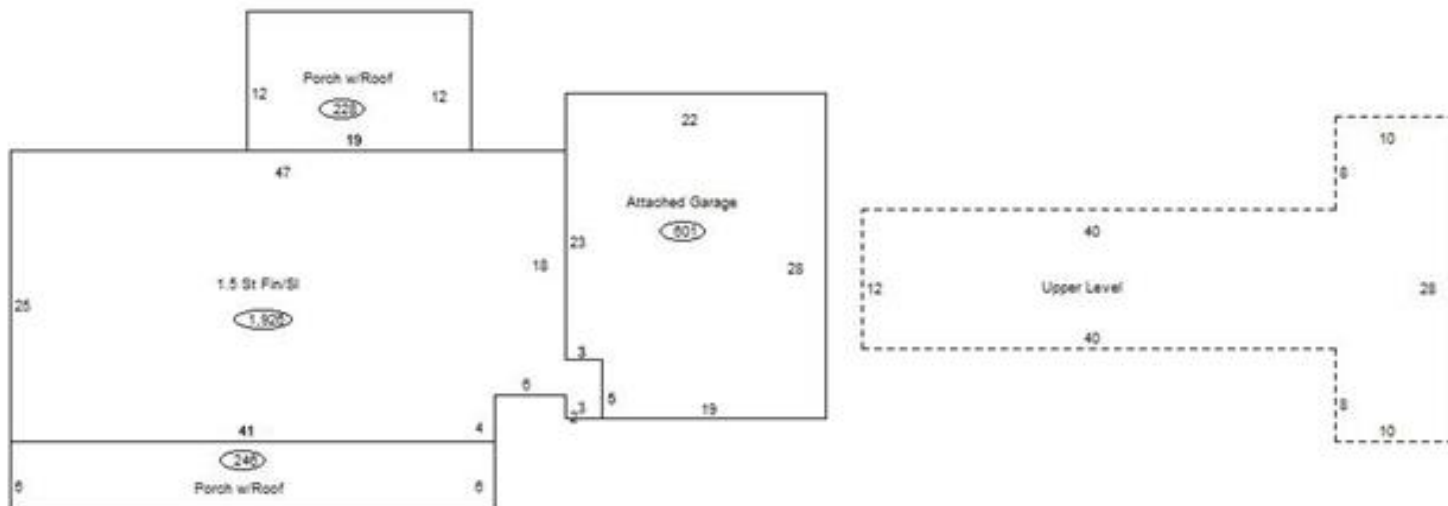

Sketch Vector Information

| Sequence | Code | Type | Built Over | Scale | Section Label | Base Area | Multiplier | Total Area |
|----------------------------|------|------|------------|-------|-----------------|--------------|------------|--------------|
| 1 | R | 5 | Slab | 13 | 1.5 St Fin/Sl | 1,166 | 1.652 | 1,926 |
| 2 | G | 1 | | 13 | Attached Garage | 601 | 1.000 | 601 |
| 3 | M | PRCH | | 13 | SLBC | 246 | 1.000 | 246 |
| 4 | M | PRCH | | 13 | SLBC | 228 | 1.000 | 228 |
| 5 | U | ^UL | Overhang | 13 | Upper Level | 760 | 1.000 | 760 |
| Total Building Area | | | | | | 1,166 | | 1,926 |