



Rogers

Assessment Property Record Card for Tax Year 2026

Data provided by LISA DELOZIER County Assessor

Date 04/17/2026
Time 01:05:49
Page 1

Assessment Data					Primary Image																																																																																																																				
Account 660052056 Parcel ID 000000-00-0-00502-002-0010 Cadastral ID 34-21-16-03070 Property Type REAL - Real Property Property Class RRP VI Area 1 Tax Area 5 - JUSTUS RURAL/NO FIRE Name ID 322302 ARNOLD, DAVID & BRIANNA R 14105 E 530 RD CLAREMORE OK 74017-0000 Parcel Location Situs 14105 E 530 RD Subdivision MEADOWRANCH IV Lot/Block 0010 / 0002 Parcel Size 1 - Lots Sec/Twn/Rng 34 / 21 / 16 / 5 Neighborhood 1127 - R-V01,3,4-SE JUSTUS School District S009 - JUSTUS-TIAWAH SCHOOLS																																																																																																																									
Legal Description Lot/Long: 36.24996377 -95.58104955																																																																																																																									
Building Permits					<table border="1"> <thead> <tr> <th>Number</th> <th>Description</th> <th>Opened</th> <th>Closed</th> <th>Amount</th> </tr> </thead> <tbody> <tr> <td colspan="5"> </td> </tr> </tbody> </table>					Number	Description	Opened	Closed	Amount																																																																																																											
Number	Description	Opened	Closed	Amount																																																																																																																					
Exemptions					Sale History																																																																																																																				
<table border="1"> <thead> <tr> <th>Code</th> <th>Type</th> <th>Active</th> <th>Maximum</th> <th>Exemption</th> </tr> </thead> <tbody> <tr> <td>H</td> <td>Homestead</td> <td>No</td> <td>1,000</td> <td></td> </tr> </tbody> </table>					Code	Type	Active	Maximum	Exemption	H	Homestead	No	1,000		<table border="1"> <thead> <tr> <th>Bk/Pg</th> <th>Grantor</th> <th>Date</th> <th>Price</th> <th>Code</th> </tr> </thead> <tbody> <tr> <td>2656/293</td> <td>GRACE, DARRELL L & KRISANN M</td> <td>08/28/2017</td> <td>189,000</td> <td>YES</td> </tr> <tr> <td>1168/926</td> <td>HARRIS, JON GILBERT &</td> <td>04/30/1999</td> <td>115,000</td> <td>Yes</td> </tr> <tr> <td>1020/648</td> <td>MOSLEY, KEVIN M & ANNETTE-M</td> <td>03/29/1996</td> <td>103,000</td> <td>Yes</td> </tr> <tr> <td>988/335</td> <td>GRIGGS, RONNIE J &</td> <td>05/01/1995</td> <td>93,000</td> <td>Yes</td> </tr> <tr> <td>967/9</td> <td>YORK, DICK TRUSTEE</td> <td>08/20/1994</td> <td>10,000</td> <td>No</td> </tr> </tbody> </table>					Bk/Pg	Grantor	Date	Price	Code	2656/293	GRACE, DARRELL L & KRISANN M	08/28/2017	189,000	YES	1168/926	HARRIS, JON GILBERT &	04/30/1999	115,000	Yes	1020/648	MOSLEY, KEVIN M & ANNETTE-M	03/29/1996	103,000	Yes	988/335	GRIGGS, RONNIE J &	05/01/1995	93,000	Yes	967/9	YORK, DICK TRUSTEE	08/20/1994	10,000	No																																																																								
Code	Type	Active	Maximum	Exemption																																																																																																																					
H	Homestead	No	1,000																																																																																																																						
Bk/Pg	Grantor	Date	Price	Code																																																																																																																					
2656/293	GRACE, DARRELL L & KRISANN M	08/28/2017	189,000	YES																																																																																																																					
1168/926	HARRIS, JON GILBERT &	04/30/1999	115,000	Yes																																																																																																																					
1020/648	MOSLEY, KEVIN M & ANNETTE-M	03/29/1996	103,000	Yes																																																																																																																					
988/335	GRIGGS, RONNIE J &	05/01/1995	93,000	Yes																																																																																																																					
967/9	YORK, DICK TRUSTEE	08/20/1994	10,000	No																																																																																																																					
Parcel Valuation																																																																																																																									
<table border="1"> <thead> <tr> <th>Source</th> <th>REAL</th> </tr> </thead> <tbody> <tr> <td>Remove Cap</td> <td>2018</td> </tr> <tr> <td>Year Frozen</td> <td>0</td> </tr> <tr> <td>Uncapped Value</td> <td>0</td> </tr> <tr> <td>TIF Project ID</td> <td>0</td> </tr> </tbody> </table>		Source	REAL	Remove Cap	2018	Year Frozen	0	Uncapped Value	0	TIF Project ID	0	<table border="1"> <thead> <tr> <th>Fair Cash</th> <th>Capped</th> <th>Asmnt Level</th> <th>Assessed</th> </tr> </thead> <tbody> <tr> <td>Land Value</td> <td>60,091</td> <td>60,091</td> <td>6,610</td> </tr> <tr> <td>Improvements</td> <td>168,302</td> <td>168,302</td> <td>18,513</td> </tr> <tr> <td>Mobile Home</td> <td>0</td> <td>0</td> <td>0</td> </tr> <tr> <td>Total Value</td> <td>228,393</td> <td>228,393</td> <td>25,123</td> </tr> </tbody> </table>			Fair Cash	Capped	Asmnt Level	Assessed	Land Value	60,091	60,091	6,610	Improvements	168,302	168,302	18,513	Mobile Home	0	0	0	Total Value	228,393	228,393	25,123	<table border="1"> <thead> <tr> <th>Levy Rate</th> <th>Current Tax</th> </tr> </thead> <tbody> <tr> <td>83.050</td> <td></td> </tr> <tr> <td>Assessed</td> <td>25,123</td> </tr> <tr> <td>Penalty</td> <td>0</td> </tr> <tr> <td>Exemption</td> <td>0</td> </tr> <tr> <td>Total Taxable</td> <td>25,123</td> </tr> </tbody> </table>		Levy Rate	Current Tax	83.050		Assessed	25,123	Penalty	0	Exemption	0	Total Taxable	25,123																																																																									
Source	REAL																																																																																																																								
Remove Cap	2018																																																																																																																								
Year Frozen	0																																																																																																																								
Uncapped Value	0																																																																																																																								
TIF Project ID	0																																																																																																																								
Fair Cash	Capped	Asmnt Level	Assessed																																																																																																																						
Land Value	60,091	60,091	6,610																																																																																																																						
Improvements	168,302	168,302	18,513																																																																																																																						
Mobile Home	0	0	0																																																																																																																						
Total Value	228,393	228,393	25,123																																																																																																																						
Levy Rate	Current Tax																																																																																																																								
83.050																																																																																																																									
Assessed	25,123																																																																																																																								
Penalty	0																																																																																																																								
Exemption	0																																																																																																																								
Total Taxable	25,123																																																																																																																								
Assessment History																																																																																																																									
<table border="1"> <thead> <tr> <th>Tax Year</th> <th>Statement Number</th> <th>Billed Owner</th> <th>Tax Area</th> <th>Total Value</th> <th>Exemptions</th> <th>Taxable Value</th> <th>Billed Tax</th> </tr> </thead> <tbody> <tr><td>2025</td><td>2025-660052056</td><td>ARNOLD, DAVID & BRIANNA R</td><td>5</td><td>224,597</td><td>0</td><td>24,706</td><td>2,052.00</td></tr> <tr><td>2024</td><td>2024-660052056</td><td>ARNOLD, DAVID & BRIANNA R</td><td>5</td><td>233,927</td><td>0</td><td>25,283</td><td>2,110.00</td></tr> <tr><td>2023</td><td>2023-660052056</td><td>ARNOLD, DAVID & BRIANNA R</td><td>5</td><td>218,897</td><td>0</td><td>24,079</td><td>2,005.00</td></tr> <tr><td>2022</td><td>2022-660052056</td><td>ARNOLD, DAVID & BRIANNA R</td><td>5</td><td>223,676</td><td>0</td><td>23,023</td><td>1,915.00</td></tr> <tr><td>2021</td><td>2021-660052056</td><td>ARNOLD, DAVID & BRIANNA R</td><td>5</td><td>199,338</td><td>0</td><td>21,927</td><td>1,860.00</td></tr> <tr><td>2020</td><td>2020-660052056</td><td>ARNOLD, DAVID & BRIANNA R</td><td>5</td><td>196,035</td><td>0</td><td>21,501</td><td>1,820.00</td></tr> <tr><td>2019</td><td>2019-660052056</td><td>ARNOLD, DAVID & BRIANNA R</td><td>5</td><td>186,160</td><td>0</td><td>20,477</td><td>1,773.00</td></tr> <tr><td>2018</td><td>2018-660052056</td><td>ARNOLD, DAVID & BRIANNA R</td><td>5</td><td>191,092</td><td>0</td><td>21,020</td><td>1,822.00</td></tr> <tr><td>2017</td><td>2017-660052056</td><td>ARNOLD, DAVID & BRIANNA R</td><td>5</td><td>160,705</td><td>1000</td><td>16,072</td><td>1,311.00</td></tr> <tr><td>2016</td><td>2016-660052056</td><td>GRACE, DARRELL L & KRISANN M</td><td>5</td><td>156,320</td><td>1000</td><td>15,574</td><td>1,328.00</td></tr> <tr><td>2015</td><td>2015-660052056</td><td>GRACE, DARRELL L & KRISANN M</td><td>5</td><td>152,412</td><td>1000</td><td>15,092</td><td>1,275.00</td></tr> <tr><td>2014</td><td>2014-660052056</td><td>GRACE, DARRELL L & KRISANN M</td><td>5</td><td>154,209</td><td>1000</td><td>14,623</td><td>1,255.00</td></tr> <tr><td>2013</td><td>2013-660052056</td><td>GRACE, DARRELL L & KRISANN M</td><td>5</td><td>145,047</td><td>1000</td><td>14,168</td><td>1,234.00</td></tr> </tbody> </table>										Tax Year	Statement Number	Billed Owner	Tax Area	Total Value	Exemptions	Taxable Value	Billed Tax	2025	2025-660052056	ARNOLD, DAVID & BRIANNA R	5	224,597	0	24,706	2,052.00	2024	2024-660052056	ARNOLD, DAVID & BRIANNA R	5	233,927	0	25,283	2,110.00	2023	2023-660052056	ARNOLD, DAVID & BRIANNA R	5	218,897	0	24,079	2,005.00	2022	2022-660052056	ARNOLD, DAVID & BRIANNA R	5	223,676	0	23,023	1,915.00	2021	2021-660052056	ARNOLD, DAVID & BRIANNA R	5	199,338	0	21,927	1,860.00	2020	2020-660052056	ARNOLD, DAVID & BRIANNA R	5	196,035	0	21,501	1,820.00	2019	2019-660052056	ARNOLD, DAVID & BRIANNA R	5	186,160	0	20,477	1,773.00	2018	2018-660052056	ARNOLD, DAVID & BRIANNA R	5	191,092	0	21,020	1,822.00	2017	2017-660052056	ARNOLD, DAVID & BRIANNA R	5	160,705	1000	16,072	1,311.00	2016	2016-660052056	GRACE, DARRELL L & KRISANN M	5	156,320	1000	15,574	1,328.00	2015	2015-660052056	GRACE, DARRELL L & KRISANN M	5	152,412	1000	15,092	1,275.00	2014	2014-660052056	GRACE, DARRELL L & KRISANN M	5	154,209	1000	14,623	1,255.00	2013	2013-660052056	GRACE, DARRELL L & KRISANN M	5	145,047	1000	14,168	1,234.00
Tax Year	Statement Number	Billed Owner	Tax Area	Total Value	Exemptions	Taxable Value	Billed Tax																																																																																																																		
2025	2025-660052056	ARNOLD, DAVID & BRIANNA R	5	224,597	0	24,706	2,052.00																																																																																																																		
2024	2024-660052056	ARNOLD, DAVID & BRIANNA R	5	233,927	0	25,283	2,110.00																																																																																																																		
2023	2023-660052056	ARNOLD, DAVID & BRIANNA R	5	218,897	0	24,079	2,005.00																																																																																																																		
2022	2022-660052056	ARNOLD, DAVID & BRIANNA R	5	223,676	0	23,023	1,915.00																																																																																																																		
2021	2021-660052056	ARNOLD, DAVID & BRIANNA R	5	199,338	0	21,927	1,860.00																																																																																																																		
2020	2020-660052056	ARNOLD, DAVID & BRIANNA R	5	196,035	0	21,501	1,820.00																																																																																																																		
2019	2019-660052056	ARNOLD, DAVID & BRIANNA R	5	186,160	0	20,477	1,773.00																																																																																																																		
2018	2018-660052056	ARNOLD, DAVID & BRIANNA R	5	191,092	0	21,020	1,822.00																																																																																																																		
2017	2017-660052056	ARNOLD, DAVID & BRIANNA R	5	160,705	1000	16,072	1,311.00																																																																																																																		
2016	2016-660052056	GRACE, DARRELL L & KRISANN M	5	156,320	1000	15,574	1,328.00																																																																																																																		
2015	2015-660052056	GRACE, DARRELL L & KRISANN M	5	152,412	1000	15,092	1,275.00																																																																																																																		
2014	2014-660052056	GRACE, DARRELL L & KRISANN M	5	154,209	1000	14,623	1,255.00																																																																																																																		
2013	2013-660052056	GRACE, DARRELL L & KRISANN M	5	145,047	1000	14,168	1,234.00																																																																																																																		



Rogers

Assessment Property Record Card for Tax Year 2026

Data provided by LISA DELOZIER County Assessor

Date 04/17/2026
 Time 01:05:49
 Page 2

Lot Data		Square-Foot - NBHD 1127 #1	
Lot Size			
Lot Count			
Units Buildable	1		
Non-Ag Acres	1.1069		
Topography			
Street Access			
Utilities			
Amenities	LAND QUALITY	0	0
Method	Square-Foot		
Base Lot Value	48,217.00 x 1.25 = 60,091		
Factor Value			
Adjustments	1.0000		
Lot Value	60,091		



\\tsclient\T\LOGAN\LOGAN RESIDENTIAL VI\2023-11-29\IMG_001 11/29/2023

Residential Data	
Type	1 Single Family Residence
Condition	3 - Average
Quality	3 - Average
Architecture	
Style	100% 1 1/2 Story Finished
Exterior Wall	90% Frame, Siding, Vinyl 10% Veneer, Masonry
Base/Total Area	1,160 / 1,800
Style	100% 1 1/2 Story Finished
HVAC	100% Warmed & Cooled Air
Roof Cover	1 Composition Shingle
Area on Slab	1,160
Fixture/RghIn	14 /
Bed/F/H Bath	3 / 2.5 /
Basement Area	
Garage Type	529 Attached Garage - Unfinished 2 Stalls
Remodel	
Year/Eff Age	1995 / 23

GRM Approach

GRM Code	
Gross Rent	0.00
Indicated Value	

Multiple Regression

MRA Code	1 Test
Adusted R	0.8445
Indicated Value	222,156 123.42 Per SqFt

Direct Comparables

Selection Model	A Adam Test
Adjustment Model	1 2022 Residential
Comparables	8
Indicated Value	253,400 Per SqFt

Value Reconciliation

Selected Approach	Cost Approach
Improvements	168,302
Lot Value	60,091
Indicated Value	228,393 126.89 Per SqFt
Agland Value	
Site Improvements	
Total Value	228,393 126.89 Total Value Per SqFt

Cost Approach		Manual : 01/2025	
Base Cost	86.76	Total Misc Impr	+ 15,621
Roofing Adj	+ 3.21	Garage Cost	+ 16,658
Subfloor Adj	+ -1.52	Total RCN	= 233,753
Heat/Cool Adj	+ 12.64	Depreciation (28%)	- 65,451
Plumbing Adj	+ 10.84	Lump Sums	+ 0
Basement Adj	+ 0.00	RCNLD	= 168,302
Adj Base Cost	= 111.93	Lot Value	+ 60,091
Total Area	x 1,800	Indicated Value	= 228,393
Adjusted Cost	= 201,474	Value Per SqFt	126.89

Miscellaneous Improvements

Code	Description	Sketch ID	Size	Year	Units	Unit Cost	Depr	Value
FPR1	FIREPLACE - RESIDENTIAL 1 STORY	0		1	1	5,615.40		5,615
PRCH	SLAB PORCH - COVERED	77674	34x6		204	26.29		5,363
PRCH	SLAB PORCH - COVERED	77675	16x11		176	26.38		4,643



Rogers

Assessment Property Record Card for Tax Year 2026

Data provided by LISA DELOZIER County Assessor

Date 04/17/2026

Time 01:05:49

Page 3

Sketch Image

660052056

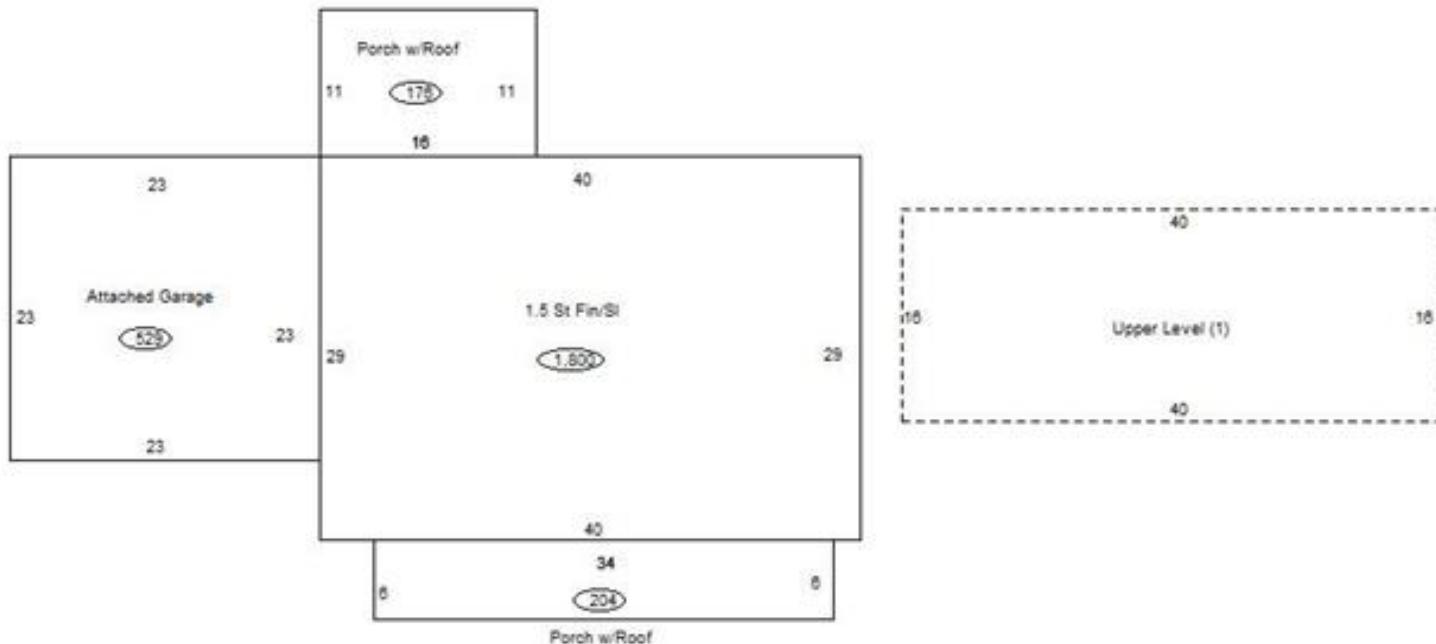

Sketch Vector Information

Sequence	Code	Type	Built Over	Scale	Section Label	Base Area	Multiplier	Total Area
1	R	5	Slab	13	1.5 St Fin/Sl	1,160	1.552	1,800
2	G	1		13	Attached Garage	529	1.000	529
3	M	PRCH		13	SLBC	204	1.000	204
4	M	PRCH		13	SLBC	176	1.000	176
5	U	^UL		13	Upper Level (1)	640	1.000	640
Total Building Area						1,160		1,800



Rogers



Assessment Property Record Card for Tax Year 2026

Data provided by LISA DELOZIER County Assessor

Date 04/17/2026
Time 01:05:49
Page 4

660052056

Outbuildings/Site Improvements

Building Image	Code	Description	Dimensions	Floor	Roofing	Total Units
	STF Qual 2	STG FAIR Cond	0x0x0 Year		Eff Age	
		Valuation Summary	Modifier Total	RCN	Depr (100% Phys/ % Func)	RCNLD
		Base Cost (4.68 x)				
	STF Qual 2	STG FAIR Cond	0x0x0 Year		Eff Age	
		Valuation Summary	Modifier Total	RCN	Depr (100% Phys/ % Func)	RCNLD
		Base Cost (4.68 x)				