



Rogers

Assessment Property Record Card for Tax Year 2026

Data provided by LISA DELOZIER County Assessor

Date 04/17/2026
 Time 16:35:31
 Page 1

Assessment Data					Primary Image																																																																																																																				
Account 660052066 Parcel ID 000000-00-0-00931-001-0001 Cadastral ID 34-21-14-01760 Property Type REAL - Real Property Property Class RRP VI Area 4 Tax Area 3 - OWASSO RURAL/NO FIRE Name ID 346958 MOHR, RICHARD & LINDSEY 15003 E 75TH PL N OWASSO OK 74055-0000 Parcel Location Situs 15003 E 75TH PL N Subdivision WILLOW-WOOD EST Lot/Block 0001 / 0001 Parcel Size 1 - Lots Sec/Twn/Rng 34 / 21 / 14 / 5 Neighborhood 1212 - R-V04-SW OWASSO School District S021 - OWASSO SCHOOLS																																																																																																																									
Legal Description Lat/Long: 36.26375442 -95.80633103																																																																																																																									
Legal Description LOT 1 BLOCK 1 WILLOW-WOOD ESTATES					Building Permits <table border="1"> <thead> <tr> <th>Number</th> <th>Description</th> <th>Opened</th> <th>Closed</th> <th>Amount</th> </tr> </thead> <tbody> <tr> <td colspan="5"> </td> </tr> </tbody> </table>					Number	Description	Opened	Closed	Amount																																																																																																											
Number	Description	Opened	Closed	Amount																																																																																																																					
Exemptions <table border="1"> <thead> <tr> <th>Code</th> <th>Type</th> <th>Active</th> <th>Maximum</th> <th>Exemption</th> </tr> </thead> <tbody> <tr> <td>H</td> <td>Homestead</td> <td>No</td> <td>1,000</td> <td></td> </tr> </tbody> </table>					Code	Type	Active	Maximum	Exemption	H	Homestead	No	1,000		Sale History <table border="1"> <thead> <tr> <th>Bk/Pg</th> <th>Grantor</th> <th>Date</th> <th>Price</th> <th>Code</th> </tr> </thead> <tbody> <tr> <td>/</td> <td>MUSGRAVE, ROBERT D &</td> <td>04/18/2025</td> <td>550,500</td> <td>YES</td> </tr> <tr> <td>2634/44</td> <td>WICKS, JAMES DALE &</td> <td>05/03/2017</td> <td>359,000</td> <td>YES</td> </tr> <tr> <td>2188/446</td> <td>HALLMAN, REX EUGENE &</td> <td>08/09/2011</td> <td>280,000</td> <td>YES</td> </tr> <tr> <td>1895/531</td> <td>SMITH, RICHARD L & RUBY J</td> <td>07/17/2007</td> <td>245,500</td> <td>YES</td> </tr> <tr> <td>1895/531</td> <td>SMITH, RICHARD</td> <td>07/17/2007</td> <td>245,500</td> <td>YES</td> </tr> <tr> <td>1132/3</td> <td>MESSER, BRIAN WAYNE</td> <td>09/04/1998</td> <td>14,000</td> <td>Yes</td> </tr> </tbody> </table>					Bk/Pg	Grantor	Date	Price	Code	/	MUSGRAVE, ROBERT D &	04/18/2025	550,500	YES	2634/44	WICKS, JAMES DALE &	05/03/2017	359,000	YES	2188/446	HALLMAN, REX EUGENE &	08/09/2011	280,000	YES	1895/531	SMITH, RICHARD L & RUBY J	07/17/2007	245,500	YES	1895/531	SMITH, RICHARD	07/17/2007	245,500	YES	1132/3	MESSER, BRIAN WAYNE	09/04/1998	14,000	Yes																																																																			
Code	Type	Active	Maximum	Exemption																																																																																																																					
H	Homestead	No	1,000																																																																																																																						
Bk/Pg	Grantor	Date	Price	Code																																																																																																																					
/	MUSGRAVE, ROBERT D &	04/18/2025	550,500	YES																																																																																																																					
2634/44	WICKS, JAMES DALE &	05/03/2017	359,000	YES																																																																																																																					
2188/446	HALLMAN, REX EUGENE &	08/09/2011	280,000	YES																																																																																																																					
1895/531	SMITH, RICHARD L & RUBY J	07/17/2007	245,500	YES																																																																																																																					
1895/531	SMITH, RICHARD	07/17/2007	245,500	YES																																																																																																																					
1132/3	MESSER, BRIAN WAYNE	09/04/1998	14,000	Yes																																																																																																																					
Parcel Valuation <table border="1"> <thead> <tr> <th>Source</th> <th>REAL</th> <th>Fair Cash</th> <th>Capped</th> <th>Asmnt Level</th> <th>Assessed</th> <th>Levy Rate</th> <th>97.960</th> <th>Current Tax</th> </tr> </thead> <tbody> <tr> <td>Remove Cap</td> <td>2026</td> <td>Land Value 110,775</td> <td>110,775</td> <td>11%</td> <td>12,185</td> <td>Assessed</td> <td>60,555</td> <td>5,931.97</td> </tr> <tr> <td>Year Frozen</td> <td>0</td> <td>Improvements 439,727</td> <td>439,727</td> <td></td> <td>48,370</td> <td>Penalty</td> <td>0</td> <td></td> </tr> <tr> <td>Uncapped Value</td> <td>0</td> <td>Mobile Home 0</td> <td>0</td> <td></td> <td>0</td> <td>Exemption</td> <td>0</td> <td>0.00</td> </tr> <tr> <td>TIF Project ID</td> <td>0</td> <td>Total Value 550,502</td> <td>550,502</td> <td></td> <td>60,555</td> <td>Total Taxable</td> <td>60,555</td> <td>5,932.00</td> </tr> </tbody> </table>										Source	REAL	Fair Cash	Capped	Asmnt Level	Assessed	Levy Rate	97.960	Current Tax	Remove Cap	2026	Land Value 110,775	110,775	11%	12,185	Assessed	60,555	5,931.97	Year Frozen	0	Improvements 439,727	439,727		48,370	Penalty	0		Uncapped Value	0	Mobile Home 0	0		0	Exemption	0	0.00	TIF Project ID	0	Total Value 550,502	550,502		60,555	Total Taxable	60,555	5,932.00																																																																			
Source	REAL	Fair Cash	Capped	Asmnt Level	Assessed	Levy Rate	97.960	Current Tax																																																																																																																	
Remove Cap	2026	Land Value 110,775	110,775	11%	12,185	Assessed	60,555	5,931.97																																																																																																																	
Year Frozen	0	Improvements 439,727	439,727		48,370	Penalty	0																																																																																																																		
Uncapped Value	0	Mobile Home 0	0		0	Exemption	0	0.00																																																																																																																	
TIF Project ID	0	Total Value 550,502	550,502		60,555	Total Taxable	60,555	5,932.00																																																																																																																	
Assessment History <table border="1"> <thead> <tr> <th>Tax Year</th> <th>Statement Number</th> <th>Billed Owner</th> <th>Tax Area</th> <th>Total Value</th> <th>Exemptions</th> <th>Taxable Value</th> <th>Billed Tax</th> </tr> </thead> <tbody> <tr><td>2025</td><td>2025-660052066</td><td>MOHR, RICHARD & LINDSEY</td><td>3</td><td>537,999</td><td>1000</td><td>44,889</td><td>4,397.00</td></tr> <tr><td>2024</td><td>2024-660052066</td><td>MUSGRAVE, ROBERT D &</td><td>3</td><td>528,135</td><td>1000</td><td>43,553</td><td>4,184.00</td></tr> <tr><td>2023</td><td>2023-660052066</td><td>MUSGRAVE, ROBERT D &</td><td>3</td><td>412,734</td><td>1000</td><td>42,255</td><td>3,960.00</td></tr> <tr><td>2022</td><td>2022-660052066</td><td>MUSGRAVE, ROBERT D &</td><td>3</td><td>414,407</td><td>1000</td><td>40,996</td><td>4,016.00</td></tr> <tr><td>2021</td><td>2021-660052066</td><td>MUSGRAVE, ROBERT D &</td><td>3</td><td>370,655</td><td>1000</td><td>39,773</td><td>3,848.00</td></tr> <tr><td>2020</td><td>2020-660052066</td><td>MUSGRAVE, ROBERT D &</td><td>3</td><td>364,672</td><td>1000</td><td>38,675</td><td>3,736.00</td></tr> <tr><td>2019</td><td>2019-660052066</td><td>MUSGRAVE, ROBERT D &</td><td>3</td><td>350,169</td><td>0</td><td>38,519</td><td>3,724.00</td></tr> <tr><td>2018</td><td>2018-660052066</td><td>MUSGRAVE, ROBERT D &</td><td>3</td><td>359,796</td><td>0</td><td>39,578</td><td>3,684.00</td></tr> <tr><td>2017</td><td>2017-660052066</td><td>MUSGRAVE, ROBERT D &</td><td>3</td><td>281,203</td><td>1000</td><td>29,932</td><td>2,815.00</td></tr> <tr><td>2016</td><td>2016-660052066</td><td>WICKS, JAMES DALE &</td><td>3</td><td>274,088</td><td>1000</td><td>29,081</td><td>2,738.00</td></tr> <tr><td>2015</td><td>2015-660052066</td><td>WICKS, JAMES DALE &</td><td>3</td><td>265,497</td><td>1000</td><td>28,205</td><td>2,675.00</td></tr> <tr><td>2014</td><td>2014-660052066</td><td>WICKS, JAMES DALE &</td><td>3</td><td>269,397</td><td>0</td><td>29,634</td><td>2,837.00</td></tr> <tr><td>2013</td><td>2013-660052066</td><td>WICKS, JAMES DALE &</td><td>3</td><td>304,875</td><td>0</td><td>32,785</td><td>3,071.00</td></tr> </tbody> </table>										Tax Year	Statement Number	Billed Owner	Tax Area	Total Value	Exemptions	Taxable Value	Billed Tax	2025	2025-660052066	MOHR, RICHARD & LINDSEY	3	537,999	1000	44,889	4,397.00	2024	2024-660052066	MUSGRAVE, ROBERT D &	3	528,135	1000	43,553	4,184.00	2023	2023-660052066	MUSGRAVE, ROBERT D &	3	412,734	1000	42,255	3,960.00	2022	2022-660052066	MUSGRAVE, ROBERT D &	3	414,407	1000	40,996	4,016.00	2021	2021-660052066	MUSGRAVE, ROBERT D &	3	370,655	1000	39,773	3,848.00	2020	2020-660052066	MUSGRAVE, ROBERT D &	3	364,672	1000	38,675	3,736.00	2019	2019-660052066	MUSGRAVE, ROBERT D &	3	350,169	0	38,519	3,724.00	2018	2018-660052066	MUSGRAVE, ROBERT D &	3	359,796	0	39,578	3,684.00	2017	2017-660052066	MUSGRAVE, ROBERT D &	3	281,203	1000	29,932	2,815.00	2016	2016-660052066	WICKS, JAMES DALE &	3	274,088	1000	29,081	2,738.00	2015	2015-660052066	WICKS, JAMES DALE &	3	265,497	1000	28,205	2,675.00	2014	2014-660052066	WICKS, JAMES DALE &	3	269,397	0	29,634	2,837.00	2013	2013-660052066	WICKS, JAMES DALE &	3	304,875	0	32,785	3,071.00
Tax Year	Statement Number	Billed Owner	Tax Area	Total Value	Exemptions	Taxable Value	Billed Tax																																																																																																																		
2025	2025-660052066	MOHR, RICHARD & LINDSEY	3	537,999	1000	44,889	4,397.00																																																																																																																		
2024	2024-660052066	MUSGRAVE, ROBERT D &	3	528,135	1000	43,553	4,184.00																																																																																																																		
2023	2023-660052066	MUSGRAVE, ROBERT D &	3	412,734	1000	42,255	3,960.00																																																																																																																		
2022	2022-660052066	MUSGRAVE, ROBERT D &	3	414,407	1000	40,996	4,016.00																																																																																																																		
2021	2021-660052066	MUSGRAVE, ROBERT D &	3	370,655	1000	39,773	3,848.00																																																																																																																		
2020	2020-660052066	MUSGRAVE, ROBERT D &	3	364,672	1000	38,675	3,736.00																																																																																																																		
2019	2019-660052066	MUSGRAVE, ROBERT D &	3	350,169	0	38,519	3,724.00																																																																																																																		
2018	2018-660052066	MUSGRAVE, ROBERT D &	3	359,796	0	39,578	3,684.00																																																																																																																		
2017	2017-660052066	MUSGRAVE, ROBERT D &	3	281,203	1000	29,932	2,815.00																																																																																																																		
2016	2016-660052066	WICKS, JAMES DALE &	3	274,088	1000	29,081	2,738.00																																																																																																																		
2015	2015-660052066	WICKS, JAMES DALE &	3	265,497	1000	28,205	2,675.00																																																																																																																		
2014	2014-660052066	WICKS, JAMES DALE &	3	269,397	0	29,634	2,837.00																																																																																																																		
2013	2013-660052066	WICKS, JAMES DALE &	3	304,875	0	32,785	3,071.00																																																																																																																		



Rogers

Assessment Property Record Card for Tax Year 2026

Data provided by LISA DELOZIER County Assessor

Date 04/17/2026
Time 16:35:32
Page 2

Lot Data	Square-Foot - NBHD 1212 #1	Primary Image
Lot Size Lot Count Units Buildable 1 Non-Ag Acres 1.1395 Topography Street Access Utilities Amenities LAND QUALITY 0 0 Method Square-Foot Base Lot Value 49,637.00 x 2.50 = 123,993 Factor Value Adjustments 0.8934 Lot Value 110,775		

Residential Data	
Type	1 Single Family Residence
Condition	3 - Average
Quality	4.5 - Good
Architecture	
Style	100% 1 1/2 Story Finished
Exterior Wall	100% Veneer, Masonry
Base/Total Area	2,113 / 3,387
Style	100% 1 1/2 Story Finished
HVAC	100% Warmed & Cooled Air
Roof Cover	1 Composition Shingle
Area on Slab	2,113
Fixture/RghIn	20 /
Bed/F/H Bath	4 / 2.5 /
Basement Area	
Garage Type	736 Attached Garage - Unfinished
Remodel	
Year/Eff Age	1999 / 20



\\tsclient\TCASEY\CASEY BOOTH RESIDENTIAL VI\2022-6-23\ 6/23/2022

GRM Approach	
GRM Code	
Gross Rent	0.00
Indicated Value	

Multiple Regression			
MRA Code	1	Test	
Adjusted R	0.8445		
Indicated Value	531,260	156.85	Per SqFt

Direct Comparables			
Selection Model	A	Adam Test	
Adjustment Model	1	2022 Residential	
Comparables	1		
Indicated Value	18,370		Per SqFt

Cost Approach				Manual : 01/2025			
Base Cost	105.21	Total Misc Impr	+ 21,076				
Roofing Adj	+ 3.97	Garage Cost	+ 35,630				
Subfloor Adj	+ -2.88	Total RCN	= 513,511				
Heat/Cool Adj	+ 17.38	Depreciation (23%)	- 118,108				
Plumbing Adj	+ 11.19	Lump Sums	+ 0				
Basement Adj	+ 0.00	RCNLD	= 395,403				
Adj Base Cost	= 134.87	Lot Value	+ 110,775				
Total Area	x 3,387	Indicated Value	= 506,178				
Adjusted Cost	= 456,805	Value Per SqFt	149.45				

Value Reconciliation			
Selected Approach	Cost Approach		
Improvements	395,403		
Lot Value	110,775		
Indicated Value	506,178	149.45	Per SqFt
Agland Value			
Site Improvements	44,324		
Total Value	550,502	162.53	Total Value Per SqFt

Miscellaneous Improvements								
Code	Description	Sketch ID	Size	Year	Units	Unit Cost	Depr	Value
PRCH	SLAB PORCH - COVERED	77679	162		162	35.91		5,817
PRCH	SLAB PORCH - COVERED	77680	36x8		288	35.25		10,152
PATO	SLAB PORCH - OPEN	77682	28x16		448	11.40		5,107



Rogers

Assessment Property Record Card for Tax Year 2026

Data provided by LISA DELOZIER County Assessor

Date 04/17/2026

Time 16:35:32

Page 3

Sketch Image

660052066

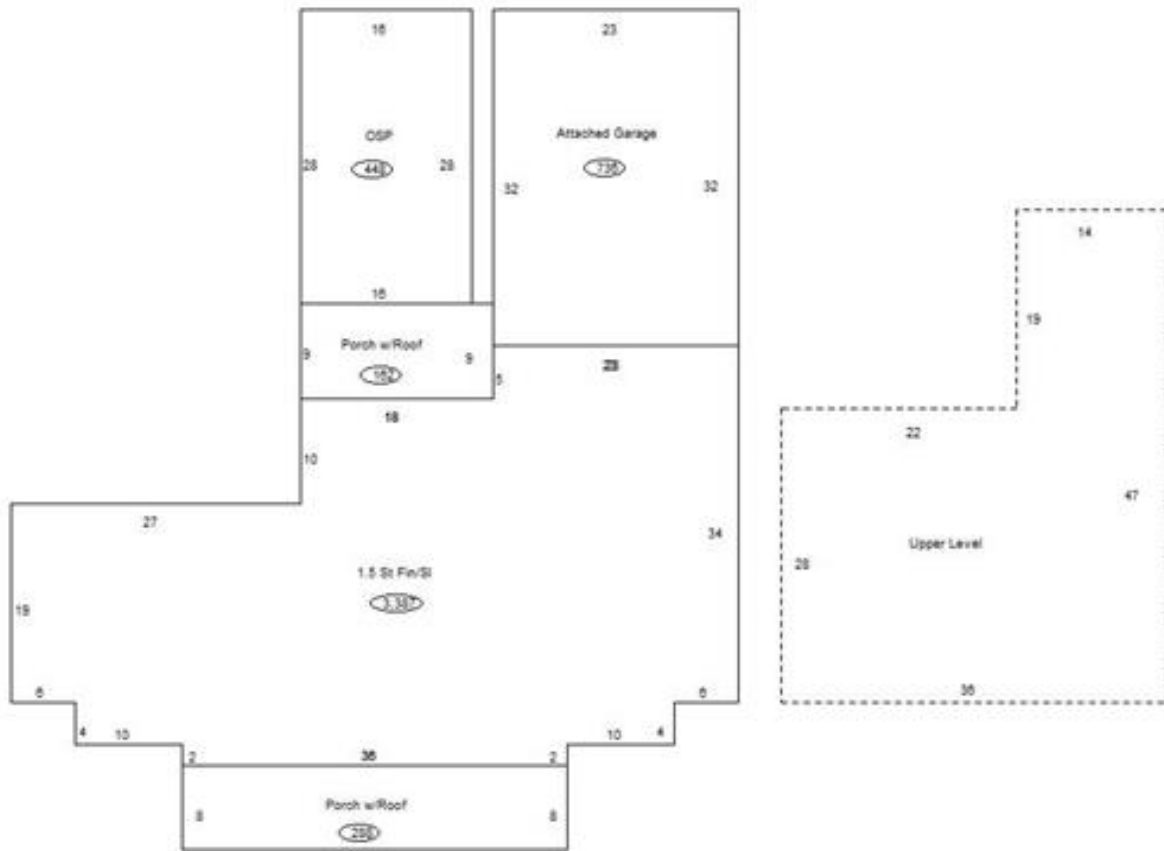

Sketch Vector Information

Sequence	Code	Type	Built Over	Scale	Section Label	Base Area	Multiplier	Total Area
1	R	5	Slab	13	1.5 St Fin/SI	2,113	1.603	3,387
2	G	1		13	Attached Garage	736	1.000	736
3	M	PRCH		13	SLBC	162	1.000	162
4	M	PRCH		13	SLBC	288	1.000	288
5	U	^UL	Overhang	13	Upper Level	1,274	1.000	1,274
6	M	PATO		13	Open Slab	448	1.000	448
Total Building Area						2,113		3,387



Rogers



Assessment Property Record Card for Tax Year 2026

Data provided by LISA DELOZIER County Assessor

Date 04/17/2026
 Time 16:35:32
 Page 4

660052066

Outbuildings/Site Improvements

Building Image	Code	Description	Dimensions	Floor	Roofing	Total Units
	UTIL	SHOP BUILDING	0x0x0			1,440
	Qual 2	Cond 3	Year	Eff Age		
	Valuation Summary		Modifier Total	RCN	Depr (10% Phys/ % Func)	RCNLD
	Base Cost (29.02 x 1,440)	41,789		41,789	4,179	37,610
	LF	LOAFING SHED	0x0x0			448
	Qual 3	Cond 3	Year	Eff Age		
	Valuation Summary		Modifier Total	RCN	Depr (35% Phys/ % Func)	RCNLD
	Base Cost (4.26 x 448)	1,908		1,908	668	1,240
	STF	STG FAIR	0x0x0			192
	Qual 2	Cond 3	Year	Eff Age		
	Valuation Summary		Modifier Total	RCN	Depr (35% Phys/ % Func)	RCNLD
	Base Cost (4.68 x 192)	899		899	315	584
	CPDT	CARPORT - DETACHED	23x25x0			575
	Qual 3	Cond 3	Year	Eff Age	1520	
	Valuation Summary		Modifier Total	RCN	Depr (30% Phys/ % Func)	RCNLD
	Base Cost (12.15 x 575)	6,986		6,986	2,096	4,890