



Rogers

Assessment Property Record Card for Tax Year 2026

Data provided by LISA DELOZIER County Assessor

Date 04/16/2026
Time 21:58:51
Page 1

Assessment Data					Primary Image																																																																																																																				
Account 660052074 Parcel ID 000000-00-0-00931-002-0001 Cadastral ID 34-21-14-01840 Property Type REAL - Real Property Property Class RRP VI Area 4 Tax Area 3 - OWASSO RURAL/NO FIRE Name ID 329790 ALLENSON PROPERTIES LLC 13964 W VIRGINIA AVE SAVAGE MN 55378-0000 Parcel Location Situs 07524 N 150TH E AVE Subdivision WILLOW-WOOD EST Lot/Block 0001 / 0002 Parcel Size 1 - Lots Sec/Twn/Rng 34 / 21 / 14 / 5 Neighborhood 1212 - R-V04-SW OWASSO School District S021 - OWASSO SCHOOLS																																																																																																																									
Legal Description Lat/Long: 36.26372957 -95.80731084																																																																																																																									
Building Permits					\\tsclient\TCASEY\CASEY BOOTH RESIDENTIAL VI\2022-6-23\ 6/23/2022																																																																																																																				
Exemptions					Sale History																																																																																																																				
LOT 1 BLOCK 2 WILLOW-WOOD ESTATES					<table border="1"> <thead> <tr> <th>Number</th> <th>Description</th> <th>Opened</th> <th>Closed</th> <th>Amount</th> </tr> </thead> <tbody> <tr> <td>/</td> <td>ALLENSON, MICHELLE LYNN &</td> <td>10/31/2019</td> <td></td> <td>0 4</td> </tr> <tr> <td>/</td> <td>MCWILLIAMS, SCOTT A &</td> <td>10/25/2019</td> <td></td> <td>225,000 YES</td> </tr> <tr> <td>896/519</td> <td>HOMES BY BETTY</td> <td>10/16/1992</td> <td></td> <td>71,000 Yes</td> </tr> <tr> <td>892/707</td> <td>A&W LAND DEVELOPMENT INC</td> <td>08/20/1992</td> <td></td> <td>15,000 Yes</td> </tr> </tbody> </table>					Number	Description	Opened	Closed	Amount	/	ALLENSON, MICHELLE LYNN &	10/31/2019		0 4	/	MCWILLIAMS, SCOTT A &	10/25/2019		225,000 YES	896/519	HOMES BY BETTY	10/16/1992		71,000 Yes	892/707	A&W LAND DEVELOPMENT INC	08/20/1992		15,000 Yes																																																																																							
Number	Description	Opened	Closed	Amount																																																																																																																					
/	ALLENSON, MICHELLE LYNN &	10/31/2019		0 4																																																																																																																					
/	MCWILLIAMS, SCOTT A &	10/25/2019		225,000 YES																																																																																																																					
896/519	HOMES BY BETTY	10/16/1992		71,000 Yes																																																																																																																					
892/707	A&W LAND DEVELOPMENT INC	08/20/1992		15,000 Yes																																																																																																																					
<table border="1"> <thead> <tr> <th>Code</th> <th>Type</th> <th>Active</th> <th>Maximum</th> <th>Exemption</th> </tr> </thead> <tbody> <tr> <td>H</td> <td>Homestead</td> <td>No</td> <td>1,000</td> <td></td> </tr> </tbody> </table>					Code	Type	Active	Maximum	Exemption	H	Homestead	No	1,000		<table border="1"> <thead> <tr> <th>Bk/Pg</th> <th>Grantor</th> <th>Date</th> <th>Price</th> <th>Code</th> </tr> </thead> <tbody> <tr> <td>/</td> <td>ALLENSON, MICHELLE LYNN &</td> <td>10/31/2019</td> <td></td> <td>0 4</td> </tr> <tr> <td>/</td> <td>MCWILLIAMS, SCOTT A &</td> <td>10/25/2019</td> <td>225,000</td> <td>YES</td> </tr> <tr> <td>896/519</td> <td>HOMES BY BETTY</td> <td>10/16/1992</td> <td>71,000</td> <td>Yes</td> </tr> <tr> <td>892/707</td> <td>A&W LAND DEVELOPMENT INC</td> <td>08/20/1992</td> <td>15,000</td> <td>Yes</td> </tr> </tbody> </table>					Bk/Pg	Grantor	Date	Price	Code	/	ALLENSON, MICHELLE LYNN &	10/31/2019		0 4	/	MCWILLIAMS, SCOTT A &	10/25/2019	225,000	YES	896/519	HOMES BY BETTY	10/16/1992	71,000	Yes	892/707	A&W LAND DEVELOPMENT INC	08/20/1992	15,000	Yes																																																																													
Code	Type	Active	Maximum	Exemption																																																																																																																					
H	Homestead	No	1,000																																																																																																																						
Bk/Pg	Grantor	Date	Price	Code																																																																																																																					
/	ALLENSON, MICHELLE LYNN &	10/31/2019		0 4																																																																																																																					
/	MCWILLIAMS, SCOTT A &	10/25/2019	225,000	YES																																																																																																																					
896/519	HOMES BY BETTY	10/16/1992	71,000	Yes																																																																																																																					
892/707	A&W LAND DEVELOPMENT INC	08/20/1992	15,000	Yes																																																																																																																					
Parcel Valuation																																																																																																																									
<table border="1"> <thead> <tr> <th>Source</th> <th>REAL</th> <th>Fair Cash</th> <th>Capped</th> <th>Asmnt Level</th> <th>Assessed</th> <th>Levy Rate</th> <th>97.960</th> <th>Current Tax</th> </tr> </thead> <tbody> <tr> <td>Remove Cap</td> <td>2020</td> <td>Land Value</td> <td>92,267</td> <td>64,328</td> <td>11%</td> <td>7,076</td> <td>Assessed</td> <td>32,159 3,150.30</td> </tr> <tr> <td>Year Frozen</td> <td>0</td> <td>Improvements</td> <td>228,022</td> <td>228,022</td> <td></td> <td>25,083</td> <td>Penalty</td> <td>0</td> </tr> <tr> <td>Uncapped Value</td> <td>0</td> <td>Mobile Home</td> <td>0</td> <td>0</td> <td></td> <td>0</td> <td>Exemption</td> <td>0 0.00</td> </tr> <tr> <td>TIF Project ID</td> <td>0</td> <td>Total Value</td> <td>320,289</td> <td>292,350</td> <td></td> <td>32,159</td> <td>Total Taxable</td> <td>32,159 3,150.00</td> </tr> </tbody> </table>		Source	REAL	Fair Cash	Capped	Asmnt Level	Assessed	Levy Rate	97.960	Current Tax	Remove Cap	2020	Land Value	92,267	64,328	11%	7,076	Assessed	32,159 3,150.30	Year Frozen	0	Improvements	228,022	228,022		25,083	Penalty	0	Uncapped Value	0	Mobile Home	0	0		0	Exemption	0 0.00	TIF Project ID	0	Total Value	320,289	292,350		32,159	Total Taxable	32,159 3,150.00																																																																											
Source	REAL	Fair Cash	Capped	Asmnt Level	Assessed	Levy Rate	97.960	Current Tax																																																																																																																	
Remove Cap	2020	Land Value	92,267	64,328	11%	7,076	Assessed	32,159 3,150.30																																																																																																																	
Year Frozen	0	Improvements	228,022	228,022		25,083	Penalty	0																																																																																																																	
Uncapped Value	0	Mobile Home	0	0		0	Exemption	0 0.00																																																																																																																	
TIF Project ID	0	Total Value	320,289	292,350		32,159	Total Taxable	32,159 3,150.00																																																																																																																	
Assessment History																																																																																																																									
<table border="1"> <thead> <tr> <th>Tax Year</th> <th>Statement Number</th> <th>Billed Owner</th> <th>Tax Area</th> <th>Total Value</th> <th>Exemptions</th> <th>Taxable Value</th> <th>Billed Tax</th> </tr> </thead> <tbody> <tr><td>2025</td><td>2025-660052074</td><td>ALLENSON PROPERTIES LLC</td><td>3</td><td>316,097</td><td>0</td><td>30,627</td><td>3,000.00</td></tr> <tr><td>2024</td><td>2024-660052074</td><td>ALLENSON PROPERTIES LLC</td><td>3</td><td>355,850</td><td>0</td><td>29,169</td><td>2,802.00</td></tr> <tr><td>2023</td><td>2023-660052074</td><td>ALLENSON PROPERTIES LLC</td><td>3</td><td>254,491</td><td>0</td><td>27,780</td><td>2,603.00</td></tr> <tr><td>2022</td><td>2022-660052074</td><td>ALLENSON PROPERTIES LLC</td><td>3</td><td>255,503</td><td>0</td><td>26,457</td><td>2,592.00</td></tr> <tr><td>2021</td><td>2021-660052074</td><td>ALLENSON PROPERTIES LLC</td><td>3</td><td>229,066</td><td>0</td><td>25,197</td><td>2,438.00</td></tr> <tr><td>2020</td><td>2020-660052074</td><td>ALLENSON PROPERTIES LLC</td><td>3</td><td>225,514</td><td>0</td><td>24,807</td><td>2,396.00</td></tr> <tr><td>2019</td><td>2019-660052074</td><td>MCWILLIAMS, SCOTT A &</td><td>3</td><td>147,129</td><td>1000</td><td>14,575</td><td>1,409.00</td></tr> <tr><td>2018</td><td>2018-660052074</td><td>MCWILLIAMS, SCOTT A &</td><td>3</td><td>146,692</td><td>1000</td><td>14,121</td><td>1,314.00</td></tr> <tr><td>2017</td><td>2017-660052074</td><td>MCWILLIAMS, SCOTT A &</td><td>3</td><td>145,565</td><td>1000</td><td>13,681</td><td>1,287.00</td></tr> <tr><td>2016</td><td>2016-660052074</td><td>MCWILLIAMS, SCOTT A &</td><td>3</td><td>142,280</td><td>1000</td><td>13,254</td><td>1,248.00</td></tr> <tr><td>2015</td><td>2015-660052074</td><td>MCWILLIAMS, SCOTT A &</td><td>3</td><td>139,103</td><td>1000</td><td>12,838</td><td>1,217.00</td></tr> <tr><td>2014</td><td>2014-660052074</td><td>MCWILLIAMS, SCOTT A &</td><td>3</td><td>166,220</td><td>1000</td><td>12,435</td><td>1,190.00</td></tr> <tr><td>2013</td><td>2013-660052074</td><td>MCWILLIAMS, SCOTT A &</td><td>3</td><td>157,237</td><td>1000</td><td>12,044</td><td>1,128.00</td></tr> </tbody> </table>										Tax Year	Statement Number	Billed Owner	Tax Area	Total Value	Exemptions	Taxable Value	Billed Tax	2025	2025-660052074	ALLENSON PROPERTIES LLC	3	316,097	0	30,627	3,000.00	2024	2024-660052074	ALLENSON PROPERTIES LLC	3	355,850	0	29,169	2,802.00	2023	2023-660052074	ALLENSON PROPERTIES LLC	3	254,491	0	27,780	2,603.00	2022	2022-660052074	ALLENSON PROPERTIES LLC	3	255,503	0	26,457	2,592.00	2021	2021-660052074	ALLENSON PROPERTIES LLC	3	229,066	0	25,197	2,438.00	2020	2020-660052074	ALLENSON PROPERTIES LLC	3	225,514	0	24,807	2,396.00	2019	2019-660052074	MCWILLIAMS, SCOTT A &	3	147,129	1000	14,575	1,409.00	2018	2018-660052074	MCWILLIAMS, SCOTT A &	3	146,692	1000	14,121	1,314.00	2017	2017-660052074	MCWILLIAMS, SCOTT A &	3	145,565	1000	13,681	1,287.00	2016	2016-660052074	MCWILLIAMS, SCOTT A &	3	142,280	1000	13,254	1,248.00	2015	2015-660052074	MCWILLIAMS, SCOTT A &	3	139,103	1000	12,838	1,217.00	2014	2014-660052074	MCWILLIAMS, SCOTT A &	3	166,220	1000	12,435	1,190.00	2013	2013-660052074	MCWILLIAMS, SCOTT A &	3	157,237	1000	12,044	1,128.00
Tax Year	Statement Number	Billed Owner	Tax Area	Total Value	Exemptions	Taxable Value	Billed Tax																																																																																																																		
2025	2025-660052074	ALLENSON PROPERTIES LLC	3	316,097	0	30,627	3,000.00																																																																																																																		
2024	2024-660052074	ALLENSON PROPERTIES LLC	3	355,850	0	29,169	2,802.00																																																																																																																		
2023	2023-660052074	ALLENSON PROPERTIES LLC	3	254,491	0	27,780	2,603.00																																																																																																																		
2022	2022-660052074	ALLENSON PROPERTIES LLC	3	255,503	0	26,457	2,592.00																																																																																																																		
2021	2021-660052074	ALLENSON PROPERTIES LLC	3	229,066	0	25,197	2,438.00																																																																																																																		
2020	2020-660052074	ALLENSON PROPERTIES LLC	3	225,514	0	24,807	2,396.00																																																																																																																		
2019	2019-660052074	MCWILLIAMS, SCOTT A &	3	147,129	1000	14,575	1,409.00																																																																																																																		
2018	2018-660052074	MCWILLIAMS, SCOTT A &	3	146,692	1000	14,121	1,314.00																																																																																																																		
2017	2017-660052074	MCWILLIAMS, SCOTT A &	3	145,565	1000	13,681	1,287.00																																																																																																																		
2016	2016-660052074	MCWILLIAMS, SCOTT A &	3	142,280	1000	13,254	1,248.00																																																																																																																		
2015	2015-660052074	MCWILLIAMS, SCOTT A &	3	139,103	1000	12,838	1,217.00																																																																																																																		
2014	2014-660052074	MCWILLIAMS, SCOTT A &	3	166,220	1000	12,435	1,190.00																																																																																																																		
2013	2013-660052074	MCWILLIAMS, SCOTT A &	3	157,237	1000	12,044	1,128.00																																																																																																																		



Rogers

Assessment Property Record Card for Tax Year 2026

Data provided by LISA DELOZIER County Assessor

Date 04/16/2026
Time 21:58:51
Page 2

Lot Data	Square-Foot - NBHD 1212 #1	Primary Image
Lot Size Lot Count Units Buildable 1 Non-Ag Acres 0.7845 Topography Street Access Utilities Amenities LAND QUALITY 0 0 Method Square-Foot Base Lot Value 34,173.00 x 2.70 = 92,267 Factor Value Adjustments 1.0000 Lot Value 92,267		

Residential Data	
Type	1 Single Family Residence
Condition	3 - Average
Quality	3 - Average
Architecture	
Style	100% One Story
Exterior Wall	60% Veneer, Masonry 40% Frame, Siding, Wood
Base/Total Area	1,716 / 1,716
Style	100% One Story
HVAC	100% Warmed & Cooled Air
Roof Cover	1 Composition Shingle
Area on Slab	1,716
Fixture/RghIn	14 /
Bed/F/H Bath	3 / 2.0 /
Basement Area	
Garage Type	520 Attached Garage - Unfinished
Remodel	RMA -
Year/Eff Age	1992 / 17



\\tsclient\TCASEY\CASEY BOOTH RESIDENTIAL VI\2022-6-23\ 6/23/2022

GRM Approach	
GRM Code	
Gross Rent	0.00
Indicated Value	

Multiple Regression			
MRA Code	1	Test	
Adjusted R	0.8445		
Indicated Value	232,877	135.71	Per SqFt

Direct Comparables	
Selection Model	A Adam Test
Adjustment Model	1 2022 Residential
Comparables	
Indicated Value	

Cost Approach				Manual : 01/2025	
Base Cost	107.60	Total Misc Impr	+	8,822	
Roofing Adj	+ 4.85	Garage Cost	+	16,437	
Subfloor Adj	+ -2.31	Total RCN	=	255,460	
Heat/Cool Adj	+ 12.64	Depreciation (19%)	-	48,537	
Plumbing Adj	+ 11.37	Lump Sums	+	0	
Basement Adj	+ 0.00	RCNLD	=	206,923	
Adj Base Cost	= 134.15	Lot Value	+	92,267	
Total Area	x 1,716	Indicated Value	=	299,190	
Adjusted Cost	= 230,201	Value Per SqFt		174.35	

Value Reconciliation			
Selected Approach	Cost Approach		
Improvements	206,923		
Lot Value	92,267		
Indicated Value	299,190	174.35	Per SqFt
Agland Value			
Site Improvements	21,099		
Total Value	320,289	186.65	Total Value Per SqFt

Miscellaneous Improvements								
Code	Description	Sketch ID	Size	Year	Units	Unit Cost	Depr	Value
FPR1	FIREPLACE - RESIDENTIAL 1 STORY	0		1	1	5,615.40		5,615
PRCH	SLAB PORCH - COVERED	77720	11x4		44	26.79		1,179
PRCH	SLAB PORCH - COVERED	77721	19x4		76	26.69		2,028



Rogers
Assessment Property Record Card for Tax Year 2026

Data provided by LISA DELOZIER County Assessor

Date 04/16/2026
 Time 21:58:51
 Page 3

Sketch Image

660052074

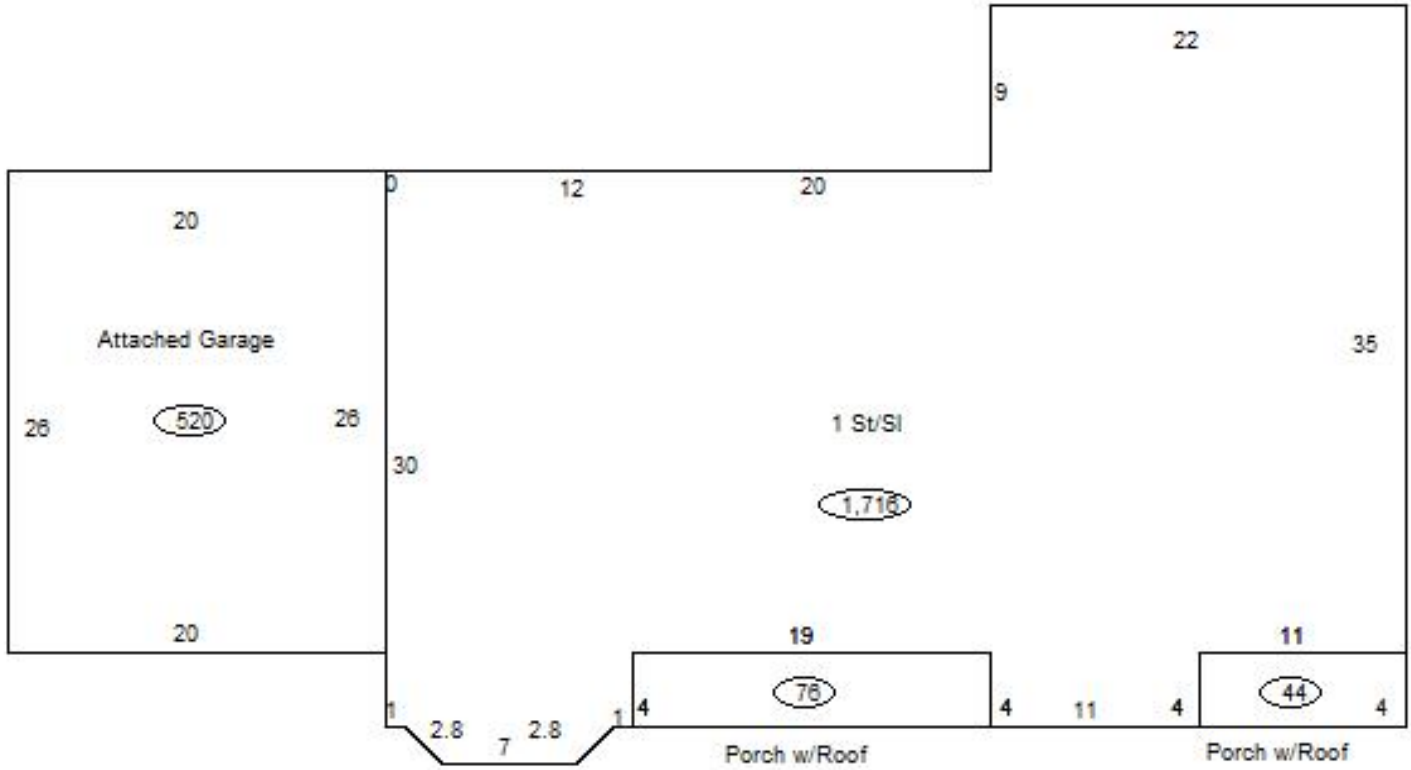

Sketch Vector Information

Sequence	Code	Type	Built Over	Scale	Section Label	Base Area	Multiplier	Total Area
1	R	1	Slab	13	1 St/SI	1,716	1.000	1,716
2	G	1		13	Attached Garage	520	1.000	520
3	M	PRCH		13	SLBC	44	1.000	44
4	M	PRCH		13	SLBC	76	1.000	76
Total Building Area						1,716		1,716



Rogers



Assessment Property Record Card for Tax Year 2026

Data provided by LISA DELOZIER County Assessor

Date 04/16/2026
Time 21:58:51
Page 4

660052074

Outbuildings/Site Improvements

Building Image	Code	Description	Dimensions	Floor	Roofing	Total Units
	UTIL	SHOP BUILDING	44x20x0			880
	Qual	2	Cond 3	Year 2010	Eff Age	
	Valuation Summary		Modifier Total	RCN	Depr (20% Phys/ % Func)	RCNLD
	Base Cost (29.97 x 880)		26,374	26,374	5,275	21,099
	CP	Carport Dirt	0x0x0			
	Qual		Cond	Year	Eff Age	
	Valuation Summary		Modifier Total	RCN	Depr (100% Phys/ % Func)	RCNLD
	Base Cost (3.50 x)					