



Rogers

Assessment Property Record Card for Tax Year 2026

Data provided by LISA DELOZIER County Assessor

Date 04/16/2026
Time 22:10:46
Page 1

Assessment Data					Primary Image																																																																																																																				
Account 660052089 Parcel ID 000000-00-0-00931-003-0007 Cadastral ID 34-21-14-01980 Property Type REAL - Real Property Property Class RRP VI Area 4 Tax Area 3 - OWASSO RURAL/NO FIRE Name ID 257545 NEWMAN, DEBBIE J & JUSTIN NEWMAN 15007 E 72ND PL N OWASSO OK 74055-0000 Parcel Location Situs 15007 E 72ND PL N Subdivision WILLOW-WOOD EST Lot/Block 0007 / 0003 Parcel Size 1 - Lots Sec/Twn/Rng 34 / 21 / 14 / 5 Neighborhood 1212 - R-V04-SW OWASSO School District S021 - OWASSO SCHOOLS																																																																																																																									
Legal Description Lat/Long: 36.25932227 -95.80646544																																																																																																																									
LOT 7 BLOCK 3 WILLOW-WOOD ESTATES					Building Permits <table border="1"> <thead> <tr> <th>Number</th> <th>Description</th> <th>Opened</th> <th>Closed</th> <th>Amount</th> </tr> </thead> <tbody> <tr> <td> </td> <td> </td> <td> </td> <td> </td> <td> </td> </tr> </tbody> </table>					Number	Description	Opened	Closed	Amount																																																																																																											
Number	Description	Opened	Closed	Amount																																																																																																																					
Exemptions <table border="1"> <thead> <tr> <th>Code</th> <th>Type</th> <th>Active</th> <th>Maximum</th> <th>Exemption</th> </tr> </thead> <tbody> <tr> <td>H</td> <td>Homestead</td> <td>Yes</td> <td>1,000</td> <td>1,000</td> </tr> </tbody> </table>					Code	Type	Active	Maximum	Exemption	H	Homestead	Yes	1,000	1,000	Sale History <table border="1"> <thead> <tr> <th>Bk/Pg</th> <th>Grantor</th> <th>Date</th> <th>Price</th> <th>Code</th> </tr> </thead> <tbody> <tr> <td>951/415</td> <td>SELLER</td> <td>03/25/1994</td> <td>0</td> <td>No</td> </tr> <tr> <td>932/136</td> <td>HOMES BY BETTY</td> <td>09/29/1993</td> <td>84,000</td> <td>Yes</td> </tr> <tr> <td>925/186</td> <td>A&W LAND DEVELOPMENT INC</td> <td>08/03/1993</td> <td>15,000</td> <td>Yes</td> </tr> </tbody> </table>					Bk/Pg	Grantor	Date	Price	Code	951/415	SELLER	03/25/1994	0	No	932/136	HOMES BY BETTY	09/29/1993	84,000	Yes	925/186	A&W LAND DEVELOPMENT INC	08/03/1993	15,000	Yes																																																																																		
Code	Type	Active	Maximum	Exemption																																																																																																																					
H	Homestead	Yes	1,000	1,000																																																																																																																					
Bk/Pg	Grantor	Date	Price	Code																																																																																																																					
951/415	SELLER	03/25/1994	0	No																																																																																																																					
932/136	HOMES BY BETTY	09/29/1993	84,000	Yes																																																																																																																					
925/186	A&W LAND DEVELOPMENT INC	08/03/1993	15,000	Yes																																																																																																																					
Parcel Valuation <table border="1"> <thead> <tr> <th>Source</th> <th>REAL</th> <th>Fair Cash</th> <th>Capped</th> <th>Asmnt Level</th> <th>Assessed</th> <th>Levy Rate</th> <th>97.960</th> <th>Current Tax</th> </tr> </thead> <tbody> <tr> <td>Remove Cap</td> <td>0</td> <td>Land Value 88,595</td> <td>36,322</td> <td>11%</td> <td>3,995</td> <td>Assessed</td> <td>22,846</td> <td>2,237.99</td> </tr> <tr> <td>Year Frozen</td> <td>0</td> <td>Improvements 245,268</td> <td>171,379</td> <td></td> <td>18,851</td> <td>Penalty</td> <td>0</td> <td></td> </tr> <tr> <td>Uncapped Value</td> <td>0</td> <td>Mobile Home 0</td> <td>0</td> <td></td> <td>0</td> <td>Exemption</td> <td>1,000</td> <td>-98.00</td> </tr> <tr> <td>TIF Project ID</td> <td>0</td> <td>Total Value 333,863</td> <td>207,701</td> <td></td> <td>22,846</td> <td>Total Taxable</td> <td>21,846</td> <td>2,140.00</td> </tr> </tbody> </table>										Source	REAL	Fair Cash	Capped	Asmnt Level	Assessed	Levy Rate	97.960	Current Tax	Remove Cap	0	Land Value 88,595	36,322	11%	3,995	Assessed	22,846	2,237.99	Year Frozen	0	Improvements 245,268	171,379		18,851	Penalty	0		Uncapped Value	0	Mobile Home 0	0		0	Exemption	1,000	-98.00	TIF Project ID	0	Total Value 333,863	207,701		22,846	Total Taxable	21,846	2,140.00																																																																			
Source	REAL	Fair Cash	Capped	Asmnt Level	Assessed	Levy Rate	97.960	Current Tax																																																																																																																	
Remove Cap	0	Land Value 88,595	36,322	11%	3,995	Assessed	22,846	2,237.99																																																																																																																	
Year Frozen	0	Improvements 245,268	171,379		18,851	Penalty	0																																																																																																																		
Uncapped Value	0	Mobile Home 0	0		0	Exemption	1,000	-98.00																																																																																																																	
TIF Project ID	0	Total Value 333,863	207,701		22,846	Total Taxable	21,846	2,140.00																																																																																																																	
Assessment History <table border="1"> <thead> <tr> <th>Tax Year</th> <th>Statement Number</th> <th>Billed Owner</th> <th>Tax Area</th> <th>Total Value</th> <th>Exemptions</th> <th>Taxable Value</th> <th>Billed Tax</th> </tr> </thead> <tbody> <tr><td>2025</td><td>2025-660052089</td><td>NEWMAN, DEBBIE J &</td><td>3</td><td>331,435</td><td>1000</td><td>21,182</td><td>2,075.00</td></tr> <tr><td>2024</td><td>2024-660052089</td><td>NEWMAN, DEBBIE J &</td><td>3</td><td>337,204</td><td>1000</td><td>20,536</td><td>1,973.00</td></tr> <tr><td>2023</td><td>2023-660052089</td><td>NEWMAN, DEBBIE J &</td><td>3</td><td>234,556</td><td>1000</td><td>19,909</td><td>1,866.00</td></tr> <tr><td>2022</td><td>2022-660052089</td><td>NEWMAN, DEBBIE J &</td><td>3</td><td>239,961</td><td>1000</td><td>19,300</td><td>1,891.00</td></tr> <tr><td>2021</td><td>2021-660052089</td><td>NEWMAN, DEBBIE J &</td><td>3</td><td>228,852</td><td>1000</td><td>18,708</td><td>1,810.00</td></tr> <tr><td>2020</td><td>2020-660052089</td><td>NEWMAN, DEBBIE J &</td><td>3</td><td>189,629</td><td>1000</td><td>18,135</td><td>1,752.00</td></tr> <tr><td>2019</td><td>2019-660052089</td><td>NEWMAN, VIRGIL L &</td><td>3</td><td>180,967</td><td>1000</td><td>17,577</td><td>1,699.00</td></tr> <tr><td>2018</td><td>2018-660052089</td><td>NEWMAN, VIRGIL L &</td><td>3</td><td>187,603</td><td>1000</td><td>17,036</td><td>1,586.00</td></tr> <tr><td>2017</td><td>2017-660052089</td><td>NEWMAN, VIRGIL L &</td><td>3</td><td>185,826</td><td>1000</td><td>16,511</td><td>1,553.00</td></tr> <tr><td>2016</td><td>2016-660052089</td><td>NEWMAN, VIRGIL L &</td><td>3</td><td>181,601</td><td>1000</td><td>16,001</td><td>1,506.00</td></tr> <tr><td>2015</td><td>2015-660052089</td><td>NEWMAN, VIRGIL L &</td><td>3</td><td>176,302</td><td>1000</td><td>15,506</td><td>1,470.00</td></tr> <tr><td>2014</td><td>2014-660052089</td><td>NEWMAN, VIRGIL L &</td><td>3</td><td>214,387</td><td>1000</td><td>15,025</td><td>1,438.00</td></tr> <tr><td>2013</td><td>2013-660052089</td><td>NEWMAN, VIRGIL L &</td><td>3</td><td>202,983</td><td>1000</td><td>14,558</td><td>1,364.00</td></tr> </tbody> </table>										Tax Year	Statement Number	Billed Owner	Tax Area	Total Value	Exemptions	Taxable Value	Billed Tax	2025	2025-660052089	NEWMAN, DEBBIE J &	3	331,435	1000	21,182	2,075.00	2024	2024-660052089	NEWMAN, DEBBIE J &	3	337,204	1000	20,536	1,973.00	2023	2023-660052089	NEWMAN, DEBBIE J &	3	234,556	1000	19,909	1,866.00	2022	2022-660052089	NEWMAN, DEBBIE J &	3	239,961	1000	19,300	1,891.00	2021	2021-660052089	NEWMAN, DEBBIE J &	3	228,852	1000	18,708	1,810.00	2020	2020-660052089	NEWMAN, DEBBIE J &	3	189,629	1000	18,135	1,752.00	2019	2019-660052089	NEWMAN, VIRGIL L &	3	180,967	1000	17,577	1,699.00	2018	2018-660052089	NEWMAN, VIRGIL L &	3	187,603	1000	17,036	1,586.00	2017	2017-660052089	NEWMAN, VIRGIL L &	3	185,826	1000	16,511	1,553.00	2016	2016-660052089	NEWMAN, VIRGIL L &	3	181,601	1000	16,001	1,506.00	2015	2015-660052089	NEWMAN, VIRGIL L &	3	176,302	1000	15,506	1,470.00	2014	2014-660052089	NEWMAN, VIRGIL L &	3	214,387	1000	15,025	1,438.00	2013	2013-660052089	NEWMAN, VIRGIL L &	3	202,983	1000	14,558	1,364.00
Tax Year	Statement Number	Billed Owner	Tax Area	Total Value	Exemptions	Taxable Value	Billed Tax																																																																																																																		
2025	2025-660052089	NEWMAN, DEBBIE J &	3	331,435	1000	21,182	2,075.00																																																																																																																		
2024	2024-660052089	NEWMAN, DEBBIE J &	3	337,204	1000	20,536	1,973.00																																																																																																																		
2023	2023-660052089	NEWMAN, DEBBIE J &	3	234,556	1000	19,909	1,866.00																																																																																																																		
2022	2022-660052089	NEWMAN, DEBBIE J &	3	239,961	1000	19,300	1,891.00																																																																																																																		
2021	2021-660052089	NEWMAN, DEBBIE J &	3	228,852	1000	18,708	1,810.00																																																																																																																		
2020	2020-660052089	NEWMAN, DEBBIE J &	3	189,629	1000	18,135	1,752.00																																																																																																																		
2019	2019-660052089	NEWMAN, VIRGIL L &	3	180,967	1000	17,577	1,699.00																																																																																																																		
2018	2018-660052089	NEWMAN, VIRGIL L &	3	187,603	1000	17,036	1,586.00																																																																																																																		
2017	2017-660052089	NEWMAN, VIRGIL L &	3	185,826	1000	16,511	1,553.00																																																																																																																		
2016	2016-660052089	NEWMAN, VIRGIL L &	3	181,601	1000	16,001	1,506.00																																																																																																																		
2015	2015-660052089	NEWMAN, VIRGIL L &	3	176,302	1000	15,506	1,470.00																																																																																																																		
2014	2014-660052089	NEWMAN, VIRGIL L &	3	214,387	1000	15,025	1,438.00																																																																																																																		
2013	2013-660052089	NEWMAN, VIRGIL L &	3	202,983	1000	14,558	1,364.00																																																																																																																		



Rogers

Assessment Property Record Card for Tax Year 2026

Data provided by LISA DELOZIER County Assessor

Date 04/16/2026
Time 22:10:46
Page 2

Lot Data	Square-Foot - NBHD 1212 #1	Primary Image
Lot Size		
Lot Count		
Units Buildable	1	
Non-Ag Acres	0.7533	
Topography		
Street Access		
Utilities		
Amenities	LAND QUALITY	
	0	
	0	
Method	Square-Foot	
Base Lot Value	32,813.00 x 2.70 = 88,595	
Factor Value		
Adjustments	1.0000	
Lot Value	88,595	

Residential Data	
Type	1 Single Family Residence
Condition	3 - Average
Quality	3.5 - Average
Architecture	
Style	100% 1 1/2 Story Finished
Exterior Wall	95% Veneer, Masonry 5% Frame, Siding, Vinyl
Base/Total Area	1,846 / 2,444
Style	100% 1 1/2 Story Finished
HVAC	100% Warmed & Cooled Air
Roof Cover	1 Composition Shingle
Area on Slab	1,846
Fixture/RghIn	14 /
Bed/F/H Bath	3 / 3.0 /
Basement Area	
Garage Type	484 Attached Garage - Unfinished
Remodel	
Year/Eff Age	1993 / 25



\\tsclient\TCASEY\CASEY BOOTH RESIDENTIAL VI\2022-6-23\ 6/23/2022

GRM Approach	
GRM Code	
Gross Rent	0.00
Indicated Value	

Multiple Regression			
MRA Code	1	Test	
Adusted R	0.8445		
Indicated Value	302,192	123.65	Per SqFt

Direct Comparables			
Selection Model	A	Adam Test	
Adjustment Model	1	2022 Residential	
Comparables	4		
Indicated Value	289,780		Per SqFt

Value Reconciliation			
Selected Approach	Cost Approach		
Improvements	236,328		
Lot Value	88,595		
Indicated Value	324,923	132.95	Per SqFt
Agland Value			
Site Improvements	8,940		
Total Value	333,863	136.61	Total Value Per SqFt

Cost Approach				Manual : 01/2025			
Base Cost	100.82	Total Misc Impr	+	15,343			
Roofing Adj	+ 4.13	Garage Cost	+	19,389			
Subfloor Adj	+ -2.64	Total RCN	=	342,505			
Heat/Cool Adj	+ 14.47	Depreciation (31%)	-	106,177			
Plumbing Adj	+ 9.15	Lump Sums	+	0			
Basement Adj	+ 0.00	RCNLD	=	236,328			
Adj Base Cost	= 125.93	Lot Value	+	88,595			
Total Area	x 2,444	Indicated Value	=	324,923			
Adjusted Cost	= 307,773	Value Per SqFt		132.95			

Miscellaneous Improvements								
Code	Description	Sketch ID	Size	Year	Units	Unit Cost	Depr	Value
FPR1	FIREPLACE - RESIDENTIAL 1 STORY	0		1	1	6,429.63		6,430
PRCH	SLAB PORCH - COVERED	77790	19x4		76	29.29		2,226
PRCH	SLAB PORCH - COVERED	77791	16x10		160	28.96		4,634
PATO	SLAB PORCH - OPEN	77792	14x12		168	12.22		2,053



Sketch Image

660052089

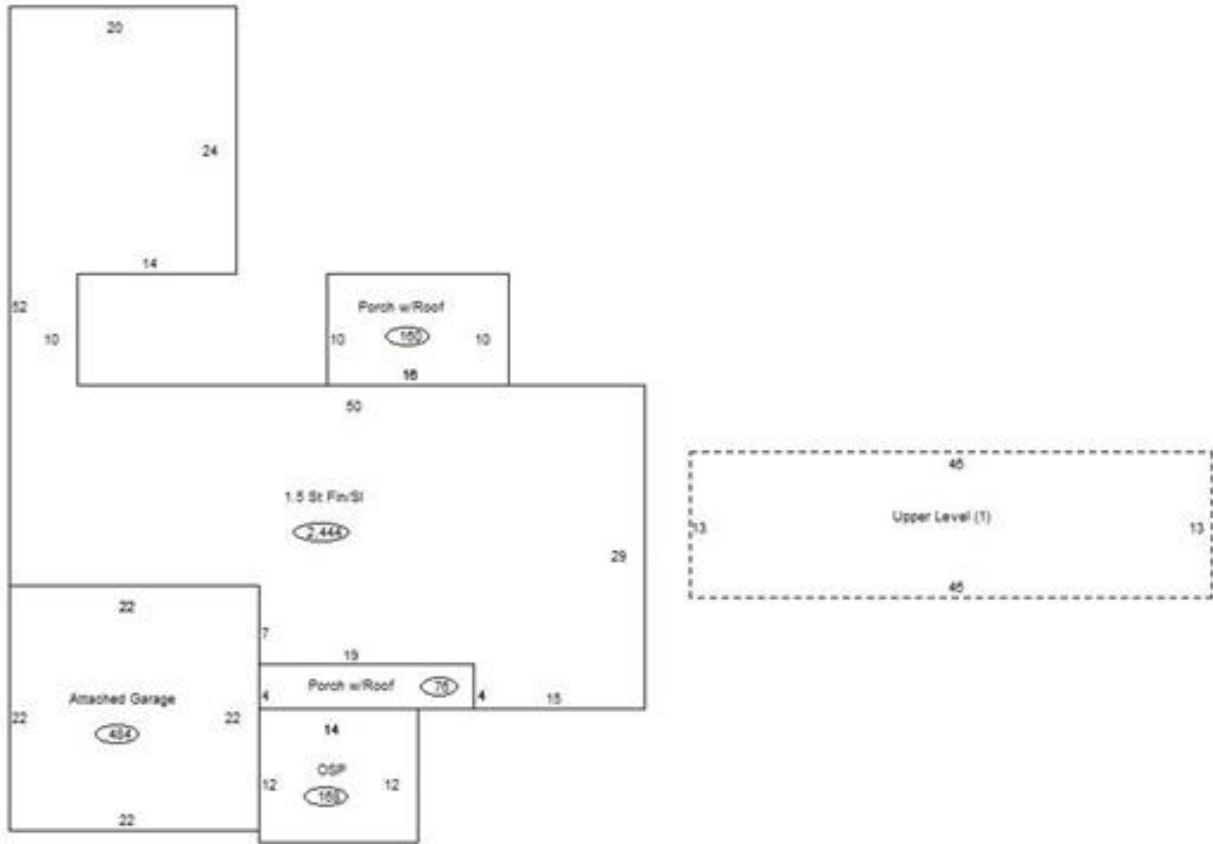

Sketch Vector Information

Sequence	Code	Type	Built Over	Scale	Section Label	Base Area	Multiplier	Total Area
1	R	5	Slab	13	1.5 St Fin/Sl	1,846	1.324	2,444
2	G	1		13	Attached Garage	484	1.000	484
3	M	PRCH		13	SLBC	76	1.000	76
4	M	PRCH		13	SLBC	160	1.000	160
5	M	PATO		13	Open Slab	168	1.000	168
6	U	^UL		13	Upper Level (1)	598	1.000	598
Total Building Area						1,846		2,444



Rogers

Assessment Property Record Card for Tax Year 2026

Data provided by LISA DELOZIER County Assessor

Date 04/16/2026
 Time 22:10:46
 Page 4

660052089

Outbuildings/Site Improvements

Building Image	Code	Description	Dimensions	Floor	Roofing	Total Units
	GRDT	GARAGE - DETACHED	0x0x0			576
	Qual	3	Cond 3	Year	Eff Age	
	Valuation Summary Base Cost (28.22 x 576) 16,255		Modifier Total	RCN 16,255	Depr (45% Phys/ % Func) 7,315	RCNLD 8,940
	STF	STG FAIR	10x12x0			120
	Qual	2	Cond 3	Year	Eff Age 1520	
	Valuation Summary Base Cost (4.68 x 120) 562		Modifier Total	RCN 562	Depr (100% Phys/ % Func) 562	RCNLD 562