



# Rogers

## Assessment Property Record Card for Tax Year 2026

Data provided by LISA DELOZIER County Assessor

Date 04/16/2026  
Time 22:24:11  
Page 1

Assessment Data					Primary Image																																																																																																																				
<b>Account</b> 660052513 <b>Parcel ID</b> 21N15E-14-3-00000-000-0000 <b>Cadastral ID</b> 14-21-15-02020 <b>Property Type</b> REAL - Real Property <b>Property Class</b> RR VI Area 4 <b>Tax Area</b> 18 - CLAREMORE RURAL/W/O FIRE <b>Name ID</b> 324009 MILLER, RAY & LORI TRUST  21717 S 4110 RD CLAREMORE OK 74019-0000  <b>Parcel Location</b> <b>Situs</b> 21717 S 4110 RD <b>Subdivision</b> <b>Lot/Block</b> / <b>Parcel Size</b> 2.53 - Acres <b>Sec/Twn/Rng</b> 14 / 21 / 15 / 3 <b>Neighborhood</b> 6080 - UNPLATTED <b>School District</b> S001 - CLAREMORE SCHOOLS					<p>\\tsclient\C\Users\Randy Necessary\Pictures\101_0802\IMG_0005. 8/2/2022</p>																																																																																																																				
<b>Legal Description</b> Lat/Long: 36.29685553 -95.68568615 S 200', W 550', SW NW SW																																																																																																																									
					<b>Building Permits</b> <table border="1"> <thead> <tr> <th>Number</th> <th>Description</th> <th>Opened</th> <th>Closed</th> <th>Amount</th> </tr> </thead> <tbody> <tr> <td>R15</td> <td>R15-NEW SHOP PER PHONE CALL 32'</td> <td>02/2014</td> <td>03/2014</td> <td></td> </tr> </tbody> </table>					Number	Description	Opened	Closed	Amount	R15	R15-NEW SHOP PER PHONE CALL 32'	02/2014	03/2014																																																																																																							
Number	Description	Opened	Closed	Amount																																																																																																																					
R15	R15-NEW SHOP PER PHONE CALL 32'	02/2014	03/2014																																																																																																																						
<b>Exemptions</b> <table border="1"> <thead> <tr> <th>Code</th> <th>Type</th> <th>Active</th> <th>Maximum</th> <th>Exemption</th> </tr> </thead> <tbody> <tr> <td>H</td> <td>Homestead</td> <td>Yes</td> <td>1,000</td> <td>1,000</td> </tr> <tr> <td>H</td> <td>Homestead</td> <td>No</td> <td>1,000</td> <td></td> </tr> </tbody> </table>					Code	Type	Active	Maximum	Exemption	H	Homestead	Yes	1,000	1,000	H	Homestead	No	1,000		<b>Sale History</b> <table border="1"> <thead> <tr> <th>Bk/Pg</th> <th>Grantor</th> <th>Date</th> <th>Price</th> <th>Code</th> </tr> </thead> <tbody> <tr> <td>2697/799</td> <td>MILLER, HELEN LORENE &amp;</td> <td>03/08/2018</td> <td>0</td> <td>4</td> </tr> <tr> <td>2256/277</td> <td>BURGESS, JEFFREY DALE &amp;</td> <td>06/20/2012</td> <td>216,000</td> <td>YES</td> </tr> </tbody> </table>					Bk/Pg	Grantor	Date	Price	Code	2697/799	MILLER, HELEN LORENE &	03/08/2018	0	4	2256/277	BURGESS, JEFFREY DALE &	06/20/2012	216,000	YES																																																																																		
Code	Type	Active	Maximum	Exemption																																																																																																																					
H	Homestead	Yes	1,000	1,000																																																																																																																					
H	Homestead	No	1,000																																																																																																																						
Bk/Pg	Grantor	Date	Price	Code																																																																																																																					
2697/799	MILLER, HELEN LORENE &	03/08/2018	0	4																																																																																																																					
2256/277	BURGESS, JEFFREY DALE &	06/20/2012	216,000	YES																																																																																																																					
<b>Parcel Valuation</b> <table border="1"> <thead> <tr> <th>Source</th> <th>REAL</th> <th>Fair Cash</th> <th>Capped</th> <th>Asmnt Level</th> <th>Assessed</th> <th>Levy Rate</th> <th>92.430</th> <th>Current Tax</th> </tr> </thead> <tbody> <tr> <td>Remove Cap</td> <td>2013</td> <td>Land Value 83,573</td> <td>60,503</td> <td>11%</td> <td>6,655</td> <td>Assessed</td> <td>33,538</td> <td>3,099.92</td> </tr> <tr> <td>Year Frozen</td> <td>0</td> <td>Improvements 255,997</td> <td>244,392</td> <td></td> <td>26,883</td> <td>Penalty</td> <td>0</td> <td></td> </tr> <tr> <td>Uncapped Value</td> <td>0</td> <td>Mobile Home 0</td> <td>0</td> <td></td> <td>0</td> <td>Exemption</td> <td>1,000</td> <td>-93.00</td> </tr> <tr> <td>TIF Project ID</td> <td>0</td> <td>Total Value 339,570</td> <td>304,895</td> <td></td> <td>33,538</td> <td>Total Taxable</td> <td>32,538</td> <td>3,007.00</td> </tr> </tbody> </table>										Source	REAL	Fair Cash	Capped	Asmnt Level	Assessed	Levy Rate	92.430	Current Tax	Remove Cap	2013	Land Value 83,573	60,503	11%	6,655	Assessed	33,538	3,099.92	Year Frozen	0	Improvements 255,997	244,392		26,883	Penalty	0		Uncapped Value	0	Mobile Home 0	0		0	Exemption	1,000	-93.00	TIF Project ID	0	Total Value 339,570	304,895		33,538	Total Taxable	32,538	3,007.00																																																																			
Source	REAL	Fair Cash	Capped	Asmnt Level	Assessed	Levy Rate	92.430	Current Tax																																																																																																																	
Remove Cap	2013	Land Value 83,573	60,503	11%	6,655	Assessed	33,538	3,099.92																																																																																																																	
Year Frozen	0	Improvements 255,997	244,392		26,883	Penalty	0																																																																																																																		
Uncapped Value	0	Mobile Home 0	0		0	Exemption	1,000	-93.00																																																																																																																	
TIF Project ID	0	Total Value 339,570	304,895		33,538	Total Taxable	32,538	3,007.00																																																																																																																	
<b>Assessment History</b> <table border="1"> <thead> <tr> <th>Tax Year</th> <th>Statement Number</th> <th>Billed Owner</th> <th>Tax Area</th> <th>Total Value</th> <th>Exemptions</th> <th>Taxable Value</th> <th>Billed Tax</th> </tr> </thead> <tbody> <tr><td>2025</td><td>2025-660052513</td><td>MILLER, RAY &amp; LORI</td><td>18</td><td>333,814</td><td>1000</td><td>31,562</td><td>2,917.00</td></tr> <tr><td>2024</td><td>2024-660052513</td><td>MILLER, RAY &amp; LORI</td><td>18</td><td>350,898</td><td>1000</td><td>30,613</td><td>2,829.00</td></tr> <tr><td>2023</td><td>2023-660052513</td><td>MILLER, RAY &amp; LORI</td><td>18</td><td>280,947</td><td>1000</td><td>29,693</td><td>2,720.00</td></tr> <tr><td>2022</td><td>2022-660052513</td><td>MILLER, RAY &amp; LORI</td><td>18</td><td>280,559</td><td>1000</td><td>28,799</td><td>2,666.00</td></tr> <tr><td>2021</td><td>2021-660052513</td><td>MILLER, RAY &amp; LORI</td><td>18</td><td>273,351</td><td>1000</td><td>27,931</td><td>2,466.00</td></tr> <tr><td>2020</td><td>2020-660052513</td><td>MILLER, RAY &amp; LORI</td><td>18</td><td>264,096</td><td>1000</td><td>27,088</td><td>2,480.00</td></tr> <tr><td>2019</td><td>2019-660052513</td><td>MILLER, RAY &amp; LORI</td><td>18</td><td>247,912</td><td>1000</td><td>26,271</td><td>2,433.00</td></tr> <tr><td>2018</td><td>2018-660052513</td><td>MILLER, RAY &amp; LORI</td><td>18</td><td>255,341</td><td>1000</td><td>27,088</td><td>2,503.00</td></tr> <tr><td>2017</td><td>2017-660052513</td><td>MILLER, HELEN LORENE &amp;</td><td>18</td><td>252,899</td><td>1000</td><td>26,819</td><td>2,460.00</td></tr> <tr><td>2016</td><td>2016-660052513</td><td>MILLER, HELEN LORENE &amp;</td><td>18</td><td>246,777</td><td>0</td><td>27,146</td><td>2,544.00</td></tr> <tr><td>2015</td><td>2015-660052513</td><td>MILLER, HELEN LORENE &amp;</td><td>18</td><td>240,511</td><td>0</td><td>26,456</td><td>2,382.00</td></tr> <tr><td>2014</td><td>2014-660052513</td><td>MILLER, HELEN LORENE &amp;</td><td>18</td><td>231,288</td><td>0</td><td>25,150</td><td>2,332.00</td></tr> <tr><td>2013</td><td>2013-660052513</td><td>MILLER, HELEN LORENE &amp;</td><td>18</td><td>217,744</td><td>0</td><td>23,952</td><td>2,192.00</td></tr> </tbody> </table>										Tax Year	Statement Number	Billed Owner	Tax Area	Total Value	Exemptions	Taxable Value	Billed Tax	2025	2025-660052513	MILLER, RAY & LORI	18	333,814	1000	31,562	2,917.00	2024	2024-660052513	MILLER, RAY & LORI	18	350,898	1000	30,613	2,829.00	2023	2023-660052513	MILLER, RAY & LORI	18	280,947	1000	29,693	2,720.00	2022	2022-660052513	MILLER, RAY & LORI	18	280,559	1000	28,799	2,666.00	2021	2021-660052513	MILLER, RAY & LORI	18	273,351	1000	27,931	2,466.00	2020	2020-660052513	MILLER, RAY & LORI	18	264,096	1000	27,088	2,480.00	2019	2019-660052513	MILLER, RAY & LORI	18	247,912	1000	26,271	2,433.00	2018	2018-660052513	MILLER, RAY & LORI	18	255,341	1000	27,088	2,503.00	2017	2017-660052513	MILLER, HELEN LORENE &	18	252,899	1000	26,819	2,460.00	2016	2016-660052513	MILLER, HELEN LORENE &	18	246,777	0	27,146	2,544.00	2015	2015-660052513	MILLER, HELEN LORENE &	18	240,511	0	26,456	2,382.00	2014	2014-660052513	MILLER, HELEN LORENE &	18	231,288	0	25,150	2,332.00	2013	2013-660052513	MILLER, HELEN LORENE &	18	217,744	0	23,952	2,192.00
Tax Year	Statement Number	Billed Owner	Tax Area	Total Value	Exemptions	Taxable Value	Billed Tax																																																																																																																		
2025	2025-660052513	MILLER, RAY & LORI	18	333,814	1000	31,562	2,917.00																																																																																																																		
2024	2024-660052513	MILLER, RAY & LORI	18	350,898	1000	30,613	2,829.00																																																																																																																		
2023	2023-660052513	MILLER, RAY & LORI	18	280,947	1000	29,693	2,720.00																																																																																																																		
2022	2022-660052513	MILLER, RAY & LORI	18	280,559	1000	28,799	2,666.00																																																																																																																		
2021	2021-660052513	MILLER, RAY & LORI	18	273,351	1000	27,931	2,466.00																																																																																																																		
2020	2020-660052513	MILLER, RAY & LORI	18	264,096	1000	27,088	2,480.00																																																																																																																		
2019	2019-660052513	MILLER, RAY & LORI	18	247,912	1000	26,271	2,433.00																																																																																																																		
2018	2018-660052513	MILLER, RAY & LORI	18	255,341	1000	27,088	2,503.00																																																																																																																		
2017	2017-660052513	MILLER, HELEN LORENE &	18	252,899	1000	26,819	2,460.00																																																																																																																		
2016	2016-660052513	MILLER, HELEN LORENE &	18	246,777	0	27,146	2,544.00																																																																																																																		
2015	2015-660052513	MILLER, HELEN LORENE &	18	240,511	0	26,456	2,382.00																																																																																																																		
2014	2014-660052513	MILLER, HELEN LORENE &	18	231,288	0	25,150	2,332.00																																																																																																																		
2013	2013-660052513	MILLER, HELEN LORENE &	18	217,744	0	23,952	2,192.00																																																																																																																		



# Rogers

## Assessment Property Record Card for Tax Year 2026

Data provided by LISA DELOZIER County Assessor

Date 04/16/2026  
Time 22:24:11  
Page 2

Lot Data	Square-Foot - NBHD 6080 #1	Primary Image
<b>Lot Size</b> <b>Lot Count</b> <b>Units Buildable</b> 1 <b>Non-Ag Acres</b> 2.5619 <b>Topography</b> <b>Street Access</b> <b>Utilities</b> <b>Amenities</b> LAND QUALITY 0 0 <b>Method</b> Square-Foot <b>Base Lot Value</b> 111,596.00 x .75 = 83,573 <b>Factor Value</b> <b>Adjustments</b> 1.0000 <b>Lot Value</b> 83,573		

Residential Data	
<b>Type</b>	1 Single Family Residence
<b>Condition</b>	3 - Average
<b>Quality</b>	3.5 - Average
<b>Architecture</b>	
<b>Style</b>	100% One Story
<b>Exterior Wall</b>	50% Veneer, Masonry 50% Frame, Siding, Wood
<b>Base/Total Area</b>	2,230 / 2,230
<b>Style</b>	100% One Story
<b>HVAC</b>	100% Warmed & Cooled Air
<b>Roof Cover</b>	1 Composition Shingle
<b>Area on Slab</b>	2,230
<b>Fixture/RghIn</b>	11 /
<b>Bed/F/H Bath</b>	3 / 2.0 /
<b>Basement Area</b>	
<b>Garage Type</b>	912 Attached Garage - Unfinished
<b>Remodel</b>	
<b>Year/Eff Age</b>	1995 / 23

GRM Approach	
<b>GRM Code</b>	
<b>Gross Rent</b>	0.00
<b>Indicated Value</b>	

Multiple Regression			
<b>MRA Code</b>	1	Test	
<b>Adusted R</b>	0.8445		
<b>Indicated Value</b>	326,932	146.61	Per SqFt

Direct Comparables	
<b>Selection Model</b>	1 Res
<b>Adjustment Model</b>	A2 AO Test
<b>Comparables</b>	
<b>Indicated Value</b>	

Cost Approach				Manual : 01/2025			
<b>Base Cost</b>	106.19	<b>Total Misc Impr</b>	+ 7,137				
<b>Roofing Adj</b>	+ 5.24	<b>Garage Cost</b>	+ 33,936				
<b>Subfloor Adj</b>	+ -3.40	<b>Total RCN</b>	= 332,021				
<b>Heat/Cool Adj</b>	+ 14.47	<b>Depreciation ( 28%)</b>	- 92,966				
<b>Plumbing Adj</b>	+ 7.97	<b>Lump Sums</b>	+ 5,409				
<b>Basement Adj</b>	+ 0.00	<b>RCNLD</b>	= 244,464				
<b>Adj Base Cost</b>	= 130.47	<b>Lot Value</b>	+ 83,573				
<b>Total Area</b>	x 2,230	<b>Indicated Value</b>	= 328,037				
<b>Adjusted Cost</b>	= 290,948	<b>Value Per SqFt</b>	147.10				

Value Reconciliation			
<b>Selected Approach</b>	Cost Approach		
<b>Improvements</b>	244,464		
<b>Lot Value</b>	83,573		
<b>Indicated Value</b>	328,037	147.10	Per SqFt
<b>Agland Value</b>			
<b>Site Improvements</b>	11,533		
<b>Total Value</b>	339,570	152.27	Total Value Per SqFt

Miscellaneous Improvements								
Code	Description	Sketch ID	Size	Year	Units	Unit Cost	Depr	Value
FPR1	FIREPLACE - RESIDENTIAL 1 STORY	0		1	1	6,429.63		6,430
PRCH	SLAB PORCH - COVERED	78096	6x4		24	29.45		707
WODO	WOOD DECK - OPEN	78097	314		314	19.14	10%	5,409



# Rogers

## Assessment Property Record Card for Tax Year 2026

Data provided by LISA DELOZIER County Assessor

Date 04/16/2026

Time 22:24:11

Page 3

### Sketch Image

660052513

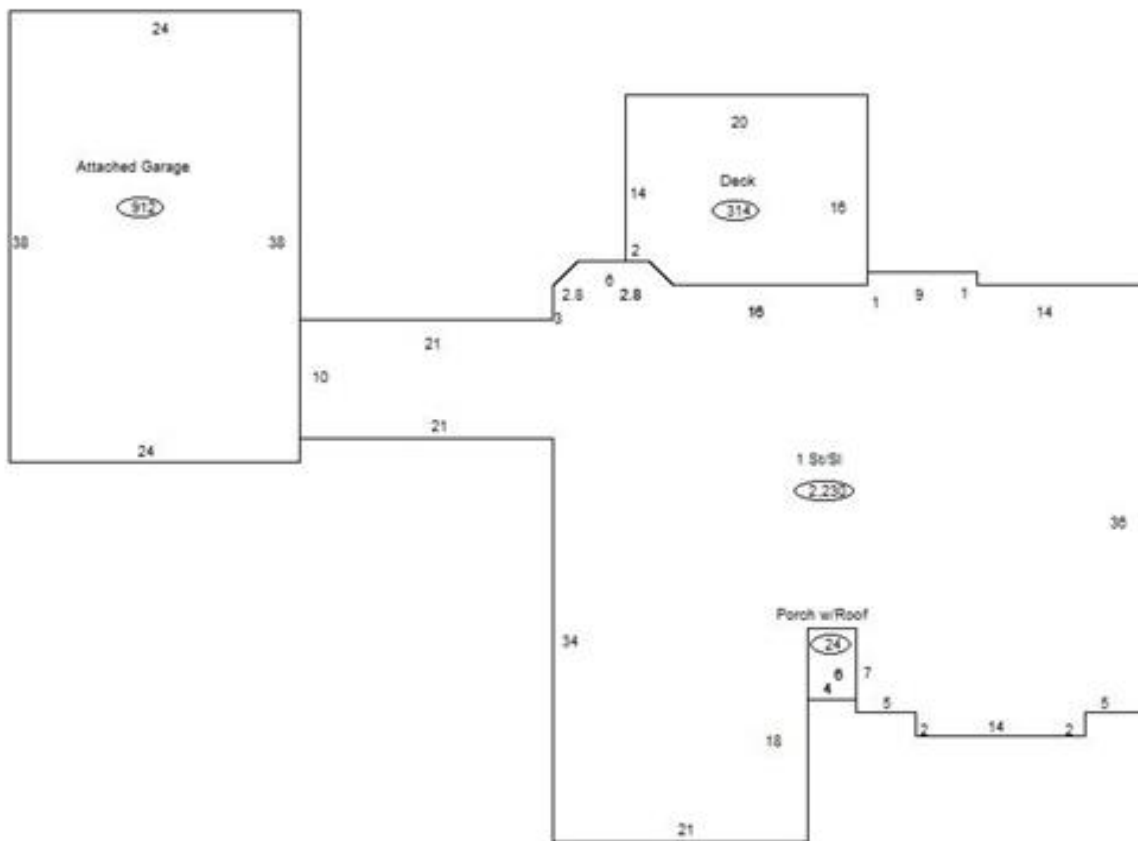

### Sketch Vector Information

Sequence	Code	Type	Built Over	Scale	Section Label	Base Area	Multiplier	Total Area
1	R	1	Slab	13	1 St/Sl	2,230	1.000	2,230
2	G	1		13	Attached Garage	912	1.000	912
3	M	PRCH		13	SLBC	24	1.000	24
4	M	WODO		13	WODO	314	1.000	314
<b>Total Building Area</b>						<b>2,230</b>		<b>2,230</b>



# Rogers



## Assessment Property Record Card for Tax Year 2026

Data provided by LISA DELOZIER County Assessor

Date 04/16/2026  
Time 22:24:11  
Page 4

660052513

### Outbuildings/Site Improvements

Building Image	Code	Description	Dimensions	Floor	Roofing	Total Units	
	QA	QUAN AVG	50x32x0	Concrete		1,600	
	Qual	2	Cond 3	Year 2014	Eff Age		
	<b>Valuation Summary</b>		<b>Modifier Total</b>	<b>RCN</b>	<b>Depr (15% Phys/ % Func)</b>	<b>RCNLD</b>	
	Base Cost (8.48 x 1,600)		13,568		13,568	2,035	11,533
	STF	STG FAIR	0x0x0				
	Qual	2	Cond 2	Year	Eff Age 2026		
	<b>Valuation Summary</b>		<b>Modifier Total</b>	<b>RCN</b>	<b>Depr (100% Phys/ % Func)</b>	<b>RCNLD</b>	
	Base Cost (4.68 x )						