



Rogers

Assessment Property Record Card for Tax Year 2026

Data provided by LISA DELOZIER County Assessor

Date 04/16/2026
Time 22:09:33
Page 1

Assessment Data					Primary Image														
Account 660054817 Parcel ID 000000-00-0-00730-002-0002 Cadastral ID 36-22-15-03610 Property Type REAL - Real Property Property Class RRP VI Area 4 Tax Area 10 - OOLOGAH RURAL/NW FIRE Name ID 317015 GONZALEZ, ALEXANDER AGUIAR & JENIFER LEANNE HENRY-GONZALEZ REVOCABLE LIVING TRUST 8312 GLENWOOD AVE OKLAHOMA CITY OK 73114-0000																			
Parcel Location Situs 09917 E SHADOWLAKE DR Subdivision SHADOWLAKE ESTATES Lot/Block 0002 / 0002 Parcel Size 1 - Lots Sec/Twn/Rng 36 / 22 / 15 / 5 Neighborhood 1114 - R-V01,4-NW OOLOGAH School District S004 - OOLOGAH SCHOOLS																			
Legal Description Lat/Long: 36.34743284 -95.65237638					Building Permits														
LOT 2 BLOCK 2 SHADOWLAKE ESTATES					<table border="1"> <thead> <tr> <th>Number</th> <th>Description</th> <th>Opened</th> <th>Closed</th> <th>Amount</th> </tr> </thead> <tbody> <tr> <td></td> <td></td> <td></td> <td></td> <td></td> </tr> </tbody> </table>					Number	Description	Opened	Closed	Amount					
Number	Description	Opened	Closed	Amount															
Exemptions					Sale History														
Code	Type	Active	Maximum	Exemption	Bk/Pg	Grantor	Date	Price	Code										
H	Homestead	No	1,000		/	GONZALEZ, ALEXANDER AGUIAR &	03/14/2019	0	4										
					2663/342	AGUIAR, JORGE ALEXANDER GONZAI	09/21/2017		4										
					2513/316	CARROLL, TIMOTHY	11/23/2015	250,000	YES										
					1324/573	STEIDLEY, TONY A & LORA-LYNN	10/12/2001	24,500	YES										
					1043/717	SHANNON PROPERTIES INC	10/24/1996	23,000	Yes										
Parcel Valuation																			
Source	REAL		Fair Cash	Capped	Asmnt Level	Assessed	Levy Rate	108.182	Current Tax										
Remove Cap	2016		Land Value	72,042	48,182	11%	5,300	Assessed	36,565 3,955.66										
Year Frozen	0		Improvements	285,549	284,224		31,265	Penalty	0										
Uncapped Value	0		Mobile Home	0	0		0	Exemption	0 0.00										
TIF Project ID	0		Total Value	357,591	332,406		36,565	Total Taxable	36,565 3,956.00										
Assessment History																			
Tax Year	Statement Number	Billed Owner			Tax Area	Total Value	Exemptions	Taxable Value	Billed Tax										
2025	2025-660054817	GONZALEZ, ALEXANDER AGUIAR &			10	350,247	0	34,824	3,767.00										
2024	2024-660054817	GONZALEZ, ALEXANDER AGUIAR &			10	372,831	0	33,165	3,474.00										
2023	2023-660054817	GONZALEZ, ALEXANDER AGUIAR &			10	287,146	0	31,586	3,285.00										
2022	2022-660054817	GONZALEZ, ALEXANDER AGUIAR &			10	293,384	0	31,346	3,245.00										
2021	2021-660054817	GONZALEZ, ALEXANDER AGUIAR &			10	271,395	0	29,853	3,112.00										
2020	2020-660054817	GONZALEZ, ALEXANDER AGUIAR &			10	266,931	0	29,362	3,105.00										
2019	2019-660054817	GONZALEZ, ALEXANDER AGUIAR &			10	256,160	0	28,178	2,925.00										
2018	2018-660054817	GONZALEZ, ALEXANDER AGUIAR &			10	262,956	0	28,925	3,106.00										
2017	2017-660054817	GONZALEZ, ALEXANDER AGUIAR &			10	260,792	0	28,687	3,261.00										
2016	2016-660054817	AGUIAR, JORGE ALEXANDER GONZALEZ &			10	254,101	0	27,951	2,894.00										
2015	2015-660054817	CARROLL, TIMOTHY			10	260,174	1000	19,684	1,942.00										
2014	2014-660054817	CARROLL, TIMOTHY			10	264,690	1000	19,082	1,878.00										
2013	2013-660054817	CARROLL, TIMOTHY			10	246,487	1000	18,497	1,762.00										



Rogers

Assessment Property Record Card for Tax Year 2026

Data provided by LISA DELOZIER County Assessor

Date 04/16/2026
Time 22:09:33
Page 2

Lot Data	Square-Foot - NBHD 1114 #1	Primary Image
Lot Size Lot Count Units Buildable 24528 Non-Ag Acres 1.1346 Topography Street Access Utilities Amenities LAND VALUE 0 0 Method Square-Foot Base Lot Value 49,425.00 x 1.46 = 72,042 Factor Value Adjustments 1.0000 Lot Value 72,042		 <p style="text-align: right; color: orange;">08/12/2022</p> <p>\\tsclient\T\TOMMY DUNLAP\081222(94)\IMG_0003.JPG 8/12/2022</p>

Residential Data	
Type	1 Single Family Residence
Condition	3 - Average
Quality	3.5 - Average
Architecture	
Style	100% One Story
Exterior Wall	100% Veneer, Masonry
Base/Total Area	2,449 / 2,449
Style	100% One Story
HVAC	100% Warmed & Cooled Air
Roof Cover	1 Composition Shingle
Area on Slab	2,449
Fixture/RghIn	14 /
Bed/F/H Bath	4 / 2.5 /
Basement Area	
Garage Type	648 Attached Garage - Unfinished 2 Stalls
Remodel	
Year/Eff Age	2003 / 17

Cost Approach		Manual : 01/2025	
Base Cost	109.00	Total Misc Impr	+ 17,209
Roofing Adj	+ 5.18	Garage Cost	+ 24,488
Subfloor Adj	+ -3.39	Total RCN	= 370,843
Heat/Cool Adj	+ 14.47	Depreciation (23%)	- 85,294
Plumbing Adj	+ 9.14	Lump Sums	+ 0
Basement Adj	+ 0.00	RCNLD	= 285,549
Adj Base Cost	= 134.40	Lot Value	+ 72,042
Total Area	x 2,449	Indicated Value	= 357,591
Adjusted Cost	= 329,146	Value Per SqFt	146.02

GRM Approach	
GRM Code	
Gross Rent	0.00
Indicated Value	

Multiple Regression			
MRA Code	1	Test	
Adusted R	0.8445		
Indicated Value	320,556	130.89	Per SqFt

Direct Comparables	
Selection Model	A Adam Test
Adjustment Model	1 2022 Residential
Comparables	3
Indicated Value	295,830 Per SqFt

Value Reconciliation			
Selected Approach	Cost Approach		
Improvements	285,549		
Lot Value	72,042		
Indicated Value	357,591	146.02	Per SqFt
Agland Value			
Site Improvements			
Total Value	357,591	146.02	Total Value Per SqFt

Miscellaneous Improvements							
Code	Description	Sketch ID	Size	Year	Units	Unit Cost	Depr Value
FPR1	FIREPLACE - RESIDENTIAL 1 STORY	0		1	1	6,429.63	6,430
PRCH	SLAB PORCH - COVERED	78443		105	105	29.19	3,065
PRCH	SLAB PORCH - COVERED	78444		270	270	28.57	7,714



Rogers
Assessment Property Record Card for Tax Year 2026

Data provided by LISA DELOZIER County Assessor

Date 04/16/2026
 Time 22:09:33
 Page 3

Sketch Image

660054817

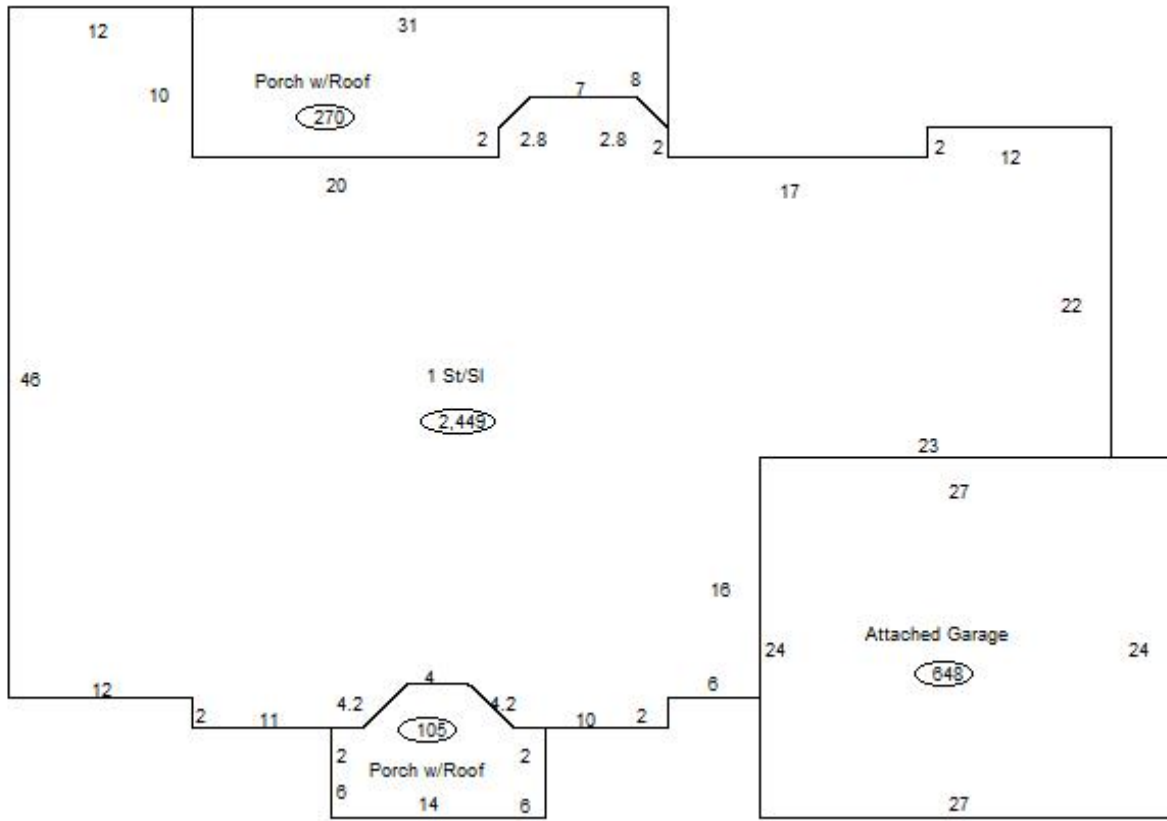

Sketch Vector Information

Sequence	Code	Type	Built Over	Scale	Section Label	Base Area	Multiplier	Total Area
1	R	1	Slab	13	1 St/Sl	2,449	1.000	2,449
2	G	1		13	Attached Garage	648	1.000	648
3	M	PRCH		13	SLBC	105	1.000	105
4	M	PRCH		13	SLBC	270	1.000	270
Total Building Area						2,449		2,449