



Rogers

Assessment Property Record Card for Tax Year 2026

Data provided by LISA DELOZIER County Assessor

Date 04/17/2026
Time 07:30:06
Page 1

Assessment Data					Primary Image																																																																																																																				
Account 660057017 Parcel ID 22N15E-36-1-00000-000-0000 Cadastral ID 36-22-15-01630 Property Type REAL - Real Property Property Class RR VI Area 4 Tax Area 10 - OOLOGAH RURAL/NW FIRE Name ID 348081 WOODY, ANDRE R 9998 E 460 RD CLAREMORE OK 74017-0000 Parcel Location Situs 09998 E 460 RD Subdivision Lot/Block / Parcel Size .998 - Acres Sec/Twn/Rng 36 / 22 / 15 / 1 Neighborhood 6080 - UNPLATTED School District S004 - OOLOGAH SCHOOLS					<p>660057017 01/09/26</p> <p>660057017_010.JPG 1/9/2026</p>																																																																																																																				
Legal Description Lat/Long: 36.35058379 -95.65117614 E 245.88', N 177.2' NE NE LESS TR BEG 45' W 38' S NE/C SEC TH W 10' S 10' E 10' N 10' TO POB																																																																																																																									
Exemptions <table border="1"> <thead> <tr> <th>Code</th> <th>Type</th> <th>Active</th> <th>Maximum</th> <th>Exemption</th> </tr> </thead> <tbody> <tr> <td>HV</td> <td>Veteran</td> <td>Yes</td> <td>999,999</td> <td>63,250</td> </tr> <tr> <td>H</td> <td>Homestead</td> <td>No</td> <td>1,000</td> <td></td> </tr> </tbody> </table>					Code	Type	Active	Maximum	Exemption	HV	Veteran	Yes	999,999	63,250	H	Homestead	No	1,000		Building Permits <table border="1"> <thead> <tr> <th>Number</th> <th>Description</th> <th>Opened</th> <th>Closed</th> <th>Amount</th> </tr> </thead> <tbody> <tr> <td>8243</td> <td>R5 FOR IMPROVEMENTS</td> <td>09/2003</td> <td>12/2004</td> <td>30,000</td> </tr> </tbody> </table>					Number	Description	Opened	Closed	Amount	8243	R5 FOR IMPROVEMENTS	09/2003	12/2004	30,000																																																																																							
Code	Type	Active	Maximum	Exemption																																																																																																																					
HV	Veteran	Yes	999,999	63,250																																																																																																																					
H	Homestead	No	1,000																																																																																																																						
Number	Description	Opened	Closed	Amount																																																																																																																					
8243	R5 FOR IMPROVEMENTS	09/2003	12/2004	30,000																																																																																																																					
Parcel Valuation <table border="1"> <thead> <tr> <th>Source</th> <th>REAL</th> <th>Fair Cash</th> <th>Capped</th> <th>Asmnt Level</th> <th>Assessed</th> <th>Levy Rate</th> <th>108.182</th> <th>Current Tax</th> </tr> </thead> <tbody> <tr> <td>Remove Cap</td> <td>2026</td> <td>Land Value</td> <td>160,910</td> <td>160,910</td> <td>11%</td> <td>17,700</td> <td>Assessed</td> <td>63,250 6,842.48</td> </tr> <tr> <td>Year Frozen</td> <td>2018</td> <td>Improvements</td> <td>414,091</td> <td>414,091</td> <td></td> <td>45,550</td> <td>Penalty</td> <td>0</td> </tr> <tr> <td>Uncapped Value</td> <td>17,960</td> <td>Mobile Home</td> <td>0</td> <td>0</td> <td></td> <td>0</td> <td>Exemption</td> <td>63,250 -5,956.00</td> </tr> <tr> <td>TIF Project ID</td> <td>0</td> <td>Total Value</td> <td>575,001</td> <td>575,001</td> <td></td> <td>63,250</td> <td>Total Taxable</td> <td>0 886.00</td> </tr> </tbody> </table>					Source	REAL	Fair Cash	Capped	Asmnt Level	Assessed	Levy Rate	108.182	Current Tax	Remove Cap	2026	Land Value	160,910	160,910	11%	17,700	Assessed	63,250 6,842.48	Year Frozen	2018	Improvements	414,091	414,091		45,550	Penalty	0	Uncapped Value	17,960	Mobile Home	0	0		0	Exemption	63,250 -5,956.00	TIF Project ID	0	Total Value	575,001	575,001		63,250	Total Taxable	0 886.00	Sale History <table border="1"> <thead> <tr> <th>Bk/Pg</th> <th>Grantor</th> <th>Date</th> <th>Price</th> <th>Code</th> </tr> </thead> <tbody> <tr> <td>/</td> <td>MORGAN, DEBRA D & RONALD</td> <td>08/26/2025</td> <td>575,000</td> <td>WG</td> </tr> <tr> <td>/</td> <td>ROSENCUTTER, CLARA L-TRUST</td> <td>02/18/2020</td> <td>200,000</td> <td>4</td> </tr> <tr> <td>2578/132</td> <td>EDELMANN, CYNTHIA K & JOHN L</td> <td>09/16/2016</td> <td>250,000</td> <td>YES</td> </tr> <tr> <td>2467/744</td> <td>THOMPSON, WILLY C</td> <td>04/18/2015</td> <td>0</td> <td>4</td> </tr> <tr> <td>2467/740</td> <td>THOMPSON, FRANK B &</td> <td>04/18/2015</td> <td>0</td> <td>4</td> </tr> <tr> <td>1706/904</td> <td>SHANK, JILL L &</td> <td>08/29/2005</td> <td>222,000</td> <td>YES</td> </tr> </tbody> </table>					Bk/Pg	Grantor	Date	Price	Code	/	MORGAN, DEBRA D & RONALD	08/26/2025	575,000	WG	/	ROSENCUTTER, CLARA L-TRUST	02/18/2020	200,000	4	2578/132	EDELMANN, CYNTHIA K & JOHN L	09/16/2016	250,000	YES	2467/744	THOMPSON, WILLY C	04/18/2015	0	4	2467/740	THOMPSON, FRANK B &	04/18/2015	0	4	1706/904	SHANK, JILL L &	08/29/2005	222,000	YES																																
Source	REAL	Fair Cash	Capped	Asmnt Level	Assessed	Levy Rate	108.182	Current Tax																																																																																																																	
Remove Cap	2026	Land Value	160,910	160,910	11%	17,700	Assessed	63,250 6,842.48																																																																																																																	
Year Frozen	2018	Improvements	414,091	414,091		45,550	Penalty	0																																																																																																																	
Uncapped Value	17,960	Mobile Home	0	0		0	Exemption	63,250 -5,956.00																																																																																																																	
TIF Project ID	0	Total Value	575,001	575,001		63,250	Total Taxable	0 886.00																																																																																																																	
Bk/Pg	Grantor	Date	Price	Code																																																																																																																					
/	MORGAN, DEBRA D & RONALD	08/26/2025	575,000	WG																																																																																																																					
/	ROSENCUTTER, CLARA L-TRUST	02/18/2020	200,000	4																																																																																																																					
2578/132	EDELMANN, CYNTHIA K & JOHN L	09/16/2016	250,000	YES																																																																																																																					
2467/744	THOMPSON, WILLY C	04/18/2015	0	4																																																																																																																					
2467/740	THOMPSON, FRANK B &	04/18/2015	0	4																																																																																																																					
1706/904	SHANK, JILL L &	08/29/2005	222,000	YES																																																																																																																					
Assessment History <table border="1"> <thead> <tr> <th>Tax Year</th> <th>Statement Number</th> <th>Billed Owner</th> <th>Tax Area</th> <th>Total Value</th> <th>Exemptions</th> <th>Taxable Value</th> <th>Billed Tax</th> </tr> </thead> <tbody> <tr><td>2025</td><td>2025-660057017</td><td>WOODY, ANDRE R</td><td>10</td><td>362,371</td><td>1000</td><td>32,521</td><td>3,533.00</td></tr> <tr><td>2024</td><td>2024-660057017</td><td>MORGAN, DEBRA D</td><td>10</td><td>377,833</td><td>1000</td><td>31,545</td><td>3,318.00</td></tr> <tr><td>2023</td><td>2023-660057017</td><td>MORGAN, DEBRA D</td><td>10</td><td>344,501</td><td>1000</td><td>30,597</td><td>3,196.00</td></tr> <tr><td>2022</td><td>2022-660057017</td><td>MORGAN, DEBRA D</td><td>10</td><td>306,104</td><td>1000</td><td>28,524</td><td>2,966.00</td></tr> <tr><td>2021</td><td>2021-660057017</td><td>BAILEY, ROBERT E &</td><td>10</td><td>278,398</td><td>1000</td><td>27,664</td><td>2,898.00</td></tr> <tr><td>2020</td><td>2020-660057017</td><td>BAILEY, ROBERT E &</td><td>10</td><td>270,643</td><td>1000</td><td>26,830</td><td>2,852.00</td></tr> <tr><td>2019</td><td>2019-660057017</td><td>ROSENCUTTER, CLARA L-TRUST</td><td>10</td><td>252,995</td><td>1000</td><td>26,830</td><td>2,799.00</td></tr> <tr><td>2018</td><td>2018-660057017</td><td>ROSENCUTTER, CLARA L-TRUST</td><td>10</td><td>256,421</td><td>1000</td><td>27,207</td><td>2,936.00</td></tr> <tr><td>2017</td><td>2017-660057017</td><td>ROSENCUTTER, CLARA L-TRUST</td><td>10</td><td>254,159</td><td>1000</td><td>26,958</td><td>3,079.00</td></tr> <tr><td>2016</td><td>2016-660057017</td><td>ROSENCUTTER, CLARA L-TRUST</td><td>10</td><td>209,024</td><td>0</td><td>22,217</td><td>2,301.00</td></tr> <tr><td>2015</td><td>2015-660057017</td><td>EDELMANN, CYNTHIA K & JOHN L</td><td>10</td><td>202,791</td><td>21159</td><td></td><td>273.00</td></tr> <tr><td>2014</td><td>2014-660057017</td><td>THOMPSON, FRANK B &</td><td>10</td><td>206,446</td><td>21159</td><td></td><td>249.00</td></tr> <tr><td>2013</td><td>2013-660057017</td><td>THOMPSON, FRANK B &</td><td>10</td><td>195,311</td><td>21158</td><td></td><td>243.00</td></tr> </tbody> </table>										Tax Year	Statement Number	Billed Owner	Tax Area	Total Value	Exemptions	Taxable Value	Billed Tax	2025	2025-660057017	WOODY, ANDRE R	10	362,371	1000	32,521	3,533.00	2024	2024-660057017	MORGAN, DEBRA D	10	377,833	1000	31,545	3,318.00	2023	2023-660057017	MORGAN, DEBRA D	10	344,501	1000	30,597	3,196.00	2022	2022-660057017	MORGAN, DEBRA D	10	306,104	1000	28,524	2,966.00	2021	2021-660057017	BAILEY, ROBERT E &	10	278,398	1000	27,664	2,898.00	2020	2020-660057017	BAILEY, ROBERT E &	10	270,643	1000	26,830	2,852.00	2019	2019-660057017	ROSENCUTTER, CLARA L-TRUST	10	252,995	1000	26,830	2,799.00	2018	2018-660057017	ROSENCUTTER, CLARA L-TRUST	10	256,421	1000	27,207	2,936.00	2017	2017-660057017	ROSENCUTTER, CLARA L-TRUST	10	254,159	1000	26,958	3,079.00	2016	2016-660057017	ROSENCUTTER, CLARA L-TRUST	10	209,024	0	22,217	2,301.00	2015	2015-660057017	EDELMANN, CYNTHIA K & JOHN L	10	202,791	21159		273.00	2014	2014-660057017	THOMPSON, FRANK B &	10	206,446	21159		249.00	2013	2013-660057017	THOMPSON, FRANK B &	10	195,311	21158		243.00
Tax Year	Statement Number	Billed Owner	Tax Area	Total Value	Exemptions	Taxable Value	Billed Tax																																																																																																																		
2025	2025-660057017	WOODY, ANDRE R	10	362,371	1000	32,521	3,533.00																																																																																																																		
2024	2024-660057017	MORGAN, DEBRA D	10	377,833	1000	31,545	3,318.00																																																																																																																		
2023	2023-660057017	MORGAN, DEBRA D	10	344,501	1000	30,597	3,196.00																																																																																																																		
2022	2022-660057017	MORGAN, DEBRA D	10	306,104	1000	28,524	2,966.00																																																																																																																		
2021	2021-660057017	BAILEY, ROBERT E &	10	278,398	1000	27,664	2,898.00																																																																																																																		
2020	2020-660057017	BAILEY, ROBERT E &	10	270,643	1000	26,830	2,852.00																																																																																																																		
2019	2019-660057017	ROSENCUTTER, CLARA L-TRUST	10	252,995	1000	26,830	2,799.00																																																																																																																		
2018	2018-660057017	ROSENCUTTER, CLARA L-TRUST	10	256,421	1000	27,207	2,936.00																																																																																																																		
2017	2017-660057017	ROSENCUTTER, CLARA L-TRUST	10	254,159	1000	26,958	3,079.00																																																																																																																		
2016	2016-660057017	ROSENCUTTER, CLARA L-TRUST	10	209,024	0	22,217	2,301.00																																																																																																																		
2015	2015-660057017	EDELMANN, CYNTHIA K & JOHN L	10	202,791	21159		273.00																																																																																																																		
2014	2014-660057017	THOMPSON, FRANK B &	10	206,446	21159		249.00																																																																																																																		
2013	2013-660057017	THOMPSON, FRANK B &	10	195,311	21158		243.00																																																																																																																		



Rogers

Assessment Property Record Card for Tax Year 2026

Data provided by LISA DELOZIER County Assessor

Date 04/17/2026
 Time 07:30:06
 Page 2

Lot Data	Square-Foot - NBHD 6080 #1	Primary Image
Lot Size		
Lot Count		
Units Buildable	0.998	
Non-Ag Acres	1.0414	
Topography		
Street Access		
Utilities		
Amenities	LAND QUALITY	
	0	
	0	
Method	Square-Foot	
Base Lot Value	45,361.00 x 1.13 = 51,175	
Factor Value		
Adjustments	3.1443	
Lot Value	160,910	

Residential Data	
Type	1 Single Family Residence
Condition	4 - Good
Quality	3.5 - Average
Architecture	
Style	100% One Story
Exterior Wall	100% Veneer, Masonry
Base/Total Area	2,108 / 2,108
Style	100% One Story
HVAC	100% Warmed & Cooled Air
Roof Cover	1 Composition Shingle
Area on Slab	2,108
Fixture/RghIn	11 /
Bed/F/H Bath	3 / 3.0 / 1.0
Basement Area	
Garage Type	506 Attached Garage - Unfinished 2 Stalls
Remodel	PARTIAL -
Year/Eff Age	1994 / 13

660057017	660057017_001.JPG	01/09/26
		1/9/2026

GRM Approach	
GRM Code	
Gross Rent	0.00
Indicated Value	

Multiple Regression			
MRA Code	1	Test	
Adusted R	0.8445		
Indicated Value	295,681	140.27	Per SqFt

Direct Comparables	
Selection Model	1 Res
Adjustment Model	A2 AO Test
Comparables	
Indicated Value	

Cost Approach				Manual : 01/2025	
Base Cost	111.46	Total Misc Impr	+	18,297	
Roofing Adj	+ 5.31	Garage Cost	+	20,088	
Subfloor Adj	+ -3.40	Total RCN	=	325,642	
Heat/Cool Adj	+ 14.47	Depreciation (13%)	-	42,333	
Plumbing Adj	+ 8.43	Lump Sums	+	3,664	
Basement Adj	+ 0.00	RCNLD	=	286,973	
Adj Base Cost	= 136.27	Lot Value	+	160,910	
Total Area	x 2,108	Indicated Value	=	447,883	
Adjusted Cost	= 287,257	Value Per SqFt		212.47	

Value Reconciliation			
Selected Approach	Cost Approach		
Improvements	286,973		
Lot Value	160,910		
Indicated Value	447,883	212.47	Per SqFt
Agland Value			
Site Improvements	28,191		
Total Value	476,074	225.84	Total Value Per SqFt

Miscellaneous Improvements								
Code	Description	Sketch ID	Size	Year	Units	Unit Cost	Depr	Value
FPR1	FIREPLACE - RESIDENTIAL 1 STORY	0		1	1	6,429.63		6,430
PRCH	Porch	79037	17x5		85	29.26		2,487
PATO	Patio - Open	79038	44x22		968	9.69		9,380
PERG	Pergola	189291	12x8		96	17.50		1,680
PERG	Pergola	189292	6x3		18	17.50		315
WODO	Wood Deck - Open	189293	10x5		50	33.38		1,669



Rogers

Assessment Property Record Card for Tax Year 2026

Data provided by LISA DELOZIER County Assessor

Date 04/17/2026
 Time 07:30:06
 Page 3

Sketch Image

660057017

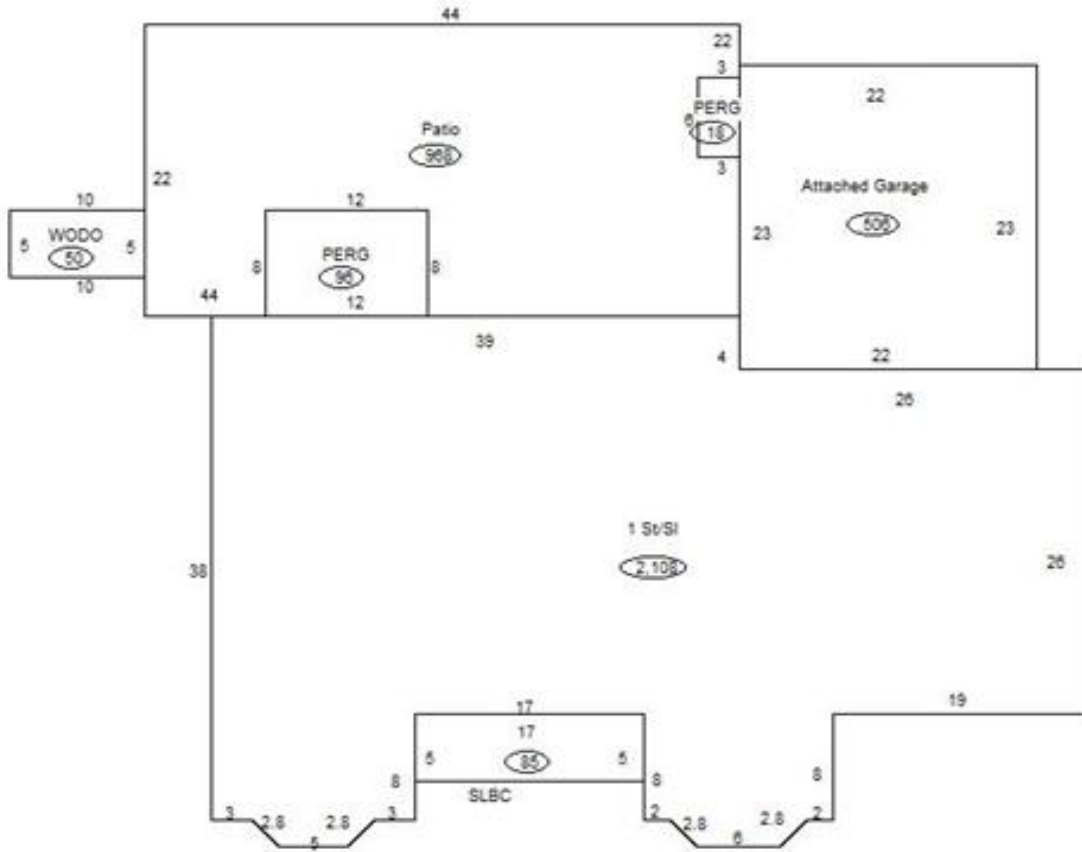

Sketch Vector Information

Sequence	Code	Type	Built Over	Scale	Section Label	Base Area	Multiplier	Total Area
1	R	1	Slab	13	1 St/SI	2,108	1.000	2,108
2	G	1		13	Attached Garage	506	1.000	506
3	M	PRCH		13	SLBC	85	1.000	85
4	M	PATO		13	Patio	968	1.000	968
5	M	PERG		13	PERG	96	1.000	96
6	M	PERG		13	PERG	18	1.000	18
7	M	WODO		13	WODO	50	1.000	50
Total Building Area						2,108		2,108



Rogers



Assessment Property Record Card for Tax Year 2026

Data provided by LISA DELOZIER County Assessor

Date 04/17/2026
 Time 07:30:06
 Page 4

660057017

Outbuildings/Site Improvements

Building Image	Code	Description	Dimensions	Floor	Roofing	Total Units
	WODC	Wood Deck - Covered	9x9x8	Plank	Formed Metal	81
	Qual 3	Cond 3	Year 2025	Eff Age 1		
	Valuation Summary		Modifier Total	RCN	Depr (5% Phys/ % Func)	RCNLD
	Base Cost (46.62 x 81) 3,776			3,776	189	3,587
	GRDT	Garage - Detached	48x16x8	Concrete	Formed Metal	768
	Qual 3.5	Cond 3	Year 2022	Eff Age 3		
	Valuation Summary		Modifier Total	RCN	Depr (5% Phys/ % Func)	RCNLD
	Base Cost (32.44 x 768) 24,914		0	24,914	1,246	23,668
	STF	STG FAIR	10x20x8	Concrete	Formed Metal	200
	Qual 3	Cond 3	Year	Eff Age 1520		
	Valuation Summary		Modifier Total	RCN	Depr (% Phys/ % Func)	RCNLD
	Base Cost (4.68 x 200) 936			936		936



Rogers

Assessment Property Record Card for Tax Year 2026

Data provided by LISA DELOZIER County Assessor

Date 04/17/2026
 Time 07:30:07
 Page 5

Lot Data		Primary Image						
Lot Size	-							
Lot Count								
Units Buildable								
Non-Ag Acres								
Topography								
Street Access								
Utilities								
Amenities	LAND QUALITY							
Method								
Base Lot Value								
Factor Value		660057017_010.JPG 1/9/2026						
Adjustments		GRM Approach						
Lot Value		GRM Code						
Residential Data		Gross Rent 0.00						
Type	1 Single Family Residence	Indicated Value						
Condition	3.5 - Average	Multiple Regression						
Quality	2 - Fair	MRA Code						
Architecture		Adusted R						
Style	100% One Story	Indicated Value						
Exterior Wall	25% Veneer, Masonry 75% Frame, Siding, Wood	Direct Comparables						
Base/Total Area	968 / 968	Selection Model 1 Res						
Style	100% One Story	Adjustment Model A2 AO Test						
HVAC	100% Warmed & Cooled Air	Comparables						
Roof Cover	1 Composition Shingle	Indicated Value						
Area on Slab	968	Value Reconciliation						
Fixture/RghIn	4 /	Selected Approach Cost Approach						
Bed/F/H Bath	1 / 1.0 /	Improvements 93,111						
Basement Area		Lot Value						
Garage Type	308 Carport - Shed Roof	Indicated Value 93,111 96.19 Per SqFt						
Remodel		Aglard Value						
Year/Eff Age	2003 / 16	Site Improvements 5,816						
Cost Approach		Total Value 98,927 102.20 Total Value Per SqFt						
Manual : 01/2025								
Base Cost	97.59	Total Misc Impr	+ 847					
Roofing Adj	+ 4.26	Garage Cost	+ 3,440					
Subfloor Adj	+ 0.00	Total RCN	= 117,862					
Heat/Cool Adj	+ 10.30	Depreciation (21%)	- 24,751					
Plumbing Adj	+ 5.18	Lump Sums	+ 0					
Basement Adj	+ 0.00	RCNLD	= 93,111					
Adj Base Cost	= 117.33	Lot Value	+ 93,111					
Total Area	x 968	Indicated Value	= 93,111					
Adjusted Cost	= 113,575	Value Per SqFt	96.19					
Miscellaneous Improvements								
Code	Description	Sketch ID	Size	Year	Units	Unit Cost	Depr	Value
PRCH	SLAB PORCH - COVERED	132166	10x4		40	21.17		847



Rogers

Assessment Property Record Card for Tax Year 2026

Data provided by LISA DELOZIER County Assessor

Date 04/17/2026
 Time 07:30:07
 Page 6

Sketch Image

660057017

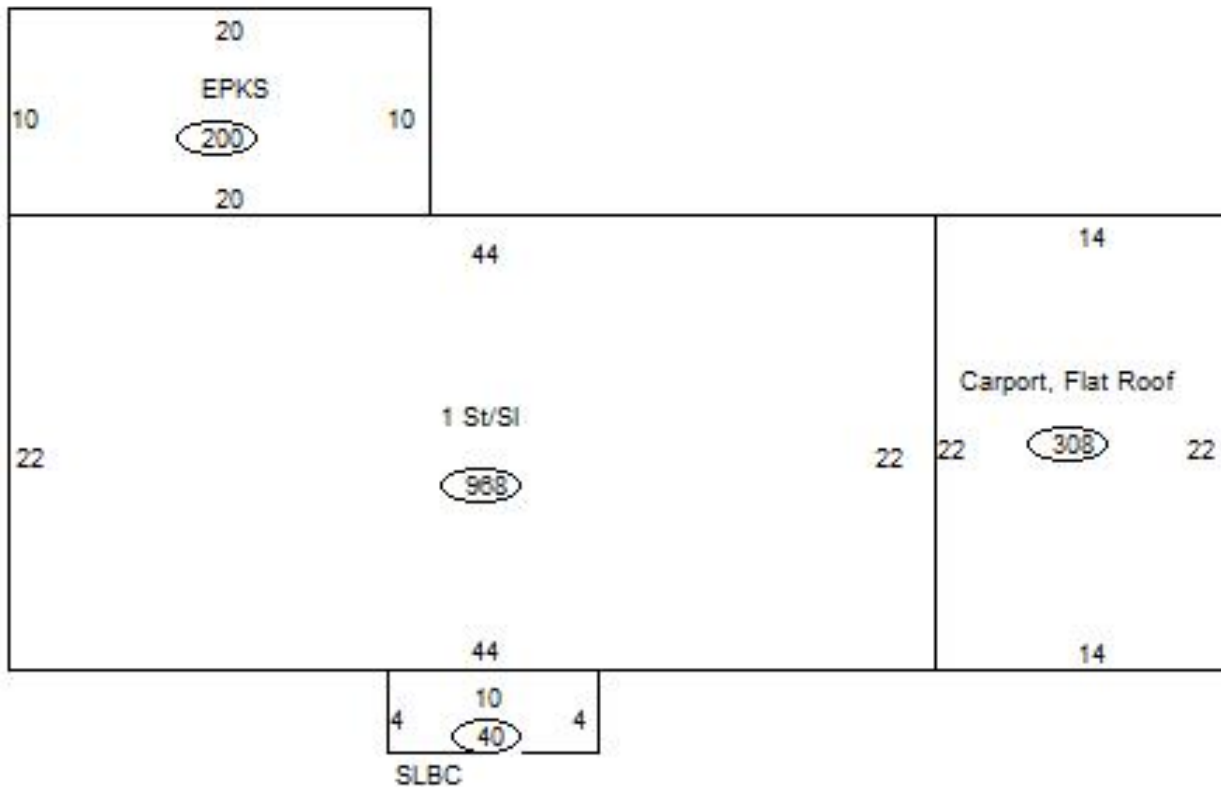

Sketch Vector Information

Sequence	Code	Type	Built Over	Scale	Section Label	Base Area	Multiplier	Total Area
1	R	1	Slab	13	1 St/SI	968	1.000	968
2	M	PRCH		13	SLBC	40	1.000	40
3	G	4		13	Carport, Flat Roof	308	1.000	308
4	O	EPKS		13	EPKS	200	1.000	200
Total Building Area						968		968



Rogers

Assessment Property Record Card for Tax Year 2026

Data provided by LISA DELOZIER County Assessor

Date 04/17/2026
Time 07:30:07
Page 7

660057017

Outbuildings/Site Improvements

Building Image	Code	Description	Dimensions	Floor	Roofing	Total Units
	EPKS	WOOD DECK - OPEN	22x0x0	Plank	Composition Shingle	200
	Qual 3	Cond 3	Year 2024	Eff Age 0		

Valuation Summary	Modifier Total	RCN	Depr (0% Phys/ 0% Func)	RCNLD
Base Cost (29.08 x 200)	5,816		5,816	5,816