



Rogers

Assessment Property Record Card for Tax Year 2026

Data provided by LISA DELOZIER County Assessor

Date 04/16/2026
Time 23:12:14
Page 1

Assessment Data					Primary Image																																																																																																																				
Account 660058582 Parcel ID 000000-00-0-00643-001-0005 Cadastral ID 13-21-14-03340 Property Type REAL - Real Property Property Class RRP VI Area 4 Tax Area 7 - OWASSO/LIMESTONE FIRE Name ID 270249 POUNDS, MICHAEL L & JENALEA J 10397 N 180TH E AVE OWASSO OK 74055-0000																																																																																																																									
Parcel Location Situs 10397 N 180TH E AVE Subdivision RANCH ACRES Lot/Block 0005 / 0001 Parcel Size 1 - Lots Sec/Twn/Rng 13 / 21 / 14 / 5 Neighborhood 1014 - R-V04-SW OWASSO School District S021 - OWASSO SCHOOLS																																																																																																																									
Legal Description Lot/Long: 36.30518114 -95.77256146 LOT 5 BLOCK 1 RANCH ACRES					Building Permits <table border="1"> <thead> <tr> <th>Number</th> <th>Description</th> <th>Opened</th> <th>Closed</th> <th>Amount</th> </tr> </thead> <tbody> <tr> <td>R2011 12 3</td> <td>R13-NEW 16X34 972 SQ FT ROOM ADI</td> <td>12/2011</td> <td>04/2012</td> <td>30,000</td> </tr> </tbody> </table>					Number	Description	Opened	Closed	Amount	R2011 12 3	R13-NEW 16X34 972 SQ FT ROOM ADI	12/2011	04/2012	30,000																																																																																																						
Number	Description	Opened	Closed	Amount																																																																																																																					
R2011 12 3	R13-NEW 16X34 972 SQ FT ROOM ADI	12/2011	04/2012	30,000																																																																																																																					
Exemptions <table border="1"> <thead> <tr> <th>Code</th> <th>Type</th> <th>Active</th> <th>Maximum</th> <th>Exemption</th> </tr> </thead> <tbody> <tr> <td>H</td> <td>Homestead</td> <td>Yes</td> <td>1,000</td> <td>1,000</td> </tr> </tbody> </table>					Code	Type	Active	Maximum	Exemption	H	Homestead	Yes	1,000	1,000	Sale History <table border="1"> <thead> <tr> <th>Bk/Pg</th> <th>Grantor</th> <th>Date</th> <th>Price</th> <th>Code</th> </tr> </thead> <tbody> <tr> <td>1151/42</td> <td>KARNEI, ARTIS L &</td> <td>01/21/1998</td> <td>147,000</td> <td>Yes</td> </tr> <tr> <td>971/132</td> <td>D&M HOMES INC</td> <td>10/13/1994</td> <td>115,000</td> <td>Yes</td> </tr> <tr> <td>971/131</td> <td>A&W LAND DEVELOPMENT INC</td> <td>09/22/1994</td> <td>0</td> <td>No</td> </tr> </tbody> </table>					Bk/Pg	Grantor	Date	Price	Code	1151/42	KARNEI, ARTIS L &	01/21/1998	147,000	Yes	971/132	D&M HOMES INC	10/13/1994	115,000	Yes	971/131	A&W LAND DEVELOPMENT INC	09/22/1994	0	No																																																																																		
Code	Type	Active	Maximum	Exemption																																																																																																																					
H	Homestead	Yes	1,000	1,000																																																																																																																					
Bk/Pg	Grantor	Date	Price	Code																																																																																																																					
1151/42	KARNEI, ARTIS L &	01/21/1998	147,000	Yes																																																																																																																					
971/132	D&M HOMES INC	10/13/1994	115,000	Yes																																																																																																																					
971/131	A&W LAND DEVELOPMENT INC	09/22/1994	0	No																																																																																																																					
Parcel Valuation <table border="1"> <thead> <tr> <th>Source</th> <th>REAL</th> <th>Fair Cash</th> <th>Capped</th> <th>Asmnt Level</th> <th>Assessed</th> <th>Levy Rate</th> <th>108.538</th> <th>Current Tax</th> </tr> </thead> <tbody> <tr> <td>Remove Cap</td> <td>2000</td> <td>Land Value 82,779</td> <td>41,880</td> <td>11%</td> <td>4,607</td> <td>Assessed</td> <td>33,982</td> <td>3,688.34</td> </tr> <tr> <td>Year Frozen</td> <td>0</td> <td>Improvements 281,259</td> <td>267,044</td> <td></td> <td>29,375</td> <td>Penalty</td> <td>0</td> <td></td> </tr> <tr> <td>Uncapped Value</td> <td>0</td> <td>Mobile Home 0</td> <td>0</td> <td></td> <td>0</td> <td>Exemption</td> <td>1,000</td> <td>-97.00</td> </tr> <tr> <td>TIF Project ID</td> <td>0</td> <td>Total Value 364,038</td> <td>308,924</td> <td></td> <td>33,982</td> <td>Total Taxable</td> <td>32,982</td> <td>3,591.00</td> </tr> </tbody> </table>										Source	REAL	Fair Cash	Capped	Asmnt Level	Assessed	Levy Rate	108.538	Current Tax	Remove Cap	2000	Land Value 82,779	41,880	11%	4,607	Assessed	33,982	3,688.34	Year Frozen	0	Improvements 281,259	267,044		29,375	Penalty	0		Uncapped Value	0	Mobile Home 0	0		0	Exemption	1,000	-97.00	TIF Project ID	0	Total Value 364,038	308,924		33,982	Total Taxable	32,982	3,591.00																																																																			
Source	REAL	Fair Cash	Capped	Asmnt Level	Assessed	Levy Rate	108.538	Current Tax																																																																																																																	
Remove Cap	2000	Land Value 82,779	41,880	11%	4,607	Assessed	33,982	3,688.34																																																																																																																	
Year Frozen	0	Improvements 281,259	267,044		29,375	Penalty	0																																																																																																																		
Uncapped Value	0	Mobile Home 0	0		0	Exemption	1,000	-97.00																																																																																																																	
TIF Project ID	0	Total Value 364,038	308,924		33,982	Total Taxable	32,982	3,591.00																																																																																																																	
Assessment History <table border="1"> <thead> <tr> <th>Tax Year</th> <th>Statement Number</th> <th>Billed Owner</th> <th>Tax Area</th> <th>Total Value</th> <th>Exemptions</th> <th>Taxable Value</th> <th>Billed Tax</th> </tr> </thead> <tbody> <tr><td>2025</td><td>2025-660058582</td><td>POUNDS, MICHAEL L &</td><td>7</td><td>354,227</td><td>1000</td><td>31,992</td><td>3,483.00</td></tr> <tr><td>2024</td><td>2024-660058582</td><td>POUNDS, MICHAEL L &</td><td>7</td><td>508,159</td><td>1000</td><td>31,031</td><td>3,438.00</td></tr> <tr><td>2023</td><td>2023-660058582</td><td>POUNDS, MICHAEL L &</td><td>7</td><td>287,253</td><td>1000</td><td>30,098</td><td>3,264.00</td></tr> <tr><td>2022</td><td>2022-660058582</td><td>POUNDS, MICHAEL L &</td><td>7</td><td>290,798</td><td>1000</td><td>29,192</td><td>3,291.00</td></tr> <tr><td>2021</td><td>2021-660058582</td><td>POUNDS, MICHAEL L &</td><td>7</td><td>266,483</td><td>1000</td><td>28,313</td><td>3,158.00</td></tr> <tr><td>2020</td><td>2020-660058582</td><td>POUNDS, MICHAEL L &</td><td>7</td><td>264,661</td><td>1000</td><td>27,498</td><td>3,063.00</td></tr> <tr><td>2019</td><td>2019-660058582</td><td>POUNDS, MICHAEL L &</td><td>7</td><td>251,531</td><td>1000</td><td>26,668</td><td>2,973.00</td></tr> <tr><td>2018</td><td>2018-660058582</td><td>POUNDS, MICHAEL L &</td><td>7</td><td>258,847</td><td>1000</td><td>27,473</td><td>2,964.00</td></tr> <tr><td>2017</td><td>2017-660058582</td><td>POUNDS, MICHAEL L &</td><td>7</td><td>256,595</td><td>1000</td><td>27,153</td><td>2,956.00</td></tr> <tr><td>2016</td><td>2016-660058582</td><td>POUNDS, MICHAEL L &</td><td>7</td><td>249,991</td><td>1000</td><td>26,333</td><td>2,869.00</td></tr> <tr><td>2015</td><td>2015-660058582</td><td>POUNDS, MICHAEL L &</td><td>7</td><td>243,304</td><td>1000</td><td>25,537</td><td>2,801.00</td></tr> <tr><td>2014</td><td>2014-660058582</td><td>POUNDS, MICHAEL L &</td><td>7</td><td>251,977</td><td>1000</td><td>24,764</td><td>2,738.00</td></tr> <tr><td>2013</td><td>2013-660058582</td><td>POUNDS, MICHAEL L &</td><td>7</td><td>236,810</td><td>1000</td><td>24,014</td><td>2,607.00</td></tr> </tbody> </table>										Tax Year	Statement Number	Billed Owner	Tax Area	Total Value	Exemptions	Taxable Value	Billed Tax	2025	2025-660058582	POUNDS, MICHAEL L &	7	354,227	1000	31,992	3,483.00	2024	2024-660058582	POUNDS, MICHAEL L &	7	508,159	1000	31,031	3,438.00	2023	2023-660058582	POUNDS, MICHAEL L &	7	287,253	1000	30,098	3,264.00	2022	2022-660058582	POUNDS, MICHAEL L &	7	290,798	1000	29,192	3,291.00	2021	2021-660058582	POUNDS, MICHAEL L &	7	266,483	1000	28,313	3,158.00	2020	2020-660058582	POUNDS, MICHAEL L &	7	264,661	1000	27,498	3,063.00	2019	2019-660058582	POUNDS, MICHAEL L &	7	251,531	1000	26,668	2,973.00	2018	2018-660058582	POUNDS, MICHAEL L &	7	258,847	1000	27,473	2,964.00	2017	2017-660058582	POUNDS, MICHAEL L &	7	256,595	1000	27,153	2,956.00	2016	2016-660058582	POUNDS, MICHAEL L &	7	249,991	1000	26,333	2,869.00	2015	2015-660058582	POUNDS, MICHAEL L &	7	243,304	1000	25,537	2,801.00	2014	2014-660058582	POUNDS, MICHAEL L &	7	251,977	1000	24,764	2,738.00	2013	2013-660058582	POUNDS, MICHAEL L &	7	236,810	1000	24,014	2,607.00
Tax Year	Statement Number	Billed Owner	Tax Area	Total Value	Exemptions	Taxable Value	Billed Tax																																																																																																																		
2025	2025-660058582	POUNDS, MICHAEL L &	7	354,227	1000	31,992	3,483.00																																																																																																																		
2024	2024-660058582	POUNDS, MICHAEL L &	7	508,159	1000	31,031	3,438.00																																																																																																																		
2023	2023-660058582	POUNDS, MICHAEL L &	7	287,253	1000	30,098	3,264.00																																																																																																																		
2022	2022-660058582	POUNDS, MICHAEL L &	7	290,798	1000	29,192	3,291.00																																																																																																																		
2021	2021-660058582	POUNDS, MICHAEL L &	7	266,483	1000	28,313	3,158.00																																																																																																																		
2020	2020-660058582	POUNDS, MICHAEL L &	7	264,661	1000	27,498	3,063.00																																																																																																																		
2019	2019-660058582	POUNDS, MICHAEL L &	7	251,531	1000	26,668	2,973.00																																																																																																																		
2018	2018-660058582	POUNDS, MICHAEL L &	7	258,847	1000	27,473	2,964.00																																																																																																																		
2017	2017-660058582	POUNDS, MICHAEL L &	7	256,595	1000	27,153	2,956.00																																																																																																																		
2016	2016-660058582	POUNDS, MICHAEL L &	7	249,991	1000	26,333	2,869.00																																																																																																																		
2015	2015-660058582	POUNDS, MICHAEL L &	7	243,304	1000	25,537	2,801.00																																																																																																																		
2014	2014-660058582	POUNDS, MICHAEL L &	7	251,977	1000	24,764	2,738.00																																																																																																																		
2013	2013-660058582	POUNDS, MICHAEL L &	7	236,810	1000	24,014	2,607.00																																																																																																																		



Rogers

Assessment Property Record Card for Tax Year 2026

Data provided by LISA DELOZIER County Assessor

Date 04/16/2026
Time 23:12:14
Page 2

Lot Data		Square-Foot - NBHD 1014 #1		Primary Image				
Lot Size								
Lot Count								
Units Buildable	1							
Non-Ag Acres	3.4131							
Topography								
Street Access								
Utilities								
Amenities	LAND QUALITY					0		
						0		
Method	Square-Foot							
Base Lot Value	148,674.00 x .56 = 82,779			\\tsclient\T\LOGAN\LOGAN RESIDENTIAL VI\2022-8-31\IMG_000! 9/2/2022				
Factor Value				GRM Approach				
Adjustments	1.0000			GRM Code				
Lot Value	82,779			Gross Rent 0.00				
Residential Data				Indicated Value				
Type	1 Single Family Residence			Multiple Regression				
Condition	3 - Average			MRA Code 1 Test				
Quality	3.5 - Average			Adusted R 0.8445				
Architecture	R1 Res Nbhd 1			Indicated Value 357,815 113.81 Per SqFt				
Style	100% 1 1/2 Story Finished			Direct Comparables				
Exterior Wall	30% Veneer, Masonry 70% Frame, Siding, Wood			Selection Model A Adam Test				
Base/Total Area	1,768 / 3,144			Adjustment Model 1 2022 Residential				
Style	100% 1 1/2 Story Finished			Comparables 2				
HVAC	100% Warmed & Cooled Air			Indicated Value 366,080 Per SqFt				
Roof Cover	1 Composition Shingle			Value Reconciliation				
Area on Slab	1,768			Selected Approach Cost Approach				
Fixture/RghIn	14 /			Improvements 277,944				
Bed/F/H Bath	3 / 2.5 /			Lot Value 82,779				
Basement Area				Indicated Value 360,723 114.73 Per SqFt				
Garage Type	484 Attached Garage - Unfinished			Agland Value				
Remodel				Site Improvements 3,315				
Year/Eff Age	1994 / 24			Total Value 364,038 115.79 Total Value Per SqFt				
Cost Approach				Manual : 01/2025				
Base Cost	91.48	Total Misc Impr	+ 13,132					
Roofing Adj	+ 3.10	Garage Cost	+ 19,389					
Subfloor Adj	+ -1.99	Total RCN	= 391,471					
Heat/Cool Adj	+ 14.47	Depreciation (29%)	- 113,527					
Plumbing Adj	+ 7.11	Lump Sums	+ 0					
Basement Adj	+ 0.00	RCNLD	= 277,944					
Adj Base Cost	= 114.17	Lot Value	+ 82,779					
Total Area	x 3,144	Indicated Value	= 360,723					
Adjusted Cost	= 358,950	Value Per SqFt	114.73					
Miscellaneous Improvements								
Code	Description	Sketch ID	Size	Year	Units	Unit Cost	Depr	Value
FPR1	FIREPLACE - RESIDENTIAL 1 STORY	0		1	1	6,429.63		6,430
PRCH	SLAB PORCH - COVERED	79517	18x5		90	29.24		2,632
PATO	SLAB PORCH - OPEN	79520	420		420	9.69		4,070



Rogers

Assessment Property Record Card for Tax Year 2026

Data provided by LISA DELOZIER County Assessor

Date 04/16/2026

Time 23:12:14

Page 3

Sketch Image

660058582

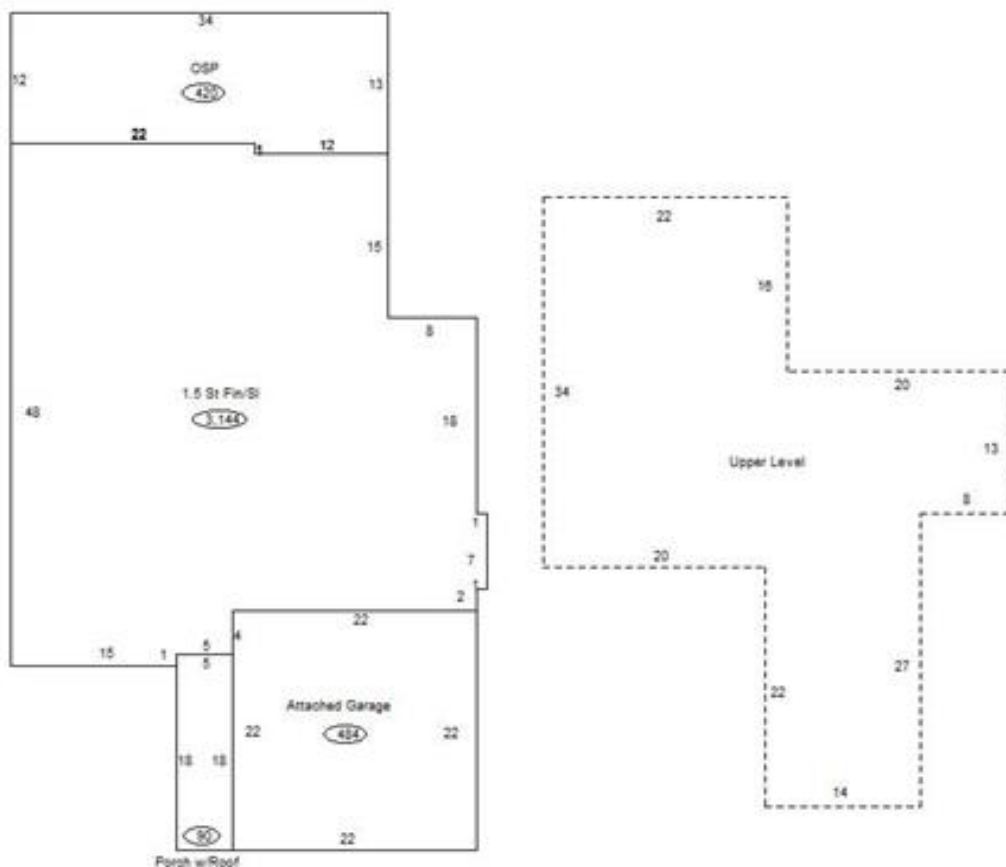

Sketch Vector Information

Sequence	Code	Type	Built Over	Scale	Section Label	Base Area	Multiplier	Total Area
1	G	1		13	Attached Garage	484	1.000	484
2	M	PRCH		13	SLBC	90	1.000	90
3	R	5	Slab	13	1.5 St Fin/SI	1,768	1.778	3,144
4	U	^UL		13	Upper Level	1,376	1.000	1,376
5	M	PATO		13	Open Slab	420	1.000	420
Total Building Area						1,768		3,144



Rogers



Assessment Property Record Card for Tax Year 2026

Data provided by LISA DELOZIER County Assessor

Date 04/16/2026
Time 23:12:14
Page 4

660058582

Outbuildings/Site Improvements

Building Image	Code	Description	Dimensions	Floor	Roofing	Total Units
	LF	LOAFING SHED	0x0x0			617
	Qual 3	Cond 3	Year	Eff Age		
	Valuation Summary		Modifier Total	RCN	Depr (20% Phys/ % Func)	RCNLD
	Base Cost (4.26 x 617)	2,628		2,628	526	2,102
	STF	STG FAIR	0x0x0			288
	Qual 2	Cond 3	Year	Eff Age		
	Valuation Summary		Modifier Total	RCN	Depr (10% Phys/ % Func)	RCNLD
	Base Cost (4.68 x 288)	1,348		1,348	135	1,213