



Rogers

Assessment Property Record Card for Tax Year 2026

Data provided by LISA DELOZIER County Assessor

Date 04/16/2026
Time 21:54:07
Page 1

Assessment Data					Primary Image																																																																																																																				
Account 660058588 Parcel ID 000000-00-0-00643-002-0004 Cadastral ID 13-21-14-03400 Property Type REAL - Real Property Property Class RRP VI Area 4 Tax Area 7 - OWASSO/LIMESTONE FIRE Name ID 338445 VASQUEZ, ESTEBAN & DALIA BADILLO 17934 E 104TH PL N OWASSO OK 74055-0000 Parcel Location Situs 17934 E 104 TH PL N Subdivision RANCH ACRES Lot/Block 0004 / 0002 Parcel Size 1 - Lots Sec/Twn/Rng 13 / 21 / 14 / 5 Neighborhood 1014 - R-V04-SW OWASSO School District S021 - OWASSO SCHOOLS																																																																																																																									
Legal Description Lot/Long: 36.30468822 -95.77369954																																																																																																																									
Building Permits					<table border="1"> <thead> <tr> <th>Number</th> <th>Description</th> <th>Opened</th> <th>Closed</th> <th>Amount</th> </tr> </thead> <tbody> <tr> <td>R18 000388</td> <td>R20-NEW 1400 SQ FT</td> <td>12/2018</td> <td>10/2019</td> <td>50,000</td> </tr> </tbody> </table>					Number	Description	Opened	Closed	Amount	R18 000388	R20-NEW 1400 SQ FT	12/2018	10/2019	50,000																																																																																																						
Number	Description	Opened	Closed	Amount																																																																																																																					
R18 000388	R20-NEW 1400 SQ FT	12/2018	10/2019	50,000																																																																																																																					
Exemptions					Sale History																																																																																																																				
<table border="1"> <thead> <tr> <th>Code</th> <th>Type</th> <th>Active</th> <th>Maximum</th> <th>Exemption</th> </tr> </thead> <tbody> <tr> <td>HV</td> <td>Veteran</td> <td>No</td> <td>999,999</td> <td></td> </tr> </tbody> </table>					Code	Type	Active	Maximum	Exemption	HV	Veteran	No	999,999		<table border="1"> <thead> <tr> <th>Bk/Pg</th> <th>Grantor</th> <th>Date</th> <th>Price</th> <th>Code</th> </tr> </thead> <tbody> <tr> <td>/</td> <td>THRAILKILL, MARY R</td> <td>05/18/2022</td> <td>330,000</td> <td>YES</td> </tr> <tr> <td>2678/447</td> <td>HOBBS, SUMMER</td> <td>11/29/2017</td> <td>166,000</td> <td>YES</td> </tr> <tr> <td>1746/368</td> <td>WILLIAMS, KATRINA E &</td> <td>01/20/2006</td> <td>134,000</td> <td>YES</td> </tr> <tr> <td>1629/86</td> <td>LEDBETTER, DAVID & STACEY</td> <td>10/13/2004</td> <td>123,000</td> <td>YES</td> </tr> <tr> <td>1016/839</td> <td>HOMES BY BETTY</td> <td>02/23/1996</td> <td>86,000</td> <td>No</td> </tr> <tr> <td>1005/828</td> <td>A&W LAND DEVELOPMENT INC</td> <td>10/24/1995</td> <td>0</td> <td>Yes</td> </tr> </tbody> </table>					Bk/Pg	Grantor	Date	Price	Code	/	THRAILKILL, MARY R	05/18/2022	330,000	YES	2678/447	HOBBS, SUMMER	11/29/2017	166,000	YES	1746/368	WILLIAMS, KATRINA E &	01/20/2006	134,000	YES	1629/86	LEDBETTER, DAVID & STACEY	10/13/2004	123,000	YES	1016/839	HOMES BY BETTY	02/23/1996	86,000	No	1005/828	A&W LAND DEVELOPMENT INC	10/24/1995	0	Yes																																																																			
Code	Type	Active	Maximum	Exemption																																																																																																																					
HV	Veteran	No	999,999																																																																																																																						
Bk/Pg	Grantor	Date	Price	Code																																																																																																																					
/	THRAILKILL, MARY R	05/18/2022	330,000	YES																																																																																																																					
2678/447	HOBBS, SUMMER	11/29/2017	166,000	YES																																																																																																																					
1746/368	WILLIAMS, KATRINA E &	01/20/2006	134,000	YES																																																																																																																					
1629/86	LEDBETTER, DAVID & STACEY	10/13/2004	123,000	YES																																																																																																																					
1016/839	HOMES BY BETTY	02/23/1996	86,000	No																																																																																																																					
1005/828	A&W LAND DEVELOPMENT INC	10/24/1995	0	Yes																																																																																																																					
Parcel Valuation																																																																																																																									
<table border="1"> <thead> <tr> <th>Source</th> <th>REAL</th> <th>Fair Cash</th> <th>Capped</th> <th>Asmnt Level</th> <th>Assessed</th> <th>Levy Rate</th> <th>108.538</th> <th>Current Tax</th> </tr> </thead> <tbody> <tr> <td>Remove Cap</td> <td>2023</td> <td>Land Value</td> <td>112,848</td> <td>112,848</td> <td>11%</td> <td>12,413</td> <td>Assessed</td> <td>36,690</td> <td>3,982.26</td> </tr> <tr> <td>Year Frozen</td> <td>0</td> <td>Improvements</td> <td>220,702</td> <td>220,702</td> <td></td> <td>24,277</td> <td>Penalty</td> <td>0</td> <td></td> </tr> <tr> <td>Uncapped Value</td> <td>0</td> <td>Mobile Home</td> <td>0</td> <td>0</td> <td></td> <td>0</td> <td>Exemption</td> <td>0</td> <td>0.00</td> </tr> <tr> <td>TIF Project ID</td> <td>0</td> <td>Total Value</td> <td>333,550</td> <td>333,550</td> <td></td> <td>36,690</td> <td>Total Taxable</td> <td>36,690</td> <td>3,982.00</td> </tr> </tbody> </table>		Source	REAL	Fair Cash	Capped	Asmnt Level	Assessed	Levy Rate	108.538	Current Tax	Remove Cap	2023	Land Value	112,848	112,848	11%	12,413	Assessed	36,690	3,982.26	Year Frozen	0	Improvements	220,702	220,702		24,277	Penalty	0		Uncapped Value	0	Mobile Home	0	0		0	Exemption	0	0.00	TIF Project ID	0	Total Value	333,550	333,550		36,690	Total Taxable	36,690	3,982.00																																																																							
Source	REAL	Fair Cash	Capped	Asmnt Level	Assessed	Levy Rate	108.538	Current Tax																																																																																																																	
Remove Cap	2023	Land Value	112,848	112,848	11%	12,413	Assessed	36,690	3,982.26																																																																																																																
Year Frozen	0	Improvements	220,702	220,702		24,277	Penalty	0																																																																																																																	
Uncapped Value	0	Mobile Home	0	0		0	Exemption	0	0.00																																																																																																																
TIF Project ID	0	Total Value	333,550	333,550		36,690	Total Taxable	36,690	3,982.00																																																																																																																
Assessment History																																																																																																																									
<table border="1"> <thead> <tr> <th>Tax Year</th> <th>Statement Number</th> <th>Billed Owner</th> <th>Tax Area</th> <th>Total Value</th> <th>Exemptions</th> <th>Taxable Value</th> <th>Billed Tax</th> </tr> </thead> <tbody> <tr><td>2025</td><td>2025-660058588</td><td>VASQUEZ, ESTEBAN &</td><td>7</td><td>330,000</td><td>0</td><td>36,300</td><td>3,940.00</td></tr> <tr><td>2024</td><td>2024-660058588</td><td>VASQUEZ, ESTEBAN &</td><td>7</td><td>330,000</td><td>0</td><td>36,300</td><td>4,005.00</td></tr> <tr><td>2023</td><td>2023-660058588</td><td>VASQUEZ, ESTEBAN &</td><td>7</td><td>330,000</td><td>0</td><td>36,300</td><td>3,920.00</td></tr> <tr><td>2022</td><td>2022-660058588</td><td>VASQUEZ, ESTEBAN &</td><td>7</td><td>234,508</td><td>23358</td><td></td><td>334.00</td></tr> <tr><td>2021</td><td>2021-660058588</td><td>THRAILKILL, MARY R</td><td>7</td><td>206,161</td><td>0</td><td></td><td>324.00</td></tr> <tr><td>2020</td><td>2020-660058588</td><td>THRAILKILL, MARY R</td><td>7</td><td>204,759</td><td>0</td><td>22,523</td><td>2,498.00</td></tr> <tr><td>2019</td><td>2019-660058588</td><td>THRAILKILL, MARY R</td><td>7</td><td>162,841</td><td>0</td><td>17,913</td><td>1,988.00</td></tr> <tr><td>2018</td><td>2018-660058588</td><td>THRAILKILL, MARY R</td><td>7</td><td>166,856</td><td>18354</td><td></td><td>262.00</td></tr> <tr><td>2017</td><td>2017-660058588</td><td>HOBBS, SUMMER</td><td>7</td><td>158,094</td><td>1000</td><td>16,390</td><td>1,790.00</td></tr> <tr><td>2016</td><td>2016-660058588</td><td>HOBBS, SUMMER</td><td>7</td><td>154,257</td><td>1000</td><td>15,968</td><td>1,745.00</td></tr> <tr><td>2015</td><td>2015-660058588</td><td>HOBBS, SUMMER</td><td>7</td><td>149,963</td><td>1000</td><td>15,496</td><td>1,705.00</td></tr> <tr><td>2014</td><td>2014-660058588</td><td>HOBBS, SUMMER</td><td>7</td><td>149,668</td><td>1000</td><td>15,033</td><td>1,668.00</td></tr> <tr><td>2013</td><td>2013-660058588</td><td>HOBBS, SUMMER</td><td>7</td><td>141,507</td><td>1000</td><td>14,566</td><td>1,587.00</td></tr> </tbody> </table>										Tax Year	Statement Number	Billed Owner	Tax Area	Total Value	Exemptions	Taxable Value	Billed Tax	2025	2025-660058588	VASQUEZ, ESTEBAN &	7	330,000	0	36,300	3,940.00	2024	2024-660058588	VASQUEZ, ESTEBAN &	7	330,000	0	36,300	4,005.00	2023	2023-660058588	VASQUEZ, ESTEBAN &	7	330,000	0	36,300	3,920.00	2022	2022-660058588	VASQUEZ, ESTEBAN &	7	234,508	23358		334.00	2021	2021-660058588	THRAILKILL, MARY R	7	206,161	0		324.00	2020	2020-660058588	THRAILKILL, MARY R	7	204,759	0	22,523	2,498.00	2019	2019-660058588	THRAILKILL, MARY R	7	162,841	0	17,913	1,988.00	2018	2018-660058588	THRAILKILL, MARY R	7	166,856	18354		262.00	2017	2017-660058588	HOBBS, SUMMER	7	158,094	1000	16,390	1,790.00	2016	2016-660058588	HOBBS, SUMMER	7	154,257	1000	15,968	1,745.00	2015	2015-660058588	HOBBS, SUMMER	7	149,963	1000	15,496	1,705.00	2014	2014-660058588	HOBBS, SUMMER	7	149,668	1000	15,033	1,668.00	2013	2013-660058588	HOBBS, SUMMER	7	141,507	1000	14,566	1,587.00
Tax Year	Statement Number	Billed Owner	Tax Area	Total Value	Exemptions	Taxable Value	Billed Tax																																																																																																																		
2025	2025-660058588	VASQUEZ, ESTEBAN &	7	330,000	0	36,300	3,940.00																																																																																																																		
2024	2024-660058588	VASQUEZ, ESTEBAN &	7	330,000	0	36,300	4,005.00																																																																																																																		
2023	2023-660058588	VASQUEZ, ESTEBAN &	7	330,000	0	36,300	3,920.00																																																																																																																		
2022	2022-660058588	VASQUEZ, ESTEBAN &	7	234,508	23358		334.00																																																																																																																		
2021	2021-660058588	THRAILKILL, MARY R	7	206,161	0		324.00																																																																																																																		
2020	2020-660058588	THRAILKILL, MARY R	7	204,759	0	22,523	2,498.00																																																																																																																		
2019	2019-660058588	THRAILKILL, MARY R	7	162,841	0	17,913	1,988.00																																																																																																																		
2018	2018-660058588	THRAILKILL, MARY R	7	166,856	18354		262.00																																																																																																																		
2017	2017-660058588	HOBBS, SUMMER	7	158,094	1000	16,390	1,790.00																																																																																																																		
2016	2016-660058588	HOBBS, SUMMER	7	154,257	1000	15,968	1,745.00																																																																																																																		
2015	2015-660058588	HOBBS, SUMMER	7	149,963	1000	15,496	1,705.00																																																																																																																		
2014	2014-660058588	HOBBS, SUMMER	7	149,668	1000	15,033	1,668.00																																																																																																																		
2013	2013-660058588	HOBBS, SUMMER	7	141,507	1000	14,566	1,587.00																																																																																																																		



Rogers

Assessment Property Record Card for Tax Year 2026

Data provided by LISA DELOZIER County Assessor

Date 04/16/2026
Time 21:54:07
Page 2

Lot Data		Square-Foot - NBHD 1014 #1	
Lot Size			
Lot Count			
Units Buildable	1		
Non-Ag Acres	0.9914		
Topography			
Street Access			
Utilities			
Amenities	LAND QUALITY	0	
		0	
Method	Square-Foot		
Base Lot Value	43,186.00 x 1.42 = 61,475		
Factor Value			
Adjustments	1.8357		
Lot Value	112,848		



\\tsclient\C\Users\eevans\Pictures\2019-10-11\IMG_0009.JPG 10/11/2019

Residential Data	
Type	1 Single Family Residence
Condition	3 - Average
Quality	3 - Average
Architecture	R1 Res Nbhd 1
Style	100% 1 1/2 Story Finished
Exterior Wall	80% Veneer, Masonry 20% Frame, Siding, Vinyl
Base/Total Area	1,292 / 1,938
Style	100% 1 1/2 Story Finished
HVAC	100% Warmed & Cooled Air
Roof Cover	1 Composition Shingle
Area on Slab	1,292
Fixture/RghIn	14 /
Bed/F/H Bath	3 / 2.0 / 1.0
Basement Area	
Garage Type	462 Attached Garage - Unfinished
Remodel	RMA -
Year/Eff Age	1996 / 15

GRM Approach

GRM Code	
Gross Rent	0.00
Indicated Value	

Multiple Regression

MRA Code	1 Test
Adusted R	0.8445
Indicated Value	227,493 117.39 Per SqFt

Direct Comparables

Selection Model	A Adam Test
Adjustment Model	1 2022 Residential
Comparables	2
Indicated Value	330,000 Per SqFt

Value Reconciliation

Selected Approach	Cost Approach
Improvements	220,702
Lot Value	112,848
Indicated Value	333,550 172.11 Per SqFt
Agland Value	
Site Improvements	
Total Value	333,550 172.11 Total Value Per SqFt

Cost Approach Manual : 01/2025

Base Cost	97.47	Total Misc Impr	+	11,308
Roofing Adj	+ 3.43	Garage Cost	+	15,015
Subfloor Adj	+ -1.62	Total RCN	=	262,740
Heat/Cool Adj	+ 12.64	Depreciation (16%)	-	42,038
Plumbing Adj	+ 10.07	Lump Sums	+	0
Basement Adj	+ 0.00	RCNLD	=	220,702
Adj Base Cost	= 121.99	Lot Value	+	112,848
Total Area	x 1,938	Indicated Value	=	333,550
Adjusted Cost	= 236,417	Value Per SqFt		172.11

Miscellaneous Improvements

Code	Description	Sketch ID	Size	Year	Units	Unit Cost	Depr	Value
PRCH	SLAB PORCH - COVERED	79549	19x4		76	26.69		2,028
PRCH	SLAB PORCH - COVERED	79552	8x5		40	26.80		1,072
PATO	SLAB PORCH - OPEN	121774	18x6		108	11.40		1,231
PRCH	SLAB PORCH - COVERED	143400	9x5		45	26.79		1,206
PATO	SLAB PORCH - OPEN	143401	671		671	8.60		5,771



Rogers
Assessment Property Record Card for Tax Year 2026

Data provided by LISA DELOZIER County Assessor

Date 04/16/2026
 Time 21:54:07
 Page 3

Sketch Image

660058588

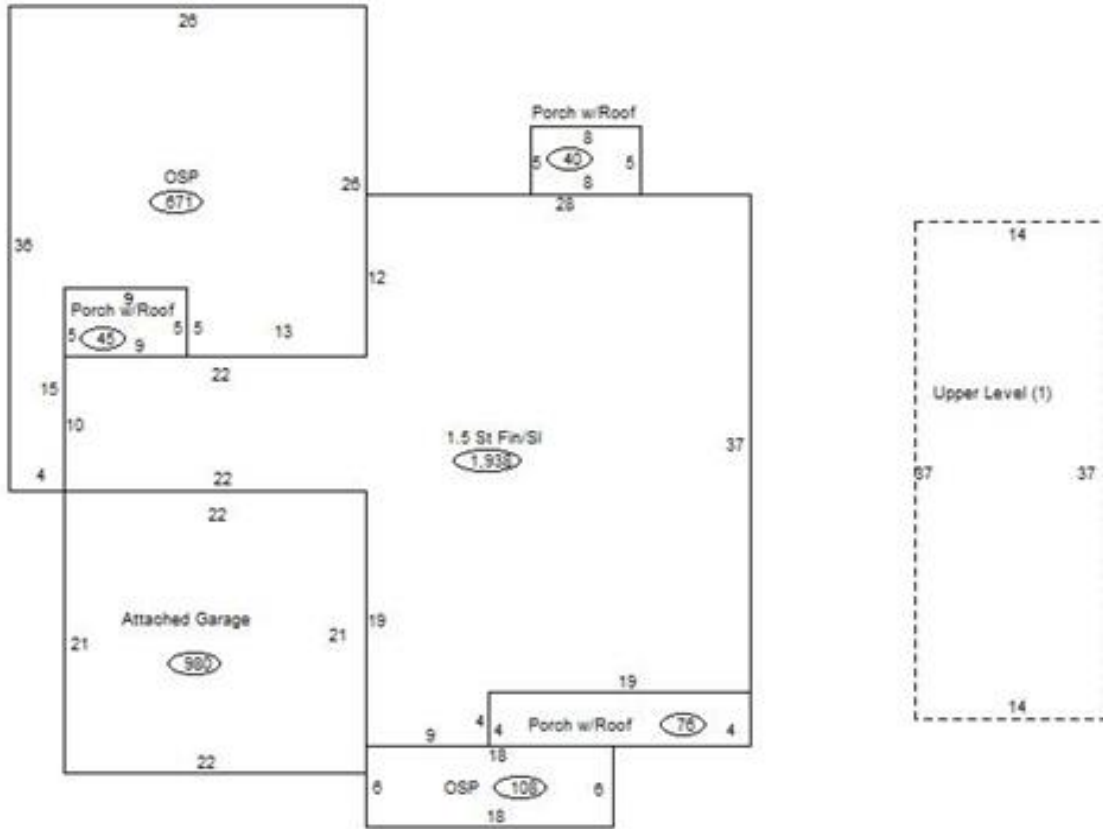

Sketch Vector Information

Sequence	Code	Type	Built Over	Scale	Section Label	Base Area	Multiplier	Total Area
1	G	1		13	Attached Garage	462	1.000	462
2	M	PRCH		13	SLBC	76	1.000	76
3	U	^UL		13	Upper Level (1)	518	1.000	518
4	R	5	Slab	13	1.5 St Fin/Sl	1,292	1.500	1,938
5	M	PRCH		13	SLBC	40	1.000	40
6	M	PATO		13	Open Slab	108	1.000	108
7	M	PRCH		13	SLBC	45	1.000	45
8	M	PATO		13	Open Slab	671	1.000	671
Total Building Area						1,292		1,938



Rogers

Assessment Property Record Card for Tax Year 2026

Data provided by LISA DELOZIER County Assessor

Date 04/16/2026
 Time 21:54:07
 Page 4

660058588

Outbuildings/Site Improvements

Building Image	Code	Description	Dimensions	Floor	Roofing	Total Units
	STF	STG FAIR	10x12x0			120
	Qual	2	Cond 2	Year	Eff Age 2026	
		Valuation Summary	Modifier Total	RCN	Depr (100% Phys/ % Func)	RCNLD
		Base Cost (4.68 x 120)	562		562	562