



# Rogers

## Assessment Property Record Card for Tax Year 2026

Data provided by LISA DELOZIER County Assessor

Date 04/16/2026  
Time 23:12:26  
Page 1

Assessment Data					Primary Image																																																																																																																				
<b>Account</b> 660058597 <b>Parcel ID</b> 000000-00-0-00643-003-0003 <b>Cadastral ID</b> 13-21-14-03470 <b>Property Type</b> REAL - Real Property <b>Property Class</b> RRP VI Area 4 <b>Tax Area</b> 7 - OWASSO/LIMESTONE FIRE <b>Name ID</b> 263325 SIMPSON, MICHAEL W & DEBORAH E-CO-TRUSTEES  17866 E 103RD PL N OWASSO OK 74055-0000  <b>Parcel Location</b> <b>Situs</b> 17866 E 103RD PL N <b>Subdivision</b> RANCH ACRES <b>Lot/Block</b> 0003 / 0003 <b>Parcel Size</b> 1 - Lots <b>Sec/Twn/Rng</b> 13 / 21 / 14 / 5 <b>Neighborhood</b> 1014 - R-V04-SW OWASSO <b>School District</b> S021 - OWASSO SCHOOLS																																																																																																																									
<b>Legal Description</b> Lot/Long: 36.30342605 -95.77444688																																																																																																																									
<b>Building Permits</b>					<table border="1"> <thead> <tr> <th>Number</th> <th>Description</th> <th>Opened</th> <th>Closed</th> <th>Amount</th> </tr> </thead> <tbody> <tr> <td colspan="5"> </td> </tr> </tbody> </table>					Number	Description	Opened	Closed	Amount																																																																																																											
Number	Description	Opened	Closed	Amount																																																																																																																					
<b>Exemptions</b>					<b>Sale History</b>																																																																																																																				
<table border="1"> <thead> <tr> <th>Code</th> <th>Type</th> <th>Active</th> <th>Maximum</th> <th>Exemption</th> </tr> </thead> <tbody> <tr> <td>H</td> <td>Homestead</td> <td>Yes</td> <td>1,000</td> <td>1,000</td> </tr> </tbody> </table>					Code	Type	Active	Maximum	Exemption	H	Homestead	Yes	1,000	1,000	<table border="1"> <thead> <tr> <th>Bk/Pg</th> <th>Grantor</th> <th>Date</th> <th>Price</th> <th>Code</th> </tr> </thead> <tbody> <tr> <td>/</td> <td>SIMPSON, MICHAEL W &amp;</td> <td>09/06/2018</td> <td>0</td> <td>4</td> </tr> <tr> <td>1026/866</td> <td>HOMES BY BETTY</td> <td>05/20/1996</td> <td>93,000</td> <td>Yes</td> </tr> <tr> <td>1019/735</td> <td>A&amp;W LAND DEVELOPMENT INC</td> <td>03/19/1996</td> <td>15,000</td> <td>Yes</td> </tr> </tbody> </table>					Bk/Pg	Grantor	Date	Price	Code	/	SIMPSON, MICHAEL W &	09/06/2018	0	4	1026/866	HOMES BY BETTY	05/20/1996	93,000	Yes	1019/735	A&W LAND DEVELOPMENT INC	03/19/1996	15,000	Yes																																																																																		
Code	Type	Active	Maximum	Exemption																																																																																																																					
H	Homestead	Yes	1,000	1,000																																																																																																																					
Bk/Pg	Grantor	Date	Price	Code																																																																																																																					
/	SIMPSON, MICHAEL W &	09/06/2018	0	4																																																																																																																					
1026/866	HOMES BY BETTY	05/20/1996	93,000	Yes																																																																																																																					
1019/735	A&W LAND DEVELOPMENT INC	03/19/1996	15,000	Yes																																																																																																																					
<b>Parcel Valuation</b>																																																																																																																									
<table border="1"> <thead> <tr> <th>Source</th> <th>REAL</th> <th>Fair Cash</th> <th>Capped</th> <th>Asmnt Level</th> <th>Assessed</th> <th>Levy Rate</th> <th>108.538</th> <th>Current Tax</th> </tr> </thead> <tbody> <tr> <td>Remove Cap</td> <td>0</td> <td>Land Value 61,534</td> <td>35,690</td> <td>11%</td> <td>3,926</td> <td>Assessed</td> <td>22,074</td> <td>2,395.87</td> </tr> <tr> <td>Year Frozen</td> <td>0</td> <td>Improvements 173,756</td> <td>164,979</td> <td></td> <td>18,148</td> <td>Penalty</td> <td>0</td> <td></td> </tr> <tr> <td>Uncapped Value</td> <td>0</td> <td>Mobile Home 0</td> <td>0</td> <td></td> <td>0</td> <td>Exemption</td> <td>1,000</td> <td>-98.00</td> </tr> <tr> <td>TIF Project ID</td> <td>0</td> <td>Total Value 235,290</td> <td>200,669</td> <td></td> <td>22,074</td> <td>Total Taxable</td> <td>21,074</td> <td>2,298.00</td> </tr> </tbody> </table>		Source	REAL	Fair Cash	Capped	Asmnt Level	Assessed	Levy Rate	108.538	Current Tax	Remove Cap	0	Land Value 61,534	35,690	11%	3,926	Assessed	22,074	2,395.87	Year Frozen	0	Improvements 173,756	164,979		18,148	Penalty	0		Uncapped Value	0	Mobile Home 0	0		0	Exemption	1,000	-98.00	TIF Project ID	0	Total Value 235,290	200,669		22,074	Total Taxable	21,074	2,298.00																																																																											
Source	REAL	Fair Cash	Capped	Asmnt Level	Assessed	Levy Rate	108.538	Current Tax																																																																																																																	
Remove Cap	0	Land Value 61,534	35,690	11%	3,926	Assessed	22,074	2,395.87																																																																																																																	
Year Frozen	0	Improvements 173,756	164,979		18,148	Penalty	0																																																																																																																		
Uncapped Value	0	Mobile Home 0	0		0	Exemption	1,000	-98.00																																																																																																																	
TIF Project ID	0	Total Value 235,290	200,669		22,074	Total Taxable	21,074	2,298.00																																																																																																																	
<b>Assessment History</b>																																																																																																																									
<table border="1"> <thead> <tr> <th>Tax Year</th> <th>Statement Number</th> <th>Billed Owner</th> <th>Tax Area</th> <th>Total Value</th> <th>Exemptions</th> <th>Taxable Value</th> <th>Billed Tax</th> </tr> </thead> <tbody> <tr><td>2025</td><td>2025-660058597</td><td>SIMPSON, MICHAEL W &amp;</td><td>7</td><td>233,391</td><td>1000</td><td>20,431</td><td>2,228.00</td></tr> <tr><td>2024</td><td>2024-660058597</td><td>SIMPSON, MICHAEL W &amp;</td><td>7</td><td>275,065</td><td>1000</td><td>19,807</td><td>2,200.00</td></tr> <tr><td>2023</td><td>2023-660058597</td><td>SIMPSON, MICHAEL W &amp;</td><td>7</td><td>186,284</td><td>1000</td><td>19,201</td><td>2,087.00</td></tr> <tr><td>2022</td><td>2022-660058597</td><td>SIMPSON, MICHAEL W &amp;</td><td>7</td><td>186,333</td><td>1000</td><td>18,612</td><td>2,103.00</td></tr> <tr><td>2021</td><td>2021-660058597</td><td>SIMPSON, MICHAEL W &amp;</td><td>7</td><td>173,101</td><td>1000</td><td>18,041</td><td>2,017.00</td></tr> <tr><td>2020</td><td>2020-660058597</td><td>SIMPSON, MICHAEL W &amp;</td><td>7</td><td>172,022</td><td>1000</td><td>17,570</td><td>1,962.00</td></tr> <tr><td>2019</td><td>2019-660058597</td><td>SIMPSON, MICHAEL W &amp;</td><td>7</td><td>163,902</td><td>1000</td><td>17,029</td><td>1,903.00</td></tr> <tr><td>2018</td><td>2018-660058597</td><td>SIMPSON, MICHAEL W &amp;</td><td>7</td><td>168,348</td><td>1000</td><td>16,583</td><td>1,795.00</td></tr> <tr><td>2017</td><td>2017-660058597</td><td>SIMPSON, MICHAEL W &amp;</td><td>7</td><td>167,028</td><td>1000</td><td>16,070</td><td>1,756.00</td></tr> <tr><td>2016</td><td>2016-660058597</td><td>SIMPSON, MICHAEL W &amp;</td><td>7</td><td>162,945</td><td>1000</td><td>15,574</td><td>1,703.00</td></tr> <tr><td>2015</td><td>2015-660058597</td><td>SIMPSON, MICHAEL W &amp;</td><td>7</td><td>158,060</td><td>1000</td><td>15,091</td><td>1,661.00</td></tr> <tr><td>2014</td><td>2014-660058597</td><td>SIMPSON, MICHAEL W &amp;</td><td>7</td><td>160,697</td><td>1000</td><td>14,623</td><td>1,623.00</td></tr> <tr><td>2013</td><td>2013-660058597</td><td>SIMPSON, MICHAEL W &amp;</td><td>7</td><td>151,559</td><td>1000</td><td>14,168</td><td>1,544.00</td></tr> </tbody> </table>										Tax Year	Statement Number	Billed Owner	Tax Area	Total Value	Exemptions	Taxable Value	Billed Tax	2025	2025-660058597	SIMPSON, MICHAEL W &	7	233,391	1000	20,431	2,228.00	2024	2024-660058597	SIMPSON, MICHAEL W &	7	275,065	1000	19,807	2,200.00	2023	2023-660058597	SIMPSON, MICHAEL W &	7	186,284	1000	19,201	2,087.00	2022	2022-660058597	SIMPSON, MICHAEL W &	7	186,333	1000	18,612	2,103.00	2021	2021-660058597	SIMPSON, MICHAEL W &	7	173,101	1000	18,041	2,017.00	2020	2020-660058597	SIMPSON, MICHAEL W &	7	172,022	1000	17,570	1,962.00	2019	2019-660058597	SIMPSON, MICHAEL W &	7	163,902	1000	17,029	1,903.00	2018	2018-660058597	SIMPSON, MICHAEL W &	7	168,348	1000	16,583	1,795.00	2017	2017-660058597	SIMPSON, MICHAEL W &	7	167,028	1000	16,070	1,756.00	2016	2016-660058597	SIMPSON, MICHAEL W &	7	162,945	1000	15,574	1,703.00	2015	2015-660058597	SIMPSON, MICHAEL W &	7	158,060	1000	15,091	1,661.00	2014	2014-660058597	SIMPSON, MICHAEL W &	7	160,697	1000	14,623	1,623.00	2013	2013-660058597	SIMPSON, MICHAEL W &	7	151,559	1000	14,168	1,544.00
Tax Year	Statement Number	Billed Owner	Tax Area	Total Value	Exemptions	Taxable Value	Billed Tax																																																																																																																		
2025	2025-660058597	SIMPSON, MICHAEL W &	7	233,391	1000	20,431	2,228.00																																																																																																																		
2024	2024-660058597	SIMPSON, MICHAEL W &	7	275,065	1000	19,807	2,200.00																																																																																																																		
2023	2023-660058597	SIMPSON, MICHAEL W &	7	186,284	1000	19,201	2,087.00																																																																																																																		
2022	2022-660058597	SIMPSON, MICHAEL W &	7	186,333	1000	18,612	2,103.00																																																																																																																		
2021	2021-660058597	SIMPSON, MICHAEL W &	7	173,101	1000	18,041	2,017.00																																																																																																																		
2020	2020-660058597	SIMPSON, MICHAEL W &	7	172,022	1000	17,570	1,962.00																																																																																																																		
2019	2019-660058597	SIMPSON, MICHAEL W &	7	163,902	1000	17,029	1,903.00																																																																																																																		
2018	2018-660058597	SIMPSON, MICHAEL W &	7	168,348	1000	16,583	1,795.00																																																																																																																		
2017	2017-660058597	SIMPSON, MICHAEL W &	7	167,028	1000	16,070	1,756.00																																																																																																																		
2016	2016-660058597	SIMPSON, MICHAEL W &	7	162,945	1000	15,574	1,703.00																																																																																																																		
2015	2015-660058597	SIMPSON, MICHAEL W &	7	158,060	1000	15,091	1,661.00																																																																																																																		
2014	2014-660058597	SIMPSON, MICHAEL W &	7	160,697	1000	14,623	1,623.00																																																																																																																		
2013	2013-660058597	SIMPSON, MICHAEL W &	7	151,559	1000	14,168	1,544.00																																																																																																																		



# Rogers

## Assessment Property Record Card for Tax Year 2026

Data provided by LISA DELOZIER County Assessor

Date 04/16/2026  
Time 23:12:26  
Page 2

Lot Data	Square-Foot - NBHD 1014 #1	Primary Image
<b>Lot Size</b> <b>Lot Count</b> <b>Units Buildable</b> 1 <b>Non-Ag Acres</b> 0.9932 <b>Topography</b> <b>Street Access</b> <b>Utilities</b> <b>Amenities</b> LAND QUALITY 0 0 <b>Method</b> Square-Foot <b>Base Lot Value</b> 43,264.00 x 1.42 = 61,534 <b>Factor Value</b> <b>Adjustments</b> 1.0000 <b>Lot Value</b> 61,534		

Residential Data	
<b>Type</b>	1 Single Family Residence
<b>Condition</b>	3 - Average
<b>Quality</b>	3 - Average
<b>Architecture</b>	R1 Res Nbhd 1
<b>Style</b>	100% One Story
<b>Exterior Wall</b>	100% Veneer, Masonry
<b>Base/Total Area</b>	1,652 / 1,652
<b>Style</b>	100% One Story
<b>HVAC</b>	100% Warmed & Cooled Air
<b>Roof Cover</b>	1 Composition Shingle
<b>Area on Slab</b>	1,652
<b>Fixture/RghIn</b>	11 /
<b>Bed/F/H Bath</b>	3 / 2.0 /
<b>Basement Area</b>	
<b>Garage Type</b>	400 Attached Garage - Unfinished
<b>Remodel</b>	
<b>Year/Eff Age</b>	1996 / 23



\\tsclient\C\TOMS PC PICS\2018-05-15 05-15-2018\05-15-2018 06 5/16/2018

GRM Approach	
<b>GRM Code</b>	
<b>Gross Rent</b>	0.00
<b>Indicated Value</b>	

Multiple Regression			
<b>MRA Code</b>	1	Test	
<b>Adusted R</b>	0.8445		
<b>Indicated Value</b>	200,898	121.61	Per SqFt

Direct Comparables	
<b>Selection Model</b>	A Adam Test
<b>Adjustment Model</b>	1 2022 Residential
<b>Comparables</b>	8
<b>Indicated Value</b>	258,160 Per SqFt

Cost Approach				Manual : 01/2025	
<b>Base Cost</b>	111.84	<b>Total Misc Impr</b>	+	2,345	
<b>Roofing Adj</b>	+ 4.88	<b>Garage Cost</b>	+	13,584	
<b>Subfloor Adj</b>	+ -2.31	<b>Total RCN</b>	=	241,328	
<b>Heat/Cool Adj</b>	+ 12.64	<b>Depreciation ( 28%)</b>	-	67,572	
<b>Plumbing Adj</b>	+ 9.39	<b>Lump Sums</b>	+	0	
<b>Basement Adj</b>	+ 0.00	<b>RCNLD</b>	=	173,756	
<b>Adj Base Cost</b>	= 136.44	<b>Lot Value</b>	+	61,534	
<b>Total Area</b>	x 1,652	<b>Indicated Value</b>	=	235,290	
<b>Adjusted Cost</b>	= 225,399	<b>Value Per SqFt</b>		142.43	

Value Reconciliation			
<b>Selected Approach</b>	Cost Approach		
<b>Improvements</b>	173,756		
<b>Lot Value</b>	61,534		
<b>Indicated Value</b>	235,290	142.43	Per SqFt
<b>Agland Value</b>			
<b>Site Improvements</b>			
<b>Total Value</b>	235,290	142.43	Total Value Per SqFt

Miscellaneous Improvements								
Code	Description	Sketch ID	Size	Year	Units	Unit Cost	Depr	Value
PRCH	SLAB PORCH - COVERED	79581	8x5		40	26.80		1,072
PATO	SLAB PORCH - OPEN	79582	112		112	11.37		1,273



**Rogers**  
**Assessment Property Record Card for Tax Year 2026**

Data provided by LISA DELOZIER County Assessor

Date 04/16/2026  
 Time 23:12:26  
 Page 3

Sketch Image

660058597

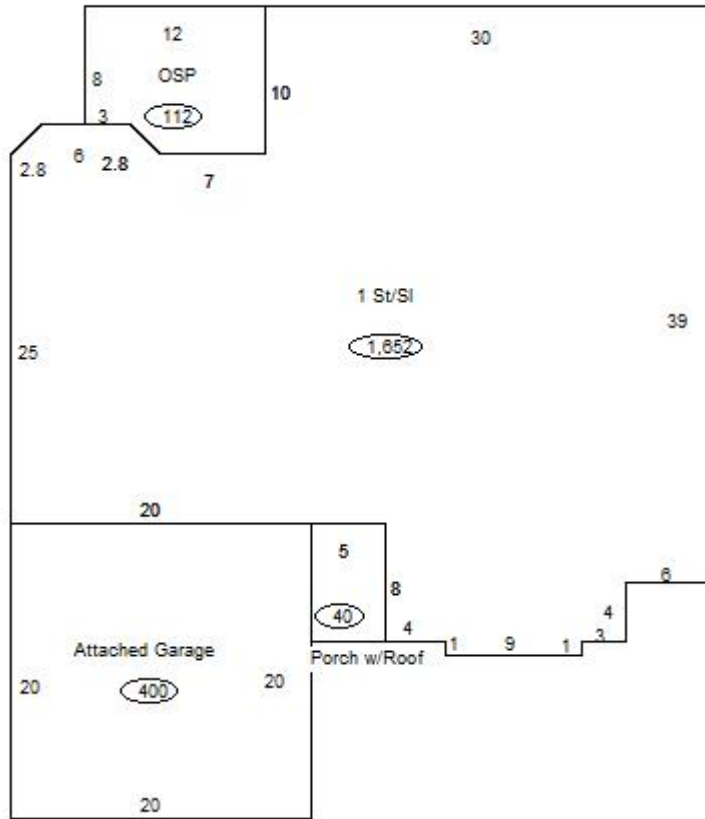

**Sketch Vector Information**

Sequence	Code	Type	Built Over	Scale	Section Label	Base Area	Multiplier	Total Area
1	R	1	Slab	13	1 St/Sl	1,652	1.000	1,652
2	G	1		13	Attached Garage	400	1.000	400
3	M	PRCH		13	SLBC	40	1.000	40
4	M	PATO		13	Open Slab	112	1.000	112
<b>Total Building Area</b>						1,652		1,652