



# Rogers

## Assessment Property Record Card for Tax Year 2026

Data provided by LISA DELOZIER County Assessor

Date 04/17/2026  
Time 09:45:20  
Page 1

Assessment Data					Primary Image																																																																																																																				
<b>Account</b> 660060248 <b>Parcel ID</b> 24N17E-34-1-00000-000-0000 <b>Cadastral ID</b> 34-24-17-00110 <b>Property Type</b> REAL - Real Property <b>Property Class</b> RA VI Area 2 <b>Tax Area</b> 14 - CHELSEA RURAL <b>Name ID</b> 343972 CHAMBERLAIN, MICHAEL G & VICKIE L  15403 E 83RD ST N OWASSO OK 74055-0000  <b>Parcel Location</b> <b>Situs</b> 06200 S 4230 RD <b>Subdivision</b> <b>Lot/Block</b> / <b>Parcel Size</b> 30 - Acres <b>Sec/Twn/Rng</b> 34 / 24 / 17 / 1 <b>Neighborhood</b> 4050 - CHELSEA FOYIL RURAL <b>School District</b> S003 - CHELSEA SCHOOLS																																																																																																																									
<b>Legal Description</b> Lat/Long: 36.52323379 -95.47340587																																																																																																																									
<b>E2 NE NE &amp; NW NE NE</b>					<b>Building Permits</b> <table border="1"> <thead> <tr> <th>Number</th> <th>Description</th> <th>Opened</th> <th>Closed</th> <th>Amount</th> </tr> </thead> <tbody> <tr> <td colspan="5" style="height: 100px;"> </td> </tr> </tbody> </table>					Number	Description	Opened	Closed	Amount																																																																																																											
Number	Description	Opened	Closed	Amount																																																																																																																					
<b>Exemptions</b> <table border="1"> <thead> <tr> <th>Code</th> <th>Type</th> <th>Active</th> <th>Maximum</th> <th>Exemption</th> </tr> </thead> <tbody> <tr> <td>H</td> <td>Homestead</td> <td>No</td> <td>1,000</td> <td></td> </tr> </tbody> </table>					Code	Type	Active	Maximum	Exemption	H	Homestead	No	1,000		<b>Sale History</b> <table border="1"> <thead> <tr> <th>Bk/Pg</th> <th>Grantor</th> <th>Date</th> <th>Price</th> <th>Code</th> </tr> </thead> <tbody> <tr> <td>/</td> <td>EVENSON, LYNDA L</td> <td>03/27/2024</td> <td>371,000</td> <td>21</td> </tr> <tr> <td>1090/218</td> <td>LARIMORE, DON G &amp; CAROLYN</td> <td>11/25/1997</td> <td>127,500</td> <td>Yes</td> </tr> <tr> <td>975/838</td> <td>PODPECHAN, FRANK TRUSTEE</td> <td>12/07/1994</td> <td>25,500</td> <td>Yes</td> </tr> </tbody> </table>					Bk/Pg	Grantor	Date	Price	Code	/	EVENSON, LYNDA L	03/27/2024	371,000	21	1090/218	LARIMORE, DON G & CAROLYN	11/25/1997	127,500	Yes	975/838	PODPECHAN, FRANK TRUSTEE	12/07/1994	25,500	Yes																																																																																		
Code	Type	Active	Maximum	Exemption																																																																																																																					
H	Homestead	No	1,000																																																																																																																						
Bk/Pg	Grantor	Date	Price	Code																																																																																																																					
/	EVENSON, LYNDA L	03/27/2024	371,000	21																																																																																																																					
1090/218	LARIMORE, DON G & CAROLYN	11/25/1997	127,500	Yes																																																																																																																					
975/838	PODPECHAN, FRANK TRUSTEE	12/07/1994	25,500	Yes																																																																																																																					
<b>Parcel Valuation</b> <table border="1"> <thead> <tr> <th>Source</th> <th>REAL</th> <th>Fair Cash</th> <th>Capped</th> <th>Asmnt Level</th> <th>Assessed</th> <th>Levy Rate</th> <th>82.750</th> <th>Current Tax</th> </tr> </thead> <tbody> <tr> <td>Remove Cap</td> <td>2025</td> <td>Land Value 4,234</td> <td>4,234</td> <td>11%</td> <td>466</td> <td>Assessed</td> <td>27,318</td> <td>2,260.56</td> </tr> <tr> <td>Year Frozen</td> <td>2017</td> <td>Improvements 256,719</td> <td>244,108</td> <td></td> <td>26,852</td> <td>Penalty</td> <td>0</td> <td></td> </tr> <tr> <td>Uncapped Value</td> <td>0</td> <td>Mobile Home 0</td> <td>0</td> <td></td> <td>0</td> <td>Exemption</td> <td>0</td> <td>0.00</td> </tr> <tr> <td>TIF Project ID</td> <td>0</td> <td>Total Value 260,953</td> <td>248,342</td> <td></td> <td>27,318</td> <td>Total Taxable</td> <td>27,318</td> <td>2,261.00</td> </tr> </tbody> </table>										Source	REAL	Fair Cash	Capped	Asmnt Level	Assessed	Levy Rate	82.750	Current Tax	Remove Cap	2025	Land Value 4,234	4,234	11%	466	Assessed	27,318	2,260.56	Year Frozen	2017	Improvements 256,719	244,108		26,852	Penalty	0		Uncapped Value	0	Mobile Home 0	0		0	Exemption	0	0.00	TIF Project ID	0	Total Value 260,953	248,342		27,318	Total Taxable	27,318	2,261.00																																																																			
Source	REAL	Fair Cash	Capped	Asmnt Level	Assessed	Levy Rate	82.750	Current Tax																																																																																																																	
Remove Cap	2025	Land Value 4,234	4,234	11%	466	Assessed	27,318	2,260.56																																																																																																																	
Year Frozen	2017	Improvements 256,719	244,108		26,852	Penalty	0																																																																																																																		
Uncapped Value	0	Mobile Home 0	0		0	Exemption	0	0.00																																																																																																																	
TIF Project ID	0	Total Value 260,953	248,342		27,318	Total Taxable	27,318	2,261.00																																																																																																																	
<b>Assessment History</b> <table border="1"> <thead> <tr> <th>Tax Year</th> <th>Statement Number</th> <th>Billed Owner</th> <th>Tax Area</th> <th>Total Value</th> <th>Exemptions</th> <th>Taxable Value</th> <th>Billed Tax</th> </tr> </thead> <tbody> <tr><td>2025</td><td>2025-660060248</td><td>CHAMBERLAIN, MICHAEL G &amp;</td><td>14</td><td>241,109</td><td>0</td><td>26,522</td><td>2,195.00</td></tr> <tr><td>2024</td><td>2024-660060248</td><td>CHAMBERLAIN, MICHAEL G &amp;</td><td>14</td><td>163,986</td><td>1000</td><td>12,683</td><td>1,070.00</td></tr> <tr><td>2023</td><td>2023-660060248</td><td>EVENSON, JAMES DELBERT &amp;</td><td>14</td><td>139,148</td><td>1000</td><td>12,684</td><td>1,081.00</td></tr> <tr><td>2022</td><td>2022-660060248</td><td>EVENSON, JAMES DELBERT &amp;</td><td>14</td><td>142,538</td><td>1000</td><td>12,684</td><td>1,073.00</td></tr> <tr><td>2021</td><td>2021-660060248</td><td>EVENSON, JAMES DELBERT &amp;</td><td>14</td><td>139,421</td><td>1000</td><td>12,685</td><td>1,075.00</td></tr> <tr><td>2020</td><td>2020-660060248</td><td>EVENSON, JAMES DELBERT &amp;</td><td>14</td><td>136,836</td><td>1000</td><td>12,684</td><td>1,076.00</td></tr> <tr><td>2019</td><td>2019-660060248</td><td>EVENSON, JAMES DELBERT &amp;</td><td>14</td><td>134,341</td><td>1000</td><td>12,684</td><td>1,089.00</td></tr> <tr><td>2018</td><td>2018-660060248</td><td>EVENSON, JAMES DELBERT &amp;</td><td>14</td><td>138,976</td><td>1000</td><td>12,684</td><td>1,083.00</td></tr> <tr><td>2017</td><td>2017-660060248</td><td>EVENSON, JAMES DELBERT &amp;</td><td>14</td><td>137,526</td><td>1000</td><td>12,685</td><td>1,088.00</td></tr> <tr><td>2016</td><td>2016-660060248</td><td>EVENSON, JAMES DELBERT &amp;</td><td>14</td><td>131,790</td><td>1000</td><td>12,286</td><td>1,071.00</td></tr> <tr><td>2015</td><td>2015-660060248</td><td>EVENSON, JAMES DELBERT &amp;</td><td>14</td><td>128,339</td><td>1000</td><td>11,898</td><td>1,025.00</td></tr> <tr><td>2014</td><td>2014-660060248</td><td>EVENSON, JAMES DELBERT &amp;</td><td>14</td><td>129,493</td><td>1000</td><td>11,523</td><td>1,026.00</td></tr> <tr><td>2013</td><td>2013-660060248</td><td>EVENSON, JAMES DELBERT &amp;</td><td>14</td><td>121,639</td><td>1000</td><td>11,158</td><td>990.00</td></tr> </tbody> </table>										Tax Year	Statement Number	Billed Owner	Tax Area	Total Value	Exemptions	Taxable Value	Billed Tax	2025	2025-660060248	CHAMBERLAIN, MICHAEL G &	14	241,109	0	26,522	2,195.00	2024	2024-660060248	CHAMBERLAIN, MICHAEL G &	14	163,986	1000	12,683	1,070.00	2023	2023-660060248	EVENSON, JAMES DELBERT &	14	139,148	1000	12,684	1,081.00	2022	2022-660060248	EVENSON, JAMES DELBERT &	14	142,538	1000	12,684	1,073.00	2021	2021-660060248	EVENSON, JAMES DELBERT &	14	139,421	1000	12,685	1,075.00	2020	2020-660060248	EVENSON, JAMES DELBERT &	14	136,836	1000	12,684	1,076.00	2019	2019-660060248	EVENSON, JAMES DELBERT &	14	134,341	1000	12,684	1,089.00	2018	2018-660060248	EVENSON, JAMES DELBERT &	14	138,976	1000	12,684	1,083.00	2017	2017-660060248	EVENSON, JAMES DELBERT &	14	137,526	1000	12,685	1,088.00	2016	2016-660060248	EVENSON, JAMES DELBERT &	14	131,790	1000	12,286	1,071.00	2015	2015-660060248	EVENSON, JAMES DELBERT &	14	128,339	1000	11,898	1,025.00	2014	2014-660060248	EVENSON, JAMES DELBERT &	14	129,493	1000	11,523	1,026.00	2013	2013-660060248	EVENSON, JAMES DELBERT &	14	121,639	1000	11,158	990.00
Tax Year	Statement Number	Billed Owner	Tax Area	Total Value	Exemptions	Taxable Value	Billed Tax																																																																																																																		
2025	2025-660060248	CHAMBERLAIN, MICHAEL G &	14	241,109	0	26,522	2,195.00																																																																																																																		
2024	2024-660060248	CHAMBERLAIN, MICHAEL G &	14	163,986	1000	12,683	1,070.00																																																																																																																		
2023	2023-660060248	EVENSON, JAMES DELBERT &	14	139,148	1000	12,684	1,081.00																																																																																																																		
2022	2022-660060248	EVENSON, JAMES DELBERT &	14	142,538	1000	12,684	1,073.00																																																																																																																		
2021	2021-660060248	EVENSON, JAMES DELBERT &	14	139,421	1000	12,685	1,075.00																																																																																																																		
2020	2020-660060248	EVENSON, JAMES DELBERT &	14	136,836	1000	12,684	1,076.00																																																																																																																		
2019	2019-660060248	EVENSON, JAMES DELBERT &	14	134,341	1000	12,684	1,089.00																																																																																																																		
2018	2018-660060248	EVENSON, JAMES DELBERT &	14	138,976	1000	12,684	1,083.00																																																																																																																		
2017	2017-660060248	EVENSON, JAMES DELBERT &	14	137,526	1000	12,685	1,088.00																																																																																																																		
2016	2016-660060248	EVENSON, JAMES DELBERT &	14	131,790	1000	12,286	1,071.00																																																																																																																		
2015	2015-660060248	EVENSON, JAMES DELBERT &	14	128,339	1000	11,898	1,025.00																																																																																																																		
2014	2014-660060248	EVENSON, JAMES DELBERT &	14	129,493	1000	11,523	1,026.00																																																																																																																		
2013	2013-660060248	EVENSON, JAMES DELBERT &	14	121,639	1000	11,158	990.00																																																																																																																		



# Rogers

## Assessment Property Record Card for Tax Year 2026

Data provided by LISA DELOZIER County Assessor

Date 04/17/2026  
 Time 09:45:20  
 Page 2

<b>Lot Data</b>	
Lot Size	
Lot Count	
Units Buildable	
Non-Ag Acres	0
Topography	
Street Access	
Utilities	
Amenities	LAND QUALITY
Method	Units-Buildable
Base Lot Value	
Factor Value	
Adjustments	
Lot Value	



<b>Residential Data</b>	
Type	1 Single Family Residence
Condition	3 - Average
Quality	3 - Average
Architecture	TRADITIONAL
Style	100% One Story
Exterior Wall	90% Frame, Siding, Vinyl 10% Veneer, Masonry
Base/Total Area	1,774 / 1,774
Style	100% One Story
HVAC	100% Warmed & Cooled Air
Roof Cover	1 Composition Shingle
Area on Slab	0
Fixture/RghIn	11 /
Bed/F/H Bath	3 / 2.0 /
Basement Area	
Garage Type	775 Attached Garage - Finished
Remodel	
Year/Eff Age	1995 / 23

**GRM Approach**

GRM Code	
Gross Rent	0.00
Indicated Value	

**Multiple Regression**

MRA Code	
Adjusted R	
Indicated Value	

**Direct Comparables**

Selection Model	1 Res
Adjustment Model	A2 AO Test
Comparables	
Indicated Value	

**Cost Approach Manual : 01/2025**

Base Cost	94.67	Total Misc Impr	+	0
Roofing Adj	+ 4.47	Garage Cost	+	28,360
Subfloor Adj	+ 0.00	Total RCN	=	241,400
Heat/Cool Adj	+ 12.39	Depreciation ( 28%)	-	67,592
Plumbing Adj	+ 8.57	Lump Sums	+	11,640
Basement Adj	+ 0.00	RCNLD	=	185,448
Adj Base Cost	= 120.09	Lot Value	+	
Total Area	x 1,774	Indicated Value	=	185,448
Adjusted Cost	= 213,040	Value Per SqFt		104.54

**Value Reconciliation**

Selected Approach	Cost Approach		
Improvements	185,448		
Lot Value			
Indicated Value	185,448	104.54	Per SqFt
Agland Value	4,234		
Site Improvements	71,271		
Total Value	260,953	147.10	Total Value Per SqFt

**Miscellaneous Improvements**

Code	Description	Sketch ID	Size	Year	Units	Unit Cost	Depr	Value
WODC	WOOD DECK - COVERED	80174	50x8		400	29.10		11,640



# Rogers

## Assessment Property Record Card for Tax Year 2026

Data provided by LISA DELOZIER County Assessor

Date 04/17/2026

Time 09:45:20

Page 3

Sketch Image

660060248

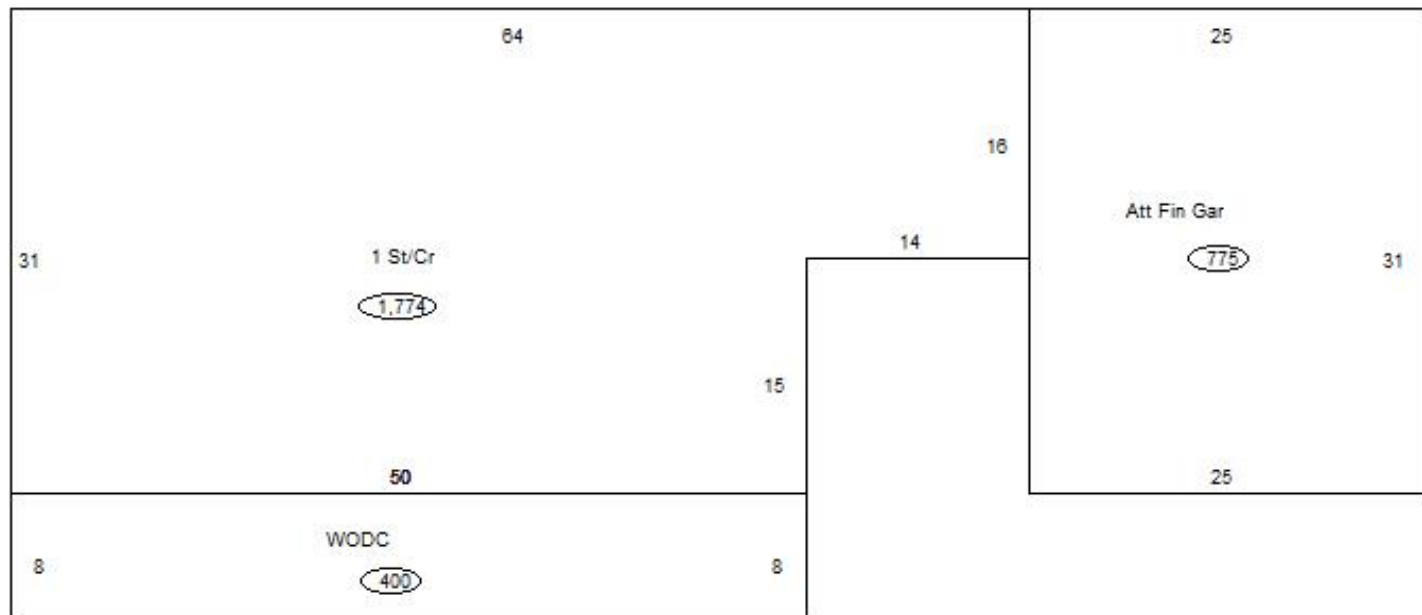

### Sketch Vector Information

Sequence	Code	Type	Built Over	Scale	Section Label	Base Area	Multiplier	Total Area
1	R	1	Crawl	13	1 St/Cr	1,774	1.000	1,774
2	G	5		13	Att Fin Gar	775	1.000	775
3	M	WODC		13	WODC	400	1.000	400
<b>Total Building Area</b>						<b>1,774</b>		<b>1,774</b>



# Rogers



## Assessment Property Record Card for Tax Year 2026

Data provided by LISA DELOZIER County Assessor

Date 04/17/2026  
 Time 09:45:20  
 Page 4

660060248

### Outbuildings/Site Improvements

Building Image	Code	Description	Dimensions	Floor	Roofing	Total Units
	UTIL	Shop Building	54x36x10	Base	Formed Metal	1,944
	Qual 3.5	Cond 3	Year 2024	Eff Age 2		
<b>Valuation Summary</b>		<b>Modifier Total</b>	<b>RCN</b>	<b>Depr (3% Phys/ % Func)</b>		<b>RCNLD</b>
Base Cost (28.46 x 1,944)		55,326		55,326 1,660		53,666
	SHDS	Shed - Small	12x10x6	Base	Composition Shingle	120
	Qual 3	Cond 3	Year 2005	Eff Age 16		
<b>Valuation Summary</b>		<b>Modifier Total</b>	<b>RCN</b>	<b>Depr (100% Phys/ % Func)</b>		<b>RCNLD</b>
Base Cost (24.88 x 120)		2,986		2,986 2,986		
	LOAF	Loading Shed	16x8x6	Dirt	Formed Metal	128
	Qual 3	Cond 3	Year 2000	Eff Age 20		
<b>Valuation Summary</b>		<b>Modifier Total</b>	<b>RCN</b>	<b>Depr (59% Phys/ % Func)</b>		<b>RCNLD</b>
Base Cost (6.82 x 128)		873		873 515		358
	BNGP	Barn - General Purpose	32x58x8	Base	Formed Metal	1,856
	Qual 3	Cond 3	Year 1995	Eff Age 23		
<b>Valuation Summary</b>		<b>Modifier Total</b>	<b>RCN</b>	<b>Depr (52% Phys/ % Func)</b>		<b>RCNLD</b>
Base Cost (19.36 x 1,856)		35,932		35,932 18,685		17,247



# Rogers

## Assessment Property Record Card for Tax Year 2026

Data provided by LISA DELOZIER County Assessor

Date 04/17/2026  
Time 09:45:20  
Page 5

### Agland Inventory

660060248

Soi	Description	Land Use	LPI	Adj Type	Adj Code	Acres	Use/Acre	Mkt/Acre	Use Value	Market Value
BR	BREAKS-ALLUVIAL LAND COMP	NTV PST	30		0	10.000	72	72	720	720
DBC	DENNIS-BATES COMPLEX 2-5%	NTV PST	60		0	5.000	144	144	720	720
DNB	DENNIS SILT LOAM 1-3% SLO	NTV PST	80		0	6.000	192	192	1,152	1,152
PAA	PARSONS SILT LOAM 0-1% SL	NTV PST	76		0	9.000	182	182	1,642	1,642
<b>NTV PST Totals</b>						30.000			4,234	4,234
<b>Total Agland</b>						30.000			4,234	4,234