



Rogers

Assessment Property Record Card for Tax Year 2026

Data provided by LISA DELOZIER County Assessor

Date 04/17/2026
Time 04:45:17
Page 1

Assessment Data					Primary Image														
Account 660061369 Parcel ID 000000-00-0-45010-002-0008 Cadastral ID 27-24-15-02145 Property Type REAL - Real Property Property Class URP VI Area 2 Tax Area 32 - TALALA OT/NW FIRE Name ID 257892 WEGENER, ELDON K & MELITA C 503 E NOWATA ST TALALA OK 74080-0000					 <p>660061369 12/04/24</p> <p>660061369_001.JPG 1/23/2025</p>														
Parcel Location Situs 00507 NOWATA Subdivision TALALA TOWN Lot/Block 0008 / 0002 Parcel Size 2 - Lots Sec/Twn/Rng 27 / 24 / 15 / 5 Neighborhood 1202 - R-V02-NW OOLOGAH School District S004 - OOLOGAH SCHOOLS																			
Legal Description Lat/Long: 36.53284949 -95.69392796					Building Permits														
LOTS 7 & 8 BLOCK 2 TALALA					<table border="1"> <thead> <tr> <th>Number</th> <th>Description</th> <th>Opened</th> <th>Closed</th> <th>Amount</th> </tr> </thead> <tbody> <tr> <td> </td> <td> </td> <td> </td> <td> </td> <td> </td> </tr> </tbody> </table>					Number	Description	Opened	Closed	Amount					
Number	Description	Opened	Closed	Amount															
Exemptions					Sale History														
Code	Type	Active	Maximum	Exemption	Bk/Pg	Grantor	Date	Price	Code										
H	Homestead	Yes	1,000	1,000															
Parcel Valuation																			
Source	REAL	Fair Cash	Capped	Asmnt Level	Assessed	Levy Rate	108.182	Current Tax											
Remove Cap	0	Land Value	8,843	7,383	11%	812	Assessed	4,130	446.79										
Year Frozen	2012	Improvements	8,980	7,497		825	Penalty	0											
Uncapped Value	0	Mobile Home	27,140	22,660		2,493	Exemption	1,000	-94.00										
TIF Project ID	0	Total Value	44,963	37,540		4,130	Total Taxable	3,130	353.00										
Assessment History																			
Tax Year	Statement Number	Billed Owner			Tax Area	Total Value	Exemptions	Taxable Value	Billed Tax										
2025	2025-660061369	WEGENER, ELDON K &			32	46,082	1000	3,129	353.00										
2024	2024-660061369	WEGENER, ELDON K &			32	47,042	1000	3,129	342.00										
2023	2023-660061369	WEGENER, ELDON K &			32	43,499	1000	3,130	340.00										
2022	2022-660061369	WEGENER, ELDON K &			32	41,341	1000	3,130	338.00										
2021	2021-660061369	WEGENER, ELDON K &			32	43,608	1000	3,130	340.00										
2020	2020-660061369	WEGENER, ELDON K &			32	38,952	1000	3,130	340.00										
2019	2019-660061369	WEGENER, ELDON K &			32	37,540	1000	3,129	334.00										
2018	2018-660061369	WEGENER, ELDON K &			32	40,307	1000	3,134	345.00										
2017	2017-660061369	WEGENER, ELDON K &			32	39,812	1000	3,134	368.00										
2016	2016-660061369	WEGENER, ELDON K &			32	37,583	1000	3,134	333.00										
2015	2015-660061369	WEGENER, ELDON K &			32	38,284	1000	3,211	327.00										
2014	2014-660061369	WEGENER, ELDON K &			32	38,403	1000	3,224	327.00										
2013	2013-660061369	WEGENER, ELDON K &			32	39,413	1000	3,335	327.00										



Rogers

Assessment Property Record Card for Tax Year 2026

Data provided by LISA DELOZIER County Assessor

Date 04/17/2026
Time 04:45:18
Page 3

660061369

Outbuildings/Site Improvements

Building Image	Code	Description	Dimensions	Floor	Roofing	Total Units
	DTGF	DETACHED GARAGE FAIR	0x0x0			576
	Qual 2	Cond 3	Year	Eff Age		
Valuation Summary		Modifier Total	RCN	Depr (40% Phys/ % Func)		RCNLD
Base Cost (16.00 x 576)		9,216		9,216	3,686	5,530



Rogers

Assessment Property Record Card for Tax Year 2026

Data provided by LISA DELOZIER County Assessor

Date 04/17/2026
 Time 04:45:18
 Page 4

Lot Data	Primary Image
Lot Size Lot Count Units Buildable Non-Ag Acres Topography Street Access Utilities Amenities LAND QUALITY Method Base Lot Value Factor Value Adjustments Lot Value	

Residential Data	
Type	6 Mobile Home 54 x 28
Condition	3.5 - Average
Quality	3 - Average
Architecture	6 MS ADJ
Style	100% Double Wide
Exterior Wall	100% Lap
Base/Total Area	1,512 / 1,512
Style	100% Double Wide
HVAC	
Roof Cover	1 Composition Shingle
Area on Slab	0
Fixture/RghIn	/
Bed/F/H Bath	/ /
Basement Area	
Garage Type	
Remodel	
Year/Eff Age	1993 / 23

\\tsclient\C\Users\TS\Pictures\2016-06-20 06-20-2016\06-20-2016 | 6/21/2016

GRM Approach	
GRM Code	
Gross Rent	0.00
Indicated Value	

Multiple Regression	
MRA Code	
Adjusted R	
Indicated Value	

Direct Comparables	
Selection Model	A Adam Test
Adjustment Model	1 2022 Residential
Comparables	
Indicated Value	

Cost Approach				Manual : 01/2025	
Base Cost	34.11	Total Misc Impr	+	0	
Roofing Adj	+ 2.63	Garage Cost	+		
Subfloor Adj	+ 0.00	Total RCN	=	66,195	
Heat/Cool Adj	+ 0.00	Depreciation (59%)	-	39,055	
Plumbing Adj	+ 7.04	Lump Sums	+	3,450	
Basement Adj	+ 0.00	RCNLD	=	30,590	
Adj Base Cost	= 43.78	Lot Value	+		
Total Area	x 1,512	Indicated Value	=	30,590	
Adjusted Cost	= 66,195	Value Per SqFt		20.23	

Value Reconciliation			
Selected Approach	Cost Approach		
Improvements	30,590		
Lot Value			
Indicated Value	30,590	20.23	Per SqFt
Agland Value			
Site Improvements			
Total Value	30,590	20.23	Total Value Per SqFt

Miscellaneous Improvements								
Code	Description	Sketch ID	Size	Year	Units	Unit Cost	Depr	Value
WODC	WOOD DECK - COVERED	132920	16x8		128	44.92	40%	3,450



Rogers

Assessment Property Record Card for Tax Year 2026

Data provided by LISA DELOZIER County Assessor

Date 04/17/2026

Time 04:45:18

Page 5

Sketch Image

660061369

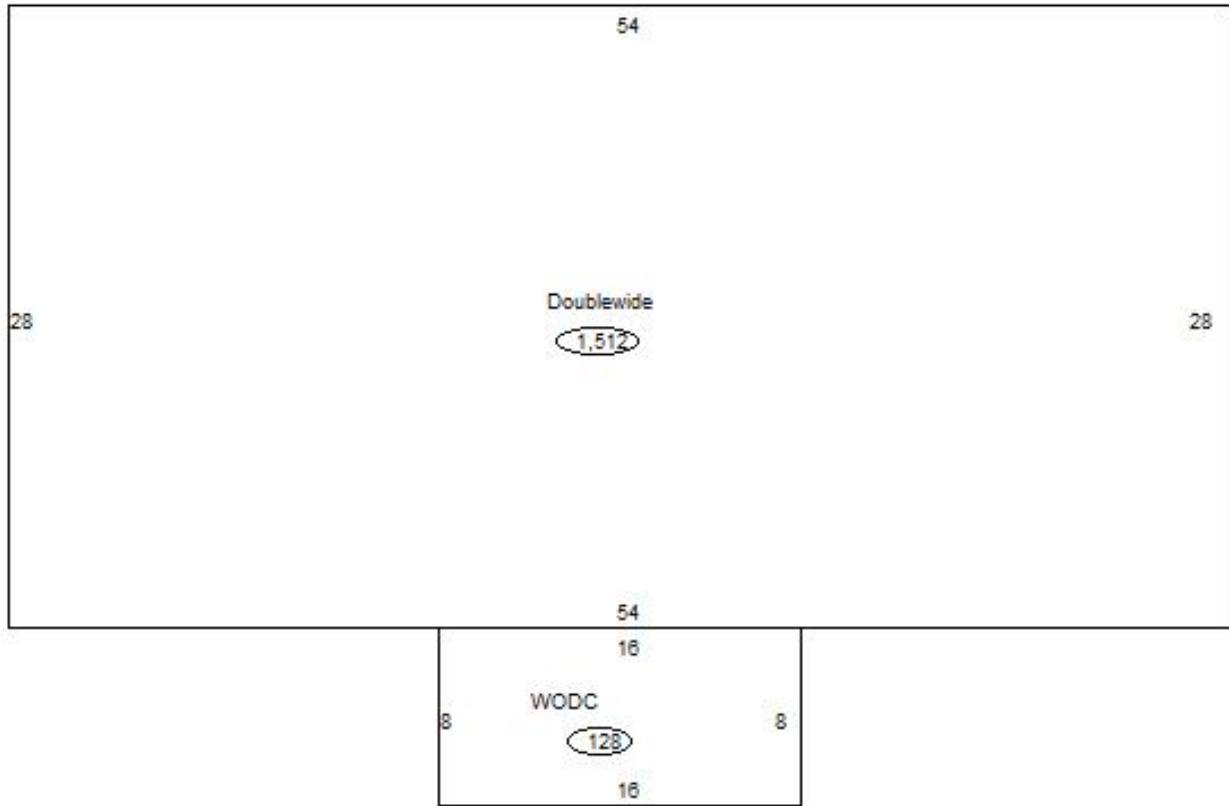

Sketch Vector Information

Sequence	Code	Type	Built Over	Scale	Section Label	Base Area	Multiplier	Total Area
1	R	14		10	Doublewide	1,512	1.000	1,512
2	M	WODC		10	WODC	128	1.000	128
Total Building Area						1,512		1,512