



# Rogers

## Assessment Property Record Card for Tax Year 2026

Data provided by LISA DELOZIER County Assessor

Date 04/17/2026  
 Time 01:17:37  
 Page 1

Assessment Data					Primary Image																																																																																																																				
<b>Account</b> 660061474 <b>Parcel ID</b> 20N16E-30-2-00000-000-0000 <b>Cadastral ID</b> 30-20-16-00110 <b>Property Type</b> REAL - Real Property <b>Property Class</b> RA VI Area 3 <b>Tax Area</b> 22 - CATOOSA / FAIR OAKS FD <b>Name ID</b> 349404 GOLKA, CHRISTOPHER LEONARD REVOCABLE TRUST  10388 E 570 RD CATOOSA OK 74015-0000  <b>Parcel Location</b> <b>Situs</b> 10388 E 570 RD <b>Subdivision</b> <b>Lot/Block</b> / <b>Parcel Size</b> 5 - Acres <b>Sec/Twn/Rng</b> 30 / 20 / 16 / 2 <b>Neighborhood</b> 2016 - UNPLATTED LAND <b>School District</b> S002 - CATOOSA SCHOOLS					<p>660061474_001.JPG 1/14/2026</p>																																																																																																																				
<b>Legal Description</b> Lat/Long: 36.18870944 -95.64751914																																																																																																																									
<b>Legal Description</b> W2 E2 NE NW LESS N2 W2 E2 NE NW					<b>Building Permits</b> <table border="1"> <thead> <tr> <th>Number</th> <th>Description</th> <th>Opened</th> <th>Closed</th> <th>Amount</th> </tr> </thead> <tbody> <tr> <td> </td> <td> </td> <td> </td> <td> </td> <td> </td> </tr> </tbody> </table>					Number	Description	Opened	Closed	Amount																																																																																																											
Number	Description	Opened	Closed	Amount																																																																																																																					
<b>Exemptions</b> <table border="1"> <thead> <tr> <th>Code</th> <th>Type</th> <th>Active</th> <th>Maximum</th> <th>Exemption</th> </tr> </thead> <tbody> <tr> <td>H</td> <td>Homestead</td> <td>Yes</td> <td>1,000</td> <td>1,000</td> </tr> </tbody> </table>					Code	Type	Active	Maximum	Exemption	H	Homestead	Yes	1,000	1,000	<b>Sale History</b> <table border="1"> <thead> <tr> <th>Bk/Pg</th> <th>Grantor</th> <th>Date</th> <th>Price</th> <th>Code</th> </tr> </thead> <tbody> <tr> <td>/</td> <td>GOLKA, CHRISTOPHER L</td> <td>01/19/2026</td> <td> </td> <td>WB</td> </tr> <tr> <td>1777/744</td> <td>GOSS, JERRY THOMAS JR</td> <td>05/18/2006</td> <td>200,000</td> <td>YES</td> </tr> <tr> <td>993/26</td> <td>GOSS, JERRY T SR</td> <td>06/01/1995</td> <td>20,000</td> <td>No</td> </tr> <tr> <td>993/25</td> <td>GOSS, JERRY T SR</td> <td>06/01/1995</td> <td>0</td> <td>No</td> </tr> </tbody> </table>					Bk/Pg	Grantor	Date	Price	Code	/	GOLKA, CHRISTOPHER L	01/19/2026		WB	1777/744	GOSS, JERRY THOMAS JR	05/18/2006	200,000	YES	993/26	GOSS, JERRY T SR	06/01/1995	20,000	No	993/25	GOSS, JERRY T SR	06/01/1995	0	No																																																																													
Code	Type	Active	Maximum	Exemption																																																																																																																					
H	Homestead	Yes	1,000	1,000																																																																																																																					
Bk/Pg	Grantor	Date	Price	Code																																																																																																																					
/	GOLKA, CHRISTOPHER L	01/19/2026		WB																																																																																																																					
1777/744	GOSS, JERRY THOMAS JR	05/18/2006	200,000	YES																																																																																																																					
993/26	GOSS, JERRY T SR	06/01/1995	20,000	No																																																																																																																					
993/25	GOSS, JERRY T SR	06/01/1995	0	No																																																																																																																					
<b>Parcel Valuation</b> <table border="1"> <thead> <tr> <th>Source</th> <th>REAL</th> <th>Fair Cash</th> <th>Capped</th> <th>Asmnt Level</th> <th>Assessed</th> <th>Levy Rate</th> <th>99.860</th> <th>Current Tax</th> </tr> </thead> <tbody> <tr> <td>Remove Cap</td> <td>2007</td> <td>Land Value 521</td> <td>521</td> <td>11%</td> <td>57</td> <td>Assessed</td> <td>13,337</td> <td>1,331.83</td> </tr> <tr> <td>Year Frozen</td> <td>0</td> <td>Improvements 189,659</td> <td>120,723</td> <td> </td> <td>13,280</td> <td>Penalty</td> <td>0</td> <td> </td> </tr> <tr> <td>Uncapped Value</td> <td>0</td> <td>Mobile Home 0</td> <td>0</td> <td> </td> <td>0</td> <td>Exemption</td> <td>1,000</td> <td>-93.00</td> </tr> <tr> <td>TIF Project ID</td> <td>0</td> <td>Total Value 190,180</td> <td>121,244</td> <td> </td> <td>13,337</td> <td>Total Taxable</td> <td>12,337</td> <td>1,239.00</td> </tr> </tbody> </table>										Source	REAL	Fair Cash	Capped	Asmnt Level	Assessed	Levy Rate	99.860	Current Tax	Remove Cap	2007	Land Value 521	521	11%	57	Assessed	13,337	1,331.83	Year Frozen	0	Improvements 189,659	120,723		13,280	Penalty	0		Uncapped Value	0	Mobile Home 0	0		0	Exemption	1,000	-93.00	TIF Project ID	0	Total Value 190,180	121,244		13,337	Total Taxable	12,337	1,239.00																																																																			
Source	REAL	Fair Cash	Capped	Asmnt Level	Assessed	Levy Rate	99.860	Current Tax																																																																																																																	
Remove Cap	2007	Land Value 521	521	11%	57	Assessed	13,337	1,331.83																																																																																																																	
Year Frozen	0	Improvements 189,659	120,723		13,280	Penalty	0																																																																																																																		
Uncapped Value	0	Mobile Home 0	0		0	Exemption	1,000	-93.00																																																																																																																	
TIF Project ID	0	Total Value 190,180	121,244		13,337	Total Taxable	12,337	1,239.00																																																																																																																	
<b>Assessment History</b> <table border="1"> <thead> <tr> <th>Tax Year</th> <th>Statement Number</th> <th>Billed Owner</th> <th>Tax Area</th> <th>Total Value</th> <th>Exemptions</th> <th>Taxable Value</th> <th>Billed Tax</th> </tr> </thead> <tbody> <tr><td>2025</td><td>2025-660061474</td><td>GOLKA, CHRISTOPHER L</td><td>22</td><td>125,580</td><td>1000</td><td>11,948</td><td>1,200.00</td></tr> <tr><td>2024</td><td>2024-660061474</td><td>GOLKA, CHRISTOPHER L</td><td>22</td><td>114,285</td><td>1000</td><td>11,571</td><td>1,135.00</td></tr> <tr><td>2023</td><td>2023-660061474</td><td>GOLKA, CHRISTOPHER L</td><td>22</td><td>122,098</td><td>1000</td><td>11,434</td><td>1,080.00</td></tr> <tr><td>2022</td><td>2022-660061474</td><td>GOLKA, CHRISTOPHER L</td><td>22</td><td>125,340</td><td>1000</td><td>11,072</td><td>1,049.00</td></tr> <tr><td>2021</td><td>2021-660061474</td><td>GOLKA, CHRISTOPHER L</td><td>22</td><td>107,415</td><td>1000</td><td>10,720</td><td>1,025.00</td></tr> <tr><td>2020</td><td>2020-660061474</td><td>GOLKA, CHRISTOPHER L</td><td>22</td><td>105,406</td><td>1000</td><td>10,379</td><td>998.00</td></tr> <tr><td>2019</td><td>2019-660061474</td><td>GOLKA, CHRISTOPHER L</td><td>22</td><td>100,435</td><td>1000</td><td>10,048</td><td>977.00</td></tr> <tr><td>2018</td><td>2018-660061474</td><td>GOLKA, CHRISTOPHER L</td><td>22</td><td>103,770</td><td>1000</td><td>10,414</td><td>1,007.00</td></tr> <tr><td>2017</td><td>2017-660061474</td><td>GOLKA, CHRISTOPHER L</td><td>22</td><td>112,890</td><td>1000</td><td>11,372</td><td>1,114.00</td></tr> <tr><td>2016</td><td>2016-660061474</td><td>GOLKA, CHRISTOPHER L</td><td>22</td><td>109,533</td><td>1000</td><td>11,011</td><td>1,063.00</td></tr> <tr><td>2015</td><td>2015-660061474</td><td>GOLKA, CHRISTOPHER L</td><td>22</td><td>106,016</td><td>1000</td><td>10,661</td><td>1,035.00</td></tr> <tr><td>2014</td><td>2014-660061474</td><td>GOLKA, CHRISTOPHER L</td><td>22</td><td>107,738</td><td>1000</td><td>10,851</td><td>1,065.00</td></tr> <tr><td>2013</td><td>2013-660061474</td><td>GOLKA, CHRISTOPHER L</td><td>20</td><td>127,077</td><td>1000</td><td>12,026</td><td>1,076.00</td></tr> </tbody> </table>										Tax Year	Statement Number	Billed Owner	Tax Area	Total Value	Exemptions	Taxable Value	Billed Tax	2025	2025-660061474	GOLKA, CHRISTOPHER L	22	125,580	1000	11,948	1,200.00	2024	2024-660061474	GOLKA, CHRISTOPHER L	22	114,285	1000	11,571	1,135.00	2023	2023-660061474	GOLKA, CHRISTOPHER L	22	122,098	1000	11,434	1,080.00	2022	2022-660061474	GOLKA, CHRISTOPHER L	22	125,340	1000	11,072	1,049.00	2021	2021-660061474	GOLKA, CHRISTOPHER L	22	107,415	1000	10,720	1,025.00	2020	2020-660061474	GOLKA, CHRISTOPHER L	22	105,406	1000	10,379	998.00	2019	2019-660061474	GOLKA, CHRISTOPHER L	22	100,435	1000	10,048	977.00	2018	2018-660061474	GOLKA, CHRISTOPHER L	22	103,770	1000	10,414	1,007.00	2017	2017-660061474	GOLKA, CHRISTOPHER L	22	112,890	1000	11,372	1,114.00	2016	2016-660061474	GOLKA, CHRISTOPHER L	22	109,533	1000	11,011	1,063.00	2015	2015-660061474	GOLKA, CHRISTOPHER L	22	106,016	1000	10,661	1,035.00	2014	2014-660061474	GOLKA, CHRISTOPHER L	22	107,738	1000	10,851	1,065.00	2013	2013-660061474	GOLKA, CHRISTOPHER L	20	127,077	1000	12,026	1,076.00
Tax Year	Statement Number	Billed Owner	Tax Area	Total Value	Exemptions	Taxable Value	Billed Tax																																																																																																																		
2025	2025-660061474	GOLKA, CHRISTOPHER L	22	125,580	1000	11,948	1,200.00																																																																																																																		
2024	2024-660061474	GOLKA, CHRISTOPHER L	22	114,285	1000	11,571	1,135.00																																																																																																																		
2023	2023-660061474	GOLKA, CHRISTOPHER L	22	122,098	1000	11,434	1,080.00																																																																																																																		
2022	2022-660061474	GOLKA, CHRISTOPHER L	22	125,340	1000	11,072	1,049.00																																																																																																																		
2021	2021-660061474	GOLKA, CHRISTOPHER L	22	107,415	1000	10,720	1,025.00																																																																																																																		
2020	2020-660061474	GOLKA, CHRISTOPHER L	22	105,406	1000	10,379	998.00																																																																																																																		
2019	2019-660061474	GOLKA, CHRISTOPHER L	22	100,435	1000	10,048	977.00																																																																																																																		
2018	2018-660061474	GOLKA, CHRISTOPHER L	22	103,770	1000	10,414	1,007.00																																																																																																																		
2017	2017-660061474	GOLKA, CHRISTOPHER L	22	112,890	1000	11,372	1,114.00																																																																																																																		
2016	2016-660061474	GOLKA, CHRISTOPHER L	22	109,533	1000	11,011	1,063.00																																																																																																																		
2015	2015-660061474	GOLKA, CHRISTOPHER L	22	106,016	1000	10,661	1,035.00																																																																																																																		
2014	2014-660061474	GOLKA, CHRISTOPHER L	22	107,738	1000	10,851	1,065.00																																																																																																																		
2013	2013-660061474	GOLKA, CHRISTOPHER L	20	127,077	1000	12,026	1,076.00																																																																																																																		



# Rogers

## Assessment Property Record Card for Tax Year 2026

Data provided by LISA DELOZIER County Assessor

Date 04/17/2026  
 Time 01:17:38  
 Page 2

Lot Data	Square-Foot - UNPLATTED LAND (ACRES)		Primary Image
Lot Size			
Lot Count			
Units Buildable			
Non-Ag Acres			
Topography			
Street Access			
Utilities			
Amenities	LAND QUALITY	1	
Method	Square-Foot		
Base Lot Value			
Factor Value			
Adjustments			
Lot Value			

Residential Data	
Type	1 Single Family Residence
Condition	3 - Average
Quality	3 - Average
Architecture	TRAD TRADITIONAL
Style	100% 1 1/2 Story Finished
Exterior Wall	50% Frame, Siding, Wood 50% Veneer, Masonry
Base/Total Area	590 / 1,626
Style	100% 1 1/2 Story Finished
HVAC	100% Warmed & Cooled Air
Roof Cover	1 Composition Shingle
Area on Slab	590
Fixture/RghIn	11 /
Bed/F/H Bath	4 / 2.0 /
Basement Area	
Garage Type	
Remodel	
Year/Eff Age	1995 / 23

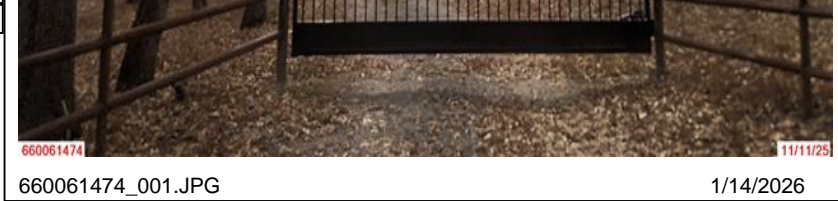

660061474\_001.JPG 1/14/2026

GRM Approach	
GRM Code	
Gross Rent	0.00
Indicated Value	

Multiple Regression	
MRA Code	
Adjusted R	
Indicated Value	

Direct Comparables	
Selection Model	1 Res
Adjustment Model	A2 AO Test
Comparables	
Indicated Value	

Cost Approach				Manual : 01/2025			
Base Cost	96.80	Total Misc Impr	+ 29,586				
Roofing Adj	+ 2.21	Garage Cost	+ 224,917				
Subfloor Adj	+ -1.06	Total RCN	= 62,977				
Heat/Cool Adj	+ 12.64	Depreciation ( 28%)	- 0				
Plumbing Adj	+ 9.54	Lump Sums	+ 161,940				
Basement Adj	+ 0.00	RCNLD	= 120.13				
Adj Base Cost	= 120.13	Lot Value	+ 161,940				
Total Area	x 1,626	Indicated Value	= 195,331				
Adjusted Cost	= 195,331	Value Per SqFt	99.59				

Value Reconciliation			
Selected Approach	Cost Approach		
Improvements	161,940		
Lot Value		161,940	99.59 Per SqFt
Indicated Value	161,940		
Agland Value	521		
Site Improvements	27,719		
Total Value	190,180	116.96	Total Value Per SqFt

Miscellaneous Improvements								
Code	Description	Sketch ID	Size	Year	Units	Unit Cost	Depr	Value
FPR1	FIREPLACE - RESIDENTIAL 1 STORY	0		1	1	5,615.40		5,615
PRCH	SLAB PORCH - COVERED	80326	35x10		350	25.83		9,041
PRCH	SLAB PORCH - COVERED	80327	37x16		592	25.22		14,930



# Rogers

## Assessment Property Record Card for Tax Year 2026

Data provided by LISA DELOZIER County Assessor

Date 04/17/2026  
 Time 01:17:38  
 Page 3

### Sketch Image

660061474

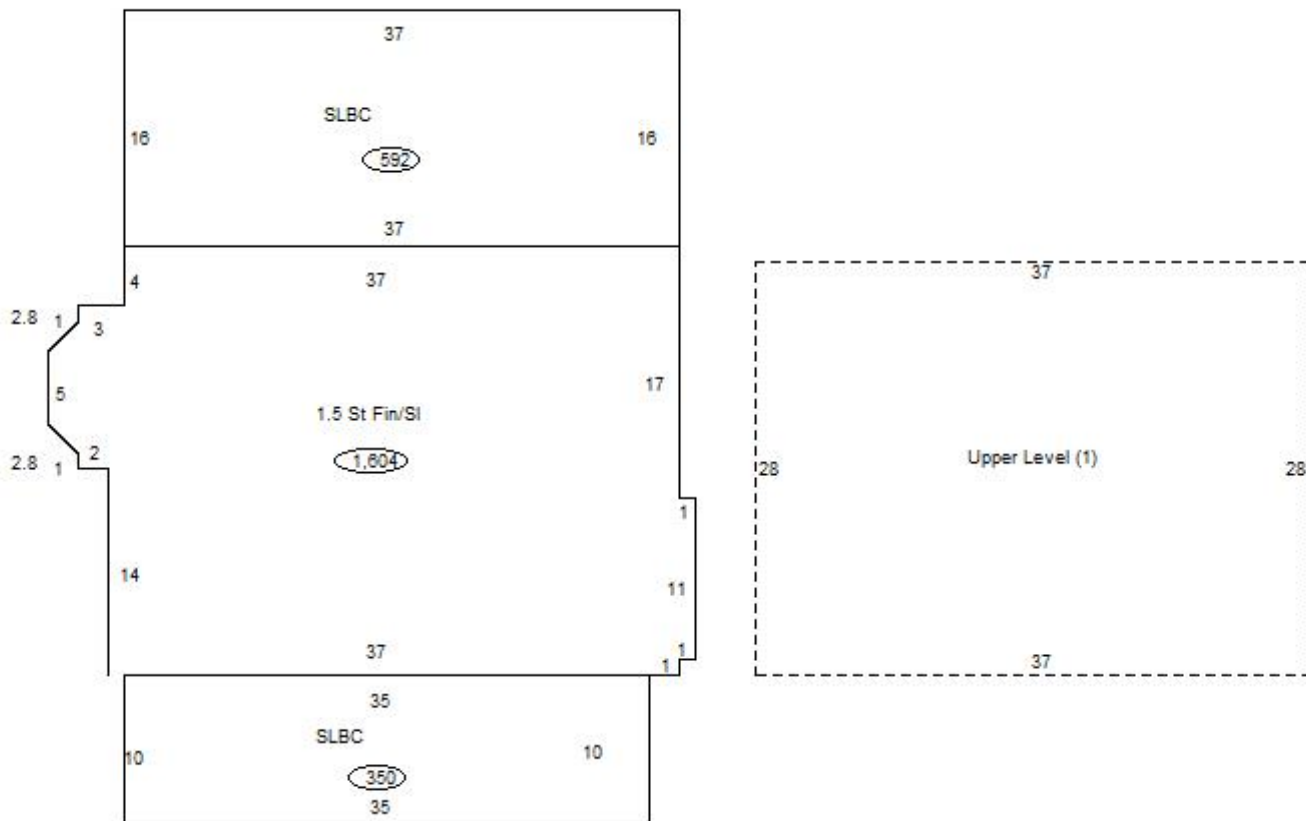

### Sketch Vector Information

Sequence	Code	Type	Built Over	Scale	Section Label	Base Area	Multiplier	Total Area
1	R	5	Slab	13	1.5 St Fin/SI	568	2.824	1,604
2	M	PRCH		13	SLBC	350	1.000	350
3	M	PRCH		13	SLBC	592	1.000	592
4	U	^UL		13	Upper Level (1)	1,036	1.000	1,036
<b>Total Building Area</b>						568		1,604



# Rogers

## Assessment Property Record Card for Tax Year 2026

Data provided by LISA DELOZIER County Assessor

Date 04/17/2026  
 Time 01:17:38  
 Page 4

660061474

### Outbuildings/Site Improvements

Building Image	Code	Description	Dimensions	Floor	Roofing	Total Units
	CPDT	Carport - Detached	40x20x10	Gravel	Composition Shingle	800
	<b>Qual</b> 3	<b>Cond</b> 3	<b>Year</b> 2015	<b>Eff Age</b> 8		

<b>Valuation Summary</b>		<b>Modifier Total</b>	<b>RCN</b>	<b>Depr (43% Phys/ % Func)</b>	<b>RCNLD</b>
Base Cost (6.75 x 800)	5,400		5,400	2,322	3,078



GRDT	Garage - Detached	32x30x10	Concrete	Formed Metal	960
<b>Qual</b> 3	<b>Cond</b> 3	<b>Year</b> 1995	<b>Eff Age</b> 23		
Apt Finish Area Over Garage	Area	600	Fixture Count		25,186

<b>Valuation Summary</b>		<b>Modifier Total</b>	<b>RCN</b>	<b>Depr (52% Phys/ % Func)</b>	<b>RCNLD</b>
Base Cost (27.24 x 960)	26,150	25,186	51,336	26,695	24,641



# Rogers

## Assessment Property Record Card for Tax Year 2026

Data provided by LISA DELOZIER County Assessor

Date 04/17/2026  
Time 01:17:38  
Page 5

### Agland Inventory

660061474

Soi	Description	Land Use	LPI	Adj Type	Adj Code	Acres	Use/Acre	Mkt/Acre	Use Value	Market Value
BC	BATES-COLLINSVILLE COMPLE	TMBR	51			3.790	92	92	348	348
<b>TMBR Totals</b>						3.790			348	348
BC	BATES-COLLINSVILLE COMPLE	IMP PST	51			1.210	143	143	173	173
<b>IMP PST Totals</b>						1.210			173	173
<b>Total Agland</b>						5.000			521	521