



# Rogers

## Assessment Property Record Card for Tax Year 2026

Data provided by LISA DELOZIER County Assessor

Date 04/17/2026  
Time 15:23:37  
Page 1

Assessment Data					Primary Image									
Account	660066456													
Parcel ID	20N14E-34-4-00000-000-0000													
Cadastral ID	34-20-14-11630													
Property Type	REAL - Real Property													
Property Class	UC	VI Area	3											
Tax Area	1 - CATOOSA OT													
Name ID	267850													
UNITED BILT HOMES INC														
8500 LINE AVENUE SHREVEPORT LA 71106-0000														
Parcel Location														
Situs	15815 E SKELLY DR													
Subdivision														
Lot/Block	/	Parcel Size	2.505 - Acres											
Sec/Twn/Rng	34 / 20 / 14 / 4													
Neighborhood	5001 - TASC 2016													
School District	S002 - CATOOSA SCHOOLS													
REVAL 2022 6/16/2021														
Legal Description Lat/Long: 36.16344377 -95.80146875														
TR IN SE SE DESC AS STARTING AT SW/C SE SE, TH N 144.20' TO POB SD PT BEING ON NLY ROW HWY 44, TH CONT N 373.16', TH E 292.48', TH S 373.01' TO PT ON NLY ROW/L HWY 44, TH W ALG ROW/L 292.48' TO POB														
Building Permits														
<table border="1"> <thead> <tr> <th>Number</th> <th>Description</th> <th>Opened</th> <th>Closed</th> <th>Amount</th> </tr> </thead> <tbody> <tr> <td></td> <td></td> <td></td> <td></td> <td></td> </tr> </tbody> </table>					Number	Description	Opened	Closed	Amount					
Number	Description	Opened	Closed	Amount										
Exemptions														
Sale History														
Code	Type	Active	Maximum	Exemption	Bk/Pg	Grantor	Date	Price	Code					
					1154/462	PITTS, DON	12/18/1998	0	No					
					1045/47	LAND-ME 1 INC	07/17/1996	178,053	No					
Parcel Valuation														
Source	REAL		Fair Cash	Capped	Asmnt Level	Assessed	Levy Rate	106.660	Current Tax					
Remove Cap	2000	Land Value	170,900	170,900	11%	18,799	Assessed	59,458	6,341.79					
Year Frozen	0	Improvements	391,116	369,625		40,659	Penalty	0						
Uncapped Value	0	Mobile Home	0	0		0	Exemption	0	0.00					
TIF Project ID	0	Total Value	562,016	540,525		59,458	Total Taxable	59,458	6,342.00					
Assessment History														
Tax Year	Statement Number	Billed Owner			Tax Area	Total Value	Exemptions	Taxable Value	Billed Tax					
2025	2025-660066456	UNITED BILT HOMES INC			1	541,292	0	56,627	6,040.00					
2024	2024-660066456	UNITED BILT HOMES INC			1	513,085	0	53,930	5,689.00					
2023	2023-660066456	UNITED BILT HOMES INC			1	486,189	0	51,362	5,271.00					
2022	2022-660066456	UNITED BILT HOMES INC			1	444,693	0	48,917	4,910.00					
2021	2021-660066456	UNITED BILT HOMES INC			1	434,067	0	47,748	4,201.00					
2020	2020-660066456	UNITED BILT HOMES INC			1	430,915	0	47,401	4,198.00					
2019	2019-660066456	UNITED BILT HOMES INC			1	418,679	0	46,055	4,136.00					
2018	2018-660066456	UNITED BILT HOMES INC			1	421,515	0	46,367	4,139.00					
2017	2017-660066456	UNITED BILT HOMES INC			1	419,519	0	46,148	4,167.00					
2016	2016-660066456	UNITED BILT HOMES INC			1	413,159	0	45,448	4,042.00					
2015	2015-660066456	UNITED BILT HOMES INC			1	637,339	0	67,787	6,059.00					
2014	2014-660066456	UNITED BILT HOMES INC			1	637,339	0	64,559	5,840.00					
2013	2013-660066456	UNITED BILT HOMES INC			1	558,953	0	61,485	5,503.00					



# Rogers

## Assessment Property Record Card for Tax Year 2026

Data provided by LISA DELOZIER County Assessor

Date 04/17/2026  
Time 15:23:37  
Page 2

Lot Data	Square-Foot - COMM	Primary Image
<b>Lot Size</b> <b>Lot Count</b> <b>Units Buildable</b> <b>Non-Ag Acres</b> <b>Topography</b> <b>Street Access</b> <b>Utilities</b> <b>Amenities</b>  <b>Method</b> Square-Foot <b>Base Lot Value</b> <b>Factor Value</b> <b>Adjustments</b> <b>Lot Value</b>		

D:\Appraisers\LOGAN\LOGAN RESIDENTIAL VI\2021-5-14\IMG\_05142021

Residential Data	
<b>Type</b>	1 Single Family Residence
<b>Condition</b>	3 - Average
<b>Quality</b>	3 - Average
<b>Architecture</b>	TRAD TRADITIONAL
<b>Style</b>	100% One Story
<b>Exterior Wall</b>	100% Frame, Siding, Wood
<b>Base/Total Area</b>	1,232 / 1,232
<b>Style</b>	100% One Story
<b>HVAC</b>	100% Warmed & Cooled Air
<b>Roof Cover</b>	1 Composition Shingle
<b>Area on Slab</b>	0
<b>Fixture/RghIn</b>	9 /
<b>Bed/F/H Bath</b>	3 / 2.0 /
<b>Basement Area</b>	
<b>Garage Type</b>	
<b>Remodel</b>	
<b>Year/Eff Age</b>	1996 / 23

GRM Approach	
<b>GRM Code</b>	
<b>Gross Rent</b>	0.00
<b>Indicated Value</b>	

Multiple Regression	
<b>MRA Code</b>	
<b>Adjusted R</b>	
<b>Indicated Value</b>	

Direct Comparables	
<b>Selection Model</b>	1 Res
<b>Adjustment Model</b>	A2 AO Test
<b>Comparables</b>	
<b>Indicated Value</b>	

Cost Approach				Manual : 01/2025			
<b>Base Cost</b>	107.62	<b>Total Misc Impr</b>	+ 3,702				
<b>Roofing Adj</b>	+ 5.09	<b>Garage Cost</b>	+ 0				
<b>Subfloor Adj</b>	+ 0.00	<b>Total RCN</b>	= 170,971				
<b>Heat/Cool Adj</b>	+ 12.64	<b>Depreciation ( 71%)</b>	- 121,389				
<b>Plumbing Adj</b>	+ 10.42	<b>Lump Sums</b>	+ 0				
<b>Basement Adj</b>	+ 0.00	<b>RCNLD</b>	= 49,582				
<b>Adj Base Cost</b>	= 135.77	<b>Lot Value</b>	+ 49,582				
<b>Total Area</b>	x 1,232	<b>Indicated Value</b>	= 49,582				
<b>Adjusted Cost</b>	= 167,269	<b>Value Per SqFt</b>	40.25				

Value Reconciliation			
<b>Selected Approach</b>	Cost Approach		
<b>Improvements</b>	49,582		
<b>Lot Value</b>			
<b>Indicated Value</b>	49,582	40.25	Per SqFt
<b>Agland Value</b>			
<b>Site Improvements</b>			
<b>Total Value</b>	49,582	40.25	Total Value Per SqFt

Miscellaneous Improvements								
Code	Description	Sketch ID	Size	Year	Units	Unit Cost	Depr	Value
CPDT	CARPOT - DETACHED	81850	24x12		288	11.36		3,272
PRCH	SLAB PORCH - COVERED	81851	4x4		16	26.88		430



# Rogers

## Assessment Property Record Card for Tax Year 2026

Data provided by LISA DELOZIER County Assessor

Date 04/17/2026  
 Time 15:23:37  
 Page 3

### Sketch Image

660066456

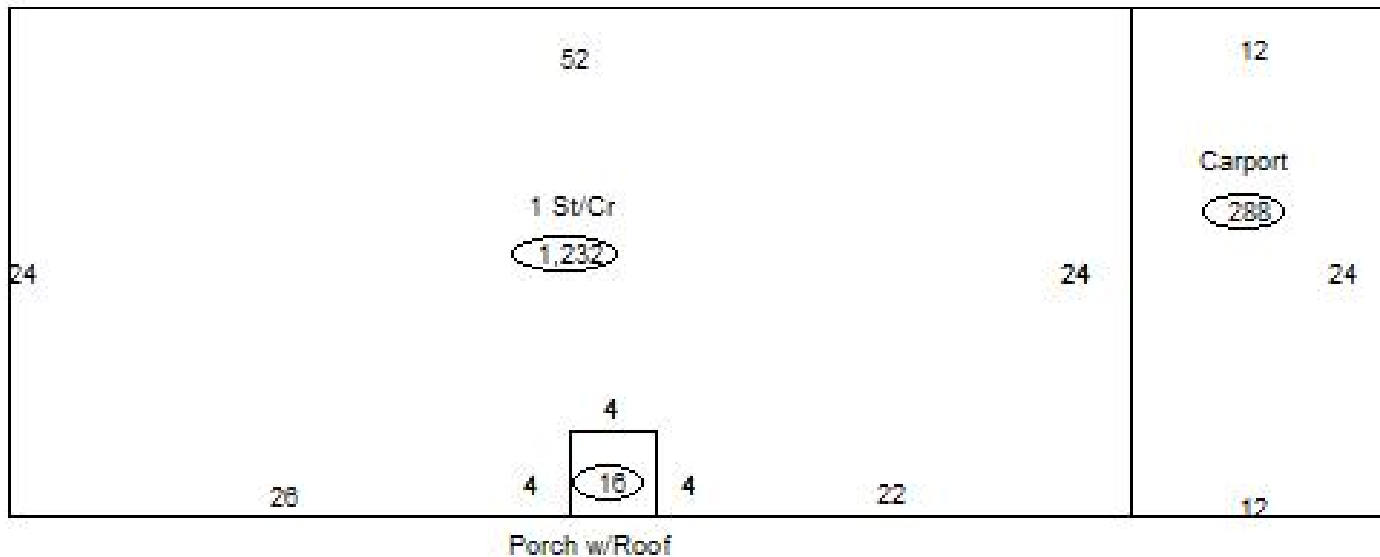

### Sketch Vector Information

Sequence	Code	Type	Built Over	Scale	Section Label	Base Area	Multiplier	Total Area
1	R	1	Crawl	13	1 St/Cr	1,232	1.000	1,232
2	M	CPDT		13	Carport	288	1.000	288
3	M	PRCH		13	SLBC	16	1.000	16
<b>Total Building Area</b>						1,232		1,232



# Rogers

## Assessment Property Record Card for Tax Year 2026

Data provided by LISA DELOZIER County Assessor

Date 04/17/2026  
 Time 15:23:37  
 Page 4

Lot Data	Primary Image
Lot Size Lot Count Units Buildable 1 Non-Ag Acres Topography Street Access Utilities Amenities  Method Base Lot Value Factor Value Adjustments Lot Value	

Residential Data	
Type	1 Single Family Residence
Condition	3 - Average
Quality	3 - Average
Architecture	TRAD TRADITIONAL
Style	100% 1 1/2 Story Finished
Exterior Wall	100% Frame, Siding, Wood
Base/Total Area	1,280 / 2,100
Style	100% 1 1/2 Story Finished
HVAC	100% Warmed & Cooled Air
Roof Cover	1 Composition Shingle
Area on Slab	0
Fixture/RghIn	14 /
Bed/F/H Bath	4 / 2.0 / 1.0
Basement Area	
Garage Type	
Remodel	
Year/Eff Age	2007 / 14

\\tsclient\C\Users\rln\Pictures\2017-03-03 03-03-17\03-03-17 070.J 3/9/2017

GRM Approach	
GRM Code	
Gross Rent	0.00
Indicated Value	

Multiple Regression	
MRA Code	
Adusted R	
Indicated Value	

Direct Comparables	
Selection Model	1 Res
Adjustment Model	A2 AO Test
Comparables	
Indicated Value	

Cost Approach				Manual : 01/2025			
Base Cost	83.93	Total Misc Impr	+ 12,505	Roofing Adj	+ 2.94	Garage Cost	+ 0
Subfloor Adj	+ 0.00	Total RCN	= 241,006	Heat/Cool Adj	+ 12.64	Depreciation ( 66%)	- 159,064
Plumbing Adj	+ 9.30	Lump Sums	+ 0	Basement Adj	+ 0.00	RCNLD	= 81,942
Adj Base Cost	= 108.81	Lot Value	+ 81,942	Total Area	x 2,100	Indicated Value	= 81,942
Adjusted Cost	= 228,501	Value Per SqFt	39.02	Adjusted Cost	= 228,501	Value Per SqFt	39.02

Value Reconciliation			
Selected Approach	Cost Approach		
Improvements	81,942		
Lot Value			
Indicated Value	81,942	39.02	Per SqFt
Agland Value			
Site Improvements			
Total Value	81,942	39.02	Total Value Per SqFt

Miscellaneous Improvements								
Code	Description	Sketch ID	Size	Year	Units	Unit Cost	Depr	Value
FPR1	FIREPLACE - RESIDENTIAL 1 STORY	0		1	1	5,615.40		5,615
PRCH	SLAB PORCH - COVERED	81846		264	264	26.10		6,890



# Rogers

## Assessment Property Record Card for Tax Year 2026

Data provided by LISA DELOZIER County Assessor

Date 04/17/2026  
 Time 15:23:37  
 Page 5

### Sketch Image

660066456

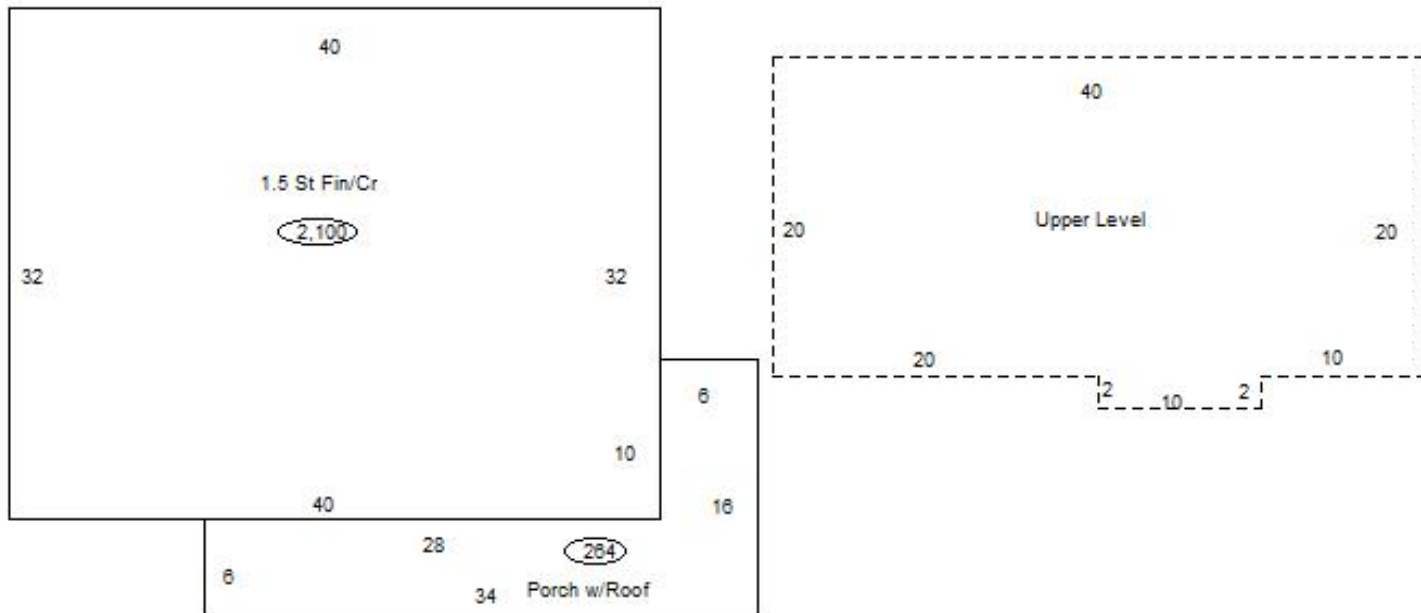

### Sketch Vector Information

Sequence	Code	Type	Built Over	Scale	Section Label	Base Area	Multiplier	Total Area
1	R	5	Crawl	13	1.5 St Fin/Cr	1,280	1.641	2,100
2	U	^UL	Overhang	13	Upper Level	820	1.000	820
3	M	PRCH		13	SLBC	264	1.000	264
<b>Total Building Area</b>						1,280		2,100



# Rogers

## Assessment Property Record Card for Tax Year 2026

Data provided by LISA DELOZIER County Assessor

Date 04/17/2026  
 Time 15:23:38  
 Page 6

Lot Data		Primary Image						
Lot Size	-	<p>\\tsclient\C\Users\rln\Pictures\2017-03-03 03-03-17\03-03-17 073.J 3/9/2017</p>						
Lot Count								
Units Buildable	1							
Non-Ag Acres								
Topography								
Street Access								
Utilities								
Amenities								
Method								
Base Lot Value								
Factor Value								
Adjustments								
Lot Value								
Residential Data								
Type	1 Single Family Residence							
Condition	3 - Average							
Quality	3 - Average							
Architecture	TRAD TRADITIONAL							
Style	100% One Story							
Exterior Wall	100% Frame, Siding, Wood							
Base/Total Area	1,456 / 1,456							
Style	100% One Story							
HVAC	100% Warmed & Cooled Air							
Roof Cover	1 Composition Shingle							
Area on Slab	0							
Fixture/RghIn	11 /							
Bed/F/H Bath	3 / 2.0 /							
Basement Area								
Garage Type								
Remodel								
Year/Eff Age	2007 / 14							
Cost Approach		Manual : 01/2025						
Base Cost	99.09	Total Misc Impr	+ 5,876					
Roofing Adj	+ 4.69	Garage Cost	+					
Subfloor Adj	+ 0.00	Total RCN	= 190,904					
Heat/Cool Adj	+ 12.64	Depreciation ( 66%)	- 125,997					
Plumbing Adj	+ 10.66	Lump Sums	+ 0					
Basement Adj	+ 0.00	RCNLD	= 64,907					
Adj Base Cost	= 127.08	Lot Value	+					
Total Area	x 1,456	Indicated Value	= 64,907					
Adjusted Cost	= 185,028	Value Per SqFt	44.58					
Value Reconciliation								
Selected Approach		Cost Approach						
Improvements	64,907							
Lot Value								
Indicated Value	64,907	44.58	Per SqFt					
Agland Value								
Site Improvements								
Total Value	64,907	44.58	Total Value Per SqFt					
Miscellaneous Improvements								
Code	Description	Sketch ID	Size	Year	Units	Unit Cost	Depr	Value
PRCH	SLAB PORCH - COVERED	81848	28x8		224	26.23		5,876



# Rogers

## Assessment Property Record Card for Tax Year 2026

Data provided by LISA DELOZIER County Assessor

Date 04/17/2026

Time 15:23:38

Page 7

Sketch Image

660066456

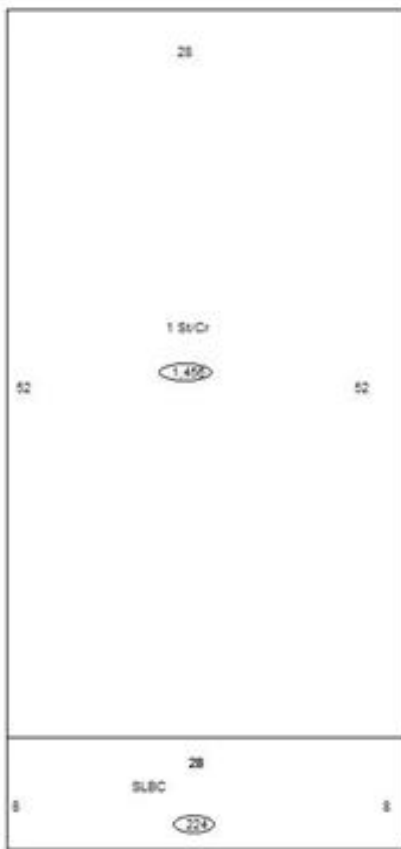

### Sketch Vector Information

Sequence	Code	Type	Built Over	Scale	Section Label	Base Area	Multiplier	Total Area
1	R	1	Crawl	10	1 St/Cr	1,456	1.000	1,456
2	M	PRCH		10	SLBC	224	1.000	224
<b>Total Building Area</b>						1,456		1,456



# Rogers

## Assessment Property Record Card for Tax Year 2026

Data provided by LISA DELOZIER County Assessor

Date 04/17/2026  
Time 15:23:38  
Page 8

Lot Data		Units-Buildable - (UNITS BUILDABLE)		Primary Image				
Lot Size Lot Count Units Buildable Non-Ag Acres Topography Street Access Utilities Amenities  Method Units-Buildable Base Lot Value Factor Value Adjustments Lot Value				<p>\\tsclient\C\Users\rln\Pictures\2017-03-03 03-03-17\03-03-17 071.J 3/9/2017</p>				
<b>Residential Data</b> Type 1 Single Family Residence Condition 3 - Average Quality 3 - Average Architecture TRAD TRADITIONAL Style 100% One Story Exterior Wall 100% Veneer, Masonry Base/Total Area 1,580 / 1,580 Style 100% One Story HVAC 100% Warmed & Cooled Air Roof Cover 1 Composition Shingle Area on Slab 0 Fixture/RghIn 12 / Bed/F/H Bath 3 / 2.0 / Basement Area Garage Type Remodel Year/Eff Age 2008 / 14								<b>GRM Approach</b> GRM Code Gross Rent 0.00 Indicated Value
<b>Cost Approach</b>		<b>Manual : 01/2025</b>		<b>Multiple Regression</b> MRA Code 1 Test Adusted R 0.8445 Indicated Value 175,750 111.23 Per SqFt				
Base Cost 110.29 Roofing Adj + 4.82 Subfloor Adj + 0.00 Heat/Cool Adj + 12.64 Plumbing Adj + 10.66 Basement Adj + 0.00 Adj Base Cost = 138.41  Total Area x 1,580 Adjusted Cost = 218,688		Total Misc Impr + 3,186 Garage Cost + Total RCN = 221,874 Depreciation ( 66%) - 146,437 Lump Sums + 0 RCNLD = 75,437 Lot Value +  Indicated Value = 75,437 Value Per SqFt 47.74		<b>Direct Comparables</b> Selection Model 1 Res Adjustment Model A2 AO Test Comparables Indicated Value				
<b>Miscellaneous Improvements</b>				<b>Value Reconciliation</b> Selected Approach Cost Approach Improvements 75,437 Lot Value Indicated Value 75,437 47.74 Per SqFt Agland Value Site Improvements Total Value 75,437 47.74 Total Value Per SqFt				
<b>Code</b>	<b>Description</b>	<b>Sketch ID</b>	<b>Size</b>	<b>Year</b>	<b>Units</b>	<b>Unit Cost</b>	<b>Depr</b>	<b>Value</b>
PRCH	SLAB PORCH - COVERED	81853	20x6		120	26.55		3,186



# Rogers

## Assessment Property Record Card for Tax Year 2026

Data provided by LISA DELOZIER County Assessor

Date 04/17/2026

Time 15:23:38

Page 9

### Sketch Image

660066456

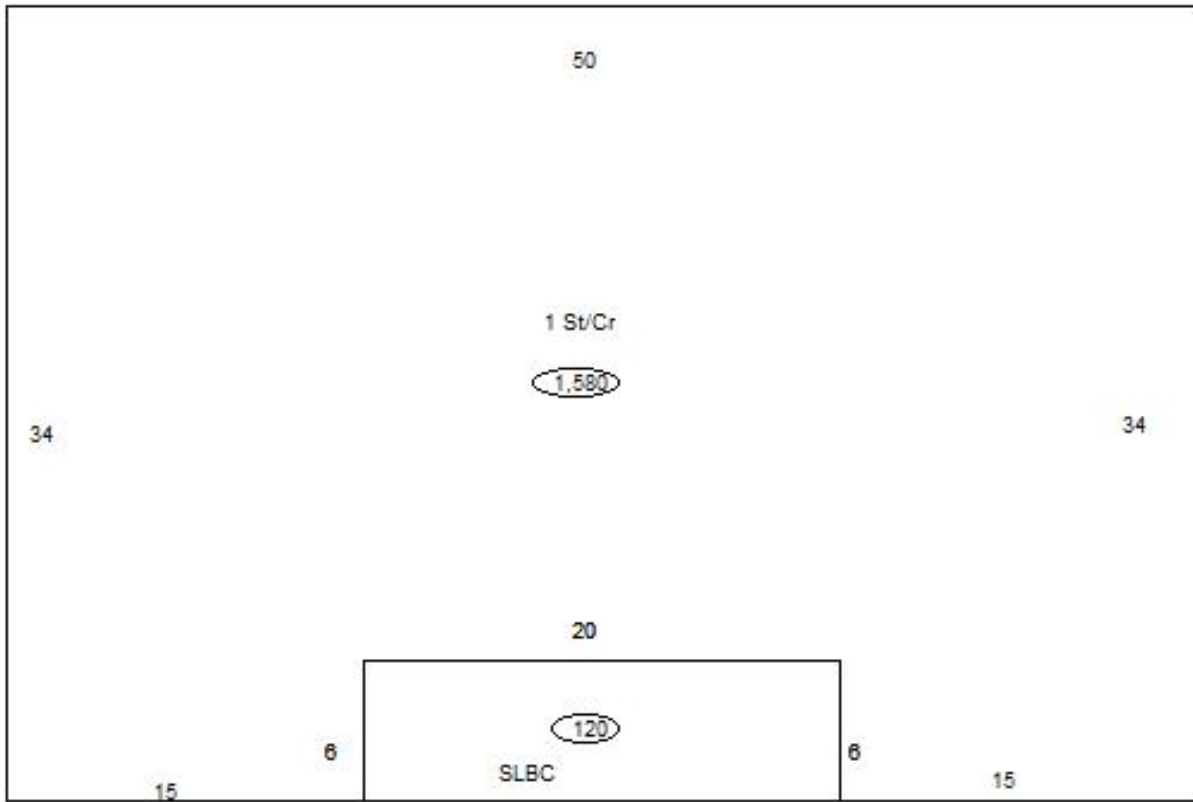

### Sketch Vector Information

Sequence	Code	Type	Built Over	Scale	Section Label	Base Area	Multiplier	Total Area
1	R	1	Crawl	10	1 St/Cr	1,580	1.000	1,580
2	M	PRCH		10	SLBC	120	1.000	120
<b>Total Building Area</b>						1,580		1,580



# Rogers

## Assessment Property Record Card for Tax Year 2026

Data provided by LISA DELOZIER County Assessor

Date 04/17/2026  
 Time 15:23:38  
 Page 10

Lot Data		Primary Image	
Lot Size	0 x 0		
Lot Count			
Units Buildable			
Non-Ag Acres	0		
Topography			
Street Access			
Utilities			
Amenities	0		
	0		
Value Model	1835 COMM		
Value Method	Square-Foot		
Base Lot Value	109,335.00 x .77 = 84,005		
Factor Value	0		
Adjustments	203.44%		
Lot Value	170,900		
Cost Approach		Image Information	
Manual Date	01/2025	Image ID	877258
Total Building Area	288	Image Date	8/31/2018
Total Base Value	122,936	Name	IMG_2903.JPG
Modifier Value		Description	REVAL 2018
Misc Improvements			
Replacement Cost New	122,936		
Phys/Func Depreciation Loss	()		
RCN Less Phys/Func	119,248		
Economic Depreciation			
RCNLD (All Sources)	119,248		
Depreciated Improvements			
Outbuilding Value			
Total Improvement Value	119,248		
Land Value	170,900		
Cost Approach Value	290,148 1,007.46/SqFt		
Income Approach		Value Reconciliation	
Potential Gross Income (PGI)		Selected Valuation Method	Cost Approach
Vacancy & Collection Loss		Total Improvement Value	75,437
Miscellaneous Income		Land Value	170,900
Effective Gross Income (EGI)		Total Appraised Value	290,148 1,007.46/SqFt
Total Expenses			
Net Operating Income (NOI)			
Income Capitalization Rate			
Indicated Value	0.00		



# Rogers

## Assessment Property Record Card for Tax Year 2026

Data provided by LISA DELOZIER County Assessor

Date 04/17/2026  
Time 15:23:38  
Page 11

Account 660066456  
Parcel ID 20N14E-34-4-00000-000-0000  
Cadastral ID 34-20-14-11630

Tax Area Code 1  
Property Class UC  
Owners Name UNITED BILT HOMES INC

### Building Data

Building ID 2358  
Building Sequence 1  
Occupancy 1 344 Office Building 100%  
Occupancy 2  
Occupancy 3  
Total Floor Area 288  
Average Perimeter 72  
Number Of Storys 1.00  
Average Wall Ht 14.00  
Year Built 2008  
Effective Age  
Construction Class 2 - Heavier Wood or Steel Stud Frame  
Quality 3 - Average  
Condition 4 - Good  
Exterior Wall 7 - Brick, Solid  
Heating/Cooling 7 - Package Unit  
Roof Type  
Roof Cover  
Basement Area  
Basement Levels  
Basement Finish  
Finish Code - 1  
Finish Area - 1  
Finish Code - 2  
Finish Area - 2

### Building Image

### Image Information

Image Name  
Image Date  
Image Name  
Description

### Cost Calculations

Appraisal Zone 3  
Zone Description  
Base Cost 128.84  
Wall Cost 277.12  
HVAC Cost 20.90  
Basement Cost 0.00  
Total Base Cost 426.86  
Total Area 288  
Base RCN 122,936  
Misc Impr Value

Manual Date 01/2025  
Base Year 2026  
Modifier Value  
Total Replacement Cost 122,936  
Physical Depreciation 3%  
Functional Depreciation  
Total Depreciation 3% (3,688)  
Total RCNLD 119,248  
Lump Sums  
Total Building Value 119,248 \$ 414.06 Per SqFt