



Rogers

Assessment Property Record Card for Tax Year 2026

Data provided by LISA DELOZIER County Assessor

Date 04/18/2026
 Time 08:16:38
 Page 1

Assessment Data					Primary Image																																																																																																																				
Account 660067608 Parcel ID 23N15E-19-4-00000-000-0000 Cadastral ID 19-23-15-01020 Property Type REAL - Real Property Property Class RR VI Area 2 Tax Area 10 - OOLOGAH RURAL/NW FIRE Name ID 331915 LOVE, STEVIE L & KIMBERLY K 4801 E 390 RD OOLOGAH OK 74053-0000 Parcel Location Situs 04801 E 390 RD Subdivision Lot/Block / Parcel Size 2.5 - Acres Sec/Twn/Rng 19 / 23 / 15 / 4 Neighborhood 4020 - OOLOGAH School District S004 - OOLOGAH SCHOOLS					<p>\\tsclient\C\Users\CB\Pictures\2020-06-01\IMG_0011.JPG 6/1/2020</p>																																																																																																																				
Legal Description Lat/Long: 36.45336098 -95.74291521																																																																																																																									
E2 E2 SW SE SE					Building Permits <table border="1"> <thead> <tr> <th>Number</th> <th>Description</th> <th>Opened</th> <th>Closed</th> <th>Amount</th> </tr> </thead> <tbody> <tr> <td>8426</td> <td>R5-POLE BARN</td> <td>12/2003</td> <td>01/2005</td> <td>6,000</td> </tr> </tbody> </table>					Number	Description	Opened	Closed	Amount	8426	R5-POLE BARN	12/2003	01/2005	6,000																																																																																																						
Number	Description	Opened	Closed	Amount																																																																																																																					
8426	R5-POLE BARN	12/2003	01/2005	6,000																																																																																																																					
Exemptions <table border="1"> <thead> <tr> <th>Code</th> <th>Type</th> <th>Active</th> <th>Maximum</th> <th>Exemption</th> </tr> </thead> <tbody> <tr> <td>H</td> <td>Homestead</td> <td>No</td> <td>1,000</td> <td></td> </tr> </tbody> </table>					Code	Type	Active	Maximum	Exemption	H	Homestead	No	1,000		Sale History <table border="1"> <thead> <tr> <th>Bk/Pg</th> <th>Grantor</th> <th>Date</th> <th>Price</th> <th>Code</th> </tr> </thead> <tbody> <tr> <td>/</td> <td>FORTNEY, FRANK L &</td> <td>03/14/2016</td> <td>0</td> <td>12</td> </tr> <tr> <td>2282/326</td> <td>COLLETT, BLAINE & SONYA</td> <td>10/30/2012</td> <td>65,000</td> <td>YES</td> </tr> <tr> <td>2268/44</td> <td>COOPER, CHARLES BRIAN &</td> <td>08/27/2012</td> <td>68,000</td> <td>YES</td> </tr> <tr> <td>1064/610</td> <td>COOPER, ELMER L</td> <td>03/29/1997</td> <td>0</td> <td>No</td> </tr> </tbody> </table>					Bk/Pg	Grantor	Date	Price	Code	/	FORTNEY, FRANK L &	03/14/2016	0	12	2282/326	COLLETT, BLAINE & SONYA	10/30/2012	65,000	YES	2268/44	COOPER, CHARLES BRIAN &	08/27/2012	68,000	YES	1064/610	COOPER, ELMER L	03/29/1997	0	No																																																																													
Code	Type	Active	Maximum	Exemption																																																																																																																					
H	Homestead	No	1,000																																																																																																																						
Bk/Pg	Grantor	Date	Price	Code																																																																																																																					
/	FORTNEY, FRANK L &	03/14/2016	0	12																																																																																																																					
2282/326	COLLETT, BLAINE & SONYA	10/30/2012	65,000	YES																																																																																																																					
2268/44	COOPER, CHARLES BRIAN &	08/27/2012	68,000	YES																																																																																																																					
1064/610	COOPER, ELMER L	03/29/1997	0	No																																																																																																																					
Parcel Valuation <table border="1"> <thead> <tr> <th>Source</th> <th>REAL</th> <th>Fair Cash</th> <th>Capped</th> <th>Asmnt Level</th> <th>Assessed</th> <th>Levy Rate</th> <th>108.182</th> <th>Current Tax</th> </tr> </thead> <tbody> <tr> <td>Remove Cap</td> <td>2013</td> <td>Land Value 66,383</td> <td>44,021</td> <td>11%</td> <td>4,842</td> <td>Assessed</td> <td>11,839</td> <td>1,280.76</td> </tr> <tr> <td>Year Frozen</td> <td>0</td> <td>Improvements 74,793</td> <td>63,608</td> <td></td> <td>6,997</td> <td>Penalty</td> <td>0</td> <td></td> </tr> <tr> <td>Uncapped Value</td> <td>0</td> <td>Mobile Home 0</td> <td>0</td> <td></td> <td>0</td> <td>Exemption</td> <td>0</td> <td>0.00</td> </tr> <tr> <td>TIF Project ID</td> <td>0</td> <td>Total Value 141,176</td> <td>107,629</td> <td></td> <td>11,839</td> <td>Total Taxable</td> <td>11,839</td> <td>1,281.00</td> </tr> </tbody> </table>										Source	REAL	Fair Cash	Capped	Asmnt Level	Assessed	Levy Rate	108.182	Current Tax	Remove Cap	2013	Land Value 66,383	44,021	11%	4,842	Assessed	11,839	1,280.76	Year Frozen	0	Improvements 74,793	63,608		6,997	Penalty	0		Uncapped Value	0	Mobile Home 0	0		0	Exemption	0	0.00	TIF Project ID	0	Total Value 141,176	107,629		11,839	Total Taxable	11,839	1,281.00																																																																			
Source	REAL	Fair Cash	Capped	Asmnt Level	Assessed	Levy Rate	108.182	Current Tax																																																																																																																	
Remove Cap	2013	Land Value 66,383	44,021	11%	4,842	Assessed	11,839	1,280.76																																																																																																																	
Year Frozen	0	Improvements 74,793	63,608		6,997	Penalty	0																																																																																																																		
Uncapped Value	0	Mobile Home 0	0		0	Exemption	0	0.00																																																																																																																	
TIF Project ID	0	Total Value 141,176	107,629		11,839	Total Taxable	11,839	1,281.00																																																																																																																	
Assessment History <table border="1"> <thead> <tr> <th>Tax Year</th> <th>Statement Number</th> <th>Billed Owner</th> <th>Tax Area</th> <th>Total Value</th> <th>Exemptions</th> <th>Taxable Value</th> <th>Billed Tax</th> </tr> </thead> <tbody> <tr><td>2025</td><td>2025-660067608</td><td>LOVE, STEVIE L &</td><td>10</td><td>136,916</td><td>0</td><td>11,276</td><td>1,220.00</td></tr> <tr><td>2024</td><td>2024-660067608</td><td>LOVE, STEVIE L &</td><td>10</td><td>135,905</td><td>0</td><td>10,739</td><td>1,124.00</td></tr> <tr><td>2023</td><td>2023-660067608</td><td>LOVE, STEVIE L &</td><td>10</td><td>92,975</td><td>0</td><td>10,228</td><td>1,063.00</td></tr> <tr><td>2022</td><td>2022-660067608</td><td>LOVE, STEVIE L &</td><td>10</td><td>89,599</td><td>0</td><td>9,856</td><td>1,020.00</td></tr> <tr><td>2021</td><td>2021-660067608</td><td>LOVE, STEVIE L &</td><td>10</td><td>90,550</td><td>0</td><td>9,961</td><td>1,038.00</td></tr> <tr><td>2020</td><td>2020-660067608</td><td>LOVE, STEVIE L &</td><td>10</td><td>86,574</td><td>0</td><td>9,524</td><td>1,008.00</td></tr> <tr><td>2019</td><td>2019-660067608</td><td>FORTNEY, FRANK L &</td><td>10</td><td>83,298</td><td>0</td><td>9,163</td><td>951.00</td></tr> <tr><td>2018</td><td>2018-660067608</td><td>FORTNEY, FRANK L &</td><td>10</td><td>86,813</td><td>0</td><td>9,126</td><td>980.00</td></tr> <tr><td>2017</td><td>2017-660067608</td><td>FORTNEY, FRANK L &</td><td>10</td><td>82,300</td><td>0</td><td>8,691</td><td>988.00</td></tr> <tr><td>2016</td><td>2016-660067608</td><td>FORTNEY, FRANK L &</td><td>10</td><td>77,782</td><td>0</td><td>8,277</td><td>857.00</td></tr> <tr><td>2015</td><td>2015-660067608</td><td>FORTNEY, FRANK L &</td><td>10</td><td>71,667</td><td>0</td><td>7,883</td><td>773.00</td></tr> <tr><td>2014</td><td>2014-660067608</td><td>FORTNEY, FRANK L &</td><td>10</td><td>71,048</td><td>0</td><td>7,815</td><td>765.00</td></tr> <tr><td>2013</td><td>2013-660067608</td><td>FORTNEY, FRANK L &/OR</td><td>10</td><td>68,209</td><td>0</td><td>7,503</td><td>710.00</td></tr> </tbody> </table>										Tax Year	Statement Number	Billed Owner	Tax Area	Total Value	Exemptions	Taxable Value	Billed Tax	2025	2025-660067608	LOVE, STEVIE L &	10	136,916	0	11,276	1,220.00	2024	2024-660067608	LOVE, STEVIE L &	10	135,905	0	10,739	1,124.00	2023	2023-660067608	LOVE, STEVIE L &	10	92,975	0	10,228	1,063.00	2022	2022-660067608	LOVE, STEVIE L &	10	89,599	0	9,856	1,020.00	2021	2021-660067608	LOVE, STEVIE L &	10	90,550	0	9,961	1,038.00	2020	2020-660067608	LOVE, STEVIE L &	10	86,574	0	9,524	1,008.00	2019	2019-660067608	FORTNEY, FRANK L &	10	83,298	0	9,163	951.00	2018	2018-660067608	FORTNEY, FRANK L &	10	86,813	0	9,126	980.00	2017	2017-660067608	FORTNEY, FRANK L &	10	82,300	0	8,691	988.00	2016	2016-660067608	FORTNEY, FRANK L &	10	77,782	0	8,277	857.00	2015	2015-660067608	FORTNEY, FRANK L &	10	71,667	0	7,883	773.00	2014	2014-660067608	FORTNEY, FRANK L &	10	71,048	0	7,815	765.00	2013	2013-660067608	FORTNEY, FRANK L &/OR	10	68,209	0	7,503	710.00
Tax Year	Statement Number	Billed Owner	Tax Area	Total Value	Exemptions	Taxable Value	Billed Tax																																																																																																																		
2025	2025-660067608	LOVE, STEVIE L &	10	136,916	0	11,276	1,220.00																																																																																																																		
2024	2024-660067608	LOVE, STEVIE L &	10	135,905	0	10,739	1,124.00																																																																																																																		
2023	2023-660067608	LOVE, STEVIE L &	10	92,975	0	10,228	1,063.00																																																																																																																		
2022	2022-660067608	LOVE, STEVIE L &	10	89,599	0	9,856	1,020.00																																																																																																																		
2021	2021-660067608	LOVE, STEVIE L &	10	90,550	0	9,961	1,038.00																																																																																																																		
2020	2020-660067608	LOVE, STEVIE L &	10	86,574	0	9,524	1,008.00																																																																																																																		
2019	2019-660067608	FORTNEY, FRANK L &	10	83,298	0	9,163	951.00																																																																																																																		
2018	2018-660067608	FORTNEY, FRANK L &	10	86,813	0	9,126	980.00																																																																																																																		
2017	2017-660067608	FORTNEY, FRANK L &	10	82,300	0	8,691	988.00																																																																																																																		
2016	2016-660067608	FORTNEY, FRANK L &	10	77,782	0	8,277	857.00																																																																																																																		
2015	2015-660067608	FORTNEY, FRANK L &	10	71,667	0	7,883	773.00																																																																																																																		
2014	2014-660067608	FORTNEY, FRANK L &	10	71,048	0	7,815	765.00																																																																																																																		
2013	2013-660067608	FORTNEY, FRANK L &/OR	10	68,209	0	7,503	710.00																																																																																																																		



Rogers

Assessment Property Record Card for Tax Year 2026

Data provided by LISA DELOZIER County Assessor

Date 04/18/2026
 Time 08:16:38
 Page 2

Lot Data		Square-Foot - NBHD 4020 #1		Primary Image				
Lot Size								
Lot Count								
Units Buildable	2.5							
Non-Ag Acres	2.5242							
Topography								
Street Access								
Utilities								
Amenities	LAND QUALITY	0	0					
Method	Square-Foot							
Base Lot Value	109,954.00 x .60 = 66,383							
Factor Value								
Adjustments	1.0000							
Lot Value	66,383							
Residential Data				\\tsclient\C\Users\CB\Pictures\2020-06-01\IMG_0011.JPG 6/1/2020				
Type				GRM Approach				
Condition	-			GRM Code				
Quality	-			Gross Rent	0.00			
Architecture				Indicated Value				
Style				Multiple Regression				
Exterior Wall				MRA Code				
Base/Total Area /				Adusted R				
Style				Indicated Value				
HVAC				Direct Comparables				
Roof Cover				Selection Model	1 Res			
Area on Slab				Adjustment Model	A2 AO Test			
Fixture/RghIn /				Comparables				
Bed/F/H Bath / /				Indicated Value				
Basement Area				Value Reconciliation				
Garage Type				Selected Approach	Cost Approach			
Remodel				Improvements				
Year/Eff Age /				Lot Value	66,383			
Cost Approach				Indicated Value	66,383			
Manual : 01/2025				Agland Value	0.00 Per SqFt			
Base Cost	0.00	Total Misc Impr	+ 0	Site Improvements	27,673			
Roofing Adj	+ 0.00	Garage Cost	+ 0	Total Value	94,056			
Subfloor Adj	+ 0.00	Total RCN	= 0		0.00 Total Value Per SqFt			
Heat/Cool Adj	+ 0.00	Depreciation (0%)	- 0					
Plumbing Adj	+ 0.00	Lump Sums	+ 0					
Basement Adj	+ 0.00	RCNLD	= 0					
Adj Base Cost	= 0.00	Lot Value	+ 66,383					
Total Area	x	Indicated Value	= 66,383					
Adjusted Cost	= 0	Value Per SqFt	0.00					
Miscellaneous Improvements								
Code	Description	Sketch ID	Size	Year	Units	Unit Cost	Depr	Value



Rogers

Assessment Property Record Card for Tax Year 2026

Data provided by LISA DELOZIER County Assessor

Date 04/18/2026
Time 08:16:38
Page 3

660067608

Outbuildings/Site Improvements

Building Image	Code	Description	Dimensions	Floor	Roofing	Total Units
	SHDS	Shed - Small	12x40x8	Plank	Formed Metal	480
	Qual 3	Cond 3	Year 2022	Eff Age 3		
Valuation Summary		Modifier Total	RCN	Depr (14% Phys/ % Func)		RCNLD
Base Cost (19.96 x 480)		9,581		9,581 1,341		8,240
	SHDS	Shed - Small	8x8x8	Plank	Formed Metal	64
	Qual 3	Cond 3	Year 2018	Eff Age 6		
Valuation Summary		Modifier Total	RCN	Depr (28% Phys/ 100% Func)		RCNLD
Base Cost (32.15 x 64)		2,058		2,058 2,058		
	SHDS	Shed - Small	8x10x6	Dirt	Formed Metal	80
	Qual 3	Cond 3	Year 2016	Eff Age 8		
Valuation Summary		Modifier Total	RCN	Depr (37% Phys/ 100% Func)		RCNLD
Base Cost (24.83 x 80)		1,986		1,986 1,986		
	SHDS	Shed - Small	8x10x6	Dirt	Formed Metal	80
	Qual 2	Cond 3	Year 2016	Eff Age 8		
Valuation Summary		Modifier Total	RCN	Depr (37% Phys/ 100% Func)		RCNLD
Base Cost (19.83 x 80)		1,586		1,586 1,586		
	SHDS	Shed - Small	10x12x8	Dirt	Formed Metal	120
	Qual 3	Cond 3	Year 2016	Eff Age 8		
Valuation Summary		Modifier Total	RCN	Depr (37% Phys/ 100% Func)		RCNLD
Base Cost (20.98 x 120)		2,518		2,518 2,518		
	UTIL	Shop Building	28x24x8	Concrete	Formed Metal	672
	Qual 3	Cond 3	Year 2015	Eff Age 8		
Valuation Summary		Modifier Total	RCN	Depr (15% Phys/ % Func)		RCNLD
Base Cost (31.86 x 672)		21,410		21,410 3,212		18,198
	SHDS	Shed - Small	10x12x8	Plank	Composition Shingle	120
	Qual 3	Cond 3	Year 2015	Eff Age 8		
Valuation Summary		Modifier Total	RCN	Depr (37% Phys/ 100% Func)		RCNLD
Base Cost (25.97 x 120)		3,116		3,116 3,116		



Rogers

Assessment Property Record Card for Tax Year 2026

Data provided by LISA DELOZIER County Assessor

Date 04/18/2026
Time 08:16:38
Page 4

660067608

Outbuildings/Site Improvements

Building Image	Code	Description	Dimensions	Floor	Roofing	Total Units
	PCPT	Carport - Portable	20x20x8	Gravel	Formed Metal	400
	Qual 3	Cond 3	Year 2015	Eff Age 8		

Valuation Summary	Modifier Total	RCN	Depr (33% Phys/ % Func)	RCNLD
Base Cost (4.61 x 400)	1,844	1,844	609	1,235



Rogers

Assessment Property Record Card for Tax Year 2026

Data provided by LISA DELOZIER County Assessor

Date 04/18/2026
 Time 08:16:38
 Page 5

Lot Data	
Lot Size	-
Lot Count	
Units Buildable	
Non-Ag Acres	
Topography	
Street Access	
Utilities	
Amenities	LAND QUALITY
Method	
Base Lot Value	
Factor Value	
Adjustments	
Lot Value	



Residential Data	
Type	6 Mobile Home 44 x 28
Condition	3 - Average
Quality	3.6 - Average
Architecture	1DW EXCP DWIDE MH
Style	100% Double Wide
Exterior Wall	100% Frame, Siding, Vinyl
Base/Total Area	1,232 / 1,232
Style	100% Double Wide
HVAC	100% Warmed & Cooled Air 1 Wall Air Conditioner
Roof Cover	1 Composition Shingle
Area on Slab	0
Fixture/RghIn	7 /
Bed/F/H Bath	3 / 2.0 /
Basement Area	
Garage Type	
Remodel	
Year/Eff Age	1997 / 22

GRM Approach

GRM Code	
Gross Rent	0.00
Indicated Value	

Multiple Regression

MRA Code	
Adusted R	
Indicated Value	

Direct Comparables

Selection Model	1 Res
Adjustment Model	A2 AO Test
Comparables	
Indicated Value	

Value Reconciliation

Selected Approach	Cost Approach
Improvements	47,120
Lot Value	
Indicated Value	47,120
Agland Value	38.25 Per SqFt
Site Improvements	
Total Value	47,120
	38.25 Total Value Per SqFt

Cost Approach		Manual : 01/2025	
Base Cost	71.67	Total Misc Impr	+ 0
Roofing Adj	+ 3.36	Garage Cost	+ 0
Subfloor Adj	+ 0.00	Total RCN	= 109,426
Heat/Cool Adj	+ 4.35	Depreciation (60%)	- 65,656
Plumbing Adj	+ 9.44	Lump Sums	+ 3,350
Basement Adj	+ 0.00	RCNLD	= 47,120
Adj Base Cost	= 88.82	Lot Value	+ 47,120
Total Area	x 1,232	Indicated Value	= 47,120
Adjusted Cost	= 109,426	Value Per SqFt	38.25

Miscellaneous Improvements

Code	Description	Sketch ID	Size	Year	Units	Unit Cost	Depr	Value
WODO	WOOD DECK - OPEN	131771	7x7		49	34.19		1,675
WODO	WOOD DECK - OPEN	131772	7x7		49	34.19		1,675



Rogers

Assessment Property Record Card for Tax Year 2026

Data provided by LISA DELOZIER County Assessor

Date 04/18/2026
Time 08:16:38
Page 6

Sketch Image

660067608

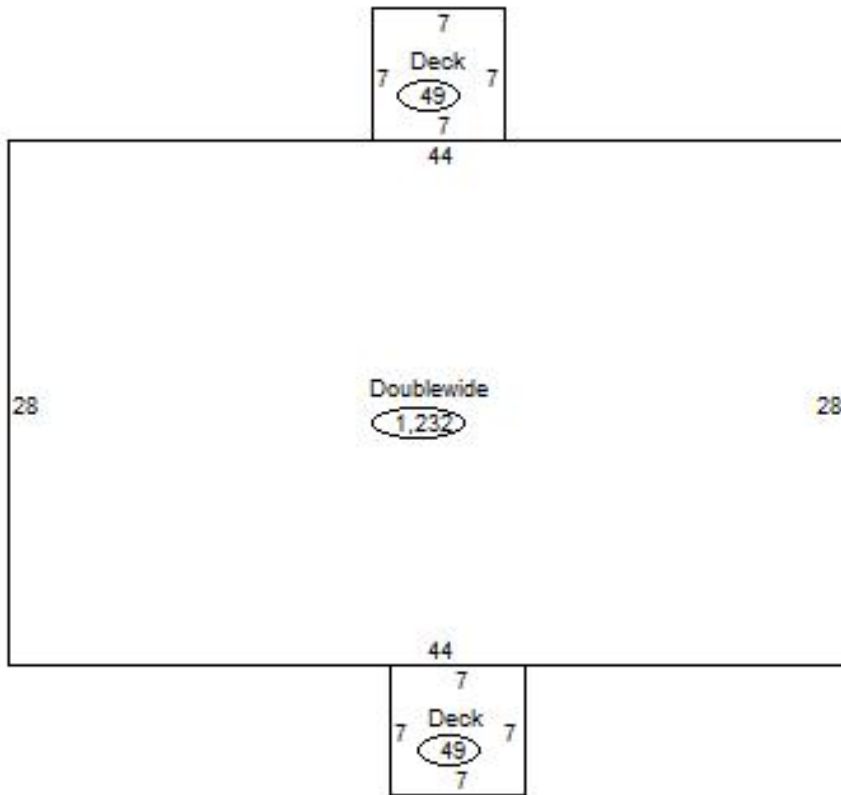

Sketch Vector Information

Sequence	Code	Type	Built Over	Scale	Section Label	Base Area	Multiplier	Total Area
1	R	14		13	Doublewide	1,232	1.000	1,232
2	M	WODO		13	WODO	49	1.000	49
3	M	WODO		13	WODO	49	1.000	49
Total Building Area						1,232		1,232