



Rogers

Assessment Property Record Card for Tax Year 2026

Data provided by LISA DELOZIER County Assessor

Date 04/18/2026
 Time 06:32:03
 Page 1

Assessment Data					Primary Image																																																																																																																				
Account 660067808 Parcel ID 000000-00-0-00633-002-0007 Cadastral ID 34-22-16-04151 Property Type REAL - Real Property Property Class RRP VI Area 1 Tax Area 9 - SEQUOYAH/ NO FIRE Name ID 316328 TRAUT, PAULA 18175 QUAIL CREEK RD CLAREMORE OK 74017-0000 Parcel Location Situs 18175 QUAIL CREEK RD Subdivision QUAIL MEADOW Lot/Block 0007 / 0002 Parcel Size .5 - Lots Sec/Twn/Rng 34 / 22 / 16 / 5 Neighborhood 1029 - R-V01-NE SEQUOYAH School District S006 - SEQUOYAH SCHOOLS																																																																																																																									
Legal Description Lat/Long: 36.34817269 -95.58393701 N 72' LOT 7 & S 72' LOT 8 BLOCK 2 QUAIL MEADOWS										Building Permits <table border="1"> <thead> <tr> <th>Number</th> <th>Description</th> <th>Opened</th> <th>Closed</th> <th>Amount</th> </tr> </thead> <tbody> <tr> <td colspan="5"> </td> </tr> </tbody> </table>					Number	Description	Opened	Closed	Amount																																																																																																						
Number	Description	Opened	Closed	Amount																																																																																																																					
Exemptions <table border="1"> <thead> <tr> <th>Code</th> <th>Type</th> <th>Active</th> <th>Maximum</th> <th>Exemption</th> </tr> </thead> <tbody> <tr> <td colspan="5"> </td> </tr> </tbody> </table>					Code	Type	Active	Maximum	Exemption						Sale History <table border="1"> <thead> <tr> <th>Bk/Pg</th> <th>Grantor</th> <th>Date</th> <th>Price</th> <th>Code</th> </tr> </thead> <tbody> <tr> <td>2502/205</td> <td>STROBLE, JODY DANIELLE</td> <td>09/08/2015</td> <td>161,000</td> <td>YES</td> </tr> <tr> <td>2159/486</td> <td>US BANK NATL ASSOC</td> <td>02/08/2011</td> <td>118,000</td> <td>3</td> </tr> <tr> <td>2143/808</td> <td>MOORE, DALE &</td> <td>11/29/2010</td> <td>0</td> <td>10</td> </tr> <tr> <td>1628/350</td> <td>MULLEN, DONALD L &</td> <td>10/12/2004</td> <td>145,000</td> <td>YES</td> </tr> <tr> <td>1068/237</td> <td>STIMSON, TERRANCE J &</td> <td>06/06/1997</td> <td>14,000</td> <td>No</td> </tr> </tbody> </table>					Bk/Pg	Grantor	Date	Price	Code	2502/205	STROBLE, JODY DANIELLE	09/08/2015	161,000	YES	2159/486	US BANK NATL ASSOC	02/08/2011	118,000	3	2143/808	MOORE, DALE &	11/29/2010	0	10	1628/350	MULLEN, DONALD L &	10/12/2004	145,000	YES	1068/237	STIMSON, TERRANCE J &	06/06/1997	14,000	No																																																																								
Code	Type	Active	Maximum	Exemption																																																																																																																					
Bk/Pg	Grantor	Date	Price	Code																																																																																																																					
2502/205	STROBLE, JODY DANIELLE	09/08/2015	161,000	YES																																																																																																																					
2159/486	US BANK NATL ASSOC	02/08/2011	118,000	3																																																																																																																					
2143/808	MOORE, DALE &	11/29/2010	0	10																																																																																																																					
1628/350	MULLEN, DONALD L &	10/12/2004	145,000	YES																																																																																																																					
1068/237	STIMSON, TERRANCE J &	06/06/1997	14,000	No																																																																																																																					
Parcel Valuation <table border="1"> <thead> <tr> <th>Source</th> <th>REAL</th> <th>Fair Cash</th> <th>Capped</th> <th>Asmnt Level</th> <th>Assessed</th> <th>Levy Rate</th> <th>88.320</th> <th>Current Tax</th> </tr> </thead> <tbody> <tr> <td>Remove Cap</td> <td>2016</td> <td>Land Value 66,303</td> <td>51,050</td> <td>11%</td> <td>5,616</td> <td>Assessed</td> <td>24,428</td> <td>2,157.48</td> </tr> <tr> <td>Year Frozen</td> <td>0</td> <td>Improvements 173,289</td> <td>171,017</td> <td></td> <td>18,812</td> <td>Penalty</td> <td>0</td> <td></td> </tr> <tr> <td>Uncapped Value</td> <td>0</td> <td>Mobile Home 0</td> <td>0</td> <td></td> <td>0</td> <td>Exemption</td> <td>0</td> <td>0.00</td> </tr> <tr> <td>TIF Project ID</td> <td>0</td> <td>Total Value 239,592</td> <td>222,067</td> <td></td> <td>24,428</td> <td>Total Taxable</td> <td>24,428</td> <td>2,157.00</td> </tr> </tbody> </table>										Source	REAL	Fair Cash	Capped	Asmnt Level	Assessed	Levy Rate	88.320	Current Tax	Remove Cap	2016	Land Value 66,303	51,050	11%	5,616	Assessed	24,428	2,157.48	Year Frozen	0	Improvements 173,289	171,017		18,812	Penalty	0		Uncapped Value	0	Mobile Home 0	0		0	Exemption	0	0.00	TIF Project ID	0	Total Value 239,592	222,067		24,428	Total Taxable	24,428	2,157.00																																																																			
Source	REAL	Fair Cash	Capped	Asmnt Level	Assessed	Levy Rate	88.320	Current Tax																																																																																																																	
Remove Cap	2016	Land Value 66,303	51,050	11%	5,616	Assessed	24,428	2,157.48																																																																																																																	
Year Frozen	0	Improvements 173,289	171,017		18,812	Penalty	0																																																																																																																		
Uncapped Value	0	Mobile Home 0	0		0	Exemption	0	0.00																																																																																																																	
TIF Project ID	0	Total Value 239,592	222,067		24,428	Total Taxable	24,428	2,157.00																																																																																																																	
Assessment History <table border="1"> <thead> <tr> <th>Tax Year</th> <th>Statement Number</th> <th>Billed Owner</th> <th>Tax Area</th> <th>Total Value</th> <th>Exemptions</th> <th>Taxable Value</th> <th>Billed Tax</th> </tr> </thead> <tbody> <tr><td>2025</td><td>2025-660067808</td><td>TRAUT, PAULA</td><td>9</td><td>232,727</td><td>0</td><td>23,264</td><td>2,055.00</td></tr> <tr><td>2024</td><td>2024-660067808</td><td>TRAUT, PAULA</td><td>9</td><td>240,139</td><td>0</td><td>22,156</td><td>1,965.00</td></tr> <tr><td>2023</td><td>2023-660067808</td><td>TRAUT, PAULA</td><td>9</td><td>196,227</td><td>0</td><td>21,102</td><td>1,916.00</td></tr> <tr><td>2022</td><td>2022-660067808</td><td>TRAUT, PAULA</td><td>9</td><td>188,108</td><td>0</td><td>20,097</td><td>1,845.00</td></tr> <tr><td>2021</td><td>2021-660067808</td><td>TRAUT, PAULA</td><td>9</td><td>173,998</td><td>0</td><td>19,140</td><td>1,688.00</td></tr> <tr><td>2020</td><td>2020-660067808</td><td>TRAUT, PAULA</td><td>9</td><td>171,415</td><td>0</td><td>18,856</td><td>1,717.00</td></tr> <tr><td>2019</td><td>2019-660067808</td><td>TRAUT, PAULA</td><td>9</td><td>164,947</td><td>0</td><td>18,144</td><td>1,625.00</td></tr> <tr><td>2018</td><td>2018-660067808</td><td>TRAUT, PAULA</td><td>9</td><td>168,980</td><td>0</td><td>18,588</td><td>1,685.00</td></tr> <tr><td>2017</td><td>2017-660067808</td><td>TRAUT, PAULA</td><td>9</td><td>167,726</td><td>0</td><td>18,450</td><td>1,647.00</td></tr> <tr><td>2016</td><td>2016-660067808</td><td>TRAUT, PAULA</td><td>9</td><td>163,645</td><td>0</td><td>18,001</td><td>1,600.00</td></tr> <tr><td>2015</td><td>2015-660067808</td><td>TRAUT, PAULA</td><td>9</td><td>151,214</td><td>0</td><td>16,634</td><td>1,514.00</td></tr> <tr><td>2014</td><td>2014-660067808</td><td>STROBLE, JODY DANIELLE</td><td>9</td><td>152,349</td><td>0</td><td>16,480</td><td>1,520.00</td></tr> <tr><td>2013</td><td>2013-660067808</td><td>STROBLE, JODY DANIELLE</td><td>9</td><td>144,554</td><td>0</td><td>15,695</td><td>1,424.00</td></tr> </tbody> </table>										Tax Year	Statement Number	Billed Owner	Tax Area	Total Value	Exemptions	Taxable Value	Billed Tax	2025	2025-660067808	TRAUT, PAULA	9	232,727	0	23,264	2,055.00	2024	2024-660067808	TRAUT, PAULA	9	240,139	0	22,156	1,965.00	2023	2023-660067808	TRAUT, PAULA	9	196,227	0	21,102	1,916.00	2022	2022-660067808	TRAUT, PAULA	9	188,108	0	20,097	1,845.00	2021	2021-660067808	TRAUT, PAULA	9	173,998	0	19,140	1,688.00	2020	2020-660067808	TRAUT, PAULA	9	171,415	0	18,856	1,717.00	2019	2019-660067808	TRAUT, PAULA	9	164,947	0	18,144	1,625.00	2018	2018-660067808	TRAUT, PAULA	9	168,980	0	18,588	1,685.00	2017	2017-660067808	TRAUT, PAULA	9	167,726	0	18,450	1,647.00	2016	2016-660067808	TRAUT, PAULA	9	163,645	0	18,001	1,600.00	2015	2015-660067808	TRAUT, PAULA	9	151,214	0	16,634	1,514.00	2014	2014-660067808	STROBLE, JODY DANIELLE	9	152,349	0	16,480	1,520.00	2013	2013-660067808	STROBLE, JODY DANIELLE	9	144,554	0	15,695	1,424.00
Tax Year	Statement Number	Billed Owner	Tax Area	Total Value	Exemptions	Taxable Value	Billed Tax																																																																																																																		
2025	2025-660067808	TRAUT, PAULA	9	232,727	0	23,264	2,055.00																																																																																																																		
2024	2024-660067808	TRAUT, PAULA	9	240,139	0	22,156	1,965.00																																																																																																																		
2023	2023-660067808	TRAUT, PAULA	9	196,227	0	21,102	1,916.00																																																																																																																		
2022	2022-660067808	TRAUT, PAULA	9	188,108	0	20,097	1,845.00																																																																																																																		
2021	2021-660067808	TRAUT, PAULA	9	173,998	0	19,140	1,688.00																																																																																																																		
2020	2020-660067808	TRAUT, PAULA	9	171,415	0	18,856	1,717.00																																																																																																																		
2019	2019-660067808	TRAUT, PAULA	9	164,947	0	18,144	1,625.00																																																																																																																		
2018	2018-660067808	TRAUT, PAULA	9	168,980	0	18,588	1,685.00																																																																																																																		
2017	2017-660067808	TRAUT, PAULA	9	167,726	0	18,450	1,647.00																																																																																																																		
2016	2016-660067808	TRAUT, PAULA	9	163,645	0	18,001	1,600.00																																																																																																																		
2015	2015-660067808	TRAUT, PAULA	9	151,214	0	16,634	1,514.00																																																																																																																		
2014	2014-660067808	STROBLE, JODY DANIELLE	9	152,349	0	16,480	1,520.00																																																																																																																		
2013	2013-660067808	STROBLE, JODY DANIELLE	9	144,554	0	15,695	1,424.00																																																																																																																		



Rogers

Assessment Property Record Card for Tax Year 2026

Data provided by LISA DELOZIER County Assessor

Date 04/18/2026
 Time 06:32:04
 Page 2

Lot Data		Square-Foot - NBHD 1029 #1	
Lot Size			
Lot Count	1		
Units Buildable	1		
Non-Ag Acres	1.0402		
Topography			
Street Access			
Utilities			
Amenities	LAND QUALITY	0	
		0	
Method	Square-Foot		
Base Lot Value	45,310.00 x 1.46 = 66,303		
Factor Value			
Adjustments	1.0000		
Lot Value	66,303		

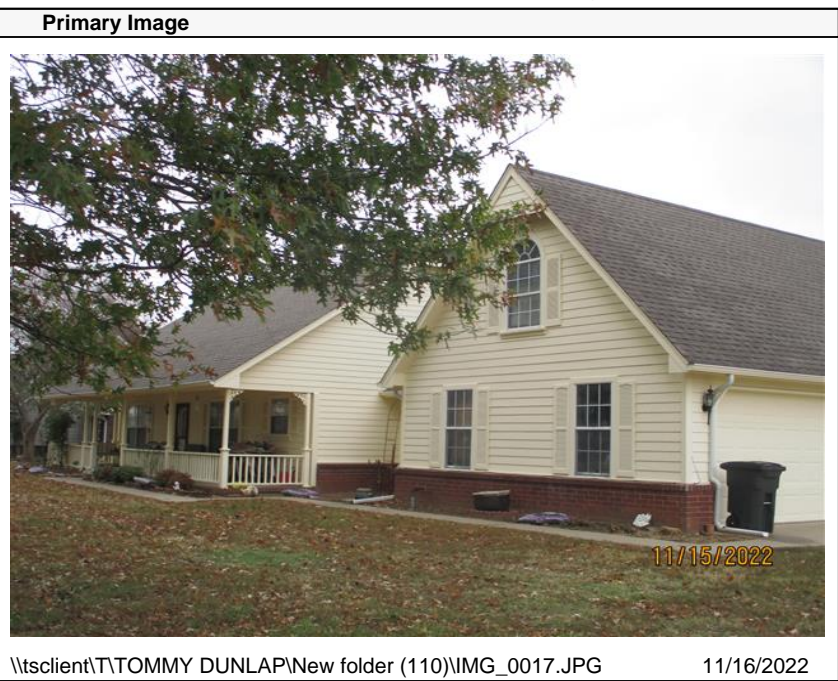

\\tsclient\T\TOMMY DUNLAP\New folder (110)\IMG_0017.JPG 11/16/2022

Residential Data	
Type	1 Single Family Residence
Condition	3 - Average
Quality	3 - Average
Architecture	
Style	100% One Story
Exterior Wall	90% Frame, Siding, Wood 10% Veneer, Masonry
Base/Total Area	1,502 / 1,502
Style	100% One Story
HVAC	100% Warmed & Cooled Air
Roof Cover	1 Composition Shingle
Area on Slab	1,502
Fixture/RghIn	11 /
Bed/F/H Bath	3 / 2.0 /
Basement Area	
Garage Type	690 Attached Garage - Unfinished
Remodel	
Year/Eff Age	1999 / 20

GRM Approach

GRM Code	
Gross Rent	0.00
Indicated Value	

Multiple Regression

MRA Code	1 Test
Adusted R	0.8445
Indicated Value	219,393 146.07 Per SqFt

Direct Comparables

Selection Model	A Adam Test
Adjustment Model	1 2022 Residential
Comparables	6
Indicated Value	248,090 Per SqFt

Value Reconciliation

Selected Approach	Cost Approach
Improvements	173,289
Lot Value	66,303
Indicated Value	239,592 159.52 Per SqFt
Agland Value	
Site Improvements	
Total Value	239,592 159.52 Total Value Per SqFt

Cost Approach Manual : 01/2025

Base Cost	102.30	Total Misc Impr	+	12,650
Roofing Adj	+ 4.80	Garage Cost	+	20,686
Subfloor Adj	+ -2.43	Total RCN	=	225,051
Heat/Cool Adj	+ 12.64	Depreciation (23%)	-	51,762
Plumbing Adj	+ 10.33	Lump Sums	+	0
Basement Adj	+ 0.00	RCNLD	=	173,289
Adj Base Cost	= 127.64	Lot Value	+	66,303
Total Area	x 1,502	Indicated Value	=	239,592
Adjusted Cost	= 191,715	Value Per SqFt		159.52

Miscellaneous Improvements

Code	Description	Sketch ID	Size	Year	Units	Unit Cost	Depr	Value
PRCH	SLAB PORCH - COVERED	82410	42x7		294	26.01		7,647
PRCH	SLAB PORCH - COVERED	82411	19x10		190	26.33		5,003



Rogers

Assessment Property Record Card for Tax Year 2026

Data provided by LISA DELOZIER County Assessor

Date 04/18/2026

Time 06:32:04

Page 3

Sketch Image

660067808

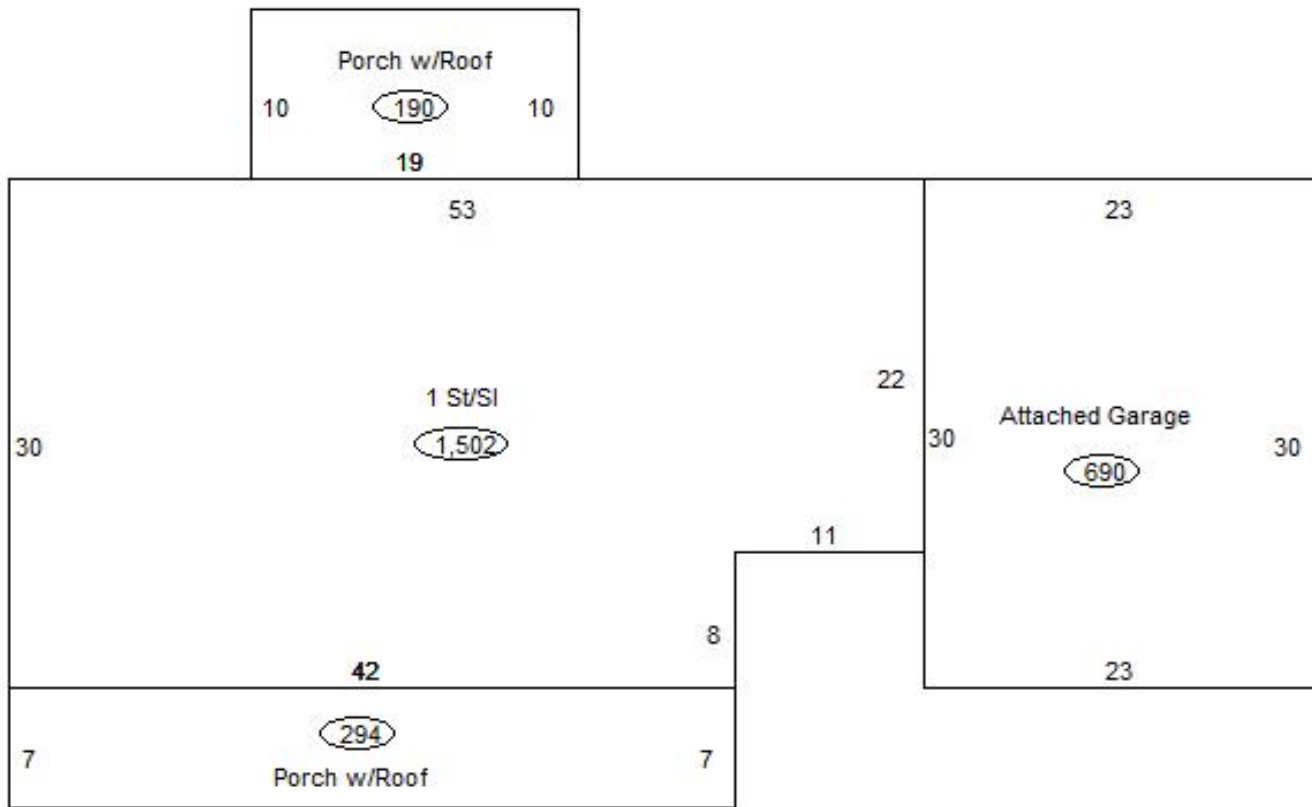

Sketch Vector Information

Sequence	Code	Type	Built Over	Scale	Section Label	Base Area	Multiplier	Total Area
1	R	1	Slab	13	1 St/SI	1,502	1.000	1,502
2	G	1		13	Attached Garage	690	1.000	690
3	M	PRCH		13	SLBC	294	1.000	294
4	M	PRCH		13	SLBC	190	1.000	190
Total Building Area						1,502		1,502



Rogers



Assessment Property Record Card for Tax Year 2026

Data provided by LISA DELOZIER County Assessor

Date 04/18/2026
Time 06:32:04
Page 4

660067808

Outbuildings/Site Improvements

Building Image	Code	Description	Dimensions	Floor	Roofing	Total Units
	STF	STG FAIR	0x0x0			
	Qual	2	Cond	Year	Eff Age	
	Valuation Summary		Modifier Total	RCN	Depr (0% Phys/ % Func)	RCNLD
	Base Cost (4.68 x)					
	STF	STG FAIR	0x0x0			
	Qual	2	Cond	Year	Eff Age	
	Valuation Summary		Modifier Total	RCN	Depr (0% Phys/ % Func)	RCNLD
	Base Cost (4.68 x)					