



Rogers

Assessment Property Record Card for Tax Year 2026

Data provided by LISA DELOZIER County Assessor

Date 04/17/2026
Time 01:15:24
Page 1

Assessment Data					Primary Image																																																																																																																				
Account 660068227 Parcel ID 22N16E-35-4-00000-000-0000 Cadastral ID 35-22-16-00910 Property Type REAL - Real Property Property Class RR VI Area 1 Tax Area 9 - SEQUOYAH/ NO FIRE Name ID 274545 FINCANNON, KELLY STEPHEN & DONNA GAYE 14500 E LAKE DR CLAREMORE OK 74017-0000																																																																																																																									
Parcel Location Situs 14500 E LAKE DR Subdivision Lot/Block / Parcel Size 1.02 - Acres Sec/Twn/Rng 35 / 22 / 16 / 4 Neighborhood 2216 - UNPLATTED School District S006 - SEQUOYAH SCHOOLS																																																																																																																									
Legal Description Lat/Long: 36.33667209 -95.56707063 TR IN S2 SW SE DESC AS; BEG AT PT 375' E OF SE/C S2 SW SE, TH N 238.50', TH S 81-15 W 202.36', TH S 207.71' TO S/L S2 SW SE, TH E 200' TO POB					Building Permits <table border="1"> <thead> <tr> <th>Number</th> <th>Description</th> <th>Opened</th> <th>Closed</th> <th>Amount</th> </tr> </thead> <tbody> <tr><td> </td><td> </td><td> </td><td> </td><td> </td></tr> <tr><td> </td><td> </td><td> </td><td> </td><td> </td></tr> <tr><td> </td><td> </td><td> </td><td> </td><td> </td></tr> <tr><td> </td><td> </td><td> </td><td> </td><td> </td></tr> <tr><td> </td><td> </td><td> </td><td> </td><td> </td></tr> </tbody> </table>					Number	Description	Opened	Closed	Amount																																																																																																											
Number	Description	Opened	Closed	Amount																																																																																																																					
Exemptions <table border="1"> <thead> <tr> <th>Code</th> <th>Type</th> <th>Active</th> <th>Maximum</th> <th>Exemption</th> </tr> </thead> <tbody> <tr> <td>H</td> <td>Homestead</td> <td>Yes</td> <td>1,000</td> <td>1,000</td> </tr> </tbody> </table>					Code	Type	Active	Maximum	Exemption	H	Homestead	Yes	1,000	1,000	Sale History <table border="1"> <thead> <tr> <th>Bk/Pg</th> <th>Grantor</th> <th>Date</th> <th>Price</th> <th>Code</th> </tr> </thead> <tbody> <tr> <td>1233/876</td> <td>PRUDENTIAL RESIDENTIAL SERVICE</td> <td>02/10/2000</td> <td>160,000</td> <td>Yes</td> </tr> <tr> <td>1233/873</td> <td>ANDERSON, SEAN W & MICHELLE J</td> <td>02/05/2000</td> <td>160,000</td> <td>No</td> </tr> <tr> <td>1162/339</td> <td>SCROGGINS, LEONARD &</td> <td>03/15/1999</td> <td>165,000</td> <td>Yes</td> </tr> <tr> <td>1096/633</td> <td>OSAGE OAKS INC</td> <td>01/23/1998</td> <td>22,500</td> <td>Yes</td> </tr> <tr> <td>1078/460</td> <td>ROBERTS, JIMMY D &</td> <td>08/23/1997</td> <td>0</td> <td>No</td> </tr> </tbody> </table>					Bk/Pg	Grantor	Date	Price	Code	1233/876	PRUDENTIAL RESIDENTIAL SERVICE	02/10/2000	160,000	Yes	1233/873	ANDERSON, SEAN W & MICHELLE J	02/05/2000	160,000	No	1162/339	SCROGGINS, LEONARD &	03/15/1999	165,000	Yes	1096/633	OSAGE OAKS INC	01/23/1998	22,500	Yes	1078/460	ROBERTS, JIMMY D &	08/23/1997	0	No																																																																								
Code	Type	Active	Maximum	Exemption																																																																																																																					
H	Homestead	Yes	1,000	1,000																																																																																																																					
Bk/Pg	Grantor	Date	Price	Code																																																																																																																					
1233/876	PRUDENTIAL RESIDENTIAL SERVICE	02/10/2000	160,000	Yes																																																																																																																					
1233/873	ANDERSON, SEAN W & MICHELLE J	02/05/2000	160,000	No																																																																																																																					
1162/339	SCROGGINS, LEONARD &	03/15/1999	165,000	Yes																																																																																																																					
1096/633	OSAGE OAKS INC	01/23/1998	22,500	Yes																																																																																																																					
1078/460	ROBERTS, JIMMY D &	08/23/1997	0	No																																																																																																																					
Parcel Valuation <table border="1"> <thead> <tr> <th>Source</th> <th>REAL</th> <th>Fair Cash</th> <th>Capped</th> <th>Asmnt Level</th> <th>Assessed</th> <th>Levy Rate</th> <th>88.320</th> <th>Current Tax</th> </tr> </thead> <tbody> <tr> <td>Remove Cap</td> <td>2001</td> <td>Land Value 31,441</td> <td>26,304</td> <td>11%</td> <td>2,893</td> <td>Assessed</td> <td>42,451</td> <td>3,749.27</td> </tr> <tr> <td>Year Frozen</td> <td>0</td> <td>Improvements 401,350</td> <td>359,618</td> <td></td> <td>39,558</td> <td>Penalty</td> <td>0</td> <td></td> </tr> <tr> <td>Uncapped Value</td> <td>0</td> <td>Mobile Home 0</td> <td>0</td> <td></td> <td>0</td> <td>Exemption</td> <td>1,000</td> <td>-88.00</td> </tr> <tr> <td>TIF Project ID</td> <td>0</td> <td>Total Value 432,791</td> <td>385,922</td> <td></td> <td>42,451</td> <td>Total Taxable</td> <td>41,451</td> <td>3,661.00</td> </tr> </tbody> </table>										Source	REAL	Fair Cash	Capped	Asmnt Level	Assessed	Levy Rate	88.320	Current Tax	Remove Cap	2001	Land Value 31,441	26,304	11%	2,893	Assessed	42,451	3,749.27	Year Frozen	0	Improvements 401,350	359,618		39,558	Penalty	0		Uncapped Value	0	Mobile Home 0	0		0	Exemption	1,000	-88.00	TIF Project ID	0	Total Value 432,791	385,922		42,451	Total Taxable	41,451	3,661.00																																																																			
Source	REAL	Fair Cash	Capped	Asmnt Level	Assessed	Levy Rate	88.320	Current Tax																																																																																																																	
Remove Cap	2001	Land Value 31,441	26,304	11%	2,893	Assessed	42,451	3,749.27																																																																																																																	
Year Frozen	0	Improvements 401,350	359,618		39,558	Penalty	0																																																																																																																		
Uncapped Value	0	Mobile Home 0	0		0	Exemption	1,000	-88.00																																																																																																																	
TIF Project ID	0	Total Value 432,791	385,922		42,451	Total Taxable	41,451	3,661.00																																																																																																																	
Assessment History <table border="1"> <thead> <tr> <th>Tax Year</th> <th>Statement Number</th> <th>Billed Owner</th> <th>Tax Area</th> <th>Total Value</th> <th>Exemptions</th> <th>Taxable Value</th> <th>Billed Tax</th> </tr> </thead> <tbody> <tr><td>2025</td><td>2025-660068227</td><td>FINCANNON, KELLY STEPHEN &</td><td>9</td><td>392,414</td><td>1000</td><td>40,215</td><td>3,552.00</td></tr> <tr><td>2024</td><td>2024-660068227</td><td>FINCANNON, KELLY STEPHEN &</td><td>9</td><td>414,740</td><td>1000</td><td>39,014</td><td>3,460.00</td></tr> <tr><td>2023</td><td>2023-660068227</td><td>FINCANNON, KELLY STEPHEN &</td><td>9</td><td>394,234</td><td>1000</td><td>37,849</td><td>3,436.00</td></tr> <tr><td>2022</td><td>2022-660068227</td><td>FINCANNON, KELLY STEPHEN &</td><td>9</td><td>398,826</td><td>1000</td><td>36,717</td><td>3,370.00</td></tr> <tr><td>2021</td><td>2021-660068227</td><td>FINCANNON, KELLY STEPHEN &</td><td>9</td><td>367,957</td><td>1000</td><td>35,619</td><td>3,141.00</td></tr> <tr><td>2020</td><td>2020-660068227</td><td>FINCANNON, KELLY STEPHEN &</td><td>9</td><td>361,532</td><td>1000</td><td>34,553</td><td>3,146.00</td></tr> <tr><td>2019</td><td>2019-660068227</td><td>FINCANNON, KELLY STEPHEN &</td><td>9</td><td>339,695</td><td>1000</td><td>33,517</td><td>3,002.00</td></tr> <tr><td>2018</td><td>2018-660068227</td><td>FINCANNON, KELLY STEPHEN &</td><td>9</td><td>350,012</td><td>1000</td><td>32,512</td><td>2,947.00</td></tr> <tr><td>2017</td><td>2017-660068227</td><td>FINCANNON, KELLY STEPHEN &</td><td>9</td><td>346,894</td><td>1000</td><td>31,536</td><td>2,815.00</td></tr> <tr><td>2016</td><td>2016-660068227</td><td>FINCANNON, KELLY STEPHEN &</td><td>9</td><td>337,137</td><td>1000</td><td>30,588</td><td>2,718.00</td></tr> <tr><td>2015</td><td>2015-660068227</td><td>FINCANNON, KELLY STEPHEN &</td><td>9</td><td>327,955</td><td>1000</td><td>29,668</td><td>2,700.00</td></tr> <tr><td>2014</td><td>2014-660068227</td><td>FINCANNON, KELLY STEPHEN &</td><td>9</td><td>332,217</td><td>1000</td><td>28,775</td><td>2,654.00</td></tr> <tr><td>2013</td><td>2013-660068227</td><td>FINCANNON, KELLY STEPHEN &</td><td>9</td><td>310,461</td><td>1000</td><td>27,908</td><td>2,532.00</td></tr> </tbody> </table>										Tax Year	Statement Number	Billed Owner	Tax Area	Total Value	Exemptions	Taxable Value	Billed Tax	2025	2025-660068227	FINCANNON, KELLY STEPHEN &	9	392,414	1000	40,215	3,552.00	2024	2024-660068227	FINCANNON, KELLY STEPHEN &	9	414,740	1000	39,014	3,460.00	2023	2023-660068227	FINCANNON, KELLY STEPHEN &	9	394,234	1000	37,849	3,436.00	2022	2022-660068227	FINCANNON, KELLY STEPHEN &	9	398,826	1000	36,717	3,370.00	2021	2021-660068227	FINCANNON, KELLY STEPHEN &	9	367,957	1000	35,619	3,141.00	2020	2020-660068227	FINCANNON, KELLY STEPHEN &	9	361,532	1000	34,553	3,146.00	2019	2019-660068227	FINCANNON, KELLY STEPHEN &	9	339,695	1000	33,517	3,002.00	2018	2018-660068227	FINCANNON, KELLY STEPHEN &	9	350,012	1000	32,512	2,947.00	2017	2017-660068227	FINCANNON, KELLY STEPHEN &	9	346,894	1000	31,536	2,815.00	2016	2016-660068227	FINCANNON, KELLY STEPHEN &	9	337,137	1000	30,588	2,718.00	2015	2015-660068227	FINCANNON, KELLY STEPHEN &	9	327,955	1000	29,668	2,700.00	2014	2014-660068227	FINCANNON, KELLY STEPHEN &	9	332,217	1000	28,775	2,654.00	2013	2013-660068227	FINCANNON, KELLY STEPHEN &	9	310,461	1000	27,908	2,532.00
Tax Year	Statement Number	Billed Owner	Tax Area	Total Value	Exemptions	Taxable Value	Billed Tax																																																																																																																		
2025	2025-660068227	FINCANNON, KELLY STEPHEN &	9	392,414	1000	40,215	3,552.00																																																																																																																		
2024	2024-660068227	FINCANNON, KELLY STEPHEN &	9	414,740	1000	39,014	3,460.00																																																																																																																		
2023	2023-660068227	FINCANNON, KELLY STEPHEN &	9	394,234	1000	37,849	3,436.00																																																																																																																		
2022	2022-660068227	FINCANNON, KELLY STEPHEN &	9	398,826	1000	36,717	3,370.00																																																																																																																		
2021	2021-660068227	FINCANNON, KELLY STEPHEN &	9	367,957	1000	35,619	3,141.00																																																																																																																		
2020	2020-660068227	FINCANNON, KELLY STEPHEN &	9	361,532	1000	34,553	3,146.00																																																																																																																		
2019	2019-660068227	FINCANNON, KELLY STEPHEN &	9	339,695	1000	33,517	3,002.00																																																																																																																		
2018	2018-660068227	FINCANNON, KELLY STEPHEN &	9	350,012	1000	32,512	2,947.00																																																																																																																		
2017	2017-660068227	FINCANNON, KELLY STEPHEN &	9	346,894	1000	31,536	2,815.00																																																																																																																		
2016	2016-660068227	FINCANNON, KELLY STEPHEN &	9	337,137	1000	30,588	2,718.00																																																																																																																		
2015	2015-660068227	FINCANNON, KELLY STEPHEN &	9	327,955	1000	29,668	2,700.00																																																																																																																		
2014	2014-660068227	FINCANNON, KELLY STEPHEN &	9	332,217	1000	28,775	2,654.00																																																																																																																		
2013	2013-660068227	FINCANNON, KELLY STEPHEN &	9	310,461	1000	27,908	2,532.00																																																																																																																		



Rogers

Assessment Property Record Card for Tax Year 2026

Data provided by LISA DELOZIER County Assessor

Date 04/17/2026
 Time 01:15:25
 Page 2

Lot Data		Square-Foot - NBHD 2216 #1	
Lot Size			
Lot Count			
Units Buildable	1		
Non-Ag Acres	0.9022		
Topography			
Street Access			
Utilities			
Amenities	LAND QUALITY	0	0
Method	Square-Foot		
Base Lot Value	39,301.00 x .80 = 31,441		
Factor Value			
Adjustments	1.0000		
Lot Value	31,441		



\\tsclient\TRANDY\11-14-2022\101_1114\IMG_0026.JPG 11/14/2022

Residential Data	
Type	1 Single Family Residence
Condition	3 - Average
Quality	4 - Good
Architecture	
Style	100% 1 1/2 Story Finished
Exterior Wall	100% Frame, Siding, Wood
Base/Total Area	2,899 / 4,072
Style	100% 1 1/2 Story Finished
HVAC	100% Warmed & Cooled Air
Roof Cover	1 Composition Shingle
Area on Slab	2,899
Fixture/RghIn	14 /
Bed/F/H Bath	4 / 2.5 /
Basement Area	
Garage Type	529 Attached Garage - Unfinished 2 Stalls
Remodel	
Year/Eff Age	1999 / 20

GRM Approach

GRM Code	
Gross Rent	0.00
Indicated Value	

Multiple Regression

MRA Code	1 Test
Adusted R	0.8445
Indicated Value	497,066 122.07 Per SqFt

Direct Comparables

Selection Model	1 Res
Adjustment Model	A2 AO Test
Comparables	
Indicated Value	

Value Reconciliation

Selected Approach	Cost Approach
Improvements	398,400
Lot Value	31,441
Indicated Value	429,841 105.56 Per SqFt
Agland Value	
Site Improvements	2,950
Total Value	432,791 106.28 Total Value Per SqFt

Cost Approach		Manual : 01/2025	
Base Cost	92.27	Total Misc Impr	+ 20,892
Roofing Adj	+ 4.04	Garage Cost	+ 25,381
Subfloor Adj	+ -3.11	Total RCN	= 517,403
Heat/Cool Adj	+ 16.31	Depreciation (23%)	- 119,003
Plumbing Adj	+ 6.19	Lump Sums	+ 0
Basement Adj	+ 0.00	RCNLD	= 398,400
Adj Base Cost	= 115.70	Lot Value	+ 31,441
Total Area	x 4,072	Indicated Value	= 429,841
Adjusted Cost	= 471,130	Value Per SqFt	105.56

Miscellaneous Improvements

Code	Description	Sketch ID	Size	Year	Units	Unit Cost	Depr	Value
FPR1	FIREPLACE - RESIDENTIAL 1 STORY	0		1	1	7,243.87		7,244
PRCH	SLAB PORCH - COVERED	82544		433	433	31.52		13,648



Rogers

Assessment Property Record Card for Tax Year 2026

Data provided by LISA DELOZIER County Assessor

Date 04/17/2026
 Time 01:15:25
 Page 3

Sketch Image

660068227

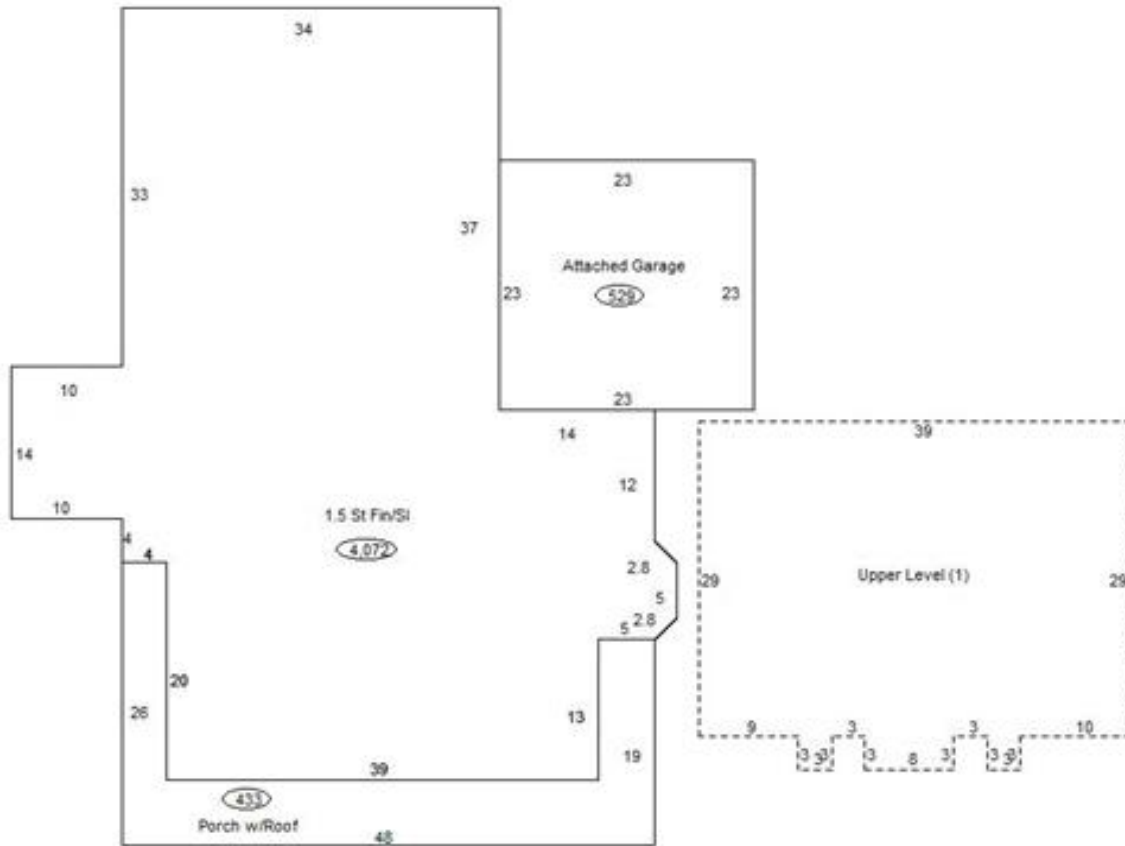

Sketch Vector Information

Sequence	Code	Type	Built Over	Scale	Section Label	Base Area	Multiplier	Total Area
1	R	5	Slab	13	1.5 St Fin/SI	2,899	1.405	4,072
2	G	1		13	Attached Garage	529	1.000	529
3	M	PRCH		13	SLBC	433	1.000	433
4	U	^UL		13	Upper Level (1)	1,173	1.000	1,173
Total Building Area						2,899		4,072



Rogers



Assessment Property Record Card for Tax Year 2026

Data provided by LISA DELOZIER County Assessor

Date 04/17/2026
 Time 01:15:25
 Page 4

660068227

Outbuildings/Site Improvements

Building Image	Code	Description	Dimensions	Floor	Roofing	Total Units	
	STF	STG FAIR	0x0x0				
	Qual	2	Cond	Year	2019	Eff Age	
	Valuation Summary		Modifier Total	RCN	Depr (100% Phys/ % Func)	RCNLD	
	Base Cost (4.68 x)						
	STF	STG FAIR	0x0x0				
	Qual	2	Cond	Year	2019	Eff Age	
	Valuation Summary		Modifier Total	RCN	Depr (100% Phys/ % Func)	RCNLD	
	Base Cost (4.68 x)						
	GF	GAZEBO FAIR	0x0x0			1	
	Qual	3	Cond 3	Year		Eff Age	
	Valuation Summary		Modifier Total	RCN	Depr (0% Phys/ % Func)	RCNLD	
	Base Cost (2,950.00 x 1)	2,950		2,950		2,950	