



Rogers

Assessment Property Record Card for Tax Year 2026

Data provided by LISA DELOZIER County Assessor

Date 04/16/2026
Time 23:19:19
Page 1

Assessment Data					Primary Image																																																																																																																				
Account 660068596 Parcel ID 000000-00-0-00157-002-0009 Cadastral ID 10-21-14-01730 Property Type REAL - Real Property Property Class RRP VI Area 4 Tax Area 3 - OWASSO RURAL/NO FIRE Name ID 283595 HENSON, LLOYD K & SUSAN M 15105 E 114TH ST N OWASSO OK 74055-0000																																																																																																																									
Parcel Location Situs 15105 E 114TH ST N Subdivision CHESTNUT FARMS Lot/Block 0009 / 0002 Parcel Size 1 - Lots Sec/Twn/Rng 10 / 21 / 14 / 5 Neighborhood 1018 - R-V04 SW OWASSO School District S021 - OWASSO SCHOOLS																																																																																																																									
Legal Description Lat/Long: 36.31929139 -95.80508989 LOT 9 BLOCK 2 CHESTNUT FARMS					Building Permits <table border="1"> <thead> <tr> <th>Number</th> <th>Description</th> <th>Opened</th> <th>Closed</th> <th>Amount</th> </tr> </thead> <tbody> <tr> <td> </td> <td> </td> <td> </td> <td> </td> <td> </td> </tr> </tbody> </table>					Number	Description	Opened	Closed	Amount																																																																																																											
Number	Description	Opened	Closed	Amount																																																																																																																					
Exemptions <table border="1"> <thead> <tr> <th>Code</th> <th>Type</th> <th>Active</th> <th>Maximum</th> <th>Exemption</th> </tr> </thead> <tbody> <tr> <td>H</td> <td>Homestead</td> <td>Yes</td> <td>1,000</td> <td>1,000</td> </tr> </tbody> </table>					Code	Type	Active	Maximum	Exemption	H	Homestead	Yes	1,000	1,000	Sale History <table border="1"> <thead> <tr> <th>Bk/Pg</th> <th>Grantor</th> <th>Date</th> <th>Price</th> <th>Code</th> </tr> </thead> <tbody> <tr> <td>1526/827</td> <td>HOPPER, BRIAN & SHEILA</td> <td>09/22/2003</td> <td>202,000</td> <td>YES</td> </tr> <tr> <td>1197/535</td> <td>PREMIER HOMES INC</td> <td>10/14/1999</td> <td>167,500</td> <td>Yes</td> </tr> <tr> <td>1176/30</td> <td>CHESTNUT FARMS LLC</td> <td>06/08/1999</td> <td>33,000</td> <td>No</td> </tr> </tbody> </table>					Bk/Pg	Grantor	Date	Price	Code	1526/827	HOPPER, BRIAN & SHEILA	09/22/2003	202,000	YES	1197/535	PREMIER HOMES INC	10/14/1999	167,500	Yes	1176/30	CHESTNUT FARMS LLC	06/08/1999	33,000	No																																																																																		
Code	Type	Active	Maximum	Exemption																																																																																																																					
H	Homestead	Yes	1,000	1,000																																																																																																																					
Bk/Pg	Grantor	Date	Price	Code																																																																																																																					
1526/827	HOPPER, BRIAN & SHEILA	09/22/2003	202,000	YES																																																																																																																					
1197/535	PREMIER HOMES INC	10/14/1999	167,500	Yes																																																																																																																					
1176/30	CHESTNUT FARMS LLC	06/08/1999	33,000	No																																																																																																																					
Parcel Valuation <table border="1"> <thead> <tr> <th>Source</th> <th>REAL</th> <th>Fair Cash</th> <th>Capped</th> <th>Asmnt Level</th> <th>Assessed</th> <th>Levy Rate</th> <th>97.960</th> <th>Current Tax</th> </tr> </thead> <tbody> <tr> <td>Remove Cap</td> <td>2004</td> <td>Land Value 98,585</td> <td>64,232</td> <td>11%</td> <td>7,066</td> <td>Assessed</td> <td>37,732</td> <td>3,696.23</td> </tr> <tr> <td>Year Frozen</td> <td>0</td> <td>Improvements 310,595</td> <td>278,775</td> <td></td> <td>30,666</td> <td>Penalty</td> <td>0</td> <td></td> </tr> <tr> <td>Uncapped Value</td> <td>0</td> <td>Mobile Home 0</td> <td>0</td> <td></td> <td>0</td> <td>Exemption</td> <td>1,000</td> <td>-98.00</td> </tr> <tr> <td>TIF Project ID</td> <td>0</td> <td>Total Value 409,180</td> <td>343,007</td> <td></td> <td>37,732</td> <td>Total Taxable</td> <td>36,732</td> <td>3,598.00</td> </tr> </tbody> </table>										Source	REAL	Fair Cash	Capped	Asmnt Level	Assessed	Levy Rate	97.960	Current Tax	Remove Cap	2004	Land Value 98,585	64,232	11%	7,066	Assessed	37,732	3,696.23	Year Frozen	0	Improvements 310,595	278,775		30,666	Penalty	0		Uncapped Value	0	Mobile Home 0	0		0	Exemption	1,000	-98.00	TIF Project ID	0	Total Value 409,180	343,007		37,732	Total Taxable	36,732	3,598.00																																																																			
Source	REAL	Fair Cash	Capped	Asmnt Level	Assessed	Levy Rate	97.960	Current Tax																																																																																																																	
Remove Cap	2004	Land Value 98,585	64,232	11%	7,066	Assessed	37,732	3,696.23																																																																																																																	
Year Frozen	0	Improvements 310,595	278,775		30,666	Penalty	0																																																																																																																		
Uncapped Value	0	Mobile Home 0	0		0	Exemption	1,000	-98.00																																																																																																																	
TIF Project ID	0	Total Value 409,180	343,007		37,732	Total Taxable	36,732	3,598.00																																																																																																																	
Assessment History <table border="1"> <thead> <tr> <th>Tax Year</th> <th>Statement Number</th> <th>Billed Owner</th> <th>Tax Area</th> <th>Total Value</th> <th>Exemptions</th> <th>Taxable Value</th> <th>Billed Tax</th> </tr> </thead> <tbody> <tr><td>2025</td><td>2025-660068596</td><td>HENSON, LLOYD K &</td><td>3</td><td>396,698</td><td>1000</td><td>35,632</td><td>3,491.00</td></tr> <tr><td>2024</td><td>2024-660068596</td><td>HENSON, LLOYD K &</td><td>3</td><td>409,057</td><td>1000</td><td>34,565</td><td>3,321.00</td></tr> <tr><td>2023</td><td>2023-660068596</td><td>HENSON, LLOYD K &</td><td>3</td><td>365,462</td><td>1000</td><td>33,529</td><td>3,142.00</td></tr> <tr><td>2022</td><td>2022-660068596</td><td>HENSON, LLOYD K &</td><td>3</td><td>329,926</td><td>1000</td><td>32,523</td><td>3,186.00</td></tr> <tr><td>2021</td><td>2021-660068596</td><td>HENSON, LLOYD K &</td><td>3</td><td>295,883</td><td>1000</td><td>31,547</td><td>3,052.00</td></tr> <tr><td>2020</td><td>2020-660068596</td><td>HENSON, LLOYD K &</td><td>3</td><td>291,302</td><td>1000</td><td>30,685</td><td>2,964.00</td></tr> <tr><td>2019</td><td>2019-660068596</td><td>HENSON, LLOYD K &</td><td>3</td><td>279,654</td><td>1000</td><td>29,762</td><td>2,877.00</td></tr> <tr><td>2018</td><td>2018-660068596</td><td>HENSON, LLOYD K &</td><td>3</td><td>289,269</td><td>1000</td><td>30,819</td><td>2,869.00</td></tr> <tr><td>2017</td><td>2017-660068596</td><td>HENSON, LLOYD K &</td><td>3</td><td>286,111</td><td>1000</td><td>30,472</td><td>2,866.00</td></tr> <tr><td>2016</td><td>2016-660068596</td><td>HENSON, LLOYD K &</td><td>3</td><td>280,063</td><td>1000</td><td>29,807</td><td>2,806.00</td></tr> <tr><td>2015</td><td>2015-660068596</td><td>HENSON, LLOYD K &</td><td>3</td><td>271,987</td><td>1000</td><td>28,918</td><td>2,742.00</td></tr> <tr><td>2014</td><td>2014-660068596</td><td>HENSON, LLOYD K &</td><td>3</td><td>276,032</td><td>1000</td><td>28,173</td><td>2,697.00</td></tr> <tr><td>2013</td><td>2013-660068596</td><td>HENSON, LLOYD K &</td><td>3</td><td>262,488</td><td>1000</td><td>27,323</td><td>2,560.00</td></tr> </tbody> </table>										Tax Year	Statement Number	Billed Owner	Tax Area	Total Value	Exemptions	Taxable Value	Billed Tax	2025	2025-660068596	HENSON, LLOYD K &	3	396,698	1000	35,632	3,491.00	2024	2024-660068596	HENSON, LLOYD K &	3	409,057	1000	34,565	3,321.00	2023	2023-660068596	HENSON, LLOYD K &	3	365,462	1000	33,529	3,142.00	2022	2022-660068596	HENSON, LLOYD K &	3	329,926	1000	32,523	3,186.00	2021	2021-660068596	HENSON, LLOYD K &	3	295,883	1000	31,547	3,052.00	2020	2020-660068596	HENSON, LLOYD K &	3	291,302	1000	30,685	2,964.00	2019	2019-660068596	HENSON, LLOYD K &	3	279,654	1000	29,762	2,877.00	2018	2018-660068596	HENSON, LLOYD K &	3	289,269	1000	30,819	2,869.00	2017	2017-660068596	HENSON, LLOYD K &	3	286,111	1000	30,472	2,866.00	2016	2016-660068596	HENSON, LLOYD K &	3	280,063	1000	29,807	2,806.00	2015	2015-660068596	HENSON, LLOYD K &	3	271,987	1000	28,918	2,742.00	2014	2014-660068596	HENSON, LLOYD K &	3	276,032	1000	28,173	2,697.00	2013	2013-660068596	HENSON, LLOYD K &	3	262,488	1000	27,323	2,560.00
Tax Year	Statement Number	Billed Owner	Tax Area	Total Value	Exemptions	Taxable Value	Billed Tax																																																																																																																		
2025	2025-660068596	HENSON, LLOYD K &	3	396,698	1000	35,632	3,491.00																																																																																																																		
2024	2024-660068596	HENSON, LLOYD K &	3	409,057	1000	34,565	3,321.00																																																																																																																		
2023	2023-660068596	HENSON, LLOYD K &	3	365,462	1000	33,529	3,142.00																																																																																																																		
2022	2022-660068596	HENSON, LLOYD K &	3	329,926	1000	32,523	3,186.00																																																																																																																		
2021	2021-660068596	HENSON, LLOYD K &	3	295,883	1000	31,547	3,052.00																																																																																																																		
2020	2020-660068596	HENSON, LLOYD K &	3	291,302	1000	30,685	2,964.00																																																																																																																		
2019	2019-660068596	HENSON, LLOYD K &	3	279,654	1000	29,762	2,877.00																																																																																																																		
2018	2018-660068596	HENSON, LLOYD K &	3	289,269	1000	30,819	2,869.00																																																																																																																		
2017	2017-660068596	HENSON, LLOYD K &	3	286,111	1000	30,472	2,866.00																																																																																																																		
2016	2016-660068596	HENSON, LLOYD K &	3	280,063	1000	29,807	2,806.00																																																																																																																		
2015	2015-660068596	HENSON, LLOYD K &	3	271,987	1000	28,918	2,742.00																																																																																																																		
2014	2014-660068596	HENSON, LLOYD K &	3	276,032	1000	28,173	2,697.00																																																																																																																		
2013	2013-660068596	HENSON, LLOYD K &	3	262,488	1000	27,323	2,560.00																																																																																																																		



Rogers

Assessment Property Record Card for Tax Year 2026

Data provided by LISA DELOZIER County Assessor

Date 04/16/2026
Time 23:19:20
Page 2

Lot Data		Square-Foot - NBHD 1018 #1		Primary Image				
Lot Size								
Lot Count	1							
Units Buildable	1							
Non-Ag Acres	2.266							
Topography								
Street Access								
Utilities								
Amenities	LAND QUALITY		0					
	SIZE		0					
Method	Square-Foot							
Base Lot Value	98,705.00 x 1.00 = 98,585							
Factor Value								
Adjustments	1.0000							
Lot Value	98,585							
Residential Data								
Type	1 Single Family Residence							
Condition	3 - Average							
Quality	3.5 - Average							
Architecture								
Style	100% 1 1/2 Story Finished							
Exterior Wall	100% Veneer, Masonry							
Base/Total Area	1,680 / 2,650							
Style	100% 1 1/2 Story Finished							
HVAC	100% Warmed & Cooled Air							
Roof Cover	1 Composition Shingle							
Area on Slab	1,680							
Fixture/RghIn	14 /							
Bed/F/H Bath	4 / 2.5 /							
Basement Area								
Garage Type	440 Attached Garage - Unfinished							
Remodel								
Year/Eff Age	1999 / 20							
Cost Approach								
Manual : 01/2025								
Base Cost	99.30	Total Misc Impr	+	9,336				
Roofing Adj	+ 3.54	Garage Cost	+	18,106				
Subfloor Adj	+ -2.27	Total RCN	=	354,664				
Heat/Cool Adj	+ 14.47	Depreciation (23%)	-	81,573				
Plumbing Adj	+ 8.44	Lump Sums	+	0				
Basement Adj	+ 0.00	RCNLD	=	273,091				
Adj Base Cost	= 123.48	Lot Value	+	98,585				
Total Area	x 2,650	Indicated Value	=	371,676				
Adjusted Cost	= 327,222	Value Per SqFt		140.26				
GRM Approach								
GRM Code								
Gross Rent	0.00							
Indicated Value								
Multiple Regression								
MRA Code								
1 Test								
Adusted R	0.8445							
Indicated Value	351,578	132.67	Per SqFt					
Direct Comparables								
Selection Model								
A Adam Test								
Adjustment Model								
1 2022 Residential								
Comparables								
1								
Indicated Value	80,740	Per SqFt						
Value Reconciliation								
Selected Approach Cost Approach								
Improvements	273,091							
Lot Value	98,585							
Indicated Value	371,676	140.26	Per SqFt					
Agland Value								
Site Improvements	37,504							
Total Value	409,180	154.41	Total Value Per SqFt					
Miscellaneous Improvements								
Code	Description	Sketch ID	Size	Year	Units	Unit Cost	Depr	Value
PRCH	SLAB PORCH - COVERED	83100	10x6		60	29.34		1,760
PRCH	SLAB PORCH - COVERED	83101	265		265	28.59		7,576

\\tsclient\T\LOGAN\LOGAN RESIDENTIAL VI\2022-7-5\IMG_0030. 7/5/2022



Rogers
Assessment Property Record Card for Tax Year 2026
 Data provided by LISA DELOZIER County Assessor

Date 04/16/2026
 Time 23:19:20
 Page 3

Sketch Image

660068596

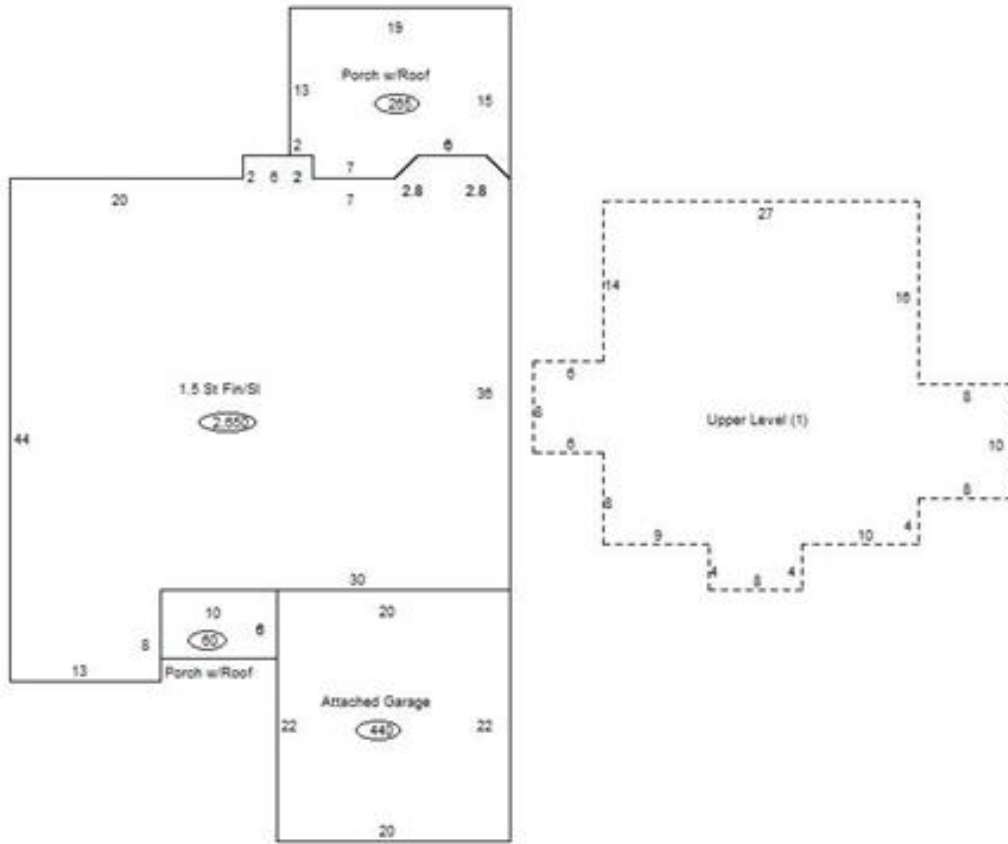

Sketch Vector Information

Sequence	Code	Type	Built Over	Scale	Section Label	Base Area	Multiplier	Total Area
1	R	5	Slab	13	1.5 St Fin/Sl	1,680	1.577	2,650
2	G	1		13	Attached Garage	440	1.000	440
3	M	PRCH		13	SLBC	60	1.000	60
4	M	PRCH		13	SLBC	265	1.000	265
5	U	^UL		13	Upper Level (1)	970	1.000	970
Total Building Area						1,680		2,650



Rogers

Assessment Property Record Card for Tax Year 2026

Data provided by LISA DELOZIER County Assessor

Date 04/16/2026
Time 23:19:20
Page 4

660068596

Outbuildings/Site Improvements

Building Image	Code	Description	Dimensions	Floor	Roofing	Total Units
	GRDT	GARAGE - DETACHED	0x0x0			1,040
	Qual 4	Cond 3	Year 2010	Eff Age		
		Valuation Summary	Modifier Total	RCN	Depr (5% Phys/ % Func)	RCNLD
		Base Cost (37.96 x 1,040)	39,478	39,478	1,974	37,504