



# Rogers

## Assessment Property Record Card for Tax Year 2026

Data provided by LISA DELOZIER County Assessor

Date 04/16/2026  
Time 23:15:41  
Page 1

Assessment Data					Primary Image																																																																																																																				
<b>Account</b> 660068602 <b>Parcel ID</b> 000000-00-0-00157-003-0003 <b>Cadastral ID</b> 10-21-14-01790 <b>Property Type</b> REAL - Real Property <b>Property Class</b> RRP VI Area 4 <b>Tax Area</b> 3 - OWASSO RURAL/NO FIRE <b>Name ID</b> 267584 PETTY, JOSEPH R  PO BOX 1001 TULSA OK 74101-1001  <b>Parcel Location</b> <b>Situs</b> 15111 E 113TH ST N <b>Subdivision</b> CHESTNUT FARMS <b>Lot/Block</b> 0003 / 0003 <b>Parcel Size</b> 1 - Lots <b>Sec/Twn/Rng</b> 10 / 21 / 14 / 5 <b>Neighborhood</b> 1018 - R-V04 SW OWASSO <b>School District</b> S021 - OWASSO SCHOOLS																																																																																																																									
<b>Legal Description</b> Lot/Long: 36.31753783 -95.80498186																																																																																																																									
<b>Building Permits</b>					<table border="1"> <thead> <tr> <th>Number</th> <th>Description</th> <th>Opened</th> <th>Closed</th> <th>Amount</th> </tr> </thead> <tbody> <tr> <td> </td> <td> </td> <td> </td> <td> </td> <td> </td> </tr> </tbody> </table>					Number	Description	Opened	Closed	Amount																																																																																																											
Number	Description	Opened	Closed	Amount																																																																																																																					
<b>Exemptions</b>					<b>Sale History</b>																																																																																																																				
<table border="1"> <thead> <tr> <th>Code</th> <th>Type</th> <th>Active</th> <th>Maximum</th> <th>Exemption</th> </tr> </thead> <tbody> <tr> <td>H</td> <td>Homestead</td> <td>Yes</td> <td>1,000</td> <td>1,000</td> </tr> </tbody> </table>					Code	Type	Active	Maximum	Exemption	H	Homestead	Yes	1,000	1,000	<table border="1"> <thead> <tr> <th>Bk/Pg</th> <th>Grantor</th> <th>Date</th> <th>Price</th> <th>Code</th> </tr> </thead> <tbody> <tr> <td>1097/718</td> <td>LEE, WILLIAM DAVID &amp;-SANDRA L</td> <td>01/29/1998</td> <td>128,500</td> <td>Yes</td> </tr> <tr> <td>1091/305</td> <td>CHESTNUT FARMS LLC</td> <td>09/10/1997</td> <td>22,000</td> <td>Yes</td> </tr> </tbody> </table>					Bk/Pg	Grantor	Date	Price	Code	1097/718	LEE, WILLIAM DAVID &-SANDRA L	01/29/1998	128,500	Yes	1091/305	CHESTNUT FARMS LLC	09/10/1997	22,000	Yes																																																																																							
Code	Type	Active	Maximum	Exemption																																																																																																																					
H	Homestead	Yes	1,000	1,000																																																																																																																					
Bk/Pg	Grantor	Date	Price	Code																																																																																																																					
1097/718	LEE, WILLIAM DAVID &-SANDRA L	01/29/1998	128,500	Yes																																																																																																																					
1091/305	CHESTNUT FARMS LLC	09/10/1997	22,000	Yes																																																																																																																					
<b>Parcel Valuation</b>																																																																																																																									
<table border="1"> <thead> <tr> <th>Source</th> <th>REAL</th> </tr> </thead> <tbody> <tr> <td>Remove Cap</td> <td>1999</td> </tr> <tr> <td>Year Frozen</td> <td>0</td> </tr> <tr> <td>Uncapped Value</td> <td>0</td> </tr> <tr> <td>TIF Project ID</td> <td>0</td> </tr> </tbody> </table>		Source	REAL	Remove Cap	1999	Year Frozen	0	Uncapped Value	0	TIF Project ID	0	<table border="1"> <thead> <tr> <th>Fair Cash</th> <th>Capped</th> <th>Asmnt Level</th> <th>Assessed</th> </tr> </thead> <tbody> <tr> <td>Land Value 70,047</td> <td>51,218</td> <td>11%</td> <td>5,634</td> </tr> <tr> <td>Improvements 214,051</td> <td>200,124</td> <td></td> <td>22,014</td> </tr> <tr> <td>Mobile Home 0</td> <td>0</td> <td></td> <td>0</td> </tr> <tr> <td>Total Value 284,098</td> <td>251,342</td> <td></td> <td>27,648</td> </tr> </tbody> </table>			Fair Cash	Capped	Asmnt Level	Assessed	Land Value 70,047	51,218	11%	5,634	Improvements 214,051	200,124		22,014	Mobile Home 0	0		0	Total Value 284,098	251,342		27,648	<table border="1"> <thead> <tr> <th>Levy Rate</th> <th>Current Tax</th> </tr> </thead> <tbody> <tr> <td>97.960</td> <td>2,708.40</td> </tr> <tr> <td>Assessed 27,648</td> <td></td> </tr> <tr> <td>Penalty 0</td> <td></td> </tr> <tr> <td>Exemption 1,000</td> <td>-98.00</td> </tr> <tr> <td>Total Taxable 26,648</td> <td>2,610.00</td> </tr> </tbody> </table>		Levy Rate	Current Tax	97.960	2,708.40	Assessed 27,648		Penalty 0		Exemption 1,000	-98.00	Total Taxable 26,648	2,610.00																																																																									
Source	REAL																																																																																																																								
Remove Cap	1999																																																																																																																								
Year Frozen	0																																																																																																																								
Uncapped Value	0																																																																																																																								
TIF Project ID	0																																																																																																																								
Fair Cash	Capped	Asmnt Level	Assessed																																																																																																																						
Land Value 70,047	51,218	11%	5,634																																																																																																																						
Improvements 214,051	200,124		22,014																																																																																																																						
Mobile Home 0	0		0																																																																																																																						
Total Value 284,098	251,342		27,648																																																																																																																						
Levy Rate	Current Tax																																																																																																																								
97.960	2,708.40																																																																																																																								
Assessed 27,648																																																																																																																									
Penalty 0																																																																																																																									
Exemption 1,000	-98.00																																																																																																																								
Total Taxable 26,648	2,610.00																																																																																																																								
<b>Assessment History</b>																																																																																																																									
<table border="1"> <thead> <tr> <th>Tax Year</th> <th>Statement Number</th> <th>Billed Owner</th> <th>Tax Area</th> <th>Total Value</th> <th>Exemptions</th> <th>Taxable Value</th> <th>Billed Tax</th> </tr> </thead> <tbody> <tr><td>2025</td><td>2025-660068602</td><td>PETTY, JOSEPH R</td><td>3</td><td>278,604</td><td>1000</td><td>25,843</td><td>2,532.00</td></tr> <tr><td>2024</td><td>2024-660068602</td><td>PETTY, JOSEPH R</td><td>3</td><td>285,656</td><td>1000</td><td>25,061</td><td>2,408.00</td></tr> <tr><td>2023</td><td>2023-660068602</td><td>PETTY, JOSEPH R</td><td>3</td><td>249,009</td><td>1000</td><td>24,302</td><td>2,277.00</td></tr> <tr><td>2022</td><td>2022-660068602</td><td>PETTY, JOSEPH R</td><td>3</td><td>236,991</td><td>1000</td><td>23,565</td><td>2,309.00</td></tr> <tr><td>2021</td><td>2021-660068602</td><td>PETTY, JOSEPH R</td><td>3</td><td>216,812</td><td>1000</td><td>22,849</td><td>2,210.00</td></tr> <tr><td>2020</td><td>2020-660068602</td><td>PETTY, JOSEPH R</td><td>3</td><td>215,491</td><td>1000</td><td>22,299</td><td>2,154.00</td></tr> <tr><td>2019</td><td>2019-660068602</td><td>PETTY, JOSEPH R</td><td>3</td><td>205,644</td><td>1000</td><td>21,621</td><td>2,090.00</td></tr> <tr><td>2018</td><td>2018-660068602</td><td>PETTY, JOSEPH R</td><td>3</td><td>211,037</td><td>1000</td><td>21,852</td><td>2,034.00</td></tr> <tr><td>2017</td><td>2017-660068602</td><td>PETTY, JOSEPH R</td><td>3</td><td>209,439</td><td>1000</td><td>21,186</td><td>1,993.00</td></tr> <tr><td>2016</td><td>2016-660068602</td><td>PETTY, JOSEPH R</td><td>3</td><td>204,510</td><td>1000</td><td>20,540</td><td>1,934.00</td></tr> <tr><td>2015</td><td>2015-660068602</td><td>PETTY, JOSEPH R</td><td>3</td><td>198,675</td><td>1000</td><td>19,913</td><td>1,888.00</td></tr> <tr><td>2014</td><td>2014-660068602</td><td>PETTY, JOSEPH R</td><td>3</td><td>201,799</td><td>1000</td><td>19,304</td><td>1,848.00</td></tr> <tr><td>2013</td><td>2013-660068602</td><td>PETTY, JOSEPH R</td><td>3</td><td>190,942</td><td>1000</td><td>18,713</td><td>1,753.00</td></tr> </tbody> </table>										Tax Year	Statement Number	Billed Owner	Tax Area	Total Value	Exemptions	Taxable Value	Billed Tax	2025	2025-660068602	PETTY, JOSEPH R	3	278,604	1000	25,843	2,532.00	2024	2024-660068602	PETTY, JOSEPH R	3	285,656	1000	25,061	2,408.00	2023	2023-660068602	PETTY, JOSEPH R	3	249,009	1000	24,302	2,277.00	2022	2022-660068602	PETTY, JOSEPH R	3	236,991	1000	23,565	2,309.00	2021	2021-660068602	PETTY, JOSEPH R	3	216,812	1000	22,849	2,210.00	2020	2020-660068602	PETTY, JOSEPH R	3	215,491	1000	22,299	2,154.00	2019	2019-660068602	PETTY, JOSEPH R	3	205,644	1000	21,621	2,090.00	2018	2018-660068602	PETTY, JOSEPH R	3	211,037	1000	21,852	2,034.00	2017	2017-660068602	PETTY, JOSEPH R	3	209,439	1000	21,186	1,993.00	2016	2016-660068602	PETTY, JOSEPH R	3	204,510	1000	20,540	1,934.00	2015	2015-660068602	PETTY, JOSEPH R	3	198,675	1000	19,913	1,888.00	2014	2014-660068602	PETTY, JOSEPH R	3	201,799	1000	19,304	1,848.00	2013	2013-660068602	PETTY, JOSEPH R	3	190,942	1000	18,713	1,753.00
Tax Year	Statement Number	Billed Owner	Tax Area	Total Value	Exemptions	Taxable Value	Billed Tax																																																																																																																		
2025	2025-660068602	PETTY, JOSEPH R	3	278,604	1000	25,843	2,532.00																																																																																																																		
2024	2024-660068602	PETTY, JOSEPH R	3	285,656	1000	25,061	2,408.00																																																																																																																		
2023	2023-660068602	PETTY, JOSEPH R	3	249,009	1000	24,302	2,277.00																																																																																																																		
2022	2022-660068602	PETTY, JOSEPH R	3	236,991	1000	23,565	2,309.00																																																																																																																		
2021	2021-660068602	PETTY, JOSEPH R	3	216,812	1000	22,849	2,210.00																																																																																																																		
2020	2020-660068602	PETTY, JOSEPH R	3	215,491	1000	22,299	2,154.00																																																																																																																		
2019	2019-660068602	PETTY, JOSEPH R	3	205,644	1000	21,621	2,090.00																																																																																																																		
2018	2018-660068602	PETTY, JOSEPH R	3	211,037	1000	21,852	2,034.00																																																																																																																		
2017	2017-660068602	PETTY, JOSEPH R	3	209,439	1000	21,186	1,993.00																																																																																																																		
2016	2016-660068602	PETTY, JOSEPH R	3	204,510	1000	20,540	1,934.00																																																																																																																		
2015	2015-660068602	PETTY, JOSEPH R	3	198,675	1000	19,913	1,888.00																																																																																																																		
2014	2014-660068602	PETTY, JOSEPH R	3	201,799	1000	19,304	1,848.00																																																																																																																		
2013	2013-660068602	PETTY, JOSEPH R	3	190,942	1000	18,713	1,753.00																																																																																																																		



# Rogers

## Assessment Property Record Card for Tax Year 2026

Data provided by LISA DELOZIER County Assessor

Date 04/16/2026  
 Time 23:15:42  
 Page 2

Lot Data	Square-Foot - NBHD 1018 #1	Primary Image
<b>Lot Size</b> <b>Lot Count</b> 1 <b>Units Buildable</b> 36000 <b>Non-Ag Acres</b> 1.164 <b>Topography</b> <b>Street Access</b> <b>Utilities</b> <b>Amenities</b> LAND QUALITY 0 SIZE 0 <b>Method</b> Square-Foot <b>Base Lot Value</b> 50,703.00 x 1.38 = 70,047 <b>Factor Value</b> <b>Adjustments</b> 1.0000 <b>Lot Value</b> 70,047		

Residential Data	
<b>Type</b>	1 Single Family Residence
<b>Condition</b>	3 - Average
<b>Quality</b>	3 - Average
<b>Architecture</b>	
<b>Style</b>	100% One Story
<b>Exterior Wall</b>	100% Veneer, Masonry
<b>Base/Total Area</b>	2,051 / 2,051
<b>Style</b>	100% One Story
<b>HVAC</b>	100% Warmed & Cooled Air
<b>Roof Cover</b>	1 Composition Shingle
<b>Area on Slab</b>	2,051
<b>Fixture/RghIn</b>	11 /
<b>Bed/F/H Bath</b>	3 / 2.0 /
<b>Basement Area</b>	
<b>Garage Type</b>	462 Attached Garage - Unfinished
<b>Remodel</b>	
<b>Year/Eff Age</b>	1998 / 21



\\tsclient\T\LOGAN\LOGAN RESIDENTIAL VI\2022-7-11\IMG\_001! 7/11/2022

GRM Approach	
<b>GRM Code</b>	
<b>Gross Rent</b>	0.00
<b>Indicated Value</b>	

Multiple Regression			
<b>MRA Code</b>	1	Test	
<b>Adusted R</b>	0.8445		
<b>Indicated Value</b>	238,203	116.14	Per SqFt

Direct Comparables			
<b>Selection Model</b>	A	Adam Test	
<b>Adjustment Model</b>	1	2022 Residential	
<b>Comparables</b>	1		
<b>Indicated Value</b>	14,060		Per SqFt

Cost Approach				Manual : 01/2025			
<b>Base Cost</b>	106.88	<b>Total Misc Impr</b>	+ 4,659				
<b>Roofing Adj</b>	+ 4.67	<b>Garage Cost</b>	+ 15,015				
<b>Subfloor Adj</b>	+ -2.19	<b>Total RCN</b>	= 285,402				
<b>Heat/Cool Adj</b>	+ 12.64	<b>Depreciation ( 25%)</b>	- 71,351				
<b>Plumbing Adj</b>	+ 7.56	<b>Lump Sums</b>	+ 0				
<b>Basement Adj</b>	+ 0.00	<b>RCNLD</b>	= 214,051				
<b>Adj Base Cost</b>	= 129.56	<b>Lot Value</b>	+ 70,047				
<b>Total Area</b>	x 2,051	<b>Indicated Value</b>	= 284,098				
<b>Adjusted Cost</b>	= 265,728	<b>Value Per SqFt</b>	138.52				

Value Reconciliation			
<b>Selected Approach</b>	Cost Approach		
<b>Improvements</b>	214,051		
<b>Lot Value</b>	70,047		
<b>Indicated Value</b>	284,098	138.52	Per SqFt
<b>Agland Value</b>			
<b>Site Improvements</b>			
<b>Total Value</b>	284,098	138.52	Total Value Per SqFt

Miscellaneous Improvements								
Code	Description	Sketch ID	Size	Year	Units	Unit Cost	Depr	Value
PRCH	SLAB PORCH - COVERED	83128		16	16	26.88		430
PRCH	SLAB PORCH - COVERED	83129	20x8		160	26.43		4,229



# Rogers

## Assessment Property Record Card for Tax Year 2026

Data provided by LISA DELOZIER County Assessor

Date 04/16/2026  
 Time 23:15:42  
 Page 3

Sketch Image

660068602

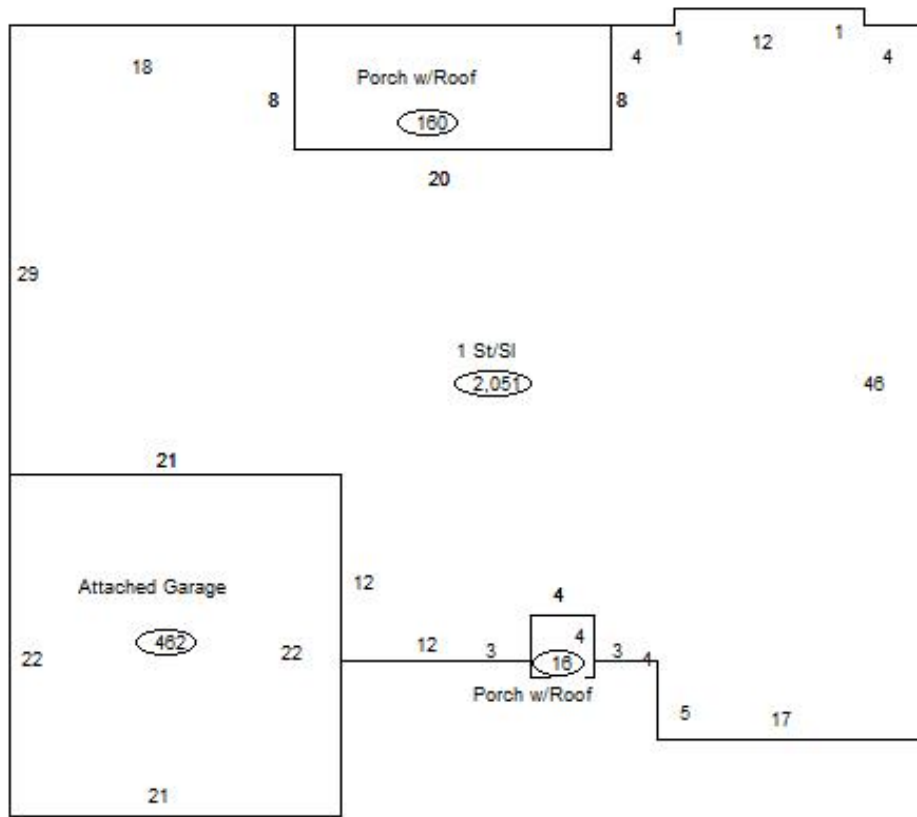

### Sketch Vector Information

Sequence	Code	Type	Built Over	Scale	Section Label	Base Area	Multiplier	Total Area
1	R	1	Slab	13	1 St/Sl	2,051	1.000	2,051
2	G	1		13	Attached Garage	462	1.000	462
3	M	PRCH		13	SLBC	16	1.000	16
4	M	PRCH		13	SLBC	160	1.000	160
<b>Total Building Area</b>						2,051		2,051