



Rogers

Assessment Property Record Card for Tax Year 2026

Data provided by LISA DELOZIER County Assessor

Date 04/17/2026
 Time 04:48:03
 Page 1

Assessment Data					Primary Image																																																																																																																				
Account 660069042 Parcel ID 24N18E-30-4-00000-000-0000 Cadastral ID 30-24-18-07410 Property Type REAL - Real Property Property Class RA VI Area 2 Tax Area 14 - CHELSEA RURAL Name ID 344329 HAND, MICHELLE ROSE & BRAD LEE AARON 650 E 6TH ST CHELSEA OK 74016-0000 Parcel Location Situs 00650 E 6TH ST Subdivision Lot/Block / Parcel Size 11 - Acres Sec/Twn/Rng 30 / 24 / 18 / 4 Neighborhood 4060 - CHELSEA School District S003 - CHELSEA SCHOOLS																																																																																																																									
Legal Description Lat/Long: 36.52752514 -95.42123469																																																																																																																									
Legal Description NW SE SE & N 25' W 285' NE SE SE & E 150' W 285' SE NE SE LYING S RD					Building Permits <table border="1"> <thead> <tr> <th>Number</th> <th>Description</th> <th>Opened</th> <th>Closed</th> <th>Amount</th> </tr> </thead> <tbody> <tr> <td colspan="5"> </td> </tr> </tbody> </table>					Number	Description	Opened	Closed	Amount																																																																																																											
Number	Description	Opened	Closed	Amount																																																																																																																					
Exemptions <table border="1"> <thead> <tr> <th>Code</th> <th>Type</th> <th>Active</th> <th>Maximum</th> <th>Exemption</th> </tr> </thead> <tbody> <tr> <td>H</td> <td>Homestead</td> <td>No</td> <td>1,000</td> <td></td> </tr> </tbody> </table>					Code	Type	Active	Maximum	Exemption	H	Homestead	No	1,000		Sale History <table border="1"> <thead> <tr> <th>Bk/Pg</th> <th>Grantor</th> <th>Date</th> <th>Price</th> <th>Code</th> </tr> </thead> <tbody> <tr> <td>/</td> <td>BLAIR, JOHN R & BRANDY E</td> <td>05/13/2024</td> <td>253,000</td> <td>21</td> </tr> <tr> <td>1089/570</td> <td>JOHNSTON, JAMES R</td> <td>11/20/1997</td> <td>20,500</td> <td>No</td> </tr> </tbody> </table>					Bk/Pg	Grantor	Date	Price	Code	/	BLAIR, JOHN R & BRANDY E	05/13/2024	253,000	21	1089/570	JOHNSTON, JAMES R	11/20/1997	20,500	No																																																																																							
Code	Type	Active	Maximum	Exemption																																																																																																																					
H	Homestead	No	1,000																																																																																																																						
Bk/Pg	Grantor	Date	Price	Code																																																																																																																					
/	BLAIR, JOHN R & BRANDY E	05/13/2024	253,000	21																																																																																																																					
1089/570	JOHNSTON, JAMES R	11/20/1997	20,500	No																																																																																																																					
Parcel Valuation <table border="1"> <thead> <tr> <th>Source</th> <th>REAL</th> <th>Fair Cash</th> <th>Capped</th> <th>Asmnt Level</th> <th>Assessed</th> <th>Levy Rate</th> <th>82.750</th> <th>Current Tax</th> </tr> </thead> <tbody> <tr> <td>Remove Cap</td> <td>2025</td> <td>Land Value</td> <td>120</td> <td>120</td> <td>13</td> <td>Assessed</td> <td>5,371</td> <td>444.45</td> </tr> <tr> <td>Year Frozen</td> <td>0</td> <td>Improvements</td> <td>6,091</td> <td>6,091</td> <td>670</td> <td>Penalty</td> <td>0</td> <td></td> </tr> <tr> <td>Uncapped Value</td> <td>0</td> <td>Mobile Home</td> <td>42,619</td> <td>42,619</td> <td>4,688</td> <td>Exemption</td> <td>0</td> <td>0.00</td> </tr> <tr> <td>TIF Project ID</td> <td>0</td> <td>Total Value</td> <td>48,830</td> <td>48,830</td> <td>5,371</td> <td>Total Taxable</td> <td>5,371</td> <td>444.00</td> </tr> </tbody> </table>										Source	REAL	Fair Cash	Capped	Asmnt Level	Assessed	Levy Rate	82.750	Current Tax	Remove Cap	2025	Land Value	120	120	13	Assessed	5,371	444.45	Year Frozen	0	Improvements	6,091	6,091	670	Penalty	0		Uncapped Value	0	Mobile Home	42,619	42,619	4,688	Exemption	0	0.00	TIF Project ID	0	Total Value	48,830	48,830	5,371	Total Taxable	5,371	444.00																																																																			
Source	REAL	Fair Cash	Capped	Asmnt Level	Assessed	Levy Rate	82.750	Current Tax																																																																																																																	
Remove Cap	2025	Land Value	120	120	13	Assessed	5,371	444.45																																																																																																																	
Year Frozen	0	Improvements	6,091	6,091	670	Penalty	0																																																																																																																		
Uncapped Value	0	Mobile Home	42,619	42,619	4,688	Exemption	0	0.00																																																																																																																	
TIF Project ID	0	Total Value	48,830	48,830	5,371	Total Taxable	5,371	444.00																																																																																																																	
Assessment History <table border="1"> <thead> <tr> <th>Tax Year</th> <th>Statement Number</th> <th>Billed Owner</th> <th>Tax Area</th> <th>Total Value</th> <th>Exemptions</th> <th>Taxable Value</th> <th>Billed Tax</th> </tr> </thead> <tbody> <tr><td>2025</td><td>2025-660069042</td><td>HAND, MICHELLE ROSE &</td><td>14</td><td>49,271</td><td>0</td><td>5,420</td><td>449.00</td></tr> <tr><td>2024</td><td>2024-660069042</td><td>HAND, MICHELLE ROSE &</td><td>14</td><td>34,369</td><td>1000</td><td>2,780</td><td>235.00</td></tr> <tr><td>2023</td><td>2023-660069042</td><td>BLAIR, JOHN R & BRANDY E</td><td>14</td><td>70,794</td><td>1000</td><td>6,788</td><td>579.00</td></tr> <tr><td>2022</td><td>2022-660069042</td><td>BLAIR, JOHN R & BRANDY E</td><td>14</td><td>69,153</td><td>1000</td><td>6,574</td><td>556.00</td></tr> <tr><td>2021</td><td>2021-660069042</td><td>BLAIR, JOHN R & BRANDY E</td><td>14</td><td>74,404</td><td>1000</td><td>6,354</td><td>539.00</td></tr> <tr><td>2020</td><td>2020-660069042</td><td>BLAIR, JOHN R & BRANDY E</td><td>14</td><td>70,862</td><td>1000</td><td>6,140</td><td>521.00</td></tr> <tr><td>2019</td><td>2019-660069042</td><td>BLAIR, JOHN R & BRANDY E</td><td>14</td><td>63,019</td><td>1000</td><td>5,932</td><td>509.00</td></tr> <tr><td>2018</td><td>2018-660069042</td><td>BLAIR, JOHN R & BRANDY E</td><td>14</td><td>65,415</td><td>1000</td><td>6,195</td><td>529.00</td></tr> <tr><td>2017</td><td>2017-660069042</td><td>BLAIR, JOHN R & BRANDY E</td><td>14</td><td>65,070</td><td>1000</td><td>6,158</td><td>528.00</td></tr> <tr><td>2016</td><td>2016-660069042</td><td>BLAIR, JOHN R & BRANDY E</td><td>14</td><td>71,855</td><td>1000</td><td>6,904</td><td>602.00</td></tr> <tr><td>2015</td><td>2015-660069042</td><td>BLAIR, JOHN R & BRANDY E</td><td>14</td><td>72,606</td><td>1000</td><td>6,987</td><td>602.00</td></tr> <tr><td>2014</td><td>2014-660069042</td><td>BLAIR, JOHN R & BRANDY E</td><td>14</td><td>72,606</td><td>1000</td><td>6,987</td><td>622.00</td></tr> <tr><td>2013</td><td>2013-660069042</td><td>BLAIR, JOHN R & BRANDY E</td><td>14</td><td>72,606</td><td>1000</td><td>6,987</td><td>620.00</td></tr> </tbody> </table>										Tax Year	Statement Number	Billed Owner	Tax Area	Total Value	Exemptions	Taxable Value	Billed Tax	2025	2025-660069042	HAND, MICHELLE ROSE &	14	49,271	0	5,420	449.00	2024	2024-660069042	HAND, MICHELLE ROSE &	14	34,369	1000	2,780	235.00	2023	2023-660069042	BLAIR, JOHN R & BRANDY E	14	70,794	1000	6,788	579.00	2022	2022-660069042	BLAIR, JOHN R & BRANDY E	14	69,153	1000	6,574	556.00	2021	2021-660069042	BLAIR, JOHN R & BRANDY E	14	74,404	1000	6,354	539.00	2020	2020-660069042	BLAIR, JOHN R & BRANDY E	14	70,862	1000	6,140	521.00	2019	2019-660069042	BLAIR, JOHN R & BRANDY E	14	63,019	1000	5,932	509.00	2018	2018-660069042	BLAIR, JOHN R & BRANDY E	14	65,415	1000	6,195	529.00	2017	2017-660069042	BLAIR, JOHN R & BRANDY E	14	65,070	1000	6,158	528.00	2016	2016-660069042	BLAIR, JOHN R & BRANDY E	14	71,855	1000	6,904	602.00	2015	2015-660069042	BLAIR, JOHN R & BRANDY E	14	72,606	1000	6,987	602.00	2014	2014-660069042	BLAIR, JOHN R & BRANDY E	14	72,606	1000	6,987	622.00	2013	2013-660069042	BLAIR, JOHN R & BRANDY E	14	72,606	1000	6,987	620.00
Tax Year	Statement Number	Billed Owner	Tax Area	Total Value	Exemptions	Taxable Value	Billed Tax																																																																																																																		
2025	2025-660069042	HAND, MICHELLE ROSE &	14	49,271	0	5,420	449.00																																																																																																																		
2024	2024-660069042	HAND, MICHELLE ROSE &	14	34,369	1000	2,780	235.00																																																																																																																		
2023	2023-660069042	BLAIR, JOHN R & BRANDY E	14	70,794	1000	6,788	579.00																																																																																																																		
2022	2022-660069042	BLAIR, JOHN R & BRANDY E	14	69,153	1000	6,574	556.00																																																																																																																		
2021	2021-660069042	BLAIR, JOHN R & BRANDY E	14	74,404	1000	6,354	539.00																																																																																																																		
2020	2020-660069042	BLAIR, JOHN R & BRANDY E	14	70,862	1000	6,140	521.00																																																																																																																		
2019	2019-660069042	BLAIR, JOHN R & BRANDY E	14	63,019	1000	5,932	509.00																																																																																																																		
2018	2018-660069042	BLAIR, JOHN R & BRANDY E	14	65,415	1000	6,195	529.00																																																																																																																		
2017	2017-660069042	BLAIR, JOHN R & BRANDY E	14	65,070	1000	6,158	528.00																																																																																																																		
2016	2016-660069042	BLAIR, JOHN R & BRANDY E	14	71,855	1000	6,904	602.00																																																																																																																		
2015	2015-660069042	BLAIR, JOHN R & BRANDY E	14	72,606	1000	6,987	602.00																																																																																																																		
2014	2014-660069042	BLAIR, JOHN R & BRANDY E	14	72,606	1000	6,987	622.00																																																																																																																		
2013	2013-660069042	BLAIR, JOHN R & BRANDY E	14	72,606	1000	6,987	620.00																																																																																																																		



Rogers

Assessment Property Record Card for Tax Year 2026

Data provided by LISA DELOZIER County Assessor

Date 04/17/2026
 Time 04:48:03
 Page 2

Lot Data		Square-Foot - NBHD 4060 #1		Primary Image				
Lot Size								
Lot Count								
Units Buildable								
Non-Ag Acres								
Topography								
Street Access								
Utilities								
Amenities	LAND QUALITY					0		
						0		
Method	Square-Foot							
Base Lot Value								
Factor Value								
Adjustments								
Lot Value								
Residential Data				5/10/2024				
Type		GRM Approach						
Condition	-	GRM Code						
Quality	-	Gross Rent 0.00						
Architecture		Indicated Value						
Style		Multiple Regression						
Exterior Wall		MRA Code						
Base/Total Area /		Adusted R						
Style		Indicated Value						
HVAC		Direct Comparables						
Roof Cover		Selection Model 1 Res						
Area on Slab		Adjustment Model A2 AO Test						
Fixture/RghIn /		Comparables						
Bed/F/H Bath / /		Indicated Value						
Basement Area		Value Reconciliation						
Garage Type		Selected Approach Cost Approach						
Remodel		Improvements						
Year/Eff Age /		Lot Value						
Cost Approach		Manual : 01/2025		Indicated Value 0.00 Per SqFt				
Base Cost	0.00	Total Misc Impr	+	0	Agland Value 120			
Roofing Adj	+ 0.00	Garage Cost	+		Site Improvements 1,278			
Subfloor Adj	+ 0.00	Total RCN	=	0	Total Value 1,398 0.00 Total Value Per SqFt			
Heat/Cool Adj	+ 0.00	Depreciation (0%)	-	0				
Plumbing Adj	+ 0.00	Lump Sums	+	0				
Basement Adj	+ 0.00	RCNLD	=					
Adj Base Cost	= 0.00	Lot Value	+					
Total Area	x	Indicated Value	=					
Adjusted Cost	= 0	Value Per SqFt		0.00				
Miscellaneous Improvements								
Code	Description	Sketch ID	Size	Year	Units	Unit Cost	Depr	Value



Rogers

Assessment Property Record Card for Tax Year 2026

Data provided by LISA DELOZIER County Assessor

Date 04/17/2026
Time 04:48:03
Page 3

660069042

Outbuildings/Site Improvements

Building Image	Code	Description	Dimensions	Floor	Roofing	Total Units	
	LF	LOAFING SHED	20x30x0			600	
	Qual	3	Cond	3	Year	Eff Age	
	Valuation Summary		Modifier Total	RCN	Depr (50% Phys/ % Func)	RCNLD	
		Base Cost (4.26 x 600)	2,556		2,556	1,278	1,278
	STF	STG FAIR	0x0x0				
	Qual	2	Cond		Year	Eff Age	
	Valuation Summary		Modifier Total	RCN	Depr (100% Phys/ % Func)	RCNLD	
		Base Cost (4.68 x)					
	STF	STG FAIR	0x0x0				
	Qual	2	Cond		Year	Eff Age	
	Valuation Summary		Modifier Total	RCN	Depr (100% Phys/ % Func)	RCNLD	
		Base Cost (4.68 x)					
	STF	STG FAIR	0x0x0				
	Qual	2	Cond		Year	Eff Age	
	Valuation Summary		Modifier Total	RCN	Depr (100% Phys/ % Func)	RCNLD	
		Base Cost (4.68 x)					
	CP	CARPORT DIRT	0x0x0				
	Qual		Cond		Year	Eff Age	
	Valuation Summary		Modifier Total	RCN	Depr (100% Phys/ % Func)	RCNLD	
		Base Cost (3.50 x)					



Rogers

Assessment Property Record Card for Tax Year 2026

Data provided by LISA DELOZIER County Assessor

Date 04/17/2026
 Time 04:48:04
 Page 4

Lot Data	Primary Image
Lot Size Lot Count Units Buildable Non-Ag Acres Topography Street Access Utilities Amenities LAND QUALITY Method Base Lot Value Factor Value Adjustments Lot Value	

Residential Data	
Type	6 Mobile Home 80 x 28
Condition	3 - Average
Quality	3 - Average
Architecture	6 MS ADJ
Style	100% Double Wide
Exterior Wall	100% Frame, Siding, Vinyl
Base/Total Area	2,240 / 2,240
Style	100% Double Wide
HVAC	100% Warmed & Cooled Air
Roof Cover	14 Metal, Ribbed
Area on Slab	0
Fixture/RghIn	/
Bed/F/H Bath	/ /
Basement Area	
Garage Type	
Remodel	
Year/Eff Age	1999 / 20

\\tsclient\C\Users\rln\Pictures\2020-05-18\IMG_0007.JPG	5/18/2020
---	-----------

GRM Approach	
GRM Code	
Gross Rent	0.00
Indicated Value	

Multiple Regression	
MRA Code	
Adjusted R	
Indicated Value	

Direct Comparables	
Selection Model	1 Res
Adjustment Model	A2 AO Test
Comparables	
Indicated Value	

Cost Approach				Manual : 01/2025	
Base Cost	30.86	Total Misc Impr	+	1,594	
Roofing Adj	+ 2.36	Garage Cost	+		
Subfloor Adj	+ 0.00	Total RCN	=	90,679	
Heat/Cool Adj	+ 1.89	Depreciation (53%)	-	48,060	
Plumbing Adj	+ 4.66	Lump Sums	+	4,813	
Basement Adj	+ 0.00	RCNLD	=	47,432	
Adj Base Cost	= 39.77	Lot Value	+		
Total Area	x 2,240	Indicated Value	=	47,432	
Adjusted Cost	= 89,085	Value Per SqFt		21.18	

Value Reconciliation			
Selected Approach	Cost Approach		
Improvements	47,432		
Lot Value			
Indicated Value	47,432	21.18	Per SqFt
Agland Value			
Site Improvements			
Total Value	47,432	21.18	Total Value Per SqFt

Miscellaneous Improvements								
Code	Description	Sketch ID	Size	Year	Units	Unit Cost	Depr	Value
PATO	SLAB PORCH - OPEN	145365	18x8		144	11.07		1,594
WODC	WOOD DECK - COVERED	145366	18x12		216	37.14	40%	4,813



Rogers

Assessment Property Record Card for Tax Year 2026

Data provided by LISA DELOZIER County Assessor

Date 04/17/2026
Time 04:48:04
Page 5

Sketch Image

660069042

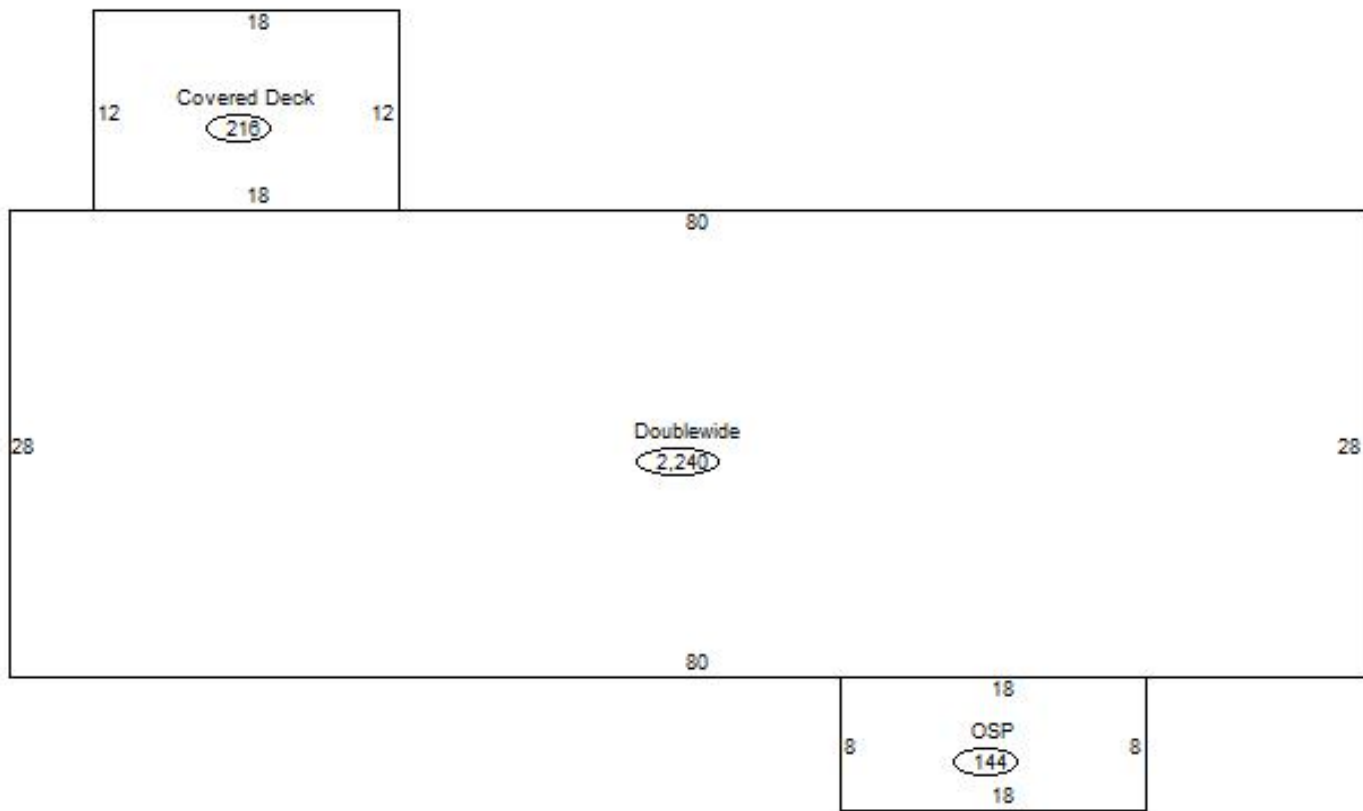

Sketch Vector Information

Sequence	Code	Type	Built Over	Scale	Section Label	Base Area	Multiplier	Total Area
1	R	14		13	Doublewide	2,240	1.000	2,240
2	M	PATO		13	Open Slab	144	1.000	144
3	M	WODC		13	WODC	216	1.000	216
Total Building Area						2,240		2,240



Rogers

Assessment Property Record Card for Tax Year 2026

Data provided by LISA DELOZIER County Assessor

Date 04/17/2026
Time 04:48:04
Page 6

Agland Inventory

660069042

Soi	Description	Land Use	LPI	Adj Type	Adj Code	Acres	Use/Acre	Mkt/Acre	Use Value	Market Value
DNC	DENNIS SILT LOAM 3-5% SLO	NTV PST	69			.723	166	166	120	120
NTV PST Totals						0.723			120	120
Total Agland						0.723			120	120