



Rogers

Assessment Property Record Card for Tax Year 2026

Data provided by LISA DELOZIER County Assessor

Date 04/18/2026
 Time 07:33:28
 Page 1

Assessment Data					Primary Image																																																																																																																				
Account 660070086 Parcel ID 21N16E-13-3-00000-000-0000 Cadastral ID 13-21-16-01310 Property Type REAL - Real Property Property Class RA VI Area 1 Tax Area 5 - JUSTUS RURAL/NO FIRE Name ID 337505 SHERBUNDY, ISAAC W & DESIREE 15485 E 500 RD CLAREMORE OK 74019-0000 Parcel Location Situs 15485 E 500 RD Subdivision Lot/Block / Parcel Size 10 - Acres Sec/Twn/Rng 13 / 21 / 16 / 3 Neighborhood 2116 - UNPLATTED School District S009 - JUSTUS-TIAWAH SCHOOLS																																																																																																																									
Legal Description Lat/Long: 36.29464260 -95.55378481																																																																																																																									
W2 E2 SE SW					Building Permits <table border="1"> <thead> <tr> <th>Number</th> <th>Description</th> <th>Opened</th> <th>Closed</th> <th>Amount</th> </tr> </thead> <tbody> <tr> <td>5092</td> <td>NEW HOME</td> <td>08/1998</td> <td>03/2000</td> <td></td> </tr> </tbody> </table>					Number	Description	Opened	Closed	Amount	5092	NEW HOME	08/1998	03/2000																																																																																																							
Number	Description	Opened	Closed	Amount																																																																																																																					
5092	NEW HOME	08/1998	03/2000																																																																																																																						
Exemptions <table border="1"> <thead> <tr> <th>Code</th> <th>Type</th> <th>Active</th> <th>Maximum</th> <th>Exemption</th> </tr> </thead> <tbody> <tr> <td>H</td> <td>Homestead</td> <td>Yes</td> <td>1,000</td> <td>1,000</td> </tr> </tbody> </table>					Code	Type	Active	Maximum	Exemption	H	Homestead	Yes	1,000	1,000	Sale History <table border="1"> <thead> <tr> <th>Bk/Pg</th> <th>Grantor</th> <th>Date</th> <th>Price</th> <th>Code</th> </tr> </thead> <tbody> <tr> <td>/</td> <td>ARNOLD, STEVEN W &</td> <td>02/21/2022</td> <td>380,000</td> <td>YES</td> </tr> <tr> <td>1100/92</td> <td>SPURLOCK, JACK & ETAL</td> <td>02/24/1998</td> <td>47,000</td> <td>No</td> </tr> </tbody> </table>					Bk/Pg	Grantor	Date	Price	Code	/	ARNOLD, STEVEN W &	02/21/2022	380,000	YES	1100/92	SPURLOCK, JACK & ETAL	02/24/1998	47,000	No																																																																																							
Code	Type	Active	Maximum	Exemption																																																																																																																					
H	Homestead	Yes	1,000	1,000																																																																																																																					
Bk/Pg	Grantor	Date	Price	Code																																																																																																																					
/	ARNOLD, STEVEN W &	02/21/2022	380,000	YES																																																																																																																					
1100/92	SPURLOCK, JACK & ETAL	02/24/1998	47,000	No																																																																																																																					
Parcel Valuation <table border="1"> <thead> <tr> <th>Source</th> <th>REAL</th> <th>Fair Cash</th> <th>Capped</th> <th>Asmnt Level</th> <th>Assessed</th> <th>Levy Rate</th> <th>83.050</th> <th>Current Tax</th> </tr> </thead> <tbody> <tr> <td>Remove Cap</td> <td>2023</td> <td>Land Value 1,576</td> <td>1,576</td> <td>11%</td> <td>173</td> <td>Assessed</td> <td>38,737</td> <td>3,217.11</td> </tr> <tr> <td>Year Frozen</td> <td>0</td> <td>Improvements 350,587</td> <td>350,587</td> <td></td> <td>38,564</td> <td>Penalty</td> <td>0</td> <td></td> </tr> <tr> <td>Uncapped Value</td> <td>0</td> <td>Mobile Home 0</td> <td>0</td> <td></td> <td>0</td> <td>Exemption</td> <td>1,000</td> <td>-83.00</td> </tr> <tr> <td>TIF Project ID</td> <td>0</td> <td>Total Value 352,163</td> <td>352,163</td> <td></td> <td>38,737</td> <td>Total Taxable</td> <td>37,737</td> <td>3,134.00</td> </tr> </tbody> </table>										Source	REAL	Fair Cash	Capped	Asmnt Level	Assessed	Levy Rate	83.050	Current Tax	Remove Cap	2023	Land Value 1,576	1,576	11%	173	Assessed	38,737	3,217.11	Year Frozen	0	Improvements 350,587	350,587		38,564	Penalty	0		Uncapped Value	0	Mobile Home 0	0		0	Exemption	1,000	-83.00	TIF Project ID	0	Total Value 352,163	352,163		38,737	Total Taxable	37,737	3,134.00																																																																			
Source	REAL	Fair Cash	Capped	Asmnt Level	Assessed	Levy Rate	83.050	Current Tax																																																																																																																	
Remove Cap	2023	Land Value 1,576	1,576	11%	173	Assessed	38,737	3,217.11																																																																																																																	
Year Frozen	0	Improvements 350,587	350,587		38,564	Penalty	0																																																																																																																		
Uncapped Value	0	Mobile Home 0	0		0	Exemption	1,000	-83.00																																																																																																																	
TIF Project ID	0	Total Value 352,163	352,163		38,737	Total Taxable	37,737	3,134.00																																																																																																																	
Assessment History <table border="1"> <thead> <tr> <th>Tax Year</th> <th>Statement Number</th> <th>Billed Owner</th> <th>Tax Area</th> <th>Total Value</th> <th>Exemptions</th> <th>Taxable Value</th> <th>Billed Tax</th> </tr> </thead> <tbody> <tr><td>2025</td><td>2025-660070086</td><td>SHERBUNDY, ISAAC W &</td><td>5</td><td>425,494</td><td>1000</td><td>42,961</td><td>3,568.00</td></tr> <tr><td>2024</td><td>2024-660070086</td><td>SHERBUNDY, ISAAC W &</td><td>5</td><td>406,521</td><td>1000</td><td>41,681</td><td>3,478.00</td></tr> <tr><td>2023</td><td>2023-660070086</td><td>SHERBUNDY, ISAAC W &</td><td>5</td><td>376,707</td><td>1000</td><td>40,437</td><td>3,367.00</td></tr> <tr><td>2022</td><td>2022-660070086</td><td>SHERBUNDY, ISAAC W &</td><td>5</td><td>216,790</td><td>1000</td><td>22,778</td><td>1,895.00</td></tr> <tr><td>2021</td><td>2021-660070086</td><td>ARNOLD, STEVEN W &</td><td>5</td><td>210,540</td><td>1000</td><td>22,085</td><td>1,873.00</td></tr> <tr><td>2020</td><td>2020-660070086</td><td>ARNOLD, STEVEN W &</td><td>5</td><td>206,720</td><td>1000</td><td>21,413</td><td>1,813.00</td></tr> <tr><td>2019</td><td>2019-660070086</td><td>ARNOLD, STEVEN W &</td><td>5</td><td>197,825</td><td>1000</td><td>20,760</td><td>1,798.00</td></tr> <tr><td>2018</td><td>2018-660070086</td><td>ARNOLD, STEVEN W &</td><td>5</td><td>203,718</td><td>1000</td><td>21,409</td><td>1,856.00</td></tr> <tr><td>2017</td><td>2017-660070086</td><td>ARNOLD, STEVEN W &</td><td>5</td><td>201,851</td><td>1000</td><td>20,965</td><td>1,710.00</td></tr> <tr><td>2016</td><td>2016-660070086</td><td>ARNOLD, STEVEN W &</td><td>5</td><td>195,886</td><td>1000</td><td>20,325</td><td>1,734.00</td></tr> <tr><td>2015</td><td>2015-660070086</td><td>ARNOLD, STEVEN W &</td><td>5</td><td>189,842</td><td>1000</td><td>19,704</td><td>1,665.00</td></tr> <tr><td>2014</td><td>2014-660070086</td><td>ARNOLD, STEVEN W &</td><td>5</td><td>191,640</td><td>1000</td><td>19,101</td><td>1,639.00</td></tr> <tr><td>2013</td><td>2013-660070086</td><td>ARNOLD, STEVEN W &</td><td>5</td><td>178,939</td><td>1000</td><td>18,516</td><td>1,613.00</td></tr> </tbody> </table>										Tax Year	Statement Number	Billed Owner	Tax Area	Total Value	Exemptions	Taxable Value	Billed Tax	2025	2025-660070086	SHERBUNDY, ISAAC W &	5	425,494	1000	42,961	3,568.00	2024	2024-660070086	SHERBUNDY, ISAAC W &	5	406,521	1000	41,681	3,478.00	2023	2023-660070086	SHERBUNDY, ISAAC W &	5	376,707	1000	40,437	3,367.00	2022	2022-660070086	SHERBUNDY, ISAAC W &	5	216,790	1000	22,778	1,895.00	2021	2021-660070086	ARNOLD, STEVEN W &	5	210,540	1000	22,085	1,873.00	2020	2020-660070086	ARNOLD, STEVEN W &	5	206,720	1000	21,413	1,813.00	2019	2019-660070086	ARNOLD, STEVEN W &	5	197,825	1000	20,760	1,798.00	2018	2018-660070086	ARNOLD, STEVEN W &	5	203,718	1000	21,409	1,856.00	2017	2017-660070086	ARNOLD, STEVEN W &	5	201,851	1000	20,965	1,710.00	2016	2016-660070086	ARNOLD, STEVEN W &	5	195,886	1000	20,325	1,734.00	2015	2015-660070086	ARNOLD, STEVEN W &	5	189,842	1000	19,704	1,665.00	2014	2014-660070086	ARNOLD, STEVEN W &	5	191,640	1000	19,101	1,639.00	2013	2013-660070086	ARNOLD, STEVEN W &	5	178,939	1000	18,516	1,613.00
Tax Year	Statement Number	Billed Owner	Tax Area	Total Value	Exemptions	Taxable Value	Billed Tax																																																																																																																		
2025	2025-660070086	SHERBUNDY, ISAAC W &	5	425,494	1000	42,961	3,568.00																																																																																																																		
2024	2024-660070086	SHERBUNDY, ISAAC W &	5	406,521	1000	41,681	3,478.00																																																																																																																		
2023	2023-660070086	SHERBUNDY, ISAAC W &	5	376,707	1000	40,437	3,367.00																																																																																																																		
2022	2022-660070086	SHERBUNDY, ISAAC W &	5	216,790	1000	22,778	1,895.00																																																																																																																		
2021	2021-660070086	ARNOLD, STEVEN W &	5	210,540	1000	22,085	1,873.00																																																																																																																		
2020	2020-660070086	ARNOLD, STEVEN W &	5	206,720	1000	21,413	1,813.00																																																																																																																		
2019	2019-660070086	ARNOLD, STEVEN W &	5	197,825	1000	20,760	1,798.00																																																																																																																		
2018	2018-660070086	ARNOLD, STEVEN W &	5	203,718	1000	21,409	1,856.00																																																																																																																		
2017	2017-660070086	ARNOLD, STEVEN W &	5	201,851	1000	20,965	1,710.00																																																																																																																		
2016	2016-660070086	ARNOLD, STEVEN W &	5	195,886	1000	20,325	1,734.00																																																																																																																		
2015	2015-660070086	ARNOLD, STEVEN W &	5	189,842	1000	19,704	1,665.00																																																																																																																		
2014	2014-660070086	ARNOLD, STEVEN W &	5	191,640	1000	19,101	1,639.00																																																																																																																		
2013	2013-660070086	ARNOLD, STEVEN W &	5	178,939	1000	18,516	1,613.00																																																																																																																		



Rogers

Assessment Property Record Card for Tax Year 2026

Data provided by LISA DELOZIER County Assessor

Date 04/18/2026
 Time 07:33:29
 Page 2

Lot Data	Primary Image
Lot Size Lot Count Units Buildable Non-Ag Acres 0 Topography Street Access Utilities Amenities LAND QUALITY Method Base Lot Value Factor Value Adjustments Lot Value	

Residential Data	
Type	1 Single Family Residence
Condition	5 - Very Good
Quality	4.5 - Good
Architecture	
Style	100% Two Story
Exterior Wall	60% Veneer, Masonry 40% Frame, Siding, Wood
Base/Total Area	1,312 / 2,624
Style	100% Two Story
HVAC	100% Warmed & Cooled Air
Roof Cover	1 Composition Shingle
Area on Slab	0
Fixture/RghIn	14 /
Bed/F/H Bath	4 / 2.5 /
Basement Area	
Garage Type	418 Attached Garage - Unfinished
Remodel	
Year/Eff Age	1999 / 12



\\tsclient\T\LOGAN\LOGAN RESIDENTIAL VI\2023-7-13\IMG_000 7/13/2023

GRM Approach	
GRM Code	
Gross Rent	0.00
Indicated Value	

Multiple Regression	
MRA Code	
Adusted R	
Indicated Value	

Direct Comparables	
Selection Model	A Adam Test
Adjustment Model	NewTest
Comparables	
Indicated Value	

Cost Approach				Manual : 01/2025			
Base Cost	95.36	Total Misc Impr	+ 16,442	Roofing Adj	+ 3.30	Garage Cost	+ 22,756
Subfloor Adj	+ 0.00	Total RCN	= 370,530	Heat/Cool Adj	+ 17.38	Depreciation (12%)	- 44,464
Plumbing Adj	+ 10.23	Lump Sums	+ 0	Basement Adj	+ 0.00	RCNLD	= 326,066
Adj Base Cost	= 126.27	Lot Value	+ 326,066	Total Area	x 2,624	Indicated Value	= 326,066
Adjusted Cost	= 331,332	Value Per SqFt	124.26	Adjusted Cost	= 331,332	Value Per SqFt	124.26

Value Reconciliation			
Selected Approach	Cost Approach		
Improvements	326,066		
Lot Value			
Indicated Value	326,066	124.26	Per SqFt
Agland Value	1,576		
Site Improvements	24,521		
Total Value	352,163	134.21	Total Value Per SqFt

Miscellaneous Improvements								
Code	Description	Sketch ID	Size	Year	Units	Unit Cost	Depr	Value
FPR1	FIREPLACE - RESIDENTIAL 1 STORY	0		1	1	7,721.18		7,721
PRCH	SLAB PORCH - COVERED	84728	41x6		246	35.45		8,721



Rogers

Assessment Property Record Card for Tax Year 2026

Data provided by LISA DELOZIER County Assessor

Date 04/18/2026
Time 07:33:29
Page 3

Sketch Image

660070086

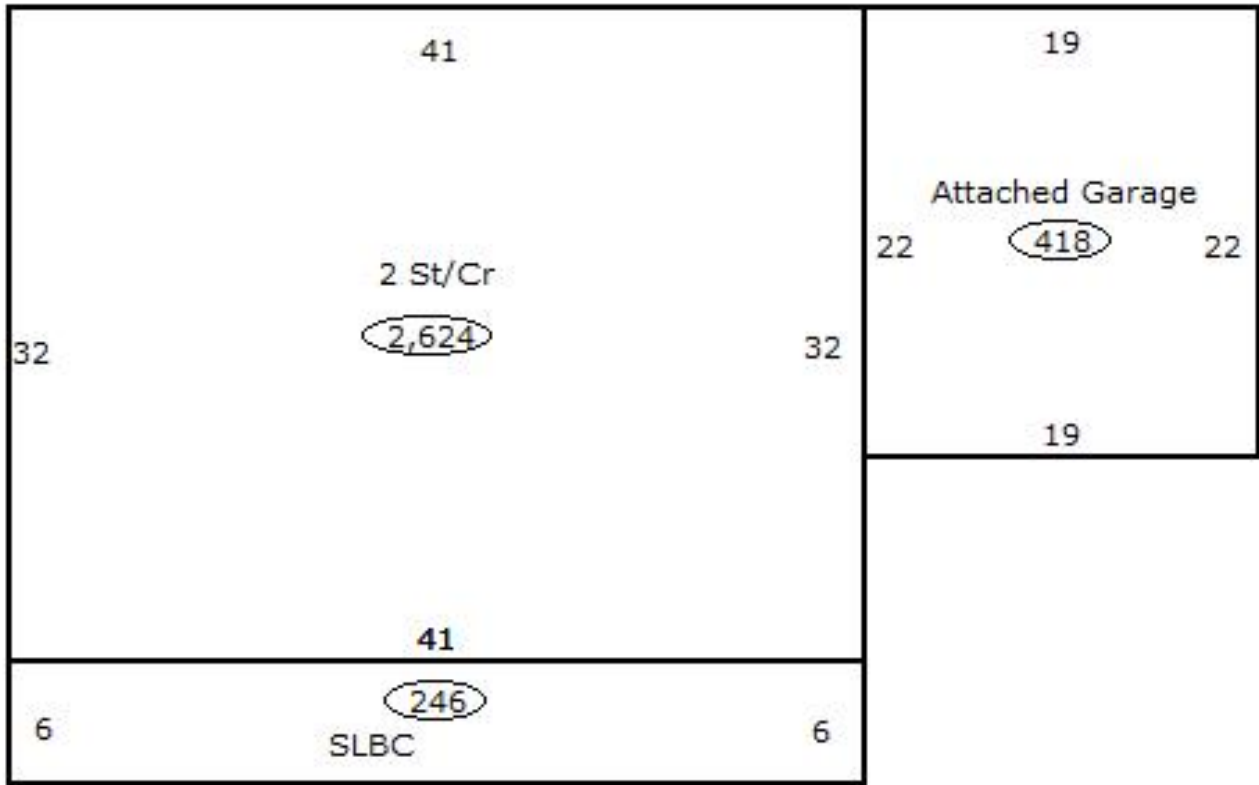

Sketch Vector Information

Sequence	Code	Type	Built Over	Scale	Section Label	Base Area	Multiplier	Total Area
1	R	2	Crawl	13	2 St/Cr	1,312	2.000	2,624
2	G	1		13	Attached Garage	418	1.000	418
3	M	PRCH		13	SLBC	246	1.000	246
Total Building Area						1,312		2,624



Rogers

Assessment Property Record Card for Tax Year 2026

Data provided by LISA DELOZIER County Assessor

Date 04/18/2026
Time 07:33:29
Page 4

660070086

Outbuildings/Site Improvements

Building Image	Code	Description	Dimensions	Floor	Roofing	Total Units
	UTIL	SHOP BUILDING	0x0x0			1,260
	Qual 2	Cond 3	Year	Eff Age		
Valuation Summary		Modifier Total	RCN	Depr (35% Phys/ % Func)	RCNLD	
Base Cost (29.94 x 1,260)		37,724	37,724	13,203	24,521	



Rogers

Assessment Property Record Card for Tax Year 2026

Data provided by LISA DELOZIER County Assessor

Date 04/18/2026
 Time 07:33:29
 Page 5

Agland Inventory

660070086

Soi	Description	Land Use	LPI	Adj Type	Adj Code	Acres	Use/Acre	Mkt/Acre	Use Value	Market Value
BC	BATES-COLLINSVILLE COMPLE	TMBR	51			.320	92	92	29	29
CO	COLLINSVILLE STONY LOAM	TMBR	22			.450	40	40	18	18
DNB	DENNIS SILT LOAM 1-3% SLO	TMBR	80			1.460	144	144	210	210
TMBR Totals						2.230			257	257
BC	BATES-COLLINSVILLE COMPLE	NTV PST	51			1.910	122	122	234	234
DNB	DENNIS SILT LOAM 1-3% SLO	NTV PST	80			4.340	192	192	833	833
DNC	DENNIS SILT LOAM 3-5% SLO	NTV PST	69			1.520	166	166	252	252
NTV PST Totals						7.770			1,319	1,319
Total Agland						10.000			1,576	1,576