



Rogers

Assessment Property Record Card for Tax Year 2026

Data provided by LISA DELOZIER County Assessor

Date 04/17/2026
Time 05:53:44
Page 1

Assessment Data					Primary Image																																																																																																																				
Account 660071060 Parcel ID 24N15E-30-3-00000-000-0000 Cadastral ID 30-24-15-00430 Property Type REAL - Real Property Property Class RA VI Area 2 Tax Area 10 - OOLOGAH RURAL/NW FIRE Name ID 300163 CHAIN, VICKI SUE TRUSTEE PO BOX 49 TALALA OK 74080-0000 Parcel Location Situs 04015 E 340 RD Subdivision Lot/Block / Parcel Size 79.02 - Acres Sec/Twn/Rng 30 / 24 / 15 / 3 Neighborhood 4040 - TALALA AREA WEST OF LAKE School District S004 - OOLOGAH SCHOOLS					<p>660071060 02/25/25</p> <p>660071060_002.JPG 2/25/2025</p>																																																																																																																				
Legal Description Lat/Long: 36.52850482 -95.75623513																																																																																																																									
Legal Description GOV'T LOTS 3 & 4					Building Permits <table border="1"> <thead> <tr> <th>Number</th> <th>Description</th> <th>Opened</th> <th>Closed</th> <th>Amount</th> </tr> </thead> <tbody> <tr> <td> </td> <td> </td> <td> </td> <td> </td> <td> </td> </tr> </tbody> </table>					Number	Description	Opened	Closed	Amount																																																																																																											
Number	Description	Opened	Closed	Amount																																																																																																																					
Exemptions <table border="1"> <thead> <tr> <th>Code</th> <th>Type</th> <th>Active</th> <th>Maximum</th> <th>Exemption</th> </tr> </thead> <tbody> <tr> <td>H</td> <td>Homestead</td> <td>Yes</td> <td>1,000</td> <td>1,000</td> </tr> </tbody> </table>					Code	Type	Active	Maximum	Exemption	H	Homestead	Yes	1,000	1,000	Sale History <table border="1"> <thead> <tr> <th>Bk/Pg</th> <th>Grantor</th> <th>Date</th> <th>Price</th> <th>Code</th> </tr> </thead> <tbody> <tr> <td>2014/356</td> <td>BANK OF AMERICA - RPMC</td> <td>03/23/2009</td> <td>650,000</td> <td>YES</td> </tr> <tr> <td>1189/216</td> <td>TAYLOR, MARSHALL &-FRANCINE</td> <td>08/25/1999</td> <td>165,000</td> <td>No</td> </tr> <tr> <td>1118/720</td> <td>CULLISON, HELEN DALE TRUSTEE</td> <td>06/24/1998</td> <td>103,000</td> <td>No</td> </tr> </tbody> </table>					Bk/Pg	Grantor	Date	Price	Code	2014/356	BANK OF AMERICA - RPMC	03/23/2009	650,000	YES	1189/216	TAYLOR, MARSHALL &-FRANCINE	08/25/1999	165,000	No	1118/720	CULLISON, HELEN DALE TRUSTEE	06/24/1998	103,000	No																																																																																		
Code	Type	Active	Maximum	Exemption																																																																																																																					
H	Homestead	Yes	1,000	1,000																																																																																																																					
Bk/Pg	Grantor	Date	Price	Code																																																																																																																					
2014/356	BANK OF AMERICA - RPMC	03/23/2009	650,000	YES																																																																																																																					
1189/216	TAYLOR, MARSHALL &-FRANCINE	08/25/1999	165,000	No																																																																																																																					
1118/720	CULLISON, HELEN DALE TRUSTEE	06/24/1998	103,000	No																																																																																																																					
Parcel Valuation <table border="1"> <thead> <tr> <th>Source</th> <th>REAL</th> <th>Fair Cash</th> <th>Capped</th> <th>Asmnt Level</th> <th>Assessed</th> <th>Levy Rate</th> <th>108.182</th> <th>Current Tax</th> </tr> </thead> <tbody> <tr> <td>Remove Cap</td> <td>2010</td> <td>Land Value 14,497</td> <td>14,497</td> <td>11%</td> <td>1,595</td> <td>Assessed</td> <td>63,517</td> <td>6,871.37</td> </tr> <tr> <td>Year Frozen</td> <td>0</td> <td>Improvements 649,836</td> <td>562,926</td> <td></td> <td>61,922</td> <td>Penalty</td> <td>0</td> <td></td> </tr> <tr> <td>Uncapped Value</td> <td>0</td> <td>Mobile Home 0</td> <td>0</td> <td></td> <td>0</td> <td>Exemption</td> <td>1,000</td> <td>-94.00</td> </tr> <tr> <td>TIF Project ID</td> <td>0</td> <td>Total Value 664,333</td> <td>577,423</td> <td></td> <td>63,517</td> <td>Total Taxable</td> <td>62,517</td> <td>6,777.00</td> </tr> </tbody> </table>										Source	REAL	Fair Cash	Capped	Asmnt Level	Assessed	Levy Rate	108.182	Current Tax	Remove Cap	2010	Land Value 14,497	14,497	11%	1,595	Assessed	63,517	6,871.37	Year Frozen	0	Improvements 649,836	562,926		61,922	Penalty	0		Uncapped Value	0	Mobile Home 0	0		0	Exemption	1,000	-94.00	TIF Project ID	0	Total Value 664,333	577,423		63,517	Total Taxable	62,517	6,777.00																																																																			
Source	REAL	Fair Cash	Capped	Asmnt Level	Assessed	Levy Rate	108.182	Current Tax																																																																																																																	
Remove Cap	2010	Land Value 14,497	14,497	11%	1,595	Assessed	63,517	6,871.37																																																																																																																	
Year Frozen	0	Improvements 649,836	562,926		61,922	Penalty	0																																																																																																																		
Uncapped Value	0	Mobile Home 0	0		0	Exemption	1,000	-94.00																																																																																																																	
TIF Project ID	0	Total Value 664,333	577,423		63,517	Total Taxable	62,517	6,777.00																																																																																																																	
Assessment History <table border="1"> <thead> <tr> <th>Tax Year</th> <th>Statement Number</th> <th>Billed Owner</th> <th>Tax Area</th> <th>Total Value</th> <th>Exemptions</th> <th>Taxable Value</th> <th>Billed Tax</th> </tr> </thead> <tbody> <tr><td>2025</td><td>2025-660071060</td><td>CHAIN, VICKI SUE</td><td>10</td><td>596,298</td><td>1000</td><td>60,667</td><td>6,577.00</td></tr> <tr><td>2024</td><td>2024-660071060</td><td>CHAIN, VICKI SUE</td><td>10</td><td>621,352</td><td>1000</td><td>58,871</td><td>6,180.00</td></tr> <tr><td>2023</td><td>2023-660071060</td><td>CHAIN, VICKI SUE</td><td>10</td><td>585,956</td><td>1000</td><td>57,127</td><td>5,954.00</td></tr> <tr><td>2022</td><td>2022-660071060</td><td>CHAIN, VICKI SUE</td><td>10</td><td>581,507</td><td>1000</td><td>55,434</td><td>5,752.00</td></tr> <tr><td>2021</td><td>2021-660071060</td><td>CHAIN, VICKI SUE</td><td>10</td><td>498,092</td><td>1000</td><td>53,790</td><td>5,621.00</td></tr> <tr><td>2020</td><td>2020-660071060</td><td>CHAIN, VICKI SUE</td><td>10</td><td>491,849</td><td>1000</td><td>53,104</td><td>5,631.00</td></tr> <tr><td>2019</td><td>2019-660071060</td><td>CHAIN, VICKI SUE</td><td>10</td><td>478,295</td><td>1000</td><td>51,613</td><td>5,371.00</td></tr> <tr><td>2018</td><td>2018-660071060</td><td>CHAIN, VICKI SUE</td><td>10</td><td>492,581</td><td>1000</td><td>50,460</td><td>5,433.00</td></tr> <tr><td>2017</td><td>2017-660071060</td><td>CHAIN, VICKI SUE</td><td>10</td><td>487,383</td><td>1000</td><td>48,962</td><td>5,581.00</td></tr> <tr><td>2016</td><td>2016-660071060</td><td>CHAIN, VICKI SUE</td><td>10</td><td>474,676</td><td>1000</td><td>47,507</td><td>4,933.00</td></tr> <tr><td>2015</td><td>2015-660071060</td><td>CHAIN, VICKI SUE</td><td>10</td><td>459,041</td><td>1000</td><td>46,094</td><td>4,529.00</td></tr> <tr><td>2014</td><td>2014-660071060</td><td>CHAIN, VICKI SUE</td><td>10</td><td>461,551</td><td>1000</td><td>44,722</td><td>4,387.00</td></tr> <tr><td>2013</td><td>2013-660071060</td><td>CHAIN, VICKI SUE</td><td>10</td><td>433,478</td><td>1000</td><td>43,390</td><td>4,117.00</td></tr> </tbody> </table>										Tax Year	Statement Number	Billed Owner	Tax Area	Total Value	Exemptions	Taxable Value	Billed Tax	2025	2025-660071060	CHAIN, VICKI SUE	10	596,298	1000	60,667	6,577.00	2024	2024-660071060	CHAIN, VICKI SUE	10	621,352	1000	58,871	6,180.00	2023	2023-660071060	CHAIN, VICKI SUE	10	585,956	1000	57,127	5,954.00	2022	2022-660071060	CHAIN, VICKI SUE	10	581,507	1000	55,434	5,752.00	2021	2021-660071060	CHAIN, VICKI SUE	10	498,092	1000	53,790	5,621.00	2020	2020-660071060	CHAIN, VICKI SUE	10	491,849	1000	53,104	5,631.00	2019	2019-660071060	CHAIN, VICKI SUE	10	478,295	1000	51,613	5,371.00	2018	2018-660071060	CHAIN, VICKI SUE	10	492,581	1000	50,460	5,433.00	2017	2017-660071060	CHAIN, VICKI SUE	10	487,383	1000	48,962	5,581.00	2016	2016-660071060	CHAIN, VICKI SUE	10	474,676	1000	47,507	4,933.00	2015	2015-660071060	CHAIN, VICKI SUE	10	459,041	1000	46,094	4,529.00	2014	2014-660071060	CHAIN, VICKI SUE	10	461,551	1000	44,722	4,387.00	2013	2013-660071060	CHAIN, VICKI SUE	10	433,478	1000	43,390	4,117.00
Tax Year	Statement Number	Billed Owner	Tax Area	Total Value	Exemptions	Taxable Value	Billed Tax																																																																																																																		
2025	2025-660071060	CHAIN, VICKI SUE	10	596,298	1000	60,667	6,577.00																																																																																																																		
2024	2024-660071060	CHAIN, VICKI SUE	10	621,352	1000	58,871	6,180.00																																																																																																																		
2023	2023-660071060	CHAIN, VICKI SUE	10	585,956	1000	57,127	5,954.00																																																																																																																		
2022	2022-660071060	CHAIN, VICKI SUE	10	581,507	1000	55,434	5,752.00																																																																																																																		
2021	2021-660071060	CHAIN, VICKI SUE	10	498,092	1000	53,790	5,621.00																																																																																																																		
2020	2020-660071060	CHAIN, VICKI SUE	10	491,849	1000	53,104	5,631.00																																																																																																																		
2019	2019-660071060	CHAIN, VICKI SUE	10	478,295	1000	51,613	5,371.00																																																																																																																		
2018	2018-660071060	CHAIN, VICKI SUE	10	492,581	1000	50,460	5,433.00																																																																																																																		
2017	2017-660071060	CHAIN, VICKI SUE	10	487,383	1000	48,962	5,581.00																																																																																																																		
2016	2016-660071060	CHAIN, VICKI SUE	10	474,676	1000	47,507	4,933.00																																																																																																																		
2015	2015-660071060	CHAIN, VICKI SUE	10	459,041	1000	46,094	4,529.00																																																																																																																		
2014	2014-660071060	CHAIN, VICKI SUE	10	461,551	1000	44,722	4,387.00																																																																																																																		
2013	2013-660071060	CHAIN, VICKI SUE	10	433,478	1000	43,390	4,117.00																																																																																																																		



Rogers

Assessment Property Record Card for Tax Year 2026

Data provided by LISA DELOZIER County Assessor

Date 04/17/2026
 Time 05:53:44
 Page 2

Units Buildable - TALALA AREA WEST OF LAKE (UNITS BUILDABL

Primary Image

Lot Size
 Lot Count
 Units Buildable
 Non-Ag Acres 0
 Topography
 Street Access
 Utilities
 Amenities LAND QUALITY

Method Units-Buildable
 Base Lot Value
 Factor Value
 Adjustments
 Lot Value



660071060

02/25/25

660071060_002.JPG

2/25/2025

Residential Data

Type 1 Single Family Residence
 Condition 3 - Average
 Quality 5 - Very Good
 Architecture
 Style 100% 1 1/2 Story Finished
 Exterior Wall 100% Veneer, Masonry
 Base/Total Area 3,585 / 4,003
 Style 100% 1 1/2 Story Finished
 HVAC 100% Warmed & Cooled Air
 Roof Cover 1 Composition Shingle
 Area on Slab 3,585
 Fixture/RghIn 17 /
 Bed/F/H Bath 5 / 4.0 /
 Basement Area
 Garage Type 1,114 Attached Garage - Unfinished
 Remodel
 Year/Eff Age 2007 / 14

GRM Approach

GRM Code
 Gross Rent 0.00
 Indicated Value

Multiple Regression

MRA Code
 Adjusted R
 Indicated Value

Direct Comparables

Selection Model 1 Res
 Adjustment Model A2 AO Test
 Comparables
 Indicated Value

Cost Approach

Manual : 01/2025

Base Cost	107.50	Total Misc Impr	+	29,814
Roofing Adj	+ 5.50	Garage Cost	+	56,126
Subfloor Adj	+ -3.78	Total RCN	=	629,147
Heat/Cool Adj	+ 18.08	Depreciation (14%)	-	88,081
Plumbing Adj	+ 8.41	Lump Sums	+	0
Basement Adj	+ 0.00	RCNLD	=	541,066
Adj Base Cost	= 135.70	Lot Value	+	
Total Area	x 4,003	Indicated Value	=	541,066
Adjusted Cost	= 543,207	Value Per SqFt		135.17

Value Reconciliation

Selected Approach	Cost Approach		
Improvements	541,066		
Lot Value			
Indicated Value	541,066	135.17	Per SqFt
Agland Value	14,497		
Site Improvements	108,770		
Total Value	664,333	165.96	Total Value Per SqFt

Miscellaneous Improvements

Code	Description	Sketch ID	Size	Year	Units	Unit Cost	Depr	Value
PRCH	SLAB PORCH - COVERED	84951	36x15		540	34.39		18,571
PRCH	SLAB PORCH - COVERED	84952	25x5		125	36.07		4,509
PRCH	SLAB PORCH - COVERED	84953	21x9		189	35.63		6,734



Rogers

Assessment Property Record Card for Tax Year 2026

Data provided by LISA DELOZIER County Assessor

Date 04/17/2026

Time 05:53:44

Page 3

Sketch Image

660071060

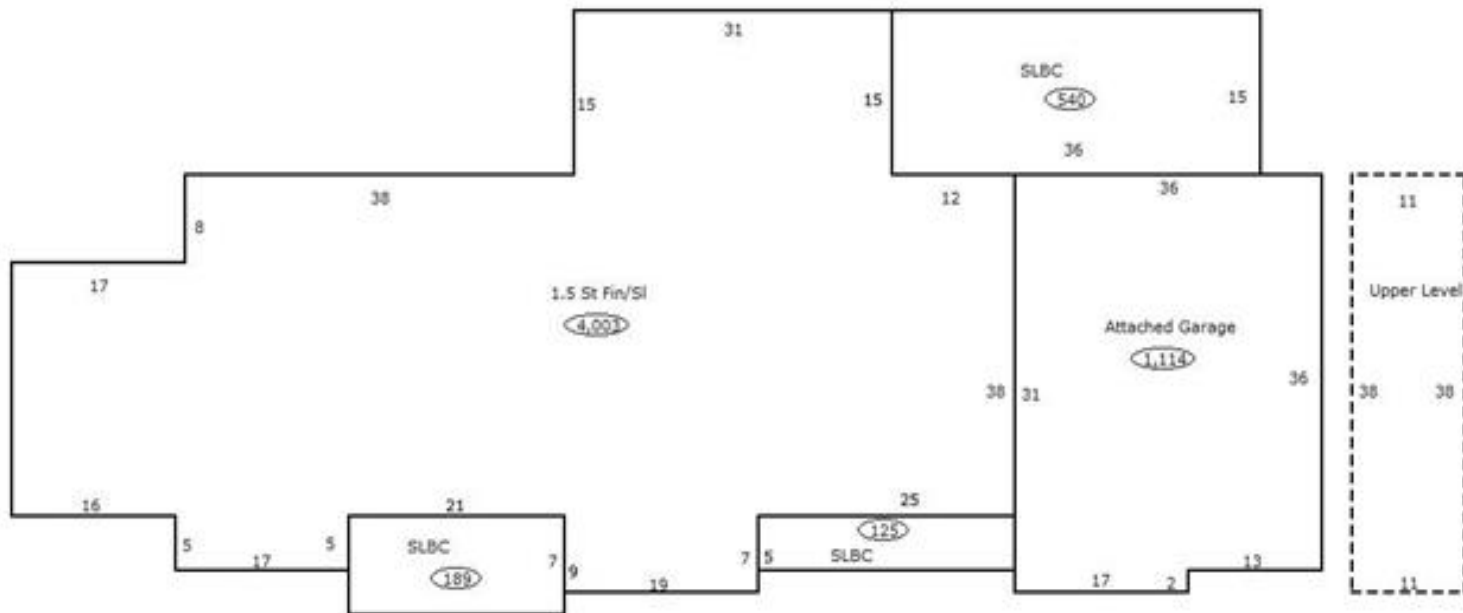

Sketch Vector Information

Sequence	Code	Type	Built Over	Scale	Section Label	Base Area	Multiplier	Total Area
1	R	5	Slab	13	1.5 St Fin/SI	3,585	1.117	4,003
2	G	1		13	Attached Garage	1,114	1.000	1,114
3	M	PRCH		13	SLBC	540	1.000	540
4	M	PRCH		13	SLBC	125	1.000	125
5	M	PRCH		13	SLBC	189	1.000	189
6	U	^UL	Overhang	13	Upper Level	418	1.000	418
Total Building Area						3,585		4,003



Rogers

Assessment Property Record Card for Tax Year 2026

Data provided by LISA DELOZIER County Assessor

Date 04/17/2026
 Time 05:53:45
 Page 4

660071060

Outbuildings/Site Improvements

Building Image	Code	Description	Dimensions	Floor	Roofing	Total Units
	LT	LEAN-TO	70x10x0			700
	Qual	2	Cond 3	Year 2012	Eff Age	
	Valuation Summary		Modifier Total	RCN	Depr (5% Phys/ % Func)	RCNLD
	Base Cost (2.92 x 700)	2,044		2,044	102	1,942
	LT	LEAN-TO	70x10x0			700
	Qual	2	Cond 3	Year 2012	Eff Age	
	Valuation Summary		Modifier Total	RCN	Depr (5% Phys/ % Func)	RCNLD
	Base Cost (2.92 x 700)	2,044		2,044	102	1,942
	BARN	BARN	40x30x0			1,200
	Qual	3	Cond 3	Year 2012	Eff Age 11	
	Valuation Summary		Modifier Total	RCN	Depr (5% Phys/ % Func)	RCNLD
	Base Cost (10.66 x 1,200)	12,792		12,792	640	12,152
	UTIL	SHOP BUILDING	0x0x0			2,800
	Qual	2	Cond 3	Year 2010	Eff Age	
	Valuation Summary		Modifier Total	RCN	Depr (5% Phys/ % Func)	RCNLD
	Base Cost (24.89 x 2,800)	69,692		69,692	3,485	66,207
	LF	LOAFING SHED	0x0x0			200
	Qual	3	Cond 3	Year 2010	Eff Age	
	Valuation Summary		Modifier Total	RCN	Depr (5% Phys/ % Func)	RCNLD
	Base Cost (4.26 x 200)	852		852	43	809
	BARN	BARN	0x0x0			1,512
	Qual	3	Cond 3	Year	Eff Age	
	Valuation Summary		Modifier Total	RCN	Depr (25% Phys/ % Func)	RCNLD
	Base Cost (9.78 x 1,512)	14,787		14,787	3,697	11,090
	LT	LEAN-TO	0x0x0			972
	Qual	3	Cond 3	Year	Eff Age	
	Valuation Summary		Modifier Total	RCN	Depr (25% Phys/ % Func)	RCNLD
	Base Cost (2.92 x 972)	2,838		2,838	710	2,128



Rogers

Assessment Property Record Card for Tax Year 2026

Data provided by LISA DELOZIER County Assessor

Date 04/17/2026
 Time 05:53:45
 Page 5

660071060

Outbuildings/Site Improvements

Building Image	Code	Description	Dimensions	Floor	Roofing	Total Units
	SV	SWIM VINYL	0x0x0			1
	Qual	3	Cond 3	Year	Eff Age	
		Valuation Summary	Modifier Total	RCN	Depr (50% Phys/ % Func)	RCNLD
		Base Cost (25,000.00 x 1)	25,000	25,000	12,500	12,500



Rogers

Assessment Property Record Card for Tax Year 2026

Data provided by LISA DELOZIER County Assessor

Date 04/17/2026
Time 05:53:45
Page 6

Agland Inventory

660071060

Soi	Description	Land Use	LPI	Adj Type	Adj Code	Acres	Use/Acre	Mkt/Acre	Use Value	Market Value
BR	BREAKS-ALLUVIAL LAND COMP	IMP PST	30		0	18.000	84	84	1,512	1,512
PAA	PARSONS SILT LOAM 0-1% SL	IMP PST	76		0	61.020	213	213	12,985	12,985
IMP PST Totals						79.020			14,497	14,497
Total Agland						79.020			14,497	14,497