



Rogers

Assessment Property Record Card for Tax Year 2026

Data provided by LISA DELOZIER County Assessor

Date 04/16/2026
Time 22:57:17
Page 1

Assessment Data					Primary Image																																																																																																																				
Account 660072100 Parcel ID 000000-00-0-00785-001-0001 Cadastral ID 31-21-16-01600 Property Type REAL - Real Property Property Class RRP VI Area 1 Tax Area 21 - CLAREMORE RURAL/VERD FIR Name ID 324282 BEVARD, KEENAN BRYCE 10952 E WESTON LN CLAREMORE OK 74019-0000 Parcel Location Situs 10952 E WESTON LN Subdivision STONEWALL Lot/Block 0001 / 0001 Parcel Size 1 - Lots Sec/Twn/Rng 31 / 21 / 16 / 5 Neighborhood 1083 - R-V01-SW CLAREMORE School District S001 - CLAREMORE SCHOOLS					<p>\\tsclient\T\TOMMY DUNLAP\New folder (119)\IMG_0032.JPG 12/8/2022</p>																																																																																																																				
Legal Description Lot/Long: 36.25003042 -95.63450071 LOT 1 STONEWALL																																																																																																																									
Exemptions <table border="1"> <thead> <tr> <th>Code</th> <th>Type</th> <th>Active</th> <th>Maximum</th> <th>Exemption</th> </tr> </thead> <tbody> <tr> <td>H</td> <td>Homestead</td> <td>No</td> <td>1,000</td> <td></td> </tr> <tr> <td>H</td> <td>Homestead</td> <td>No</td> <td>1,000</td> <td></td> </tr> </tbody> </table>					Code	Type	Active	Maximum	Exemption	H	Homestead	No	1,000		H	Homestead	No	1,000		Building Permits <table border="1"> <thead> <tr> <th>Number</th> <th>Description</th> <th>Opened</th> <th>Closed</th> <th>Amount</th> </tr> </thead> <tbody> <tr> <td></td> <td></td> <td></td> <td></td> <td></td> </tr> </tbody> </table>					Number	Description	Opened	Closed	Amount																																																																																												
Code	Type	Active	Maximum	Exemption																																																																																																																					
H	Homestead	No	1,000																																																																																																																						
H	Homestead	No	1,000																																																																																																																						
Number	Description	Opened	Closed	Amount																																																																																																																					
Parcel Valuation <table border="1"> <thead> <tr> <th>Source</th> <th>REAL</th> <th>Fair Cash</th> <th>Capped</th> <th>Asmnt Level</th> <th>Assessed</th> <th>Levy Rate</th> <th>109.172</th> <th>Current Tax</th> </tr> </thead> <tbody> <tr> <td>Remove Cap</td> <td>2019</td> <td>Land Value 72,795</td> <td>51,270</td> <td>11%</td> <td>5,640</td> <td>Assessed</td> <td>23,730</td> <td>2,590.65</td> </tr> <tr> <td>Year Frozen</td> <td>0</td> <td>Improvements 164,452</td> <td>164,452</td> <td></td> <td>18,090</td> <td>Penalty</td> <td>0</td> <td></td> </tr> <tr> <td>Uncapped Value</td> <td>0</td> <td>Mobile Home 0</td> <td>0</td> <td></td> <td>0</td> <td>Exemption</td> <td>0</td> <td>0.00</td> </tr> <tr> <td>TIF Project ID</td> <td>0</td> <td>Total Value 237,247</td> <td>215,722</td> <td></td> <td>23,730</td> <td>Total Taxable</td> <td>23,730</td> <td>2,591.00</td> </tr> </tbody> </table>					Source	REAL	Fair Cash	Capped	Asmnt Level	Assessed	Levy Rate	109.172	Current Tax	Remove Cap	2019	Land Value 72,795	51,270	11%	5,640	Assessed	23,730	2,590.65	Year Frozen	0	Improvements 164,452	164,452		18,090	Penalty	0		Uncapped Value	0	Mobile Home 0	0		0	Exemption	0	0.00	TIF Project ID	0	Total Value 237,247	215,722		23,730	Total Taxable	23,730	2,591.00	Sale History <table border="1"> <thead> <tr> <th>Bk/Pg</th> <th>Grantor</th> <th>Date</th> <th>Price</th> <th>Code</th> </tr> </thead> <tbody> <tr> <td>2704/627</td> <td>SMITH, ROBBI &</td> <td>04/13/2018</td> <td>160,000</td> <td>YES</td> </tr> <tr> <td>2504/461</td> <td>NOAH, LINDA G</td> <td>10/05/2015</td> <td>145,000</td> <td>YES</td> </tr> <tr> <td>2504/463</td> <td>NOAH, SAMUEL M JR & LINDA G</td> <td>06/10/2004</td> <td>0</td> <td>4</td> </tr> <tr> <td>1342/223</td> <td>BURNS, ANDREW J & -CATHERINE M</td> <td>12/21/2001</td> <td>131,667</td> <td>YES</td> </tr> <tr> <td>1140/908</td> <td>DORSEY INC</td> <td>11/06/1998</td> <td>87,000</td> <td>Yes</td> </tr> <tr> <td>1123/211</td> <td>DORSEY, TERRY L</td> <td>07/24/1998</td> <td>0</td> <td>No</td> </tr> </tbody> </table>					Bk/Pg	Grantor	Date	Price	Code	2704/627	SMITH, ROBBI &	04/13/2018	160,000	YES	2504/461	NOAH, LINDA G	10/05/2015	145,000	YES	2504/463	NOAH, SAMUEL M JR & LINDA G	06/10/2004	0	4	1342/223	BURNS, ANDREW J & -CATHERINE M	12/21/2001	131,667	YES	1140/908	DORSEY INC	11/06/1998	87,000	Yes	1123/211	DORSEY, TERRY L	07/24/1998	0	No																																
Source	REAL	Fair Cash	Capped	Asmnt Level	Assessed	Levy Rate	109.172	Current Tax																																																																																																																	
Remove Cap	2019	Land Value 72,795	51,270	11%	5,640	Assessed	23,730	2,590.65																																																																																																																	
Year Frozen	0	Improvements 164,452	164,452		18,090	Penalty	0																																																																																																																		
Uncapped Value	0	Mobile Home 0	0		0	Exemption	0	0.00																																																																																																																	
TIF Project ID	0	Total Value 237,247	215,722		23,730	Total Taxable	23,730	2,591.00																																																																																																																	
Bk/Pg	Grantor	Date	Price	Code																																																																																																																					
2704/627	SMITH, ROBBI &	04/13/2018	160,000	YES																																																																																																																					
2504/461	NOAH, LINDA G	10/05/2015	145,000	YES																																																																																																																					
2504/463	NOAH, SAMUEL M JR & LINDA G	06/10/2004	0	4																																																																																																																					
1342/223	BURNS, ANDREW J & -CATHERINE M	12/21/2001	131,667	YES																																																																																																																					
1140/908	DORSEY INC	11/06/1998	87,000	Yes																																																																																																																					
1123/211	DORSEY, TERRY L	07/24/1998	0	No																																																																																																																					
Assessment History <table border="1"> <thead> <tr> <th>Tax Year</th> <th>Statement Number</th> <th>Billed Owner</th> <th>Tax Area</th> <th>Total Value</th> <th>Exemptions</th> <th>Taxable Value</th> <th>Billed Tax</th> </tr> </thead> <tbody> <tr><td>2025</td><td>2025-660072100</td><td>BEVARD, KEENAN BRYCE</td><td>21</td><td>233,509</td><td>0</td><td>22,600</td><td>2,467.00</td></tr> <tr><td>2024</td><td>2024-660072100</td><td>BEVARD, KEENAN BRYCE</td><td>21</td><td>197,341</td><td>0</td><td>21,523</td><td>2,211.00</td></tr> <tr><td>2023</td><td>2023-660072100</td><td>BEVARD, KEENAN BRYCE</td><td>21</td><td>186,350</td><td>0</td><td>20,499</td><td>2,089.00</td></tr> <tr><td>2022</td><td>2022-660072100</td><td>BEVARD, KEENAN BRYCE</td><td>21</td><td>190,401</td><td>0</td><td>19,792</td><td>2,036.00</td></tr> <tr><td>2021</td><td>2021-660072100</td><td>BEVARD, KEENAN BRYCE</td><td>21</td><td>171,361</td><td>0</td><td>18,850</td><td>1,858.00</td></tr> <tr><td>2020</td><td>2020-660072100</td><td>BEVARD, KEENAN BRYCE</td><td>21</td><td>170,247</td><td>0</td><td>18,714</td><td>1,907.00</td></tr> <tr><td>2019</td><td>2019-660072100</td><td>BEVARD, KEENAN BRYCE</td><td>21</td><td>162,025</td><td>0</td><td>17,823</td><td>1,835.00</td></tr> <tr><td>2018</td><td>2018-660072100</td><td>BEVARD, KEENAN BRYCE</td><td>21</td><td>151,864</td><td>1000</td><td>15,705</td><td>1,623.00</td></tr> <tr><td>2017</td><td>2017-660072100</td><td>SMITH, ROBBI &</td><td>21</td><td>150,655</td><td>1000</td><td>15,572</td><td>1,599.00</td></tr> <tr><td>2016</td><td>2016-660072100</td><td>SMITH, ROBBI &</td><td>21</td><td>146,755</td><td>1000</td><td>15,143</td><td>1,585.00</td></tr> <tr><td>2015</td><td>2015-660072100</td><td>NOAH, SAMUEL M JR & LINDA G</td><td>21</td><td>147,455</td><td>1000</td><td>14,569</td><td>1,472.00</td></tr> <tr><td>2014</td><td>2014-660072100</td><td>NOAH, SAMUEL M JR & LINDA G</td><td>21</td><td>150,894</td><td>1000</td><td>14,116</td><td>1,465.00</td></tr> <tr><td>2013</td><td>2013-660072100</td><td>NOAH, SAMUEL M JR & LINDA G</td><td>21</td><td>142,146</td><td>1000</td><td>13,676</td><td>1,402.00</td></tr> </tbody> </table>										Tax Year	Statement Number	Billed Owner	Tax Area	Total Value	Exemptions	Taxable Value	Billed Tax	2025	2025-660072100	BEVARD, KEENAN BRYCE	21	233,509	0	22,600	2,467.00	2024	2024-660072100	BEVARD, KEENAN BRYCE	21	197,341	0	21,523	2,211.00	2023	2023-660072100	BEVARD, KEENAN BRYCE	21	186,350	0	20,499	2,089.00	2022	2022-660072100	BEVARD, KEENAN BRYCE	21	190,401	0	19,792	2,036.00	2021	2021-660072100	BEVARD, KEENAN BRYCE	21	171,361	0	18,850	1,858.00	2020	2020-660072100	BEVARD, KEENAN BRYCE	21	170,247	0	18,714	1,907.00	2019	2019-660072100	BEVARD, KEENAN BRYCE	21	162,025	0	17,823	1,835.00	2018	2018-660072100	BEVARD, KEENAN BRYCE	21	151,864	1000	15,705	1,623.00	2017	2017-660072100	SMITH, ROBBI &	21	150,655	1000	15,572	1,599.00	2016	2016-660072100	SMITH, ROBBI &	21	146,755	1000	15,143	1,585.00	2015	2015-660072100	NOAH, SAMUEL M JR & LINDA G	21	147,455	1000	14,569	1,472.00	2014	2014-660072100	NOAH, SAMUEL M JR & LINDA G	21	150,894	1000	14,116	1,465.00	2013	2013-660072100	NOAH, SAMUEL M JR & LINDA G	21	142,146	1000	13,676	1,402.00
Tax Year	Statement Number	Billed Owner	Tax Area	Total Value	Exemptions	Taxable Value	Billed Tax																																																																																																																		
2025	2025-660072100	BEVARD, KEENAN BRYCE	21	233,509	0	22,600	2,467.00																																																																																																																		
2024	2024-660072100	BEVARD, KEENAN BRYCE	21	197,341	0	21,523	2,211.00																																																																																																																		
2023	2023-660072100	BEVARD, KEENAN BRYCE	21	186,350	0	20,499	2,089.00																																																																																																																		
2022	2022-660072100	BEVARD, KEENAN BRYCE	21	190,401	0	19,792	2,036.00																																																																																																																		
2021	2021-660072100	BEVARD, KEENAN BRYCE	21	171,361	0	18,850	1,858.00																																																																																																																		
2020	2020-660072100	BEVARD, KEENAN BRYCE	21	170,247	0	18,714	1,907.00																																																																																																																		
2019	2019-660072100	BEVARD, KEENAN BRYCE	21	162,025	0	17,823	1,835.00																																																																																																																		
2018	2018-660072100	BEVARD, KEENAN BRYCE	21	151,864	1000	15,705	1,623.00																																																																																																																		
2017	2017-660072100	SMITH, ROBBI &	21	150,655	1000	15,572	1,599.00																																																																																																																		
2016	2016-660072100	SMITH, ROBBI &	21	146,755	1000	15,143	1,585.00																																																																																																																		
2015	2015-660072100	NOAH, SAMUEL M JR & LINDA G	21	147,455	1000	14,569	1,472.00																																																																																																																		
2014	2014-660072100	NOAH, SAMUEL M JR & LINDA G	21	150,894	1000	14,116	1,465.00																																																																																																																		
2013	2013-660072100	NOAH, SAMUEL M JR & LINDA G	21	142,146	1000	13,676	1,402.00																																																																																																																		



Rogers

Assessment Property Record Card for Tax Year 2026

Data provided by LISA DELOZIER County Assessor

Date 04/16/2026
Time 22:57:18
Page 2

Lot Data	Square-Foot - NBHD 1083 #1	Primary Image
Lot Size Lot Count Units Buildable 1 Non-Ag Acres 1.1058 Topography Street Access Utilities Amenities LAND QUALITY 0 0 Method Square-Foot Base Lot Value 48,167.00 x 1.51 = 72,795 Factor Value Adjustments 1.0000 Lot Value 72,795		

Residential Data	
Type	1 Single Family Residence
Condition	3 - Average
Quality	3 - Average
Architecture	
Style	100% 1 1/2 Story Finished
Exterior Wall	10% Veneer, Masonry 90% Frame, Siding, Wood
Base/Total Area	1,076 / 1,488
Style	100% 1 1/2 Story Finished
HVAC	100% Warmed & Cooled Air
Roof Cover	1 Composition Shingle
Area on Slab	1,076
Fixture/RghIn	18 /
Bed/F/H Bath	3 / 2.5 /
Basement Area	
Garage Type	572 Attached Garage - Unfinished
Remodel	
Year/Eff Age	1998 / 21

\\tsclient\T\TOMMY DUNLAP\New folder (119)\IMG_0032.JPG 12/8/2022
--

GRM Approach	
GRM Code	
Gross Rent	0.00
Indicated Value	

Multiple Regression	
MRA Code	1 Test
Adusted R	0.8445
Indicated Value	206,589 138.84 Per SqFt

Direct Comparables	
Selection Model	A Adam Test
Adjustment Model	1 2022 Residential
Comparables	
Indicated Value	

Cost Approach				Manual : 01/2025			
Base Cost	94.35	Total Misc Impr	+ 14,587				
Roofing Adj	+ 3.74	Garage Cost	+ 17,686				
Subfloor Adj	+ -1.78	Total RCN	= 219,270				
Heat/Cool Adj	+ 12.64	Depreciation (25%)	- 54,818				
Plumbing Adj	+ 16.72	Lump Sums	+ 0				
Basement Adj	+ 0.00	RCNLD	= 164,452				
Adj Base Cost	= 125.67	Lot Value	+ 72,795				
Total Area	x 1,488	Indicated Value	= 237,247				
Adjusted Cost	= 186,997	Value Per SqFt	159.44				

Value Reconciliation			
Selected Approach	Cost Approach		
Improvements	164,452		
Lot Value	72,795		
Indicated Value	237,247	159.44	Per SqFt
Agland Value			
Site Improvements			
Total Value	237,247	159.44	Total Value Per SqFt

Miscellaneous Improvements								
Code	Description	Sketch ID	Size	Year	Units	Unit Cost	Depr	Value
FPR1	FIREPLACE - RESIDENTIAL 1 STORY	0		1	1	5,615.40		5,615
PRCH	SLAB PORCH - COVERED	85348	38x5		190	26.33		5,003
PRCH	SLAB PORCH - COVERED	85349	15x10		150	26.46		3,969



Rogers

Assessment Property Record Card for Tax Year 2026

Data provided by LISA DELOZIER County Assessor

Date 04/16/2026

Time 22:57:18

Page 3

Sketch Image

660072100

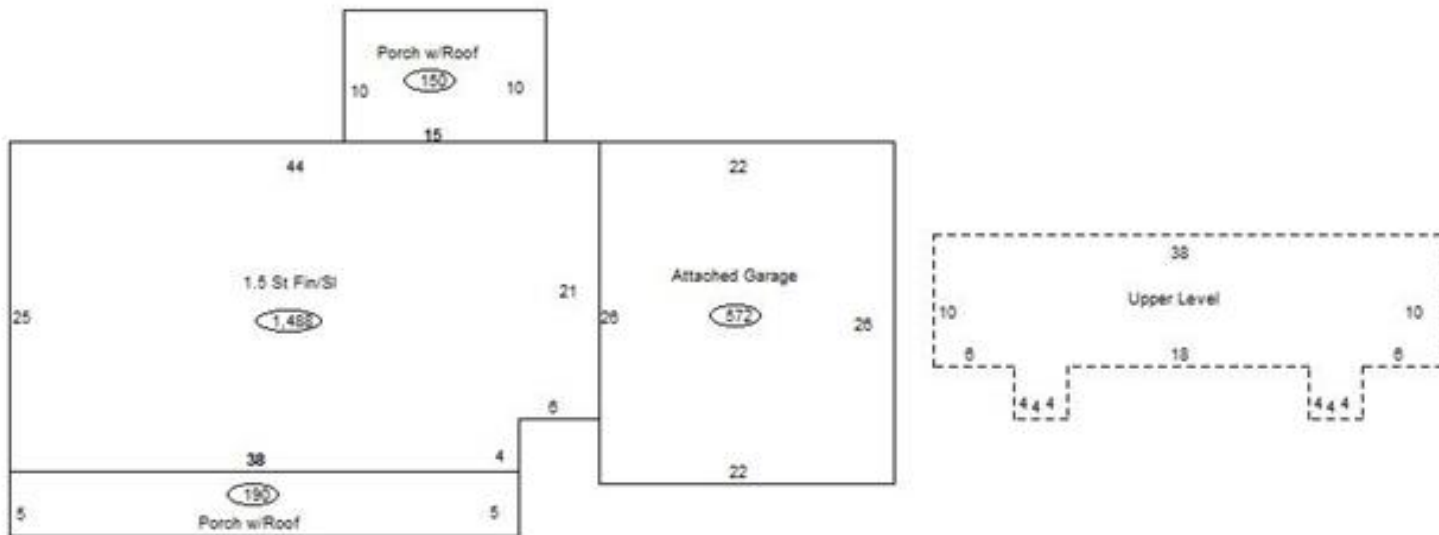

Sketch Vector Information

Sequence	Code	Type	Built Over	Scale	Section Label	Base Area	Multiplier	Total Area
1	R	5	Slab	13	1.5 St Fin/Sl	1,076	1.383	1,488
2	G	1		13	Attached Garage	572	1.000	572
3	M	PRCH		13	SLBC	190	1.000	190
4	M	PRCH		13	SLBC	150	1.000	150
5	U	^UL	Overhang	13	Upper Level	412	1.000	412
Total Building Area						1,076		1,488



Rogers

Assessment Property Record Card for Tax Year 2026

Data provided by LISA DELOZIER County Assessor

Date 04/16/2026
Time 22:57:18
Page 4

660072100

Outbuildings/Site Improvements

Building Image	Code	Description	Dimensions	Floor	Roofing	Total Units
	STF	STG FAIR	0x0x0			
	Qual	2	Cond	Year	Eff Age	
		Valuation Summary	Modifier Total	RCN	Depr (100% Phys/ % Func)	RCNLD
		Base Cost (4.68 x)				