



Rogers

Assessment Property Record Card for Tax Year 2026

Data provided by LISA DELOZIER County Assessor

Date 04/16/2026
Time 23:35:35
Page 1

Assessment Data					Primary Image																																																																																																																				
Account 660072193 Parcel ID 000000-00-0-00586-002-0026 Cadastral ID 31-22-17-04380 Property Type REAL - Real Property Property Class RRP VI Area 2 Tax Area 94 - SEQUOYAH/TRI-DISTRICT FI Name ID 256975 WEST, LANCE & AMY LIVING TRUST 16303 E PUEBLO RD CLAREMORE OK 74017-0000 Parcel Location Situs 16303 E PUEBLO RD Subdivision PEPPER RIDGE Lot/Block 0026 / 0002 Parcel Size 1 - Lots Sec/Twn/Rng 31 / 22 / 17 / 5 Neighborhood 1131 - R-V01,2-NE OOLOGAH School District S006 - SEQUOYAH SCHOOLS																																																																																																																									
Legal Description Lot/Long: 36.33968954 -95.53772896																																																																																																																									
Legal Description LOT 26 BLOCK 2 PEPPER RIDGE					Building Permits <table border="1"> <thead> <tr> <th>Number</th> <th>Description</th> <th>Opened</th> <th>Closed</th> <th>Amount</th> </tr> </thead> <tbody> <tr> <td></td> <td></td> <td></td> <td></td> <td></td> </tr> </tbody> </table>					Number	Description	Opened	Closed	Amount																																																																																																											
Number	Description	Opened	Closed	Amount																																																																																																																					
Exemptions <table border="1"> <thead> <tr> <th>Code</th> <th>Type</th> <th>Active</th> <th>Maximum</th> <th>Exemption</th> </tr> </thead> <tbody> <tr> <td>H</td> <td>Homestead</td> <td>Yes</td> <td>1,000</td> <td>1,000</td> </tr> </tbody> </table>					Code	Type	Active	Maximum	Exemption	H	Homestead	Yes	1,000	1,000	Sale History <table border="1"> <thead> <tr> <th>Bk/Pg</th> <th>Grantor</th> <th>Date</th> <th>Price</th> <th>Code</th> </tr> </thead> <tbody> <tr> <td>2699/663</td> <td>WEST, LANCE &</td> <td>03/14/2018</td> <td></td> <td>4</td> </tr> <tr> <td>1390/941</td> <td>SCHLOMANN, BRETT & LINDSEY</td> <td>06/27/2002</td> <td>180,500</td> <td>YES</td> </tr> <tr> <td>1375/693</td> <td>ROBERTS, JIMMY D TRUST</td> <td>03/05/2002</td> <td>30,000</td> <td>YES</td> </tr> <tr> <td>1265/879</td> <td>RED FOX LAND COMPANY LLC</td> <td>01/18/2001</td> <td>0</td> <td>No</td> </tr> </tbody> </table>					Bk/Pg	Grantor	Date	Price	Code	2699/663	WEST, LANCE &	03/14/2018		4	1390/941	SCHLOMANN, BRETT & LINDSEY	06/27/2002	180,500	YES	1375/693	ROBERTS, JIMMY D TRUST	03/05/2002	30,000	YES	1265/879	RED FOX LAND COMPANY LLC	01/18/2001	0	No																																																																													
Code	Type	Active	Maximum	Exemption																																																																																																																					
H	Homestead	Yes	1,000	1,000																																																																																																																					
Bk/Pg	Grantor	Date	Price	Code																																																																																																																					
2699/663	WEST, LANCE &	03/14/2018		4																																																																																																																					
1390/941	SCHLOMANN, BRETT & LINDSEY	06/27/2002	180,500	YES																																																																																																																					
1375/693	ROBERTS, JIMMY D TRUST	03/05/2002	30,000	YES																																																																																																																					
1265/879	RED FOX LAND COMPANY LLC	01/18/2001	0	No																																																																																																																					
Parcel Valuation <table border="1"> <thead> <tr> <th>Source</th> <th>REAL</th> <th>Fair Cash</th> <th>Capped</th> <th>Asmnt Level</th> <th>Assessed</th> <th>Levy Rate</th> <th>98.320</th> <th>Current Tax</th> </tr> </thead> <tbody> <tr> <td>Remove Cap</td> <td>2003</td> <td>Land Value 82,289</td> <td>48,508</td> <td>11%</td> <td>5,336</td> <td>Assessed</td> <td>39,421</td> <td>3,875.87</td> </tr> <tr> <td>Year Frozen</td> <td>0</td> <td>Improvements 351,083</td> <td>309,861</td> <td></td> <td>34,085</td> <td>Penalty</td> <td>0</td> <td></td> </tr> <tr> <td>Uncapped Value</td> <td>0</td> <td>Mobile Home 0</td> <td>0</td> <td></td> <td>0</td> <td>Exemption</td> <td>1,000</td> <td>-88.00</td> </tr> <tr> <td>TIF Project ID</td> <td>0</td> <td>Total Value 433,372</td> <td>358,369</td> <td></td> <td>39,421</td> <td>Total Taxable</td> <td>38,421</td> <td>3,788.00</td> </tr> </tbody> </table>										Source	REAL	Fair Cash	Capped	Asmnt Level	Assessed	Levy Rate	98.320	Current Tax	Remove Cap	2003	Land Value 82,289	48,508	11%	5,336	Assessed	39,421	3,875.87	Year Frozen	0	Improvements 351,083	309,861		34,085	Penalty	0		Uncapped Value	0	Mobile Home 0	0		0	Exemption	1,000	-88.00	TIF Project ID	0	Total Value 433,372	358,369		39,421	Total Taxable	38,421	3,788.00																																																																			
Source	REAL	Fair Cash	Capped	Asmnt Level	Assessed	Levy Rate	98.320	Current Tax																																																																																																																	
Remove Cap	2003	Land Value 82,289	48,508	11%	5,336	Assessed	39,421	3,875.87																																																																																																																	
Year Frozen	0	Improvements 351,083	309,861		34,085	Penalty	0																																																																																																																		
Uncapped Value	0	Mobile Home 0	0		0	Exemption	1,000	-88.00																																																																																																																	
TIF Project ID	0	Total Value 433,372	358,369		39,421	Total Taxable	38,421	3,788.00																																																																																																																	
Assessment History <table border="1"> <thead> <tr> <th>Tax Year</th> <th>Statement Number</th> <th>Billed Owner</th> <th>Tax Area</th> <th>Total Value</th> <th>Exemptions</th> <th>Taxable Value</th> <th>Billed Tax</th> </tr> </thead> <tbody> <tr><td>2025</td><td>2025-660072193</td><td>WEST, LANCE & AMY</td><td>94</td><td>420,425</td><td>1000</td><td>37,272</td><td>3,675.00</td></tr> <tr><td>2024</td><td>2024-660072193</td><td>WEST, LANCE & AMY</td><td>94</td><td>408,719</td><td>1000</td><td>36,158</td><td>3,802.00</td></tr> <tr><td>2023</td><td>2023-660072193</td><td>WEST, LANCE & AMY</td><td>94</td><td>351,444</td><td>1000</td><td>35,076</td><td>3,761.00</td></tr> <tr><td>2022</td><td>2022-660072193</td><td>WEST, LANCE & AMY</td><td>94</td><td>355,168</td><td>1000</td><td>34,025</td><td>3,683.00</td></tr> <tr><td>2021</td><td>2021-660072193</td><td>WEST, LANCE & AMY</td><td>94</td><td>317,291</td><td>1000</td><td>33,005</td><td>3,455.00</td></tr> <tr><td>2020</td><td>2020-660072193</td><td>WEST, LANCE &</td><td>94</td><td>307,057</td><td>1000</td><td>32,015</td><td>3,344.00</td></tr> <tr><td>2019</td><td>2019-660072193</td><td>WEST, LANCE &</td><td>94</td><td>291,391</td><td>1000</td><td>31,053</td><td>3,198.00</td></tr> <tr><td>2018</td><td>2018-660072193</td><td>WEST, LANCE &</td><td>94</td><td>299,643</td><td>1000</td><td>30,555</td><td>3,179.00</td></tr> <tr><td>2017</td><td>2017-660072193</td><td>WEST, LANCE &</td><td>94</td><td>297,088</td><td>1000</td><td>29,635</td><td>3,044.00</td></tr> <tr><td>2016</td><td>2016-660072193</td><td>WEST, LANCE &</td><td>94</td><td>289,363</td><td>1000</td><td>28,743</td><td>2,941.00</td></tr> <tr><td>2015</td><td>2015-660072193</td><td>WEST, LANCE &</td><td>94</td><td>280,429</td><td>1000</td><td>27,877</td><td>2,912.00</td></tr> <tr><td>2014</td><td>2014-660072193</td><td>WEST, LANCE &</td><td>94</td><td>285,880</td><td>1000</td><td>27,036</td><td>2,774.00</td></tr> <tr><td>2013</td><td>2013-660072193</td><td>WEST, LANCE &</td><td>94</td><td>268,547</td><td>1000</td><td>26,219</td><td>2,651.00</td></tr> </tbody> </table>										Tax Year	Statement Number	Billed Owner	Tax Area	Total Value	Exemptions	Taxable Value	Billed Tax	2025	2025-660072193	WEST, LANCE & AMY	94	420,425	1000	37,272	3,675.00	2024	2024-660072193	WEST, LANCE & AMY	94	408,719	1000	36,158	3,802.00	2023	2023-660072193	WEST, LANCE & AMY	94	351,444	1000	35,076	3,761.00	2022	2022-660072193	WEST, LANCE & AMY	94	355,168	1000	34,025	3,683.00	2021	2021-660072193	WEST, LANCE & AMY	94	317,291	1000	33,005	3,455.00	2020	2020-660072193	WEST, LANCE &	94	307,057	1000	32,015	3,344.00	2019	2019-660072193	WEST, LANCE &	94	291,391	1000	31,053	3,198.00	2018	2018-660072193	WEST, LANCE &	94	299,643	1000	30,555	3,179.00	2017	2017-660072193	WEST, LANCE &	94	297,088	1000	29,635	3,044.00	2016	2016-660072193	WEST, LANCE &	94	289,363	1000	28,743	2,941.00	2015	2015-660072193	WEST, LANCE &	94	280,429	1000	27,877	2,912.00	2014	2014-660072193	WEST, LANCE &	94	285,880	1000	27,036	2,774.00	2013	2013-660072193	WEST, LANCE &	94	268,547	1000	26,219	2,651.00
Tax Year	Statement Number	Billed Owner	Tax Area	Total Value	Exemptions	Taxable Value	Billed Tax																																																																																																																		
2025	2025-660072193	WEST, LANCE & AMY	94	420,425	1000	37,272	3,675.00																																																																																																																		
2024	2024-660072193	WEST, LANCE & AMY	94	408,719	1000	36,158	3,802.00																																																																																																																		
2023	2023-660072193	WEST, LANCE & AMY	94	351,444	1000	35,076	3,761.00																																																																																																																		
2022	2022-660072193	WEST, LANCE & AMY	94	355,168	1000	34,025	3,683.00																																																																																																																		
2021	2021-660072193	WEST, LANCE & AMY	94	317,291	1000	33,005	3,455.00																																																																																																																		
2020	2020-660072193	WEST, LANCE &	94	307,057	1000	32,015	3,344.00																																																																																																																		
2019	2019-660072193	WEST, LANCE &	94	291,391	1000	31,053	3,198.00																																																																																																																		
2018	2018-660072193	WEST, LANCE &	94	299,643	1000	30,555	3,179.00																																																																																																																		
2017	2017-660072193	WEST, LANCE &	94	297,088	1000	29,635	3,044.00																																																																																																																		
2016	2016-660072193	WEST, LANCE &	94	289,363	1000	28,743	2,941.00																																																																																																																		
2015	2015-660072193	WEST, LANCE &	94	280,429	1000	27,877	2,912.00																																																																																																																		
2014	2014-660072193	WEST, LANCE &	94	285,880	1000	27,036	2,774.00																																																																																																																		
2013	2013-660072193	WEST, LANCE &	94	268,547	1000	26,219	2,651.00																																																																																																																		



Rogers

Assessment Property Record Card for Tax Year 2026

Data provided by LISA DELOZIER County Assessor

Date 04/16/2026
Time 23:35:35
Page 2

Lot Data		Square-Foot - NBHD 1131 #1	
Lot Size			
Lot Count			
Units Buildable	1		
Non-Ag Acres	3.5164		
Topography			
Street Access			
Utilities			
Amenities	LAND QUALITY	0	0
Method	Square-Foot		
Base Lot Value	153,174.00 x .54 = 82,289		
Factor Value			
Adjustments	1.0000		
Lot Value	82,289		



\\tsclient\TCASEY\CASEY BOOTH VISUAL INSPECTION\2020-1; 12/7/2020

Residential Data	
Type	1 Single Family Residence
Condition	3 - Average
Quality	4 - Good
Architecture	TRAD TRADITIONAL
Style	100% 1 1/2 Story Finished
Exterior Wall	10% Frame, Siding, Wood 90% Veneer, Masonry
Base/Total Area	1,959 / 2,939
Style	100% 1 1/2 Story Finished
HVAC	100% Warmed & Cooled Air
Roof Cover	1 Composition Shingle
Area on Slab	1,959
Fixture/RghIn	17 /
Bed/F/H Bath	3 / 4.0 /
Basement Area	
Garage Type	576 Attached Garage - Finished
Remodel	
Year/Eff Age	2002 / 18

GRM Approach

GRM Code	
Gross Rent	0.00
Indicated Value	

Multiple Regression

MRA Code	1 Test
Adusted R	0.8445
Indicated Value	396,302 134.84 Per SqFt

Direct Comparables

Selection Model	A Adam Test
Adjustment Model	1 2022 Residential
Comparables	2
Indicated Value	375,670 Per SqFt

Value Reconciliation

Selected Approach	Cost Approach
Improvements	345,717
Lot Value	82,289
Indicated Value	428,006 145.63 Per SqFt
Agland Value	
Site Improvements	5,366
Total Value	433,372 147.46 Total Value Per SqFt

Cost Approach		Manual : 01/2025	
Base Cost	101.59	Total Misc Impr	+ 18,460
Roofing Adj	+ 4.06	Garage Cost	+ 33,967
Subfloor Adj	+ -3.09	Total RCN	= 432,146
Heat/Cool Adj	+ 16.31	Depreciation (20%)	- 86,429
Plumbing Adj	+ 10.33	Lump Sums	+ 0
Basement Adj	+ 0.00	RCNLD	= 345,717
Adj Base Cost	= 129.20	Lot Value	+ 82,289
Total Area	x 2,939	Indicated Value	= 428,006
Adjusted Cost	= 379,719	Value Per SqFt	145.63

Miscellaneous Improvements

Code	Description	Sketch ID	Size	Year	Units	Unit Cost	Depr	Value
PRCH	SLAB PORCH - COVERED	85694	35x7		245	32.11		7,867
EPKS	ENCLOSED PORCH - KNEEWALL SCREEN	85695	20x15		300	35.31		10,593



Rogers

Assessment Property Record Card for Tax Year 2026

Data provided by LISA DELOZIER County Assessor

Date 04/16/2026
 Time 23:35:35
 Page 3

Sketch Image

660072193

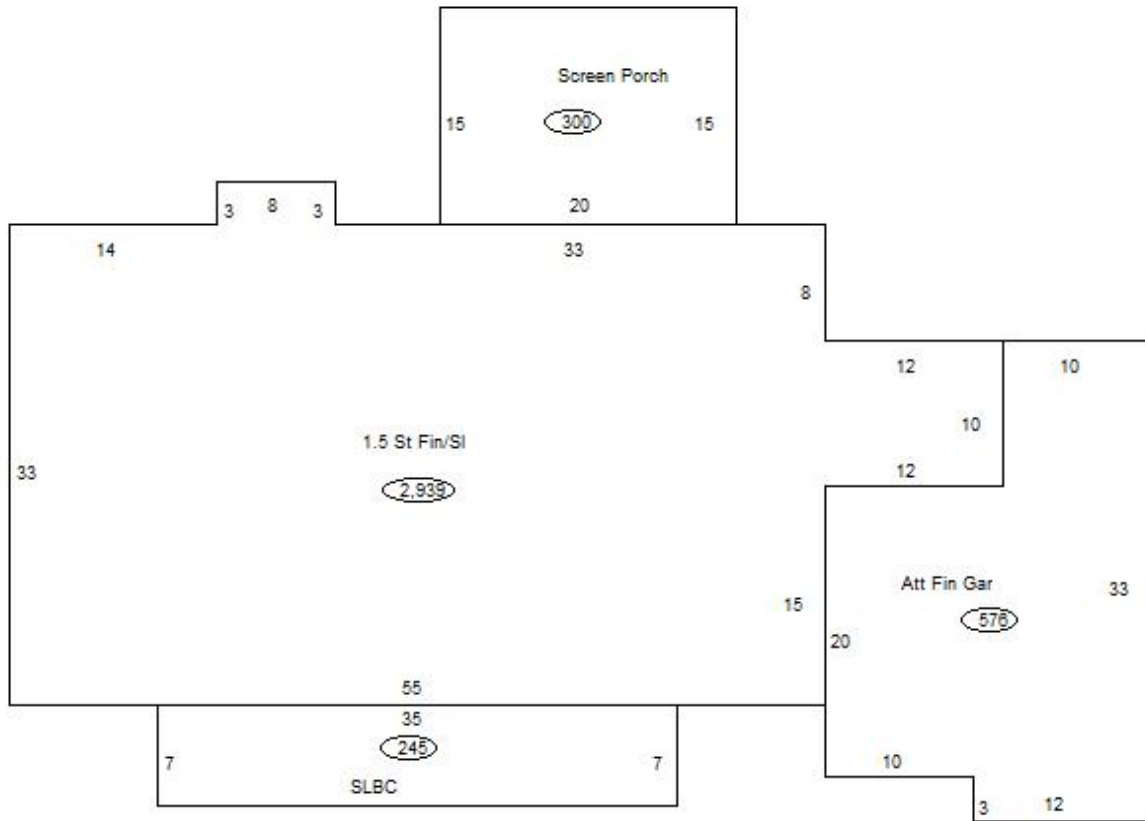

Sketch Vector Information

Sequence	Code	Type	Built Over	Scale	Section Label	Base Area	Multiplier	Total Area
1	R	5	Slab	13	1.5 St Fin/SI	1,959	1.500	2,939
2	G	5	Slab	13	Att Fin Gar	576	1.000	576
3	M	PRCH		13	SLBC	245	1.000	245
4	M	EPKS		13	Screen Porch	300	1.000	300
Total Building Area						1,959		2,939



Rogers

Assessment Property Record Card for Tax Year 2026

Data provided by LISA DELOZIER County Assessor

Date 04/16/2026
Time 23:35:36
Page 4

660072193

Outbuildings/Site Improvements

Building Image	Code	Description	Dimensions	Floor	Roofing	Total Units
	SHDS	Shed - Small	10x16x8	Plank	Formed Metal	160
	Qual 3	Cond 3	Year 2023	Eff Age 2		

Valuation Summary	Modifier Total	RCN	Depr (100% Phys/ % Func)	RCNLD
Base Cost (25.44 x 160)	4,070		4,070	4,070

	SHDS	Shed - Small	12x16x8	Plank	Composition Shingle	192
	Qual 4	Cond 3	Year 2022	Eff Age 3		

Valuation Summary	Modifier Total	RCN	Depr (14% Phys/ % Func)	RCNLD
Base Cost (25.66 x 192)	4,927		4,927	690

	LNT0	Lean To - Attached	12x8x8	Concrete	Formed Metal	96
	Qual 3	Cond 3	Year 2022	Eff Age 3		

Valuation Summary	Modifier Total	RCN	Depr (19% Phys/ % Func)	RCNLD
Base Cost (14.52 x 96)	1,394		1,394	265

--	--	--	--	--	--	--