



# Rogers

## Assessment Property Record Card for Tax Year 2026

Data provided by LISA DELOZIER County Assessor

Date 04/16/2026  
Time 23:56:40  
Page 1

Assessment Data					Primary Image																																																																																																																				
<b>Account</b> 660072205 <b>Parcel ID</b> 000000-00-0-00194-001-0008 <b>Cadastral ID</b> 27-21-14-04080 <b>Property Type</b> REAL - Real Property <b>Property Class</b> RRP VI Area 4 <b>Tax Area</b> 3 - OWASSO RURAL/NO FIRE <b>Name ID</b> 270450 ARNETT, DANIEL W & SANDRA L  16089 E 77TH ST N OWASSO OK 74055-0000  <b>Parcel Location</b> <b>Situs</b> 16089 E 77TH ST N <b>Subdivision</b> CORNERSTONE ADDITION 6 <b>Lot/Block</b> 0008 / 0001 <b>Parcel Size</b> 1 - Lots <b>Sec/Twn/Rng</b> 27 / 21 / 14 / 5 <b>Neighborhood</b> 1212 - R-V04-SW OWASSO <b>School District</b> S021 - OWASSO SCHOOLS																																																																																																																									
<b>Legal Description</b> Lot/Long: 36.26545783 -95.79459867																																																																																																																									
<b>Legal Description</b> LOT 8 BLOCK 1 CORNERSTONE 6					<b>Building Permits</b> <table border="1"> <thead> <tr> <th>Number</th> <th>Description</th> <th>Opened</th> <th>Closed</th> <th>Amount</th> </tr> </thead> <tbody> <tr> <td></td> <td></td> <td></td> <td></td> <td></td> </tr> </tbody> </table>					Number	Description	Opened	Closed	Amount																																																																																																											
Number	Description	Opened	Closed	Amount																																																																																																																					
<b>Exemptions</b> <table border="1"> <thead> <tr> <th>Code</th> <th>Type</th> <th>Active</th> <th>Maximum</th> <th>Exemption</th> </tr> </thead> <tbody> <tr> <td>H</td> <td>Homestead</td> <td>Yes</td> <td>1,000</td> <td>1,000</td> </tr> </tbody> </table>					Code	Type	Active	Maximum	Exemption	H	Homestead	Yes	1,000	1,000	<b>Sale History</b> <table border="1"> <thead> <tr> <th>Bk/Pg</th> <th>Grantor</th> <th>Date</th> <th>Price</th> <th>Code</th> </tr> </thead> <tbody> <tr> <td>1155/261</td> <td>WYLIE, GREG</td> <td>01/15/1999</td> <td>138,500</td> <td>Yes</td> </tr> <tr> <td>1123/238</td> <td>CORNERSTONE CENTER, INC.</td> <td>07/21/1998</td> <td>27,500</td> <td>Yes</td> </tr> </tbody> </table>					Bk/Pg	Grantor	Date	Price	Code	1155/261	WYLIE, GREG	01/15/1999	138,500	Yes	1123/238	CORNERSTONE CENTER, INC.	07/21/1998	27,500	Yes																																																																																							
Code	Type	Active	Maximum	Exemption																																																																																																																					
H	Homestead	Yes	1,000	1,000																																																																																																																					
Bk/Pg	Grantor	Date	Price	Code																																																																																																																					
1155/261	WYLIE, GREG	01/15/1999	138,500	Yes																																																																																																																					
1123/238	CORNERSTONE CENTER, INC.	07/21/1998	27,500	Yes																																																																																																																					
<b>Parcel Valuation</b> <table border="1"> <thead> <tr> <th>Source</th> <th>REAL</th> <th>Fair Cash</th> <th>Capped</th> <th>Asmnt Level</th> <th>Assessed</th> <th>Levy Rate</th> <th>97.960</th> <th>Current Tax</th> </tr> </thead> <tbody> <tr> <td>Remove Cap</td> <td>2000</td> <td>Land Value 116,726</td> <td>46,278</td> <td>11%</td> <td>5,091</td> <td>Assessed</td> <td>29,317</td> <td>2,871.89</td> </tr> <tr> <td>Year Frozen</td> <td>0</td> <td>Improvements 275,929</td> <td>220,244</td> <td></td> <td>24,226</td> <td>Penalty</td> <td>0</td> <td></td> </tr> <tr> <td>Uncapped Value</td> <td>0</td> <td>Mobile Home 0</td> <td>0</td> <td></td> <td>0</td> <td>Exemption</td> <td>1,000</td> <td>-98.00</td> </tr> <tr> <td>TIF Project ID</td> <td>0</td> <td>Total Value 392,655</td> <td>266,522</td> <td></td> <td>29,317</td> <td>Total Taxable</td> <td>28,317</td> <td>2,774.00</td> </tr> </tbody> </table>										Source	REAL	Fair Cash	Capped	Asmnt Level	Assessed	Levy Rate	97.960	Current Tax	Remove Cap	2000	Land Value 116,726	46,278	11%	5,091	Assessed	29,317	2,871.89	Year Frozen	0	Improvements 275,929	220,244		24,226	Penalty	0		Uncapped Value	0	Mobile Home 0	0		0	Exemption	1,000	-98.00	TIF Project ID	0	Total Value 392,655	266,522		29,317	Total Taxable	28,317	2,774.00																																																																			
Source	REAL	Fair Cash	Capped	Asmnt Level	Assessed	Levy Rate	97.960	Current Tax																																																																																																																	
Remove Cap	2000	Land Value 116,726	46,278	11%	5,091	Assessed	29,317	2,871.89																																																																																																																	
Year Frozen	0	Improvements 275,929	220,244		24,226	Penalty	0																																																																																																																		
Uncapped Value	0	Mobile Home 0	0		0	Exemption	1,000	-98.00																																																																																																																	
TIF Project ID	0	Total Value 392,655	266,522		29,317	Total Taxable	28,317	2,774.00																																																																																																																	
<b>Assessment History</b> <table border="1"> <thead> <tr> <th>Tax Year</th> <th>Statement Number</th> <th>Billed Owner</th> <th>Tax Area</th> <th>Total Value</th> <th>Exemptions</th> <th>Taxable Value</th> <th>Billed Tax</th> </tr> </thead> <tbody> <tr><td>2025</td><td>2025-660072205</td><td>ARNETT, DANIEL W &amp; SANDRA L</td><td>3</td><td>369,640</td><td>1000</td><td>27,463</td><td>2,690.00</td></tr> <tr><td>2024</td><td>2024-660072205</td><td>ARNETT, DANIEL W &amp; SANDRA L</td><td>3</td><td>404,167</td><td>1000</td><td>26,634</td><td>2,559.00</td></tr> <tr><td>2023</td><td>2023-660072205</td><td>ARNETT, DANIEL W &amp; SANDRA L</td><td>3</td><td>281,393</td><td>1000</td><td>25,830</td><td>2,421.00</td></tr> <tr><td>2022</td><td>2022-660072205</td><td>ARNETT, DANIEL W &amp; SANDRA L</td><td>3</td><td>261,883</td><td>1000</td><td>25,048</td><td>2,454.00</td></tr> <tr><td>2021</td><td>2021-660072205</td><td>ARNETT, DANIEL W &amp; SANDRA L</td><td>3</td><td>229,906</td><td>1000</td><td>24,290</td><td>2,350.00</td></tr> <tr><td>2020</td><td>2020-660072205</td><td>ARNETT, DANIEL W &amp; SANDRA L</td><td>3</td><td>226,554</td><td>1000</td><td>23,728</td><td>2,292.00</td></tr> <tr><td>2019</td><td>2019-660072205</td><td>ARNETT, DANIEL W &amp; SANDRA L</td><td>3</td><td>218,250</td><td>1000</td><td>23,008</td><td>2,224.00</td></tr> <tr><td>2018</td><td>2018-660072205</td><td>ARNETT, DANIEL W &amp; SANDRA L</td><td>3</td><td>224,701</td><td>1000</td><td>23,717</td><td>2,208.00</td></tr> <tr><td>2017</td><td>2017-660072205</td><td>ARNETT, DANIEL W &amp; SANDRA L</td><td>3</td><td>223,036</td><td>1000</td><td>23,534</td><td>2,214.00</td></tr> <tr><td>2016</td><td>2016-660072205</td><td>ARNETT, DANIEL W &amp; SANDRA L</td><td>3</td><td>217,887</td><td>1000</td><td>22,963</td><td>2,162.00</td></tr> <tr><td>2015</td><td>2015-660072205</td><td>ARNETT, DANIEL W &amp; SANDRA L</td><td>3</td><td>211,497</td><td>1000</td><td>22,265</td><td>2,111.00</td></tr> <tr><td>2014</td><td>2014-660072205</td><td>ARNETT, DANIEL W &amp; SANDRA L</td><td>3</td><td>224,242</td><td>1000</td><td>23,155</td><td>2,216.00</td></tr> <tr><td>2013</td><td>2013-660072205</td><td>ARNETT, DANIEL W &amp; SANDRA L</td><td>3</td><td>213,197</td><td>1000</td><td>22,452</td><td>2,103.00</td></tr> </tbody> </table>										Tax Year	Statement Number	Billed Owner	Tax Area	Total Value	Exemptions	Taxable Value	Billed Tax	2025	2025-660072205	ARNETT, DANIEL W & SANDRA L	3	369,640	1000	27,463	2,690.00	2024	2024-660072205	ARNETT, DANIEL W & SANDRA L	3	404,167	1000	26,634	2,559.00	2023	2023-660072205	ARNETT, DANIEL W & SANDRA L	3	281,393	1000	25,830	2,421.00	2022	2022-660072205	ARNETT, DANIEL W & SANDRA L	3	261,883	1000	25,048	2,454.00	2021	2021-660072205	ARNETT, DANIEL W & SANDRA L	3	229,906	1000	24,290	2,350.00	2020	2020-660072205	ARNETT, DANIEL W & SANDRA L	3	226,554	1000	23,728	2,292.00	2019	2019-660072205	ARNETT, DANIEL W & SANDRA L	3	218,250	1000	23,008	2,224.00	2018	2018-660072205	ARNETT, DANIEL W & SANDRA L	3	224,701	1000	23,717	2,208.00	2017	2017-660072205	ARNETT, DANIEL W & SANDRA L	3	223,036	1000	23,534	2,214.00	2016	2016-660072205	ARNETT, DANIEL W & SANDRA L	3	217,887	1000	22,963	2,162.00	2015	2015-660072205	ARNETT, DANIEL W & SANDRA L	3	211,497	1000	22,265	2,111.00	2014	2014-660072205	ARNETT, DANIEL W & SANDRA L	3	224,242	1000	23,155	2,216.00	2013	2013-660072205	ARNETT, DANIEL W & SANDRA L	3	213,197	1000	22,452	2,103.00
Tax Year	Statement Number	Billed Owner	Tax Area	Total Value	Exemptions	Taxable Value	Billed Tax																																																																																																																		
2025	2025-660072205	ARNETT, DANIEL W & SANDRA L	3	369,640	1000	27,463	2,690.00																																																																																																																		
2024	2024-660072205	ARNETT, DANIEL W & SANDRA L	3	404,167	1000	26,634	2,559.00																																																																																																																		
2023	2023-660072205	ARNETT, DANIEL W & SANDRA L	3	281,393	1000	25,830	2,421.00																																																																																																																		
2022	2022-660072205	ARNETT, DANIEL W & SANDRA L	3	261,883	1000	25,048	2,454.00																																																																																																																		
2021	2021-660072205	ARNETT, DANIEL W & SANDRA L	3	229,906	1000	24,290	2,350.00																																																																																																																		
2020	2020-660072205	ARNETT, DANIEL W & SANDRA L	3	226,554	1000	23,728	2,292.00																																																																																																																		
2019	2019-660072205	ARNETT, DANIEL W & SANDRA L	3	218,250	1000	23,008	2,224.00																																																																																																																		
2018	2018-660072205	ARNETT, DANIEL W & SANDRA L	3	224,701	1000	23,717	2,208.00																																																																																																																		
2017	2017-660072205	ARNETT, DANIEL W & SANDRA L	3	223,036	1000	23,534	2,214.00																																																																																																																		
2016	2016-660072205	ARNETT, DANIEL W & SANDRA L	3	217,887	1000	22,963	2,162.00																																																																																																																		
2015	2015-660072205	ARNETT, DANIEL W & SANDRA L	3	211,497	1000	22,265	2,111.00																																																																																																																		
2014	2014-660072205	ARNETT, DANIEL W & SANDRA L	3	224,242	1000	23,155	2,216.00																																																																																																																		
2013	2013-660072205	ARNETT, DANIEL W & SANDRA L	3	213,197	1000	22,452	2,103.00																																																																																																																		



# Rogers

## Assessment Property Record Card for Tax Year 2026

Data provided by LISA DELOZIER County Assessor

Date 04/16/2026  
Time 23:56:40  
Page 2

Lot Data	Square-Foot - NBHD 1212 #1	Primary Image
Lot Size		
Lot Count	1	
Units Buildable	1	
Non-Ag Acres	0.9925	
Topography		
Street Access		
Utilities		
Amenities	LAND QUALITY	
	0	
	0	
Method	Square-Foot	
Base Lot Value	43,232.00 x 2.70 = 116,726	
Factor Value		
Adjustments	1.0000	
Lot Value	116,726	

Residential Data	
Type	1 Single Family Residence
Condition	3 - Average
Quality	3 - Average
Architecture	
Style	100% One Story
Exterior Wall	100% Veneer, Masonry
Base/Total Area	2,028 / 2,028
Style	100% One Story
HVAC	100% Warmed & Cooled Air
Roof Cover	1 Composition Shingle
Area on Slab	2,028
Fixture/RghIn	11 /
Bed/F/H Bath	3 / 2.0 /
Basement Area	
Garage Type	420 Attached Garage - Unfinished
Remodel	
Year/Eff Age	1999 / 20

Cost Approach		Manual : 01/2025	
Base Cost	107.15	Total Misc Impr	+ 17,942
Roofing Adj	+ 4.68	Garage Cost	+ 14,049
Subfloor Adj	+ -2.19	Total RCN	= 295,489
Heat/Cool Adj	+ 12.64	Depreciation ( 23%)	- 67,962
Plumbing Adj	+ 7.65	Lump Sums	+ 0
Basement Adj	+ 0.00	RCNLD	= 227,527
Adj Base Cost	= 129.93	Lot Value	+ 116,726
Total Area	x 2,028	Indicated Value	= 344,253
Adjusted Cost	= 263,498	Value Per SqFt	169.75

GRM Approach	
GRM Code	
Gross Rent	0.00
Indicated Value	

Multiple Regression	
MRA Code	1 Test
Adusted R	0.8445
Indicated Value	282,387 139.24 Per SqFt

Direct Comparables	
Selection Model	A Adam Test
Adjustment Model	1 2022 Residential
Comparables	2
Indicated Value	339,350 Per SqFt

Value Reconciliation	
Selected Approach	Cost Approach
Improvements	227,527
Lot Value	116,726
Indicated Value	344,253 169.75 Per SqFt
Agland Value	
Site Improvements	48,402
Total Value	392,655 193.62 Total Value Per SqFt

Miscellaneous Improvements								
Code	Description	Sketch ID	Size	Year	Units	Unit Cost	Depr	Value
FPR1	FIREPLACE - RESIDENTIAL 1 STORY	0		1	1	5,615.40		5,615
PRCH	SLAB PORCH - COVERED	85756		77	77	26.69		2,055
PRCH	SLAB PORCH - COVERED	85757	20x20		400	25.68		10,272



# Rogers

## Assessment Property Record Card for Tax Year 2026

Data provided by LISA DELOZIER County Assessor

Date 04/16/2026  
 Time 23:56:40  
 Page 3

### Sketch Image

660072205

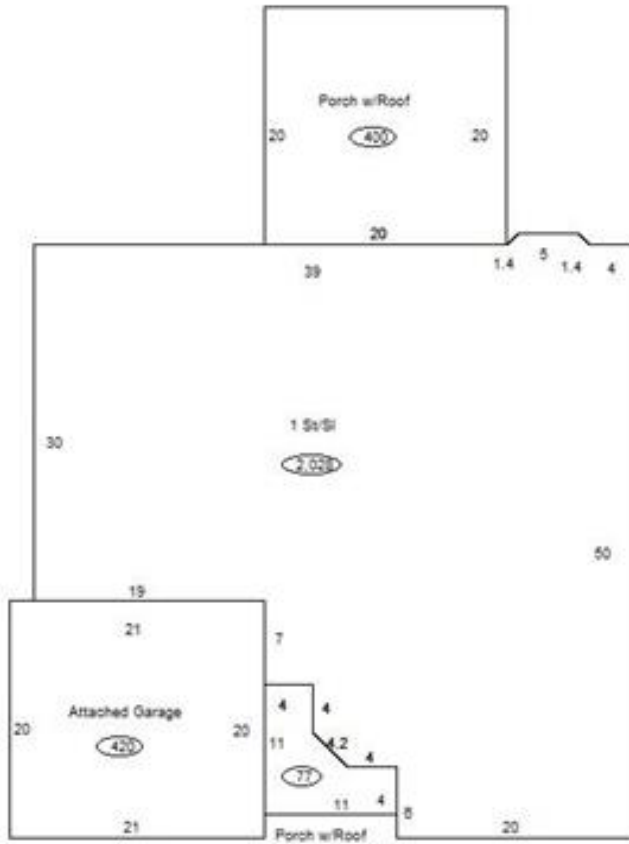

### Sketch Vector Information

Sequence	Code	Type	Built Over	Scale	Section Label	Base Area	Multiplier	Total Area
1	R	1	Slab	13	1 St/Sl	2,028	1.000	2,028
2	G	1		13	Attached Garage	420	1.000	420
3	M	PRCH		13	SLBC	77	1.000	77
4	M	PRCH		13	SLBC	400	1.000	400
<b>Total Building Area</b>						2,028		2,028



# Rogers

## Assessment Property Record Card for Tax Year 2026

Data provided by LISA DELOZIER County Assessor

Date 04/16/2026  
Time 23:56:40  
Page 4

660072205

### Outbuildings/Site Improvements

Building Image	Code	Description	Dimensions	Floor	Roofing	Total Units
	UTIL	SHOP BUILDING	0x0x0			2,000
	Qual 2	Cond 3	Year 2005	Eff Age		
		<b>Valuation Summary</b>	<b>Modifier Total</b>	<b>RCN</b>	<b>Depr (10% Phys/ % Func)</b>	<b>RCNLD</b>
		Base Cost (26.89 x 2,000)	53,780	53,780	5,378	48,402