



Rogers

Assessment Property Record Card for Tax Year 2026

Data provided by LISA DELOZIER County Assessor

Date 04/17/2026
Time 02:25:13
Page 1

Assessment Data					Primary Image				
Account	660072621								
Parcel ID	000000-00-0-00317-010-0002								
Cadastral ID	03-21-14-03910								
Property Type	REAL - Real Property								
Property Class	RRP	VI Area 4							
Tax Area	16 - OWASSO/COLL FIRE								
Name ID	287287								
AHMED, REHMAN									
SHEILAH									
11633 N 158TH E AVE COLLINSVILLE OK 74021-0000									
Parcel Location									
Situs	11633 N 158TH E AVE								
Subdivision	FALCON RIDGE II								
Lot/Block	0002 / 0010	Parcel Size 1 - Lots							
Sec/Twn/Rng	3 / 21 / 14 / 5								
Neighborhood	1047 - R-V04-SW OWASSO								
School District	S021 - OWASSO SCHOOLS								
Legal Description									
Lat/Long: 36.32274163 -95.79707030									
LOT 2 BLOCK 10 FALCON RIDGE II									
Building Permits									
Number	Description	Opened	Closed	Amount					
10275	R7-NEW 1200 SQ FT POLE BARN (30x	08/2006	12/2006	6,000					
6022	NEW HOME	01/2001	11/2001						
Exemptions									
Code	Type	Active	Maximum	Exemption					
H	Homestead	Yes	1,000	1,000					
Sale History									
Bk/Pg	Grantor	Date	Price	Code					
1637/426	SECRETARY OF HUD	11/09/2004	119,000	1					
1616/381	GILMORE, RICHARD	07/27/2004	0	10					
1239/761	HERITAGE CONSTRUCTION	07/28/2000	114,000	Yes					
1217/639	A&W LAND DEVELOPMENT INC	03/06/2000	17,667	No					
Parcel Valuation									
Source	REAL	Fair Cash	Capped	Asmnt Level	Assessed	Levy Rate	97.960	Current Tax	
Remove Cap	2005	Land Value	81,725	34,905	11%	3,840	Assessed	21,772	2,132.79
Year Frozen	0	Improvements	182,250	163,020		17,932	Penalty	0	
Uncapped Value	0	Mobile Home	0	0		0	Exemption	1,000	-98.00
TIF Project ID	0	Total Value	263,975	197,925		21,772	Total Taxable	20,772	2,035.00
Assessment History									
Tax Year	Statement Number	Billed Owner	Tax Area	Total Value	Exemptions	Taxable Value	Billed Tax		
2025	2025-660072621	AHMED, REHMAN	16	261,264	1000	20,138	1,973.00		
2024	2024-660072621	AHMED, REHMAN	16	266,459	1000	19,522	1,875.00		
2023	2023-660072621	AHMED, REHMAN	16	190,316	1000	18,925	1,773.00		
2022	2022-660072621	AHMED, REHMAN	16	186,457	1000	18,344	1,797.00		
2021	2021-660072621	AHMED, REHMAN	16	170,735	1000	17,781	1,720.00		
2020	2020-660072621	AHMED, REHMAN	16	169,587	1000	17,302	1,671.00		
2019	2019-660072621	AHMED, REHMAN	16	161,537	1000	16,769	1,621.00		
2018	2018-660072621	AHMED, REHMAN	16	167,588	1000	17,435	1,623.00		
2017	2017-660072621	AHMED, REHMAN	16	166,090	1000	17,202	1,618.00		
2016	2016-660072621	AHMED, REHMAN	16	160,738	1000	16,672	1,570.00		
2015	2015-660072621	AHMED, REHMAN	16	155,979	1000	16,158	1,532.00		
2014	2014-660072621	AHMED, REHMAN	16	158,602	1000	15,992	1,531.00		
2013	2013-660072621	AHMED, REHMAN	16	149,976	1000	15,497	1,452.00		



Rogers

Assessment Property Record Card for Tax Year 2026

Data provided by LISA DELOZIER County Assessor

Date 04/17/2026
Time 02:25:14
Page 2

Lot Data	Square-Foot - NBHD 1047 #1	Primary Image
Lot Size		
Lot Count		
Units Buildable	1	
Non-Ag Acres	1.03	
Topography		
Street Access		
Utilities		
Amenities	0	
	0	
Method	Square-Foot	
Base Lot Value	44,866.00 x 1.82 = 81,725	
Factor Value		
Adjustments	1.0000	
Lot Value	81,725	

Residential Data	
Type	1 Single Family Residence
Condition	3 - Average
Quality	2.5 - Fair
Architecture	
Style	100% One Story
Exterior Wall	100% Veneer, Masonry
Base/Total Area	1,615 / 1,615
Style	100% One Story
HVAC	100% Warmed & Cooled Air
Roof Cover	1 Composition Shingle
Area on Slab	1,615
Fixture/RghIn	11 /
Bed/F/H Bath	3 / 2.0 /
Basement Area	
Garage Type	441 Attached Garage - Unfinished
Remodel	
Year/Eff Age	2000 / 20



\\tsclient\C\TOMS PC PICS\2018-02-16 02-16-2018\02-16-2018 1C 2/20/2018

GRM Approach	
GRM Code	
Gross Rent	0.00
Indicated Value	

Multiple Regression			
MRA Code	1	Test	
Adusted R	0.8445		
Indicated Value	197,733	122.44	Per SqFt

Direct Comparables			
Selection Model	A	Adam Test	
Adjustment Model	1	2022 Residential	
Comparables	5		
Indicated Value	231,390		Per SqFt

Value Reconciliation			
Selected Approach	Cost Approach		
Improvements	171,412		
Lot Value	81,725		
Indicated Value	253,137	156.74	Per SqFt
Agland Value			
Site Improvements	10,838		
Total Value	263,975	163.45	Total Value Per SqFt

Cost Approach				Manual : 01/2025			
Base Cost	105.32	Total Misc Impr	+	8,030			
Roofing Adj	+ 4.45	Garage Cost	+	12,507			
Subfloor Adj	+ -1.15	Total RCN	=	228,549			
Heat/Cool Adj	+ 11.47	Depreciation (25%)	-	57,137			
Plumbing Adj	+ 8.71	Lump Sums	+	0			
Basement Adj	+ 0.00	RCNLD	=	171,412			
Adj Base Cost	= 128.80	Lot Value	+	81,725			
Total Area	x 1,615	Indicated Value	=	253,137			
Adjusted Cost	= 208,012	Value Per SqFt		156.74			

Miscellaneous Improvements								
Code	Description	Sketch ID	Size	Year	Units	Unit Cost	Depr	Value
FPR1	FIREPLACE - RESIDENTIAL 1 STORY	0		1	1	5,095.98		5,096
PRCH	SLAB PORCH - COVERED	86123	6x6		36	24.16		870
PRCH	SLAB PORCH - COVERED	86126	86		86	24.00		2,064



Rogers
Assessment Property Record Card for Tax Year 2026
 Data provided by LISA DELOZIER County Assessor

Date 04/17/2026
 Time 02:25:14
 Page 3

Sketch Image

660072621

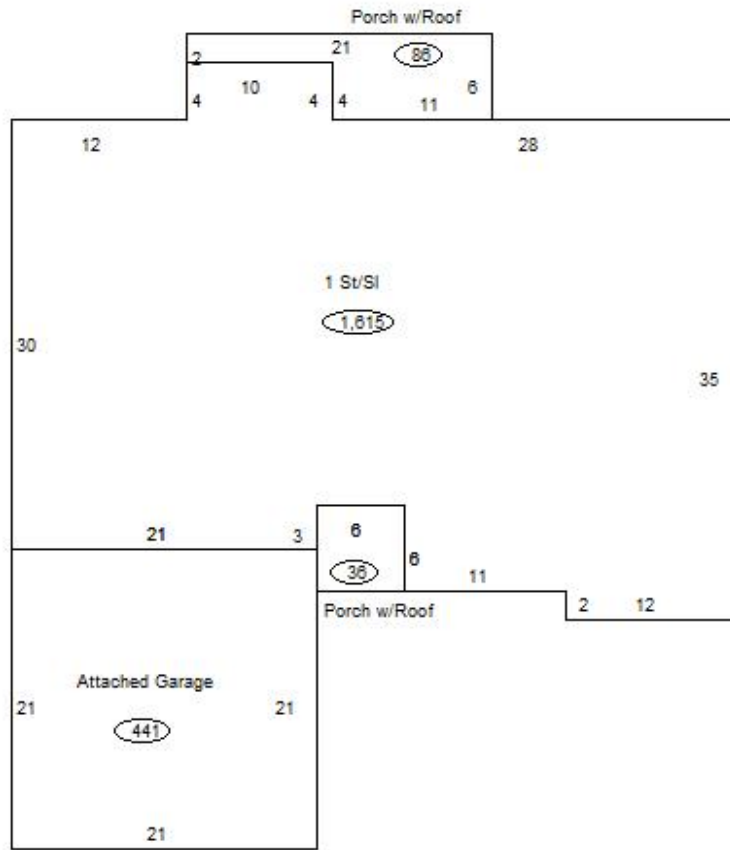

Sketch Vector Information

Sequence	Code	Type	Built Over	Scale	Section Label	Base Area	Multiplier	Total Area
1	M	PRCH		13	SLBC	36	1.000	36
2	R	1	Slab	13	1 St/Sl	1,615	1.000	1,615
3	G	1		13	Attached Garage	441	1.000	441
4	M	PRCH		13	SLBC	86	1.000	86
Total Building Area						1,615		1,615



Rogers

Assessment Property Record Card for Tax Year 2026

Data provided by LISA DELOZIER County Assessor

Date 04/17/2026
Time 02:25:14
Page 4

660072621

Outbuildings/Site Improvements

Building Image	Code	Description	Dimensions	Floor	Roofing	Total Units
	BARN	BARN	0x0x0			1,260
	Qual	3	Cond 3	Year	Eff Age	
Valuation Summary		Modifier Total	RCN	Depr (15% Phys/ % Func)		RCNLD
Base Cost (10.12 x 1,260)		12,751	12,751	1,913		10,838