



Rogers

Assessment Property Record Card for Tax Year 2026

Data provided by LISA DELOZIER County Assessor

Date 04/17/2026
Time 04:49:59
Page 1

Assessment Data					Primary Image																																																																																																																				
Account 660073863 Parcel ID 22N16E-15-3-00000-000-0000 Cadastral ID 15-22-16-01500 Property Type REAL - Real Property Property Class RR VI Area 1 Tax Area 11 - SEQUOYAH/NW FIRE Name ID 262391 KIRKENDALL, DON C TRUSTEE 16251 S 4160 RD CLAREMORE OK 74017-1221 Parcel Location Situs 13119 E 440 RD Subdivision Lot/Block / Parcel Size 2.15 - Acres Sec/Twn/Rng 15 / 22 / 16 / 3 Neighborhood 6050 - UNPLATTED School District S006 - SEQUOYAH SCHOOLS																																																																																																																									
Legal Description Lat/Long: 36.38012459 -95.59525982 S 272.74' SW SW SW LESS S 272.74' W 170' E 180' SW SW SW SW & LESS W 150' OF S 272.74 OF SW SW SW																																																																																																																									
Exemptions <table border="1"> <thead> <tr> <th>Code</th> <th>Type</th> <th>Active</th> <th>Maximum</th> <th>Exemption</th> </tr> </thead> <tbody> <tr> <td>H</td> <td>Homestead</td> <td>No</td> <td>1,000</td> <td></td> </tr> <tr> <td>PD</td> <td>Add-Homestead</td> <td>No</td> <td>1,000</td> <td></td> </tr> </tbody> </table>					Code	Type	Active	Maximum	Exemption	H	Homestead	No	1,000		PD	Add-Homestead	No	1,000		Building Permits <table border="1"> <thead> <tr> <th>Number</th> <th>Description</th> <th>Opened</th> <th>Closed</th> <th>Amount</th> </tr> </thead> <tbody> <tr> <td>R3</td> <td>RECK FOR HOUSE BUILT PER OWNEI</td> <td>10/2002</td> <td>01/2004</td> <td></td> </tr> </tbody> </table>					Number	Description	Opened	Closed	Amount	R3	RECK FOR HOUSE BUILT PER OWNEI	10/2002	01/2004																																																																																								
Code	Type	Active	Maximum	Exemption																																																																																																																					
H	Homestead	No	1,000																																																																																																																						
PD	Add-Homestead	No	1,000																																																																																																																						
Number	Description	Opened	Closed	Amount																																																																																																																					
R3	RECK FOR HOUSE BUILT PER OWNEI	10/2002	01/2004																																																																																																																						
Parcel Valuation <table border="1"> <thead> <tr> <th>Source</th> <th>REAL</th> <th>Fair Cash</th> <th>Capped</th> <th>Asmnt Level</th> <th>Assessed</th> <th>Levy Rate</th> <th>102.332</th> <th>Current Tax</th> </tr> </thead> <tbody> <tr> <td>Remove Cap</td> <td>0</td> <td>Land Value 46,811</td> <td>30,111</td> <td>11%</td> <td>3,312</td> <td>Assessed</td> <td>14,535</td> <td>1,487.39</td> </tr> <tr> <td>Year Frozen</td> <td>2015</td> <td>Improvements 165,013</td> <td>102,027</td> <td></td> <td>11,223</td> <td>Penalty</td> <td>0</td> <td></td> </tr> <tr> <td>Uncapped Value</td> <td>0</td> <td>Mobile Home 0</td> <td>0</td> <td></td> <td>0</td> <td>Exemption</td> <td>0</td> <td>0.00</td> </tr> <tr> <td>TIF Project ID</td> <td>0</td> <td>Total Value 211,824</td> <td>132,138</td> <td></td> <td>14,535</td> <td>Total Taxable</td> <td>14,535</td> <td>1,487.00</td> </tr> </tbody> </table>					Source	REAL	Fair Cash	Capped	Asmnt Level	Assessed	Levy Rate	102.332	Current Tax	Remove Cap	0	Land Value 46,811	30,111	11%	3,312	Assessed	14,535	1,487.39	Year Frozen	2015	Improvements 165,013	102,027		11,223	Penalty	0		Uncapped Value	0	Mobile Home 0	0		0	Exemption	0	0.00	TIF Project ID	0	Total Value 211,824	132,138		14,535	Total Taxable	14,535	1,487.00	Sale History <table border="1"> <thead> <tr> <th>Bk/Pg</th> <th>Grantor</th> <th>Date</th> <th>Price</th> <th>Code</th> </tr> </thead> <tbody> <tr> <td>2626/558</td> <td>KIRKENDALL, DON C</td> <td>04/13/2017</td> <td></td> <td>4</td> </tr> </tbody> </table>					Bk/Pg	Grantor	Date	Price	Code	2626/558	KIRKENDALL, DON C	04/13/2017		4																																																									
Source	REAL	Fair Cash	Capped	Asmnt Level	Assessed	Levy Rate	102.332	Current Tax																																																																																																																	
Remove Cap	0	Land Value 46,811	30,111	11%	3,312	Assessed	14,535	1,487.39																																																																																																																	
Year Frozen	2015	Improvements 165,013	102,027		11,223	Penalty	0																																																																																																																		
Uncapped Value	0	Mobile Home 0	0		0	Exemption	0	0.00																																																																																																																	
TIF Project ID	0	Total Value 211,824	132,138		14,535	Total Taxable	14,535	1,487.00																																																																																																																	
Bk/Pg	Grantor	Date	Price	Code																																																																																																																					
2626/558	KIRKENDALL, DON C	04/13/2017		4																																																																																																																					
Assessment History <table border="1"> <thead> <tr> <th>Tax Year</th> <th>Statement Number</th> <th>Billed Owner</th> <th>Tax Area</th> <th>Total Value</th> <th>Exemptions</th> <th>Taxable Value</th> <th>Billed Tax</th> </tr> </thead> <tbody> <tr><td>2025</td><td>2025-660073863</td><td>KIRKENDALL, DON C</td><td>11</td><td>198,026</td><td>0</td><td>13,843</td><td>1,417.00</td></tr> <tr><td>2024</td><td>2024-660073863</td><td>KIRKENDALL, DON C</td><td>11</td><td>205,432</td><td>2000</td><td>11,184</td><td>1,177.00</td></tr> <tr><td>2023</td><td>2023-660073863</td><td>KIRKENDALL, DON C</td><td>11</td><td>166,005</td><td>2000</td><td>11,184</td><td>1,200.00</td></tr> <tr><td>2022</td><td>2022-660073863</td><td>KIRKENDALL, DON C</td><td>11</td><td>172,798</td><td>2000</td><td>11,184</td><td>1,207.00</td></tr> <tr><td>2021</td><td>2021-660073863</td><td>KIRKENDALL, DON C</td><td>11</td><td>152,895</td><td>2000</td><td>11,184</td><td>1,165.00</td></tr> <tr><td>2020</td><td>2020-660073863</td><td>KIRKENDALL, DON C</td><td>11</td><td>150,929</td><td>2000</td><td>11,184</td><td>1,203.00</td></tr> <tr><td>2019</td><td>2019-660073863</td><td>KIRKENDALL, DON C</td><td>11</td><td>131,724</td><td>2000</td><td>11,184</td><td>1,188.00</td></tr> <tr><td>2018</td><td>2018-660073863</td><td>KIRKENDALL, DON C</td><td>11</td><td>134,693</td><td>2000</td><td>11,184</td><td>1,200.00</td></tr> <tr><td>2017</td><td>2017-660073863</td><td>KIRKENDALL, DON C</td><td>11</td><td>133,733</td><td>2000</td><td>11,184</td><td>1,171.00</td></tr> <tr><td>2016</td><td>2016-660073863</td><td>KIRKENDALL, DON C</td><td>11</td><td>130,828</td><td>2000</td><td>11,184</td><td>1,180.00</td></tr> <tr><td>2015</td><td>2015-660073863</td><td>KIRKENDALL, DON C</td><td>11</td><td>127,109</td><td>2000</td><td>11,184</td><td>1,188.00</td></tr> <tr><td>2014</td><td>2014-660073863</td><td>KIRKENDALL, DON C</td><td>11</td><td>128,173</td><td>1000</td><td>11,800</td><td>1,239.00</td></tr> <tr><td>2013</td><td>2013-660073863</td><td>KIRKENDALL, DON C</td><td>11</td><td>121,969</td><td>1000</td><td>11,427</td><td>1,180.00</td></tr> </tbody> </table>										Tax Year	Statement Number	Billed Owner	Tax Area	Total Value	Exemptions	Taxable Value	Billed Tax	2025	2025-660073863	KIRKENDALL, DON C	11	198,026	0	13,843	1,417.00	2024	2024-660073863	KIRKENDALL, DON C	11	205,432	2000	11,184	1,177.00	2023	2023-660073863	KIRKENDALL, DON C	11	166,005	2000	11,184	1,200.00	2022	2022-660073863	KIRKENDALL, DON C	11	172,798	2000	11,184	1,207.00	2021	2021-660073863	KIRKENDALL, DON C	11	152,895	2000	11,184	1,165.00	2020	2020-660073863	KIRKENDALL, DON C	11	150,929	2000	11,184	1,203.00	2019	2019-660073863	KIRKENDALL, DON C	11	131,724	2000	11,184	1,188.00	2018	2018-660073863	KIRKENDALL, DON C	11	134,693	2000	11,184	1,200.00	2017	2017-660073863	KIRKENDALL, DON C	11	133,733	2000	11,184	1,171.00	2016	2016-660073863	KIRKENDALL, DON C	11	130,828	2000	11,184	1,180.00	2015	2015-660073863	KIRKENDALL, DON C	11	127,109	2000	11,184	1,188.00	2014	2014-660073863	KIRKENDALL, DON C	11	128,173	1000	11,800	1,239.00	2013	2013-660073863	KIRKENDALL, DON C	11	121,969	1000	11,427	1,180.00
Tax Year	Statement Number	Billed Owner	Tax Area	Total Value	Exemptions	Taxable Value	Billed Tax																																																																																																																		
2025	2025-660073863	KIRKENDALL, DON C	11	198,026	0	13,843	1,417.00																																																																																																																		
2024	2024-660073863	KIRKENDALL, DON C	11	205,432	2000	11,184	1,177.00																																																																																																																		
2023	2023-660073863	KIRKENDALL, DON C	11	166,005	2000	11,184	1,200.00																																																																																																																		
2022	2022-660073863	KIRKENDALL, DON C	11	172,798	2000	11,184	1,207.00																																																																																																																		
2021	2021-660073863	KIRKENDALL, DON C	11	152,895	2000	11,184	1,165.00																																																																																																																		
2020	2020-660073863	KIRKENDALL, DON C	11	150,929	2000	11,184	1,203.00																																																																																																																		
2019	2019-660073863	KIRKENDALL, DON C	11	131,724	2000	11,184	1,188.00																																																																																																																		
2018	2018-660073863	KIRKENDALL, DON C	11	134,693	2000	11,184	1,200.00																																																																																																																		
2017	2017-660073863	KIRKENDALL, DON C	11	133,733	2000	11,184	1,171.00																																																																																																																		
2016	2016-660073863	KIRKENDALL, DON C	11	130,828	2000	11,184	1,180.00																																																																																																																		
2015	2015-660073863	KIRKENDALL, DON C	11	127,109	2000	11,184	1,188.00																																																																																																																		
2014	2014-660073863	KIRKENDALL, DON C	11	128,173	1000	11,800	1,239.00																																																																																																																		
2013	2013-660073863	KIRKENDALL, DON C	11	121,969	1000	11,427	1,180.00																																																																																																																		



Rogers

Assessment Property Record Card for Tax Year 2026

Data provided by LISA DELOZIER County Assessor

Date 04/17/2026
Time 04:49:59
Page 2

Lot Data	Square-Foot - NBHD 6050 #1	Primary Image
Lot Size		
Lot Count		
Units Buildable	1	
Non-Ag Acres	0	
Topography		
Street Access		
Utilities		
Amenities	LAND QUALITY	
	0	
	0	
Method	Square-Foot	
Base Lot Value	92,486.00 x .51 = 46,811	
Factor Value		
Adjustments	1.0000	
Lot Value	46,811	

Residential Data	
Type	1 Single Family Residence
Condition	3 - Average
Quality	2 - Fair
Architecture	
Style	100% One Story
Exterior Wall	100% Frame, Siding, Wood
Base/Total Area	1,390 / 1,390
Style	100% One Story
HVAC	100% Warmed & Cooled Air
Roof Cover	4 Metal, Preformed
Area on Slab	0
Fixture/RghIn	4 /
Bed/F/H Bath	3 / 1.0 /
Basement Area	
Garage Type	
Remodel	
Year/Eff Age	2003 / 17



\\tsclient\T\LOGAN\LOGAN RESIDENTIAL VI\2022-11-28\IMG_00; 11/28/2022

GRM Approach	
GRM Code	
Gross Rent	0.00
Indicated Value	

Multiple Regression			
MRA Code	1	Test	
Adjusted R	0.8445		
Indicated Value	156,057	112.27	Per SqFt

Direct Comparables	
Selection Model	1 Res
Adjustment Model	A2 AO Test
Comparables	
Indicated Value	

Cost Approach				Manual : 01/2025	
Base Cost	88.16	Total Misc Impr	+	5,913	
Roofing Adj	+ 4.63	Garage Cost	+		
Subfloor Adj	+ 2.30	Total RCN	=	157,409	
Heat/Cool Adj	+ 10.30	Depreciation (23%)	-	36,204	
Plumbing Adj	+ 3.60	Lump Sums	+	8,282	
Basement Adj	+ 0.00	RCNLD	=	129,487	
Adj Base Cost	= 108.99	Lot Value	+	46,811	
Total Area	x 1,390	Indicated Value	=	176,298	
Adjusted Cost	= 151,496	Value Per SqFt		126.83	

Value Reconciliation			
Selected Approach	Cost Approach		
Improvements	129,487		
Lot Value	46,811		
Indicated Value	176,298	126.83	Per SqFt
Agland Value			
Site Improvements	35,526		
Total Value	211,824	152.39	Total Value Per SqFt

Miscellaneous Improvements								
Code	Description	Sketch ID	Size	Year	Units	Unit Cost	Depr	Value
PRCH	SLAB PORCH - COVERED	87244	29x10		290	20.39		5,913
WODO	WOOD DECK - OPEN	87245	20x16		320	15.15		4,848
WODO	WOOD DECK - OPEN	141673	16x10		160	21.46		3,434



Rogers

Assessment Property Record Card for Tax Year 2026

Data provided by LISA DELOZIER County Assessor

Date 04/17/2026
 Time 04:49:59
 Page 3

Sketch Image

660073863

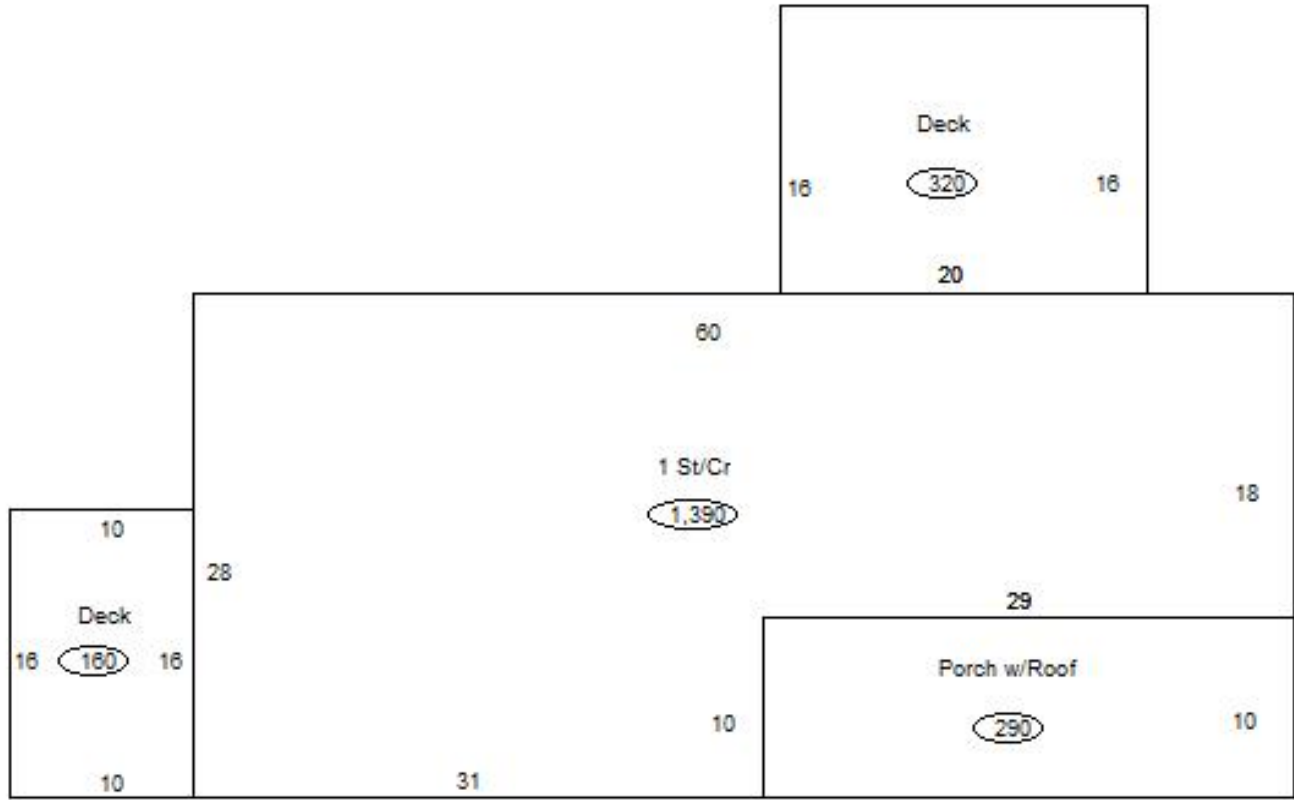

Sketch Vector Information

Sequence	Code	Type	Built Over	Scale	Section Label	Base Area	Multiplier	Total Area
1	R	1	Crawl	13	1 St/Cr	1,390	1.000	1,390
2	M	PRCH		13	SLBC	290	1.000	290
3	M	WODO		13	WODO	320	1.000	320
4	M	WODO		13	WODO	160	1.000	160
Total Building Area						1,390		1,390



Rogers



Assessment Property Record Card for Tax Year 2026

Data provided by LISA DELOZIER County Assessor

Date 04/17/2026
 Time 04:49:59
 Page 4

660073863

Outbuildings/Site Improvements

Building Image	Code	Description	Dimensions	Floor	Roofing	Total Units
	UTIL	SHOP BUILDING	0x0x0			1,500
	Qual 2	Cond 3	Year	Eff Age		
	Valuation Summary Base Cost (28.71 x 1,500) 43,065		Modifier Total	RCN 43,065	Depr (20% Phys/ % Func) 8,613	RCNLD 34,452
	LF	LOAFING SHED	0x0x0			560
	Qual 3	Cond 3	Year	Eff Age		
	Valuation Summary Base Cost (4.26 x 560) 2,386		Modifier Total	RCN 2,386	Depr (55% Phys/ % Func) 1,312	RCNLD 1,074